







The A9 Trunk Road (Tomatin to Moy)
(Side Roads) Order 201[]

SCALE

Key Plan - 1:12,500

Order Plan : SR1, SR2, SR3, SR4,
SR5, SR6, SR7, SR8, SR9, SR10,
SR11 and SR12 - 1:2500

LEGEND

Associated Road Proposals	
New Side Road	
Side Road to be Improved	
Road to be Stopped Up	
New Means of Access	
Private Means of Access to be Stopped Up	

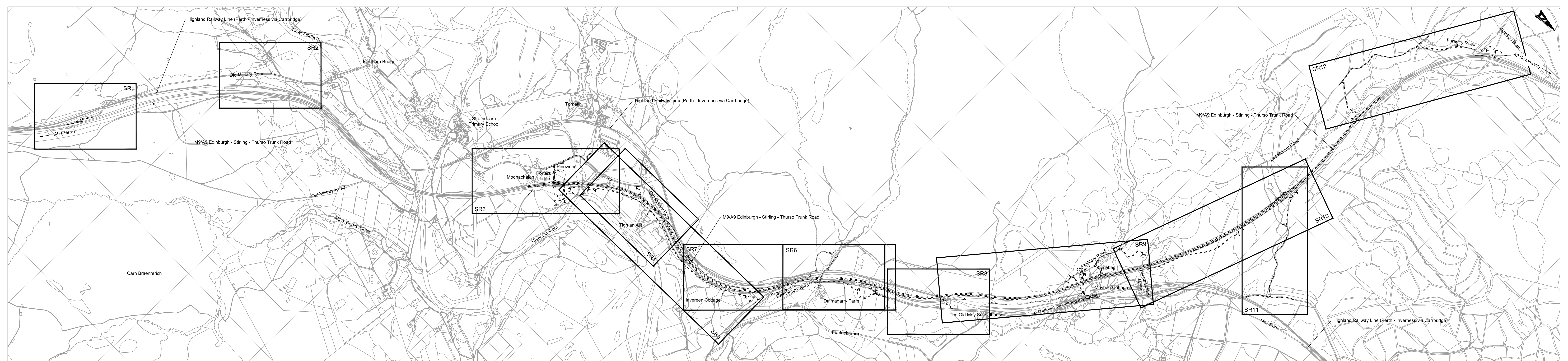

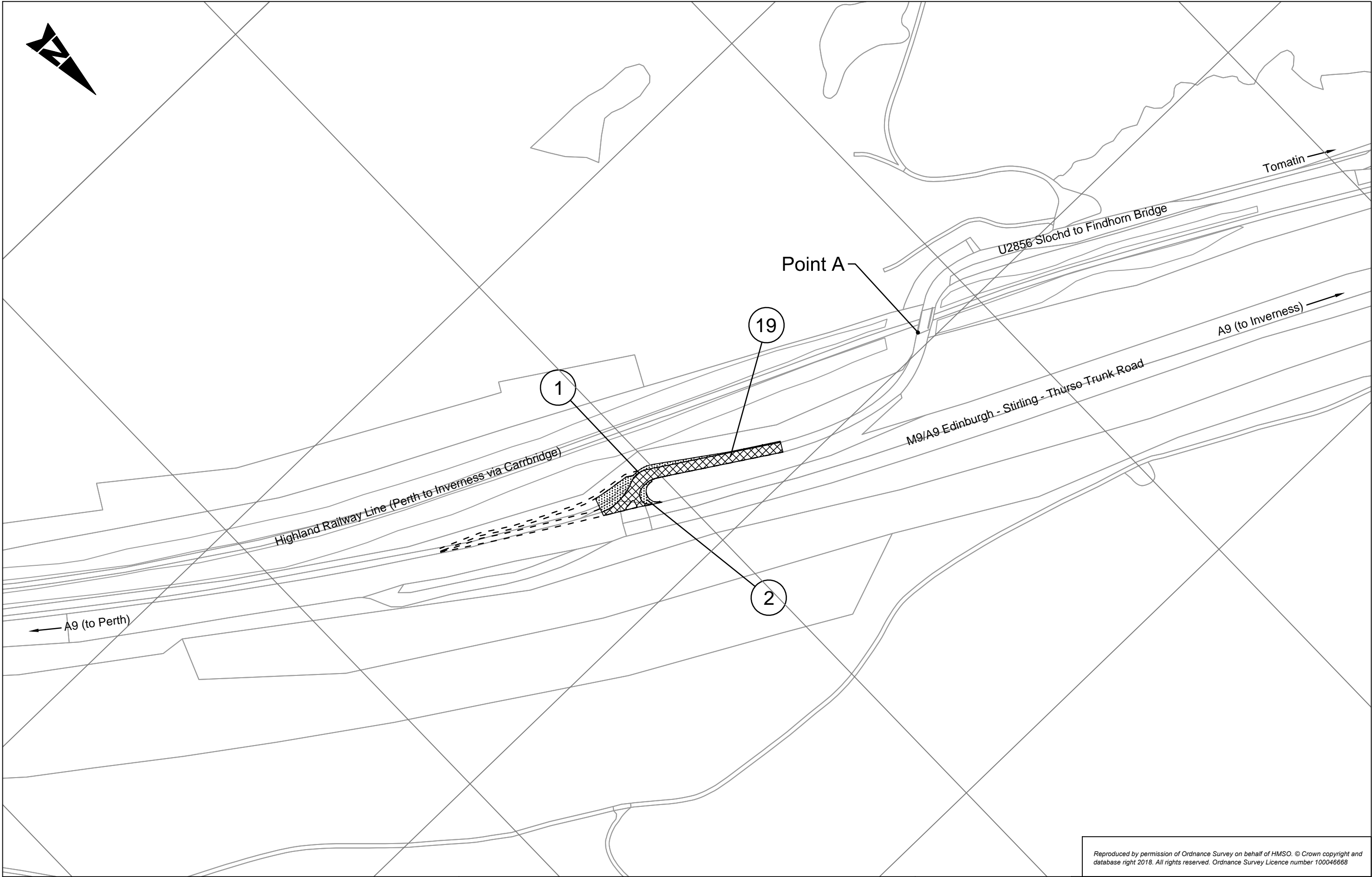

Reproduced by permission of Ordnance Survey on behalf of HMSO. © Crown copyright and database right 2018. All rights reserved. Ordnance Survey Licence number 100046668

The A9 Trunk Road (Tomatin to Moy)
(Side Roads) Order 201[]

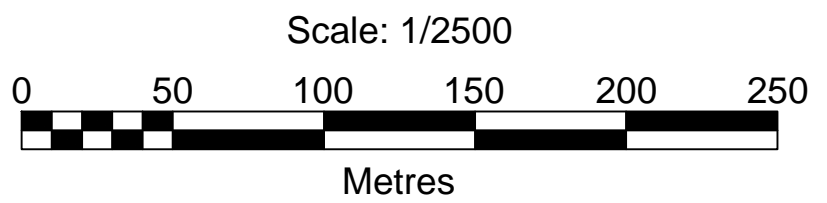

plan
SR1



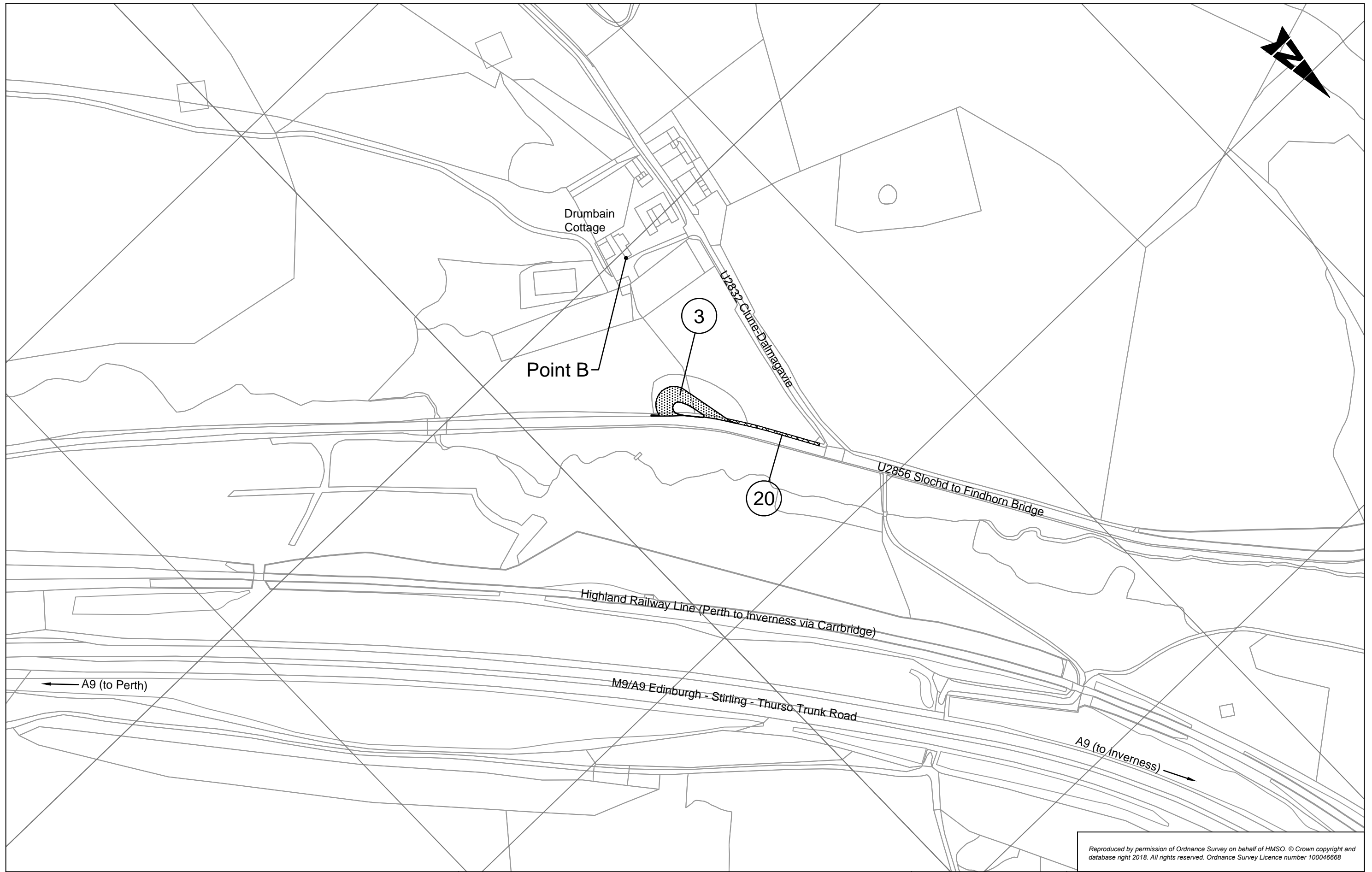

Reproduced by permission of Ordnance Survey on behalf of HMSO. © Crown copyright and database right 2018. All rights reserved. Ordnance Survey Licence number 100046668

The A9 Trunk Road (Tomatin to Moy)
(Side Roads) Order 201[]

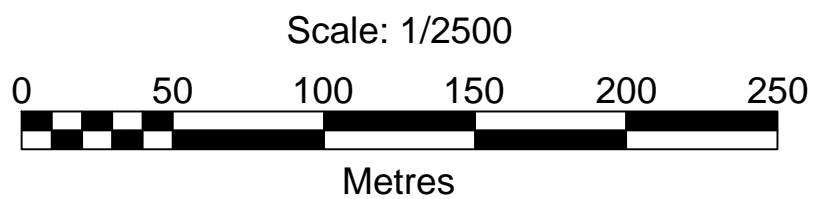

plan
SR2



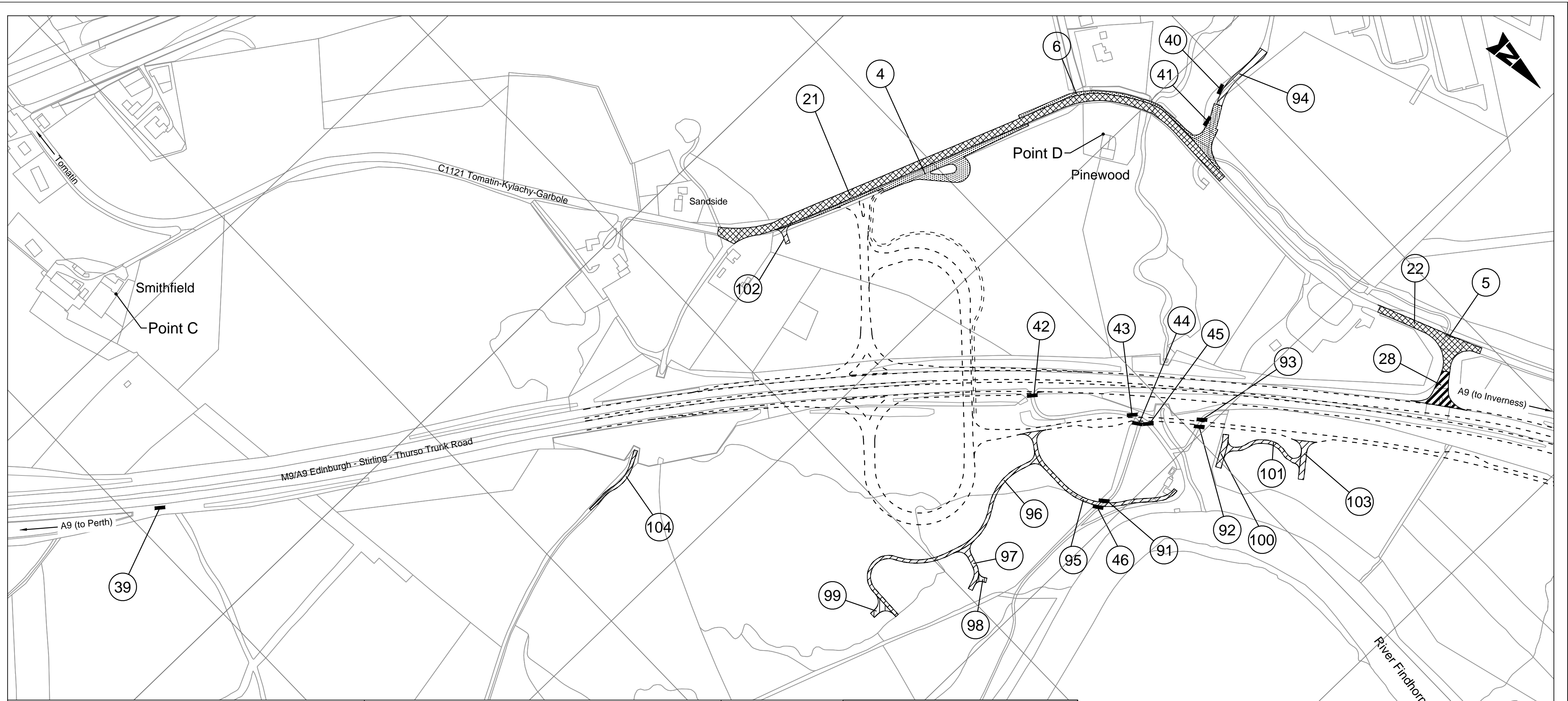

The A9 Trunk Road (Tomatin to Moy)
(Side Roads) Order 201[]

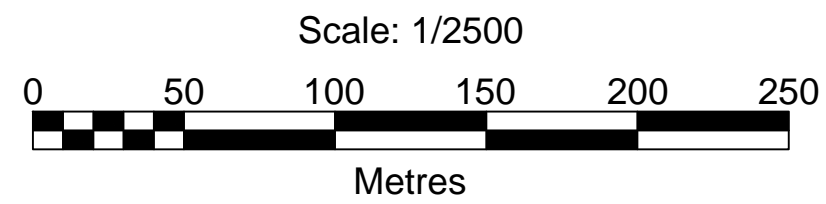

plan
SR3



Reproduced by permission of Ordnance Survey on behalf of HMSO. © Crown copyright and database right 2018. All rights reserved. Ordnance Survey Licence number 100046668

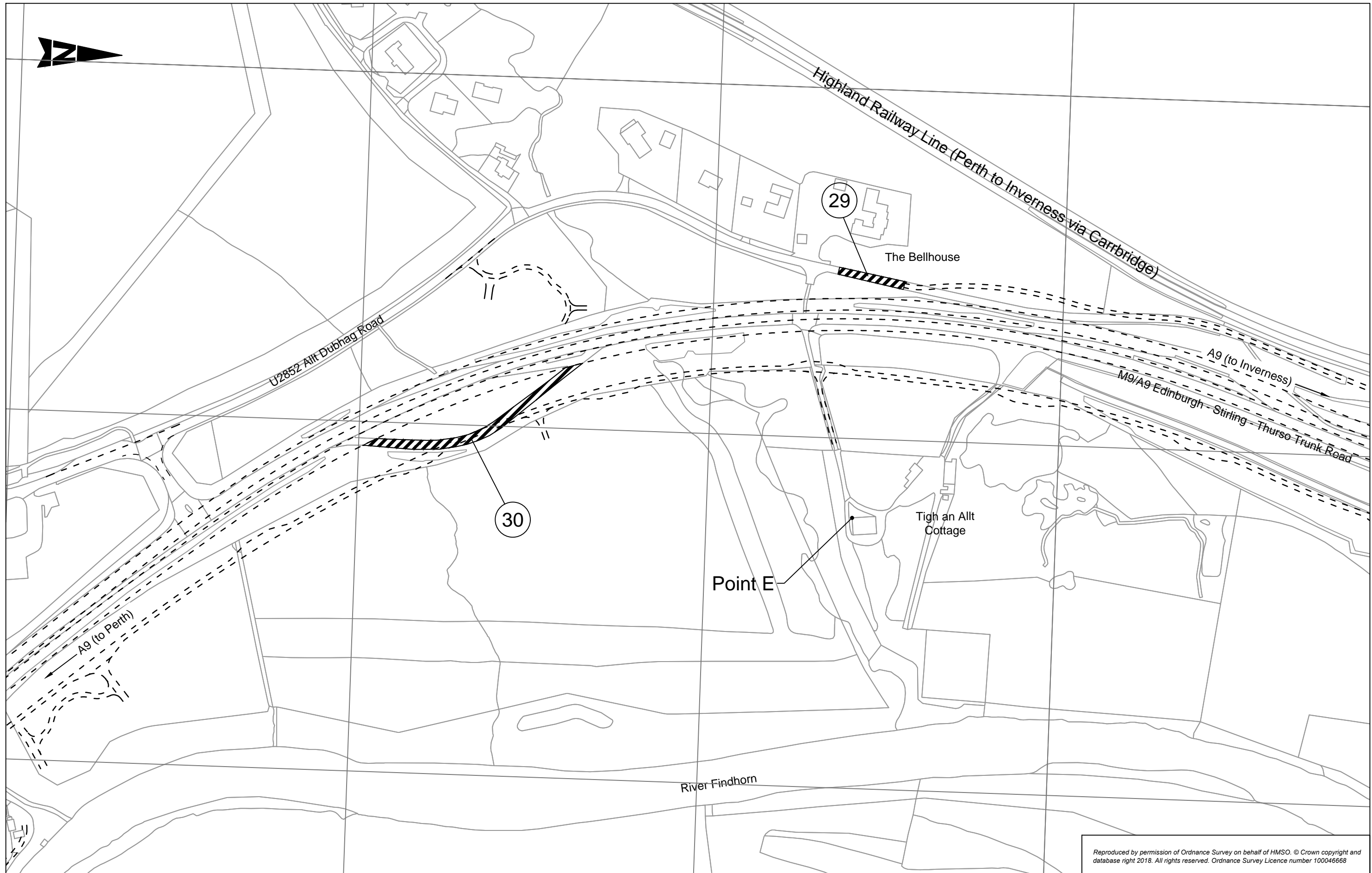

Reproduced by permission of Ordnance Survey on behalf of HMSO. © Crown copyright and database right 2018. All rights reserved. Ordnance Survey Licence number 100046668

The A9 Trunk Road (Tomatin to Moy)
(Side Roads) Order 201[]

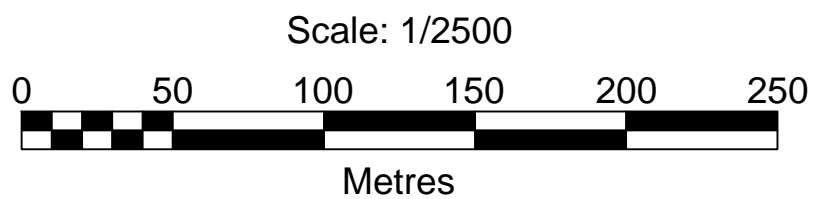

plan
SR4



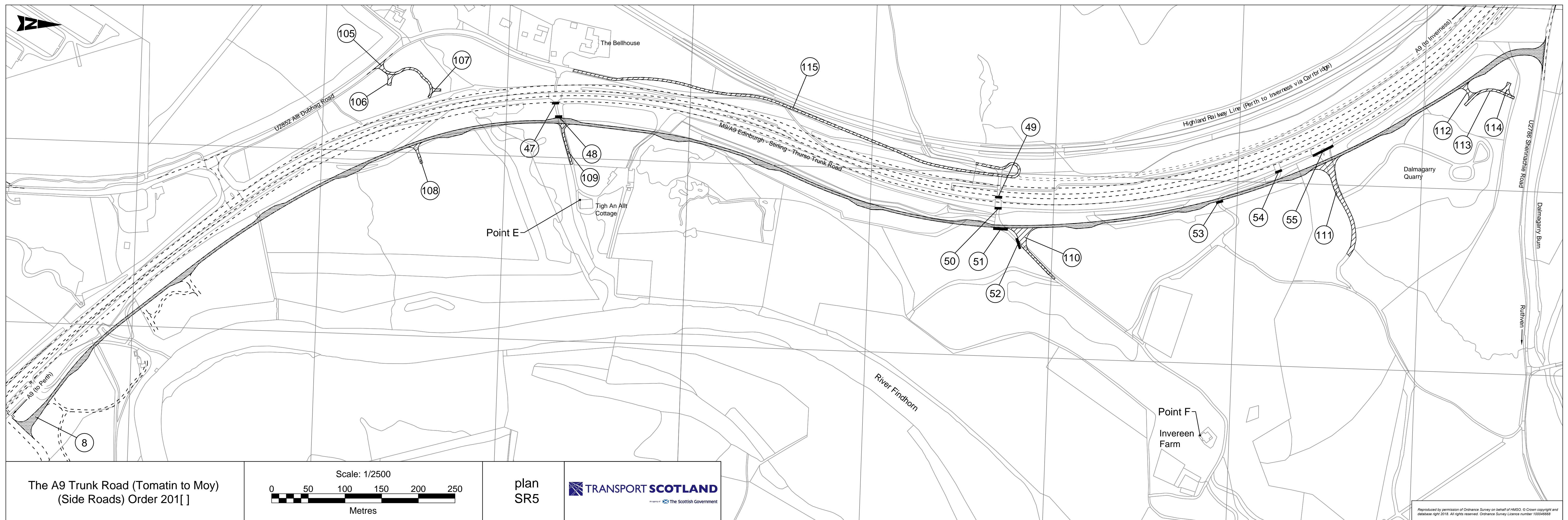

The A9 Trunk Road (Tomatin to Moy)
(Side Roads) Order 201[]

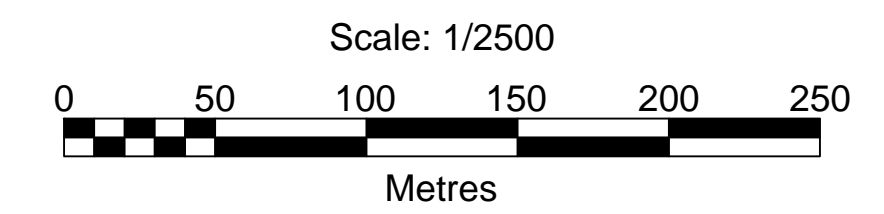

plan
SR5



Point F
Inverreen
Farm

Reproduced by permission of Ordnance Survey on behalf of HMSO. © Crown copyright and database right 2018. All rights reserved. Ordnance Survey Licence number 100046668

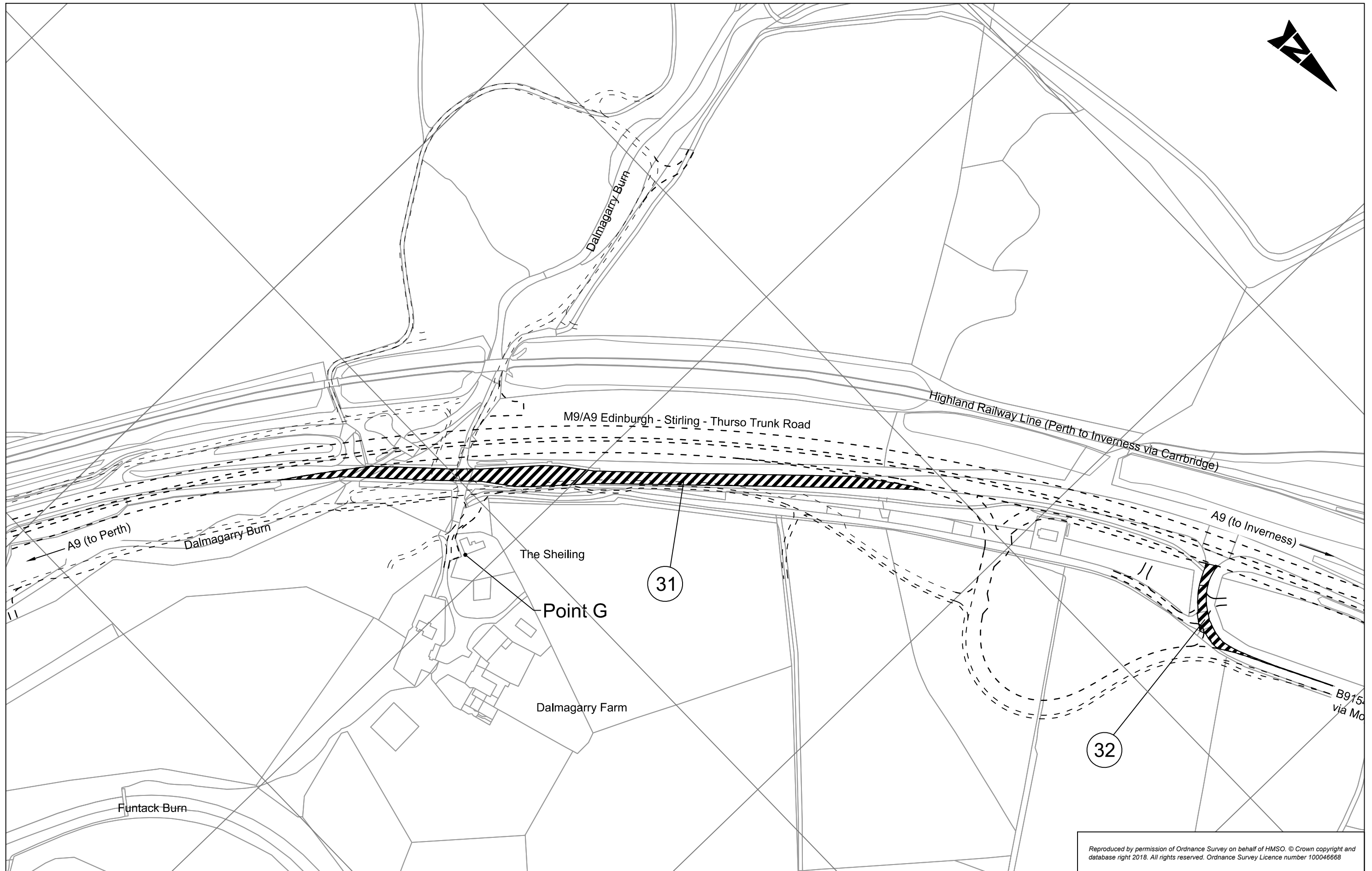

Reproduced by permission of Ordnance Survey on behalf of HMSO. © Crown copyright and database right 2018. All rights reserved. Ordnance Survey Licence number 100046668

The A9 Trunk Road (Tomatin to Moy)
(Side Roads) Order 201[]

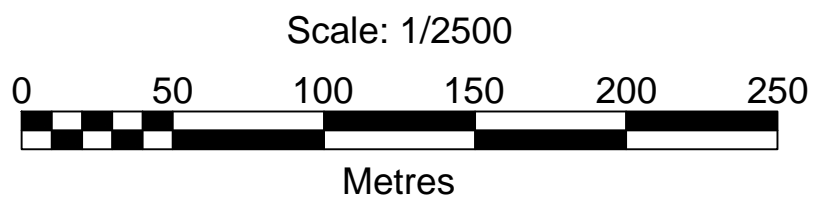

plan
SR6



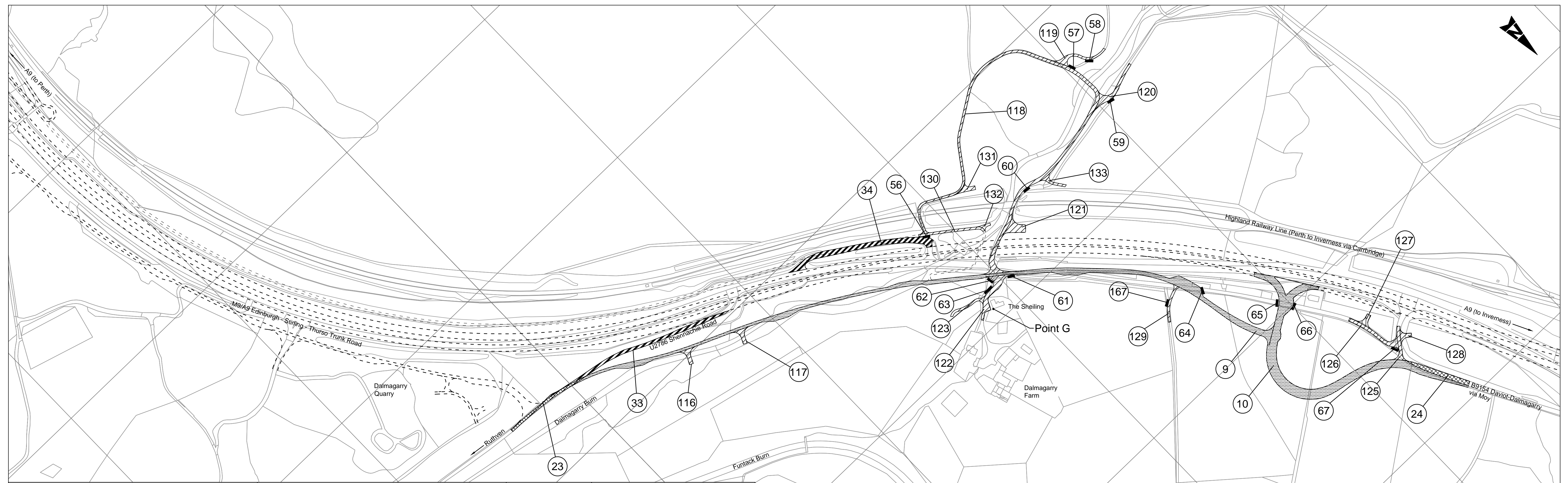

The A9 Trunk Road (Tomatin to Moy)
(Side Roads) Order 201[]

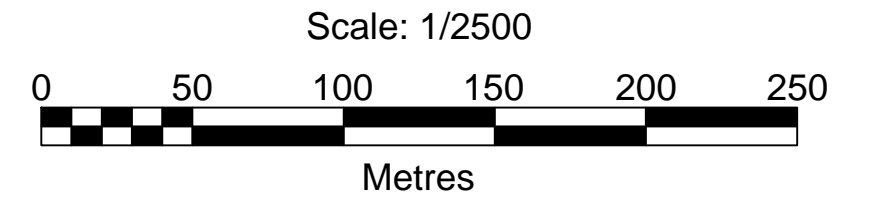

plan
SR7



Reproduced by permission of Ordnance Survey on behalf of HMSO. © Crown copyright and database right 2018. All rights reserved. Ordnance Survey Licence number 100046668

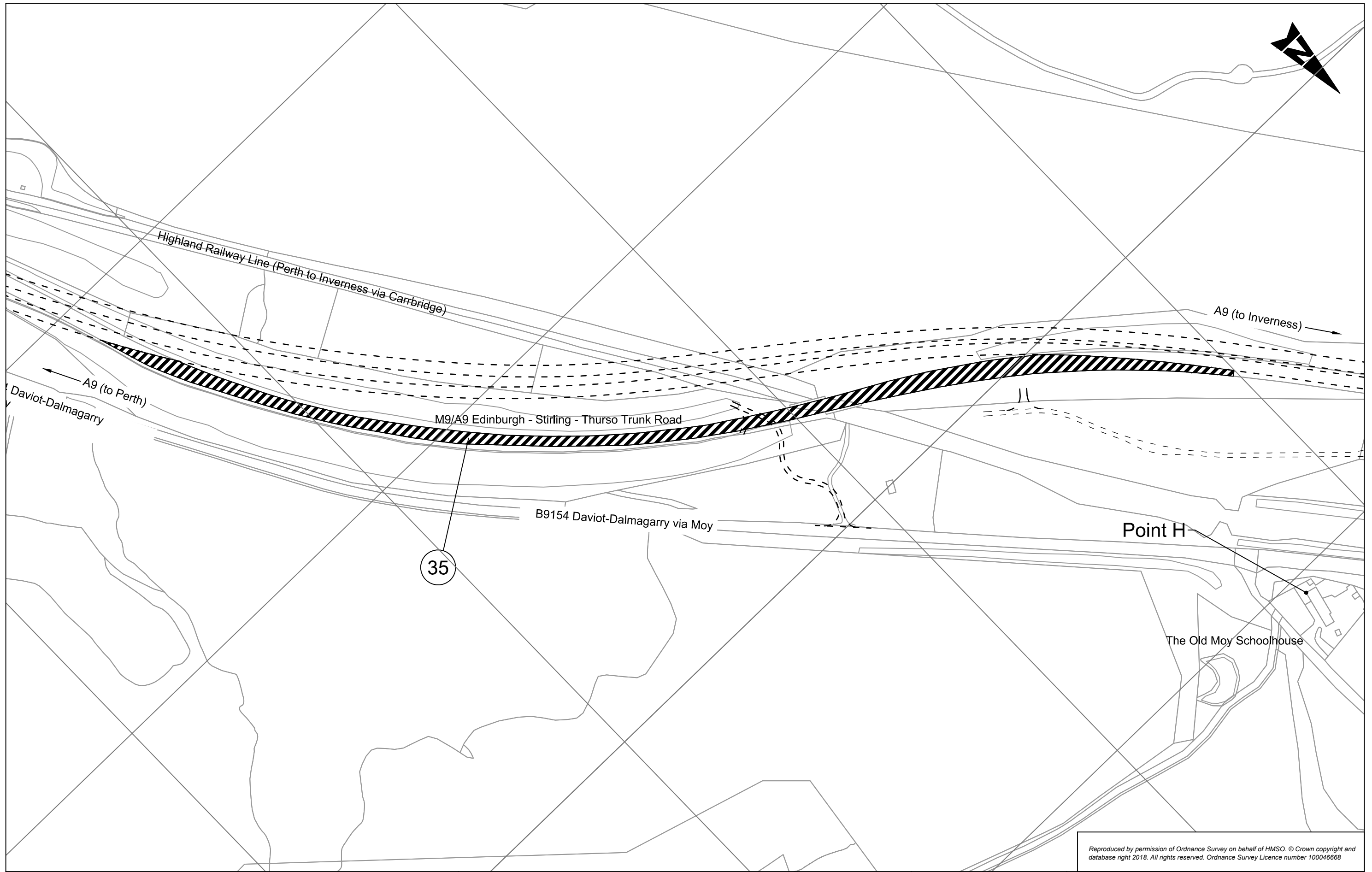

Reproduced by permission of Ordnance Survey on behalf of HMSO. © Crown copyright and database right 2018. All rights reserved. Ordnance Survey Licence number 100046668

The A9 Trunk Road (Tomatin to Moy)
(Side Roads) Order 201[]

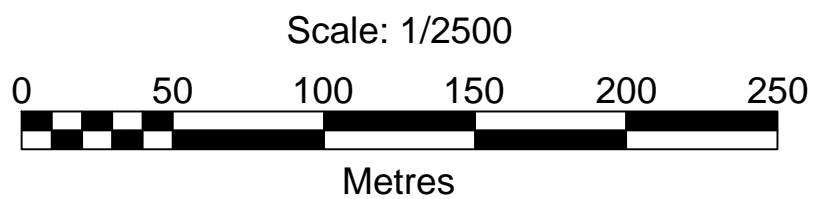

plan
SR8



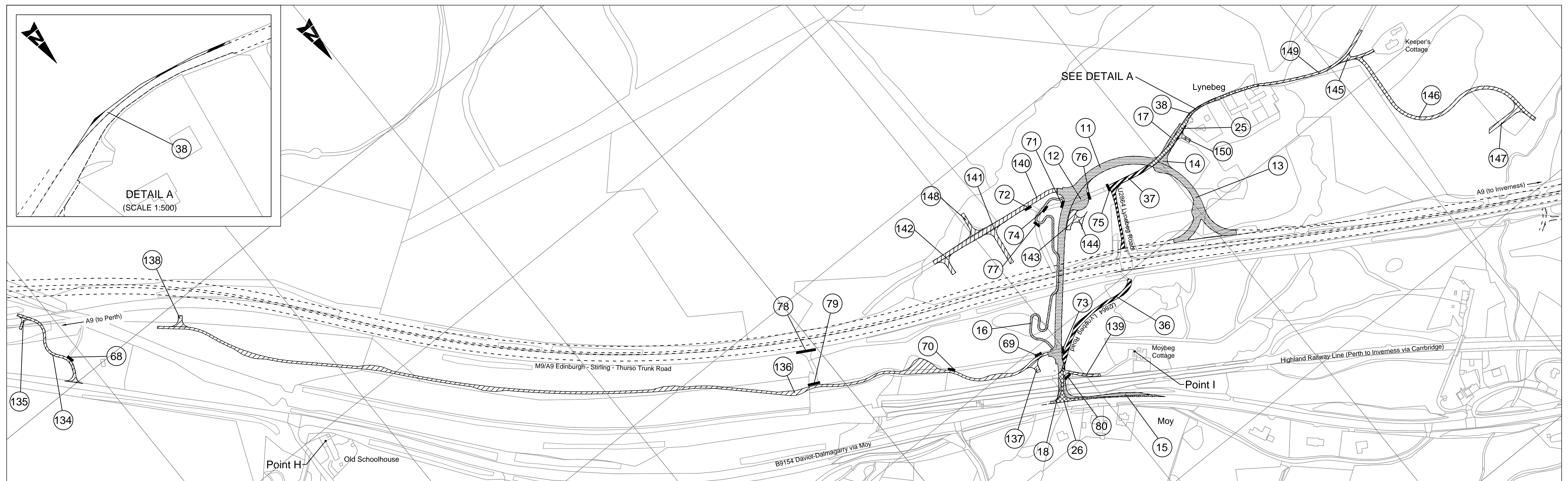
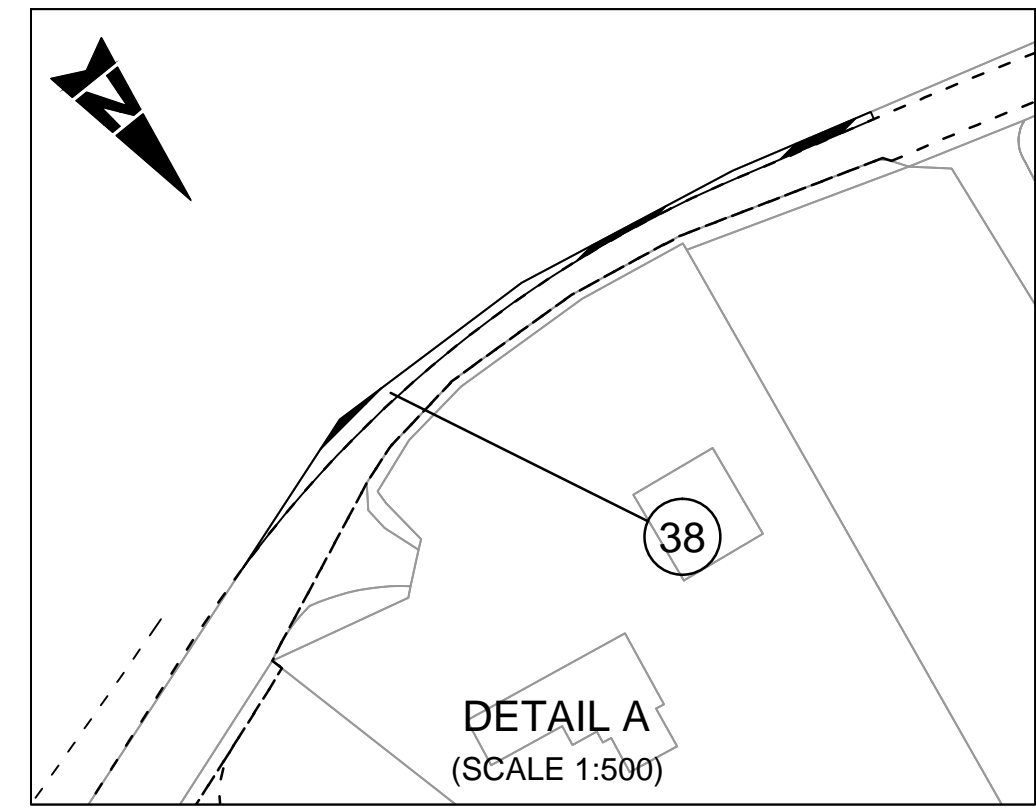

The A9 Trunk Road (Tomatin to Moy)
(Side Roads) Order 201[]

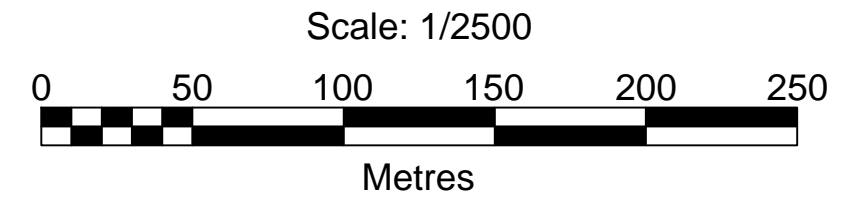

plan
SR9



Reproduced by permission of Ordnance Survey on behalf of HMSO. © Crown copyright and database right 2018. All rights reserved. Ordnance Survey Licence number 100046668

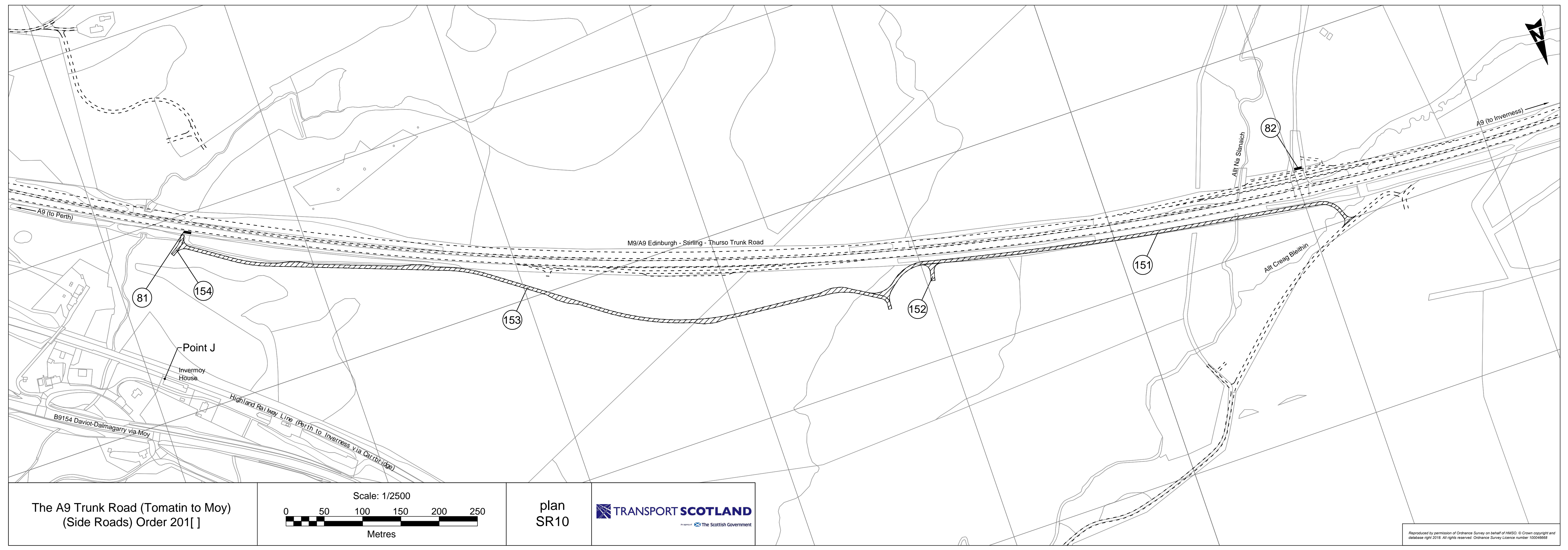

The A9 Trunk Road (Tomatin to Moy)
(Side Roads) Order 201[]

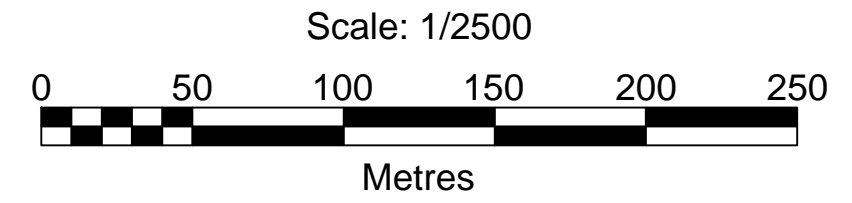

plan
SR10



Reproduced by permission of Ordnance Survey on behalf of HMSO. © Crown copyright and database right 2018. All rights reserved. Ordnance Survey Licence number 100046668

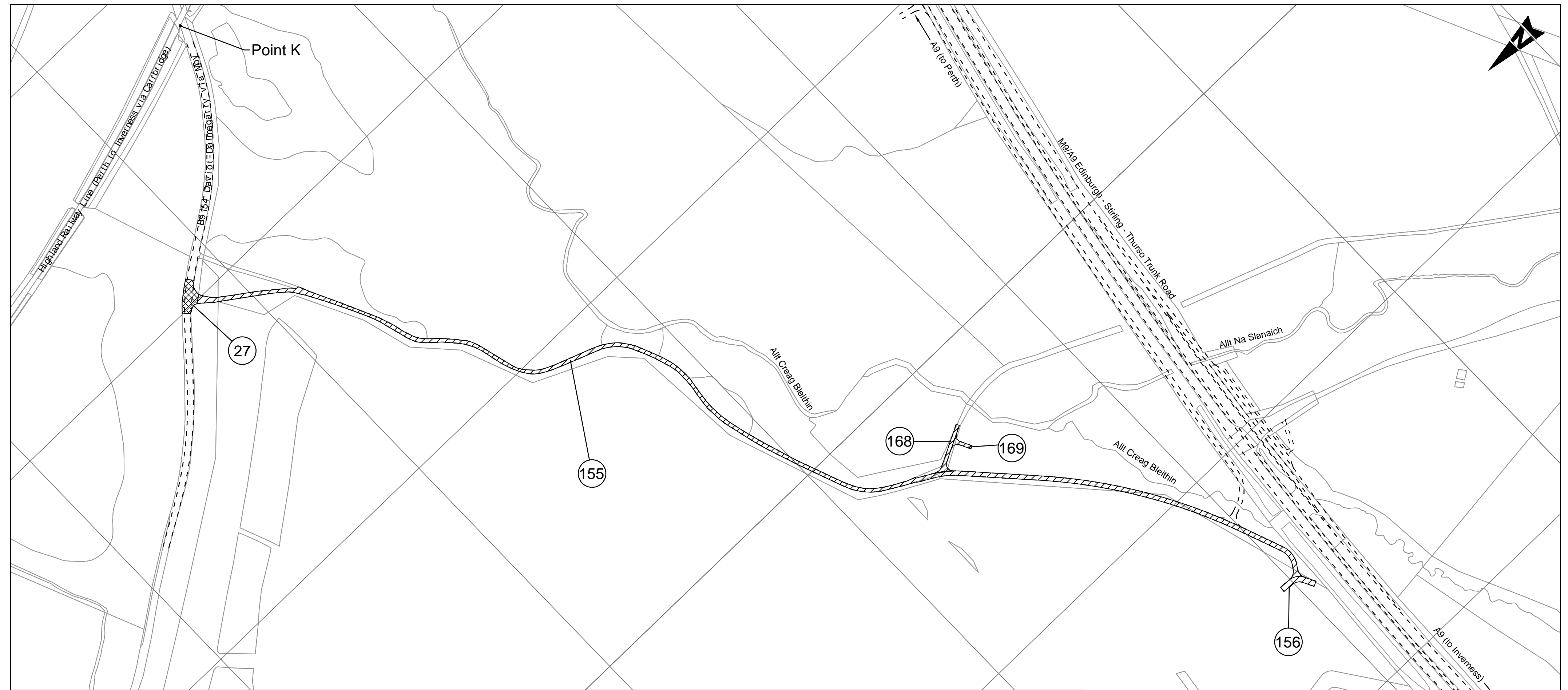

The A9 Trunk Road (Tomatin to Moy)
(Side Roads) Order 201[]

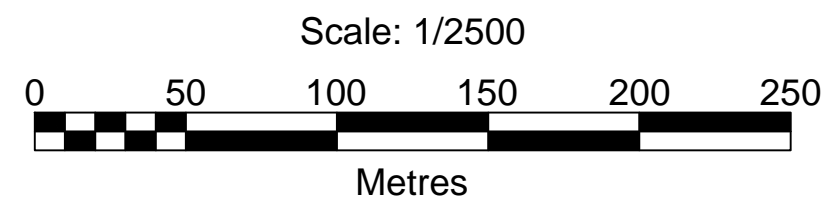

plan
SR11



Reproduced by permission of Ordnance Survey on behalf of HMSO. © Crown copyright and database right 2018. All rights reserved. Ordnance Survey Licence number 100046668

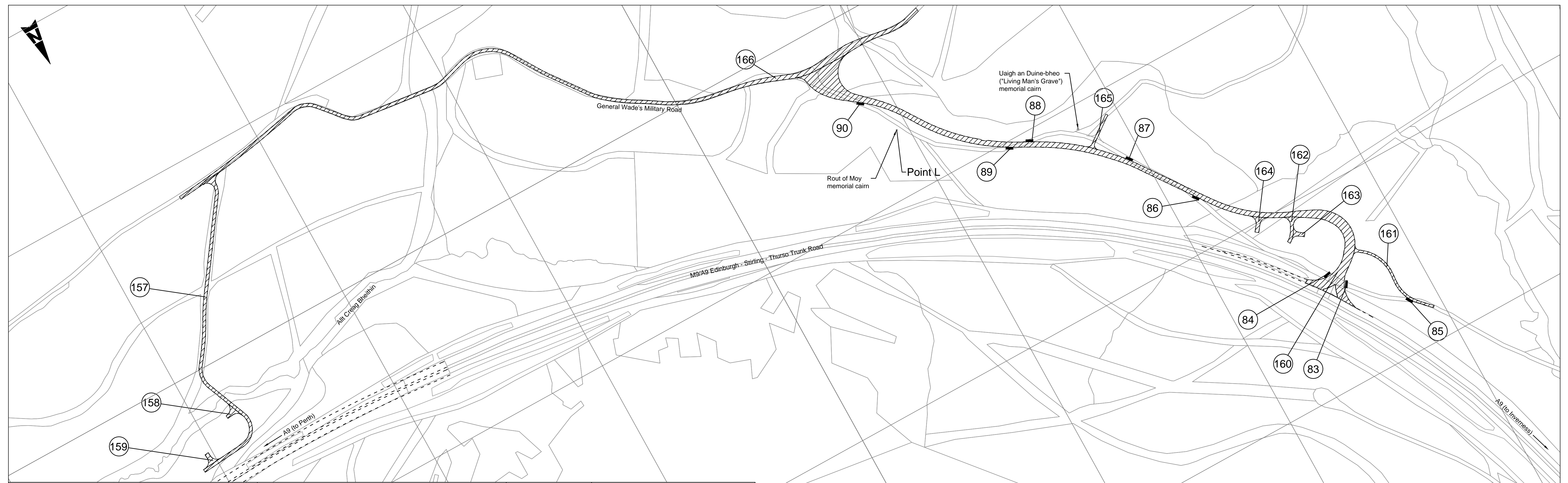

The A9 Trunk Road (Tomatin to Moy)
(Side Roads) Order 201[]

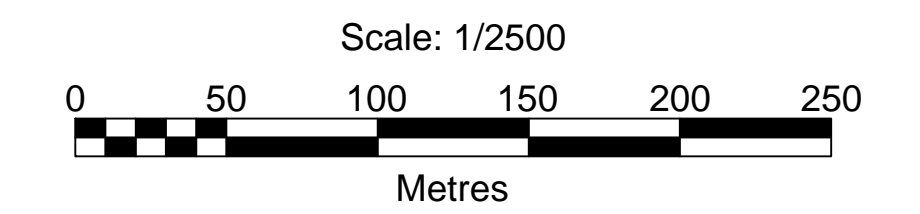

plan
SR12



Reproduced by permission of Ordnance Survey on behalf of HMSO. © Crown copyright and database right 2018. All rights reserved. Ordnance Survey Licence number 100046668