

Reproduced by permission of Ordnance Survey on behalf of HMSO.  
 © Crown copyright and database right 2014. All rights reserved.  
 Ordnance Survey Licence number 100046668.

**NOTES:**  
 1. All dimensions are in metres unless stated otherwise.

This OS Mastermap was obtained in March 2014 and is for illustration purposes only.

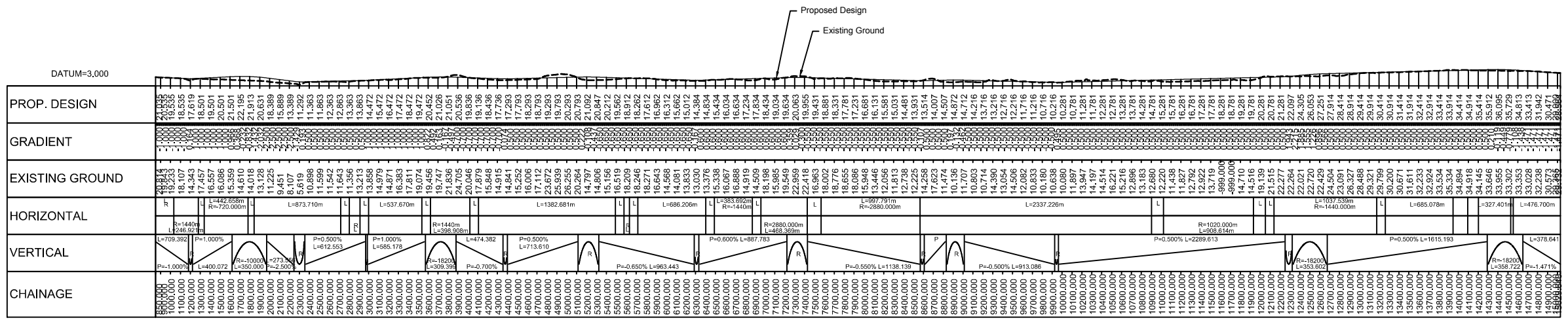

**LONGITUDINAL SECTION (CHAINAGE 850m TO 15029.64m)**



A	08/09/14	DMRB Stage 2 Report	DAD	CMM	GAH	EBH
Rev	Rev. Date	Purpose of revision	Drawn	Checked	Rev'd	Aspn'd



Drawing title  
**DMRB STAGE 2  
 INVERNESS TO GOLLANFIELD  
 OPTION 1A PLAN & PROFILE  
 CH 850 TO CH 15029.64**

Drawing status  
**PRELIMINARY**

Scale  
**AS SHOWN @ A1 DO NOT SCALE**

Jacobs No. B1557601  
 Client no.

Drawing number  
**B1557601/MLA/1100** Rev  
**A**

This drawing is not to be used in whole or part other than for the intended purpose and project as defined on this drawing. Refer to the contract for full terms and conditions.

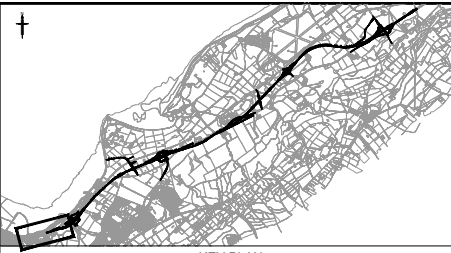
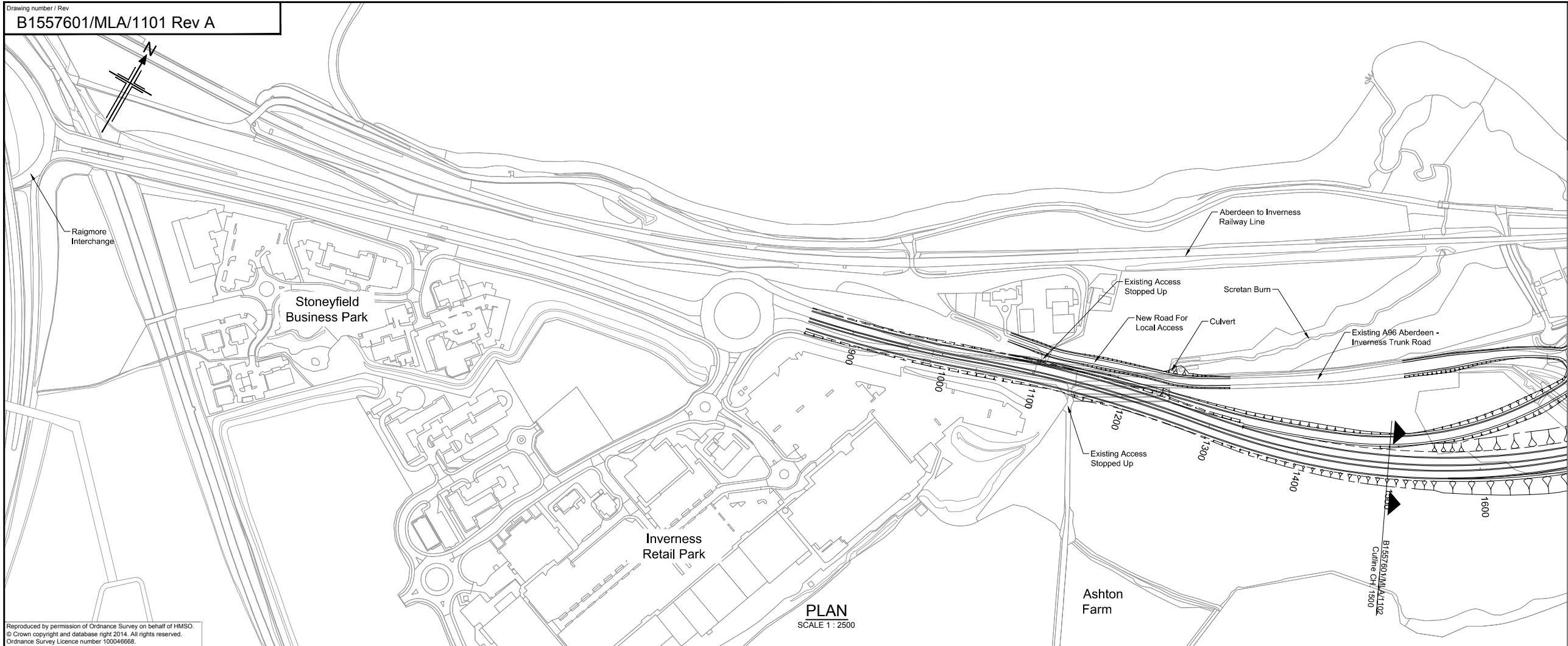

NOTES:  
 1. All dimensions are in metres unless stated otherwise.

Reproduced by permission of Ordnance Survey on behalf of HMSO.  
 © Crown copyright and database right 2014. All rights reserved.  
 Ordnance Survey Licence number 100046668.

This OS Mastermap was obtained in March 2014 and is for illustration purposes only.

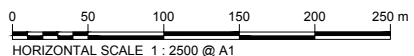
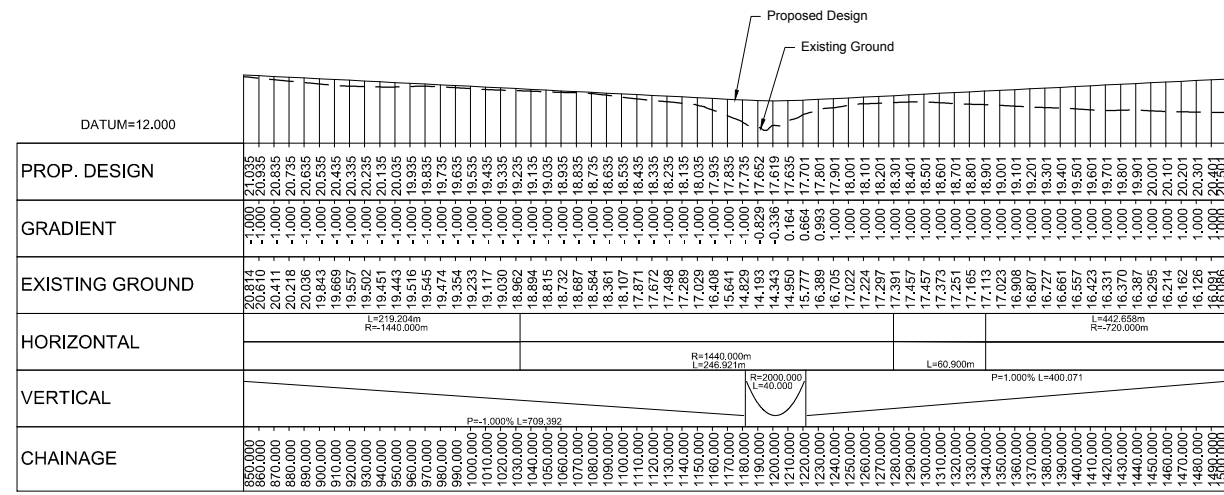

LONGITUDINAL SECTION (CHAINAGE 850m TO 1500m)

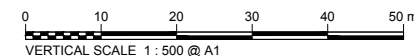

A	08/09/14	DMRB Stage 2 Report	DAD	CMM	GAH	EHB
Rev	Rev. Date	Purpose of revision	Drawn	Checked	Rev'd	Appr'd

**JACOBS**  
 85 Bothwell St, Glasgow, G2 7HX  
 Tel: +44(0)141 243 8000 Fax: +44(0)141 226 3109  
 www.jacobs.com

Client  
  
 TRANSPORT SCOTLAND  
 COMH-DHAL ALBA

Project  
  
 A96 DUALLING  
 INVERNESS TO NAIRN  
 (incl. Malm. bypass)

Drawing title  
**DMRB STAGE 2  
 INVERNESS TO GOLLANFIELD  
 OPTION 1A PLAN & PROFILE  
 CH 850 TO CH 1500**

Drawing status  
**PRELIMINARY**

Scale  
 1:2,500 @ A1 | DO NOT SCALE

Jacobs No. B1557601

Drawing number  
**B1557601/MLA/1101** | Rev **A**

This drawing is not to be used in whole or part other than for the intended purpose and project as defined on this drawing. Refer to the contract for full terms and conditions.

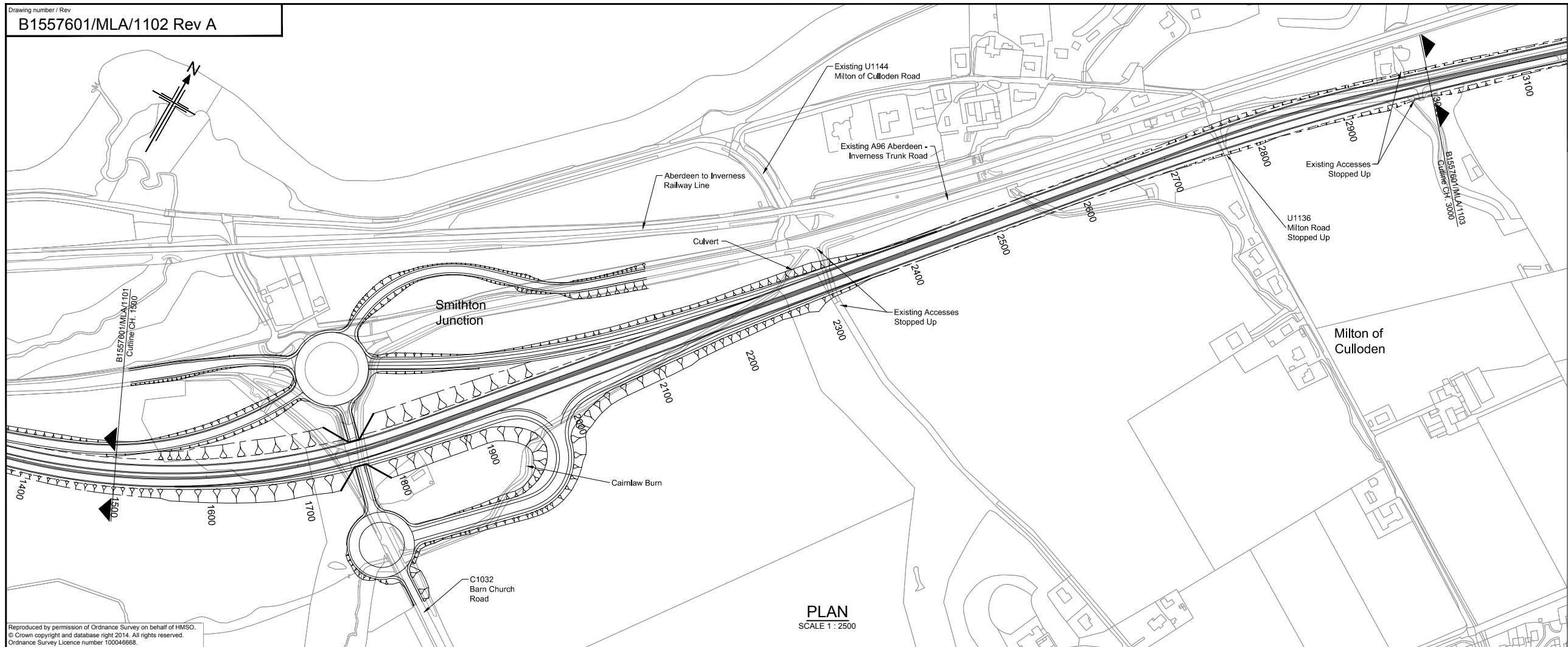

PLAN  
 SCALE 1 : 2500

Reproduced by permission of Ordnance Survey on behalf of HMSO.  
 © Crown copyright and database right 2014. All rights reserved.  
 Ordnance Survey Licence number 100046668.



- NOTES:
- All dimensions are in metres unless stated otherwise.
  - For Smithton Junction refer to Drawing No. B1557601/MLA/1111

This OS Mastermap was obtained in March 2014 and is for illustration purposes only.

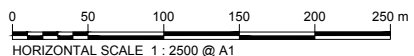
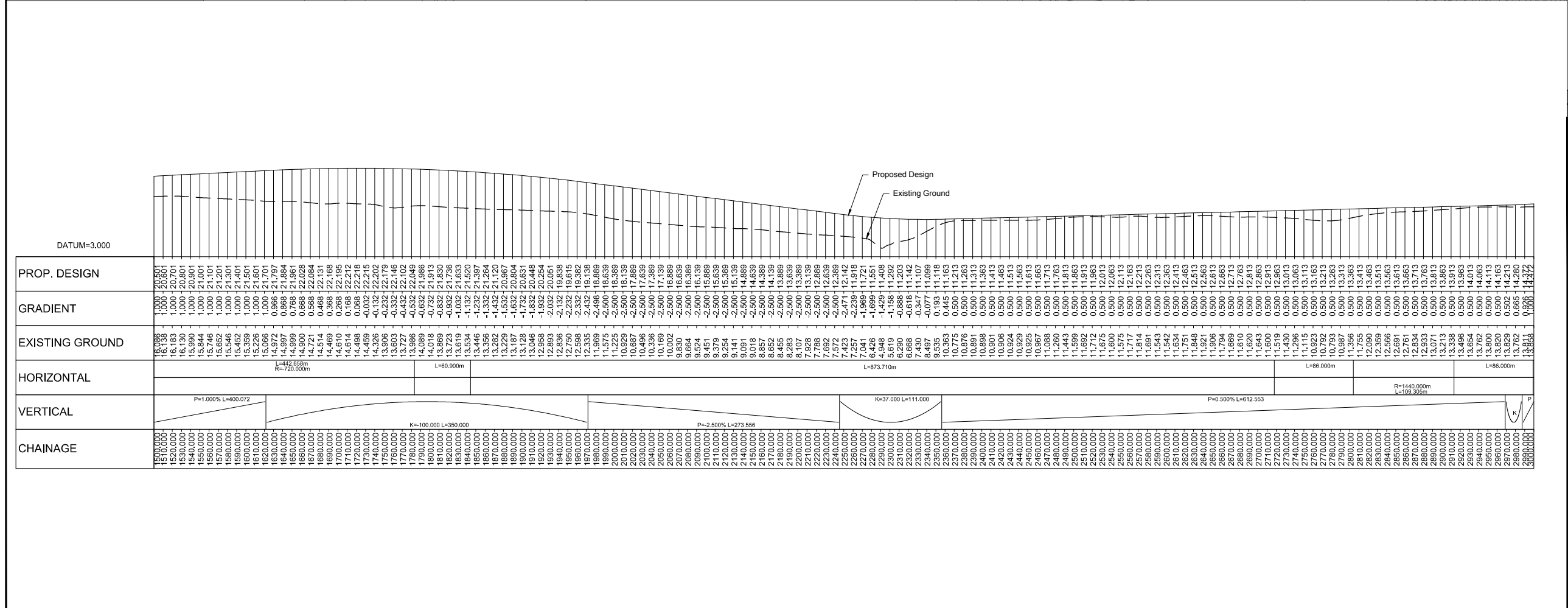

LONGITUDINAL SECTION (CHAINAGE 1500m TO 3000m)



A	08/09/14	DMRB Stage 2 Report	DAD	CMM	GAH	EHB
Rev	Rev. Date	Purpose of revision	Drawn	Checked	Rev'd	Apprv'd

**JACOBS**  
 85 Bothwell St, Glasgow, G2 7HX  
 Tel: +44(0)141 243 8000 Fax: +44(0)141 226 3109  
 www.jacobs.com

Client  
  
 TRANSPORT SCOTLAND  
 CÒR-THAL ALBA

Project  
  
**A96 DUALLING**  
 INVERNESS TO NAIRN  
 (incl. Main Bypass)

Drawing title  
**DMRB STAGE 2  
 INVERNESS TO GOLLANFIELD  
 OPTION 1A PLAN & PROFILE  
 CH 1500 TO CH 3000**

Drawing status  
**PRELIMINARY**

Scale  
 1:2,500 @ A1 DO NOT SCALE

Jacobs No. B1557601

Client no.

Drawing number  
**B1557601/MLA/1102**

Rev  
**A**

This drawing is not to be used in whole or part other than for the intended purpose and project as defined on this drawing. Refer to the contract for full terms and conditions.

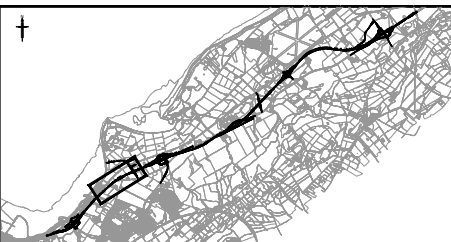
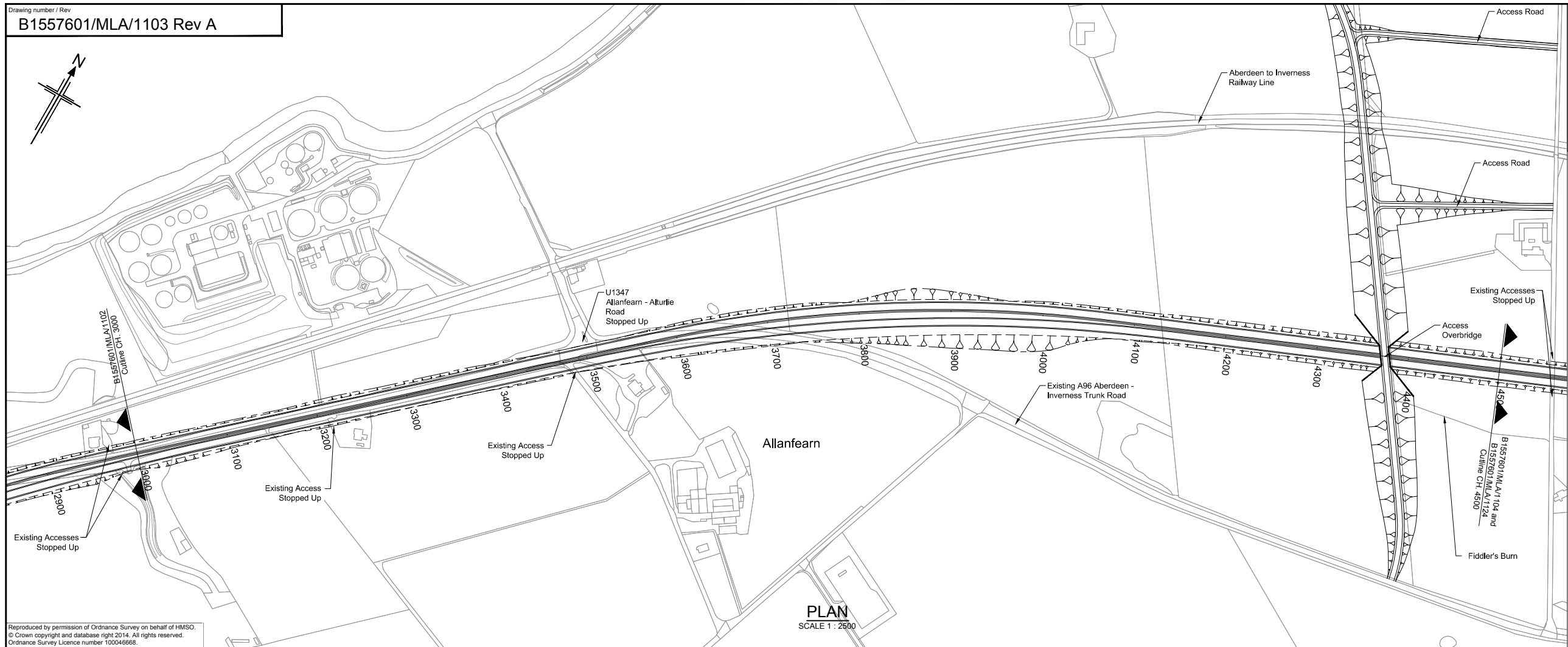
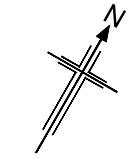

NOTES: 1. All dimensions are in metres unless stated otherwise.

Reproduced by permission of Ordnance Survey on behalf of HMSO. © Crown copyright and database right 2014. All rights reserved. Ordnance Survey Licence number 100046668.

This OS Mastermap was obtained in March 2014 and is for illustration purposes only.

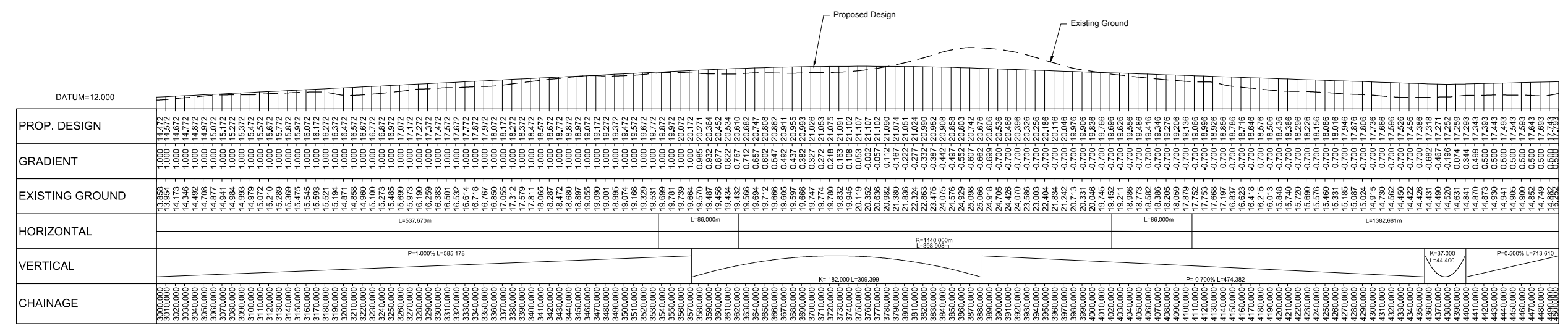

Revision table with columns: Rev, Rev. Date, Purpose of revision, Drawn, Checkd, Rev'd, Apprv'd

JACOBS logo and contact information: 85 Bothwell St, Glasgow, G2 7HX. Tel: +44(0)141 243 8000 Fax: +44(0)141 226 3109 www.jacobs.com

Client logo: TRANSPORT SCOTLAND CONHADAL ALBA

Project logo: A95 DUALLING INVERNESS TO NAIRN (incl. Nairn Bypass)

Drawing title: DMRB STAGE 2 INVERNESS TO GOLLANFIELD OPTION 1A PLAN & PROFILE CH 3000 TO CH 4500. Drawing status: PRELIMINARY. Scale: 1:2,500 @ A1. DO NOT SCALE. Jacobs No. B1557601. Client no. Drawing number B1557601/MLA/1103. Rev A.

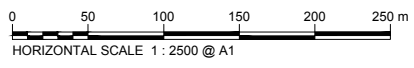

LONGITUDINAL SECTION (CHAINAGE 3000m TO 4500m)

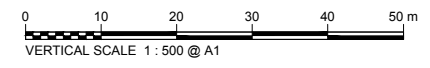

This drawing is not to be used in whole or part other than for the intended purpose and project as defined on this drawing. Refer to the contract for full terms and conditions.

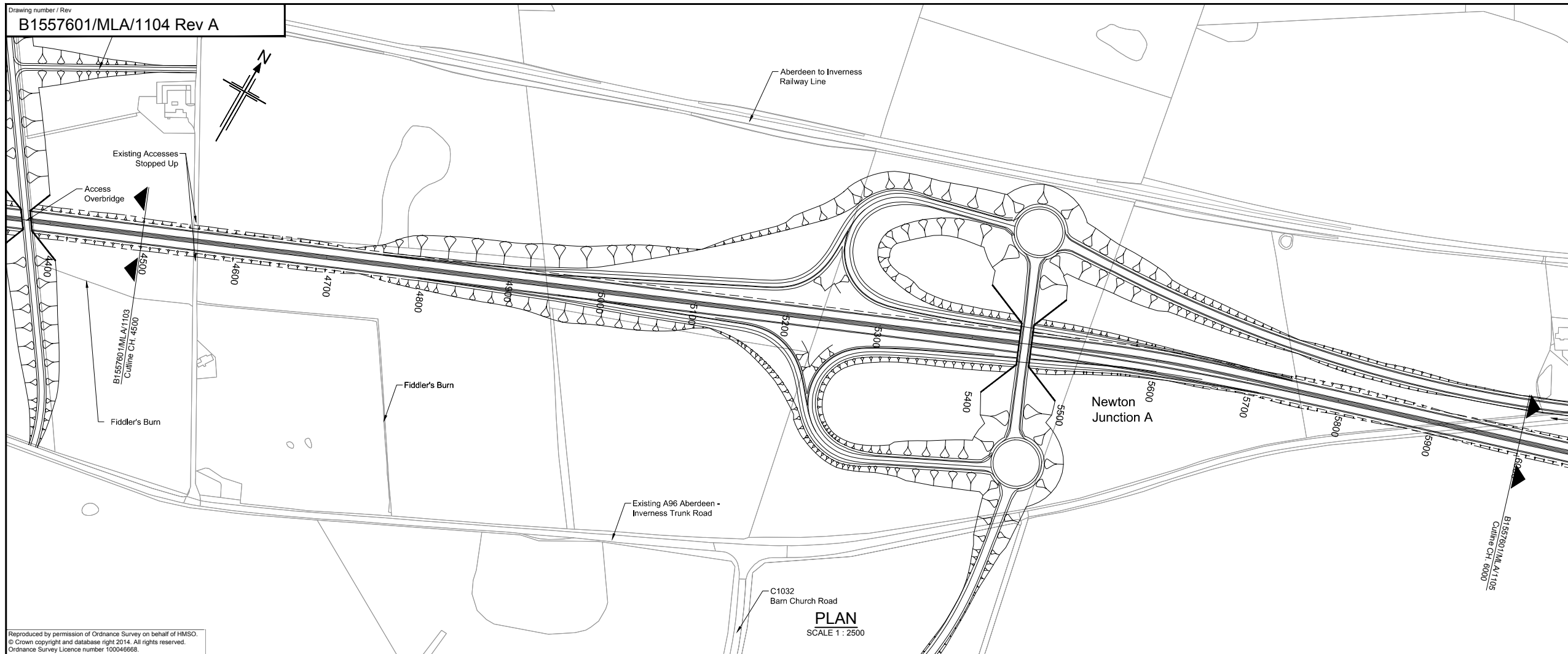

Reproduced by permission of Ordnance Survey on behalf of HMSO.  
 © Crown copyright and database right 2014. All rights reserved.  
 Ordnance Survey Licence number 100046668.

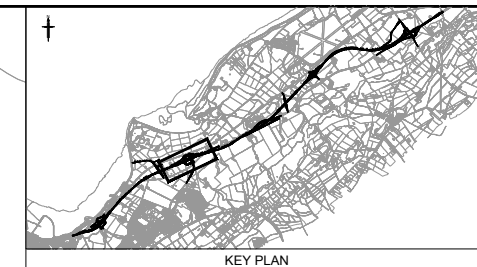

- NOTES**
- All dimensions are in metres unless stated otherwise.
  - Fot Option 1A (Morayston Variant) refer to drawings B1557601/MLA/1124 to 1126.
  - For Newton Junction A refer to drawing no. B155760/MLA/1112

This OS Mastermap was obtained in March 2014 and is for illustration purposes only.

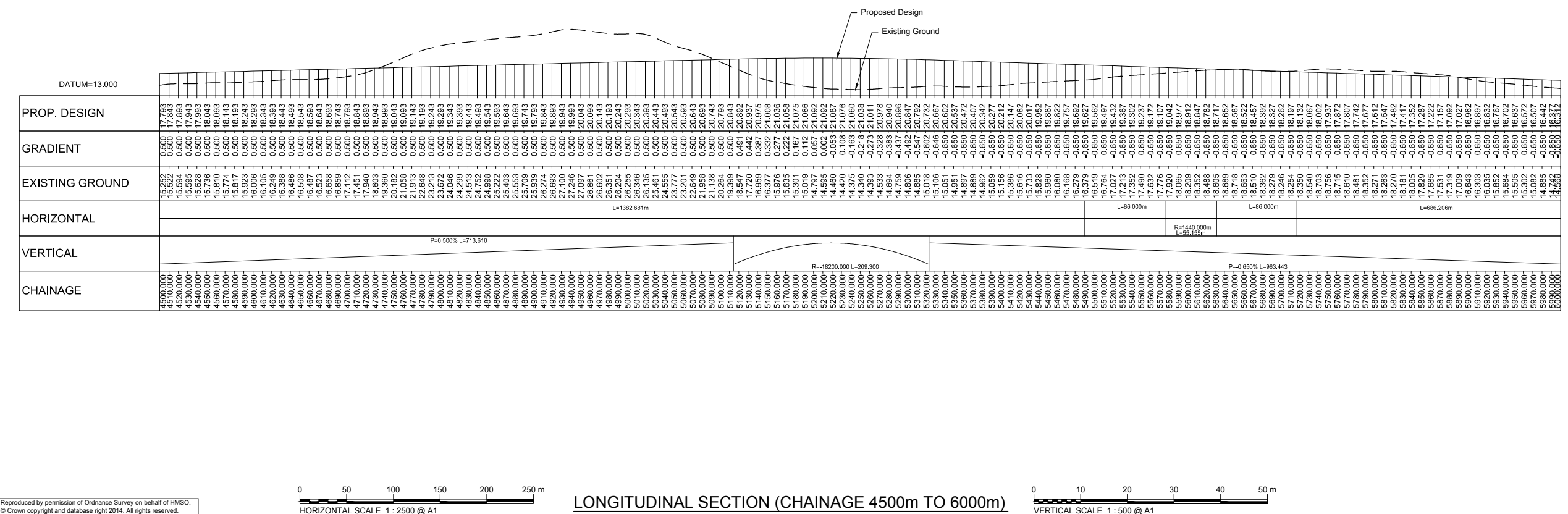

Reproduced by permission of Ordnance Survey on behalf of HMSO.  
 © Crown copyright and database right 2014. All rights reserved.  
 Ordnance Survey Licence number 100046668.

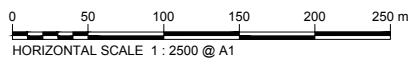

LONGITUDINAL SECTION (CHAINAGE 4500m TO 6000m)

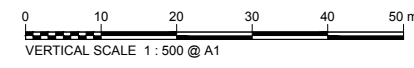

A	08/09/14	DMRB Stage 2 Report	DAD	CMM	GAH	EHB
Rev	Rev. Date	Purpose of revision	Drawn	Checked	Rev'd	Appr'd

**JACOBS**  
 85 Bothwell St, Glasgow, G2 7HX  
 Tel: +44(0)141 243 8000 Fax: +44(0)141 226 3109  
 www.jacobs.com

Client

TRANSPORT SCOTLAND  
 COMHAIL ALBA

Project

A96  
 DUALLING  
 INVERNESS TO NAIRN  
 (incl. Nairn Bypass)

Drawing title  
**DMRB STAGE 2  
 INVERNESS TO GOLLANFIELD  
 OPTION 1A PLAN & PROFILE  
 CH 4500 TO CH 6000**

Drawing status  
**PRELIMINARY**

Scale  
 1:2,500 @ A1 DO NOT SCALE

Jacobs No. B1557601

Client no.

Drawing number  
**B1557601/MLA/1104**

Rev  
**A**

This drawing is not to be used in whole or part other than for the intended purpose and project as defined on this drawing. Refer to the contract for full terms and conditions.

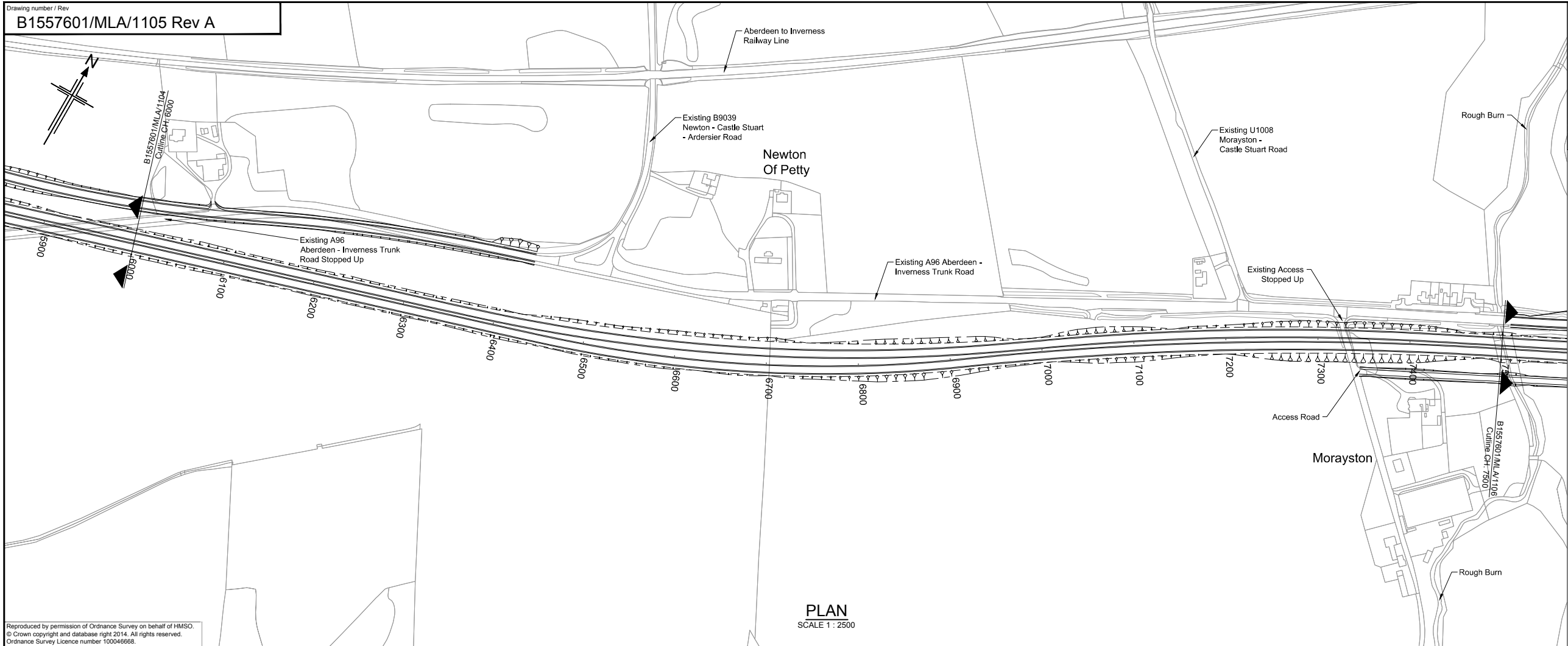

PLAN  
 SCALE 1 : 2500

Reproduced by permission of Ordnance Survey on behalf of HMSO.  
 © Crown copyright and database right 2014. All rights reserved.  
 Ordnance Survey Licence number 100046668.

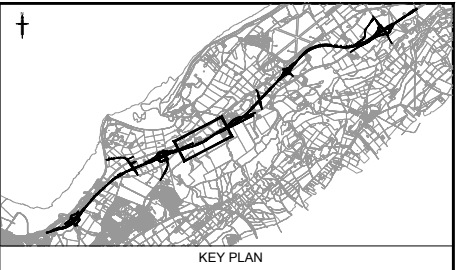

- NOTES
- All dimensions are in metres unless stated otherwise.
  - For Option 1A (Morayston Variant) refer to drawings B1557601/MLA/1124 to 1126.

This OS Mastermap was obtained in March 2014 and is for illustration purposes only.

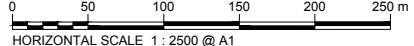
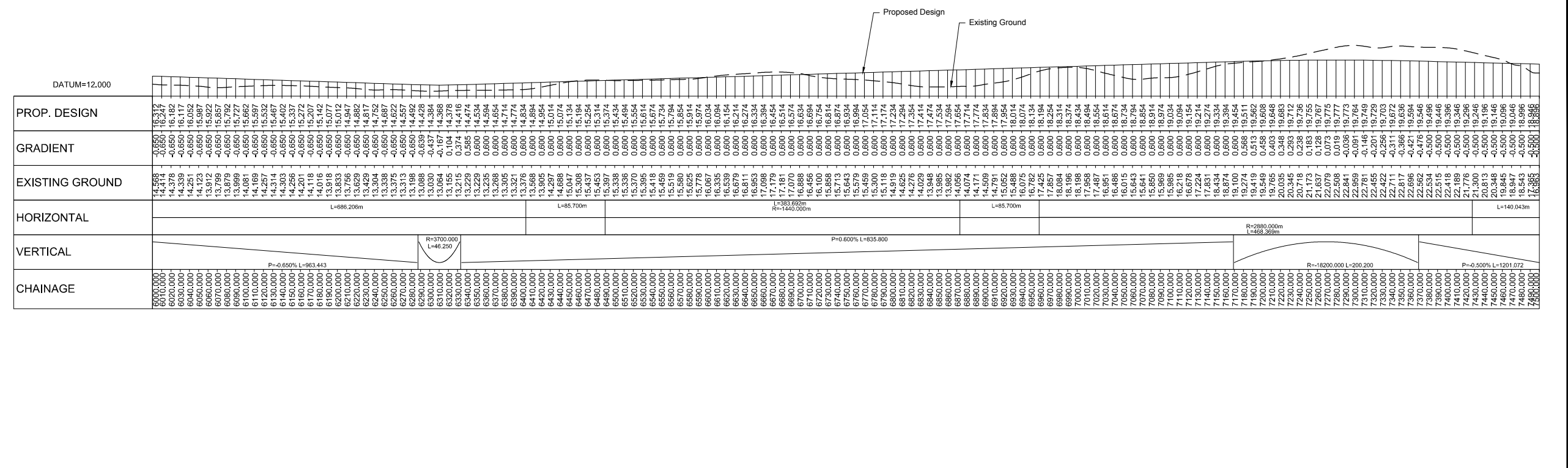

LONGITUDINAL SECTION (CHAINAGE 6000m TO 7500m)

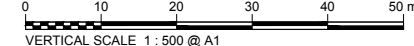

A	08/09/14	DMRB Stage 2 Report	DAD	CMM	GAH	EHB
Rev	Rev. Date	Purpose of revision	Drawn	Checked	Rev'd	Apprv'd

**JACOBS**  
 85 Bothwell St, Glasgow, G2 7HX  
 Tel: +44(0)141 243 8000 Fax: +44(0)141 226 3109  
 www.jacobs.com

Client

CONHADAL ALBA

Project

(incl. Main Bypass)

Drawing title  
**DMRB STAGE 2  
 INVERNESS TO GOLLANFIELD  
 OPTION 1A PLAN & PROFILE  
 CH 6000 TO CH 7500**

Drawing status  
**PRELIMINARY**

Scale  
 AS SHOWN @ A1      DO NOT SCALE

Jacobs No. B1557601  
 Client no.  
 Drawing number  
**B1557601/MLA/1105**

Rev  
**A**  
 This drawing is not to be used in whole or part other than for the intended purpose and project as defined on this drawing. Refer to the contract for full terms and conditions.

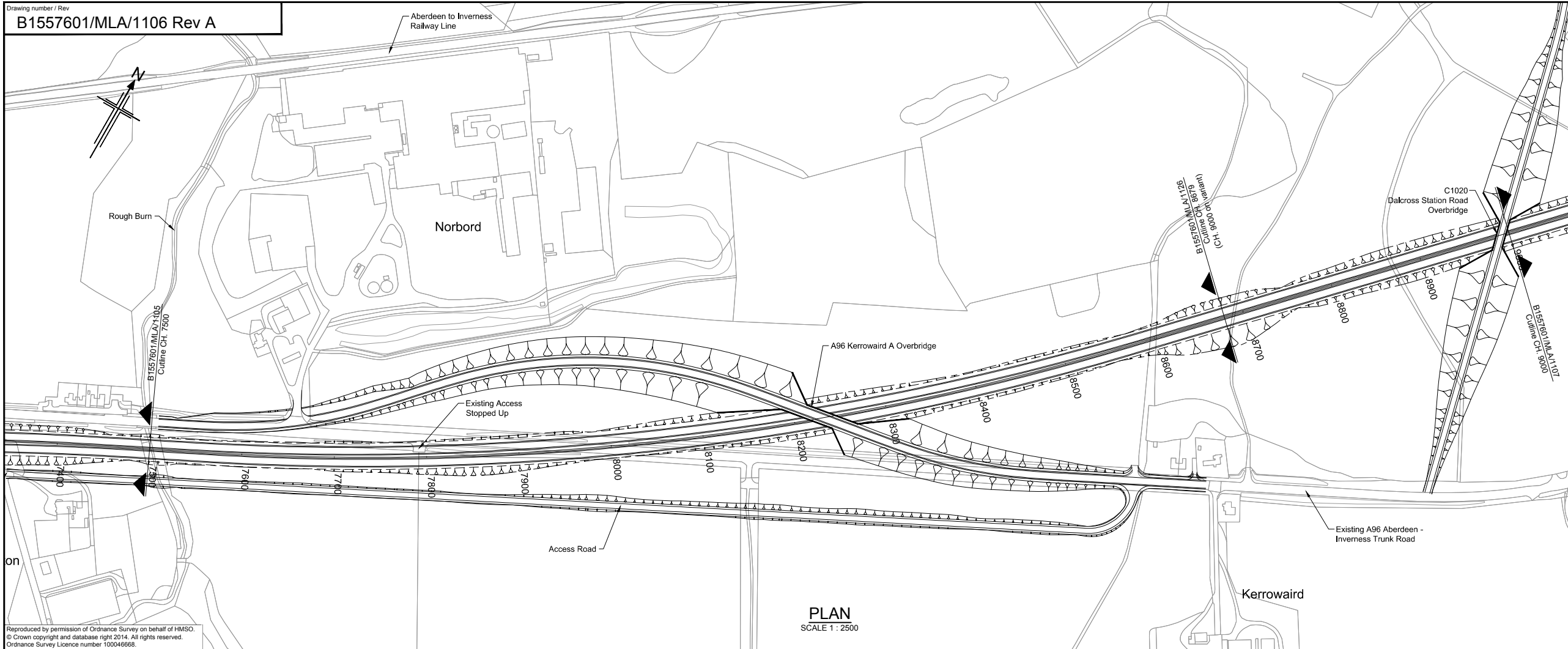

Reproduced by permission of Ordnance Survey on behalf of HMSO.  
 © Crown copyright and database right 2014. All rights reserved.  
 Ordnance Survey Licence number 100046668.

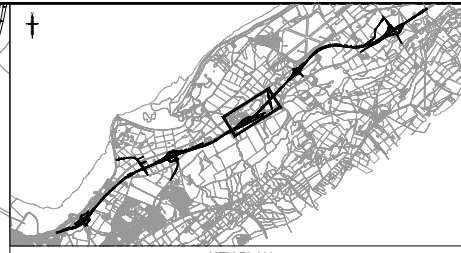

- NOTES**
- All dimensions are in metres unless stated otherwise.
  - Fot Option 1A (Morayston Variant) refer to drawings B1557601/MLA/1124 to 1126.

This OS Mastermap was obtained in March 2014 and is for illustration purposes only.

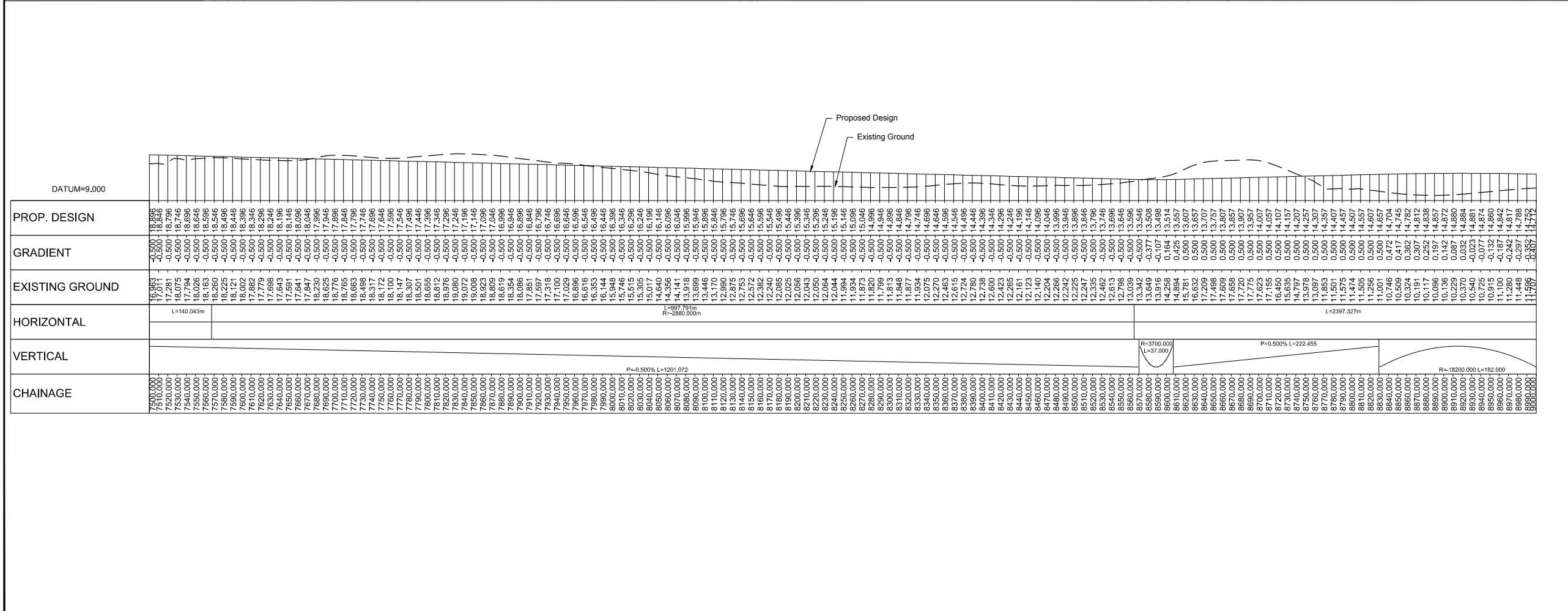

**LONGITUDINAL SECTION (CHAINAGE 7500m TO 9000m)**

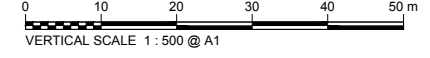

A	08/09/14	DMRB Stage 2 Report	DAD	CMM	GAH	EHB
Rev	Rev. Date	Purpose of revision	Drawn	Checked	Rev'd	Apprv'd

**JACOBS**  
 85 Bothwell St, Glasgow, G2 7HX  
 Tel: +44(0)141 243 8000 Fax: +44(0)141 226 3109  
 www.jacobs.com

Client

Project

Drawing title  
**DMRB STAGE 2  
 INVERNESS TO GOLLANFIELD  
 OPTION 1A PLAN & PROFILE  
 CH 7500 TO CH 9000**

Drawing status  
**PRELIMINARY**

Scale  
 1:2,500 @ A1      **DO NOT SCALE**

Jacobs No.  
 B1557601

Client no.

Drawing number  
**B1557601/MLA/1106**

Rev  
**A**

This drawing is not to be used in whole or part other than for the intended purpose and project as defined on this drawing. Refer to the contract for full terms and conditions.

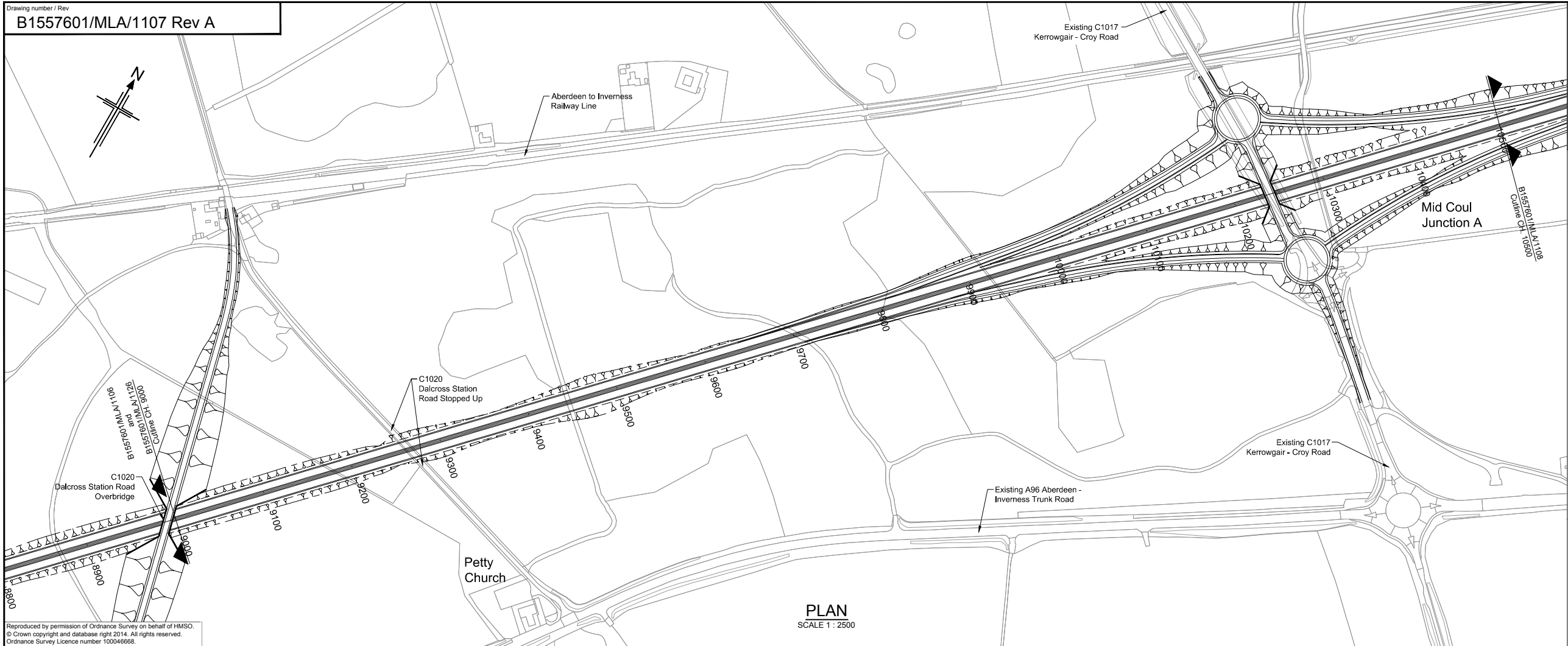

Reproduced by permission of Ordnance Survey on behalf of HMSO.  
 © Crown copyright and database right 2014. All rights reserved.  
 Ordnance Survey Licence number 100046668.

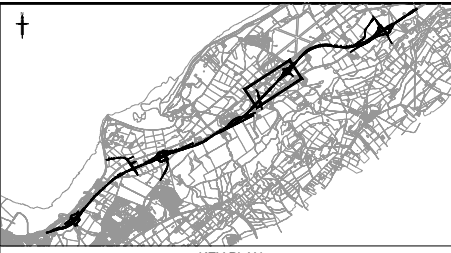

- NOTES**
- All dimensions are in metres unless stated otherwise.
  - For Mid Coul Junction A refer to drawing no. B1557601/MLA/1113.

This OS Mastermap was obtained in March 2014 and is for illustration purposes only.

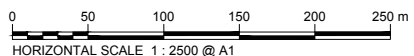
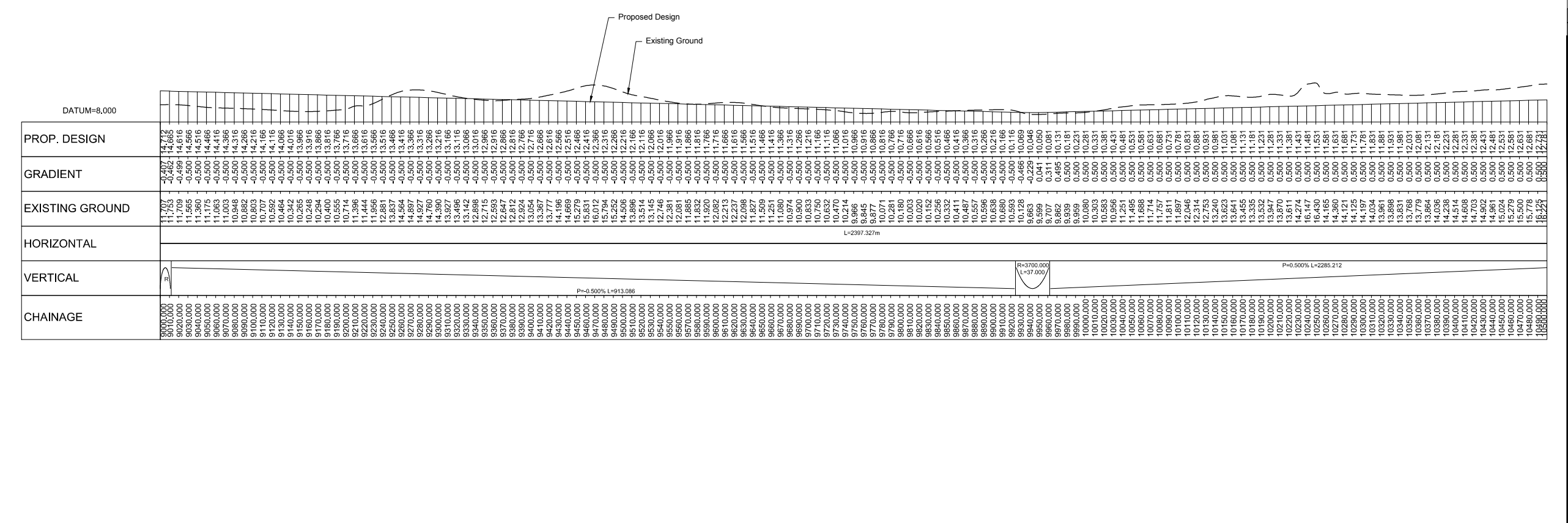

**LONGITUDINAL SECTION (CHAINAGE 9000m TO 10500m)**

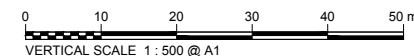

Rev	Rev. Date	Purpose of revision	Drawn	Checked	Rev'd	Appr'd
A	08/09/14	DMRB Stage 2 Report	DAD	CMM	GAH	EHB

**JACOBS**  
 85 Bothwell St, Glasgow, G2 7HX  
 Tel: +44(0)141 243 8000 Fax: +44(0)141 226 3109  
 www.jacobs.com

Client

**TRANSPORT SCOTLAND**  
 COMHAIL ALBA

Project

**A96 DUALLING**  
 INVERNESS TO NAIRN  
 (incl. Nairn Bypass)

Drawing title  
**DMRB STAGE 2  
 INVERNESS TO GOLLANFIELD  
 OPTION 1A PLAN & PROFILE  
 CH 9000 TO CH 10500**

Drawing status  
**PRELIMINARY**

Scale  
 1:2,500 @ A1      DO NOT SCALE

Jacobs No. B1557601  
 Client no.

Drawing number  
**B1557601/MLA/1107**      Rev **A**

This drawing is not to be used in whole or part other than for the intended purpose and project as defined on this drawing. Refer to the contract for full terms and conditions.



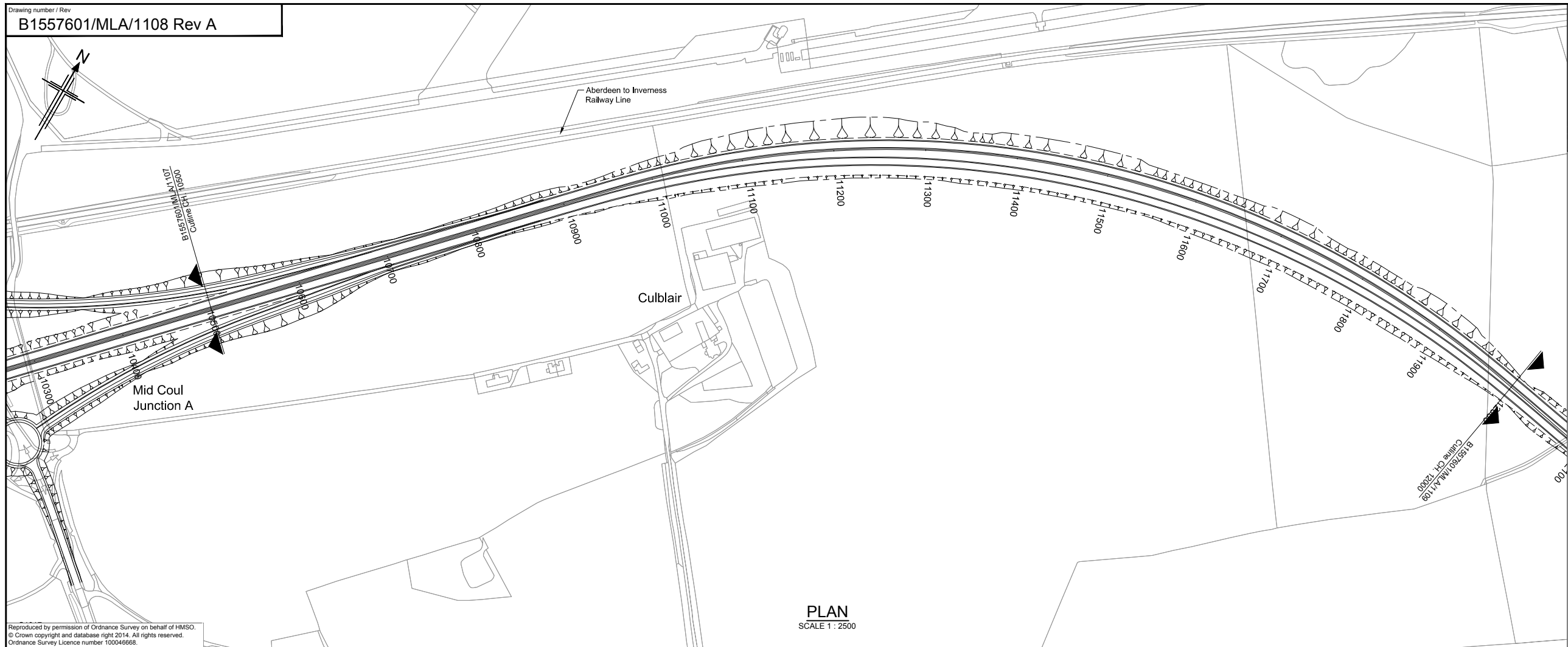

**NOTES**  
 1. All dimensions are in metres unless stated otherwise.

**PLAN**  
 SCALE 1 : 2500

Reproduced by permission of Ordnance Survey on behalf of HMSO.  
 © Crown copyright and database right 2014. All rights reserved.  
 Ordnance Survey Licence number 100046668.

This OS Mastermap was obtained in March 2014 and is for illustration purposes only.

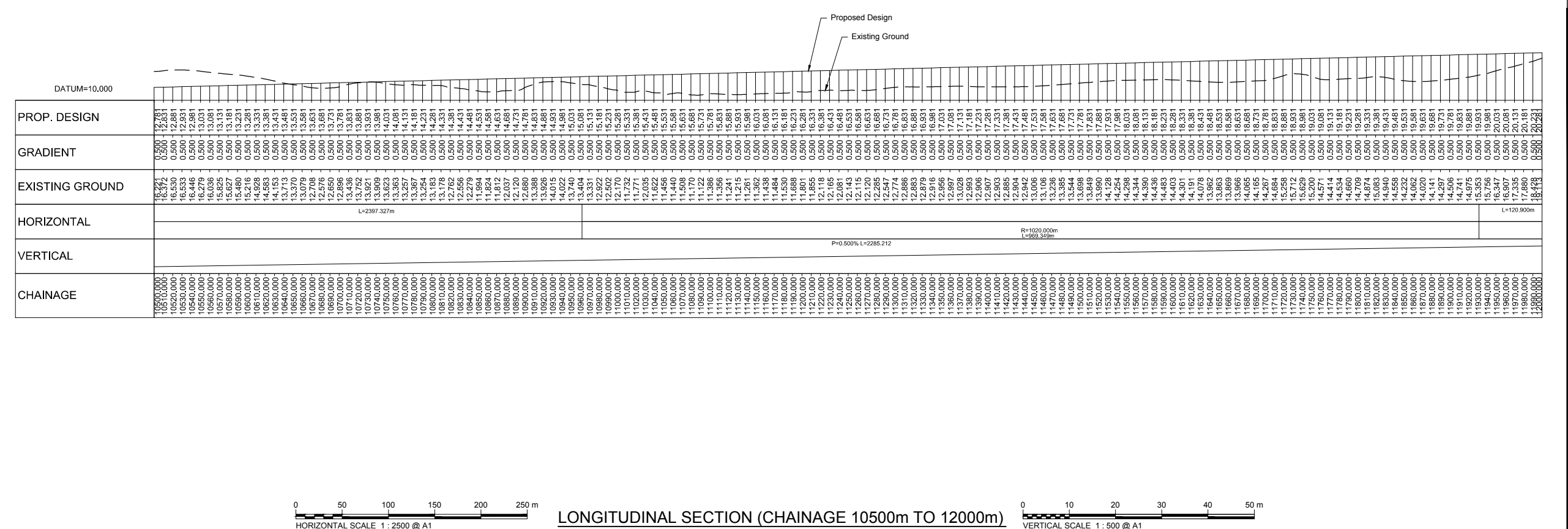

A	08/09/14	DMRB Stage 2 Report	DAD	CMM	GAH	EHB
Rev	Rev. Date	Purpose of revision	Drawn	Checked	Rev'd	Apprv'd

**JACOBS**  
 85 Bothwell St, Glasgow, G2 7HX  
 Tel: +44(0)141 243 8000 Fax: +44(0)141 226 3109  
 www.jacobs.com

Client

TRANSPORT SCOTLAND  
 COMHAIL ALBA

Project

A95  
 DUALLING  
 INVERNESS TO NAIRN  
 (incl. Nairn Bypass)

Drawing title  
**DMRB STAGE 2  
 INVERNESS TO GOLLANFIELD  
 OPTION 1A PLAN & PROFILE  
 CH 10500 TO CH 12000**

Drawing status  
**PRELIMINARY**

Scale  
 1:2,500 @ A1 DO NOT SCALE

Jacobs No. B1557601

Client no.

Drawing number  
**B1557601/MLA/1108**

Rev  
**A**

This drawing is not to be used in whole or part other than for the intended purpose and project as defined on this drawing. Refer to the contract for full terms and conditions.

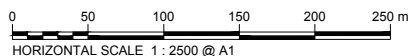

**LONGITUDINAL SECTION (CHAINAGE 10500m TO 12000m)**

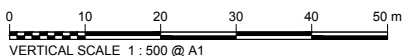

Drawing number / Rev  
**B1557601/MLA/1109 Rev A**

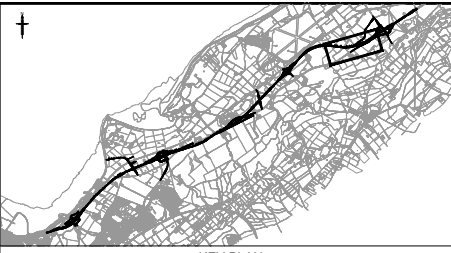
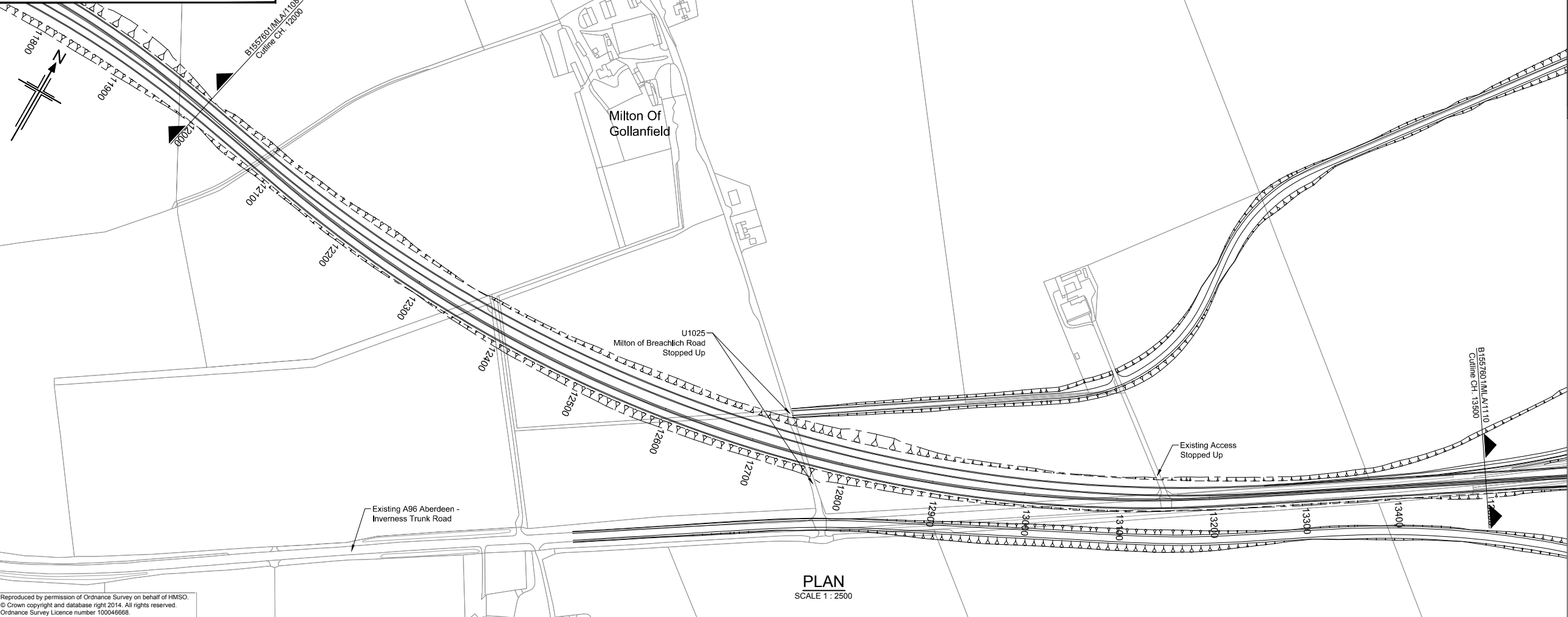

**NOTES**  
 1. All dimensions are in metres unless stated otherwise.

Reproduced by permission of Ordnance Survey on behalf of HMSO.  
 © Crown copyright and database right 2014. All rights reserved.  
 Ordnance Survey Licence number 100046668.

**PLAN**  
 SCALE 1 : 2500

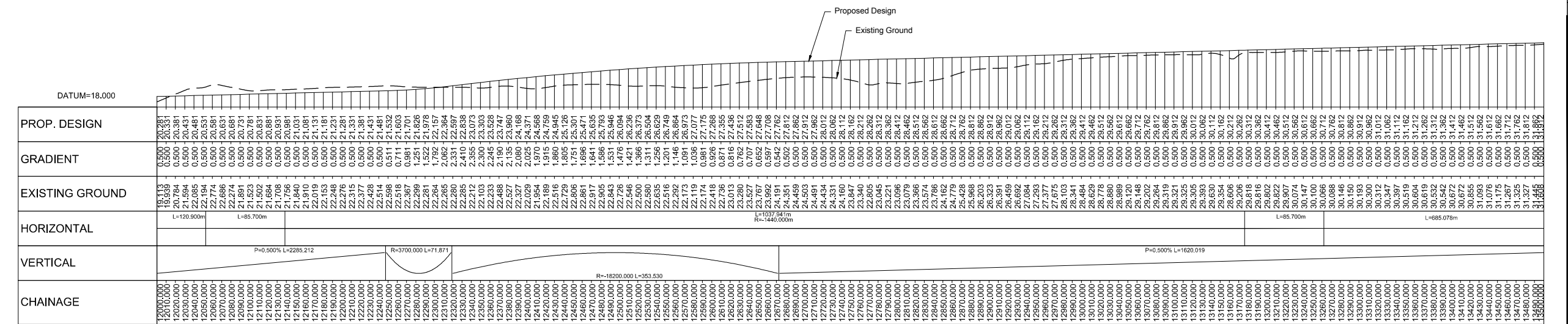

A	08/09/14	DMRB Stage 2 Report	DAD	CMM	GAH	EBH
Rev	Rev. Date	Purpose of revision	Drawn	Checked	Rev'd	Apprv'd

**JACOBS**  
 85 Bothwell St, Glasgow, G2 7HX  
 Tel: +44(0)141 243 8000 Fax: +44(0)141 226 3109  
 www.jacobs.com



Drawing title  
**DMRB STAGE 2  
 INVERNESS TO GOLLANFIELD  
 OPTION 1A PLAN & PROFILE  
 CH 12000 TO CH 13500**

Drawing status  
**PRELIMINARY**

Scale  
 1:2,500 @ A1 | DO NOT SCALE

Jacobs No. B1557601  
 Client no.

Drawing number  
**B1557601/MLA/1109** | Rev A

This drawing is not to be used in whole or part other than for the intended purpose and project as defined on this drawing. Refer to the contract for full terms and conditions.

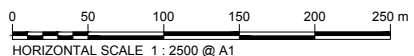

**LONGITUDINAL SECTION (CHAINAGE 12000m TO 13500m)**

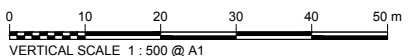

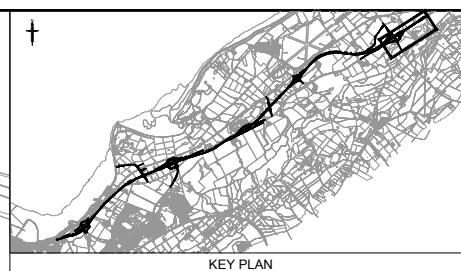
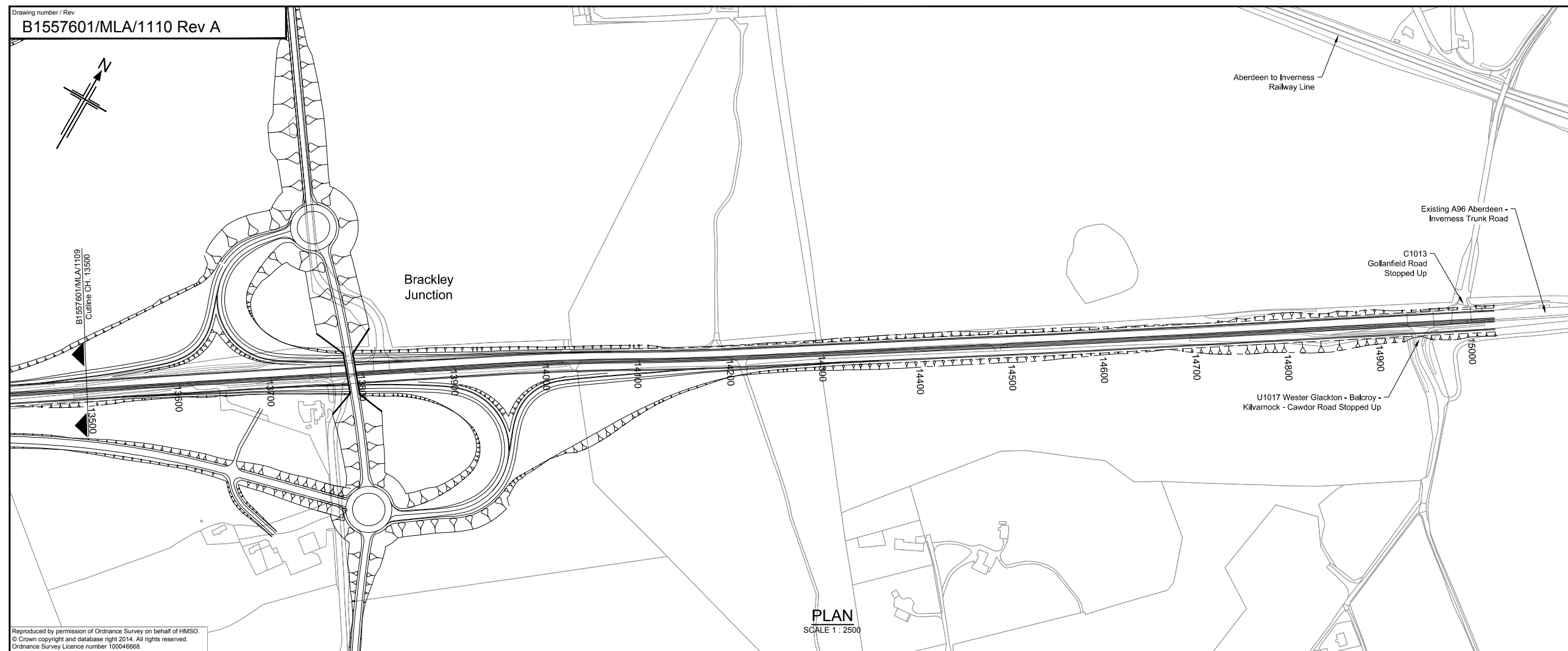
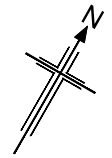

**NOTES**

- All dimensions are in metres unless stated otherwise.
- For Brackley Junction refer to drawing no. B1557601/MLA/1114.

Reproduced by permission of Ordnance Survey on behalf of HMSO.  
 © Crown copyright and database right 2014. All rights reserved.  
 Ordnance Survey Licence number 100046668.

This OS Mastermap was obtained in March 2014 and is for illustration purposes only.

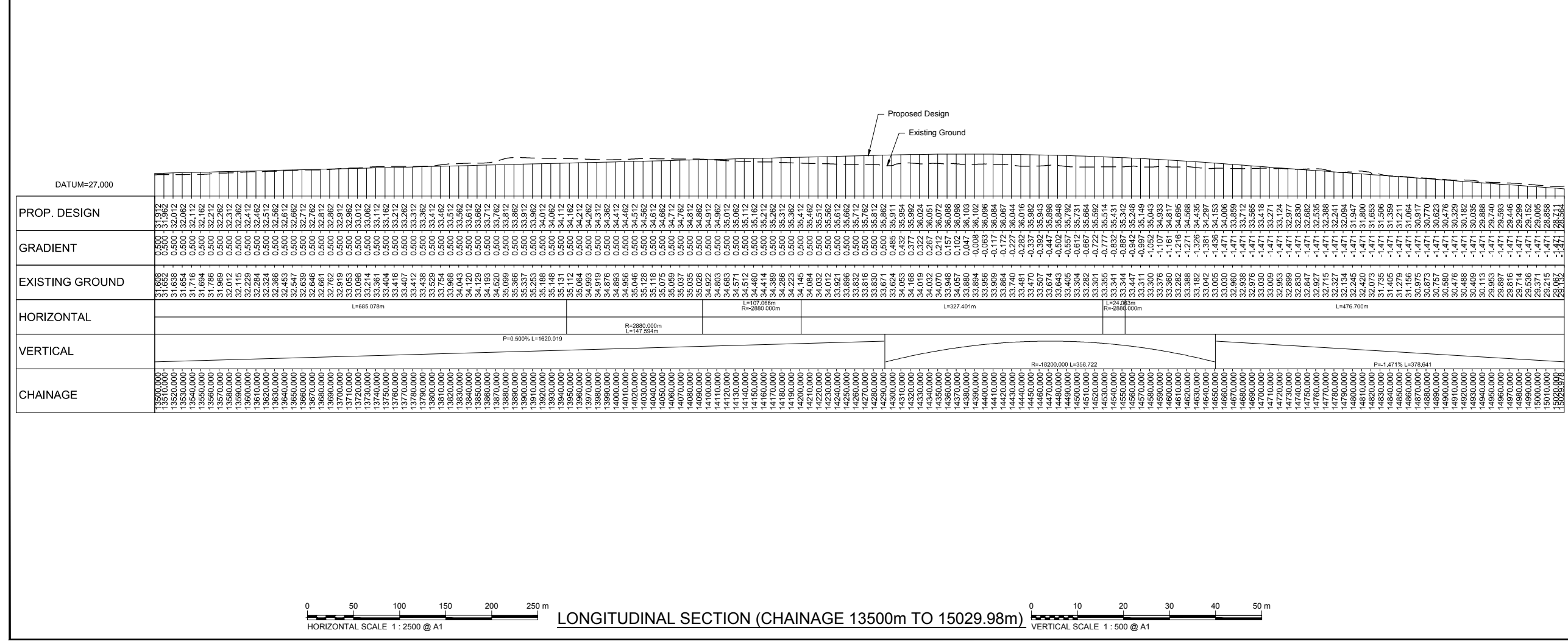

Rev	Rev. Date	Purpose of revision	Drawn	Checkd	Rev'd	Apprv'd
A	08/09/14	DMRB Stage 2 Report	DAD	CMM	GAH	EHB

**JACOBS**  
 85 Bothwell St, Glasgow, G2 7HX  
 Tel: +44(0)141 243 8000 Fax: +44(0)141 226 3109  
 www.jacobs.com

Client

Project

Drawing title  
**DMRB STAGE 2  
 INVERNESS TO GOLLANFIELD  
 OPTION 1A PLAN & PROFILE  
 CH 13500 TO CH 15029.98**

Drawing status  
**PRELIMINARY**

Scale  
 1:2,500 @ A1 | DO NOT SCALE

Jacobs No.  
 B1557601

Client no.

Drawing number  
**B1557601/MLA/1110**

Rev  
**A**

This drawing is not to be used in whole or part other than for the intended purpose and project as defined on this drawing. Refer to the contract for full terms and conditions.

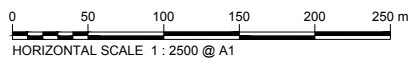

**LONGITUDINAL SECTION (CHAINAGE 13500m TO 15029.98m)**

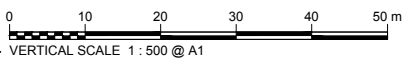

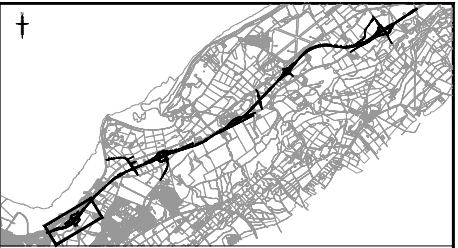
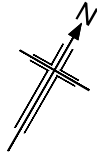

KEY PLAN

**NOTES**

- All dimensions are in metres unless stated otherwise.

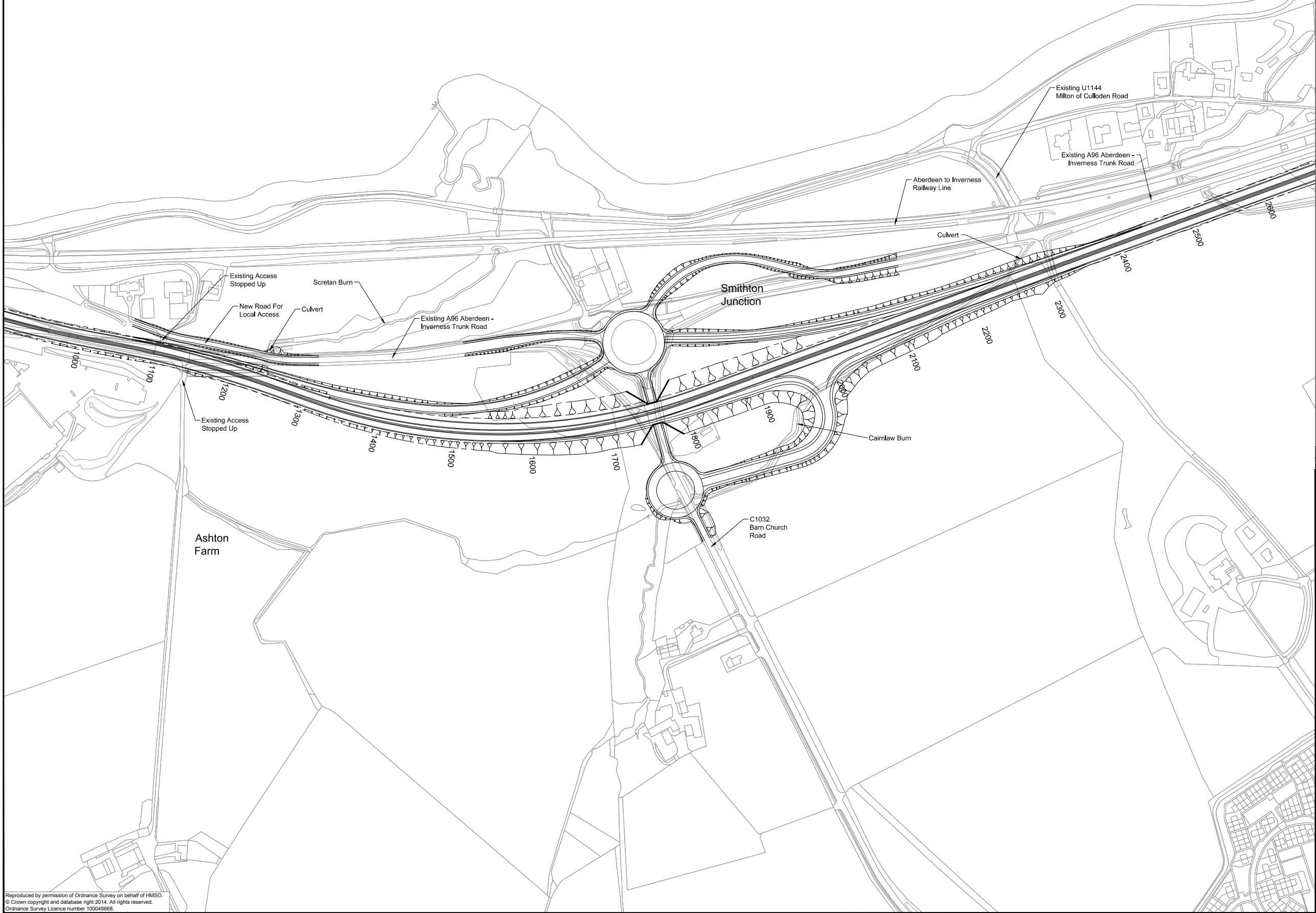

This OS Mastermap was obtained in March 2014 and is for illustration purposes only.

2	01/05/14	DMRB Stage 2 Report	DAD	CMM	GAH	EHB
Rev	Rev. Date	Purpose of revision	Drawn	Checked	Rev'd	Apprv'd



95 Bothwell St, Glasgow, G2 7HX  
 Tel: +44(0)141 243 8000 Fax: +44(0)141 226 3109  
 www.jacobs.com



**DMRB STAGE 2  
 INVERNESS TO GOLLANFIELD  
 SMITHTON JUNCTION  
 OPTION 1A**

Drawing status	PRELIMINARY	
Scale	1:2,500 @ A1	DO NOT SCALE
Jacobs No.	B1557601	
Client no.		
Drawing number	B1557601/MLA/1111	Rev A

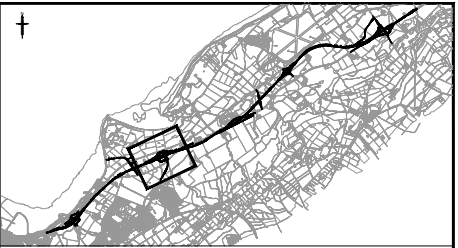
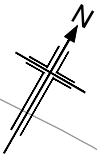

KEY PLAN

**NOTES**

1. All dimensions are in metres unless stated otherwise.
2. For Option 1A (Morayston Variant) refer to drawings B1557601/MLA/1124 to 1126.

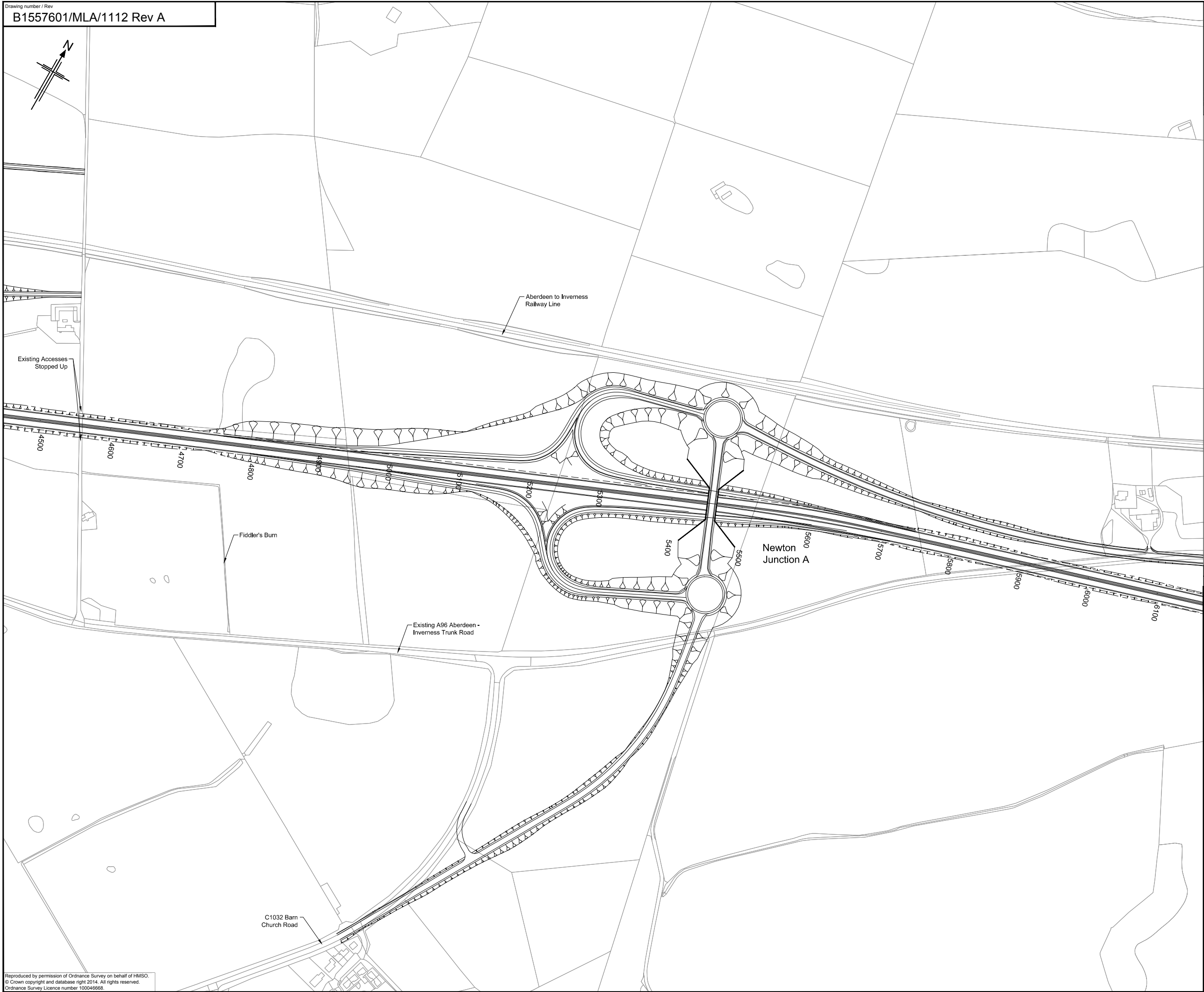

This OS Mastermap was obtained in March 2014 and is for illustration purposes only.

Rev	Rev. Date	Purpose of revision	Drawn	Checked	Rev'd	Apprv'd
A	08/09/14	DMRB Stage 2 Report	DAD	CMM	GAH	EHB



Drawing title  
**DMRB STAGE 2  
 INVERNESS TO GOLLANFIELD  
 NEWTON JUNCTION A  
 OPTION 1A**

Drawing status  
**PRELIMINARY**

Scale  
 1:2,500 @ A1 **DO NOT SCALE**

Jacobs No. B1557601

Drawing number  
**B1557601/MLA/1112**

Rev  
**A**

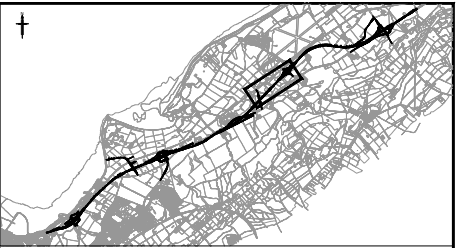
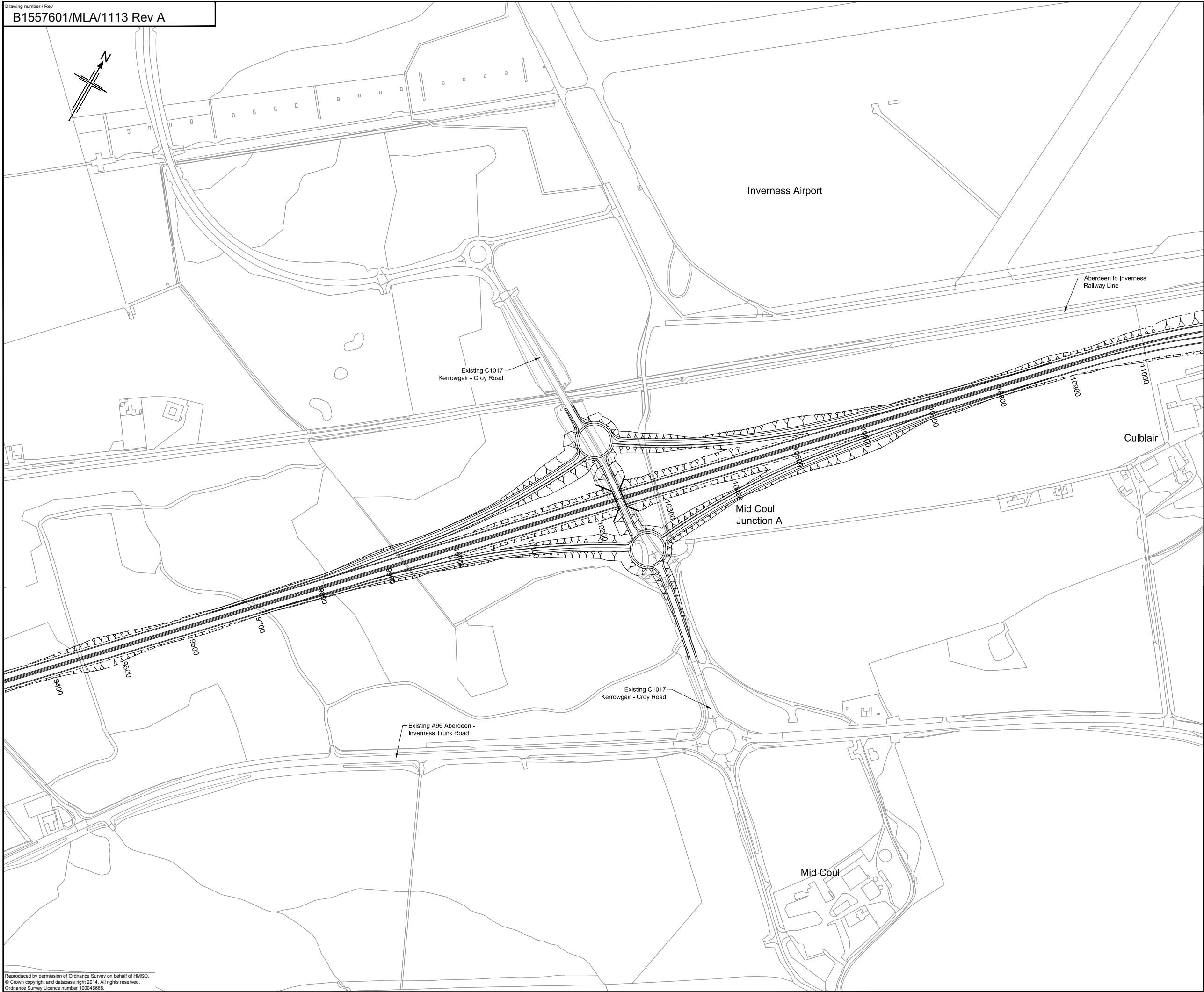

KEY PLAN

**NOTES**

1. All dimensions are in metres unless stated otherwise.

This OS Mastermap was obtained in March 2014 and is for illustration purposes only.

A	08/09/14	DMRB Stage 2 Report	DAD	CMM	GAH	EHB
Rev	Rev. Date	Purpose of revision	Drawn	Checked	Rev'd	Appr'd

**JACOBS**  
 85 Bothwell St, Glasgow, G2 7HX  
 Tel: +44(0)141 243 8000 Fax: +44(0)141 226 3109  
 www.jacobs.com

Client

**TRANSPORT SCOTLAND**  
 COMHAIRLE ALBA

Project

**A96**  
 DUALLING  
 INVERNESS TO NAIRN  
(incl. Mid-Coul Junction)

Drawing title  
**DMRB STAGE 2  
 INVERNESS TO GOLLANFIELD  
 MID COUL JUNCTION A  
 OPTION 1A**

Drawing status  
**PRELIMINARY**

Scale  
 1:2,500 @ A1 **DO NOT SCALE**

Jacobs No. B1557601

Drawing number  
**B1557601/MLA/1113**

Rev  
**A**

Reproduced by permission of Ordnance Survey on behalf of HMSO.  
 © Crown copyright and database right 2014. All rights reserved.  
 Ordnance Survey Licence number 100046668.

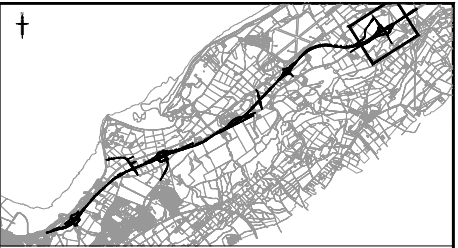
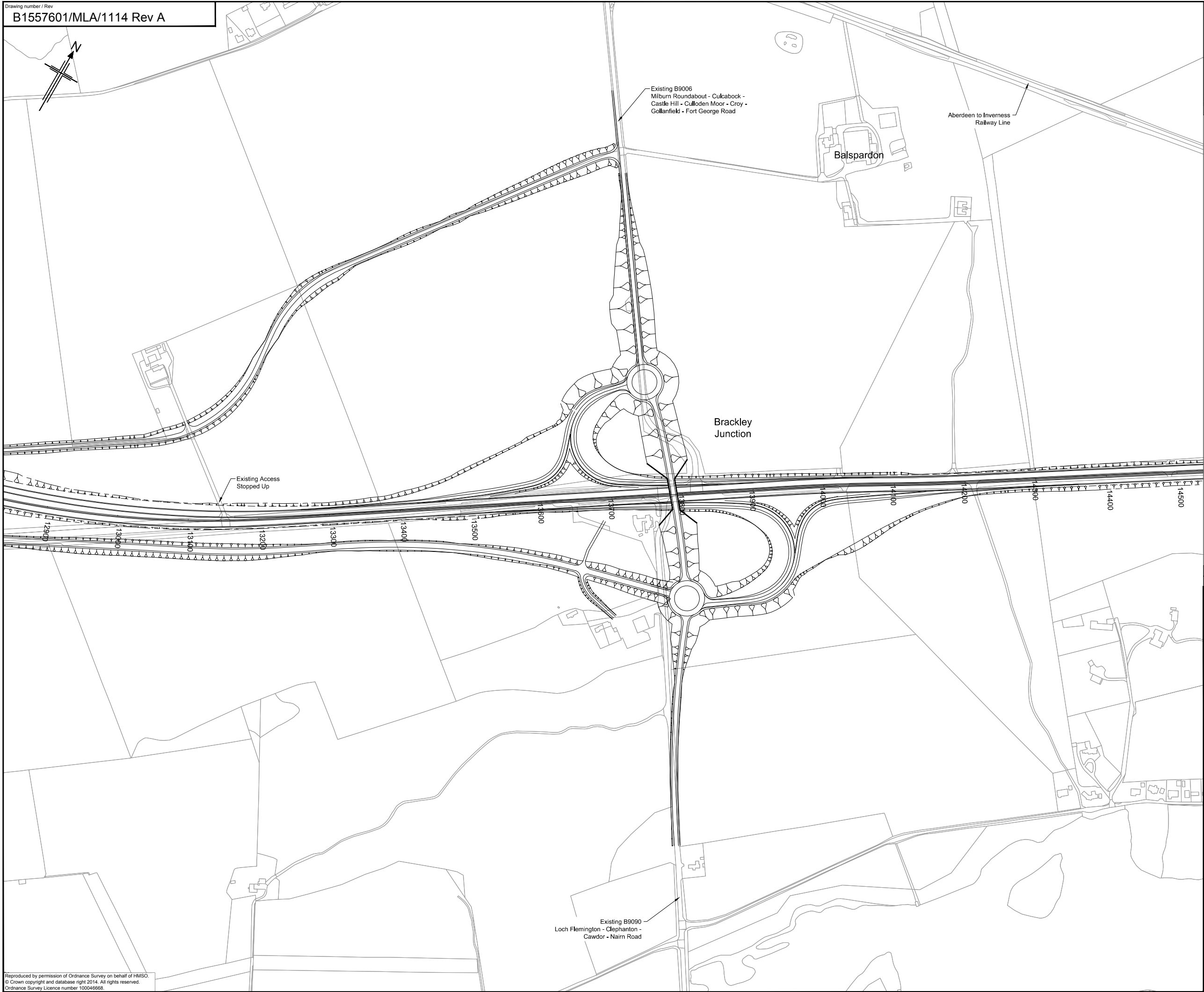

KEY PLAN

**NOTES**

- All dimensions are in metres unless stated otherwise.

This OS Mastermap was obtained in March 2014 and is for illustration purposes only.

A	08/09/14	DMRB Stage 2 Report	DAD	CMM	GAH	EHB
Rev	Rev. Date	Purpose of revision	Drawn	Checked	Rev'd	Apprv'd

**JACOBS**  
 85 Bothwell St, Glasgow, G2 7HX  
 Tel: +44(0)141 243 8000 Fax: +44(0)141 226 3109  
 www.jacobs.com

Client

**TRANSPORT SCOTLAND**  
 COMHAIRLE ALBA

Project

**A96**  
**DUALLING**  
 INVERNESS TO NAIRN  
 (incl. Malmogpass)

Drawing title  
**DMRB STAGE 2  
 INVERNESS TO GOLLANFIELD  
 BRACKLEY JUNCTION  
 OPTION 1A**

Drawing status  
**PRELIMINARY**

Scale  
 1:2,500 @ A1 **DO NOT SCALE**

Jacobs No. B1557601

Drawing number  
**B1557601/MLA/1114** Rev **A**

Reproduced by permission of Ordnance Survey on behalf of HMSO.  
 © Crown copyright and database right 2014. All rights reserved.  
 Ordnance Survey Licence number 100046668.