

NOTES:
 1. All dimensions are in metres unless stated otherwise.

Reproduced by permission of Ordnance Survey on behalf of HMSO.
 © Crown copyright and database right 2014. All rights reserved.
 Ordnance Survey Licence number 100046668.

PLAN
 SCALE 1 : 25000

This OS Mastermap was obtained in March 2014 and is for illustration purposes only.

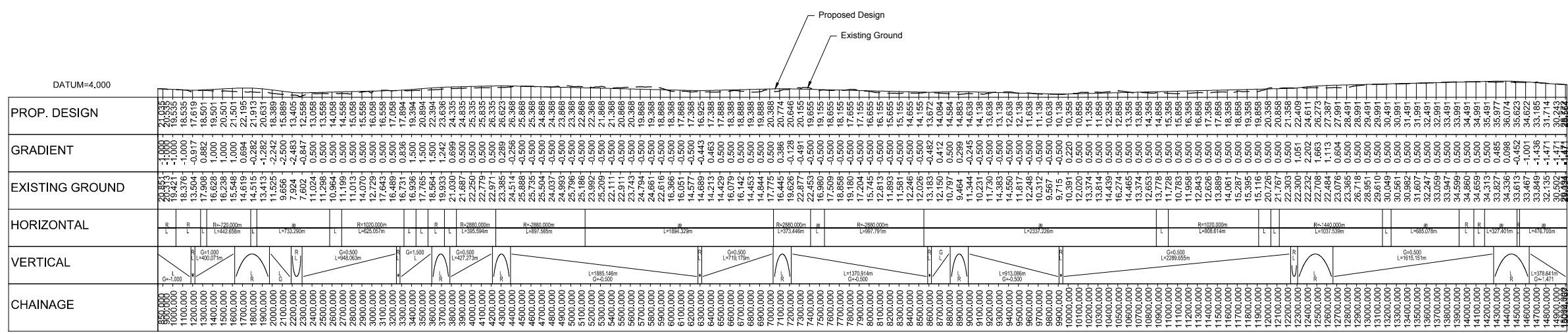

LONGITUDINAL SECTION (CHAINAGE 850m TO 14697.11m)

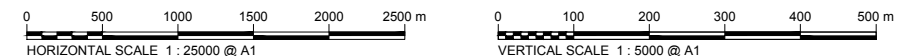

| | | | | | | |
|-----|-----------|---------------------|-------|---------|-------|---------|
| A | 08/09/14 | DMRB Stage 2 Report | DAD | CMM | GAH | EHB |
| Rev | Rev. Date | Purpose of revision | Drawn | Checked | Rev'd | Apprv'd |

JACOBS
 85 Bothwell St, Glasgow, G2 7HX
 Tel: +44(0)141 243 8000 Fax: +44(0)141 226 3109
 www.jacobs.com

Client

TRANSPORT SCOTLAND
 COMHAIL ALBA

Project

A95
 DUALLING
 INVERNESS TO NAIRN
 (incl. Blair Atholl)

Drawing title
**DMRB STAGE 2
 INVERNESS TO GOLLANFIELD
 OPTION 1C PLAN & PROFILE
 CH 850 TO CH 14697.11**

Drawing status
PRELIMINARY

| | | |
|------------|---------------|--------------|
| Scale | AS SHOWN @ A1 | DO NOT SCALE |
| Jacobs No. | B1557601 | |
| Client no. | | |

| | | | |
|----------------|--------------------------|-----|----------|
| Drawing number | B1557601/MLA/1300 | Rev | A |
|----------------|--------------------------|-----|----------|

This drawing is not to be used in whole or part other than for the intended purpose and project as defined on this drawing. Refer to the contract for full terms and conditions.

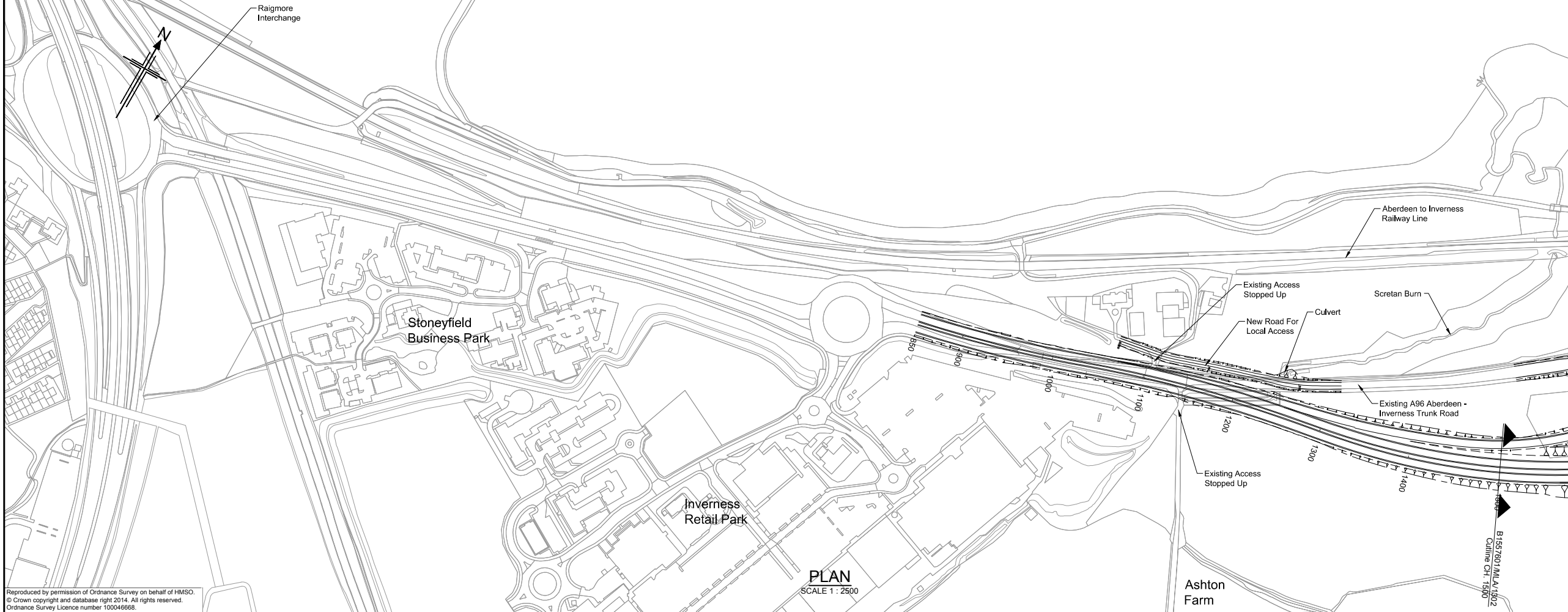

Reproduced by permission of Ordnance Survey on behalf of HMSO.
 © Crown copyright and database right 2014. All rights reserved.
 Ordnance Survey Licence number 100046668.

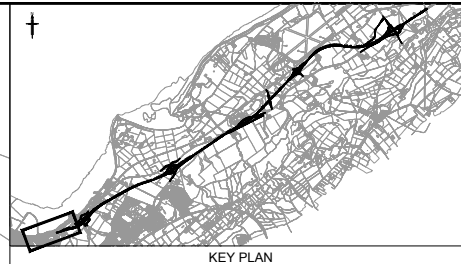

NOTES:
 1. All dimensions are in metres unless stated otherwise.

This OS Mastermap was obtained in March 2014 and is for illustration purposes only.

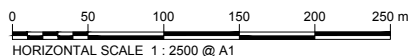
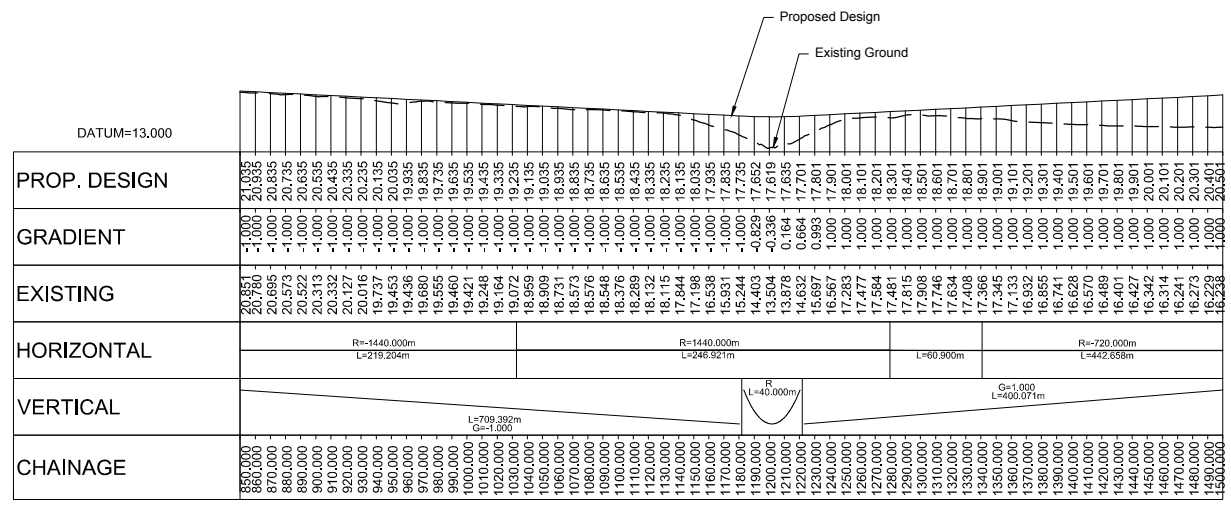

LONGITUDINAL SECTION (CHAINAGE 850m TO 1500m)

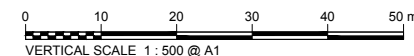

| | | | | | | |
|-----|-----------|---------------------|-------|---------|-------|--------|
| A | 08/09/14 | DMRB Stage 2 Report | DAD | CMM | GAH | EHB |
| Rev | Rev. Date | Purpose of revision | Drawn | Checked | Rev'd | Appr'd |



Drawing title
**DMRB STAGE 2
 INVERNESS TO GOLLANFIELD
 OPTION 1C PLAN & PROFILE
 CH 850 TO CH 1500**

Drawing status
PRELIMINARY

Scale
 1:2,500 @ A1 DO NOT SCALE

Jacobs No. B1557601

Drawing number
B1557601/MLA/1301

Rev
A

This drawing is not to be used in whole or part other than for the intended purpose and project as defined on this drawing. Refer to the contract for full terms and conditions.

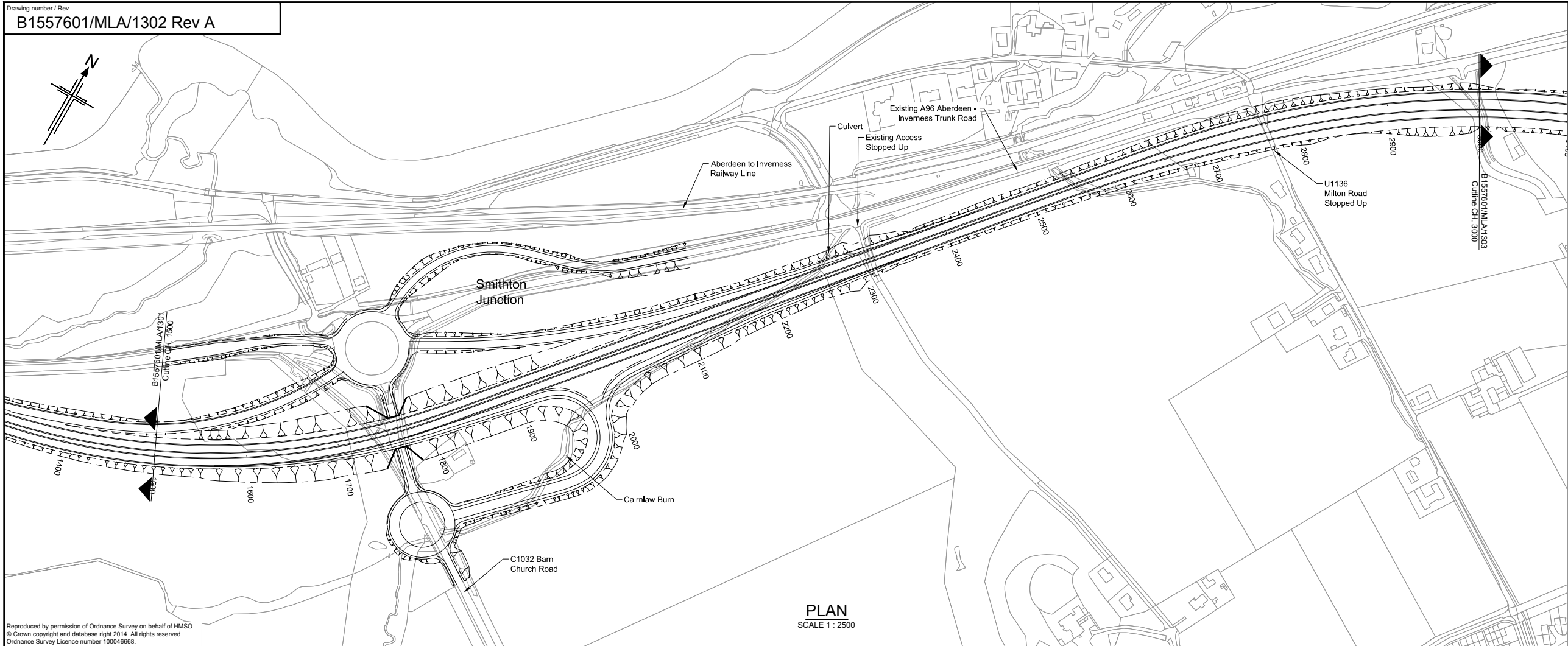

PLAN
 SCALE 1: 2500

Reproduced by permission of Ordnance Survey on behalf of HMSO.
 © Crown copyright and database right 2014. All rights reserved.
 Ordnance Survey Licence number 100046668.

NOTES:
 1. All dimensions are in metres unless stated otherwise.
 2. For Smithton Junction refer to drawing no. B155760/MLA/1311.

This OS Mastermap was obtained in March 2014 and is for illustration purposes only.

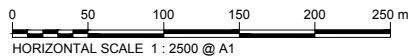
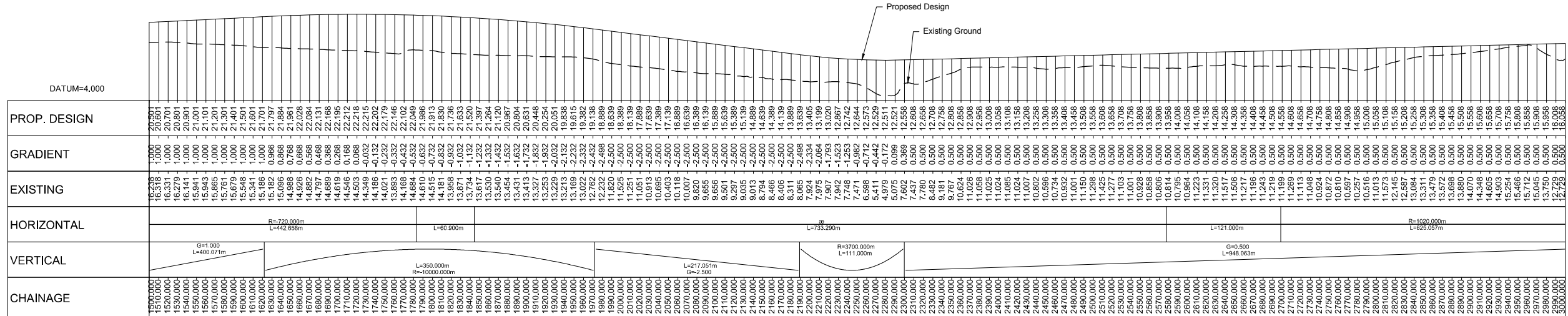

LONGITUDINAL SECTION (CHAINAGE 1500m TO 3000m)

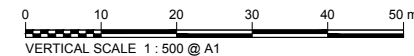

| | | | | | | |
|-----|-----------|---------------------|-------|---------|-------|---------|
| A | 08/09/14 | DMRB Stage 2 Report | DAD | CMM | GAH | EHB |
| Rev | Rev. Date | Purpose of revision | Drawn | Checked | Rev'd | Apprv'd |

JACOBS
 85 Bothwell St, Glasgow, G2 7HX
 Tel: +44(0)141 243 8000 Fax: +44(0)141 226 3109
 www.jacobs.com

Client

TRANSPORT SCOTLAND
 COMHAIL ALBA

Project

A96
 DUALLING
 INVERNESS TO NAIRN
 (incl. Milton Dyppan)

Drawing title
**DMRB STAGE 2
 INVERNESS TO GOLLANFIELD
 OPTION 1C PLAN & PROFILE
 CH 1500 TO CH 3000**

Drawing status
PRELIMINARY

Scale
 1:2,500 @ A1 DO NOT SCALE

Jacobs No. B1557601

Client no.

Drawing number
B1557601/MLA/1302

Rev
A

This drawing is not to be used in whole or part other than for the intended purpose and project as defined on this drawing. Refer to the contract for full terms and conditions.

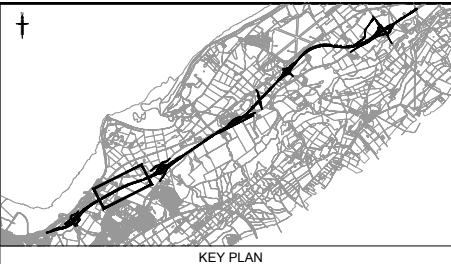
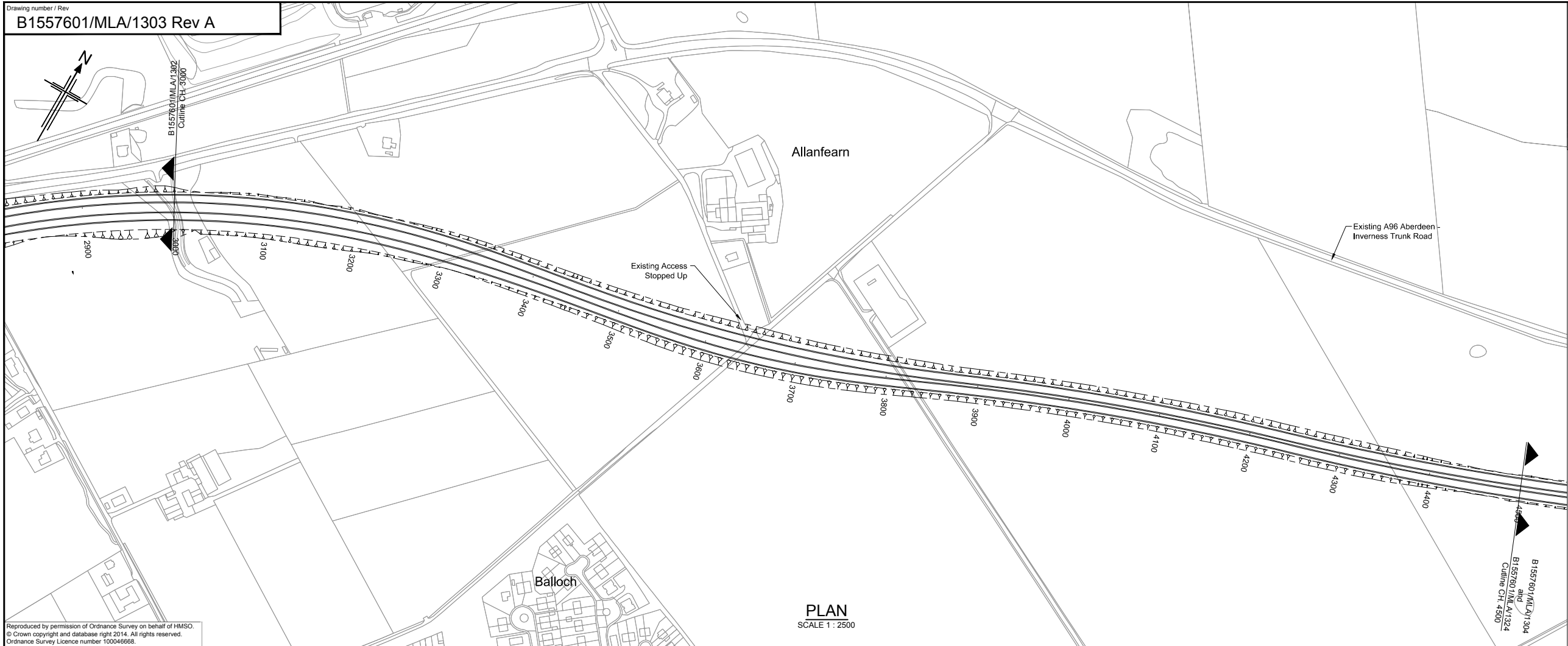

NOTES:
 1. All dimensions are in metres unless stated otherwise.

Reproduced by permission of Ordnance Survey on behalf of HMSO.
 © Crown copyright and database right 2014. All rights reserved.
 Ordnance Survey Licence number 100046668.

This OS Mastermap was obtained in March 2014 and is for illustration purposes only.

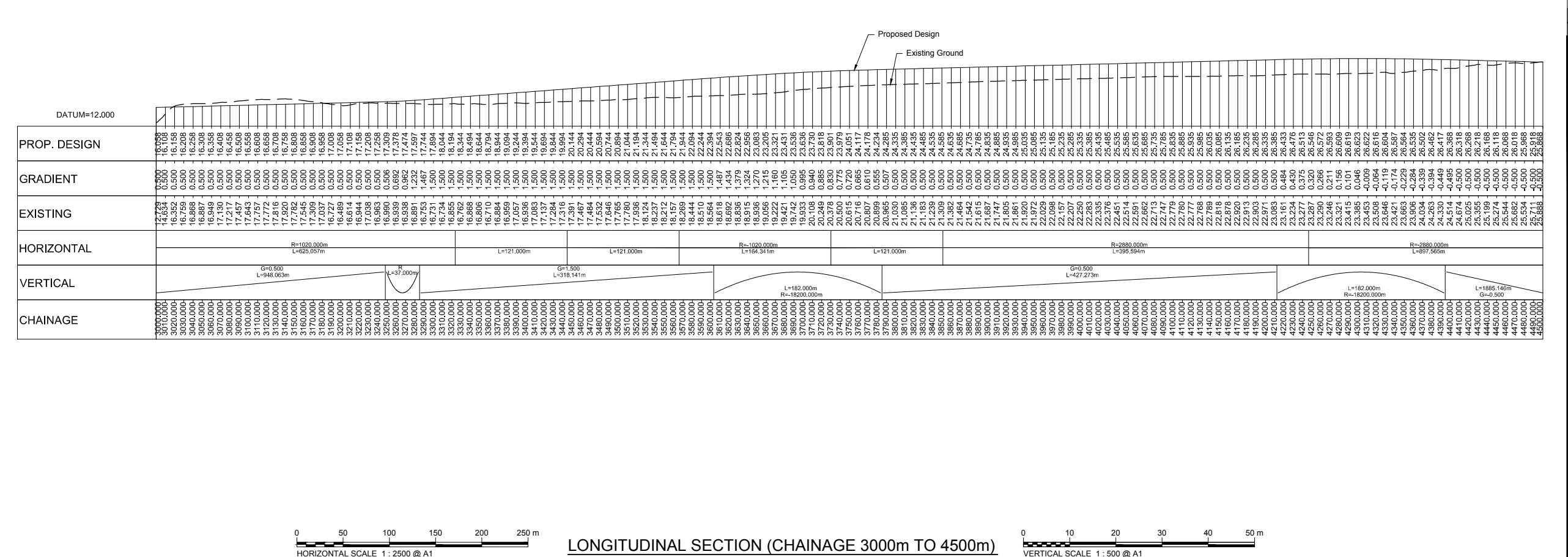

| | | | | | | |
|-----|-----------|---------------------|-------|---------|-------|---------|
| A | 08/09/14 | DMRB Stage 2 Report | DAD | CMM | GAH | EHB |
| Rev | Rev. Date | Purpose of revision | Drawn | Checked | Rev'd | Apprv'd |

JACOBS
 85 Bothwell St, Glasgow, G2 7HX
 Tel: +44(0)141 243 8000 Fax: +44(0)141 226 3109
 www.jacobs.com

Client

TRANSPORT SCOTLAND
 COMHAIL ALBA

Project

A96
 DUALLING
 INVERNESS TO NAIRN
 (incl. Nairn Bypass)

Drawing title
**DMRB STAGE 2
 INVERNESS TO GOLLANFIELD
 OPTION 1C PLAN & PROFILE
 CH 3000 TO CH 4500**

Drawing status
PRELIMINARY

Scale
 1:2,500 @ A1 DO NOT SCALE

Jacobs No.
 B1557601

Client no.

Drawing number
B1557601/MLA/1303

Rev
A

This drawing is not to be used in whole or part other than for the intended purpose and project as defined on this drawing. Refer to the contract for full terms and conditions.

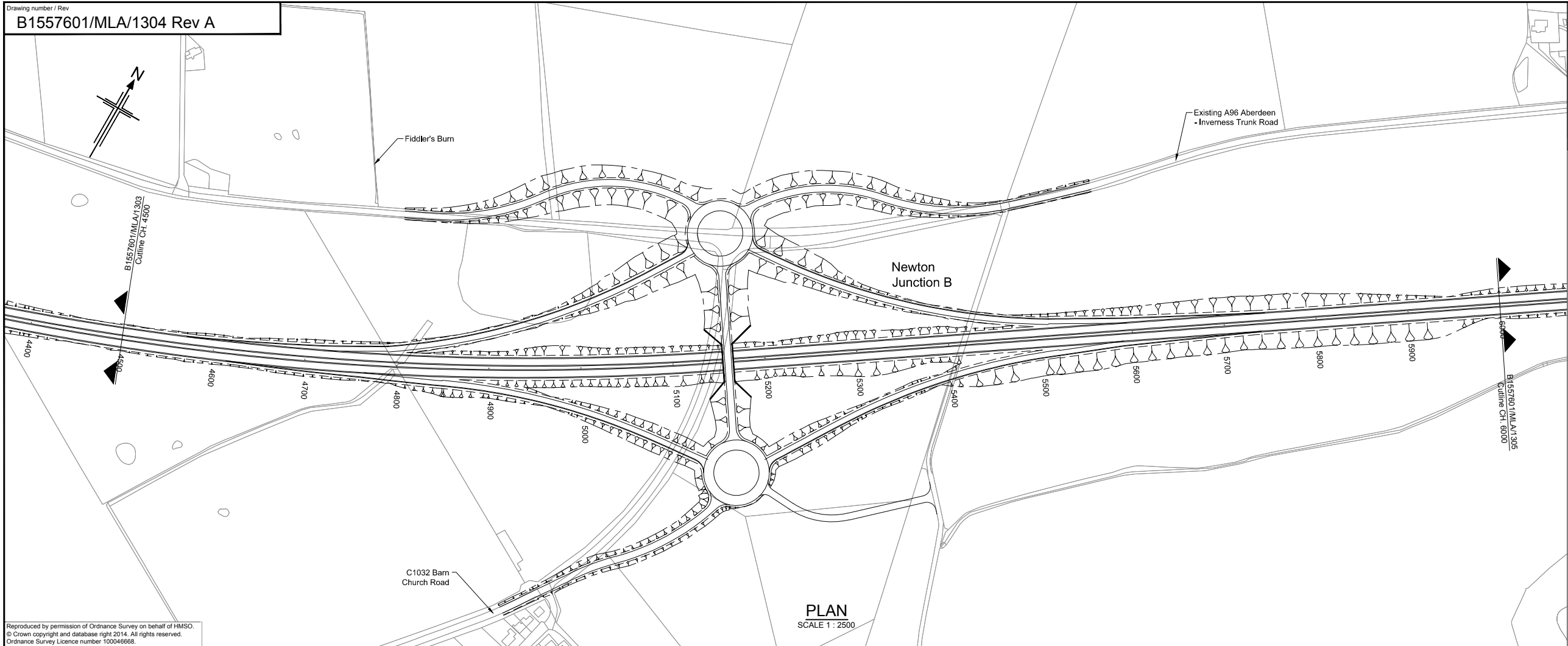

PLAN
 SCALE 1 : 2500

Reproduced by permission of Ordnance Survey on behalf of HMSO.
 © Crown copyright and database right 2014. All rights reserved.
 Ordnance Survey Licence number 100046668.

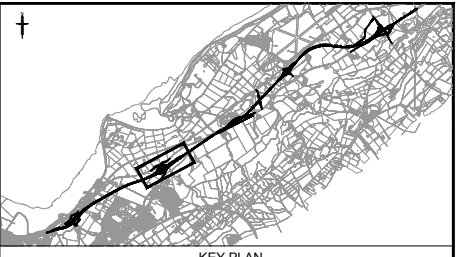

- NOTES:**
- All dimensions are in metres unless stated otherwise.
 - For Newton Junction refer to drawing no. B1557601/MLA/1312.

This OS Mastermap was obtained in March 2014 and is for illustration purposes only.

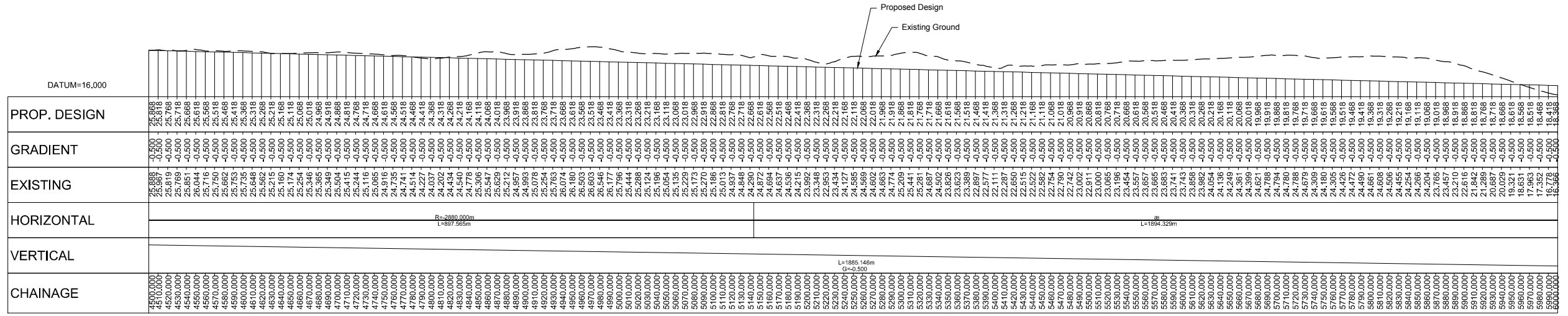

| CHAINAGE | PROP. DESIGN | GRADIENT | EXISTING | HORIZONTAL | VERTICAL |
|----------|--------------|----------|----------|------------|----------|
| 4500.000 | 25.868 | -0.500 | 25.868 | | |
| 4510.000 | 25.868 | -0.500 | 25.868 | | |
| 4520.000 | 25.868 | -0.500 | 25.868 | | |
| 4530.000 | 25.718 | -0.500 | 25.718 | | |
| 4540.000 | 25.668 | -0.500 | 25.668 | | |
| 4550.000 | 25.618 | -0.500 | 25.618 | | |
| 4560.000 | 25.568 | -0.500 | 25.568 | | |
| 4570.000 | 25.518 | -0.500 | 25.518 | | |
| 4580.000 | 25.468 | -0.500 | 25.468 | | |
| 4590.000 | 25.418 | -0.500 | 25.418 | | |
| 4600.000 | 25.368 | -0.500 | 25.368 | | |
| 4610.000 | 25.318 | -0.500 | 25.318 | | |
| 4620.000 | 25.268 | -0.500 | 25.268 | | |
| 4630.000 | 25.218 | -0.500 | 25.218 | | |
| 4640.000 | 25.168 | -0.500 | 25.168 | | |
| 4650.000 | 25.118 | -0.500 | 25.118 | | |
| 4660.000 | 25.068 | -0.500 | 25.068 | | |
| 4670.000 | 25.018 | -0.500 | 25.018 | | |
| 4680.000 | 24.968 | -0.500 | 24.968 | | |
| 4690.000 | 24.918 | -0.500 | 24.918 | | |
| 4700.000 | 24.868 | -0.500 | 24.868 | | |
| 4710.000 | 24.818 | -0.500 | 24.818 | | |
| 4720.000 | 24.768 | -0.500 | 24.768 | | |
| 4730.000 | 24.718 | -0.500 | 24.718 | | |
| 4740.000 | 24.668 | -0.500 | 24.668 | | |
| 4750.000 | 24.618 | -0.500 | 24.618 | | |
| 4760.000 | 24.568 | -0.500 | 24.568 | | |
| 4770.000 | 24.518 | -0.500 | 24.518 | | |
| 4780.000 | 24.468 | -0.500 | 24.468 | | |
| 4790.000 | 24.418 | -0.500 | 24.418 | | |
| 4800.000 | 24.368 | -0.500 | 24.368 | | |
| 4810.000 | 24.318 | -0.500 | 24.318 | | |
| 4820.000 | 24.268 | -0.500 | 24.268 | | |
| 4830.000 | 24.218 | -0.500 | 24.218 | | |
| 4840.000 | 24.168 | -0.500 | 24.168 | | |
| 4850.000 | 24.118 | -0.500 | 24.118 | | |
| 4860.000 | 24.068 | -0.500 | 24.068 | | |
| 4870.000 | 24.018 | -0.500 | 24.018 | | |
| 4880.000 | 23.968 | -0.500 | 23.968 | | |
| 4890.000 | 23.918 | -0.500 | 23.918 | | |
| 4900.000 | 23.868 | -0.500 | 23.868 | | |
| 4910.000 | 23.818 | -0.500 | 23.818 | | |
| 4920.000 | 23.768 | -0.500 | 23.768 | | |
| 4930.000 | 23.718 | -0.500 | 23.718 | | |
| 4940.000 | 23.668 | -0.500 | 23.668 | | |
| 4950.000 | 23.618 | -0.500 | 23.618 | | |
| 4960.000 | 23.568 | -0.500 | 23.568 | | |
| 4970.000 | 23.518 | -0.500 | 23.518 | | |
| 4980.000 | 23.468 | -0.500 | 23.468 | | |
| 4990.000 | 23.418 | -0.500 | 23.418 | | |
| 5000.000 | 23.368 | -0.500 | 23.368 | | |
| 5010.000 | 23.318 | -0.500 | 23.318 | | |
| 5020.000 | 23.268 | -0.500 | 23.268 | | |
| 5030.000 | 23.218 | -0.500 | 23.218 | | |
| 5040.000 | 23.168 | -0.500 | 23.168 | | |
| 5050.000 | 23.118 | -0.500 | 23.118 | | |
| 5060.000 | 23.068 | -0.500 | 23.068 | | |
| 5070.000 | 23.018 | -0.500 | 23.018 | | |
| 5080.000 | 22.968 | -0.500 | 22.968 | | |
| 5090.000 | 22.918 | -0.500 | 22.918 | | |
| 5100.000 | 22.868 | -0.500 | 22.868 | | |
| 5110.000 | 22.818 | -0.500 | 22.818 | | |
| 5120.000 | 22.768 | -0.500 | 22.768 | | |
| 5130.000 | 22.718 | -0.500 | 22.718 | | |
| 5140.000 | 22.668 | -0.500 | 22.668 | | |
| 5150.000 | 22.618 | -0.500 | 22.618 | | |
| 5160.000 | 22.568 | -0.500 | 22.568 | | |
| 5170.000 | 22.518 | -0.500 | 22.518 | | |
| 5180.000 | 22.468 | -0.500 | 22.468 | | |
| 5190.000 | 22.418 | -0.500 | 22.418 | | |
| 5200.000 | 22.368 | -0.500 | 22.368 | | |
| 5210.000 | 22.318 | -0.500 | 22.318 | | |
| 5220.000 | 22.268 | -0.500 | 22.268 | | |
| 5230.000 | 22.218 | -0.500 | 22.218 | | |
| 5240.000 | 22.168 | -0.500 | 22.168 | | |
| 5250.000 | 22.118 | -0.500 | 22.118 | | |
| 5260.000 | 22.068 | -0.500 | 22.068 | | |
| 5270.000 | 22.018 | -0.500 | 22.018 | | |
| 5280.000 | 21.968 | -0.500 | 21.968 | | |
| 5290.000 | 21.918 | -0.500 | 21.918 | | |
| 5300.000 | 21.868 | -0.500 | 21.868 | | |
| 5310.000 | 21.818 | -0.500 | 21.818 | | |
| 5320.000 | 21.768 | -0.500 | 21.768 | | |
| 5330.000 | 21.718 | -0.500 | 21.718 | | |
| 5340.000 | 21.668 | -0.500 | 21.668 | | |
| 5350.000 | 21.618 | -0.500 | 21.618 | | |
| 5360.000 | 21.568 | -0.500 | 21.568 | | |
| 5370.000 | 21.518 | -0.500 | 21.518 | | |
| 5380.000 | 21.468 | -0.500 | 21.468 | | |
| 5390.000 | 21.418 | -0.500 | 21.418 | | |
| 5400.000 | 21.368 | -0.500 | 21.368 | | |
| 5410.000 | 21.318 | -0.500 | 21.318 | | |
| 5420.000 | 21.268 | -0.500 | 21.268 | | |
| 5430.000 | 21.218 | -0.500 | 21.218 | | |
| 5440.000 | 21.168 | -0.500 | 21.168 | | |
| 5450.000 | 21.118 | -0.500 | 21.118 | | |
| 5460.000 | 21.068 | -0.500 | 21.068 | | |
| 5470.000 | 21.018 | -0.500 | 21.018 | | |
| 5480.000 | 20.968 | -0.500 | 20.968 | | |
| 5490.000 | 20.918 | -0.500 | 20.918 | | |
| 5500.000 | 20.868 | -0.500 | 20.868 | | |
| 5510.000 | 20.818 | -0.500 | 20.818 | | |
| 5520.000 | 20.768 | -0.500 | 20.768 | | |
| 5530.000 | 20.718 | -0.500 | 20.718 | | |
| 5540.000 | 20.668 | -0.500 | 20.668 | | |
| 5550.000 | 20.618 | -0.500 | 20.618 | | |
| 5560.000 | 20.568 | -0.500 | 20.568 | | |
| 5570.000 | 20.518 | -0.500 | 20.518 | | |
| 5580.000 | 20.468 | -0.500 | 20.468 | | |
| 5590.000 | 20.418 | -0.500 | 20.418 | | |
| 5600.000 | 20.368 | -0.500 | 20.368 | | |
| 5610.000 | 20.318 | -0.500 | 20.318 | | |
| 5620.000 | 20.268 | -0.500 | 20.268 | | |
| 5630.000 | 20.218 | -0.500 | 20.218 | | |
| 5640.000 | 20.168 | -0.500 | 20.168 | | |
| 5650.000 | 20.118 | -0.500 | 20.118 | | |
| 5660.000 | 20.068 | -0.500 | 20.068 | | |
| 5670.000 | 20.018 | -0.500 | 20.018 | | |
| 5680.000 | 19.968 | -0.500 | 19.968 | | |
| 5690.000 | 19.918 | -0.500 | 19.918 | | |
| 5700.000 | 19.868 | -0.500 | 19.868 | | |
| 5710.000 | 19.818 | -0.500 | 19.818 | | |
| 5720.000 | 19.768 | -0.500 | 19.768 | | |
| 5730.000 | 19.718 | -0.500 | 19.718 | | |
| 5740.000 | 19.668 | -0.500 | 19.668 | | |
| 5750.000 | 19.618 | -0.500 | 19.618 | | |
| 5760.000 | 19.568 | -0.500 | 19.568 | | |
| 5770.000 | 19.518 | -0.500 | 19.518 | | |
| 5780.000 | 19.468 | -0.500 | 19.468 | | |
| 5790.000 | 19.418 | -0.500 | 19.418 | | |
| 5800.000 | 19.368 | -0.500 | 19.368 | | |
| 5810.000 | 19.318 | -0.500 | 19.318 | | |
| 5820.000 | 19.268 | -0.500 | 19.268 | | |
| 5830.000 | 19.218 | -0.500 | 19.218 | | |
| 5840.000 | 19.168 | -0.500 | 19.168 | | |
| 5850.000 | 19.118 | -0.500 | 19.118 | | |
| 5860.000 | 19.068 | -0.500 | 19.068 | | |
| 5870.000 | 19.018 | -0.500 | 19.018 | | |
| 5880.000 | 18.968 | -0.500 | 18.968 | | |
| 5890.000 | 18.918 | -0.500 | 18.918 | | |
| 5900.000 | 18.868 | -0.500 | 18.868 | | |
| 5910.000 | 18.818 | -0.500 | 18.818 | | |
| 5920.000 | 18.768 | -0.500 | 18.768 | | |
| 5930.000 | 18.718 | -0.500 | 18.718 | | |
| 5940.000 | 18.668 | -0.500 | 18.668 | | |
| 5950.000 | 18.618 | -0.500 | 18.618 | | |
| 5960.000 | 18.568 | -0.500 | 18.568 | | |
| 5970.000 | 18.518 | -0.500 | 18.518 | | |
| 5980.000 | 18.468 | -0.500 | 18.468 | | |
| 5990.000 | 18.418 | -0.500 | 18.418 | | |
| 6000.000 | 18.368 | -0.500 | 18.368 | | |

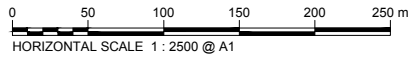

LONGITUDINAL SECTION (CHAINAGE 4500m TO 6000m)

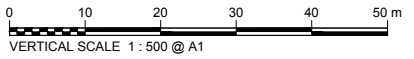

| A | 08/09/14 | DMRB Stage 2 Report | DAD | CMM | GAH | EHB |
|-----|-----------|---------------------|-------|---------|-------|---------|
| Rev | Rev. Date | Purpose of revision | Drawn | Checked | Rev'd | Apprv'd |

JACOBS
 85 Bothwell St, Glasgow, G2 7HX
 Tel: +44(0)141 243 8000 Fax: +44(0)141 226 3109
 www.jacobs.com



Drawing title
**DMRB STAGE 2
 INVERNESS TO GOLLANFIELD
 OPTION 1C PLAN & PROFILE
 CH 4500 TO CH 6000**

Drawing status
PRELIMINARY

Scale
 1:2,500 @ A1 DO NOT SCALE

Jacobs No. B1557601
 Client no.

Drawing number
B1557601/MLA/1304 Rev **A**

This drawing is not to be used in whole or part other than for the intended purpose and project as defined on this drawing. Refer to the contract for full terms and conditions.

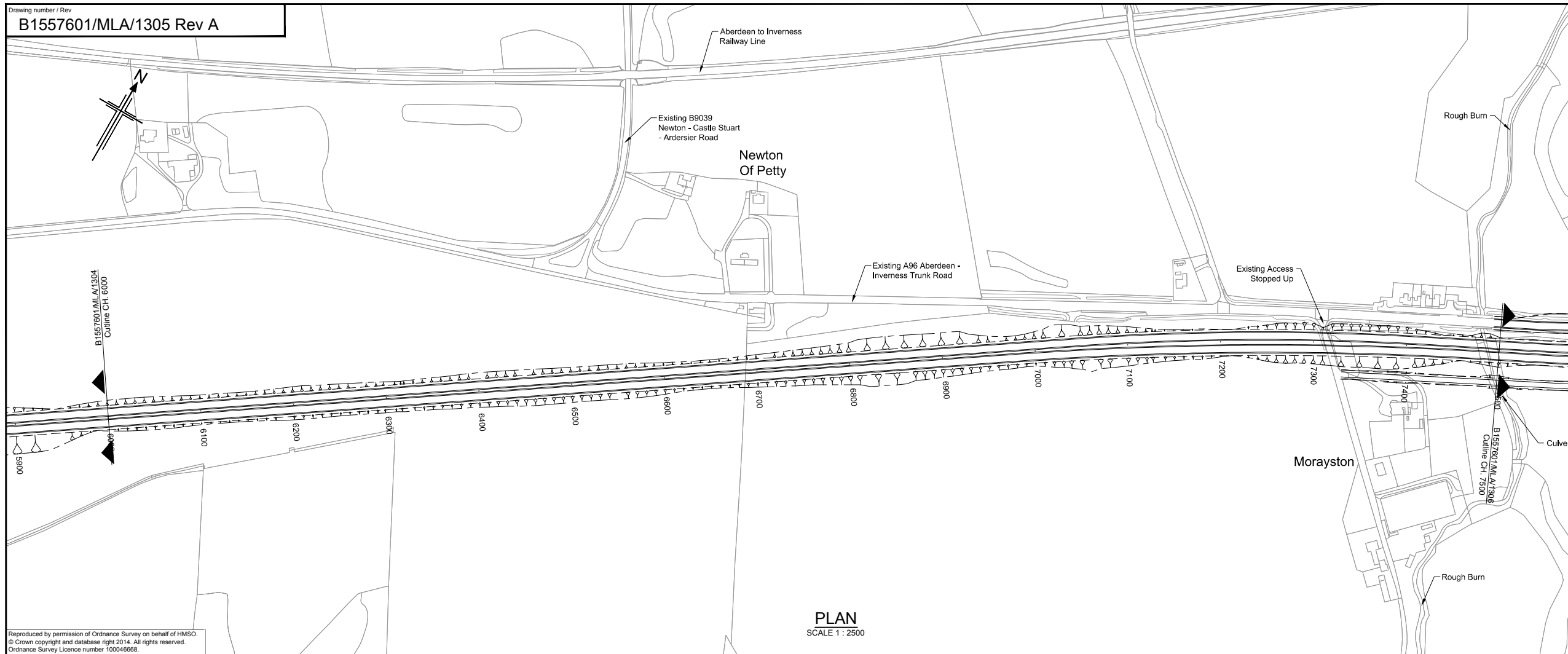

Reproduced by permission of Ordnance Survey on behalf of HMSO.
 © Crown copyright and database right 2014. All rights reserved.
 Ordnance Survey Licence number 100046668.

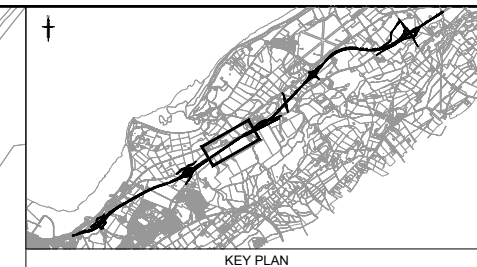

NOTES:
 1. All dimensions are in metres unless stated otherwise.

This OS Mastermap was obtained in March 2014 and is for illustration purposes only.

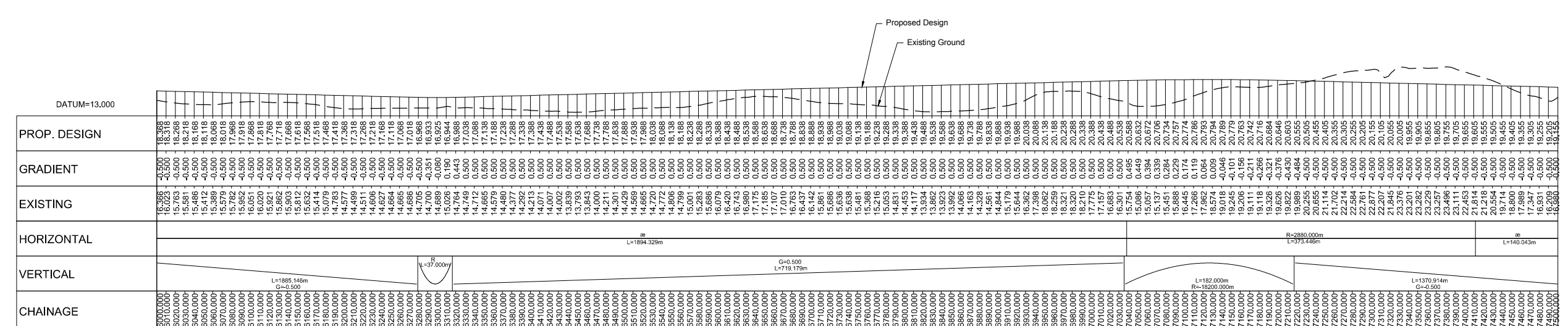

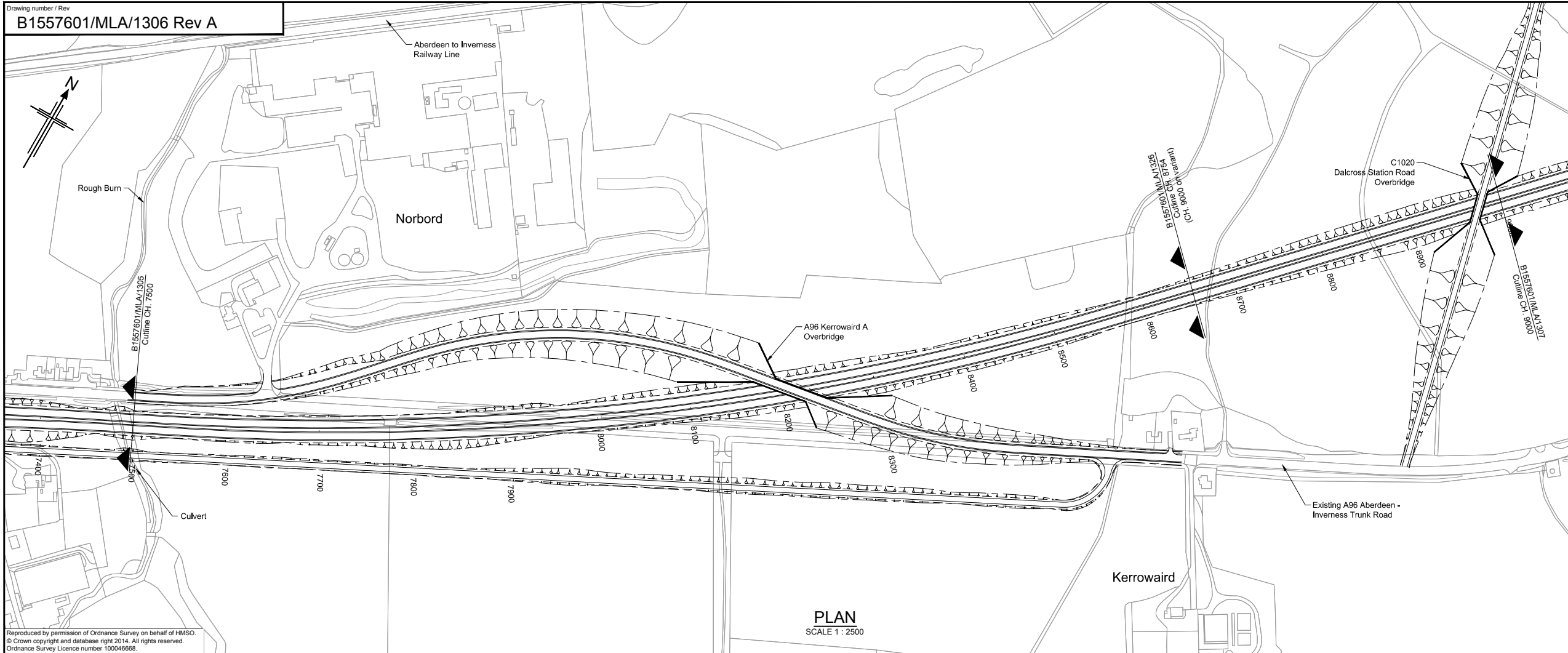

PLAN
 SCALE 1 : 2500

Reproduced by permission of Ordnance Survey on behalf of HMSO.
 © Crown copyright and database right 2014. All rights reserved.
 Ordnance Survey Licence number 100046668.

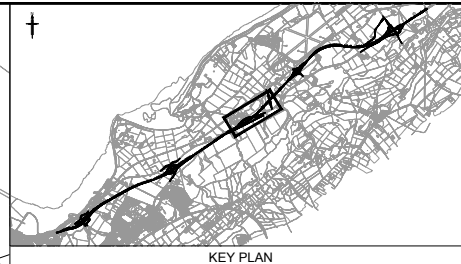

NOTES:
 1. All dimensions are in metres unless stated otherwise.

This OS Mastermap was obtained in March 2014 and is for illustration purposes only.

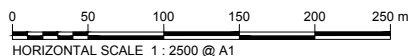
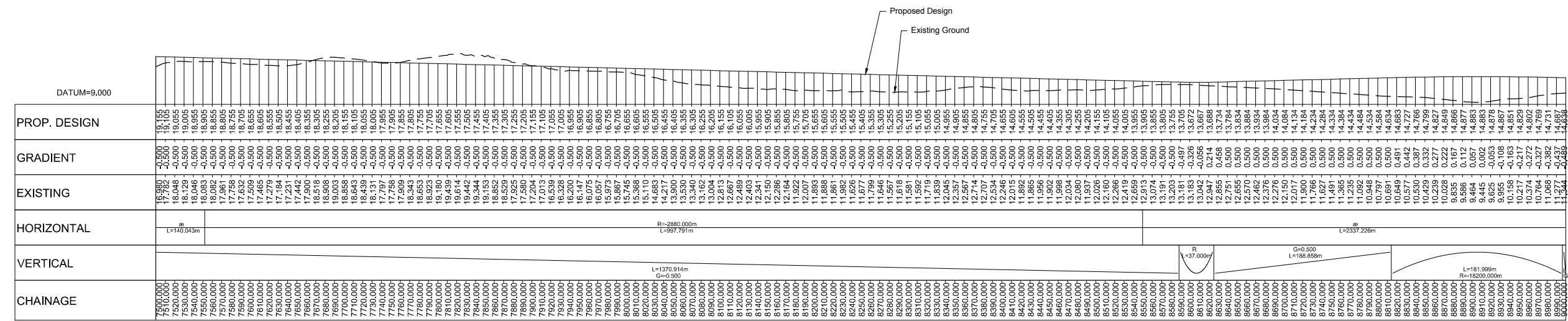

LONGITUDINAL SECTION (CHAINAGE 7500m TO 9000m)

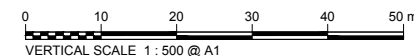

| | | | | | | |
|-----|-----------|---------------------|-------|---------|-------|---------|
| A | 08/09/14 | DMRB Stage 2 Report | DAD | CMM | GAH | EHB |
| Rev | Rev. Date | Purpose of revision | Drawn | Checked | Rev'd | Apprv'd |

JACOBS
 85 Bothwell St, Glasgow, G2 7HX
 Tel: +44(0)141 243 8000 Fax: +44(0)141 226 3109
 www.jacobs.com

Client

COMHDAIL ALBA

Project

Drawing title
**DMRB STAGE 2
 INVERNESS TO GOLLANFIELD
 OPTION 1C PLAN & PROFILE
 CH 7500 TO CH 9000**

Drawing status
PRELIMINARY

Scale
 1:2,500 @ A1 DO NOT SCALE

Jacobs No.
 B1557601

Client no.

Drawing number
B1557601/MLA/1306

Rev
A

This drawing is not to be used in whole or part other than for the intended purpose and project as defined on this drawing. Refer to the contract for full terms and conditions.

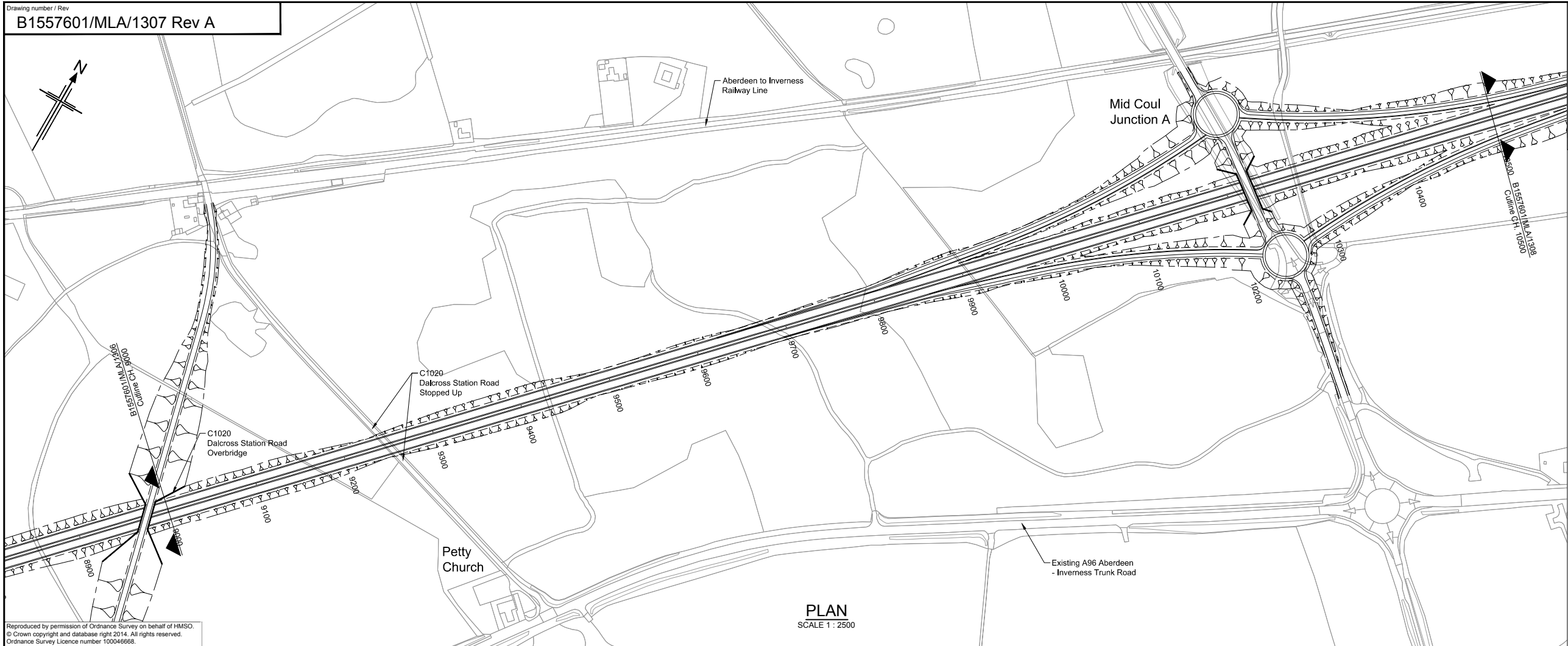

Reproduced by permission of Ordnance Survey on behalf of HMSO.
 © Crown copyright and database right 2014. All rights reserved.
 Ordnance Survey Licence number 100046668.

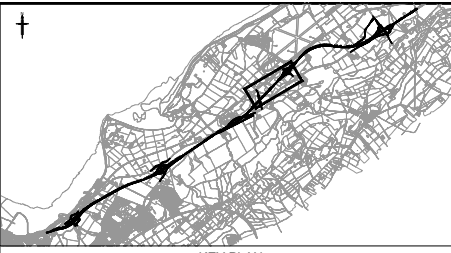

- NOTES:**
- All dimensions are in metres unless stated otherwise.
 - For Mid Coul Junction A refer to drawing no. B1557601/MLA/1313.

This OS Mastermap was obtained in March 2014 and is for illustration purposes only.

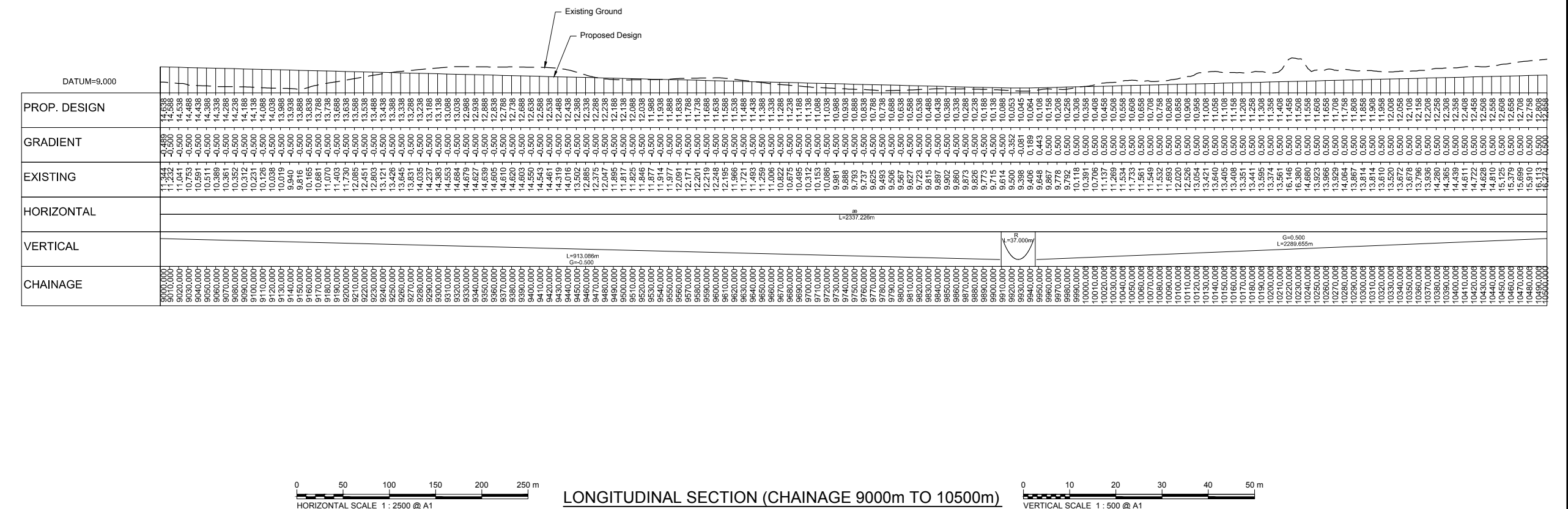

| | | | | | | |
|-----|-----------|---------------------|-------|---------|-------|---------|
| A | 08/09/14 | DMRB Stage 2 Report | DAD | CMM | GAH | EHB |
| Rev | Rev. Date | Purpose of revision | Drawn | Checked | Rev'd | Apprv'd |

JACOBS
 85 Bothwell St, Glasgow, G2 7HX
 Tel: +44(0)141 243 8000 Fax: +44(0)141 226 3109
 www.jacobs.com

Client

TRANSPORT SCOTLAND
 COMH-DHAL ALBA

Project

A96
 DUALLING
 INVERNESS TO NAIRN
 (incl. Nairn Bypass)

Drawing title
**DMRB STAGE 2
 INVERNESS TO GOLLANFIELD
 OPTION 1C PLAN & PROFILE
 CH 9000 TO CH 10500**

Drawing status
PRELIMINARY

Scale
 1:2,500 @ A1 DO NOT SCALE

Jacobs No. B1557601
 Client no.
 Drawing number **B1557601/MLA/1307** Rev **A**

This drawing is not to be used in whole or part other than for the intended purpose and project as defined on this drawing. Refer to the contract for full terms and conditions.

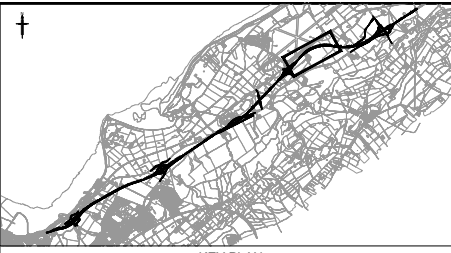
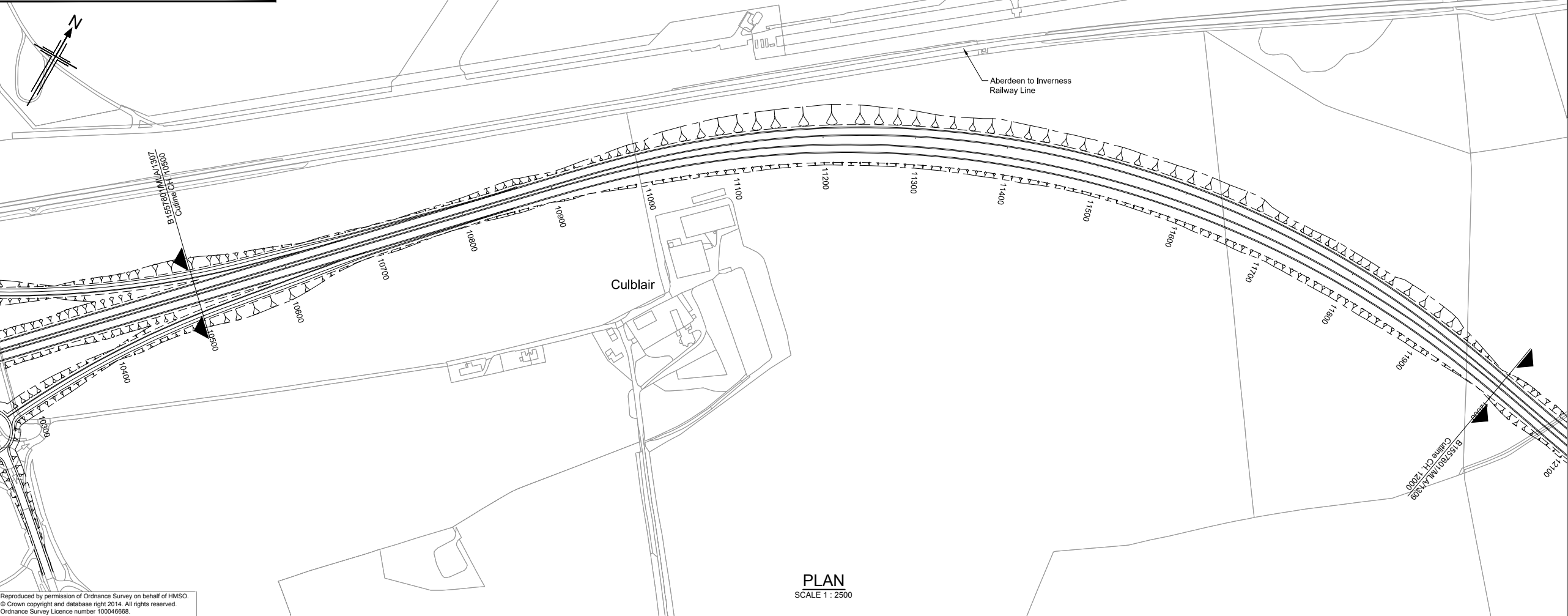

NOTES:
 1. All dimensions are in metres unless stated otherwise.

Reproduced by permission of Ordnance Survey on behalf of HMSO.
 © Crown copyright and database right 2014. All rights reserved.
 Ordnance Survey Licence number 100046668.

This OS Mastermap was obtained in March 2014 and is for illustration purposes only.

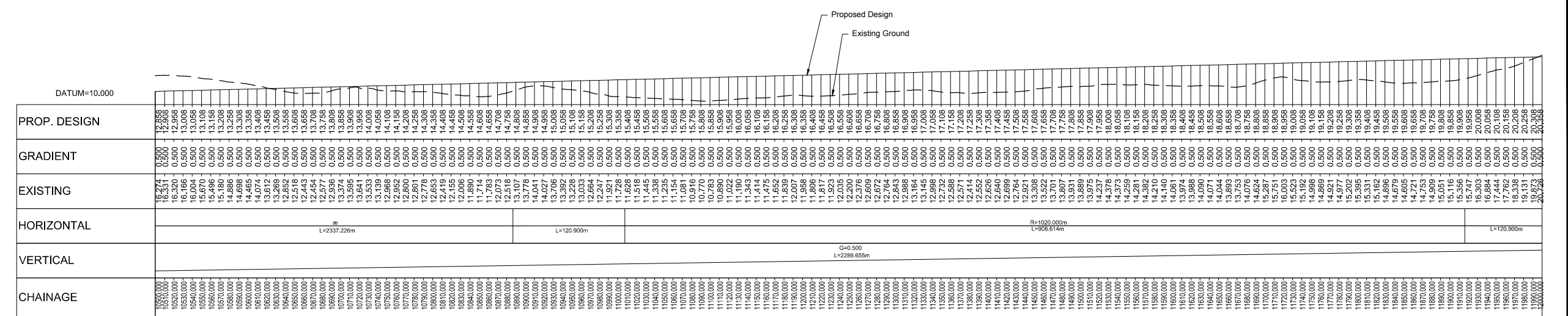

| PROP. DESIGN | GRADIENT | EXISTING | HORIZONTAL | VERTICAL | CHAINAGE |
|--------------|----------|----------|---------------------------|------------------------|-----------|
| 16.274 | 0.500 | 16.331 | L=2337.226m | G=0.500 L=2289.655m | 10500.000 |
| 16.320 | 0.500 | 16.320 | | | 10520.000 |
| 16.366 | 0.500 | 16.308 | L=120.900m | G=0.500 L=2289.655m | 10540.000 |
| 16.412 | 0.500 | 16.296 | | | 10560.000 |
| 16.458 | 0.500 | 16.284 | R=1020.000m L=508.814m | G=0.500 L=2289.655m | 10580.000 |
| 16.504 | 0.500 | 16.272 | | | 10600.000 |
| 16.550 | 0.500 | 16.260 | L=120.900m | G=0.500 L=2289.655m | 10620.000 |
| 16.596 | 0.500 | 16.248 | | | 10640.000 |
| 16.642 | 0.500 | 16.236 | | | 10660.000 |
| 16.688 | 0.500 | 16.224 | | | 10680.000 |
| 16.734 | 0.500 | 16.212 | | | 10700.000 |
| 16.780 | 0.500 | 16.200 | | | 10720.000 |
| 16.826 | 0.500 | 16.188 | | | 10740.000 |
| 16.872 | 0.500 | 16.176 | | | 10760.000 |
| 16.918 | 0.500 | 16.164 | | | 10780.000 |
| 16.964 | 0.500 | 16.152 | | | 10800.000 |
| 17.010 | 0.500 | 16.140 | | | 10820.000 |
| 17.056 | 0.500 | 16.128 | | | 10840.000 |
| 17.102 | 0.500 | 16.116 | | | 10860.000 |
| 17.148 | 0.500 | 16.104 | | | 10880.000 |
| 17.194 | 0.500 | 16.092 | | | 10900.000 |
| 17.240 | 0.500 | 16.080 | | | 10920.000 |
| 17.286 | 0.500 | 16.068 | | | 10940.000 |
| 17.332 | 0.500 | 16.056 | | | 10960.000 |
| 17.378 | 0.500 | 16.044 | | | 10980.000 |
| 17.424 | 0.500 | 16.032 | | | 11000.000 |
| 17.470 | 0.500 | 16.020 | | | 11020.000 |
| 17.516 | 0.500 | 16.008 | | | 11040.000 |
| 17.562 | 0.500 | 16.000 | | | 11060.000 |
| 17.608 | 0.500 | 15.992 | | | 11080.000 |
| 17.654 | 0.500 | 15.984 | | | 11100.000 |
| 17.700 | 0.500 | 15.976 | | | 11120.000 |
| 17.746 | 0.500 | 15.968 | | | 11140.000 |
| 17.792 | 0.500 | 15.960 | | | 11160.000 |
| 17.838 | 0.500 | 15.952 | | | 11180.000 |
| 17.884 | 0.500 | 15.944 | | | 11200.000 |

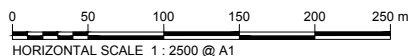

LONGITUDINAL SECTION (CHAINAGE 10500m TO 12000m)

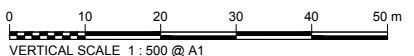

| Rev | Rev. Date | Purpose of revision | Drawn | Checked | Rev'd | Appr'd |
|-----|-----------|---------------------|-------|---------|-------|--------|
| A | 08/09/14 | DMRB Stage 2 Report | DAD | CMM | GAH | EHB |

JACOBS
 85 Bothwell St, Glasgow, G2 7HX
 Tel: +44(0)141 243 8000 Fax: +44(0)141 226 3109
 www.jacobs.com

Client

 TRANSPORT SCOTLAND
 COMHAIL ALBA

Project

 A95
 DUALLING
 INVERNESS TO NAIRN
 (incl. Nairn Bypass)

Drawing title
**DMRB STAGE 2
 INVERNESS TO GOLLANFIELD
 OPTION 1C PLAN & PROFILE
 CH 10500 TO CH 12000**

Drawing status
PRELIMINARY

Scale
 1:2,500 @ A1 DO NOT SCALE

Jacobs No.
 B1557601

Client no.

Drawing number
B1557601/MLA/1308

Rev
A

This drawing is not to be used in whole or part other than for the intended purpose and project as defined on this drawing. Refer to the contract for full terms and conditions.

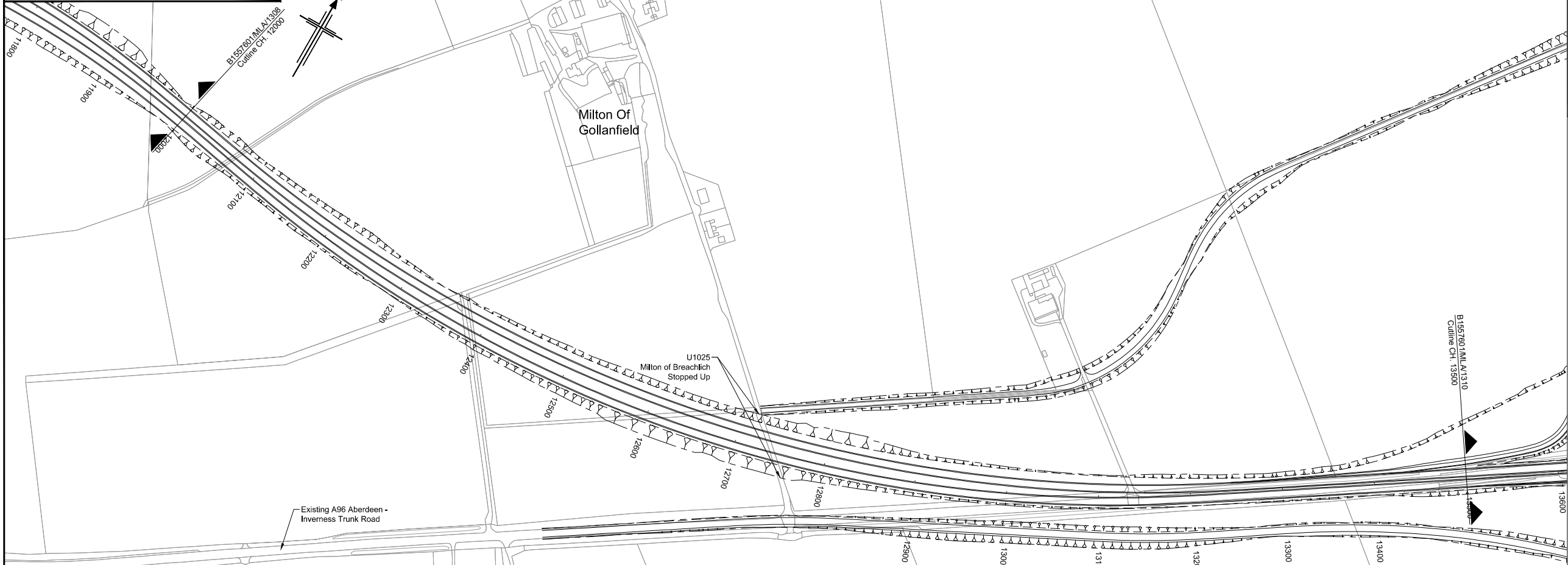

PLAN
 SCALE 1 : 2500

Reproduced by permission of Ordnance Survey on behalf of HMSO.
 © Crown copyright and database right 2014. All rights reserved.
 Ordnance Survey Licence number 100046668.

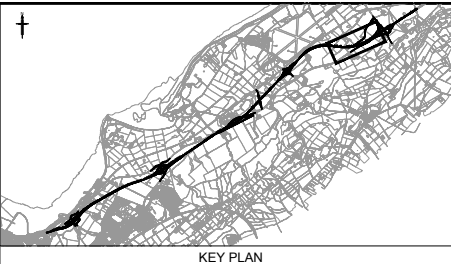

NOTES:
 1. All dimensions are in metres unless stated otherwise.

This OS Mastermap was obtained in March 2014 and is for illustration purposes only.

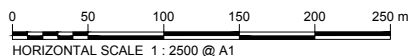
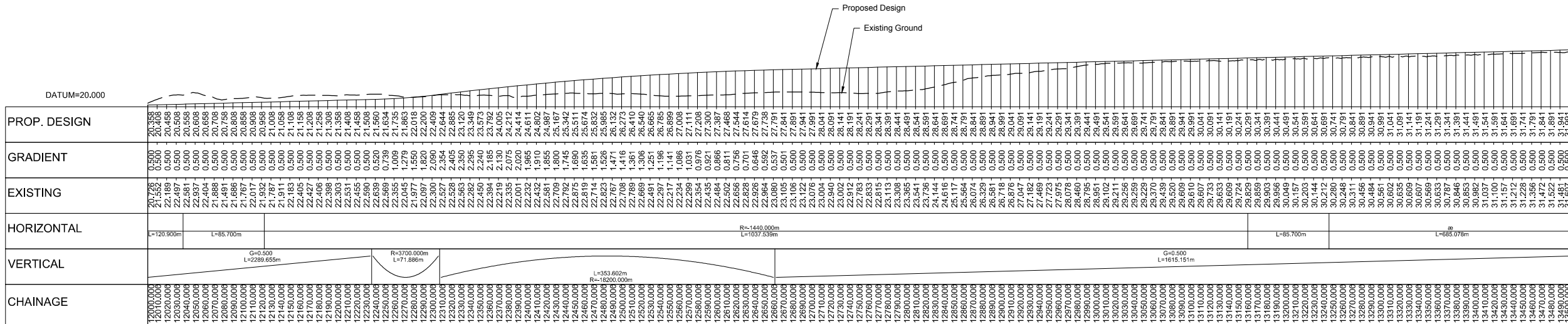

LONGITUDINAL SECTION (CHAINAGE 12000m TO 13500m)

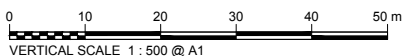

| | | | | | | |
|-----|-----------|---------------------|-------|---------|-------|---------|
| A | 08/09/14 | DMRB Stage 2 Report | DAD | CMM | GAH | EBH |
| Rev | Rev. Date | Purpose of revision | Drawn | Checked | Rev'd | Apprv'd |

JACOBS
 85 Bothwell St, Glasgow, G2 7HX
 Tel: +44(0)141 243 8000 Fax: +44(0)141 226 3109
 www.jacobs.com

Client

TRANSPORT SCOTLAND
 COMHAIL ALBA

Project

A96
 DUALLING
 INVERNESS TO NAIRN
 (incl. Main Bypass)

Drawing title
**DMRB STAGE 2
 INVERNESS TO GOLLANFIELD
 OPTION 1C PLAN & PROFILE
 CH 12000 TO CH 13500**

Drawing status
PRELIMINARY

Scale
 1:2,500 @ A1 DO NOT SCALE

Jacobs No.
 B1557601

Client no.

Drawing number
B1557601/MLA/1309

Rev
A

This drawing is not to be used in whole or part other than for the intended purpose and project as defined on this drawing. Refer to the contract for full terms and conditions.

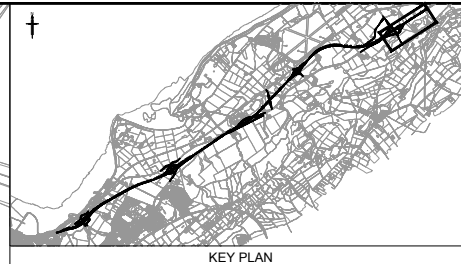
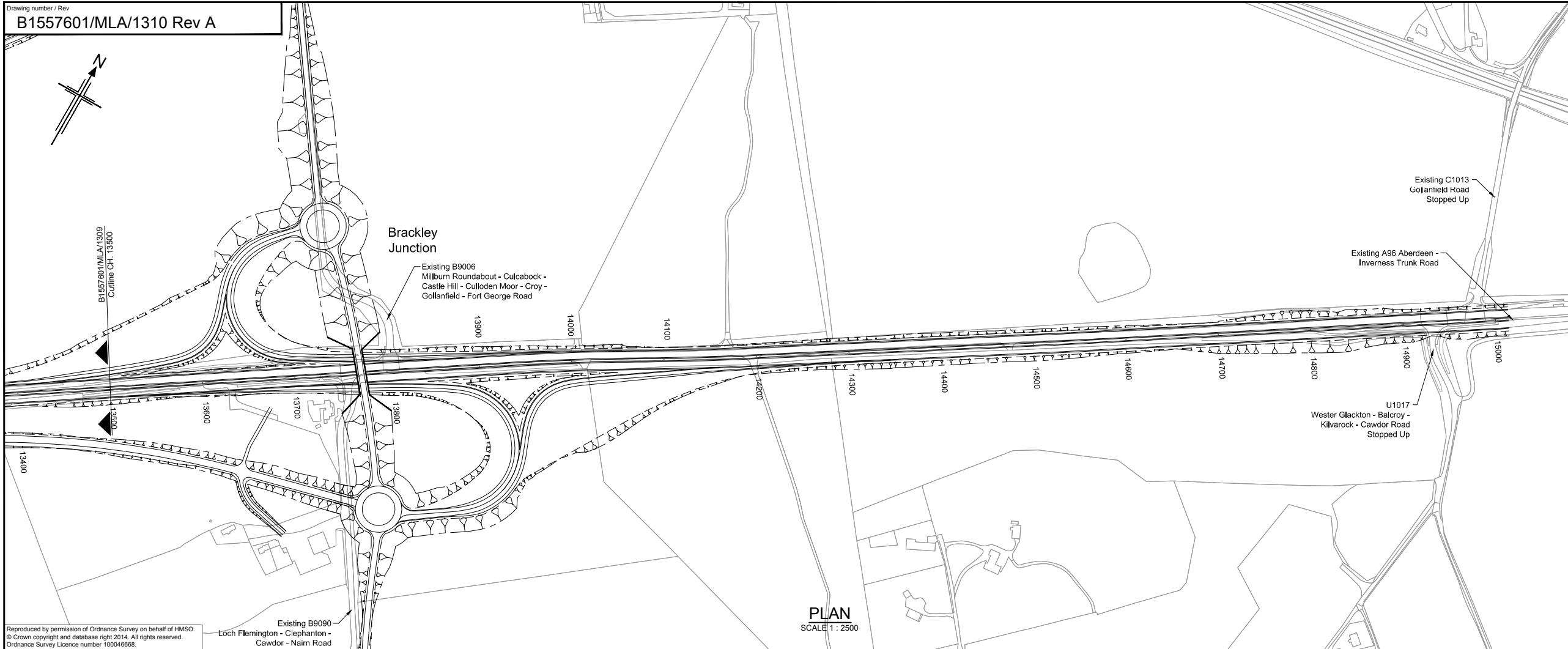
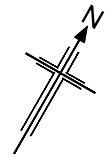

- NOTES:**
1. All dimensions are in metres unless stated otherwise.
 2. For Brackley Junction refer to drawing no. B1557601/MLA/1314.

Reproduced by permission of Ordnance Survey on behalf of HMSO.
 © Crown copyright and database right 2014. All rights reserved.
 Ordnance Survey Licence number 100046668.

This OS Mastermap was obtained in March 2014 and is for illustration purposes only.

| A | 08/09/14 | DMRB Stage 2 Report | DAD | CMM | GAH | EHB |
|-----|-----------|---------------------|-------|---------|-------|---------|
| Rev | Rev. Date | Purpose of revision | Drawn | Checked | Rev'd | Apprv'd |



| | PROPOSED DESIGN | GRADIENT | EXISTING | HORIZONTAL | VERTICAL | CHAINAGE |
|--------------|-----------------|----------|----------|------------|----------|-----------|
| DATUM=28.000 | 31.991 | 0.500 | 31.991 | | | 13540.000 |
| | 31.918 | 0.500 | 31.918 | | | 13550.000 |
| | 31.914 | 0.500 | 31.914 | | | 13560.000 |
| | 31.914 | 0.500 | 31.914 | | | 13570.000 |
| | 31.914 | 0.500 | 31.914 | | | 13580.000 |
| | 31.914 | 0.500 | 31.914 | | | 13590.000 |
| | 31.914 | 0.500 | 31.914 | | | 13600.000 |
| | 31.914 | 0.500 | 31.914 | | | 13610.000 |
| | 31.914 | 0.500 | 31.914 | | | 13620.000 |
| | 31.914 | 0.500 | 31.914 | | | 13630.000 |
| | 31.914 | 0.500 | 31.914 | | | 13640.000 |
| | 31.914 | 0.500 | 31.914 | | | 13650.000 |
| | 31.914 | 0.500 | 31.914 | | | 13660.000 |
| | 31.914 | 0.500 | 31.914 | | | 13670.000 |
| | 31.914 | 0.500 | 31.914 | | | 13680.000 |
| | 31.914 | 0.500 | 31.914 | | | 13690.000 |
| | 31.914 | 0.500 | 31.914 | | | 13700.000 |
| | 31.914 | 0.500 | 31.914 | | | 13710.000 |
| | 31.914 | 0.500 | 31.914 | | | 13720.000 |
| | 31.914 | 0.500 | 31.914 | | | 13730.000 |
| | 31.914 | 0.500 | 31.914 | | | 13740.000 |
| | 31.914 | 0.500 | 31.914 | | | 13750.000 |
| | 31.914 | 0.500 | 31.914 | | | 13760.000 |
| | 31.914 | 0.500 | 31.914 | | | 13770.000 |
| | 31.914 | 0.500 | 31.914 | | | 13780.000 |
| | 31.914 | 0.500 | 31.914 | | | 13790.000 |
| | 31.914 | 0.500 | 31.914 | | | 13800.000 |
| | 31.914 | 0.500 | 31.914 | | | 13810.000 |
| | 31.914 | 0.500 | 31.914 | | | 13820.000 |
| | 31.914 | 0.500 | 31.914 | | | 13830.000 |
| | 31.914 | 0.500 | 31.914 | | | 13840.000 |
| | 31.914 | 0.500 | 31.914 | | | 13850.000 |
| | 31.914 | 0.500 | 31.914 | | | 13860.000 |
| | 31.914 | 0.500 | 31.914 | | | 13870.000 |
| | 31.914 | 0.500 | 31.914 | | | 13880.000 |
| | 31.914 | 0.500 | 31.914 | | | 13890.000 |
| | 31.914 | 0.500 | 31.914 | | | 13900.000 |
| | 31.914 | 0.500 | 31.914 | | | 13910.000 |
| | 31.914 | 0.500 | 31.914 | | | 13920.000 |
| | 31.914 | 0.500 | 31.914 | | | 13930.000 |
| | 31.914 | 0.500 | 31.914 | | | 13940.000 |
| | 31.914 | 0.500 | 31.914 | | | 13950.000 |
| | 31.914 | 0.500 | 31.914 | | | 13960.000 |
| | 31.914 | 0.500 | 31.914 | | | 13970.000 |
| | 31.914 | 0.500 | 31.914 | | | 13980.000 |
| | 31.914 | 0.500 | 31.914 | | | 13990.000 |
| | 31.914 | 0.500 | 31.914 | | | 14000.000 |
| | 31.914 | 0.500 | 31.914 | | | 14010.000 |
| | 31.914 | 0.500 | 31.914 | | | 14020.000 |
| | 31.914 | 0.500 | 31.914 | | | 14030.000 |
| | 31.914 | 0.500 | 31.914 | | | 14040.000 |
| | 31.914 | 0.500 | 31.914 | | | 14050.000 |
| | 31.914 | 0.500 | 31.914 | | | 14060.000 |
| | 31.914 | 0.500 | 31.914 | | | 14070.000 |
| | 31.914 | 0.500 | 31.914 | | | 14080.000 |
| | 31.914 | 0.500 | 31.914 | | | 14090.000 |
| | 31.914 | 0.500 | 31.914 | | | 14100.000 |
| | 31.914 | 0.500 | 31.914 | | | 14110.000 |
| | 31.914 | 0.500 | 31.914 | | | 14120.000 |
| | 31.914 | 0.500 | 31.914 | | | 14130.000 |
| | 31.914 | 0.500 | 31.914 | | | 14140.000 |
| | 31.914 | 0.500 | 31.914 | | | 14150.000 |
| | 31.914 | 0.500 | 31.914 | | | 14160.000 |
| | 31.914 | 0.500 | 31.914 | | | 14170.000 |
| | 31.914 | 0.500 | 31.914 | | | 14180.000 |
| | 31.914 | 0.500 | 31.914 | | | 14190.000 |
| | 31.914 | 0.500 | 31.914 | | | 14200.000 |
| | 31.914 | 0.500 | 31.914 | | | 14210.000 |
| | 31.914 | 0.500 | 31.914 | | | 14220.000 |
| | 31.914 | 0.500 | 31.914 | | | 14230.000 |
| | 31.914 | 0.500 | 31.914 | | | 14240.000 |
| | 31.914 | 0.500 | 31.914 | | | 14250.000 |
| | 31.914 | 0.500 | 31.914 | | | 14260.000 |
| | 31.914 | 0.500 | 31.914 | | | 14270.000 |
| | 31.914 | 0.500 | 31.914 | | | 14280.000 |
| | 31.914 | 0.500 | 31.914 | | | 14290.000 |
| | 31.914 | 0.500 | 31.914 | | | 14300.000 |
| | 31.914 | 0.500 | 31.914 | | | 14310.000 |
| | 31.914 | 0.500 | 31.914 | | | 14320.000 |
| | 31.914 | 0.500 | 31.914 | | | 14330.000 |
| | 31.914 | 0.500 | 31.914 | | | 14340.000 |
| | 31.914 | 0.500 | 31.914 | | | 14350.000 |
| | 31.914 | 0.500 | 31.914 | | | 14360.000 |
| | 31.914 | 0.500 | 31.914 | | | 14370.000 |
| | 31.914 | 0.500 | 31.914 | | | 14380.000 |
| | 31.914 | 0.500 | 31.914 | | | 14390.000 |
| | 31.914 | 0.500 | 31.914 | | | 14400.000 |
| | 31.914 | 0.500 | 31.914 | | | 14410.000 |
| | 31.914 | 0.500 | 31.914 | | | 14420.000 |
| | 31.914 | 0.500 | 31.914 | | | 14430.000 |
| | 31.914 | 0.500 | 31.914 | | | 14440.000 |
| | 31.914 | 0.500 | 31.914 | | | 14450.000 |
| | 31.914 | 0.500 | 31.914 | | | 14460.000 |
| | 31.914 | 0.500 | 31.914 | | | 14470.000 |
| | 31.914 | 0.500 | 31.914 | | | 14480.000 |
| | 31.914 | 0.500 | 31.914 | | | 14490.000 |
| | 31.914 | 0.500 | 31.914 | | | 14500.000 |
| | 31.914 | 0.500 | 31.914 | | | 14510.000 |
| | 31.914 | 0.500 | 31.914 | | | 14520.000 |
| | 31.914 | 0.500 | 31.914 | | | 14530.000 |
| | 31.914 | 0.500 | 31.914 | | | 14540.000 |
| | 31.914 | 0.500 | 31.914 | | | 14550.000 |
| | 31.914 | 0.500 | 31.914 | | | 14560.000 |
| | 31.914 | 0.500 | 31.914 | | | 14570.000 |
| | 31.914 | 0.500 | 31.914 | | | 14580.000 |
| | 31.914 | 0.500 | 31.914 | | | 14590.000 |
| | 31.914 | 0.500 | 31.914 | | | 14600.000 |
| | 31.914 | 0.500 | 31.914 | | | 14610.000 |
| | 31.914 | 0.500 | 31.914 | | | 14620.000 |
| | 31.914 | 0.500 | 31.914 | | | 14630.000 |
| | 31.914 | 0.500 | 31.914 | | | 14640.000 |
| | 31.914 | 0.500 | 31.914 | | | 14650.000 |
| | 31.914 | 0.500 | 31.914 | | | 14660.000 |
| | 31.914 | 0.500 | 31.914 | | | 14670.000 |
| | 31.914 | 0.500 | 31.914 | | | 14680.000 |
| | 31.914 | 0.500 | 31.914 | | | 14690.000 |
| | 31.914 | 0.500 | 31.914 | | | 14700.000 |
| | 31.914 | 0.500 | 31.914 | | | 14710.000 |
| | 31.914 | 0.500 | 31.914 | | | 14720.000 |
| | 31.914 | 0.500 | 31.914 | | | 14730.000 |
| | 31.914 | 0.500 | 31.914 | | | 14740.000 |
| | 31.914 | 0.500 | 31.914 | | | 14750.000 |
| | 31.914 | 0.500 | 31.914 | | | 14760.000 |
| | 31.914 | 0.500 | 31.914 | | | 14770.000 |
| | 31.914 | 0.500 | 31.914 | | | 14780.000 |
| | 31.914 | 0.500 | 31.914 | | | 14790.000 |
| | 31.914 | 0.500 | 31.914 | | | 14800.000 |
| | 31.914 | 0.500 | 31.914 | | | 14810.000 |
| | 31.914 | 0.500 | 31.914 | | | 14820.000 |
| | 31.914 | 0.500 | 31.914 | | | 14830.000 |
| | 31.914 | 0.500 | 31.914 | | | 14840.000 |
| | 31.914 | 0.500 | 31.914 | | | 14850.000 |
| | 31.914 | 0.500 | 31.914 | | | 14860.000 |
| | 31.914 | 0.500 | 31.914 | | | 14870.000 |
| | 31.914 | 0.500 | 31.914 | | | 14880.000 |
| | 31.914 | 0.500 | 31.914 | | | 14890.000 |
| | 31.914 | 0.500 | 31.914 | | | 14900.000 |
| | 31.914 | 0.500 | 31.914 | | | 14910.000 |
| | 31.914 | 0.500 | 31.914 | | | 14920.000 |
| | 31.914 | 0.500 | 31.914 | | | 14930.000 |
| | 31.914 | 0.500 | 31.914 | | | 14940.000 |
| | 31.914 | 0.500 | 31.914 | | | 14950.000 |
| | 31.914 | 0.500 | 31.914 | | | 14960.000 |
| | 31.914 | 0.500 | 31.914 | | | 14970.000 |
| | 31.914 | 0.500 | 31.914 | | | 14980.000 |
| | 31.914 | 0.500 | 31.914 | | | 14990.000 |
| | 31.914 | 0.500 | 31.914 | | | 15000.000 |

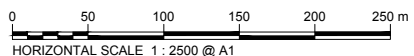

LONGITUDINAL SECTION (CHAINAGE 13500m TO 14954.52m)

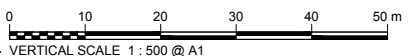

Drawing title
**DMRB STAGE 2
 INVERNESS TO GOLLANFIELD
 OPTION 1C PLAN & PROFILE
 CH 13500 TO CH 15014.167**

Drawing status
PRELIMINARY

Scale
 1:2,500 @ A1 DO NOT SCALE

Jacobs No. B1557601

Drawing number
B1557601/MLA/1310

Rev
A

This drawing is not to be used in whole or part other than for the intended purpose and project as defined on this drawing. Refer to the contract for full terms and conditions.

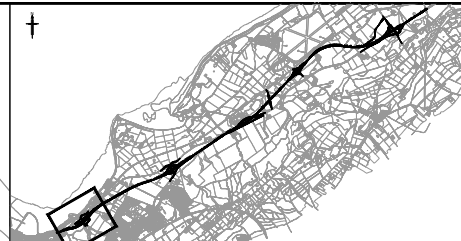
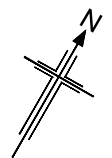

NOTES:
 1. All dimensions are in metres unless stated otherwise.

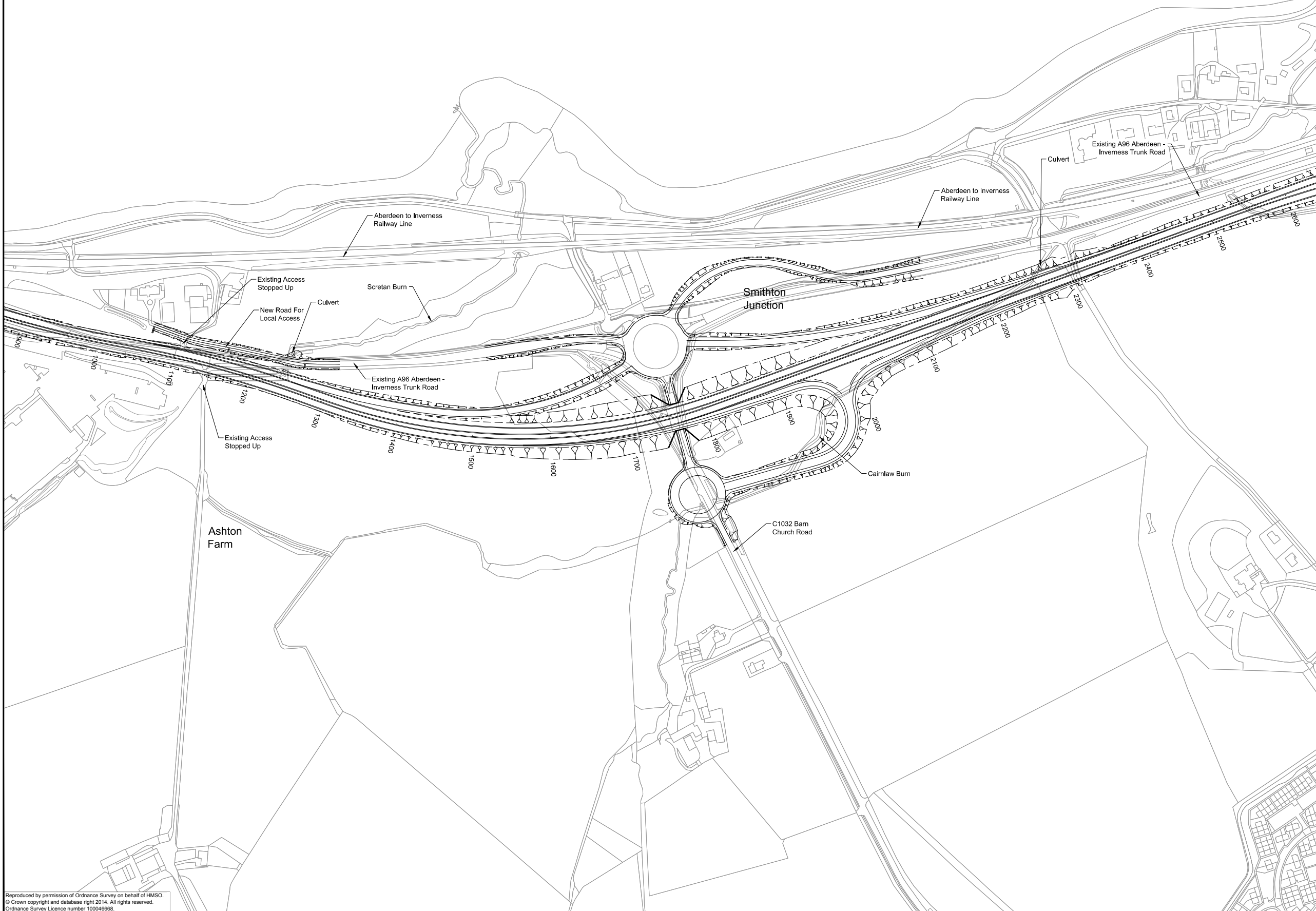

This OS Mastermap was obtained in March 2014 and is for illustration purposes only.

| Rev | Rev. Date | Purpose of revision | Drawn | Checked | Rev'd | Apprv'd |
|-----|-----------|---------------------|-------|---------|-------|---------|
| A | 08/09/14 | DMRB Stage 2 Report | DAD | CMM | GAH | EHB |

JACOBS
 85 Bothwell St, Glasgow, G2 7HX
 Tel: +44(0)141 243 8000 Fax: +44(0)141 226 3109
 www.jacobs.com



A96
DUALLING
 INVERNESS TO NAIRN
 (incl. Nairn Bypass)

Drawing title
**DMRB STAGE 2
 INVERNESS TO GOLLANFIELD
 SMITHTON JUNCTION
 OPTION 1C**

Drawing status
PRELIMINARY

Scale
 1:2,500 @ A1 **DO NOT SCALE**

Jacobs No. B1557601

Drawing number
B1557601/MLA/1311 Rev **A**

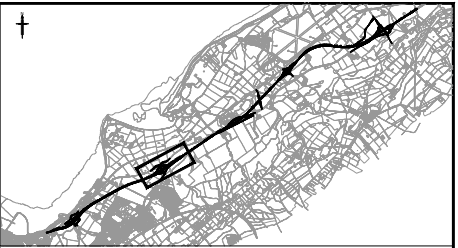
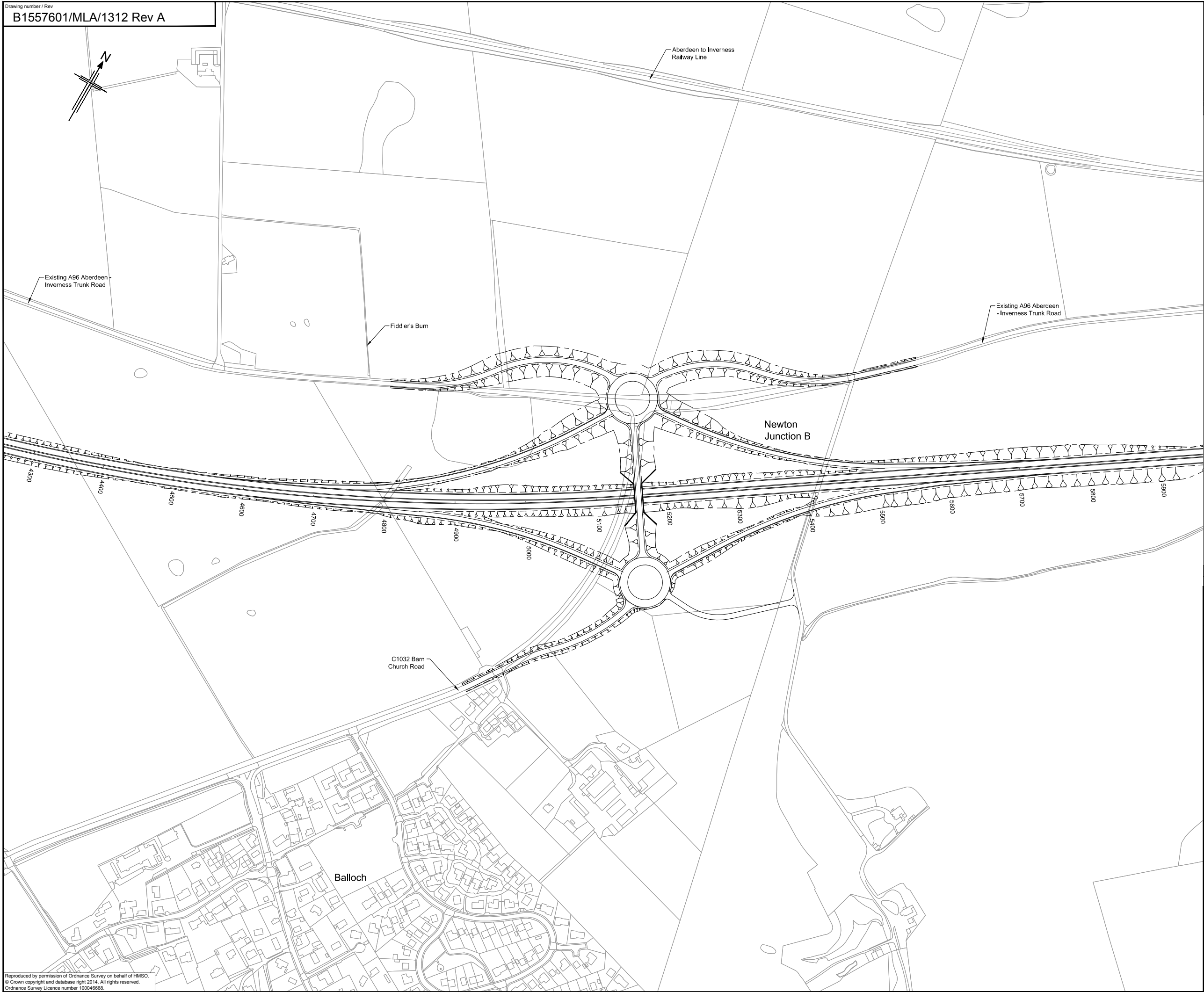

NOTES:
 1. All dimensions are in metres unless stated otherwise.

This OS Mastermap was obtained in March 2014 and is for illustration purposes only.

| | | | | | | |
|-----|-----------|---------------------|-------|---------|-------|---------|
| A | 08/09/14 | DMRB Stage 2 Report | DAD | CMM | GAH | EHB |
| Rev | Rev. Date | Purpose of revision | Drawn | Checked | Rev'd | Apprv'd |

JACOBS
 85 Bothwell St, Glasgow, G2 7HX
 Tel: +44(0)141 243 8000 Fax: +44(0)141 226 3109
 www.jacobs.com

Client

Project

Drawing title
**DMRB STAGE 2
 INVERNESS TO GOLLANFIELD
 NEWTON JUNCTION B
 OPTION 1C**

Drawing status
PRELIMINARY

Scale
 1:2,500 @ A1 **DO NOT SCALE**

Jacobs No. B1557601

Drawing number
B1557601/MLA/1312 Rev **A**

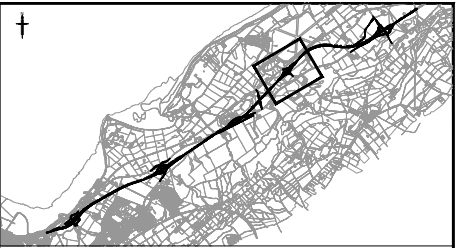
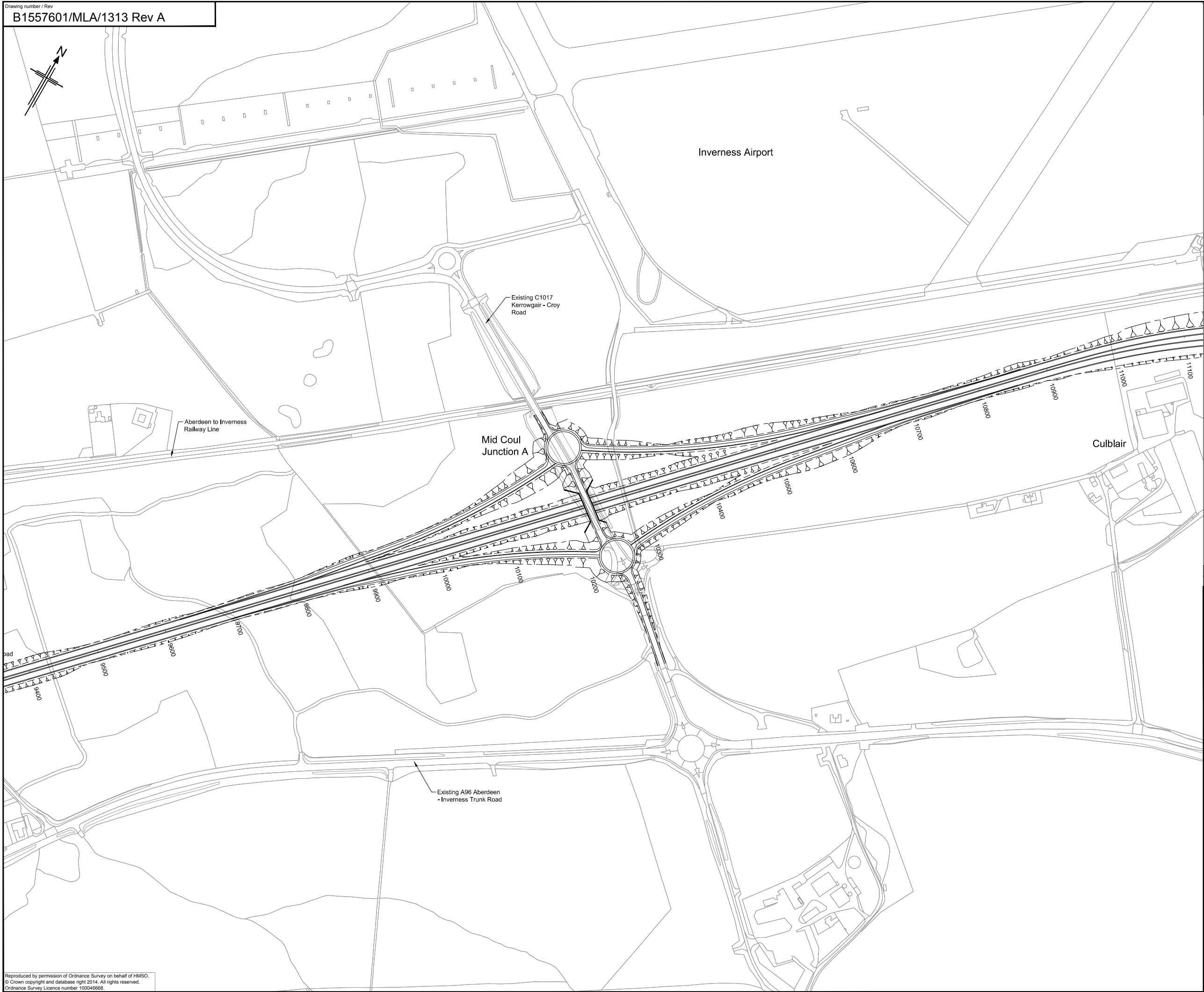
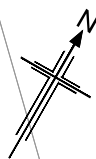

NOTES:
 1. All dimensions are in metres unless stated otherwise.

This OS Mastermap was obtained in March 2014 and is for illustration purposes only.

| | | | | | | |
|-----|-----------|---------------------|-------|---------|-------|---------|
| A | 08/09/14 | DMRB Stage 2 Report | DAD | CMM | GAH | EHB |
| Rev | Rev. Date | Purpose of revision | Drawn | Checked | Rev'd | Apprv'd |

JACOBS
 85 Bothwell St, Glasgow, G2 7HX
 Tel: +44(0)141 243 8000 Fax: +44(0)141 226 3109
 www.jacobs.com

Client

TRANSPORT SCOTLAND
 COMH-DHAL ALBA

Project

A96
DUALLING
 INVERNESS TO NAIRN
 (incl. Nairn Bypass)

Drawing title
**DMRB STAGE 2
 INVERNESS TO GOLLANFIELD
 MID COUL JUNCTION A
 OPTION 1C**

Drawing status
PRELIMINARY

Scale
 1:2,500 @ A1 **DO NOT SCALE**

Jacobs No. B1557601

Drawing number
B1557601/MLA/1313

Rev
A

Reproduced by permission of Ordnance Survey on behalf of HMSO.
 © Crown copyright and database right 2014. All rights reserved.
 Ordnance Survey Licence number 100046668.

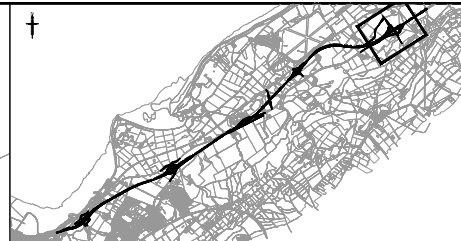
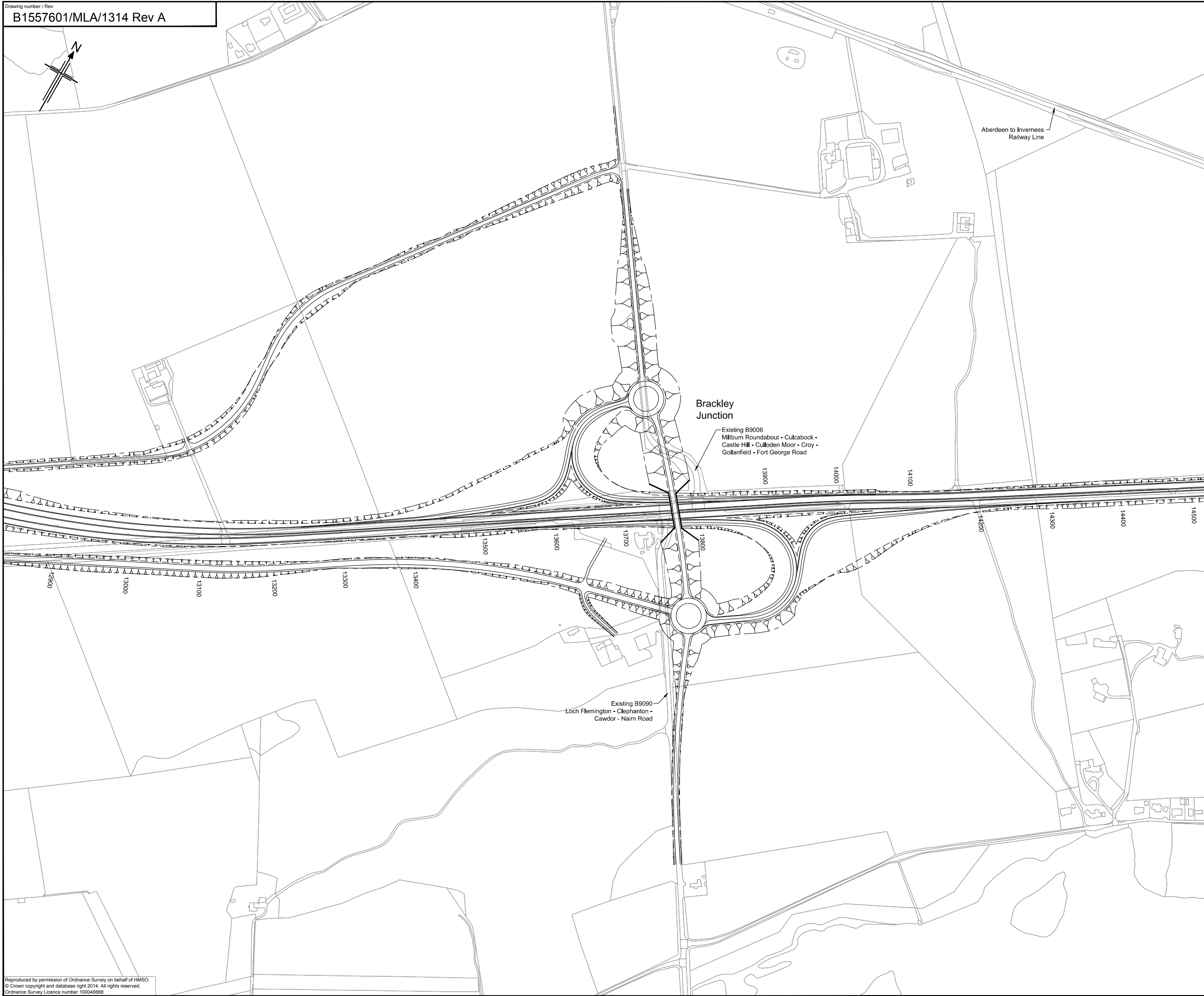

NOTES:
 1. All dimensions are in metres unless stated otherwise.

This OS Mastermap was obtained in March 2014 and is for illustration purposes only.

| | | | | | | |
|-----|-----------|---------------------|-------|---------|-------|---------|
| A | 08/09/14 | DMRB Stage 2 Report | DAD | CMM | GAH | EHB |
| Rev | Rev. Date | Purpose of revision | Drawn | Checked | Rev'd | Apprv'd |

JACOBS
 85 Bothwell St, Glasgow, G2 7HX
 Tel: +44(0)141 243 8000 Fax: +44(0)141 226 3109
 www.jacobs.com

Client

Project

Drawing title
**DMRB STAGE 2
 INVERNESS TO GOLLANFIELD
 BRACKLEY JUNCTION
 OPTION 1C**

Drawing status
PRELIMINARY

| | | |
|------------|--------------|--------------|
| Scale | 1:2,500 @ A1 | DO NOT SCALE |
| Jacobs No. | B1557601 | |
| Client no. | | |

| | |
|--------------------------|----------|
| Drawing number | Rev |
| B1557601/MLA/1314 | A |

Reproduced by permission of Ordnance Survey on behalf of HMSO.
 © Crown copyright and database right 2014. All rights reserved.
 Ordnance Survey Licence number 100046668.

This drawing is not to be used in whole or part other than for the intended purpose and project as defined on this drawing. Refer to the contract for full terms and conditions.