

Reproduced by permission of Ordnance Survey on behalf of HMSO.  
 © Crown copyright and database right 2014. All rights reserved.  
 Ordnance Survey Licence number 100046668.

**NOTES:**  
 1. All dimensions are in metres unless stated otherwise.

This OS Mastermap was obtained in March 2014 and is for illustration purposes only.

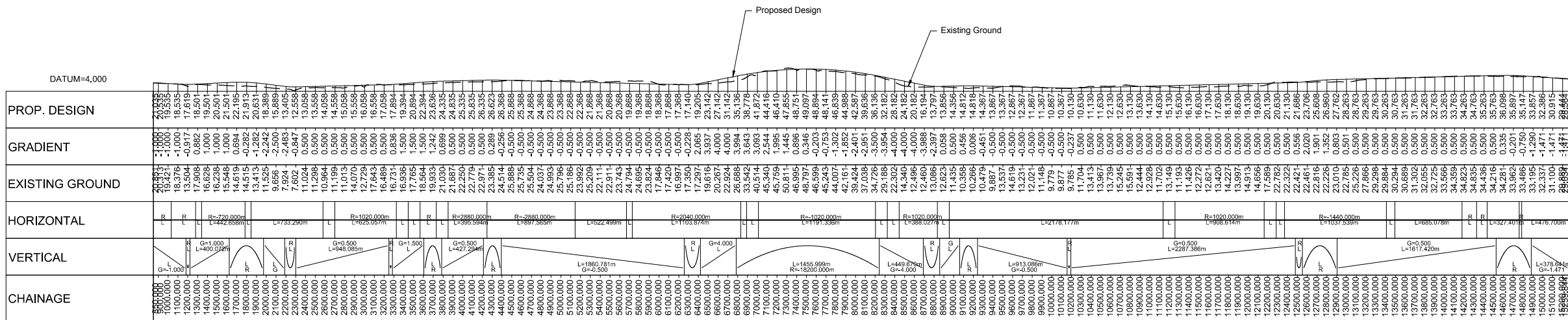

**LONGITUDINAL SECTION (CHAINAGE 850m TO 15259.84m)**



A	08/09/14	DMRB Stage 2 Report	DAD	CMM	GAH	EHB
Rev	Rev. Date	Purpose of revision	Drawn	Checked	Rev'd	Apprv'd



Drawing title  
**DMRB STAGE 2  
 INVERNESS TO GOLLANFIELD  
 OPTION 1C(MV) PLAN & PROFILE  
 CH 850 TO CH 15259.84**

Drawing status  
**PRELIMINARY**

Scale	AS SHOWN @ A1	DO NOT SCALE
JACOBS No.	B1557601	
Client no.		

Drawing number	<b>B1557601/MLA/1320</b>	Rev	<b>A</b>
----------------	--------------------------	-----	----------

This drawing is not to be used in whole or part other than for the intended purpose and project as defined on this drawing. Refer to the contract for full terms and conditions.

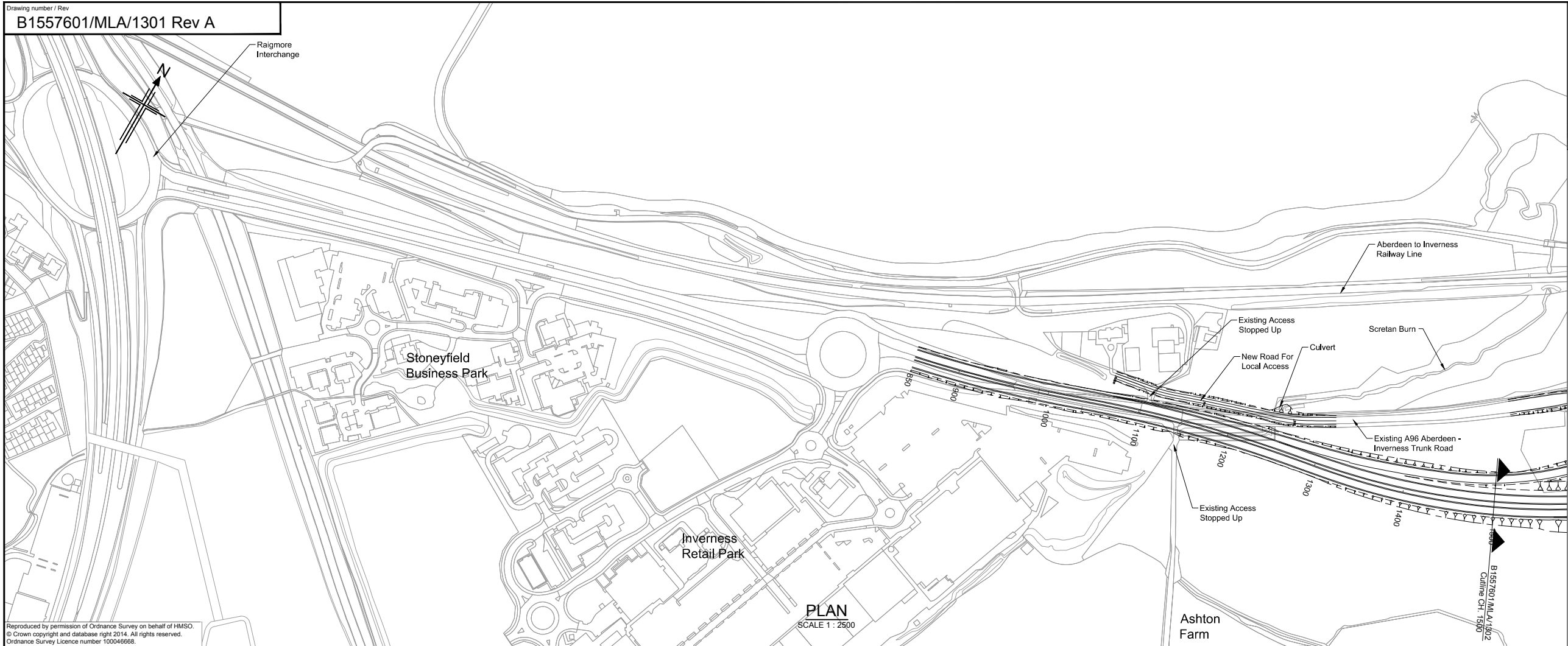

Reproduced by permission of Ordnance Survey on behalf of HMSO.  
 © Crown copyright and database right 2014. All rights reserved.  
 Ordnance Survey Licence number 100046668.

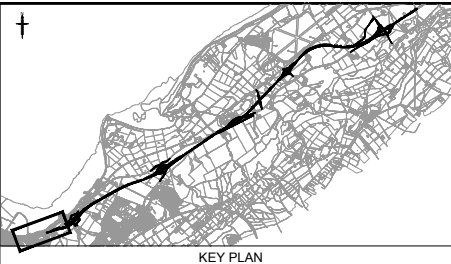

NOTES:  
 1. All dimensions are in metres unless stated otherwise.

This OS Mastermap was obtained in March 2014 and is for illustration purposes only.

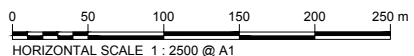
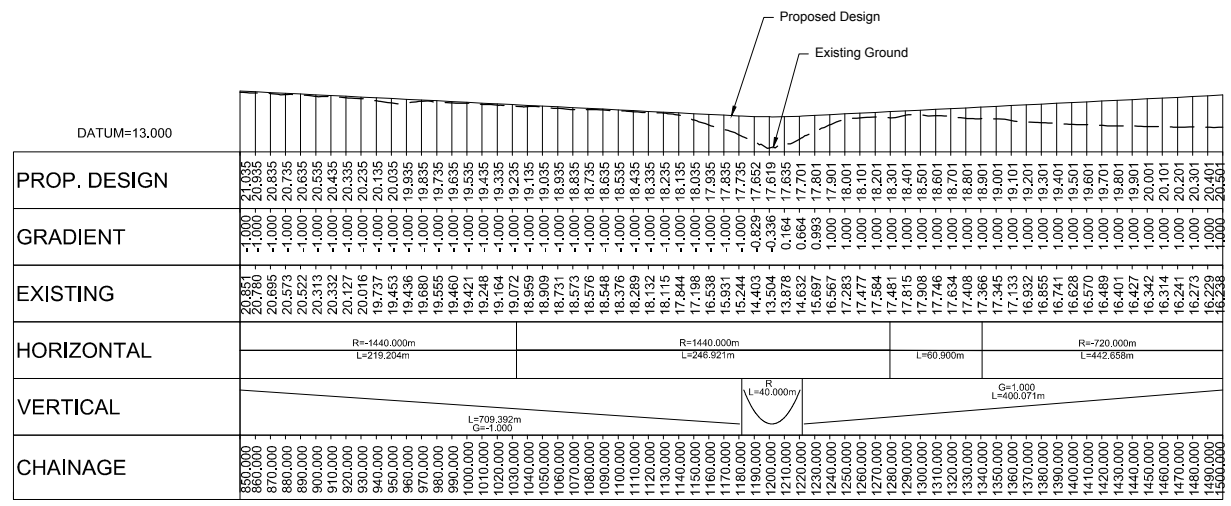

LONGITUDINAL SECTION (CHAINAGE 850m TO 1500m)

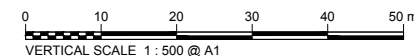

A	08/09/14	DMRB Stage 2 Report	DAD	CMM	GAH	EHB
Rev	Rev. Date	Purpose of revision	Drawn	Checked	Rev'd	Appr'd



95 Bothwell St, Glasgow, G2 7HX  
 Tel: +44(0)141 243 8000 Fax: +44(0)141 226 3109  
 www.jacobs.com



Drawing title  
**DMRB STAGE 2  
 INVERNESS TO GOLLANFIELD  
 OPTION 1C PLAN & PROFILE  
 CH 850 TO CH 1500**

Drawing status  
**PRELIMINARY**

Scale  
 1:2,500 @ A1      DO NOT SCALE

Jacobs No. B1557601

Drawing number  
**B1557601/MLA/1301**

Rev  
**A**  
 This drawing is not to be used in whole or part other than for the intended purpose and project as defined on this drawing. Refer to the contract for full terms and conditions.



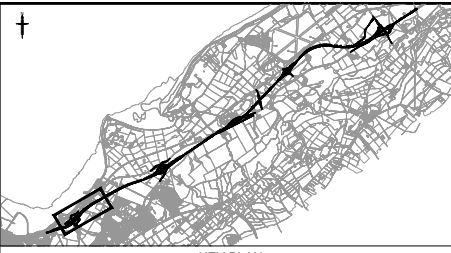
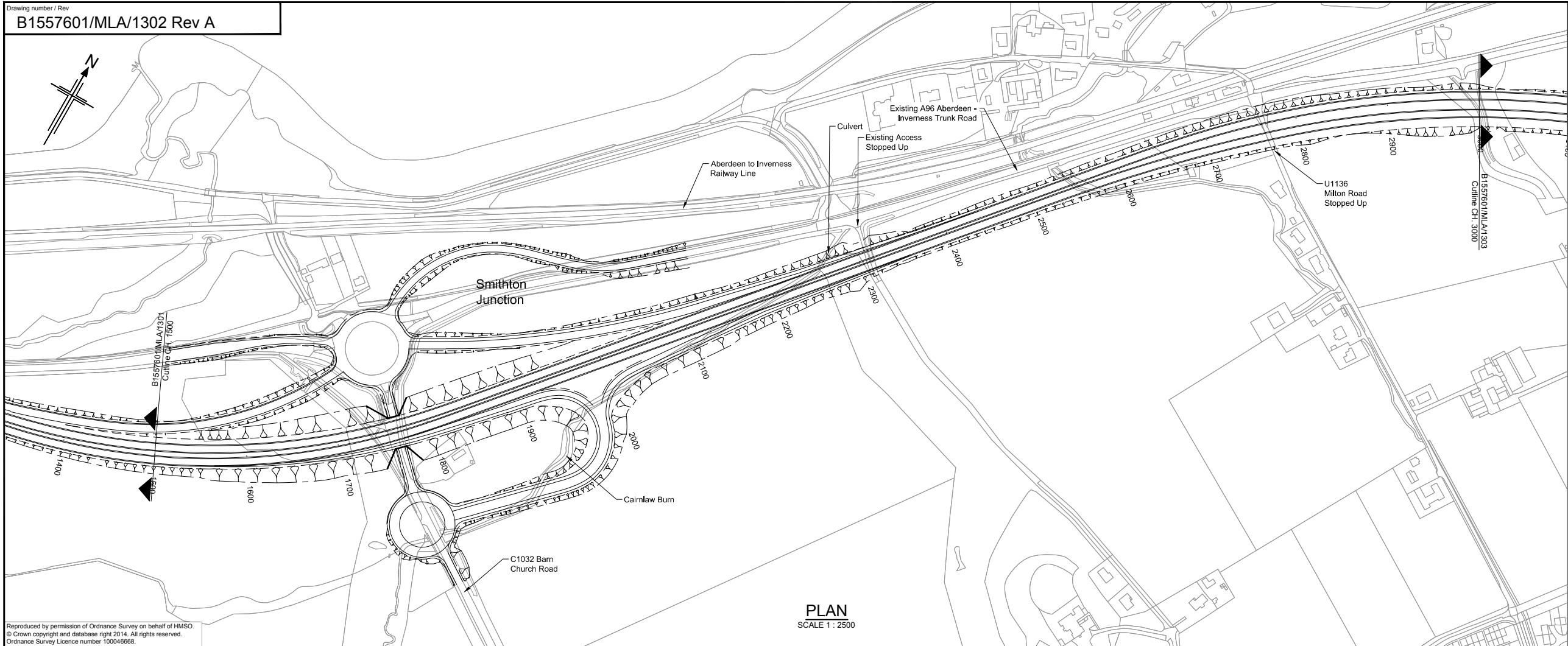

- NOTES:**
- All dimensions are in metres unless stated otherwise.
  - For Smithton Junction refer to drawing no. B155760/MLA/1311.

Reproduced by permission of Ordnance Survey on behalf of HMSO.  
 © Crown copyright and database right 2014. All rights reserved.  
 Ordnance Survey Licence number 100046668.

This OS Mastermap was obtained in March 2014 and is for illustration purposes only.

**PLAN**  
 SCALE 1 : 2500

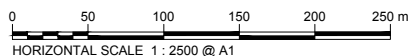
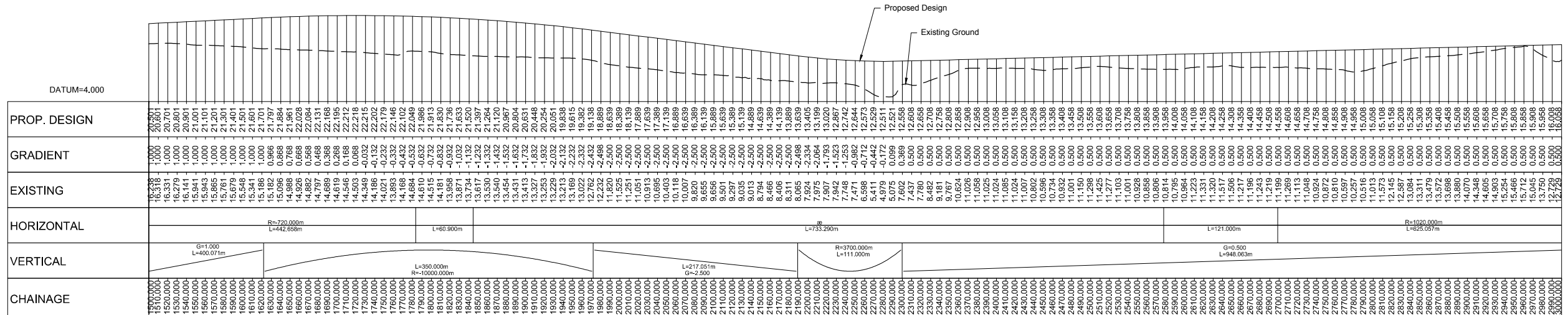

**LONGITUDINAL SECTION (CHAINAGE 1500m TO 3000m)**

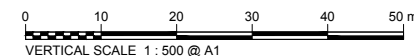

A	08/09/14	DMRB Stage 2 Report	DAD	CMM	GAH	EHB
Rev	Rev. Date	Purpose of revision	Drawn	Checked	Rev'd	Apprv'd

**JACOBS**  
 85 Bothwell St, Glasgow, G2 7HX  
 Tel: +44(0)141 243 8000 Fax: +44(0)141 226 3109  
 www.jacobs.com

Client

TRANSPORT SCOTLAND  
 COMHAIL ALBA

Project

**A96**  
 DUALLING  
 INVERNESS TO NAIRN  
 (incl. Milton Dyppan)

Drawing title  
**DMRB STAGE 2  
 INVERNESS TO GOLLANFIELD  
 OPTION 1C PLAN & PROFILE  
 CH 1500 TO CH 3000**

Drawing status  
**PRELIMINARY**

Scale  
 1:2,500 @ A1      DO NOT SCALE

Jacobs No. B1557601  
 Client no.

Drawing number  
**B1557601/MLA/1302**      Rev **A**

This drawing is not to be used in whole or part other than for the intended purpose and project as defined on this drawing. Refer to the contract for full terms and conditions.





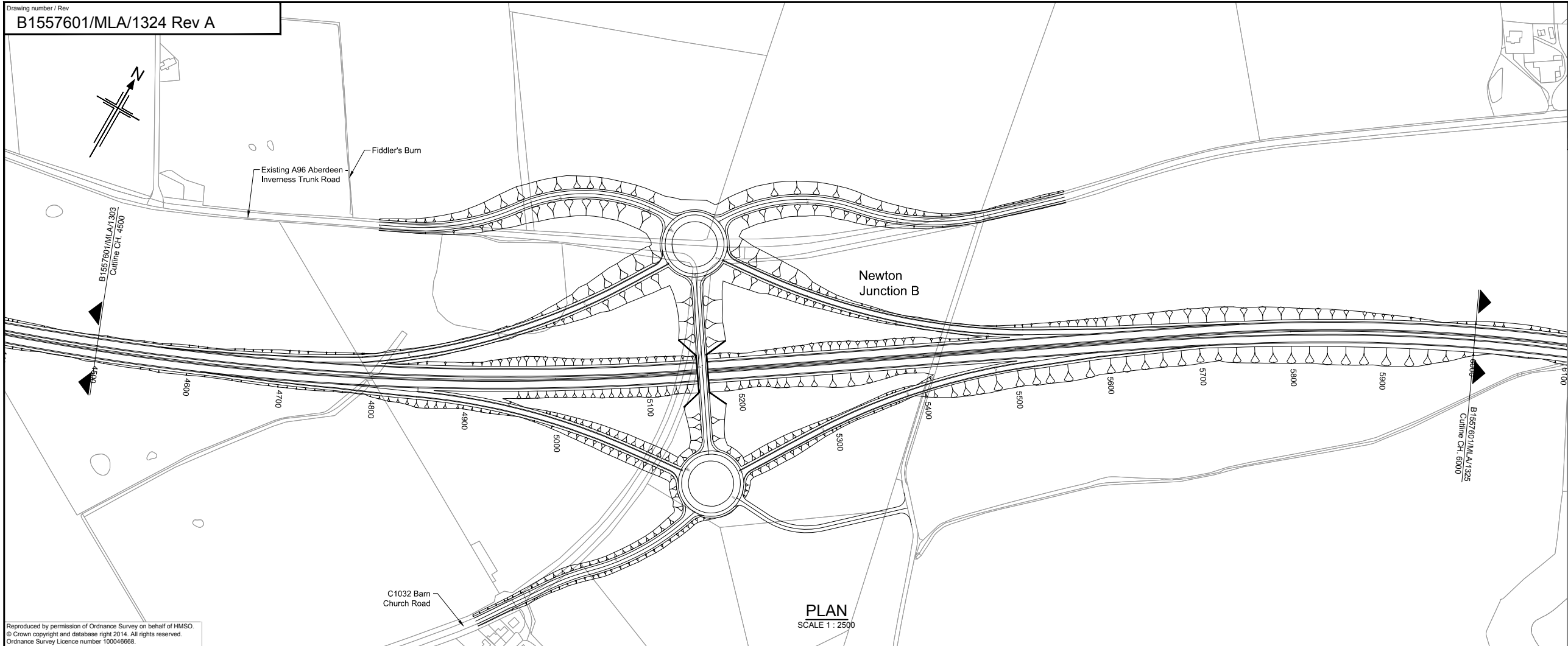

**PLAN**  
 SCALE 1 : 2500

Reproduced by permission of Ordnance Survey on behalf of HMSO.  
 © Crown copyright and database right 2014. All rights reserved.  
 Ordnance Survey Licence number 100046668.

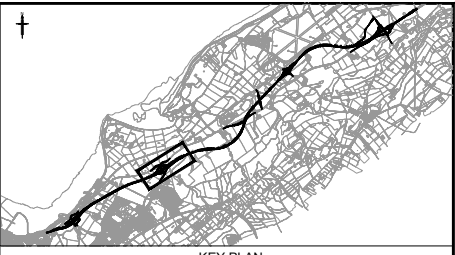

- NOTES:**
- All dimensions are in metres unless stated otherwise.
  - For Newton Junction refer to drawing no. B1557601/MLA/1327.

This OS Mastermap was obtained in March 2014 and is for illustration purposes only.

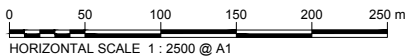
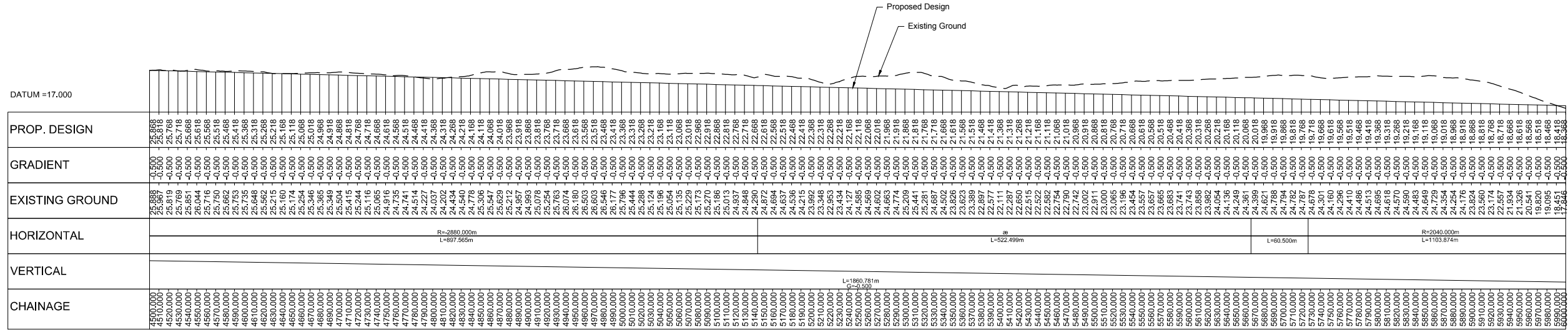

**LONGITUDINAL SECTION (CHAINAGE 4500m TO 6000m)**

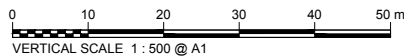

A	08/09/14	DMRB Stage 2 Report	DAD	CMM	GAH	EHB
Rev	Rev. Date	Purpose of revision	Drawn	Checked	Rev'd	Apprv'd



**DMRB STAGE 2  
 INVERNESS TO GOLLANFIELD  
 OPTION 1C (MV) PLAN & PROFILE  
 CH 4500 TO CH 6000**

Drawing status: **PRELIMINARY**

Scale: 1:2,500 @ A1 | DO NOT SCALE

Drawing number: **B1557601/MLA/1324** | Rev: **A**

This drawing is not to be used in whole or part other than for the intended purpose and project as defined on this drawing. Refer to the contract for full terms and conditions.

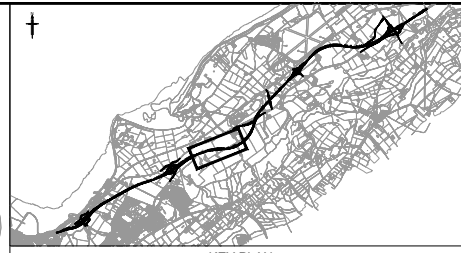
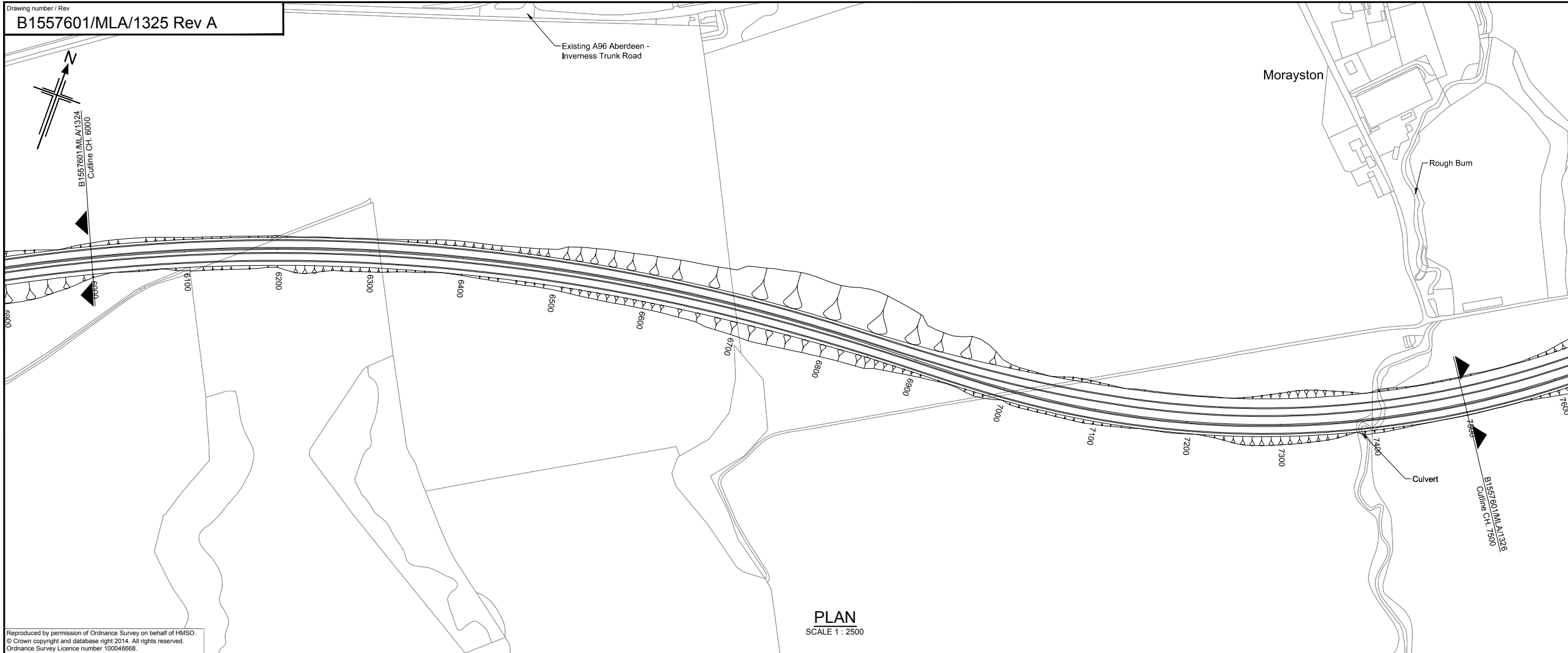

NOTES:  
 1. All dimensions are in metres unless stated otherwise.

Reproduced by permission of Ordnance Survey on behalf of HMSO.  
 © Crown copyright and database right 2014. All rights reserved.  
 Ordnance Survey Licence number 100046668.

This OS Mastermap was obtained in March 2014 and is for illustration purposes only.

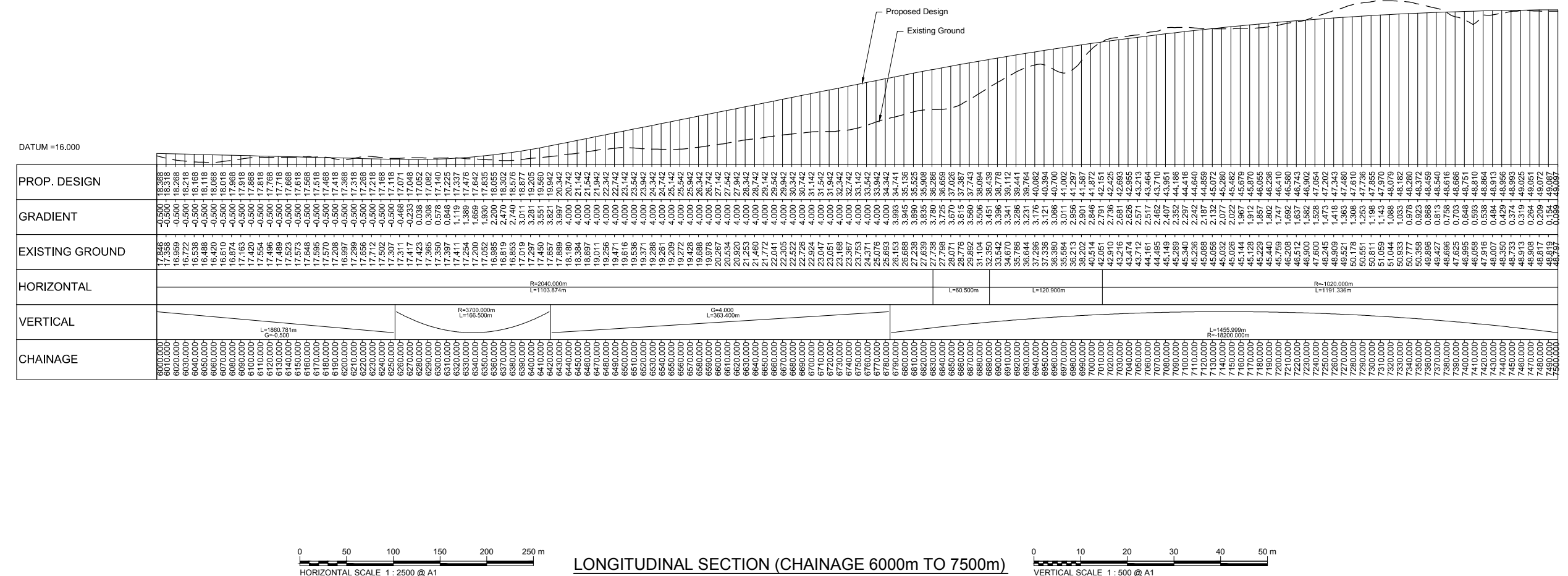

A	08/09/14	DMRB Stage 2 Report	DAD	CMM	GAH	EBH
Rev	Rev. Date	Purpose of revision	Drawn	Checked	Rev'd	Apprv'd

**JACOBS**  
 85 Bothwell St, Glasgow, G2 7HX  
 Tel: +44(0)141 243 8000 Fax: +44(0)141 226 3109  
 www.jacobs.com

Client

TRANSPORT SCOTLAND  
 COMHAIL ALBA

Project

A96  
 DUALLING  
 INVERNESS TO NAIRN  
 (incl. Malm-Byggnad)

Drawing title  
**DMRB STAGE 2  
 INVERNESS TO GOLLANFIELD  
 OPTION 1C (MV) PLAN & PROFILE  
 CH 6000 TO CH 7500**

Drawing status  
**PRELIMINARY**

Scale  
 1:2,500 @ A1      DO NOT SCALE

Jacobs No. B1557601  
 Client no.

Drawing number  
**B1557601/MLA/1325**      Rev  
**A**

This drawing is not to be used in whole or part other than for the intended purpose and project as defined on this drawing. Refer to the contract for full terms and conditions.



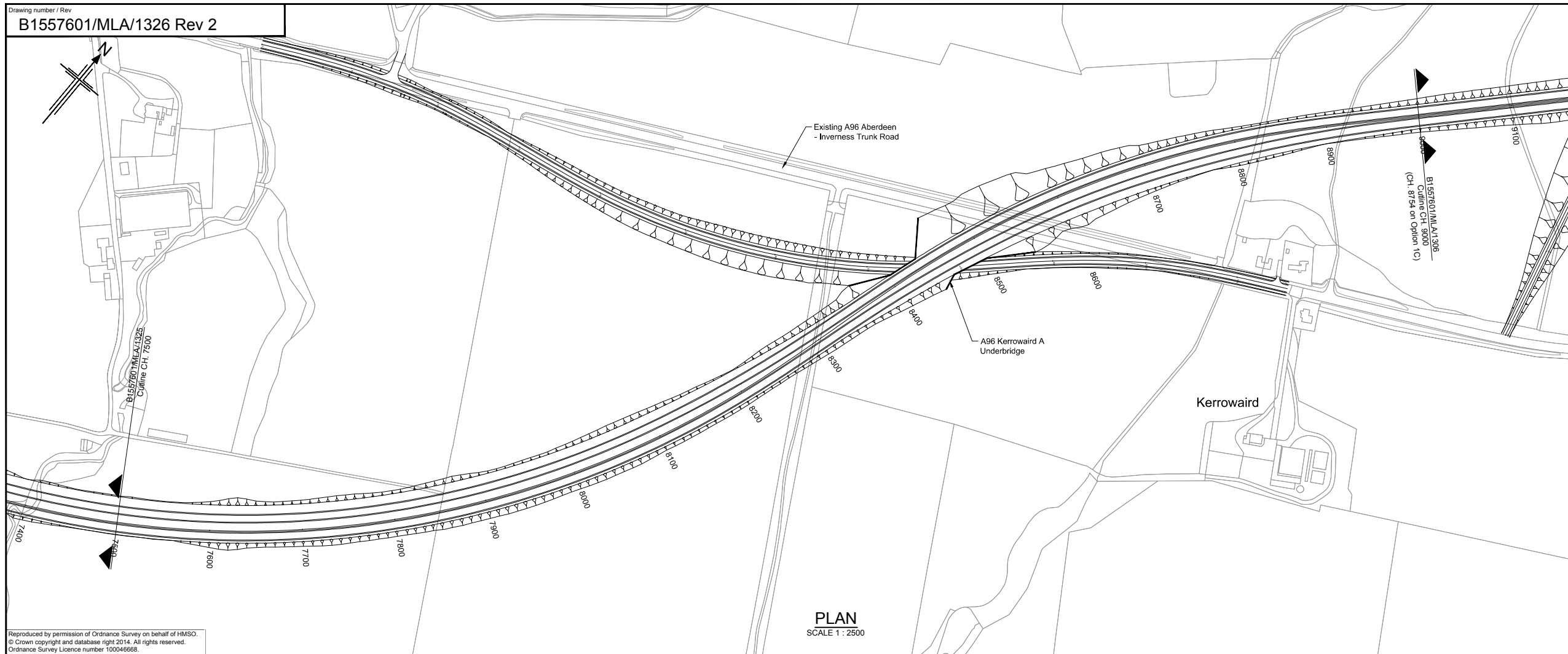

NOTES:  
 1. All dimensions are in metres unless stated otherwise.

Reproduced by permission of Ordnance Survey on behalf of HMSO.  
 © Crown copyright and database right 2014. All rights reserved.  
 Ordnance Survey Licence number 100046668.

This OS Mastermap was obtained in March 2014 and is for illustration purposes only.

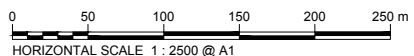
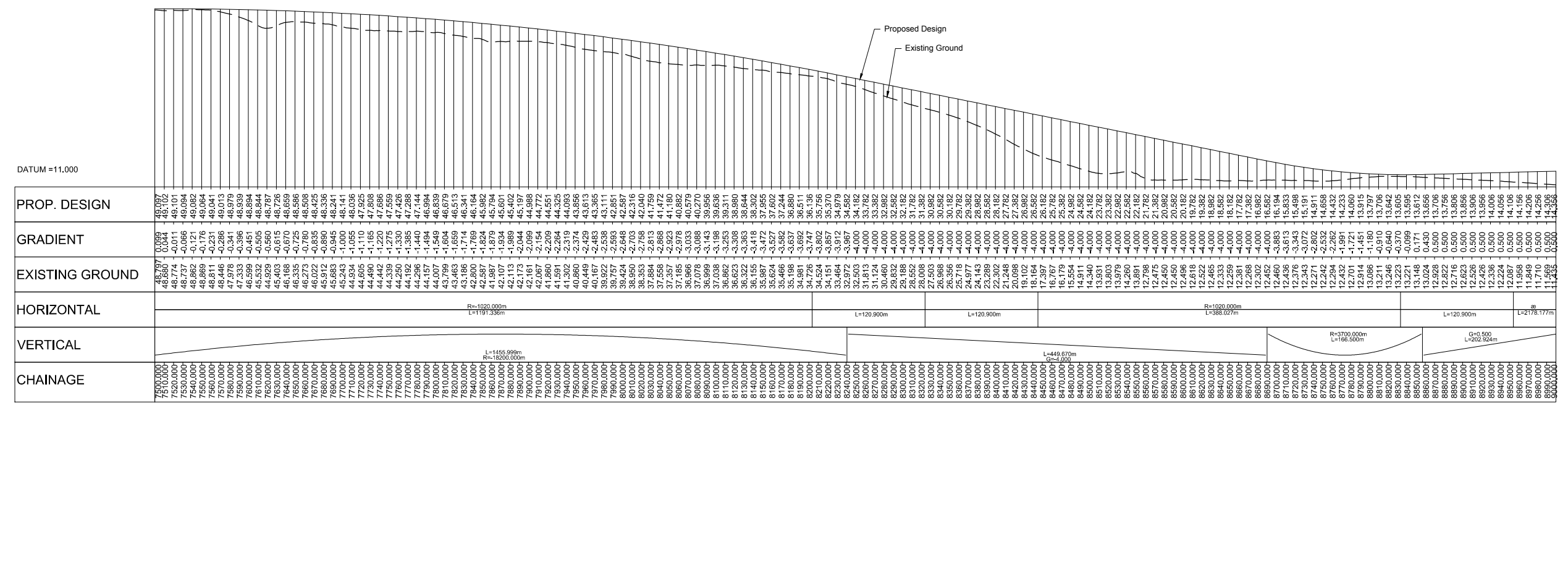

LONGITUDINAL SECTION (CHAINAGE 7500m to 9000m)

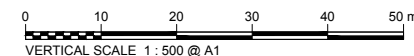

A	08/09/14	DMRB Stage 2 Report	DAD	CMM	GAH	EHB
Rev	Rev. Date	Purpose of revision	Drawn	Checked	Rev'd	Appr'd

**JACOBS**  
 85 Bothwell St, Glasgow, G2 7HX  
 Tel: +44(0)141 243 8000 Fax: +44(0)141 226 3109  
 www.jacobs.com

Client

TRANSPORT SCOTLAND  
 COMHAIL ALBA

Project

A96  
 DUALLING  
 INVERNESS TO NAIRN  
 (incl. Nairn Bypass)

Drawing title  
**DMRB STAGE 2  
 INVERNESS TO GOLLANFIELD  
 OPTION 1C (MV) PLAN & PROFILE  
 CH 7500 TO CH 9000**

Drawing status  
**PRELIMINARY**

Scale  
 1:2,500 @ A1      DO NOT SCALE

Jacobs No. B1557601  
 Client no.

Drawing number  
**B1557601/MLA/1326**      Rev **2**

This drawing is not to be used in whole or part other than for the intended purpose and project as defined on this drawing. Refer to the contract for full terms and conditions.

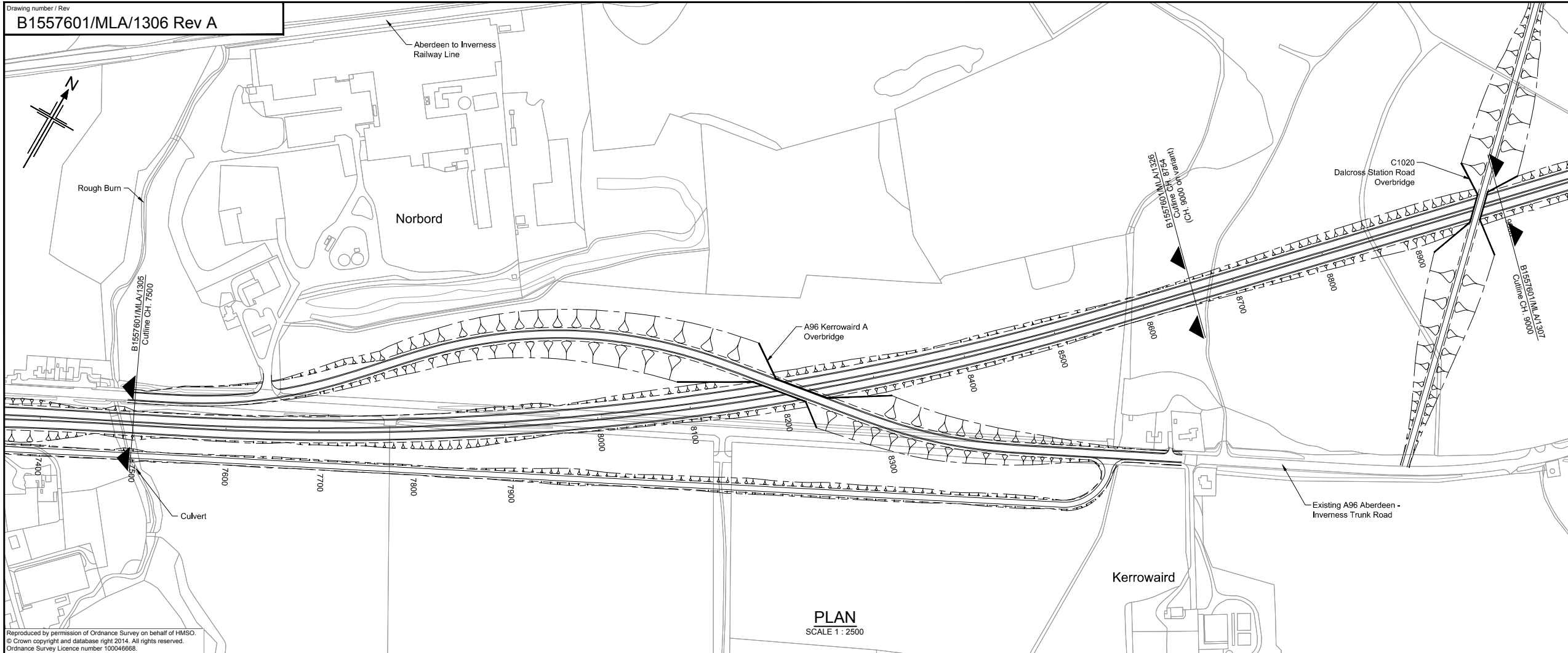

PLAN  
 SCALE 1 : 2500

Reproduced by permission of Ordnance Survey on behalf of HMSO.  
 © Crown copyright and database right 2014. All rights reserved.  
 Ordnance Survey Licence number 100046668.

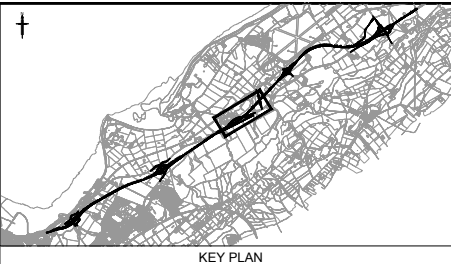

NOTES:  
 1. All dimensions are in metres unless stated otherwise.

This OS Mastermap was obtained in March 2014 and is for illustration purposes only.

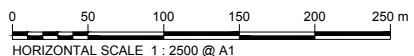
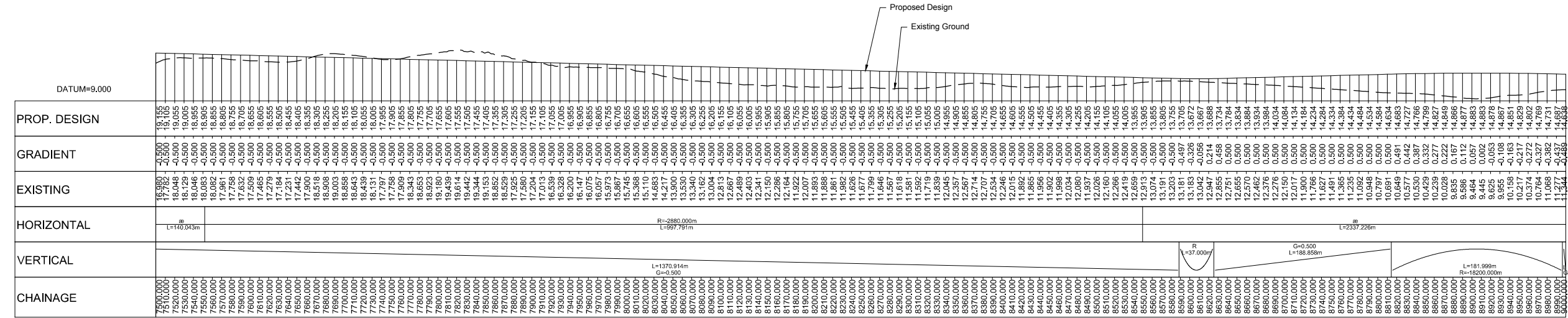

LONGITUDINAL SECTION (CHAINAGE 7500m TO 9000m)

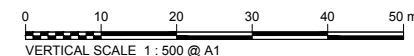

A	08/09/14	DMRB Stage 2 Report	DAD	CMM	GAH	EHB
Rev	Rev. Date	Purpose of revision	Drawn	Checked	Rev'd	Appr'd

**JACOBS**  
 85 Bothwell St, Glasgow, G2 7HX  
 Tel: +44(0)141 243 8000 Fax: +44(0)141 226 3109  
 www.jacobs.com

Client

TRANSPORT SCOTLAND  
 COMHAIL ALBA

Project

**A96**  
 DUALLING  
 INVERNESS TO NAIRN  
 (incl. Nairn Bypass)

Drawing title  
**DMRB STAGE 2  
 INVERNESS TO GOLLANFIELD  
 OPTION 1C PLAN & PROFILE  
 CH 7500 TO CH 9000**

Drawing status  
**PRELIMINARY**

Scale	1:2,500 @ A1	DO NOT SCALE
Jacobs No.	B1557601	
Client no.		

Drawing number	<b>B1557601/MLA/1306</b>	Rev	<b>A</b>
----------------	--------------------------	-----	----------

This drawing is not to be used in whole or part other than for the intended purpose and project as defined on this drawing. Refer to the contract for full terms and conditions.



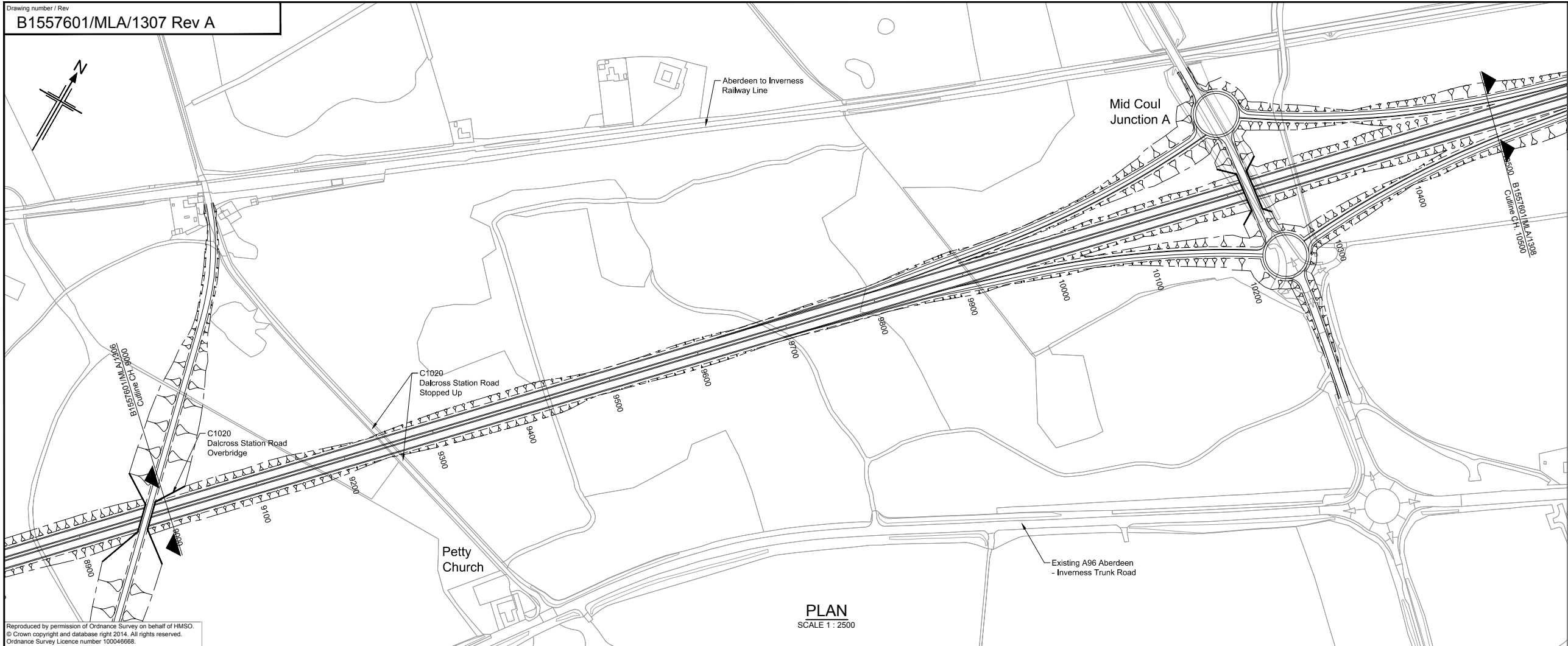

Reproduced by permission of Ordnance Survey on behalf of HMSO.  
 © Crown copyright and database right 2014. All rights reserved.  
 Ordnance Survey Licence number 100046668.

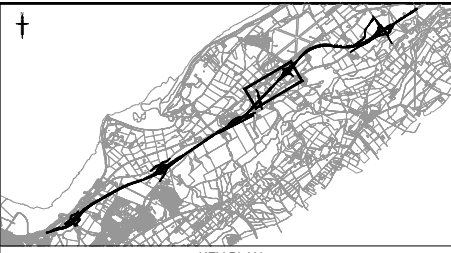

- NOTES:**
- All dimensions are in metres unless stated otherwise.
  - For Mid Coul Junction A refer to drawing no. B1557601/MLA/1313.

This OS Mastermap was obtained in March 2014 and is for illustration purposes only.

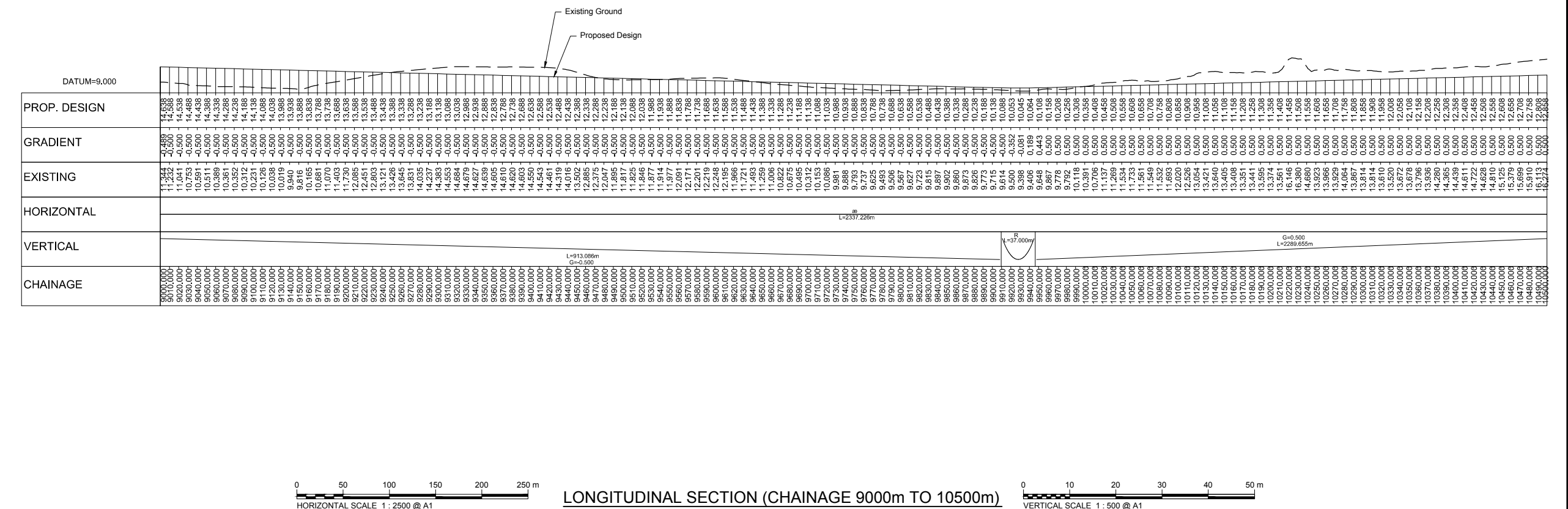

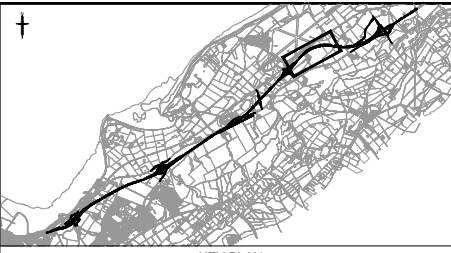
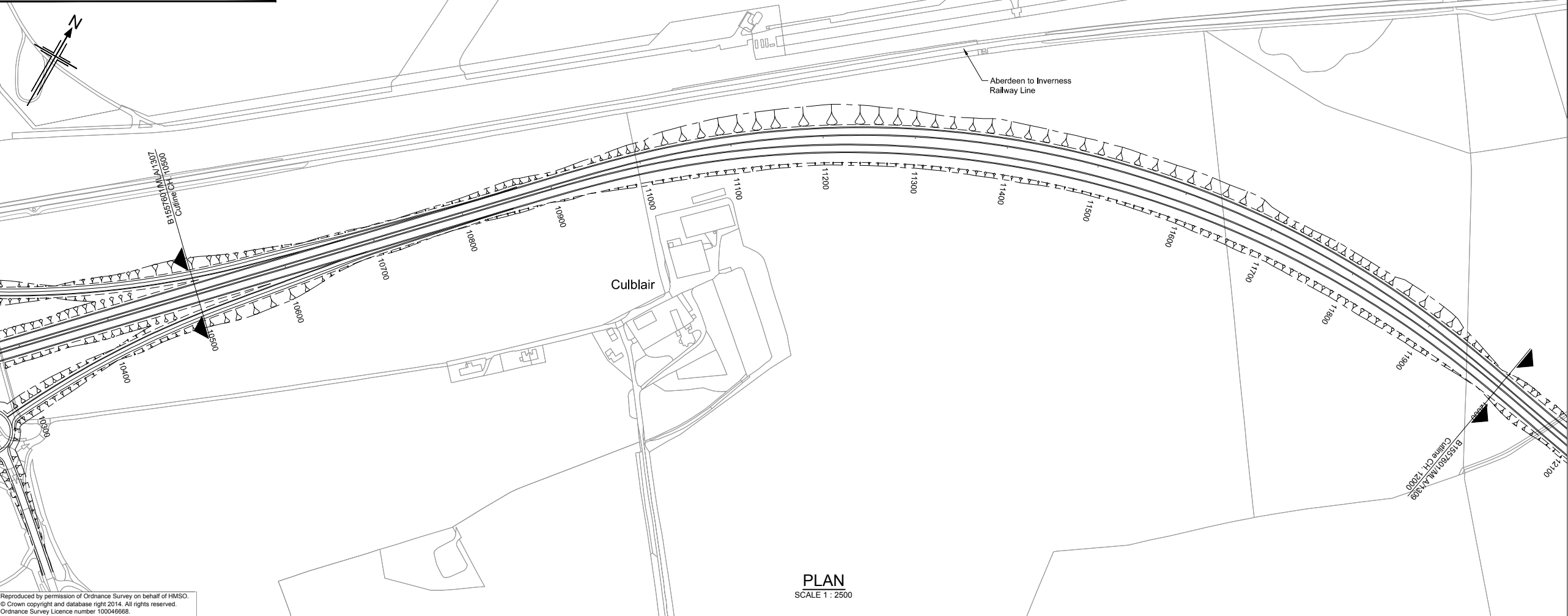

NOTES:  
 1. All dimensions are in metres unless stated otherwise.

Reproduced by permission of Ordnance Survey on behalf of HMSO.  
 © Crown copyright and database right 2014. All rights reserved.  
 Ordnance Survey Licence number 100046668.

This OS Mastermap was obtained in March 2014 and is for illustration purposes only.

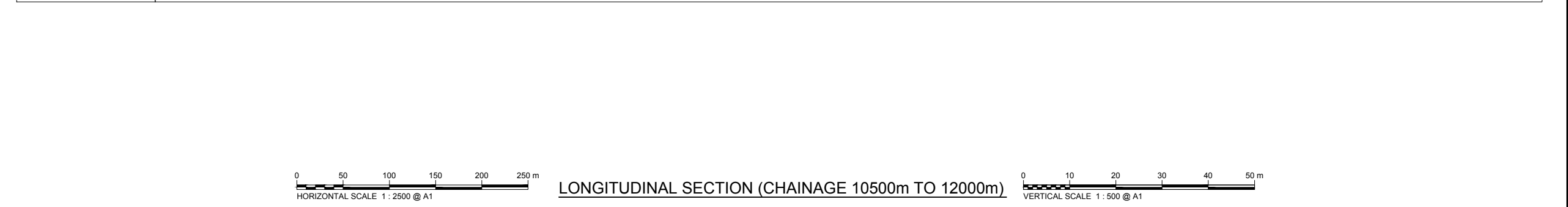
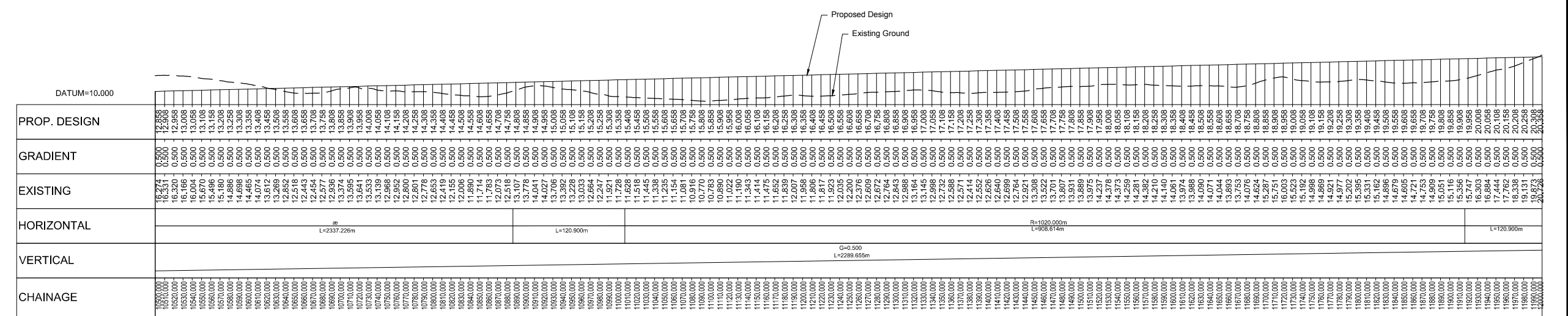

Rev	Rev. Date	Purpose of revision	Drawn	Checked	Rev'd	Appr'd
A	08/09/14	DMRB Stage 2 Report	DAD	CMM	GAH	EHB

**JACOBS**  
 85 Bothwell St, Glasgow, G2 7HX  
 Tel: +44(0)141 243 8000 Fax: +44(0)141 226 3109  
 www.jacobs.com

Client

TRANSPORT SCOTLAND  
 COMHAIL ALBA

Project

A95  
 DUALLING  
 INVERNESS TO NAIRN  
 (incl. Nairn Bypass)

Drawing title  
**DMRB STAGE 2  
 INVERNESS TO GOLLANFIELD  
 OPTION 1C PLAN & PROFILE  
 CH 10500 TO CH 12000**

Drawing status  
**PRELIMINARY**

Scale  
 1:2,500 @ A1 DO NOT SCALE

Jacobs No.  
 B1557601

Client no.

Drawing number  
**B1557601/MLA/1308**

Rev  
**A**

This drawing is not to be used in whole or part other than for the intended purpose and project as defined on this drawing. Refer to the contract for full terms and conditions.



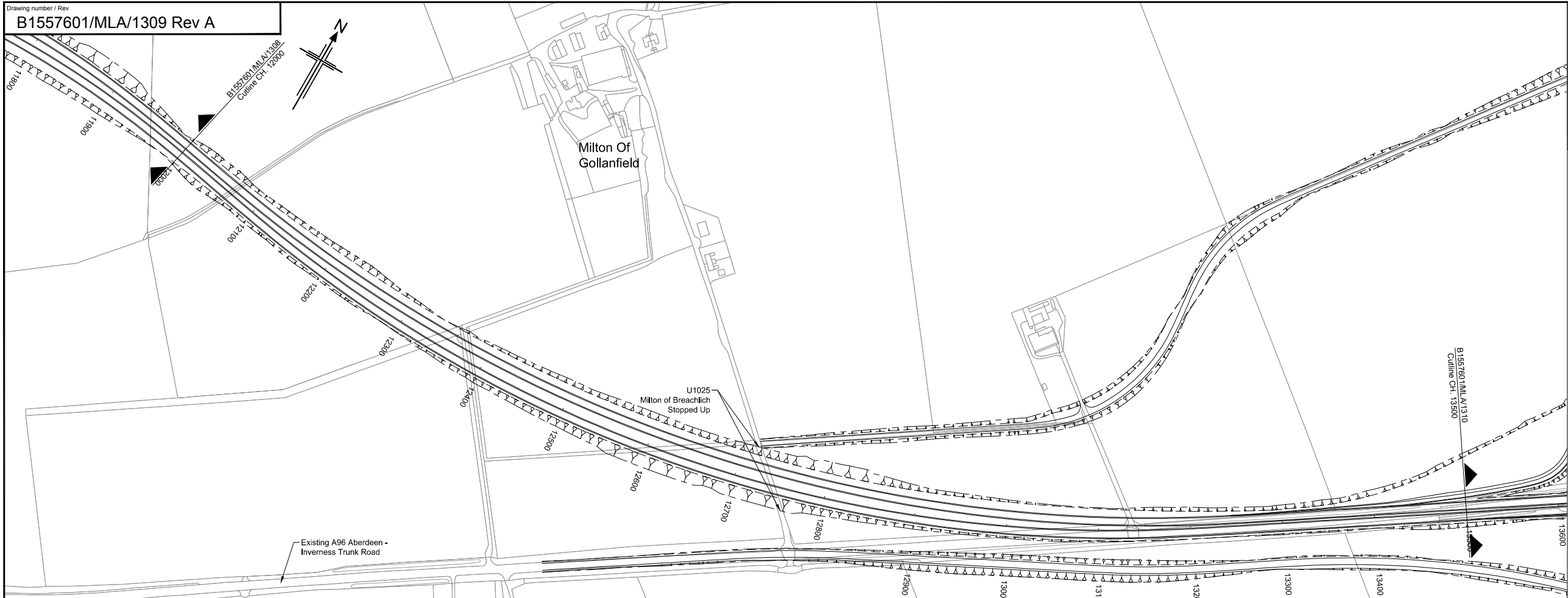

**PLAN**  
 SCALE 1 : 2500

Reproduced by permission of Ordnance Survey on behalf of HMSO.  
 © Crown copyright and database right 2014. All rights reserved.  
 Ordnance Survey Licence number 100046668.

**NOTES:**  
 1. All dimensions are in metres unless stated otherwise.

This OS Mastermap was obtained in March 2014 and is for illustration purposes only.

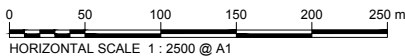
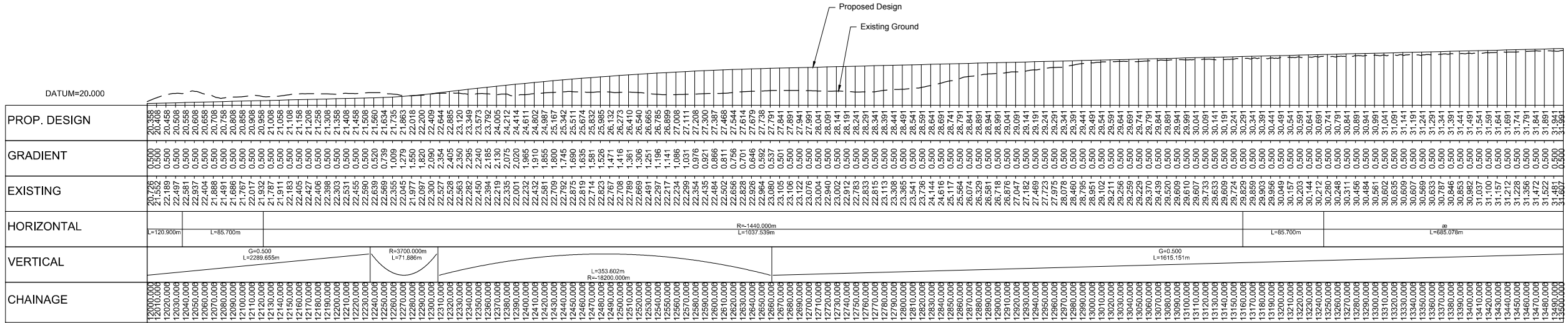

**LONGITUDINAL SECTION (CHAINAGE 12000m TO 13500m)**

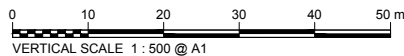

A	08/09/14	DMRB Stage 2 Report	DAD	CMM	GAH	EBH
Rev	Rev. Date	Purpose of revision	Drawn	Checked	Rev'd	Apprv'd



Drawing title  
**DMRB STAGE 2  
 INVERNESS TO GOLLANFIELD  
 OPTION 1C PLAN & PROFILE  
 CH 12000 TO CH 13500**

Drawing status  
**PRELIMINARY**

Scale  
 1:2,500 @ A1      DO NOT SCALE

Jacobs No.      B1557601

Client no.

Drawing number  
**B1557601/MLA/1309**

Rev  
**A**

This drawing is not to be used in whole or part other than for the intended purpose and project as defined on this drawing. Refer to the contract for full terms and conditions.

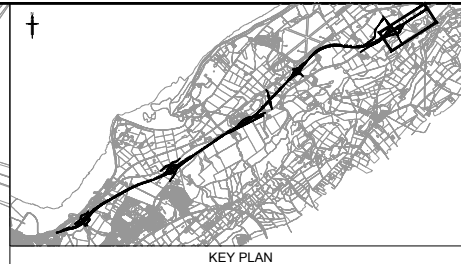
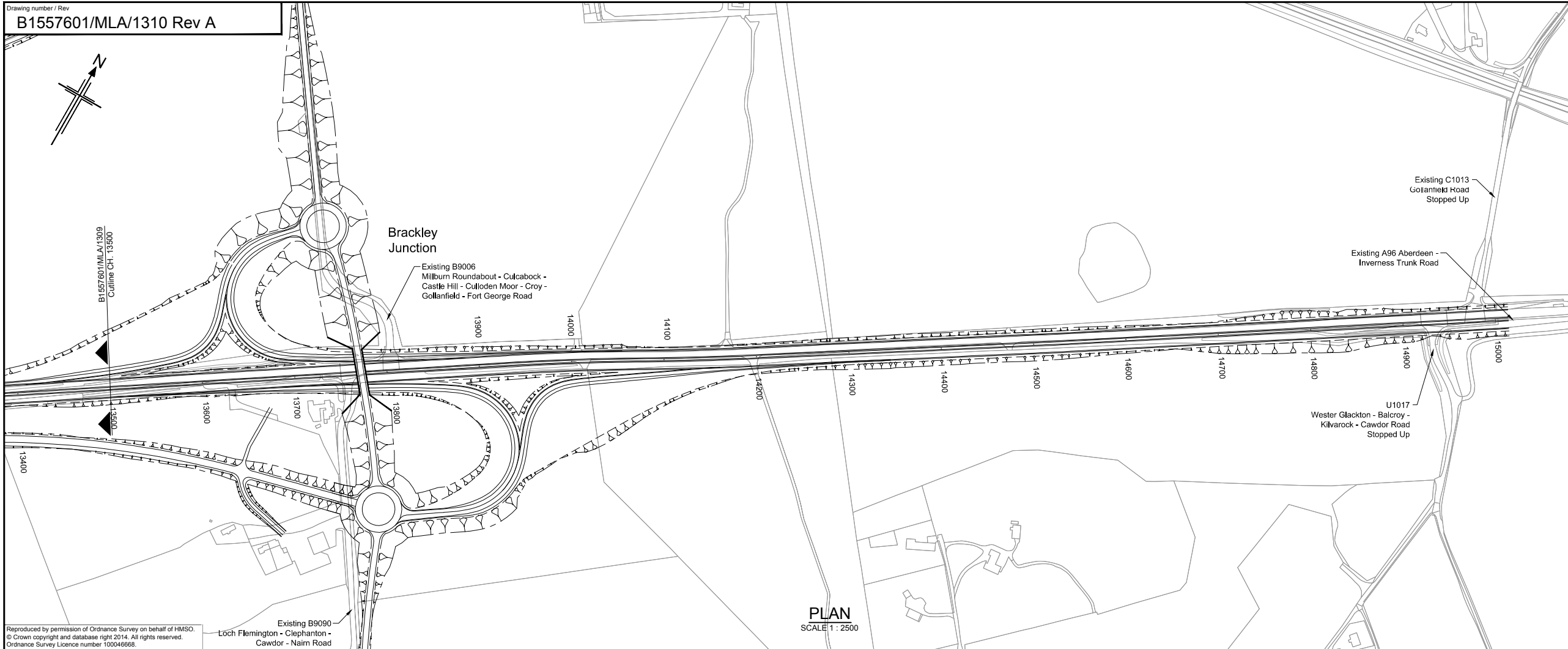
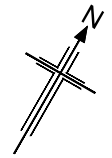

- NOTES:**
- All dimensions are in metres unless stated otherwise.
  - For Brackley Junction refer to drawing no. B1557601/MLA/1314.

Reproduced by permission of Ordnance Survey on behalf of HMSO.  
 © Crown copyright and database right 2014. All rights reserved.  
 Ordnance Survey Licence number 100046668.

This OS Mastermap was obtained in March 2014 and is for illustration purposes only.

A	08/09/14	DMRB Stage 2 Report	DAD	CMM	GAH	EHB
Rev	Rev. Date	Purpose of revision	Drawn	Checked	Rev'd	Apprv'd

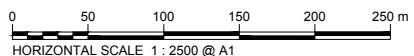
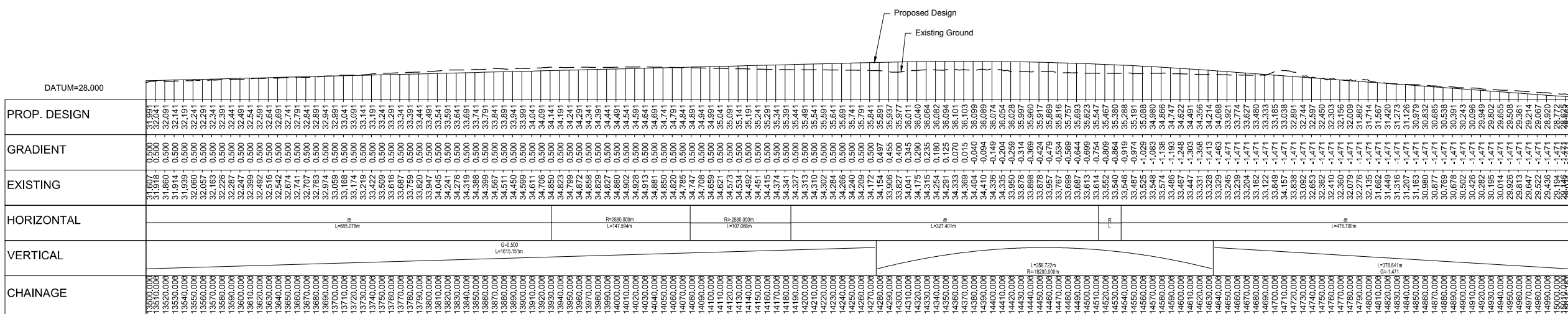

**LONGITUDINAL SECTION (CHAINAGE 13500m TO 14954.52m)**

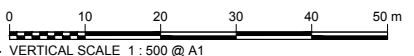

Drawing title  
**DMRB STAGE 2  
 INVERNESS TO GOLLANFIELD  
 OPTION 1C PLAN & PROFILE  
 CH 13500 TO CH 15014.167**

Drawing status  
**PRELIMINARY**

Scale  
 1:2,500 @ A1      DO NOT SCALE

Jacobs No.      B1557601

Client no.

Drawing number  
**B1557601/MLA/1310**

Rev  
**A**

This drawing is not to be used in whole or part other than for the intended purpose and project as defined on this drawing. Refer to the contract for full terms and conditions.



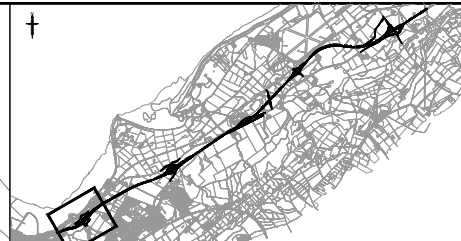
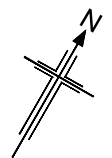

**NOTES:**  
 1. All dimensions are in metres unless stated otherwise.

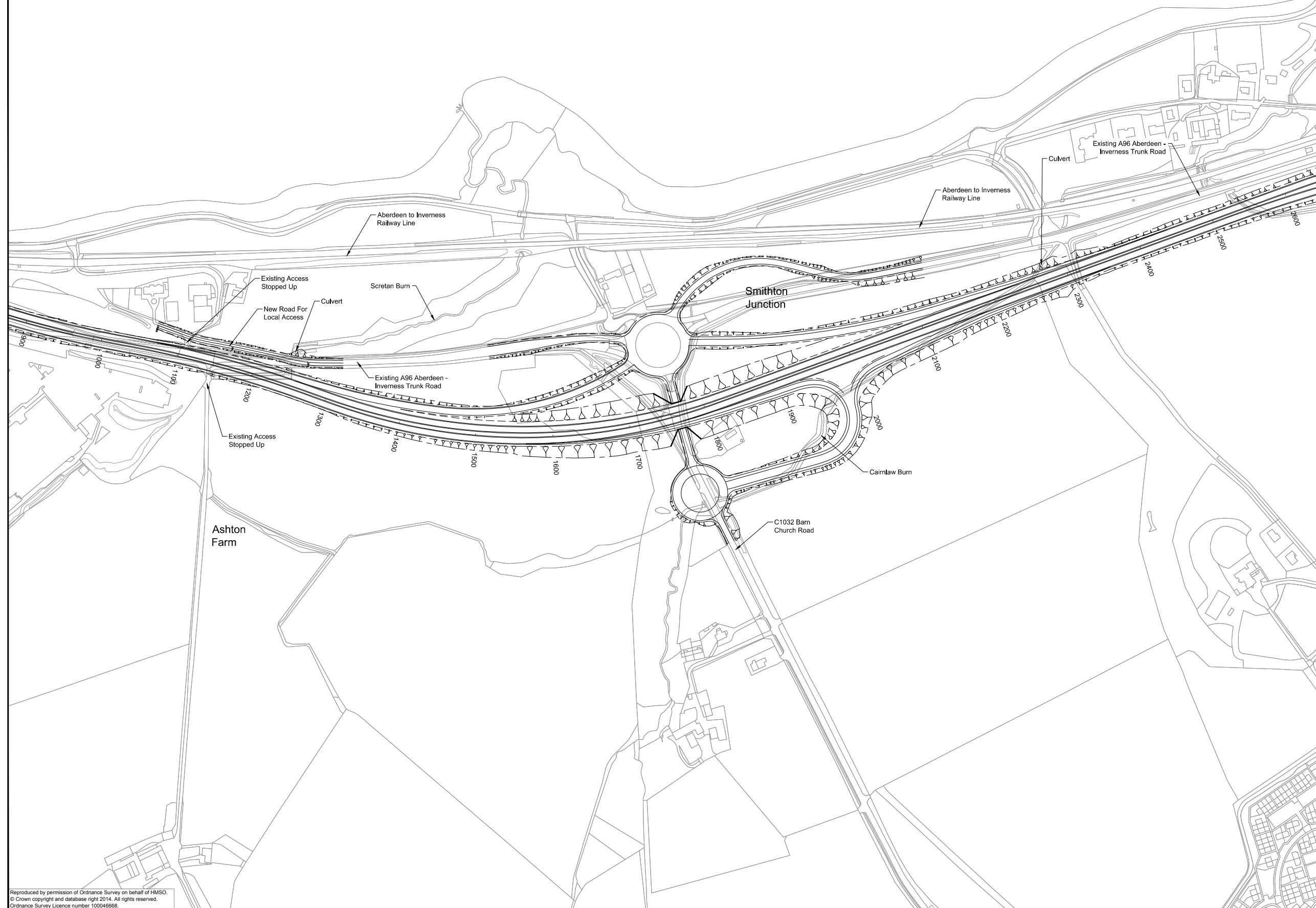

This OS Mastermap was obtained in March 2014 and is for illustration purposes only.

A	08/09/14	DMRB Stage 2 Report	DAD	CMM	GAH	EHB
Rev	Rev. Date	Purpose of revision	Drawn	Checked	Rev'd	Apprv'd

**JACOBS**  
 85 Bothwell St, Glasgow, G2 7HX  
 Tel: +44(0)141 243 8000 Fax: +44(0)141 226 3109  
 www.jacobs.com



**A96**  
**DUALLING**  
 INVERNESS TO NAIRN  
 (incl. Nairn Bypass)

Drawing title  
**DMRB STAGE 2  
 INVERNESS TO GOLLANFIELD  
 SMITHTON JUNCTION  
 OPTION 1C**

Drawing status  
**PRELIMINARY**

Scale  
 1:2,500 @ A1 **DO NOT SCALE**

Jacobs No. B1557601

Drawing number  
**B1557601/MLA/1311**

Rev  
**A**

Reproduced by permission of Ordnance Survey on behalf of HMSO.  
 © Crown copyright and database right 2014. All rights reserved.  
 Ordnance Survey Licence number 100046668.

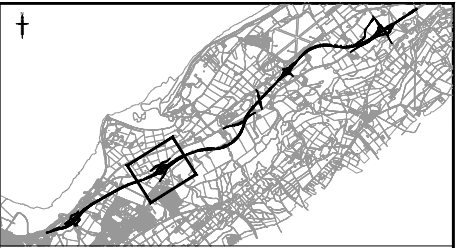
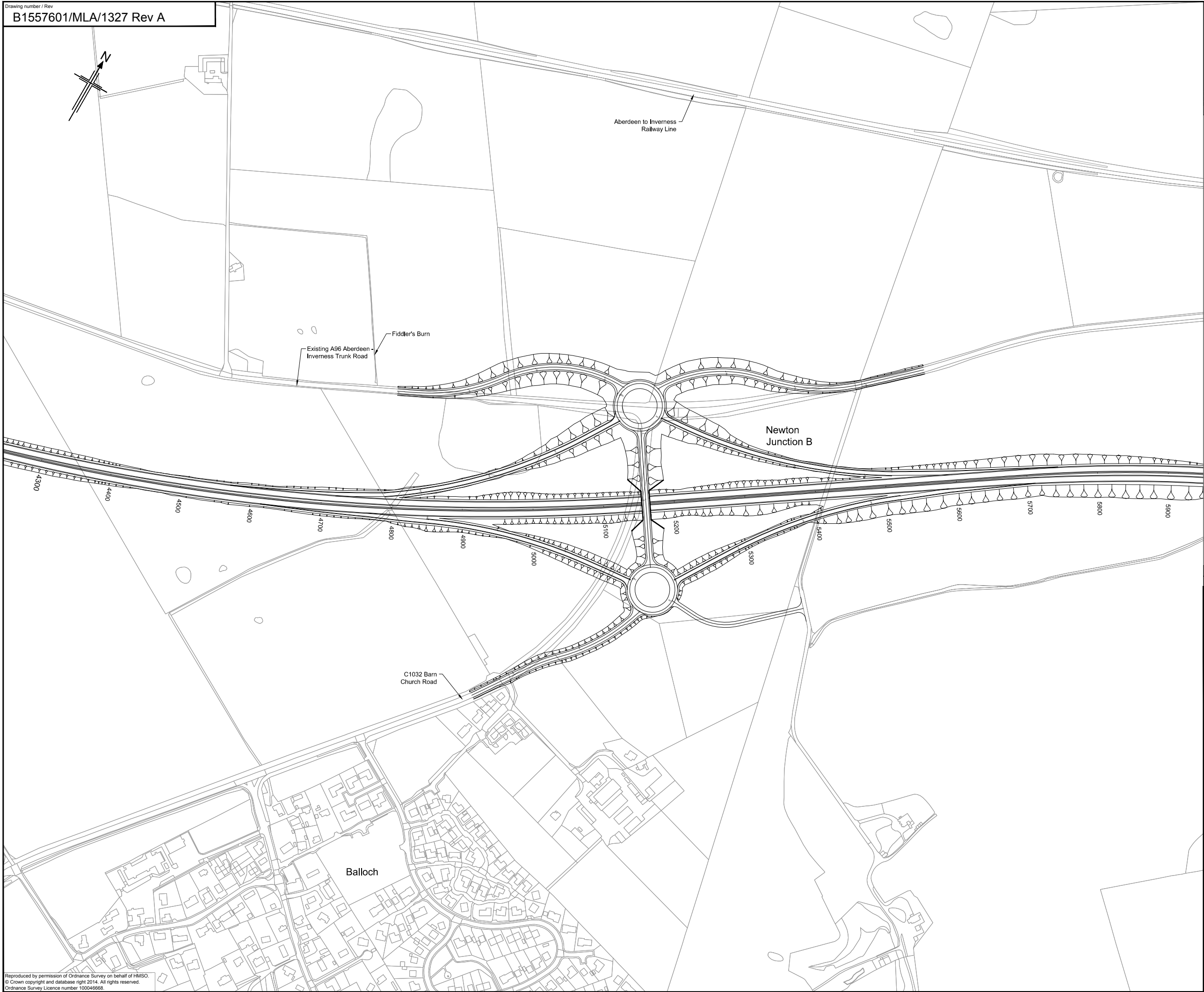

**NOTES:**  
 1. All dimensions are in metres unless stated otherwise.

This OS Mastermap was obtained in March 2014 and is for illustration purposes only.

A	08/09/14	DMRB Stage 2 Report	DAD	CMM	GAH	EHB
Rev	Rev. Date	Purpose of revision	Drawn	Checked	Rev'd	Appr'd

**JACOBS**  
 85 Bothwell St, Glasgow, G2 7HX  
 Tel: +44(0)141 243 8000 Fax: +44(0)141 226 3109  
 www.jacobs.com

Client

Project

Drawing title  
**DMRB STAGE 2  
 INVERNESS TO GOLLANFIELD  
 NEWTON JUNCTION B  
 OPTION 1C (MV)**

Drawing status  
**PRELIMINARY**

Scale: 1:2,500 @ A1 **DO NOT SCALE**

Jacobs No. B1557601

Drawing number **B1557601/MLA/1327** Rev **A**

Reproduced by permission of Ordnance Survey on behalf of HMSO.  
 © Crown copyright and database right 2014. All rights reserved.  
 Ordnance Survey Licence number 100046668.



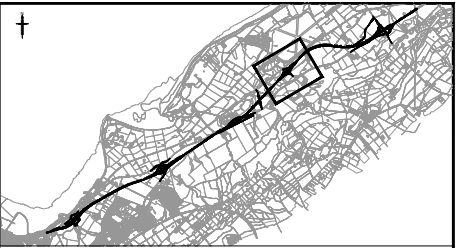
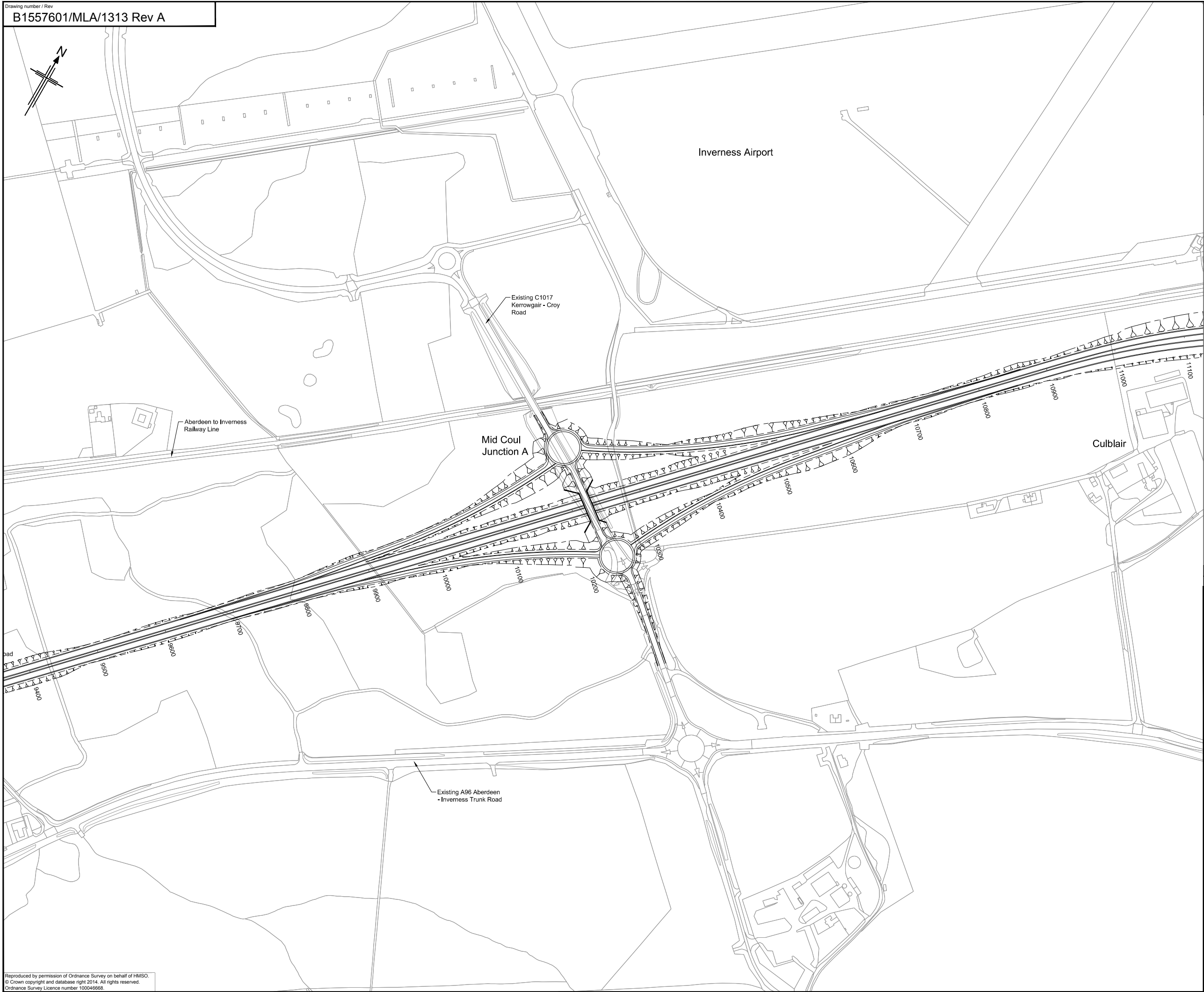
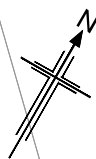

**NOTES:**  
 1. All dimensions are in metres unless stated otherwise.

This OS Mastermap was obtained in March 2014 and is for illustration purposes only.

A	08/09/14	DMRB Stage 2 Report	DAD	CMM	GAH	EHB
Rev	Rev. Date	Purpose of revision	Drawn	Checked	Rev'd	Apprv'd

**JACOBS**  
 85 Bothwell St, Glasgow, G2 7HX  
 Tel: +44(0)141 243 8000 Fax: +44(0)141 226 3109  
 www.jacobs.com

Client

**TRANSPORT SCOTLAND**  
 COMH-DHAL ALBA

Project

**A96**  
**DUALLING**  
 INVERNESS TO NAIRN  
 (incl. Nairn Bypass)

Drawing title  
**DMRB STAGE 2  
 INVERNESS TO GOLLANFIELD  
 MID COUL JUNCTION A  
 OPTION 1C**

Drawing status  
**PRELIMINARY**

Scale  
 1:2,500 @ A1 **DO NOT SCALE**

Jacobs No. B1557601

Drawing number  
**B1557601/MLA/1313**

Rev  
**A**

Reproduced by permission of Ordnance Survey on behalf of HMSO.  
 © Crown copyright and database right 2014. All rights reserved.  
 Ordnance Survey Licence number 100046668.

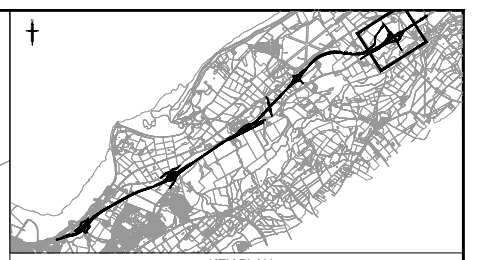
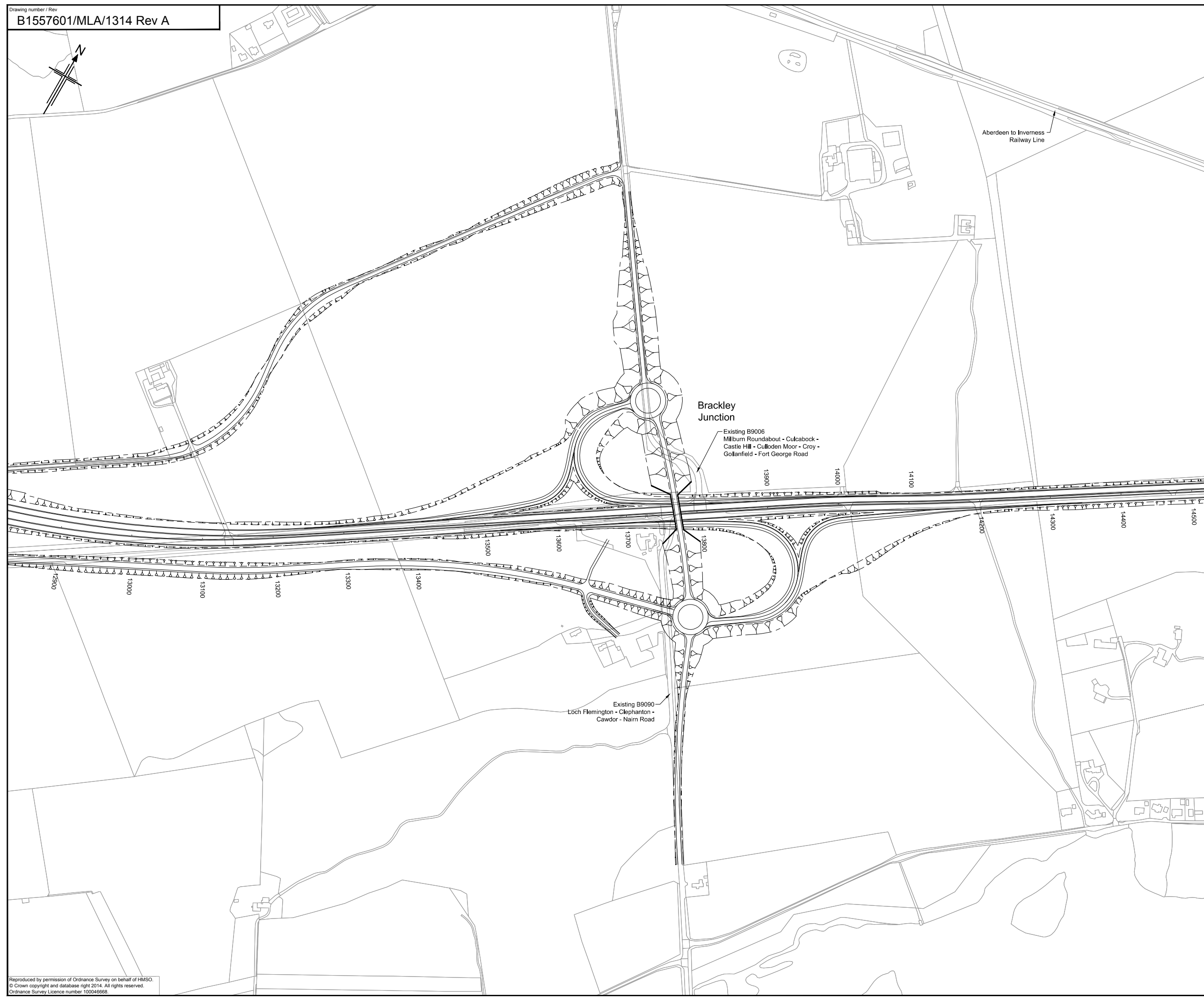

**NOTES:**  
 1. All dimensions are in metres unless stated otherwise.

This OS Mastermap was obtained in March 2014 and is for illustration purposes only.

Rev	Date	Purpose of revision	Drawn	Checked	Rev'd	Apprv'd
A	08/09/14	DMRB Stage 2 Report	DAD	CMM	GAH	EHB

**JACOBS**  
 85 Bothwell St, Glasgow, G2 7HX  
 Tel: +44(0)141 243 8000 Fax: +44(0)141 226 3109  
 www.jacobs.com



**DMRB STAGE 2  
 INVERNESS TO GOLLANFIELD  
 BRACKLEY JUNCTION  
 OPTION 1C**

Drawing status		PRELIMINARY
Scale	1:2,500 @ A1	DO NOT SCALE
Jacobs No.	B1557601	
Client no.		
Drawing number	B1557601/MLA/1314	Rev A