

- Legend**
- Proposed Scheme (as per Draft Orders)
 - SUDS (e.g. Basin or Pond)*
 - 500m Study Area
 - Planning Application**

* Actual shape of pond/basin will be subject to detailed design
 ** The Highland Council (as provided June 2016)

Rev.	Rev. Date	Purpose of revision	Orig/Dwn	Check'd	Rev'd	Apprv'd
0	NOV 2016	ES Publication	HM	AN	GK	ENG

JACOBS
 66 Belford Street, Glasgow, G2 7NK, UK
 Tel: +44(0)141 243 8000 Fax: +44(0)141 226 3109
 www.jacobs.com

Client

 TRANSPORT SCOTLAND
 COMH-DHAIL ALBA

Project

A96
 DUALLING
 INVERNESS TO NAIRN
 (incl. Nairn Bypass)

Drawing title
Figure 15.4a
Environmental Statement
Planning Applications

Sheet 1 of 12

Drawing Status	FINAL	
Scale	1:10,000 @ A3	DO NOT SCALE
Jacobs No.	B2103500	
BIM No.		
Drawing number	B2103500/EN/EIA/DR/1504a	Rev 0

This drawing is not to be used in whole or part other than for the intended purpose and project as defined on this drawing. Refer to the contract for full terms and conditions.



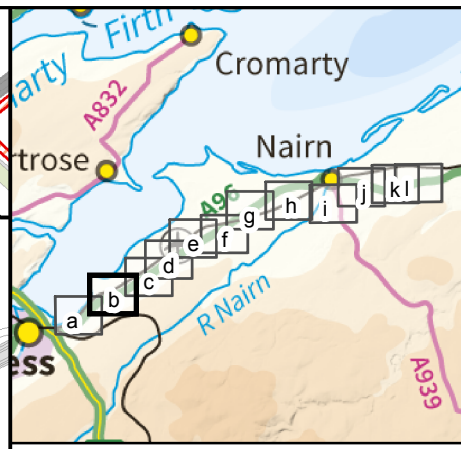
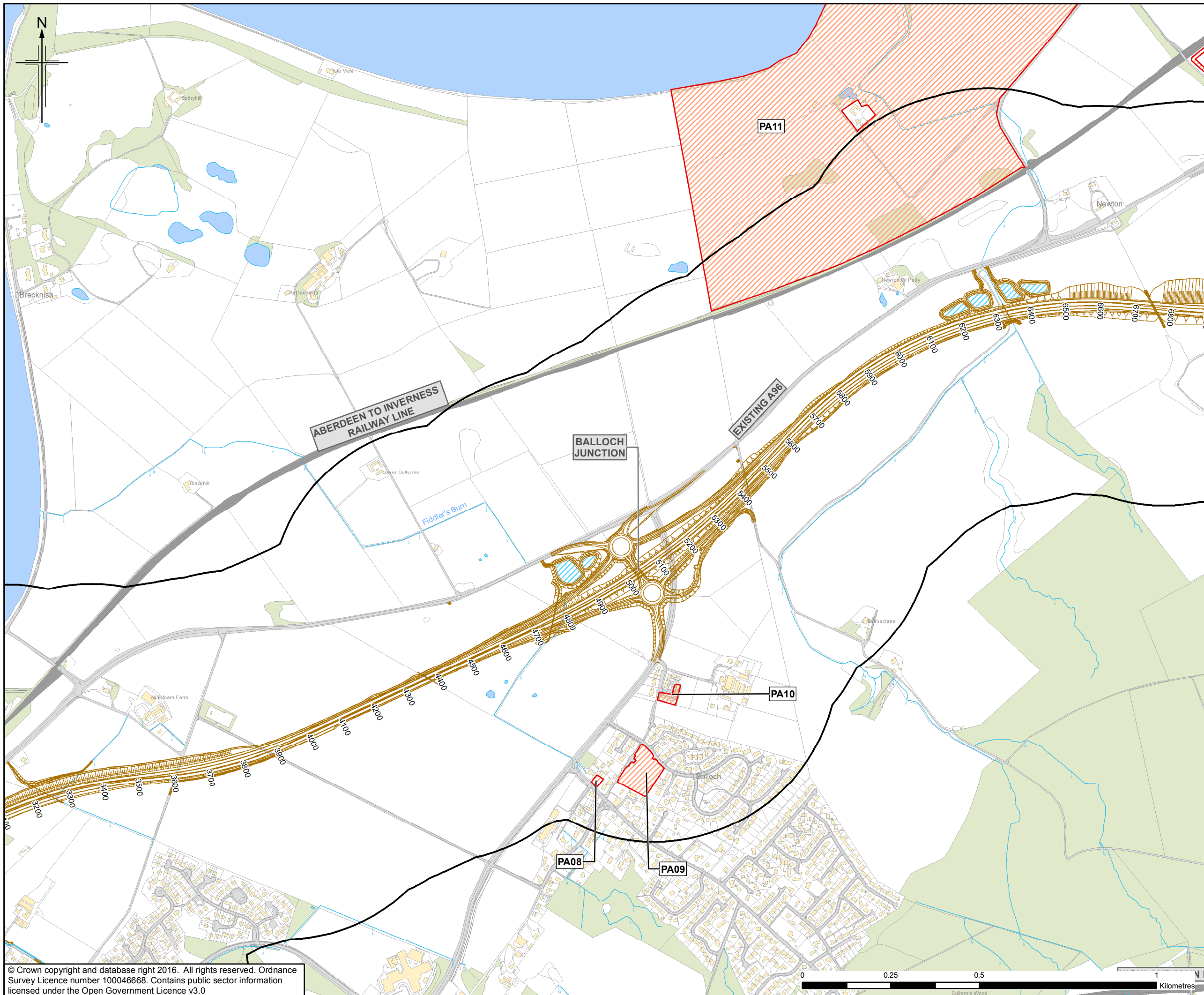

- Legend**
- Proposed Scheme (as per Draft Orders)
 - SUDS (e.g. Basin or Pond)*
 - 500m Study Area
 - Planning Application**

* Actual shape of pond/basin will be subject to detailed design
 ** The Highland Council (as provided June 2016)

Rev.	Rev. Date	Purpose of revision	Orig/Dwn	Check'd	Rev'd	Apprv'd
0	NOV 2016	ES Publication	HM	AN	GK	ENG

JACOBS
 55 Belford Street, Glasgow, G2 7NK, UK
 Tel: +44(0)141 243 8000 Fax: +44(0)141 226 3109
 www.jacobs.com



Drawing title
**Figure 15.4b
 Environmental Statement
 Planning Applications**
 Sheet 2 of 12

Drawing Status	FINAL	
Scale	1:10,000 @ A3	DO NOT SCALE
Jacobs No.	B2103500	
BIM No.		
Drawing number	B2103500/EN/EIA/DR/1504b	Rev 0

This drawing is not to be used in whole or part other than for the intended purpose and project as defined on this drawing. Refer to the contract for full terms and conditions.

© Crown copyright and database right 2016. All rights reserved. Ordnance Survey Licence number 100046668. Contains public sector information licensed under the Open Government Licence v3.0



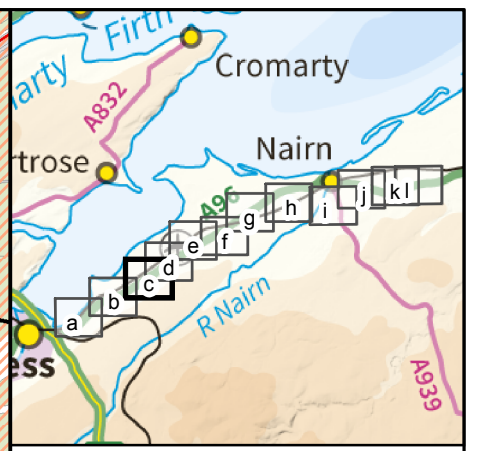
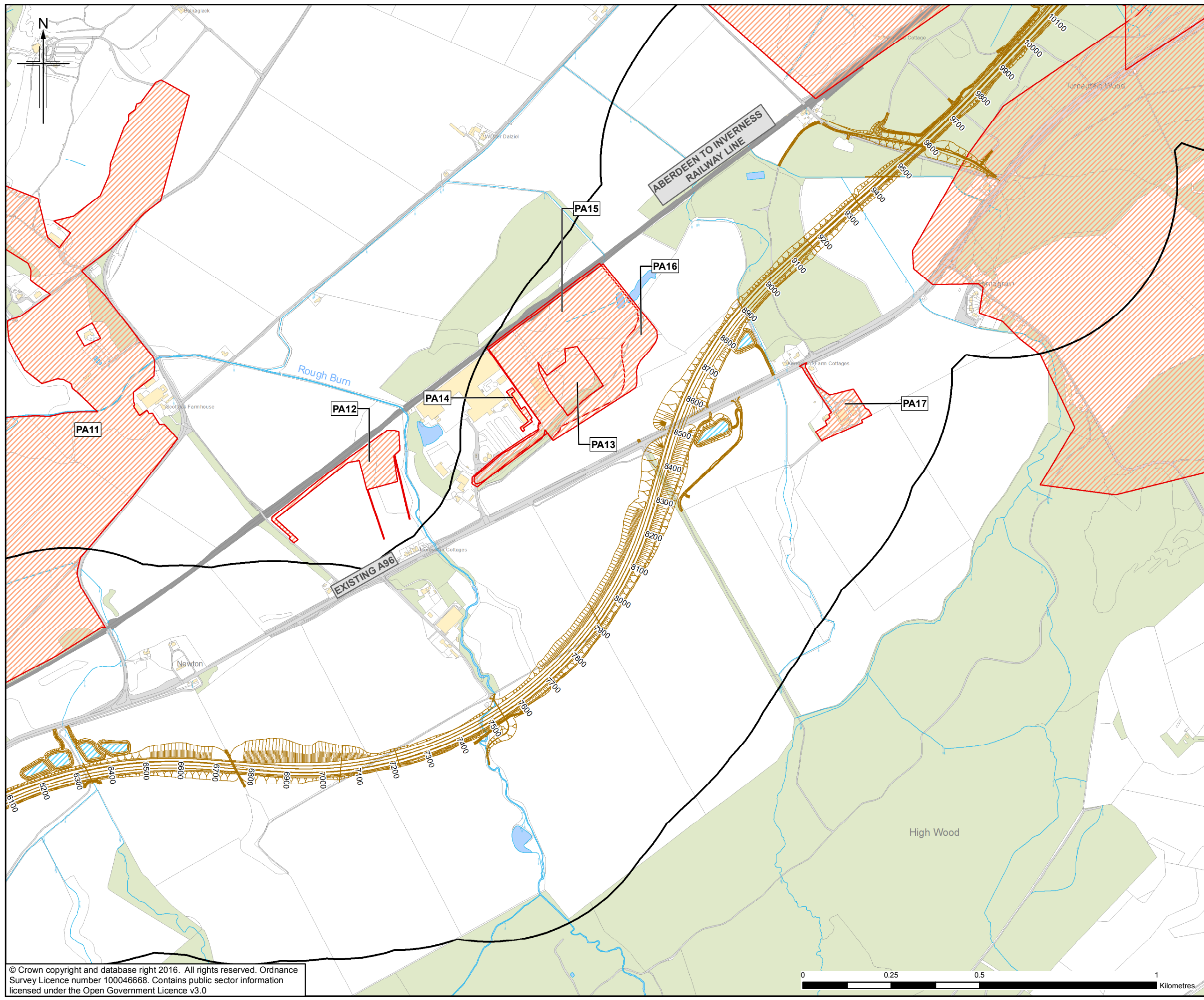

- Legend**
- Proposed Scheme (as per Draft Orders)
 - SUDS (e.g. Basin or Pond)*
 - 500m Study Area
 - Planning Application**

* Actual shape of pond/basin will be subject to detailed design
 ** The Highland Council (as provided June 2016)

Rev.	Rev. Date	Purpose of revision	Orig/Dwn	Check'd	Rev'd	Appr'd
0	NOV 2016	ES Publication	HM	AN	GK	ENG

JACOBS
 55 Belford Street, Glasgow, G2 7NK, UK
 Tel: +44(0)141 243 8000 Fax: +44(0)141 226 3109
 www.jacobs.com



Drawing title
**Figure 15.4c
 Environmental Statement
 Planning Applications**

Sheet 3 of 12

Drawing Status: FINAL
 Scale: 1:10,000 @ A3 DO NOT SCALE
 Jacobs No.: B2103500
 BIM No.:
 Drawing number: B2103500/EN/EIA/DR/1504c Rev 0

This drawing is not to be used in whole or part other than for the intended purpose and project as defined on this drawing. Refer to the contract for full terms and conditions.



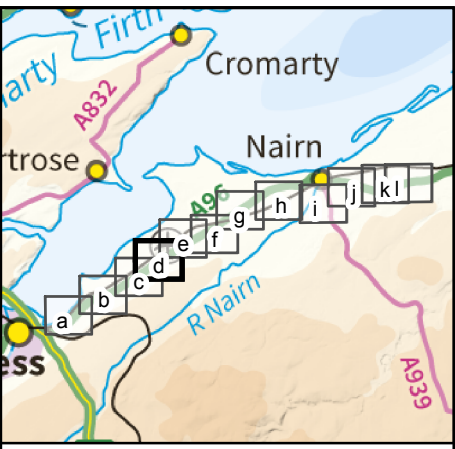
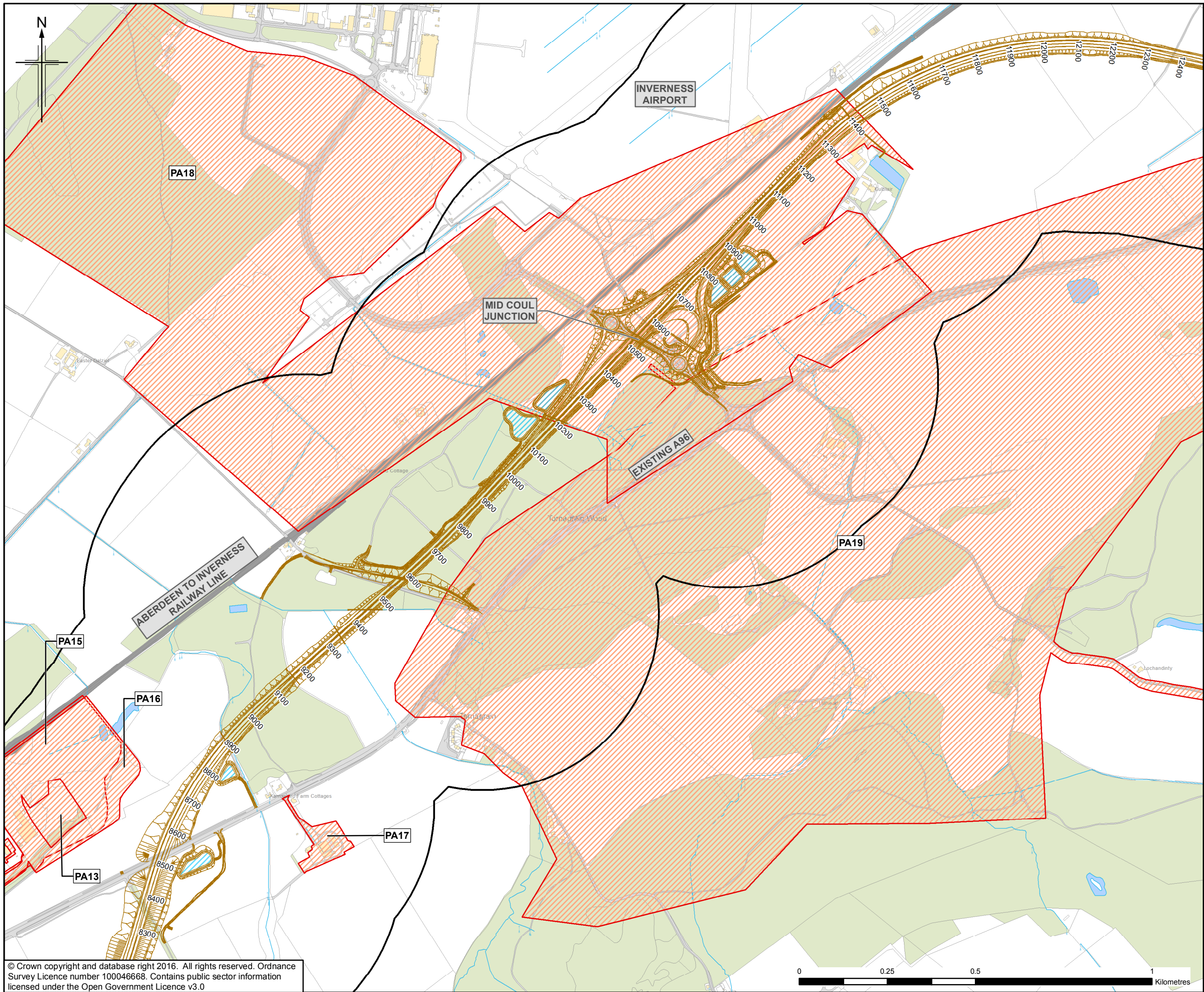

- Legend**
- Proposed Scheme (as per Draft Orders)
 - SUDS (e.g. Basin or Pond)*
 - 500m Study Area
 - Planning Application**

* Actual shape of pond/basin will be subject to detailed design
 ** The Highland Council (as provided June 2016)

Rev.	Rev. Date	Purpose of revision	Orig/Dwn	Check'd	Rev'd	Apprv'd
0	NOV 2016	ES Publication	HM	AN	GK	ENG

JACOBS
 16 Bedford Street, Glasgow, G2 7NK, UK
 Tel: +44(0)141 243 8000 Fax: +44(0)141 226 3109
 www.jacobs.com



Drawing title
**Figure 15.4d
 Environmental Statement
 Planning Applications**

Drawing Status	FINAL	
Scale	1:10,000 @ A3	DO NOT SCALE
Jacobs No.	B2103500	
BIM No.		
Drawing number	B2103500/EN/EIA/DR/1504d	Rev 0

This drawing is not to be used in whole or part other than for the intended purpose and project as defined on this drawing. Refer to the contract for full terms and conditions.

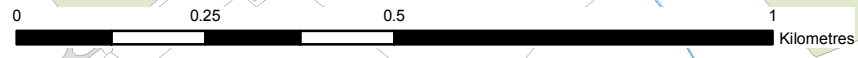

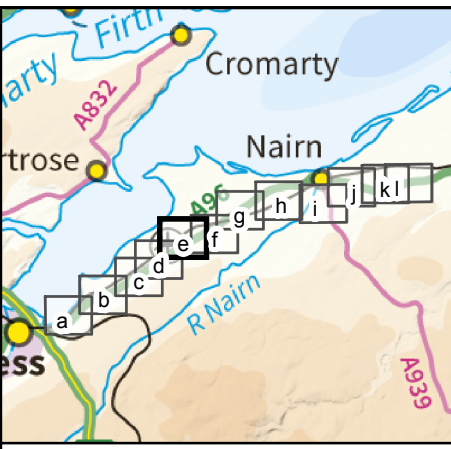
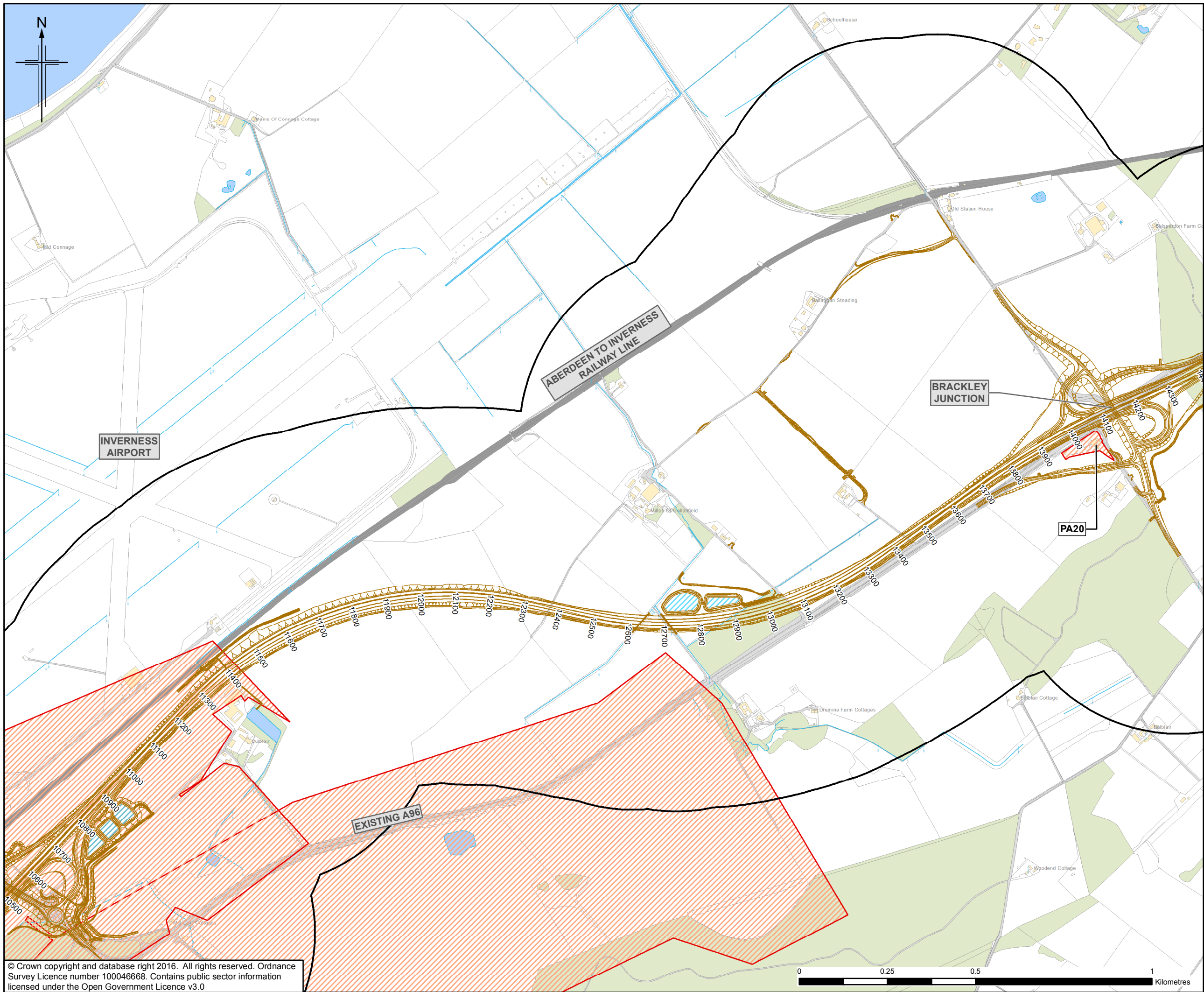

- Legend**
- Proposed Scheme (as per Draft Orders)
 - SUDS (e.g. Basin or Pond)*
 - 500m Study Area
 - Planning Application**

* Actual shape of pond/basin will be subject to detailed design
 ** The Highland Council (as provided June 2016)

Rev.	Rev. Date	Purpose of revision	Orig/Dwn	Checkd	Rev'd	Apprv'd
0	NOV 2016	ES Publication	HM	AN	GK	ENG

JACOBS
 66 Belford Street, Glasgow, G2 7NK, UK
 Tel: +44(0)141 243 8000 Fax: +44(0)141 226 3109
 www.jacobs.com



Drawing title
**Figure 15.4e
 Environmental Statement
 Planning Applications**

Drawing Status	FINAL	
Scale	1:10,000 @ A3	DO NOT SCALE
Jacobs No.	B2103500	
BIM No.		
Drawing number	B2103500/EN/EIA/DR/1504e	Rev 0

This drawing is not to be used in whole or part other than for the intended purpose and project as defined on this drawing. Refer to the contract for full terms and conditions.



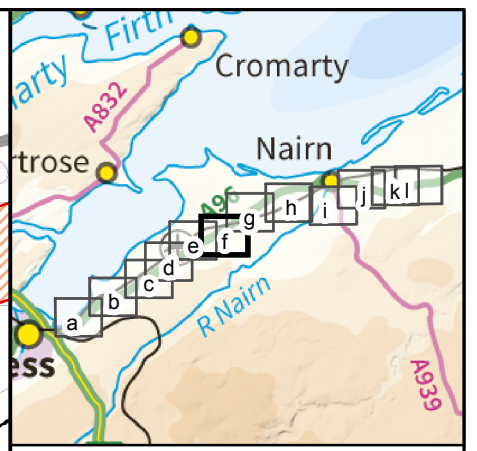
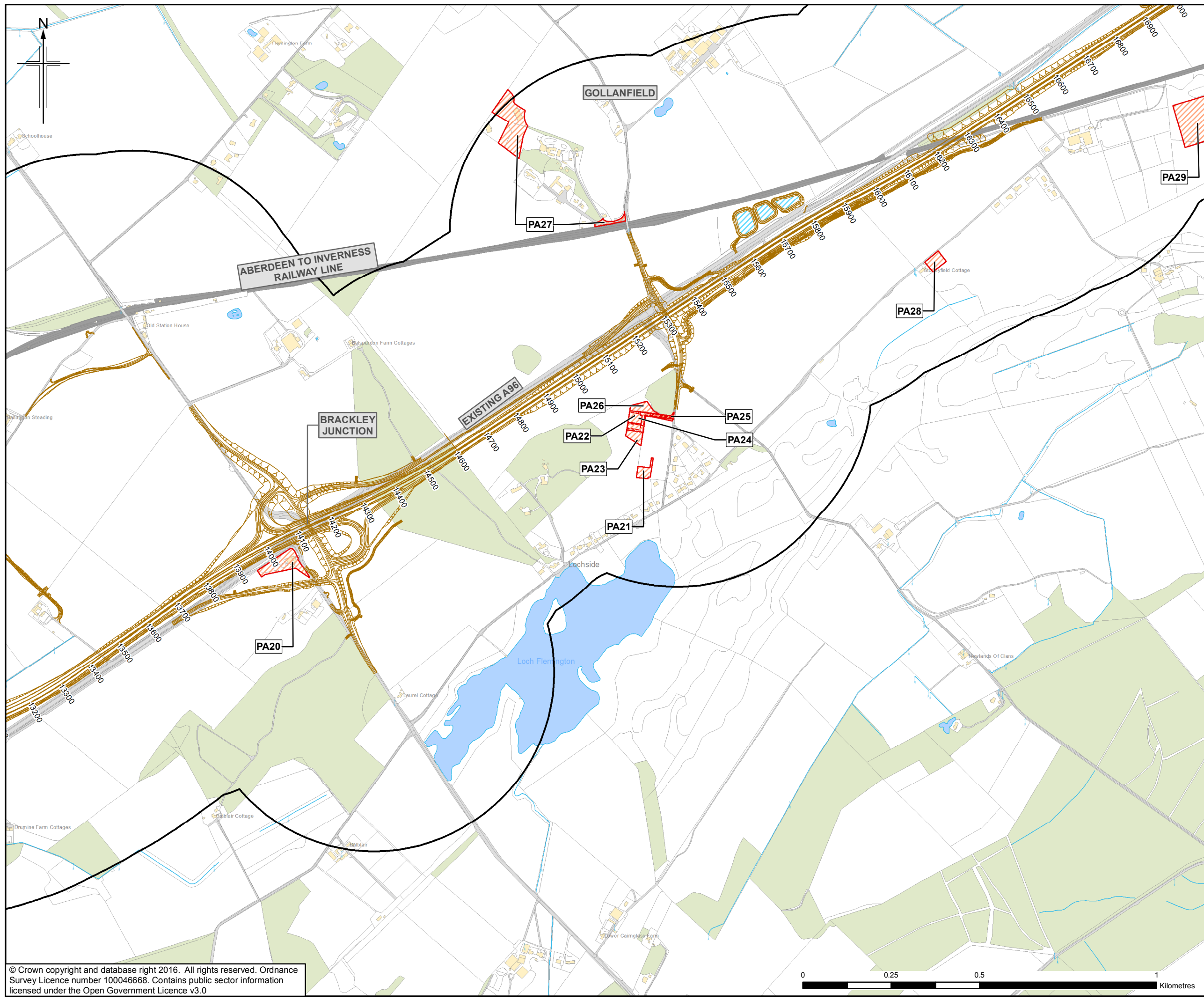

- Legend**
- Proposed Scheme (as per Draft Orders)
 - SUDS (e.g. Basin or Pond)*
 - 500m Study Area
 - Planning Application**

* Actual shape of pond/basin will be subject to detailed design
 ** The Highland Council (as provided June 2016)

Rev.	Rev. Date	Purpose of revision	Orig/Dwn	Checkd	Rev'd	Apprv'd
0	NOV 2016	ES Publication	HM	AN	GK	ENG

JACOBS
 55 Belford Street, Glasgow, G2 7NK, UK
 Tel: +44(0)141 243 8000 Fax: +44(0)141 226 3109
 www.jacobs.com

Client

 TRANSPORT SCOTLAND
 COMHÙDHAIL ALBA

Project

A96
 DUALLING
 INVERNESS TO NAIRN
 (incl. Nairn Bypass)

Drawing title
Figure 15.4f
Environmental Statement
Planning Applications
 Sheet 6 of 12

Drawing Status	FINAL	
Scale	1:10,000 @ A3	DO NOT SCALE
Jacobs No.	B2103500	
BIM No.		
Drawing number	B2103500/EN/EIA/DR/1504f	Rev 0

This drawing is not to be used in whole or part other than for the intended purpose and project as defined on this drawing. Refer to the contract for full terms and conditions.

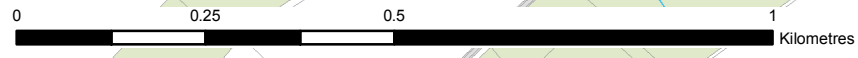

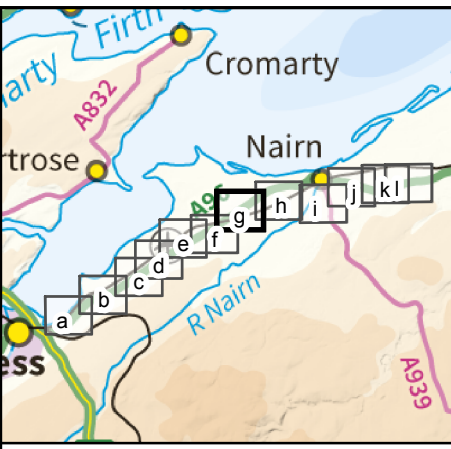
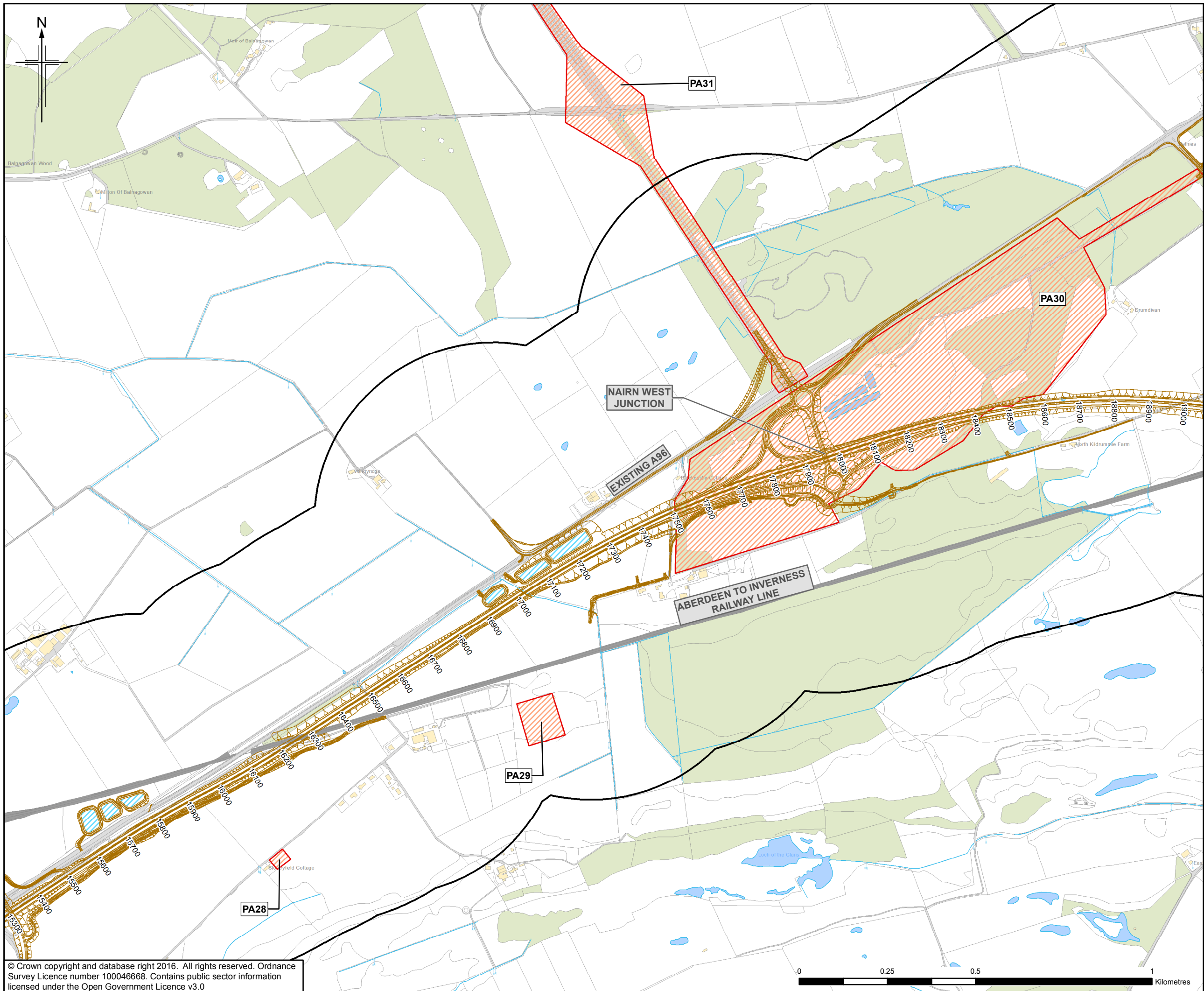

- Legend**
- Proposed Scheme (as per Draft Orders)
 - SUDS (e.g. Basin or Pond)*
 - 500m Study Area
 - Planning Application**

* Actual shape of pond/basin will be subject to detailed design
 ** The Highland Council (as provided June 2016)

Rev.	Rev. Date	Purpose of revision	Orig/Dwn	Checkd	Rev'd	Apprv'd
0	NOV 2016	ES Publication	HM	AN	GK	ENG

JACOBS
 16 Belford Street, Glasgow, G2 7NK, UK
 Tel: +44(0)141 243 8000 Fax: +44(0)141 226 3109
 www.jacobs.com



Drawing title
**Figure 15.4g
 Environmental Statement
 Planning Applications**

Drawing Status	FINAL	
Scale	1:10,000 @ A3	DO NOT SCALE
Jacobs No.	B2103500	
BIM No.		
Drawing number	B2103500/EN/EIA/DR/1504g	Rev 0

This drawing is not to be used in whole or part other than for the intended purpose and project as defined on this drawing. Refer to the contract for full terms and conditions.



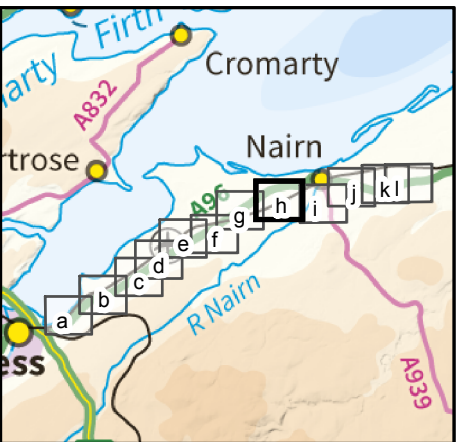
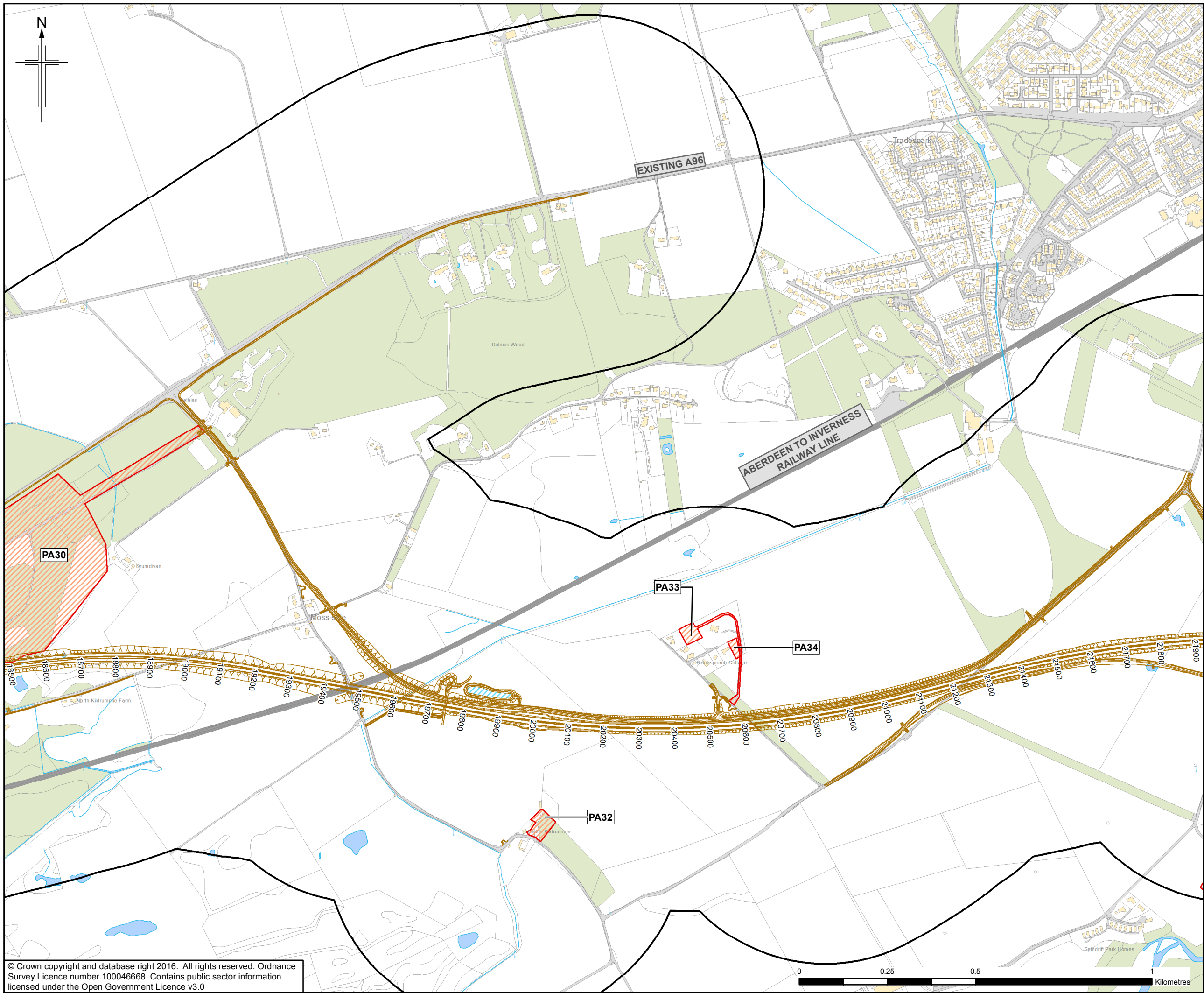

- Legend**
- Proposed Scheme (as per Draft Orders)
 - SUDS (e.g. Basin or Pond)*
 - 500m Study Area
 - Planning Application**

* Actual shape of pond/basin will be subject to detailed design
 ** The Highland Council (as provided June 2016)

Rev.	Rev. Date	ES Position	HM	AN	GK	ENG
0	NOV 2016	ES Position	HM	AN	GK	ENG

JACOBS
 16 Bedford Street, Glasgow, G2 7NK, UK
 Tel: +44(0)141 243 8000 Fax: +44(0)141 226 3109
 www.jacobs.com

Client

 TRANSPORT SCOTLAND
 COMHAIL ALBA

Project

A96
 DUALLING
 INVERNESS TO NAIRN
 (incl. Nairn Bypass)

Drawing title
Figure 15.4h
Environmental Statement
Planning Applications
 Sheet 8 of 12

Drawing Status	FINAL	
Scale	1:10,000 @ A3	DO NOT SCALE
Jacobs No.	B2103500	
BIM No.		
Drawing number	B2103500/EN/EIA/DR/1504h	Rev 0

This drawing is not to be used in whole or part other than for the intended purpose and project as defined on this drawing. Refer to the contract for full terms and conditions.



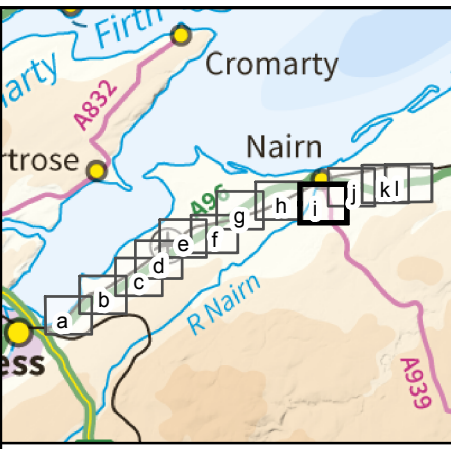
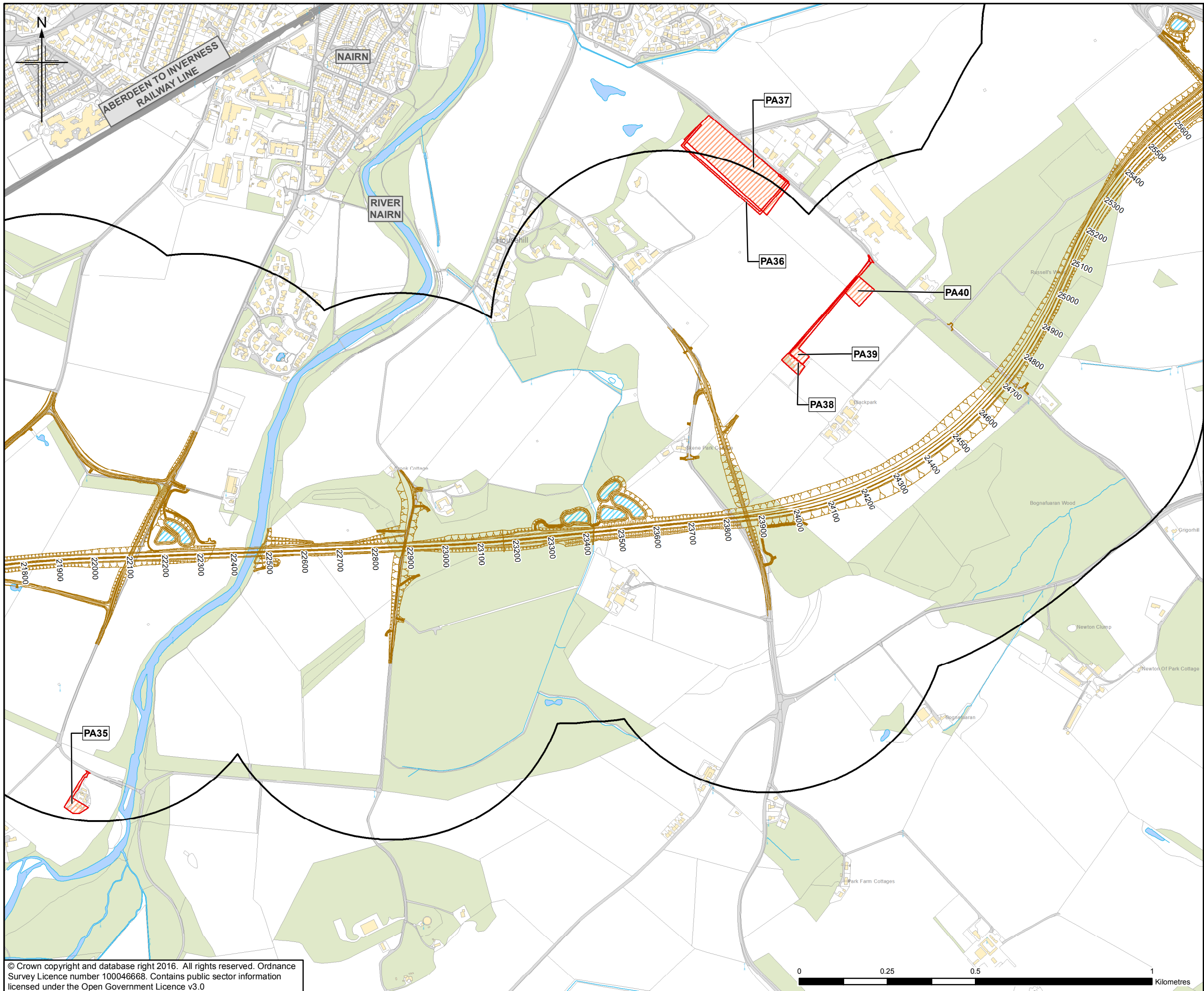

- Legend**
- Proposed Scheme (as per Draft Orders)
 - SUDS (e.g. Basin or Pond)*
 - 500m Study Area
 - Planning Application**

* Actual shape of pond/basin will be subject to detailed design
 ** The Highland Council (as provided June 2016)

Rev.	Rev. Date	Purpose of revision	Orig/Dwn	Checkd	Rev'd	Apprv'd
0	NOV 2016	ES Publication	HM	AN	GK	ENG

JACOBS
 55 Belford Street, Glasgow, G2 7NK, UK
 Tel: +44(0)141 243 8000 Fax: +44(0)141 226 3109
 www.jacobs.com



Drawing title
Figure 15.4i
Environmental Statement
Planning Applications

Drawing Status	FINAL	
Scale	1:10,000 @ A3	DO NOT SCALE
Jacobs No.	B2103500	
BIM No.		
Drawing number	B2103500/EN/EIA/DR/1504i	Rev 0

This drawing is not to be used in whole or part other than for the intended purpose and project as defined on this drawing. Refer to the contract for full terms and conditions.

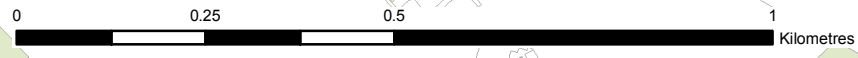

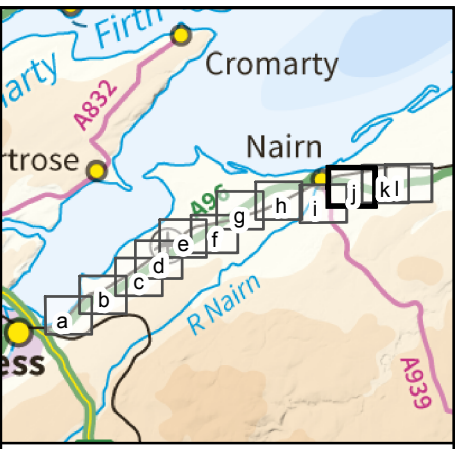
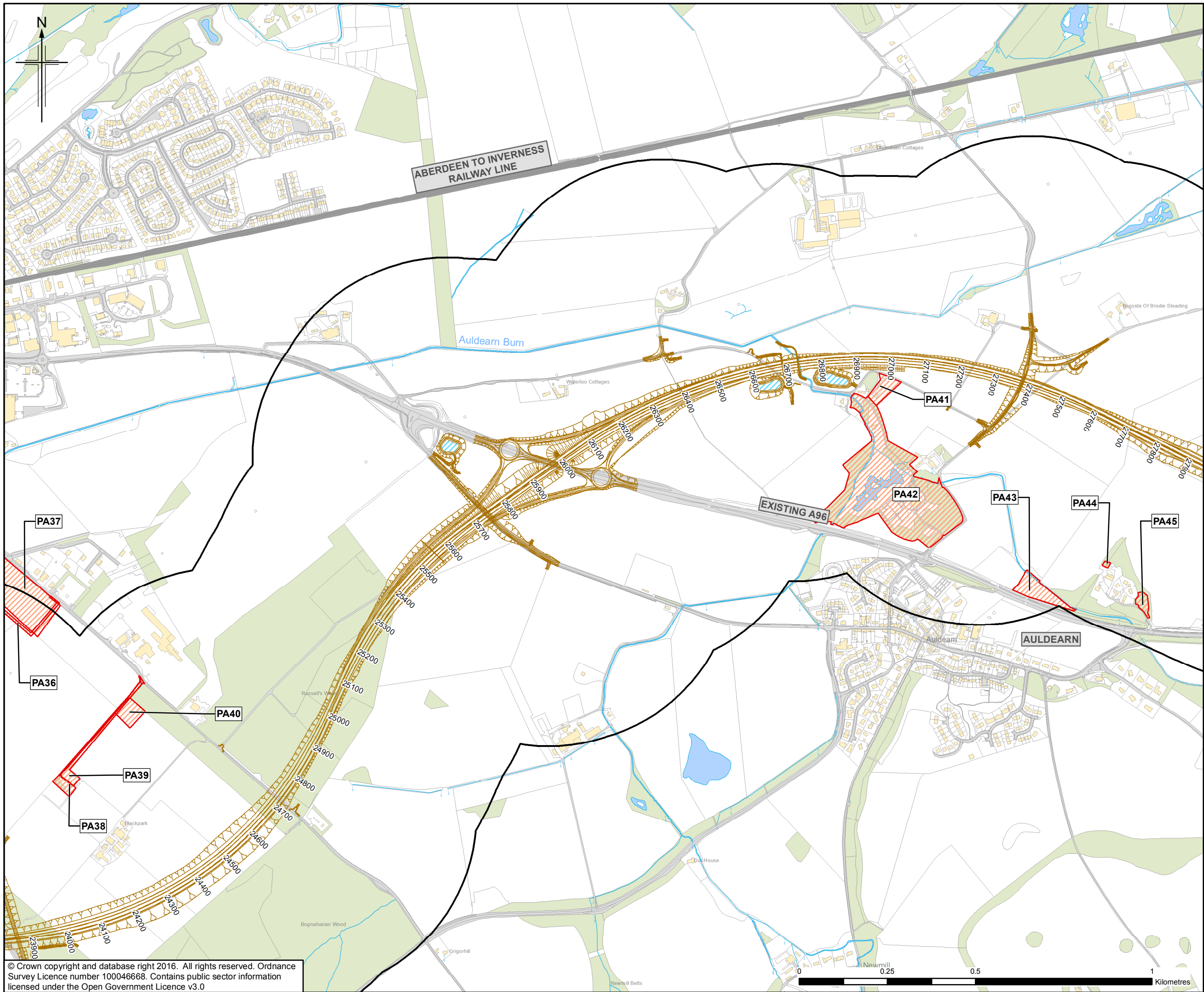

- Legend**
- Proposed Scheme (as per Draft Orders)
 - SUDS (e.g. Basin or Pond)*
 - 500m Study Area
 - Planning Application**

* Actual shape of pond/basin will be subject to detailed design
 ** The Highland Council (as provided June 2016)

Rev.	Rev. Date	Purpose of revision	Orig/Dwn	Check'd	Rev'd	Apprv'd
0	NOV 2016	ES Publication	HM	AN	GK	ENG

JACOBS
 16 Bedford Street, Glasgow, G2 7NK, UK
 Tel: +44(0)141 243 8000 Fax: +44(0)141 226 3109
 www.jacobs.com



Drawing title
**Figure 15.4j
 Environmental Statement
 Planning Applications**

Drawing Status	FINAL	
Scale	1:10,000 @ A3	DO NOT SCALE
Jacobs No.	B2103500	
BIM No.		
Drawing number	B2103500/EN/EIA/DR/1504j	Rev 0

This drawing is not to be used in whole or part other than for the intended purpose and project as defined on this drawing. Refer to the contract for full terms and conditions.

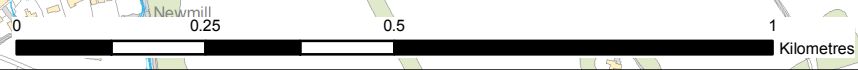

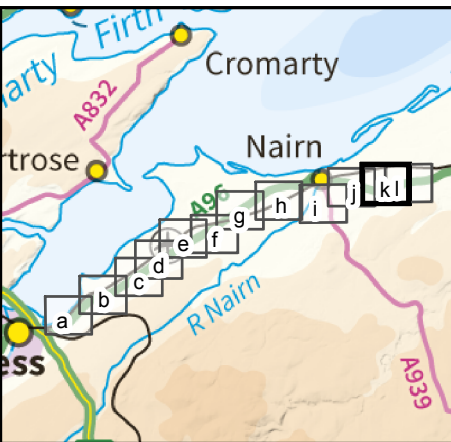
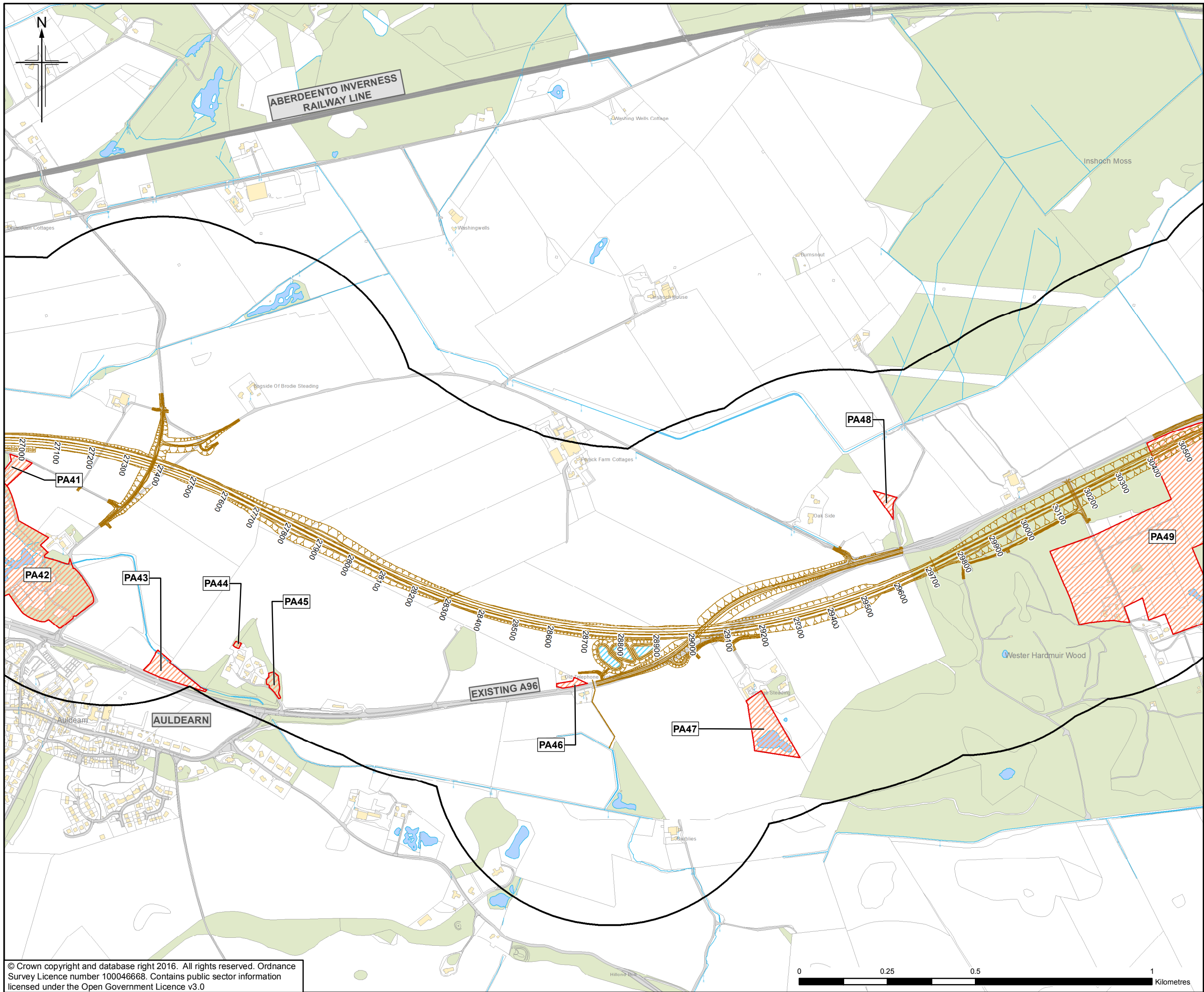

- Legend**
- Proposed Scheme (as per Draft Orders)
 - SUDS (e.g. Basin or Pond)*
 - 500m Study Area
 - Planning Application**

* Actual shape of pond/basin will be subject to detailed design
 ** The Highland Council (as provided June 2016)

Rev.	Rev. Date	ES Position	HM	AN	GK	ENG
0	NOV 2016	ES Position	HM	AN	GK	ENG

JACOBS
 16 Bedford Street, Glasgow, G2 7NK, UK
 Tel: +44(0)141 243 8000 Fax: +44(0)141 226 3109
 www.jacobs.com

Client

 TRANSPORT SCOTLAND
 COMHÀTHAL ALBA

Project

A96
 DUALLING
 INVERNESS TO NAIRN
 (incl. Nairn Bypass)

Drawing title
Figure 15.4k
Environmental Statement
Planning Applications

Drawing Status	FINAL	
Scale	1:10,000 @ A3	DO NOT SCALE
Jacobs No.	B2103500	
BIM No.		
Drawing number	B2103500/EN/EIA/DR/1504k	Rev 0

This drawing is not to be used in whole or part other than for the intended purpose and project as defined on this drawing. Refer to the contract for full terms and conditions.

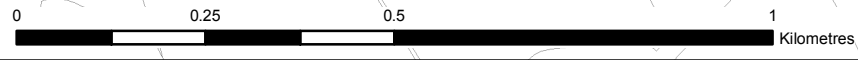

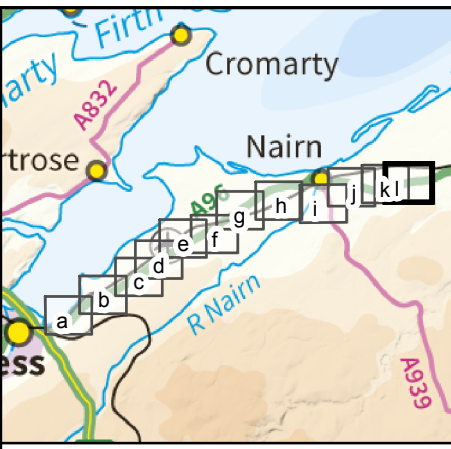
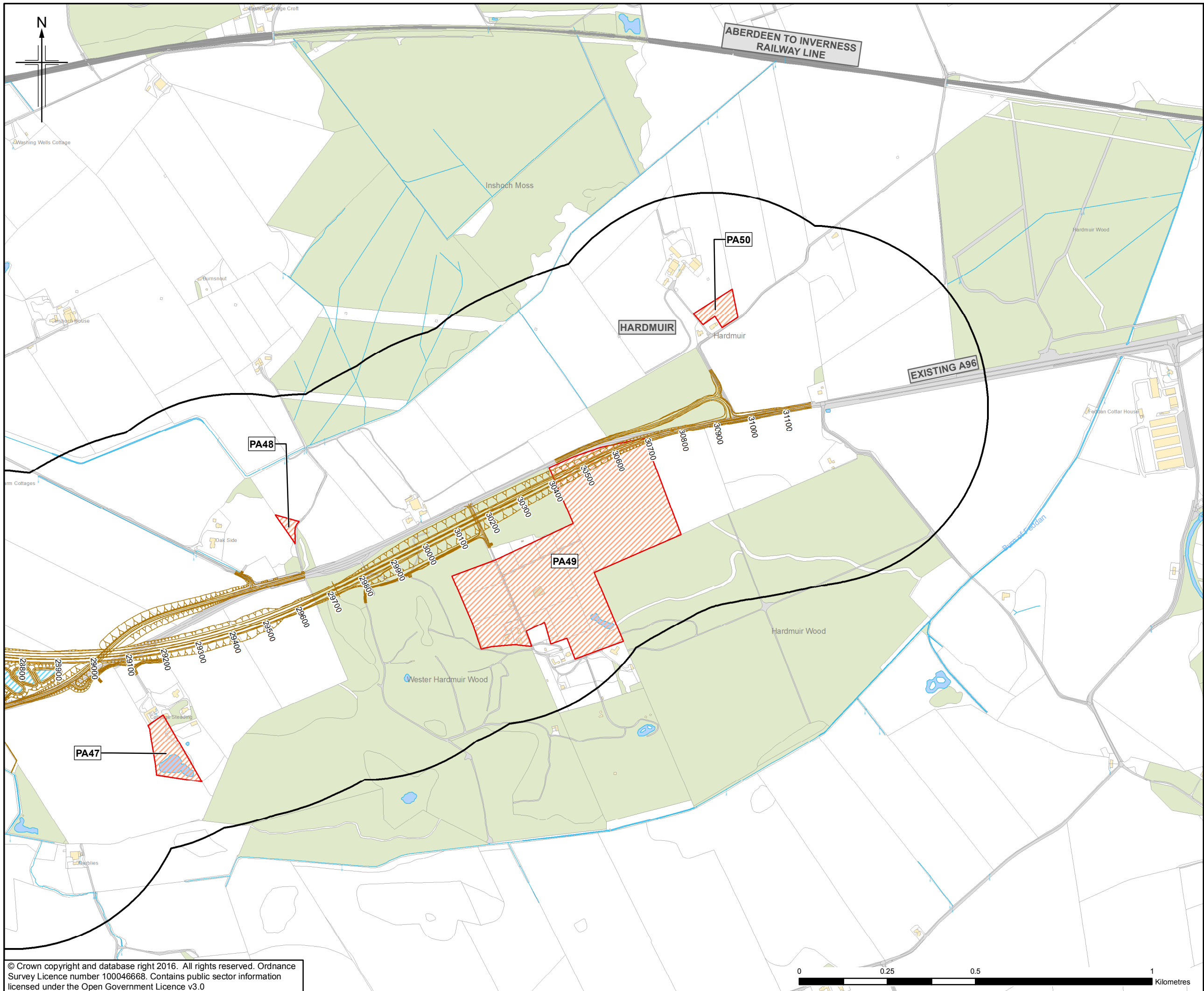

- Legend**
- Proposed Scheme (as per Draft Orders)
 - SUDS (e.g. Basin or Pond)*
 - 500m Study Area
 - Planning Application**

* Actual shape of pond/basin will be subject to detailed design
 ** The Highland Council (as provided June 2016)

Rev.	Rev. Date	Purpose of revision	Orig/Dwn	Checked	Rev'd	Apprv'd
0	NOV 2016	ES Publication	HM	AN	GK	ENG

JACOBS
 55 Belford Street, Glasgow, G2 7NK, UK
 Tel: +44(0)141 243 8000 Fax: +44(0)141 226 3109
 www.jacobs.com



Drawing title
**Figure 15.41
 Environmental Statement
 Planning Applications**

Drawing Status	FINAL		Sheet 12 of 12
Scale	1:10,000 @ A3	DO NOT SCALE	
Jacobs No.	B2103500		
BIM No.			
Drawing number	B2103500/EN/EIA/DR/15041	Rev	0

This drawing is not to be used in whole or part other than for the intended purpose and project as defined on this drawing. Refer to the contract for full terms and conditions.

