

Legend

- Proposed Scheme (as per Draft Orders)
- SUDS (e.g. Basin or Pond)*
- Draft CPO Boundary
- Field Boundary
- Development Land Allocations and Planning Applications**

Land Capability for Agriculture

Land Capable of Supporting Arable Agriculture (Prime Agricultural Land)

- Class 2
- Class 3.1

Land Capable of Supporting Mixed Agriculture

- Class 3.2
- Class 4.1
- Class 4.2

Land Capable of Supporting Improved Grassland

- Class 5.2
- Class 5.3

Land Capable of Supporting only Rough Grazing

- Class 6.2
- Class 7

Other

- Built-up area
- Inland water

Other

- Land Plot Number
- Field Reference

* Actual shape of pond/basin will be subject to detailed design
 ** Inner Moray Firth Local Development Plan (as provided by The Highland Council April 2016)
 Planning Applications provided by The Highland Council (June 2016)

0	NOV 2016	ES Publication	HM	AN	GK	ENG
Rev.	Rev. Date	Purpose of revision	Orig/Dwn	Checkd	Rev'd	Apprv'd

JACOBS
 16 Belford Street, Glasgow, G2 7NK, UK
 Tel: +44(0)141 243 8000 Fax: +44(0)141 228 3109
 www.jacobs.com

Client

TRANSPORT SCOTLAND
 COMHÀTHAL ALBA

Project

A96
DUALLING
 INVERNESS TO NAIRN
 (incl. Nairn Bypass)

Drawing title

Figure 15.6a
Environmental Statement
Proposed Scheme Land-take:
Agricultural and Forestry Land
 Sheet 1 of 12

Drawing Status	FINAL	
Scale	1:10,000 @ A3	DO NOT SCALE
Jacobs No.	B2103500	
BIM No.		
Drawing number	B2103500/EN/EIA/DR/1506a	Rev 0

This drawing is not to be used in whole or part other than for the intended purpose and project as defined on this drawing. Refer to the contract for full terms and conditions.



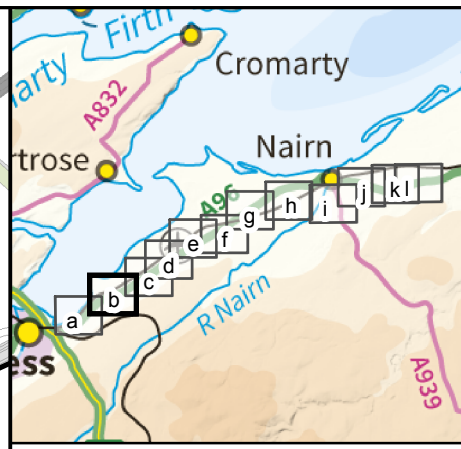
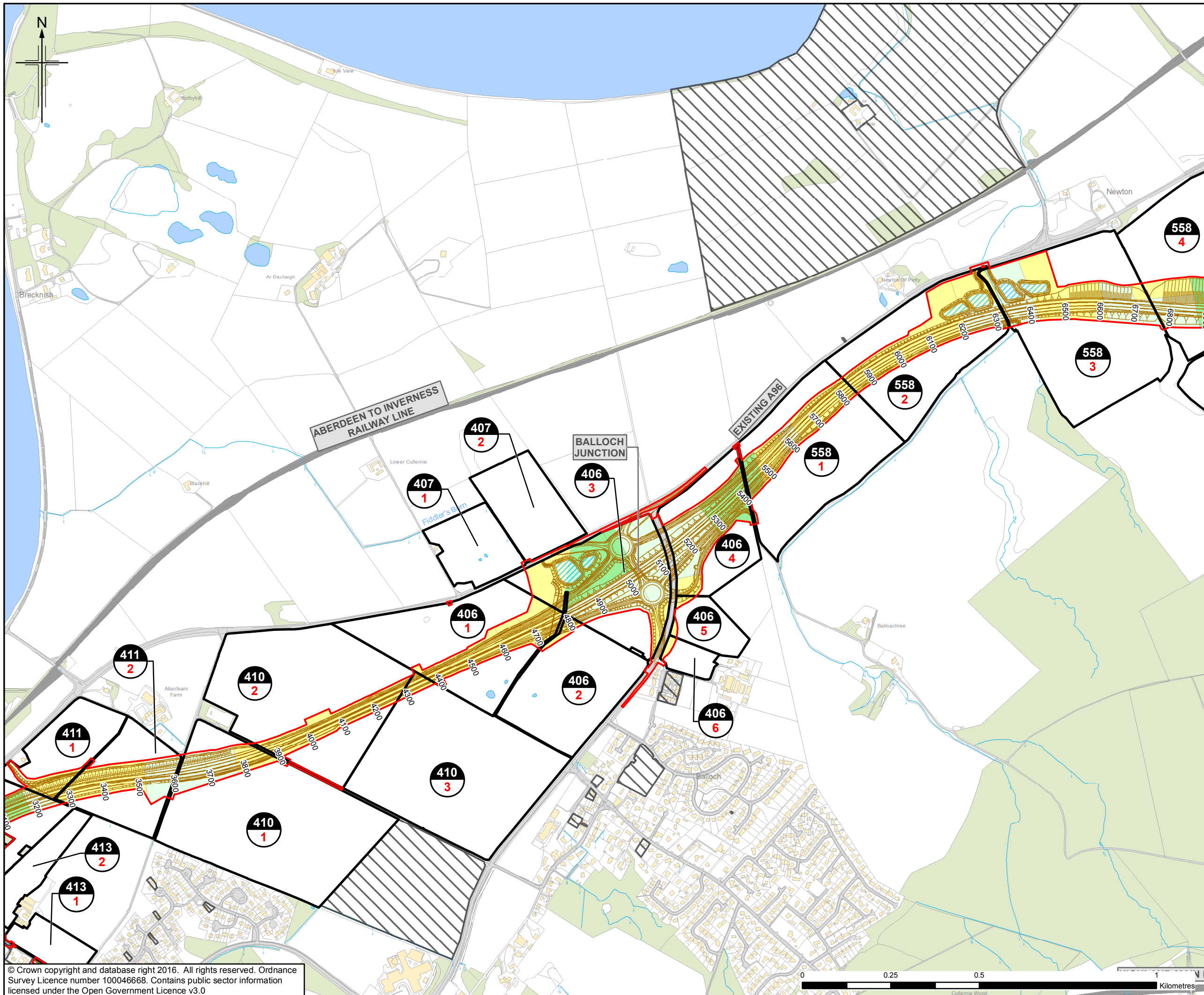

Legend

- Proposed Scheme (as per Draft Orders)
- SUDS (e.g. Basin or Pond)*
- Draft CPO Boundary
- Field Boundary
- Development Land Allocations and Planning Applications**

Land Capability for Agriculture

Land Capable of Supporting Arable Agriculture (Prime Agricultural Land)

- Class 2
- Class 3.1

Land Capable of Supporting Mixed Agriculture

- Class 3.2
- Class 4.1
- Class 4.2

Land Capable of Supporting Improved Grassland

- Class 5.2
- Class 5.3

Land Capable of Supporting only Rough Grazing

- Class 6.2
- Class 7

Other

- Built-up area
- Inland water

Land Plot Number (e.g., 407, 406, 410, 411, 413, 558)

Field Reference (e.g., 1, 2, 3, 4, 5, 6)

* Actual shape of pond/basin will be subject to detailed design

** Inner Moray Firth Local Development Plan (as provided by The Highland Council April 2016)
Planning Applications provided by The Highland Council (June 2016)

Rev.	Rev. Date	Purpose of revision	Orig/Dwn	Check'd	Rev'd	Appr'd
0	NOV 2016	ES Publication	HM	AN	GK	ENG

JACOBS
 66 Belford Street, Glasgow, G2 7NK, UK
 Tel: +44(0)141 243 8000 Fax: +44(0)141 228 3109
 www.jacobs.com

Client: **TRANSPORT SCOTLAND**
 COMHDAIL ALBA

Project: **A96 DUALLING**
 INVERNESS TO NAIRN
 (incl. Nairn Bypass)

Drawing title: **Figure 15.6b**
Environmental Statement
Proposed Scheme Land-take:
Agricultural and Forestry Land
 Sheet 2 of 12

Drawing Status	FINAL	
Scale	1:10,000 @ A3	DO NOT SCALE
Jacobs No.	B2103500	
BIM No.		
Drawing number	B2103500/EN/EIA/DR/1506b	Rev 0

This drawing is not to be used in whole or part other than for the intended purpose and project as defined on this drawing. Refer to the contract for full terms and conditions.

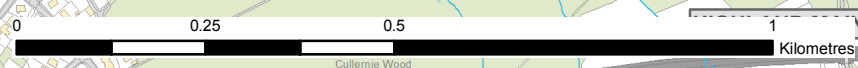

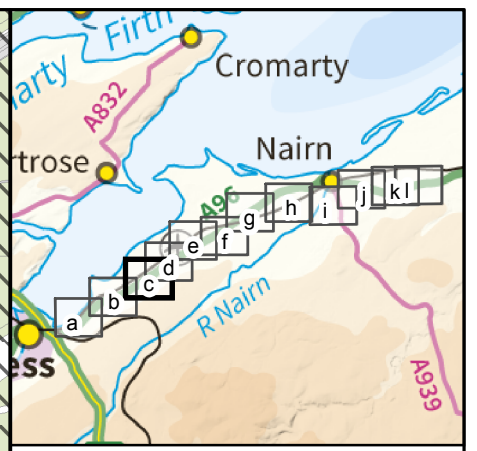
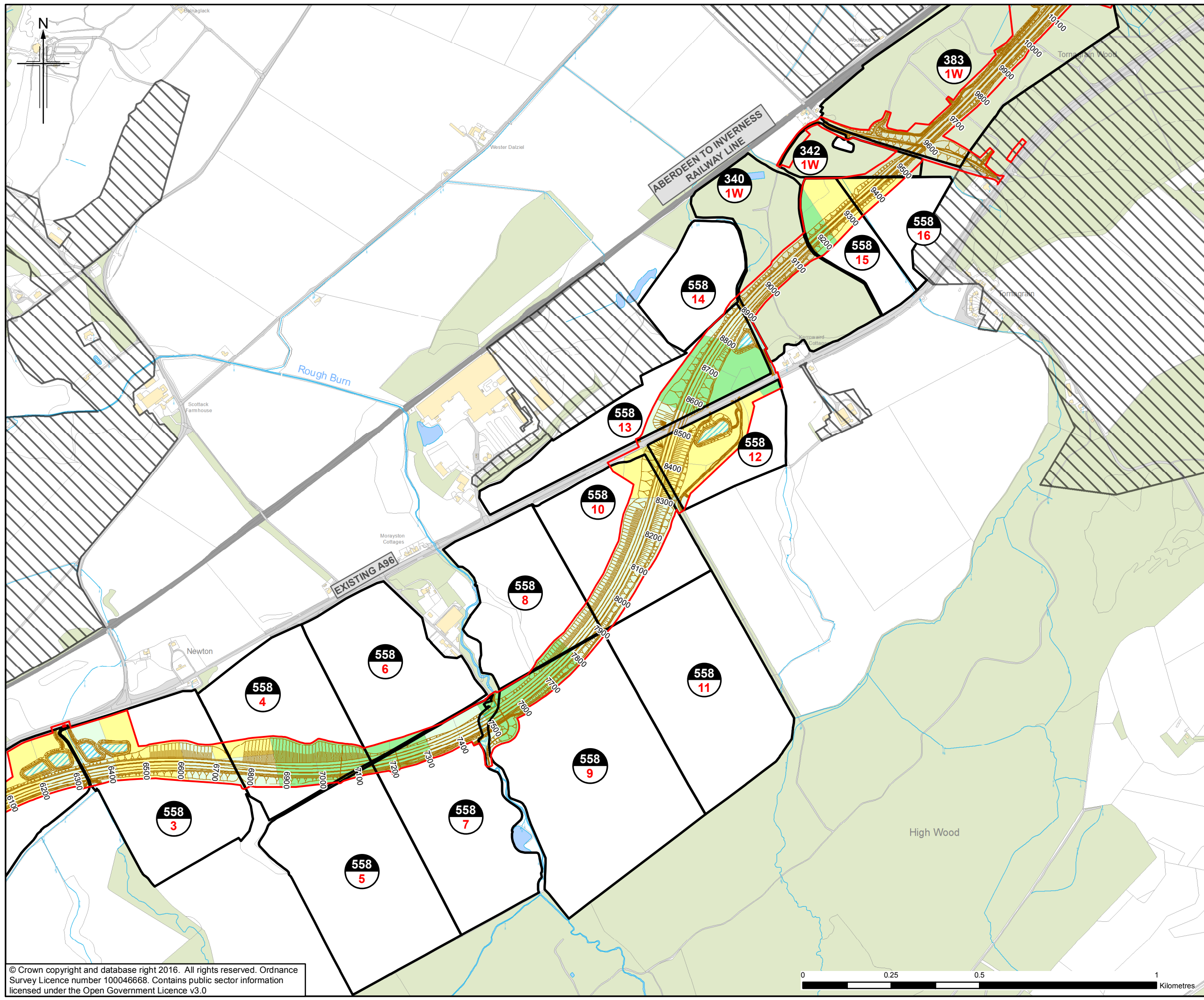

Legend

- Proposed Scheme (as per Draft Orders)
- SUDS (e.g. Basin or Pond)*
- Draft CPO Boundary
- Field Boundary
- Development Land Allocations and Planning Applications**

Land Capability for Agriculture

Land Capable of Supporting Arable Agriculture (Prime Agricultural Land)

- Class 2
- Class 3.1

Land Capable of Supporting Mixed Agriculture

- Class 3.2
- Class 4.1
- Class 4.2

Land Capable of Supporting Improved Grassland

- Class 5.2
- Class 5.3

Land Capable of Supporting only Rough Grazing

- Class 6.2
- Class 7

Other

- Built-up area
- Inland water
- Land Plot Number
- Field Reference

* Actual shape of pond/basin will be subject to detailed design
 ** Inner Moray Firth Local Development Plan (as provided by The Highland Council April 2016)
 Planning Applications provided by The Highland Council (June 2016)

Rev.	Rev. Date	Purpose of revision	Orig/Dwn	Checkd	Rev'd	Apprv'd
0	NOV 2016	ES Position	HM	AN	GK	ENG

JACOBS
 16 Bedford Street, Glasgow, G2 7NK, UK
 Tel: +44(0)141 243 8000 Fax: +44(0)141 226 3109
 www.jacobs.com

Client

 TRANSPORT SCOTLAND
 COMHDAIL ALBA

Project

A96
 DUALLING
 INVERNESS TO NAIRN
 (incl. Nairn Bypass)

Drawing title
Figure 15.6c
Environmental Statement
Proposed Scheme Land-take:
Agricultural and Forestry Land
 Sheet 3 of 12

Drawing Status	FINAL	
Scale	1:10,000 @ A3	DO NOT SCALE
Jacobs No.	B2103500	
BIM No.		
Drawing number	B2103500/EN/EIA/DR/1506c	Rev 0

This drawing is not to be used in whole or part other than for the intended purpose and project as defined on this drawing. Refer to the contract for full terms and conditions.



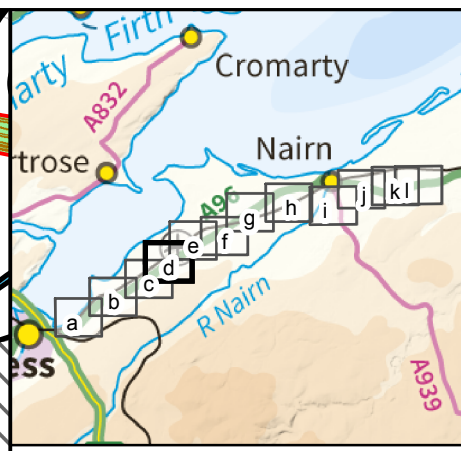
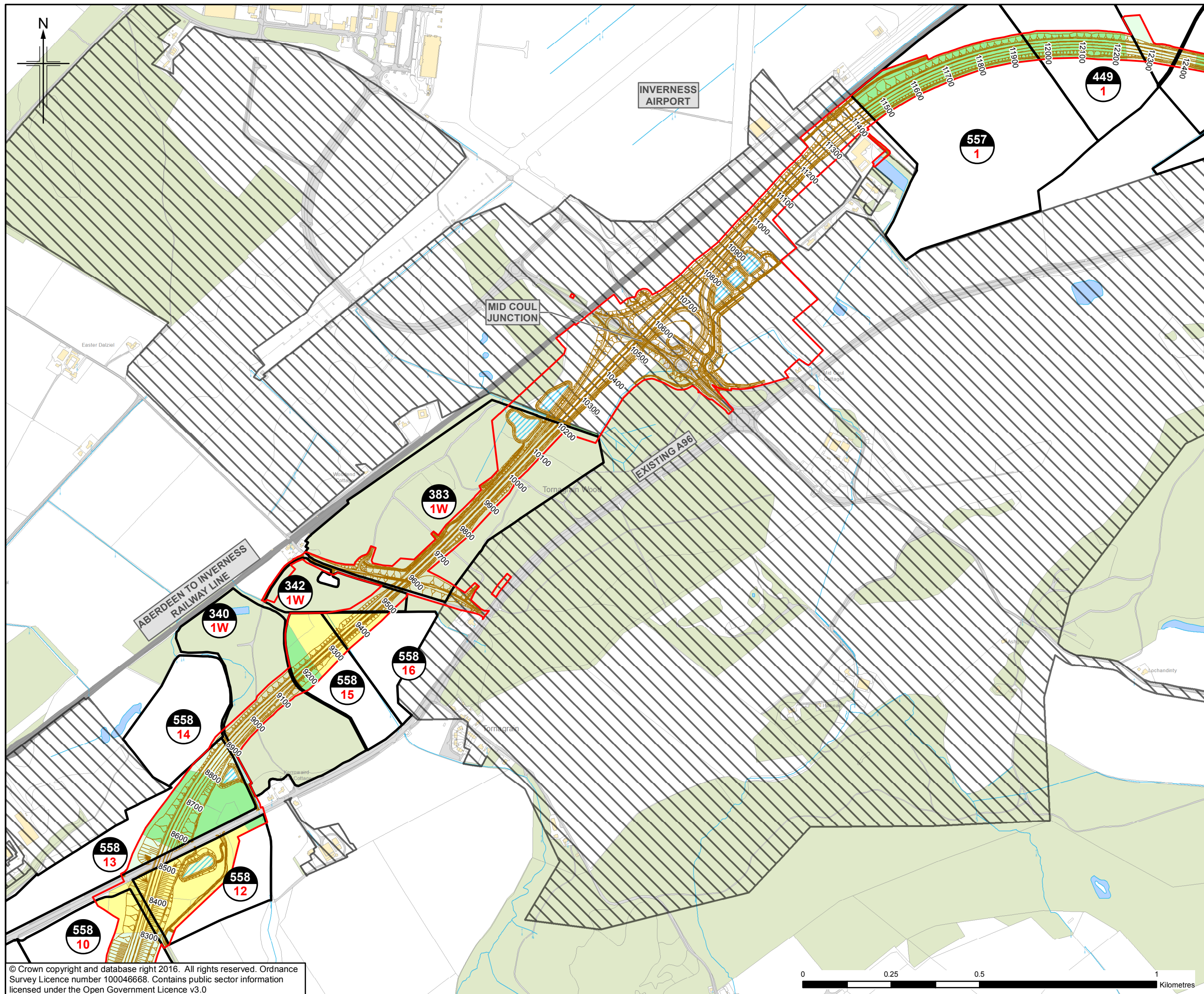

Legend

- Proposed Scheme (as per Draft Orders)
- SUDS (e.g. Basin or Pond)*
- Draft CPO Boundary
- Field Boundary
- Development Land Allocations and Planning Applications**

Land Capability for Agriculture

Land Capable of Supporting Arable Agriculture (Prime Agricultural Land)

- Class 2
- Class 3.1

Land Capable of Supporting Mixed Agriculture

- Class 3.2
- Class 4.1
- Class 4.2

Land Capable of Supporting Improved Grassland

- Class 5.2
- Class 5.3

Land Capable of Supporting only Rough Grazing

- Class 6.2
- Class 7

Other

- Built-up area
- Inland water

Land Plot Number (4)

Field Reference (1)

* Actual shape of pond/basin will be subject to detailed design
 ** Inner Moray Firth Local Development Plan (as provided by The Highland Council April 2016)
 Planning Applications provided by The Highland Council (June 2016)

Rev.	Rev. Date	Purpose of revision	Orig/Dwn	Checkd	Rev'd	Apprv'd
0	NOV 2016	ES Publication	HM	AN	GK	ENG

JACOBS
 16 Bedford Street, Glasgow, G2 7NK, UK
 Tel: +44(0)141 243 8000 Fax: +44(0)141 226 3109
 www.jacobs.com

Client

TRANSPORT SCOTLAND
COMHDAIL ALBA

Project

A96
DUALLING
INVERNESS TO NAIRN
(incl. Nairn Bypass)

Drawing title

Figure 15.6d
Environmental Statement
Proposed Scheme Land-take:
Agricultural and Forestry Land
 Sheet 4 of 12

Drawing Status	FINAL	
Scale	1:10,000 @ A3	DO NOT SCALE
Jacobs No.	B2103500	
BIM No.		
Drawing number	B2103500/EN/EIA/DR/1506d	Rev 0

This drawing is not to be used in whole or part other than for the intended purpose and project as defined on this drawing. Refer to the contract for full terms and conditions.

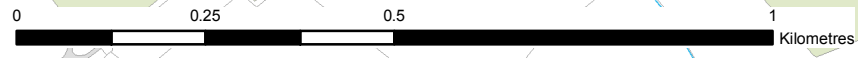

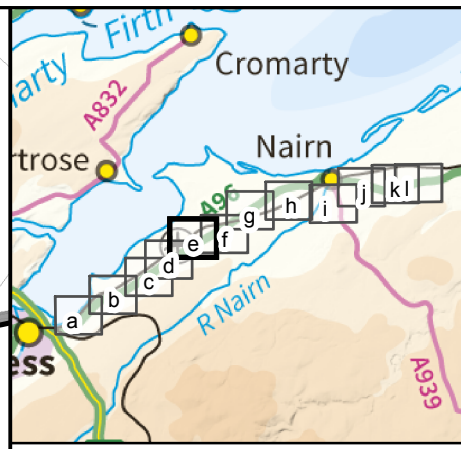
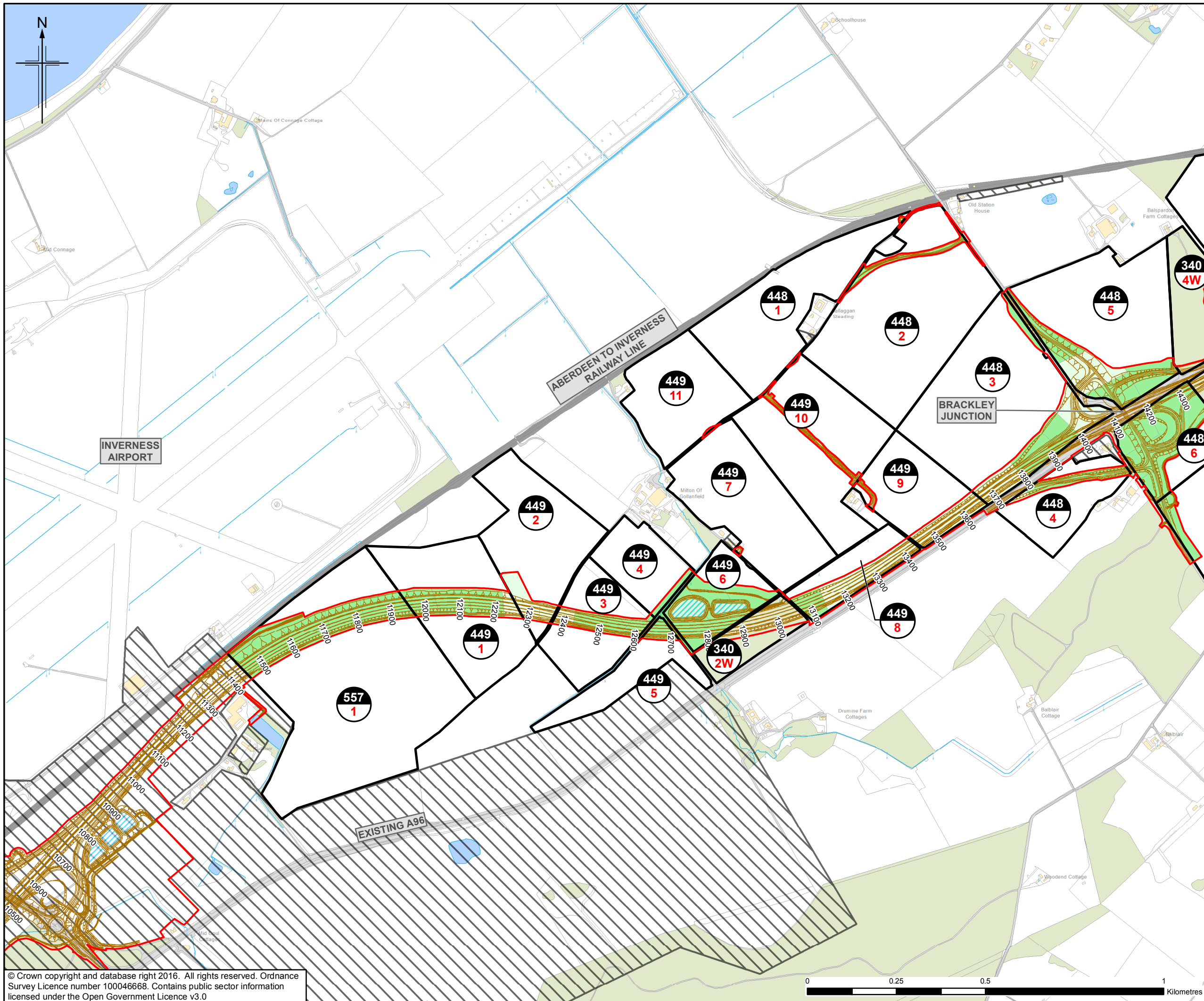

Legend

- Proposed Scheme (as per Draft Orders)
- SUDS (e.g. Basin or Pond)*
- Draft CPO Boundary
- Field Boundary
- Development Land Allocations and Planning Applications**

Land Capability for Agriculture

Land Capable of Supporting Arable Agriculture (Prime Agricultural Land)

- Class 2
- Class 3.1

Land Capable of Supporting Mixed Agriculture

- Class 3.2
- Class 4.1
- Class 4.2

Land Capable of Supporting Improved Grassland

- Class 5.2
- Class 5.3

Land Capable of Supporting only Rough Grazing

- Class 6.2
- Class 7

Other

- Built-up area
- Inland water

4 = Land Plot Number
1 = Field Reference

* Actual shape of pond/basin will be subject to detailed design
** Inner Moray Firth Local Development Plan (as provided by The Highland Council April 2016)
Planning Applications provided by The Highland Council (June 2016)

Rev.	Rev. Date	Purpose of revision	Orig/Dwn	Checkd	Rev'd	Apprv'd
0	NOV 2016	ES Publication	HM	AN	GK	ENG

JACOBS
 16 Belford Street, Glasgow, G2 7NK, UK
 Tel: +44(0)141 243 8000 Fax: +44(0)141 226 3109
 www.jacobs.com

Client

TRANSPORT SCOTLAND
COMHÀTHAL ALBA

Project

A96
DUALLING
INVERNESS TO NAIRN
(incl. Nairn Bypass)

Drawing title

Figure 15.6e
Environmental Statement
Proposed Scheme Land-take:
Agricultural and Forestry Land
 Sheet 5 of 12

Drawing Status	FINAL		
Scale	1:10,000	@ A3	DO NOT SCALE
Jacobs No.	B2103500		
BIM No.			
Drawing number	B2103500/EN/EIA/DR/1506e		Rev 0

This drawing is not to be used in whole or part other than for the intended purpose and project as defined on this drawing. Refer to the contract for full terms and conditions.



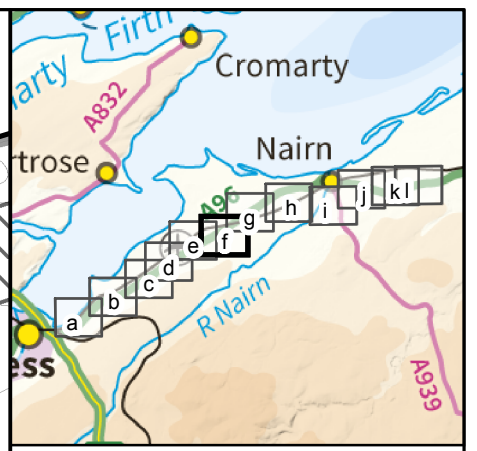
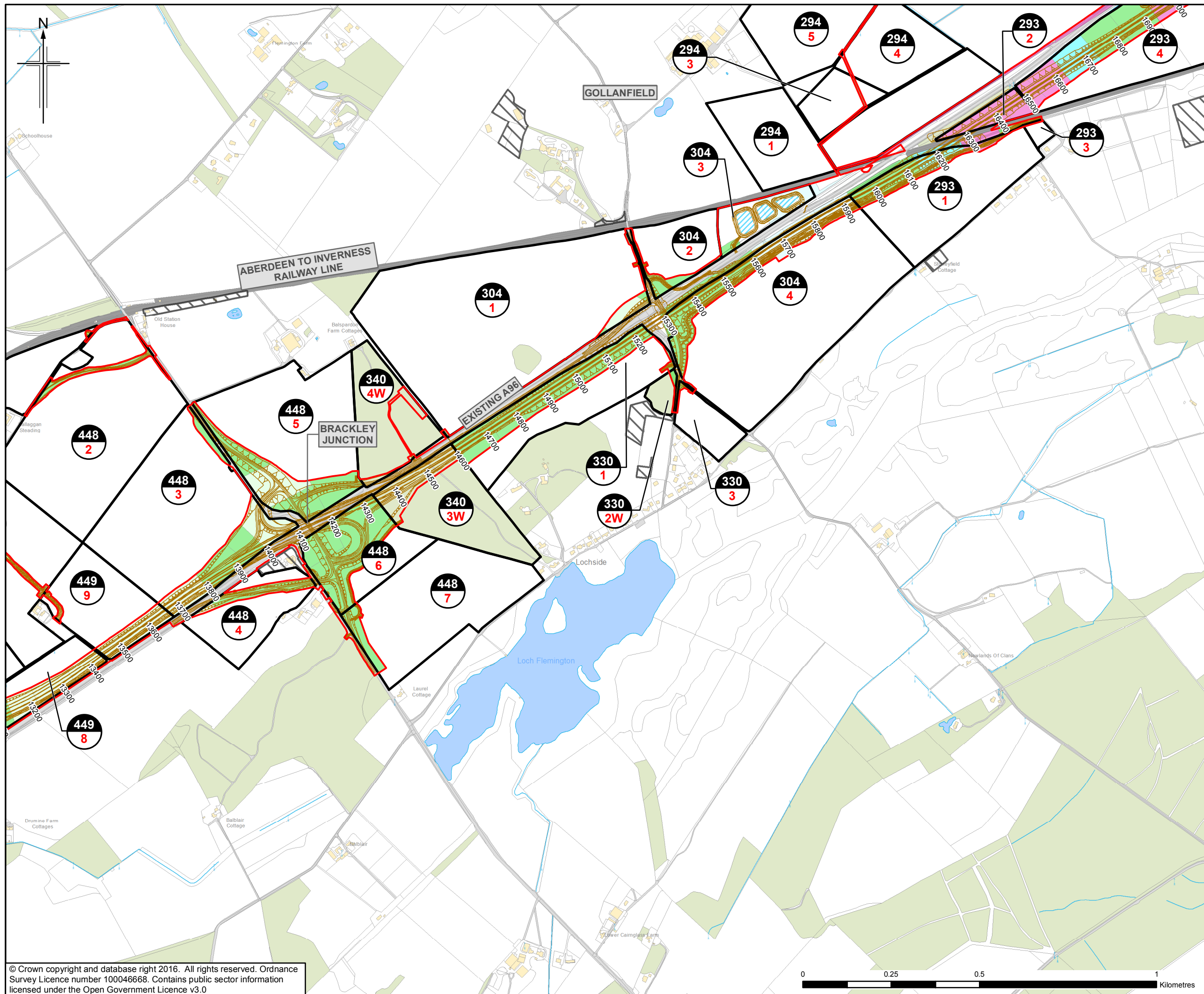

Legend

- Proposed Scheme (as per Draft Orders)
- SUDS (e.g. Basin or Pond)*
- Draft CPO Boundary
- Field Boundary
- Development Land Allocations and Planning Applications**

Land Capability for Agriculture

Land Capable of Supporting Arable Agriculture (Prime Agricultural Land)

- Class 2
- Class 3.1

Land Capable of Supporting Mixed Agriculture

- Class 3.2
- Class 4.1
- Class 4.2

Land Capable of Supporting Improved Grassland

- Class 5.2
- Class 5.3

Land Capable of Supporting only Rough Grazing

- Class 6.2
- Class 7

Other

- Built-up area
- Inland water

4 Land Plot Number
1 Field Reference

* Actual shape of pond/basin will be subject to detailed design
** Inner Moray Firth Local Development Plan (as provided by The Highland Council April 2016)
Planning Applications provided by The Highland Council (June 2016)

0	NOV 2016	ES Position	HM	AN	GK	ENG
Rev.	Rev. Date	Purpose of revision	Orig/Dwn	Checked	Rev'd	Appr'd

JACOBS
16 Bedford Street, Glasgow, G2 7NK, UK
Tel: +44(0)141 243 8000 Fax: +44(0)141 226 3109
www.jacobs.com

Client: **TRANSPORT SCOTLAND**
COMHDAIL ALBA

Project: **A96 DUALLING**
INVERNESS TO NAIRN
(incl. Nairn Bypass)

Drawing title: **Figure 15.6f**
Environmental Statement
Proposed Scheme Land-take:
Agricultural and Forestry Land
Sheet 6 of 12

Drawing Status	FINAL	
Scale	1:10,000 @ A3	DO NOT SCALE
Jacobs No.	B2103500	
BIM No.		
Drawing number	B2103500/EN/EIA/DR/1506f	Rev 0

This drawing is not to be used in whole or part other than for the intended purpose and project as defined on this drawing. Refer to the contract for full terms and conditions.

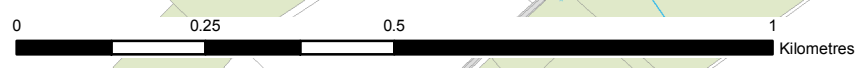

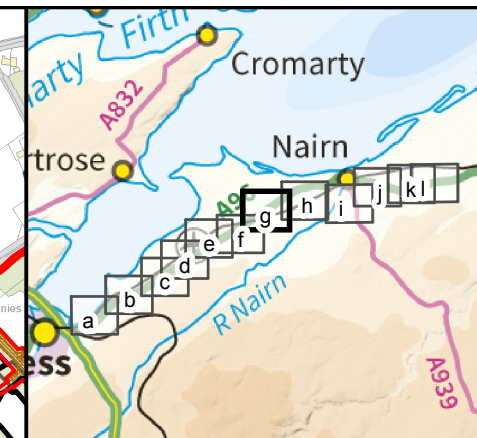
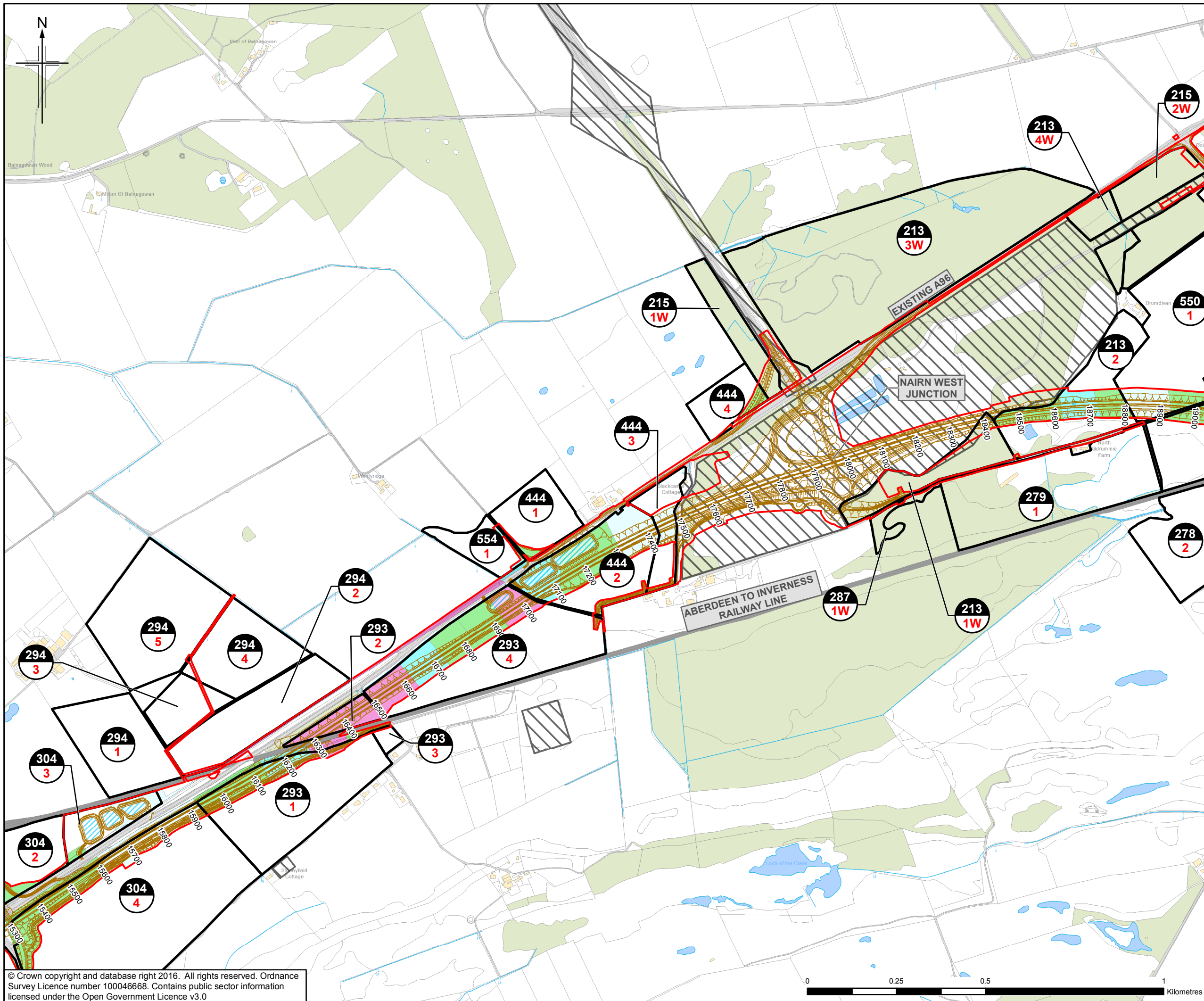

Legend

- Proposed Scheme (as per Draft Orders)
- SUDS (e.g. Basin or Pond)*
- Draft CPO Boundary
- Field Boundary
- Development Land Allocations and Planning Applications**

Land Capability for Agriculture

Land Capable of Supporting Arable Agriculture (Prime Agricultural Land)

- Class 2
- Class 3.1

Land Capable of Supporting Mixed Agriculture

- Class 3.2
- Class 4.1
- Class 4.2

Land Capable of Supporting Improved Grassland

- Class 5.2
- Class 5.3

Land Capable of Supporting only Rough Grazing

- Class 6.2
- Class 7

Other

- Built-up area
- Inland water
- Land Plot Number
- Field Reference

* Actual shape of pond/basin will be subject to detailed design
 ** Inner Moray Firth Local Development Plan (as provided by The Highland Council April 2016)
 Planning Applications provided by The Highland Council (June 2016)

Rev.	Rev. Date	Purpose of revision	Orig/Dwn	Checkd	Rev'd	Apprv'd
0	NOV 2016	ES Publication	HM	AN	GK	ENG

JACOBS
 16 Belford Street, Glasgow, G2 7NK, UK
 Tel: +44(0)141 243 8000 Fax: +44(0)141 226 3109
 www.jacobs.com

Client: **TRANSPORT SCOTLAND**
 COMHDAIL ALBA

Project: **A95 DUALLING**
 INVERNESS TO NAIRN
 (incl. Nairn Bypass)

Drawing title: **Figure 15.6g**
Environmental Statement
Proposed Scheme Land-take:
Agricultural and Forestry Land
 Sheet 7 of 12

Drawing Status	FINAL	
Scale	1:10,000 @ A3	DO NOT SCALE
Jacobs No.	B2103500	
BIM No.		
Drawing number	B2103500/EN/EIA/DR/1506g	Rev 0

This drawing is not to be used in whole or part other than for the intended purpose and project as defined on this drawing. Refer to the contract for full terms and conditions.



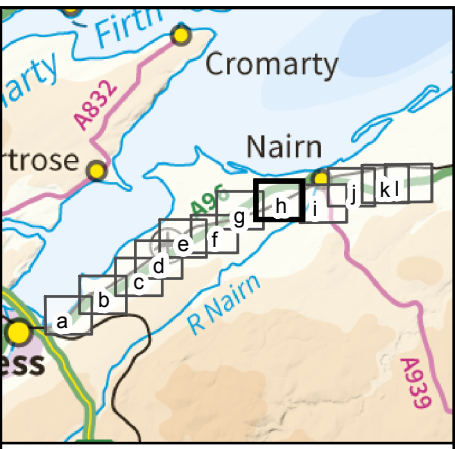
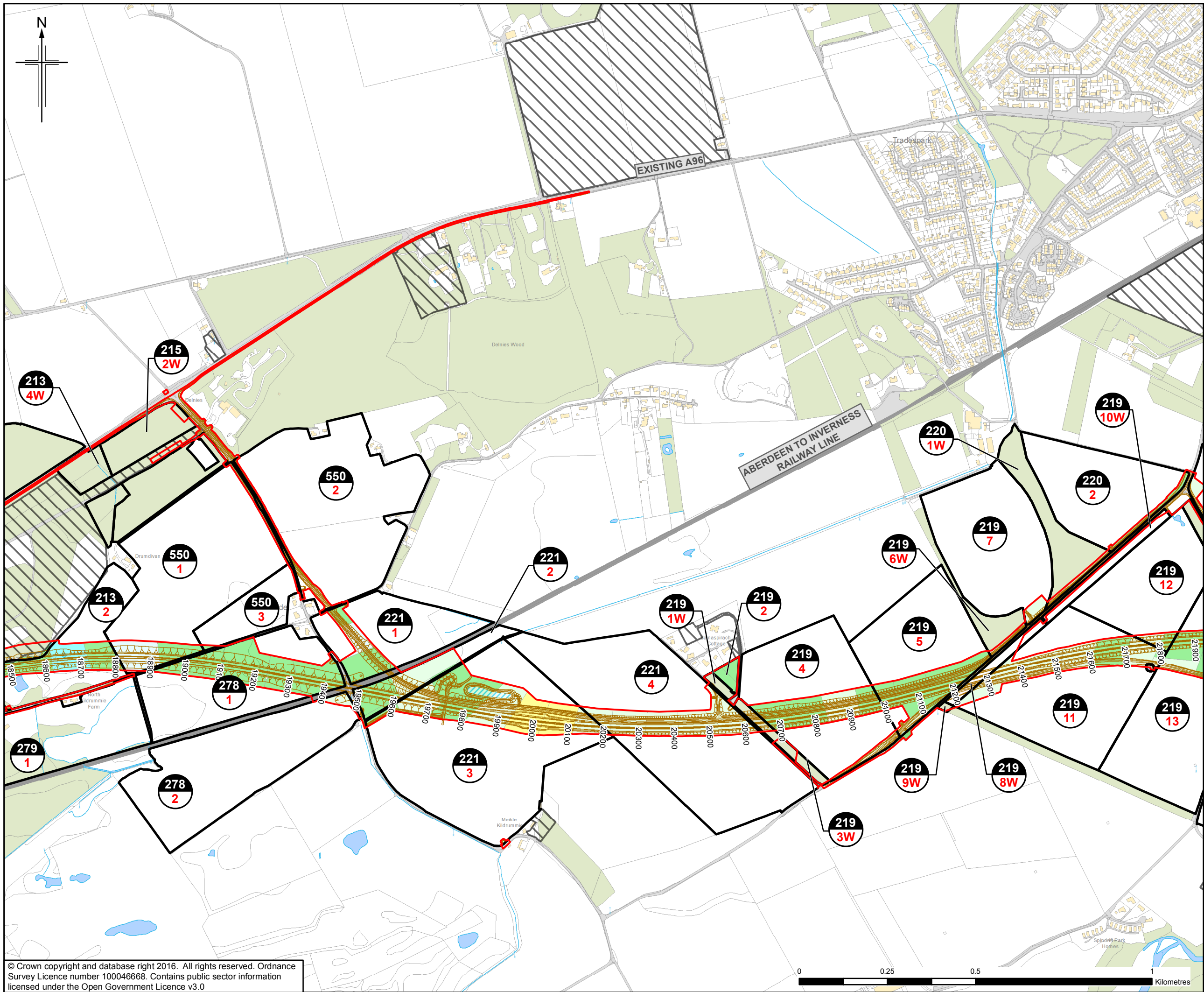

Legend

- Proposed Scheme (as per Draft Orders)
- SUDS (e.g. Basin or Pond)*
- Draft CPO Boundary
- Field Boundary
- Development Land Allocations and Planning Applications**

Land Capability for Agriculture

Land Capable of Supporting Arable Agriculture (Prime Agricultural Land)

- Class 2
- Class 3.1

Land Capable of Supporting Mixed Agriculture

- Class 3.2
- Class 4.1
- Class 4.2

Land Capable of Supporting Improved Grassland

- Class 5.2
- Class 5.3

Land Capable of Supporting only Rough Grazing

- Class 6.2
- Class 7

Other

- Built-up area
- Inland water

4 = Land Plot Number
1 = Field Reference

* Actual shape of pond/basin will be subject to detailed design
** Inner Moray Firth Local Development Plan (as provided by The Highland Council April 2016)
Planning Applications provided by The Highland Council (June 2016)

Rev.	Rev. Date	Purpose of revision	Orig/Dwn	Checkd	Rev'd	Apprv'd
0	NOV 2016	ES Publication	HM	AN	GK	ENG

JACOBS
16 Bedford Street, Glasgow, G2 7NK, UK
Tel: +44(0)141 243 8000 Fax: +44(0)141 228 3109
www.jacobs.com

Client
TRANSPORT SCOTLAND
COMHDAIL ALBA

Project
A96 DUALLING
INVERNESS TO NAIRN
(incl. Nairn Bypass)

Drawing title
Figure 15.6h
Environmental Statement
Proposed Scheme Land-take:
Agricultural and Forestry Land
Sheet 8 of 12

Drawing Status: FINAL
Scale: 1:10,000 @ A3 DO NOT SCALE
Jacobs No.: B2103500
BIM No.:
Drawing number: B2103500/EN/EIA/DR/1506h Rev 0

This drawing is not to be used in whole or part other than for the intended purpose and project as defined on this drawing. Refer to the contract for full terms and conditions.



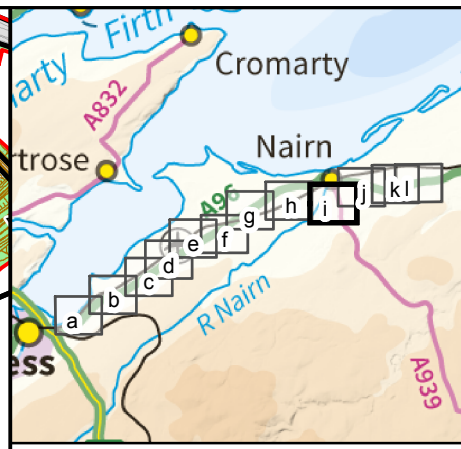
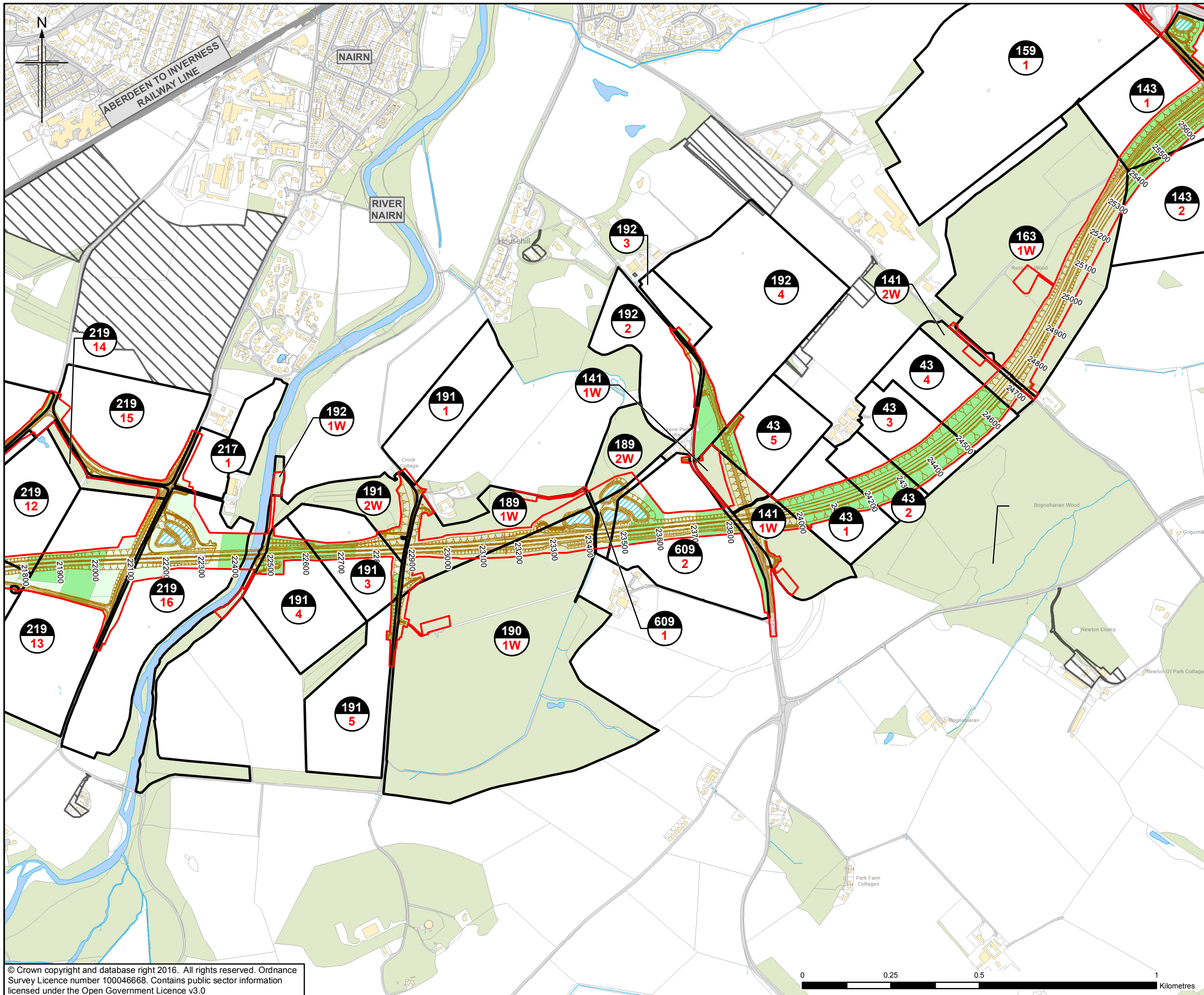

Legend

- Proposed Scheme (as per Draft Orders)
- SUDS (e.g. Basin or Pond)*
- Draft CPO Boundary
- Field Boundary
- Development Land Allocations and Planning Applications**

Land Capability for Agriculture

Land Capable of Supporting Arable Agriculture (Prime Agricultural Land)

- Class 2
- Class 3.1

Land Capable of Supporting Mixed Agriculture

- Class 3.2
- Class 4.1
- Class 4.2

Land Capable of Supporting Improved Grassland

- Class 5.2
- Class 5.3

Land Capable of Supporting only Rough Grazing

- Class 6.2
- Class 7

Other

- Built-up area
- Inland water
- Land Plot Number
- Field Reference

* Actual shape of pond/basin will be subject to detailed design
 ** Inner Moray Firth Local Development Plan (as provided by The Highland Council April 2016)
 Planning Applications provided by The Highland Council (June 2016)

Rev.	Rev. Date	Purpose of revision	Orig/Dwn	Checkd	Rev'd	Apprv'd
0	NOV 2016	ES Publication	HM	AN	GK	ENG

JACOBS
 55 Belford Street, Glasgow, G2 7NK, UK
 Tel: +44(0)141 243 8000 Fax: +44(0)141 226 3109
 www.jacobs.com



Drawing title

Figure 15.6i
Environmental Statement
Proposed Scheme Land-take:
Agricultural and Forestry Land
 Sheet 9 of 12

Drawing Status: FINAL

Scale: 1:10,000 @ A3 DO NOT SCALE

Jacobs No. B2103500

BIM No.

Drawing number: B2103500/EN/EIA/DR/1506i Rev 0

This drawing is not to be used in whole or part other than for the intended purpose and project as defined on this drawing. Refer to the contract for full terms and conditions.



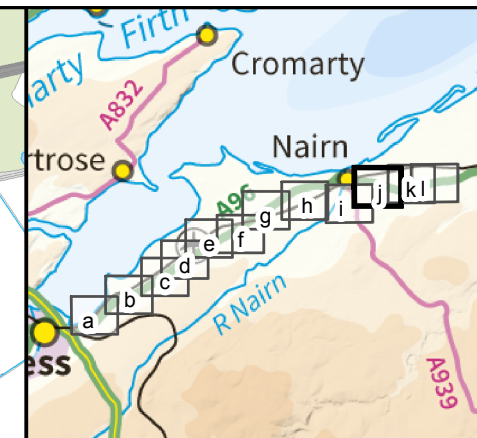
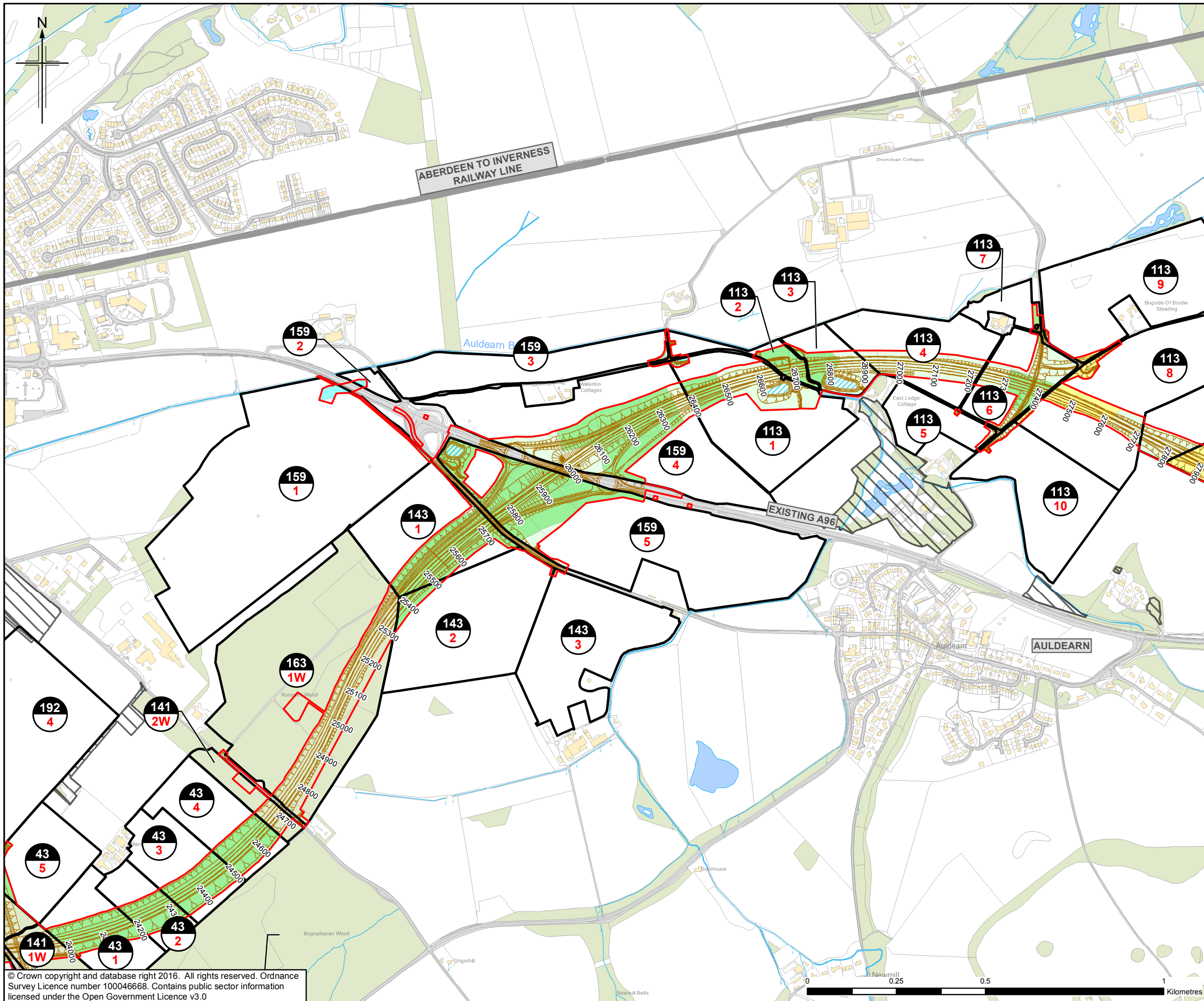

Legend

- Proposed Scheme (as per Draft Orders)
- SUDS (e.g. Basin or Pond)*
- Draft CPO Boundary
- Field Boundary
- Development Land Allocations and Planning Applications**

Land Capability for Agriculture

Land Capable of Supporting Arable Agriculture (Prime Agricultural Land)

- Class 2
- Class 3.1

Land Capable of Supporting Mixed Agriculture

- Class 3.2
- Class 4.1
- Class 4.2

Land Capable of Supporting Improved Grassland

- Class 5.2
- Class 5.3

Land Capable of Supporting only Rough Grazing

- Class 6.2
- Class 7

Other

- Built-up area
- Inland water
- Land Plot Number
- Field Reference

* Actual shape of pond/basin will be subject to detailed design
 ** Inner Moray Firth Local Development Plan (as provided by The Highland Council April 2016)
 Planning Applications provided by The Highland Council (June 2016)

Rev.	Rev. Date	Purpose of revision	Orig/Dwn	Checkd	Rev'd	Apprv'd
0	NOV 2016	ES Publication	HM	AN	GK	ENG

JACOBS
 66 Belford Street, Glasgow, G2 7NK, UK
 Tel: +44(0)141 243 8000 Fax: +44(0)141 226 3109
 www.jacobs.com

Client: **TRANSPORT SCOTLAND**
 COMHDAIL ALBA

Project: **A96 DUALLING**
 INVERNESS TO NAIRN
 (incl. Nairn Bypass)

Drawing title: **Figure 15.6j**
Environmental Statement
Proposed Scheme Land-take:
Agricultural and Forestry Land
 Sheet 10 of 12

Drawing Status	FINAL	
Scale	1:10,000 @ A3	DO NOT SCALE
Jacobs No.	B2103500	
BIM No.		
Drawing number	B2103500/EN/EIA/DR/1506j	Rev 0

This drawing is not to be used in whole or part other than for the intended purpose and project as defined on this drawing. Refer to the contract for full terms and conditions.

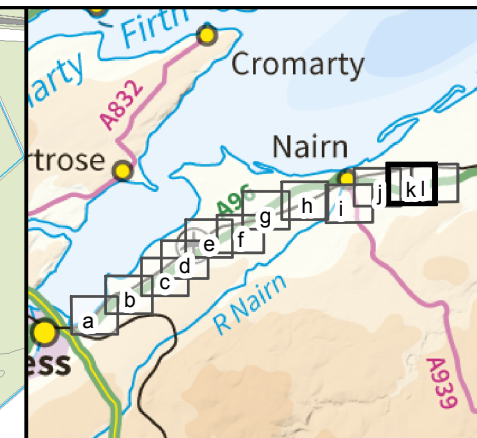
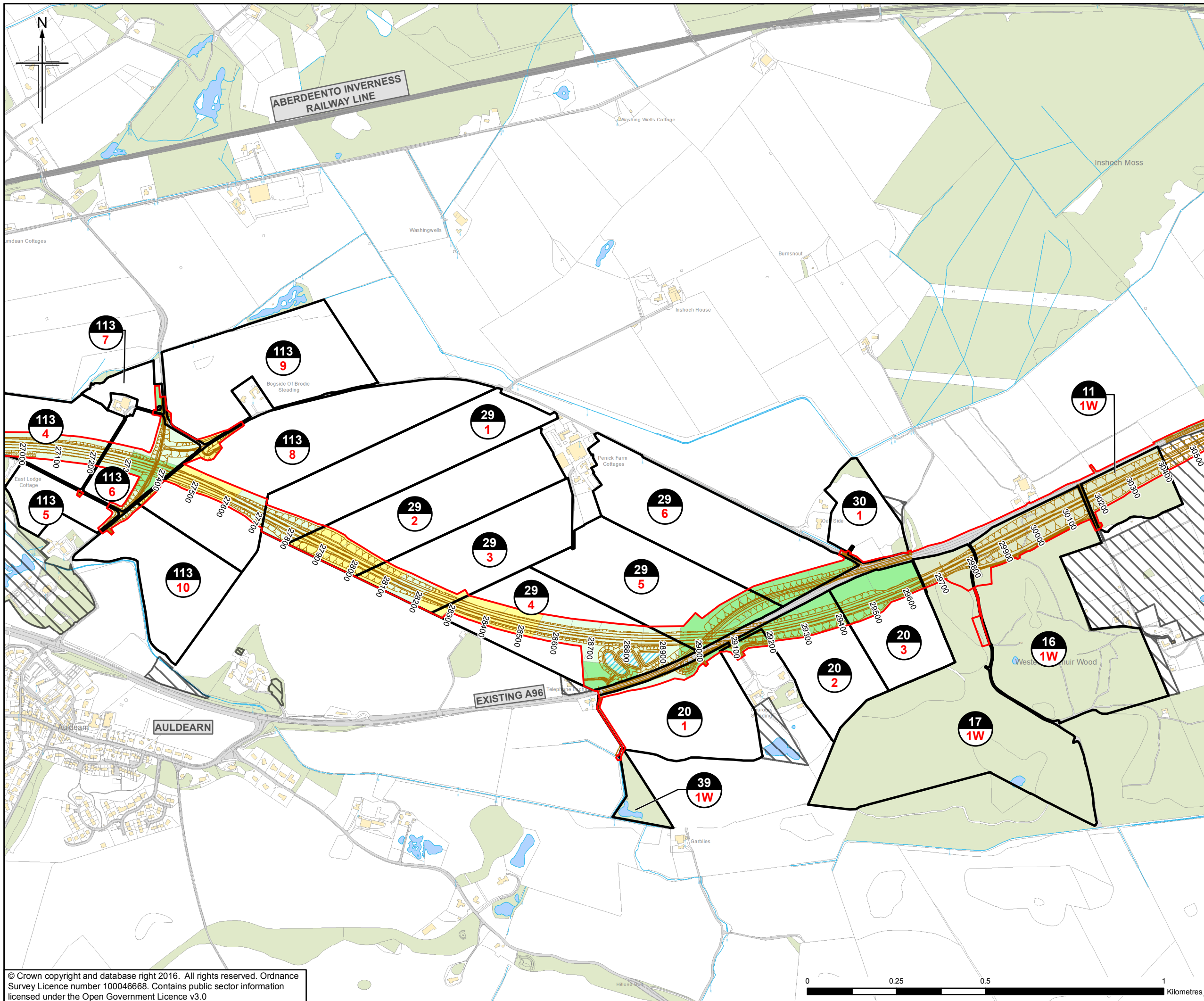

Legend

- Proposed Scheme (as per Draft Orders)
- SUDS (e.g. Basin or Pond)*
- Draft CPO Boundary
- Field Boundary
- Development Land Allocations and Planning Applications**

Land Capability for Agriculture

Land Capable of Supporting Arable Agriculture (Prime Agricultural Land)

- Class 2
- Class 3.1

Land Capable of Supporting Mixed Agriculture

- Class 3.2
- Class 4.1
- Class 4.2

Land Capable of Supporting Improved Grassland

- Class 5.2
- Class 5.3

Land Capable of Supporting only Rough Grazing

- Class 6.2
- Class 7

Other

- Built-up area
- Inland water

4 Land Plot Number
1 Field Reference

* Actual shape of pond/basin will be subject to detailed design
** Inner Moray Firth Local Development Plan (as provided by The Highland Council April 2016)
Planning Applications provided by The Highland Council (June 2016)

Rev.	Rev. Date	Purpose of revision	Orig/Dwn	Checkd	Rev'd	Apprv'd
0	NOV 2016	ES Publication	HM	AN	GK	ENG

JACOBS
 55 Belford Street, Glasgow, G2 7NK, UK
 Tel: +44(0)141 243 8000 Fax: +44(0)141 228 3109
 www.jacobs.com

Client

TRANSPORT SCOTLAND
COMHAIL ALBA

Project

A96
DUALLING
INVERNESS TO NAIRN
(incl. Nairn Bypass)

Drawing title

Figure 15.6k
Environmental Statement
Proposed Scheme Land-take:
Agricultural and Forestry Land
 Sheet 11 of 12

Drawing Status	FINAL	
Scale	1:10,000 @ A3	DO NOT SCALE
Jacobs No.	B2103500	
BIM No.		
Drawing number	B2103500/EN/EIA/DR/1506k	Rev 0

This drawing is not to be used in whole or part other than for the intended purpose and project as defined on this drawing. Refer to the contract for full terms and conditions.

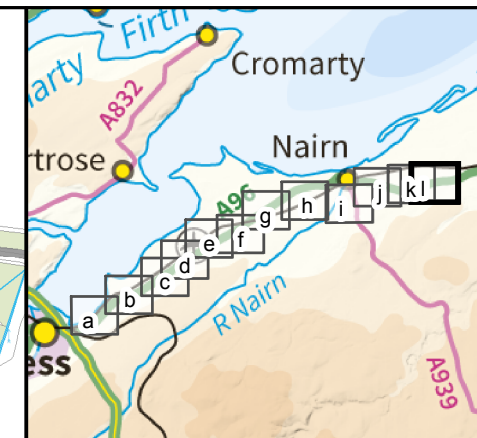
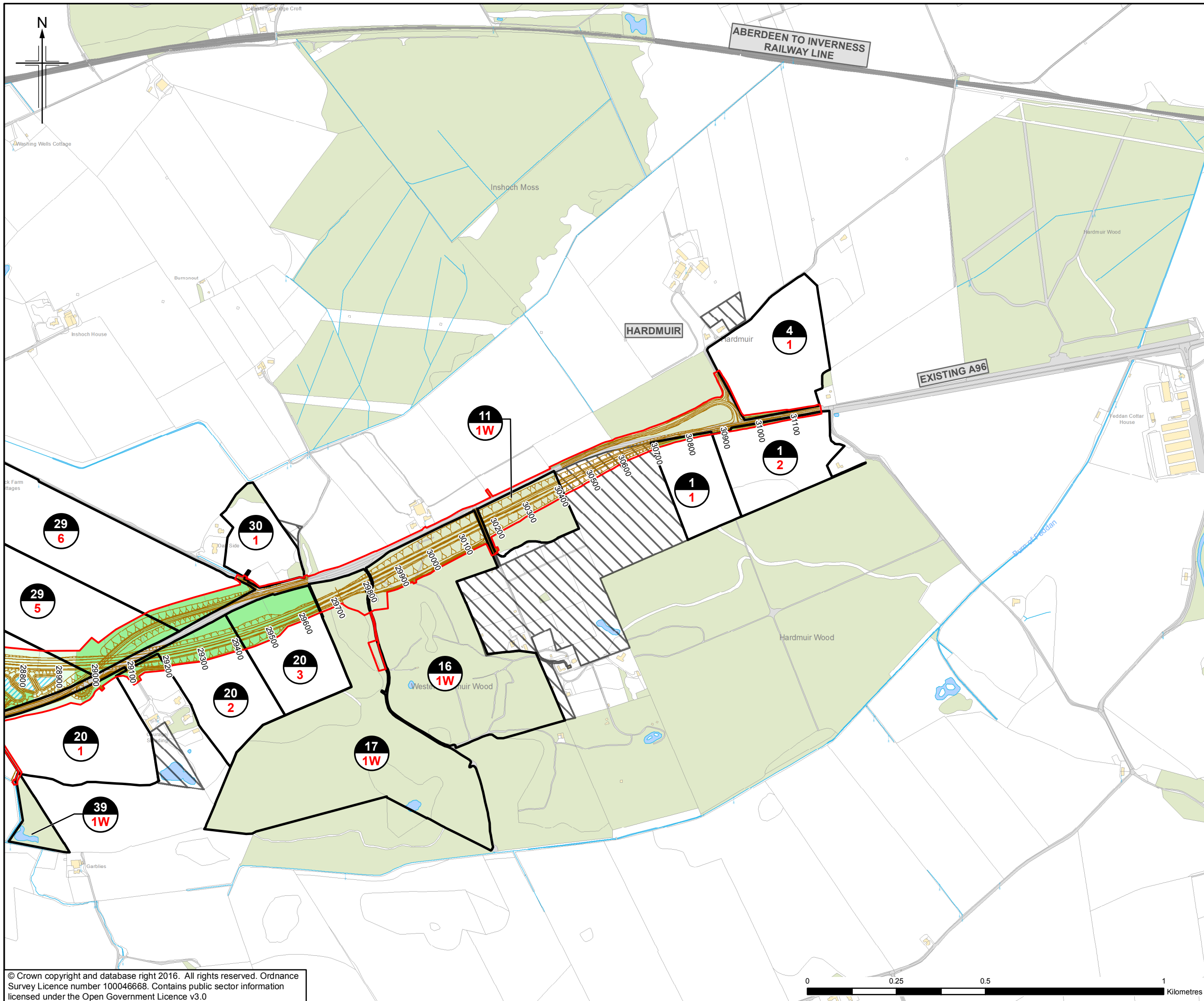

Legend

- Proposed Scheme (as per Draft Orders)
- SUDS (e.g. Basin or Pond)*
- Draft CPO Boundary
- Field Boundary
- Development Land Allocations and Planning Applications**

Land Capability for Agriculture

Land Capable of Supporting Arable Agriculture (Prime Agricultural Land)

- Class 2
- Class 3.1

Land Capable of Supporting Mixed Agriculture

- Class 3.2
- Class 4.1
- Class 4.2

Land Capable of Supporting Improved Grassland

- Class 5.2
- Class 5.3

Land Capable of Supporting only Rough Grazing

- Class 6.2
- Class 7

Other

- Built-up area
- Inland water
- Land Plot Number
- Field Reference

* Actual shape of pond/basin will be subject to detailed design
 ** Inner Moray Firth Local Development Plan (as provided by The Highland Council April 2016)
 Planning Applications provided by The Highland Council (June 2016)

0	NOV 2016	ES Publication	HM	AN	GK	ENG
Rev.	Rev. Date	Purpose of revision	Orig/Dwn	Checked	Rev'd	Apprv'd

JACOBS
 66 Bellfield Street, Glasgow, G2 7NK, UK
 Tel: +44(0)141 243 8000 Fax: +44(0)141 226 3109
 www.jacobs.com

Client

TRANSPORT SCOTLAND
 COMHAIL ALBA

Project

A96
DUALLING
 INVERNESS TO NAIRN
 (incl. Nairn Bypass)

Drawing title

Figure 15.61
Environmental Statement
Proposed Scheme Land-take:
Agricultural and Forestry Land
 Sheet 12 of 12

Drawing Status	FINAL		
Scale	1:10,000 @ A3	DO NOT SCALE	
Jacobs No.	B2103500		
BIM No.			
Drawing number	B2103500/EN/EIA/DR/15061	Rev	0

