

Blackcastle Cottage	
68.0	68.2
55.7	60.3
55.7	61.1
Slight Adverse	
Moderate/ Large Adverse	
Moderate/ Large Adverse	

New House, Easter Glackton Road	
55.7	55.9
53.7	56.9
53.7	57.7
Slight Adverse	
Moderate/ Large Adverse	
Slight/ Moderate Adverse	

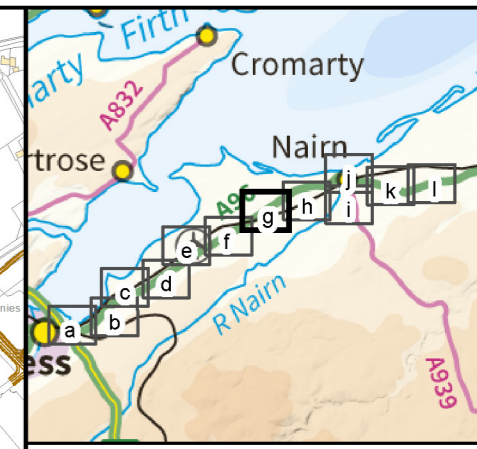

- Legend**
- Proposed Scheme (as per Draft Orders)
  - SUDS (e.g. Basin or Pond)\*
  - Calculation Area
  - Sample Receptor

Location Name**	
Do Minimum Baseline Year	Do Minimum Future Year
Do Minimum Baseline Year	Do Something Baseline Year
Do Minimum Baseline Year	Do Something Future Year
Significance of Impact (DMB vs DMF)	
Significance of Impact (DMB vs DSB)	
Significance of Impact (DMB vs DSF)	

DMB = Do Minimum Baseline Year  
 DMF = Do Minimum Future Year  
 DSB = Do Something Baseline Year  
 DSF = Do Something Future Year

\* Actual shape of pond/basin will be subject to detailed design  
 \*\* Predicted noise levels at the least beneficial façade for each scenario comparison

Rev.	Rev. Date	Purpose of revision	Orig/Dwnl	Check'd	Rev'd	Apprv'd
0	NOV 2016	ES Publication	KA	KF	BMCK	EHO

**JACOBS**  
 36 Belford Street, Glasgow, G2 7HX, UK  
 Tel: +44(0)141 243 8000 Fax: +44(0)141 226 3109  
 www.jacobs.com

Client  
  
 TRANSPORT SCOTLAND  
 COMHDAHL ALBA

Project  
  
**A96**  
 DUALLING  
 INVERNESS TO NAIRN  
 (Incl. Nairn Bypass)

Drawing title  
**Figure 8.15g**  
 Environmental Statement  
 Sample Receptor Predicted Daytime Noise Levels  
 (First Floor)

Sheet 7 of 12

Drawing Status	FINAL	
Scale	1:10,000 @ A3	DO NOT SCALE
Jacobs No.	B2103500	
BIM No.		
Drawing number	B2103500/EN/EIA/DR/815g	Rev 0

This drawing is not to be used in whole or part other than for the intended purpose and project as defined on this drawing. Refer to the contract for full terms and conditions.

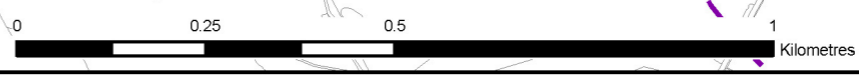



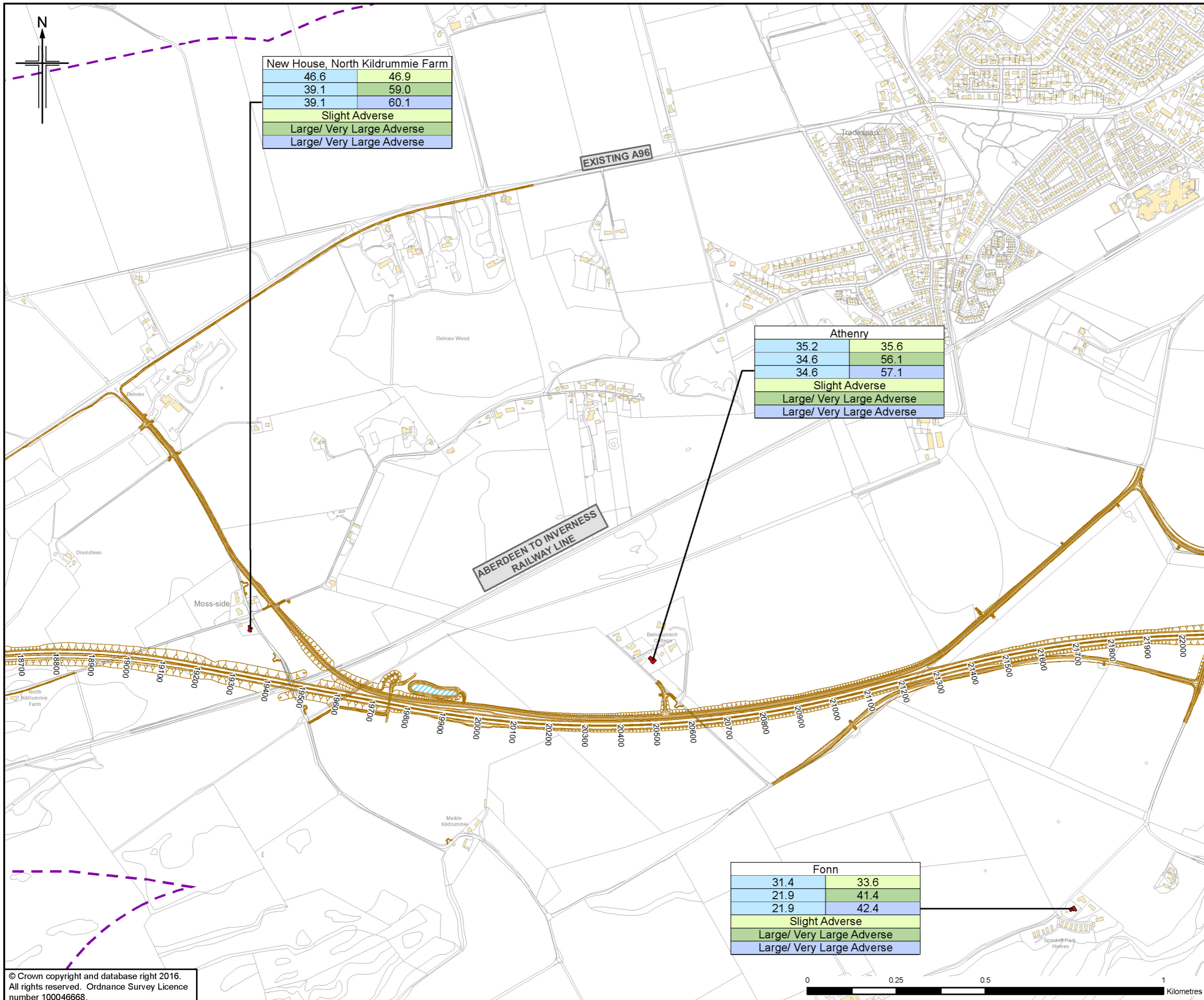

New House, North Kildrummie Farm	
46.6	46.9
39.1	59.0
39.1	60.1
Slight Adverse	
Large/ Very Large Adverse	
Large/ Very Large Adverse	

Athenry	
35.2	35.6
34.6	56.1
34.6	57.1
Slight Adverse	
Large/ Very Large Adverse	
Large/ Very Large Adverse	

Fonn	
31.4	33.6
21.9	41.4
21.9	42.4
Slight Adverse	
Large/ Very Large Adverse	
Large/ Very Large Adverse	

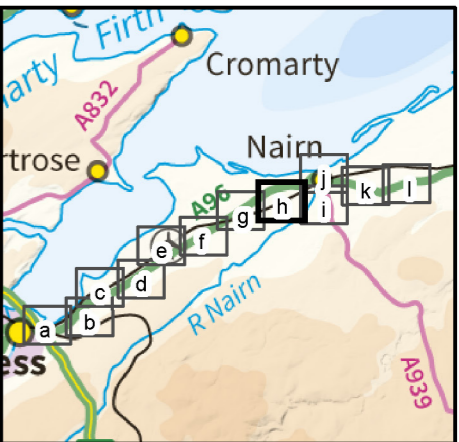

- Legend**
- Proposed Scheme (as per Draft Orders)
  - SUDS (e.g. Basin or Pond)\*
  - Calculation Area
  - Sample Receptor

Location Name**	
Do Minimum Baseline Year	Do Minimum Future Year
Do Minimum Baseline Year	Do Something Baseline Year
Do Minimum Baseline Year	Do Something Future Year
Significance of Impact (DMB vs DMF)	
Significance of Impact (DMB vs DSB)	
Significance of Impact (DMB vs DSF)	

DMB = Do Minimum Baseline Year  
 DMF = Do Minimum Future Year  
 DSB = Do Something Baseline Year  
 DSF = Do Something Future Year

\* Actual shape of pond/basin will be subject to detailed design  
 \*\* Predicted noise levels at the least beneficial façade for each scenario comparison

Rev.	Rev. Date	Purpose of revision	OrigDwnl	Checkd	Rev'd	Apprv'd
0	NOV 2016	ES Publication	KA	KF	BMCK	EHO

**JACOBS**  
 36 Belford Street, Glasgow, G2 7HF, UK  
 Tel: +44(0)141 243 8000 Fax: +44(0)141 226 3109  
 www.jacobs.com

Client  
  
 TRANSPORT SCOTLAND  
 COMHDAHL ALBA

Project  
  
**A96**  
 DUALLING  
 INVERNESS TO NAIRN  
 (Incl. Nairn Bypass)

Drawing title  
**Figure 8.15h**  
**Environmental Statement**  
**Sample Receptor Predicted Daytime Noise Levels**  
**(First Floor)**

Drawing Status	FINAL	Sheet 8 of 12
Scale	1:10,000 @ A3	DO NOT SCALE
Jacobs No.	B2103500	
BIM No.		
Drawing number	B2103500/EN/EIA/DR/815h	Rev 0

This drawing is not to be used in whole or part other than for the intended purpose and project as defined on this drawing. Refer to the contract for full terms and conditions.

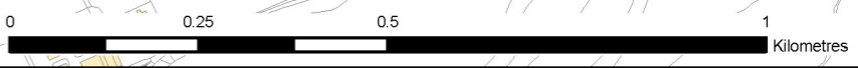



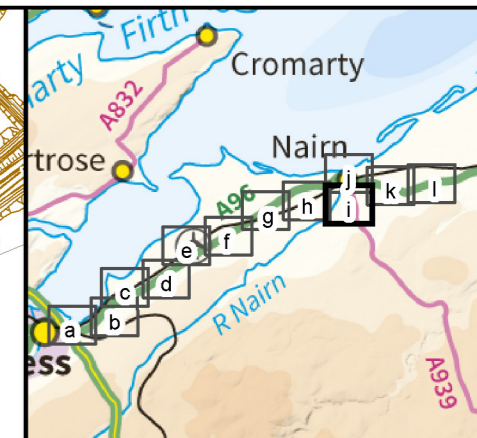
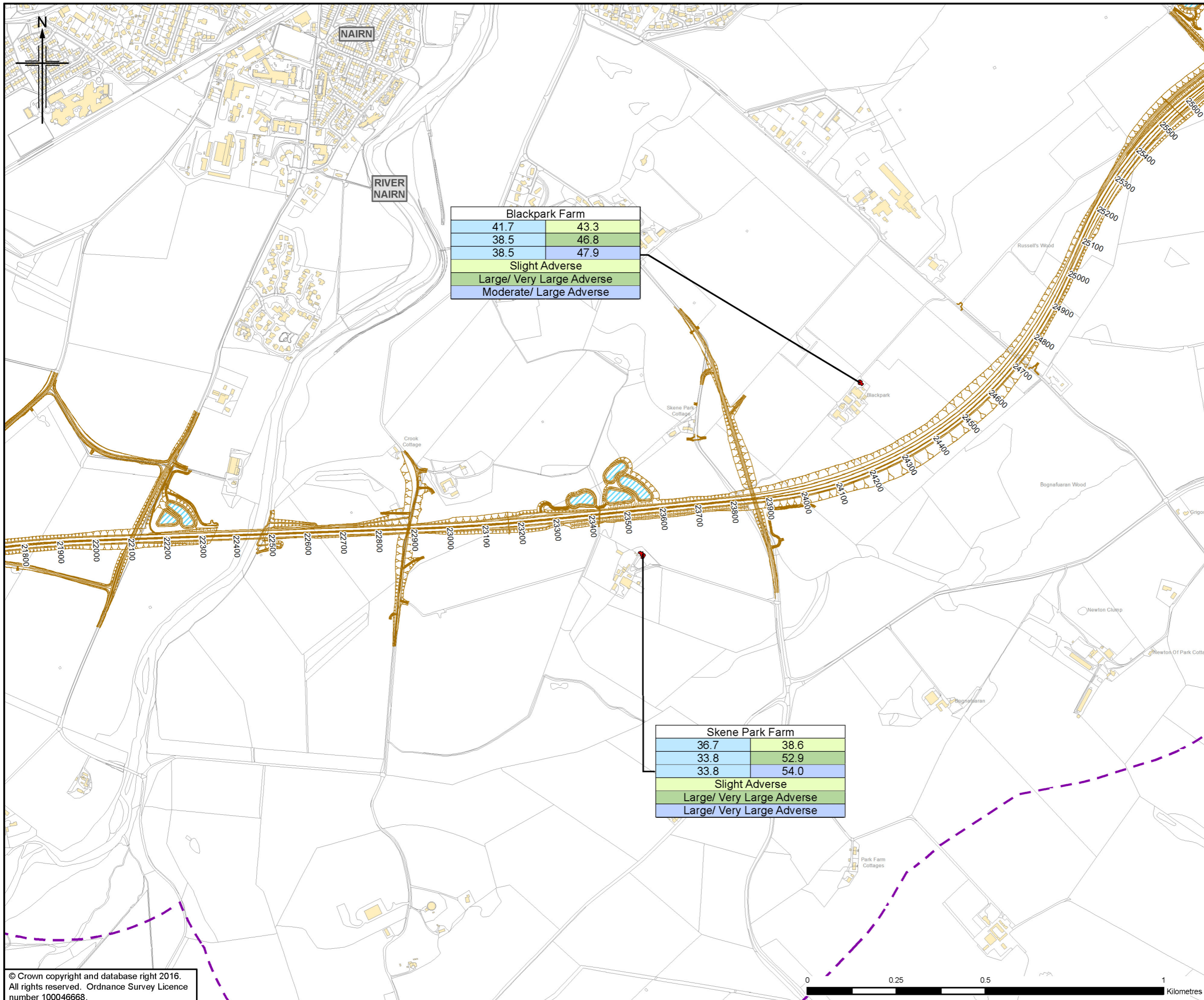

- Legend**
- Proposed Scheme (as per Draft Orders)
  - SUDS (e.g. Basin or Pond)\*
  - Calculation Area
  - Sample Receptor

Location Name**	
Do Minimum Baseline Year	Do Minimum Future Year
Do Minimum Baseline Year	Do Something Baseline Year
Do Minimum Baseline Year	Do Something Future Year
Significance of Impact (DMB vs DMF)	
Significance of Impact (DMB vs DSB)	
Significance of Impact (DMB vs DSF)	

DMB = Do Minimum Baseline Year  
 DMF = Do Minimum Future Year  
 DSB = Do Something Baseline Year  
 DSF = Do Something Future Year

\* Actual shape of pond/basin will be subject to detailed design  
 \*\* Predicted noise levels at the least beneficial façade for each scenario comparison

Rev.	Rev. Date	Purpose of revision	OrigDwnl	Checkd	Rev'd	Apprv'd
0	NOV 2016	ES Preparation	KA	KF	BMCK	EHO

**JACOBS**  
 36 Belford Street, Glasgow, G2 7HX, UK  
 Tel: +44(0)141 243 8000 Fax: +44(0)141 226 3109  
 www.jacobs.com

Client  
  
 TRANSPORT SCOTLAND  
 COMHDAH ALBA

Project  
  
**A95**  
 DUALLING  
 INVERNESS TO NAIRN  
 (Incl. Nairn Bypass)

Drawing title  
**Figure 8.15i**  
**Environmental Statement**  
**Sample Receptor Predicted Daytime Noise Levels**  
**(First Floor)**

Sheet 9 of 12

Drawing Status	FINAL
Scale	1:10,000 @ A3 DO NOT SCALE
Jacobs No.	B2103500
BIM No.	
Drawing number	B2103500/EN/EIA/DR/815i
Rev	0

This drawing is not to be used in whole or part other than for the intended purpose and project as defined on this drawing. Refer to the contract for full terms and conditions.

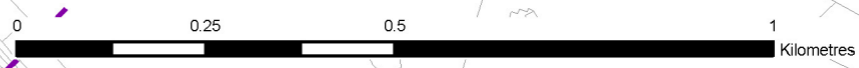



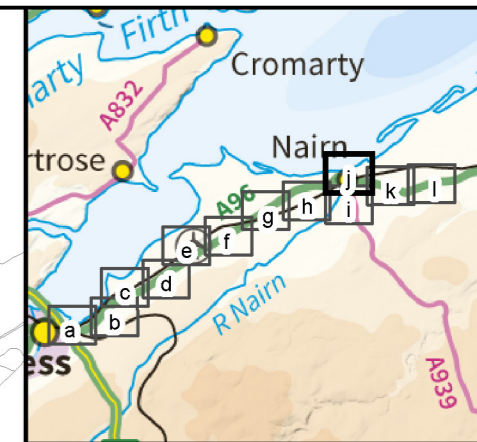
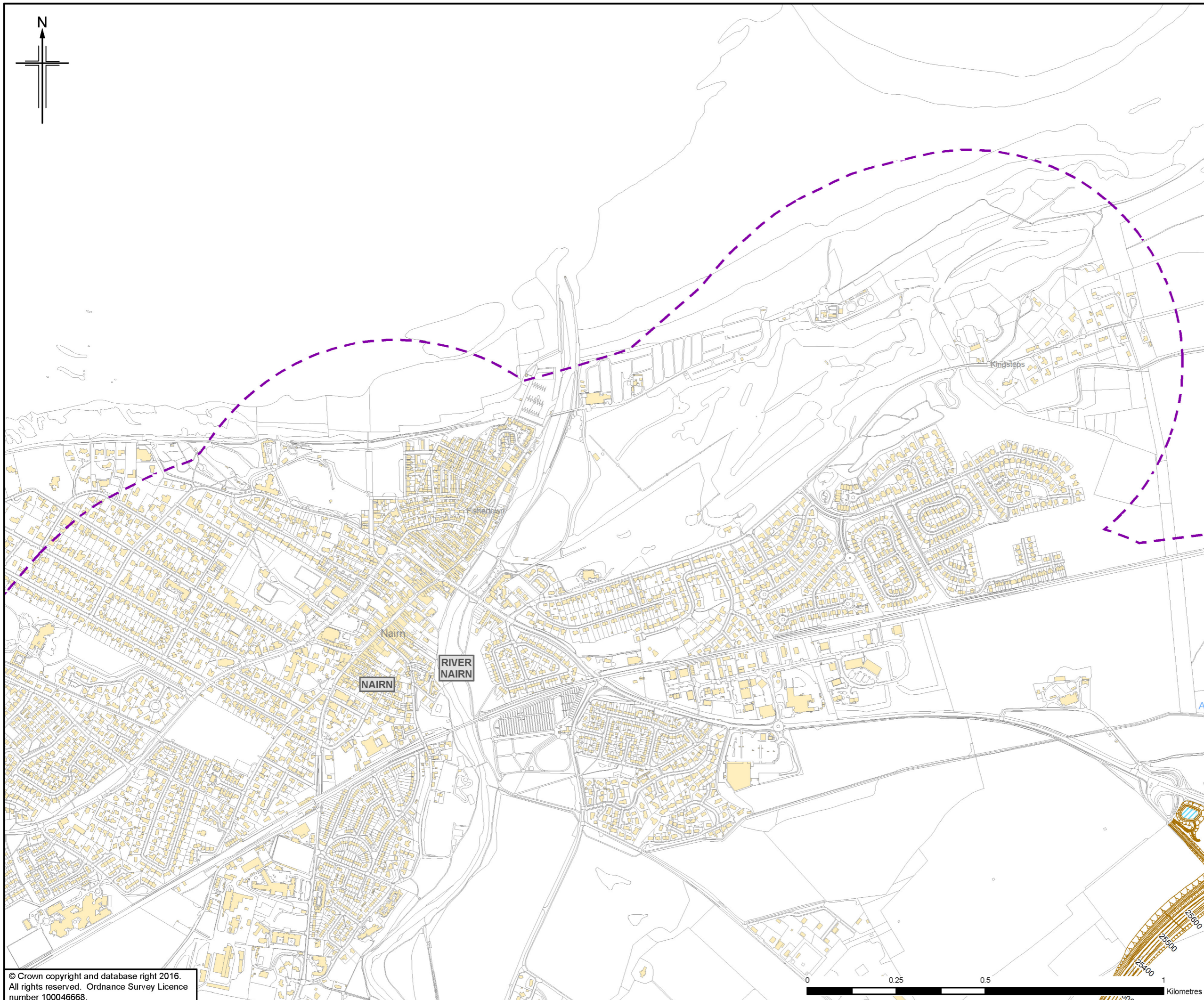

- Legend**
- Proposed Scheme (as per Draft Orders)
  - SUDS (e.g. Basin or Pond)\*
  - Calculation Area
  - Sample Receptor

Location Name**	
Do Minimum Baseline Year	Do Minimum Future Year
Do Minimum Baseline Year	Do Something Baseline Year
Do Minimum Baseline Year	Do Something Future Year
Significance of Impact (DMB vs DMF)	
Significance of Impact (DMB vs DSB)	
Significance of Impact (DMB vs DSF)	

DMB = Do Minimum Baseline Year  
 DMF = Do Minimum Future Year  
 DSB = Do Something Baseline Year  
 DSF = Do Something Future Year

\* Actual shape of pond/basin will be subject to detailed design  
 \*\* Predicted noise levels at the least beneficial façade for each scenario comparison

Rev.	Rev. Date	Purpose of revision	Orig/Dwnl	Checkd	Rev'd	Apprv'd
0	NOV 2016	BB Publication	KA	KF	BMCK	EHG

**JACOBS**  
 36 Belford Street, Glasgow, G2 7HX, UK  
 Tel: +44(0)141 243 8000 Fax: +44(0)141 226 3109  
 www.jacobs.com

Client  
  
 TRANSPORT SCOTLAND  
 COMHDAI ALBA

Project  
  
**A96**  
 DUALLING  
 INVERNESS TO NAIRN  
 (Incl. Nairn Bypass)

Drawing title  
**Figure 8.15j**  
**Environmental Statement**  
**Sample Receptor Predicted Daytime Noise Levels**  
**(First Floor)**

Drawing Status	FINAL			Sheet 10 of 12
Scale	1:10,000	@ A3	DO NOT SCALE	
Jacobs No.	B2103500			
BIM No.				
Drawing number	B2103500/EN/EIA/DR/815j			Rev 0

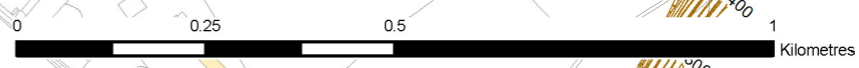



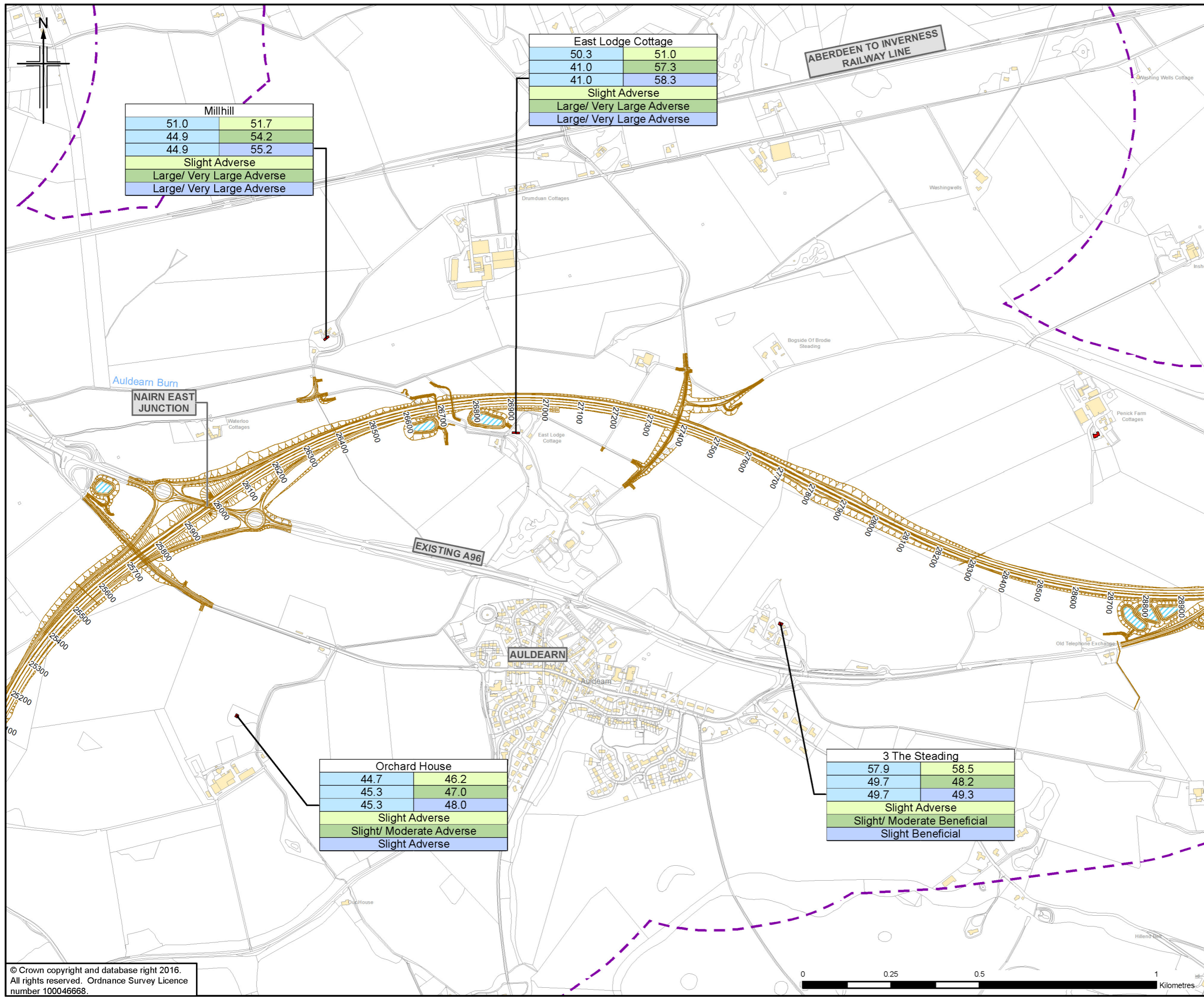

Millhill	
51.0	51.7
44.9	54.2
44.9	55.2
Slight Adverse	
Large/ Very Large Adverse	
Large/ Very Large Adverse	

East Lodge Cottage	
50.3	51.0
41.0	57.3
41.0	58.3
Slight Adverse	
Large/ Very Large Adverse	
Large/ Very Large Adverse	

Orchard House	
44.7	46.2
45.3	47.0
45.3	48.0
Slight Adverse	
Slight/ Moderate Adverse	
Slight Adverse	

3 The Steading	
57.9	58.5
49.7	48.2
49.7	49.3
Slight Adverse	
Slight/ Moderate Beneficial	
Slight Beneficial	

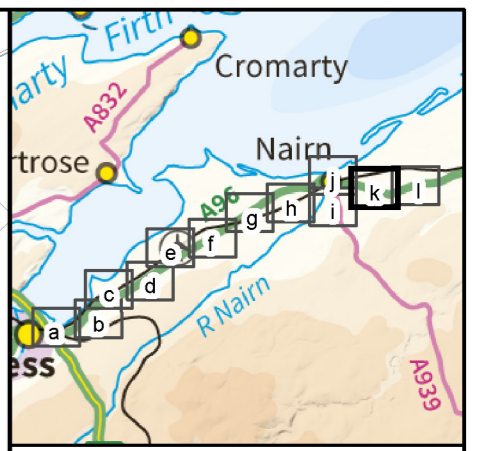

- Legend**
- Proposed Scheme (as per Draft Orders)
  - SUDS (e.g. Basin or Pond)\*
  - Calculation Area
  - Sample Receptor

Location Name**	
Do Minimum Baseline Year	Do Minimum Future Year
Do Minimum Baseline Year	Do Something Baseline Year
Do Minimum Baseline Year	Do Something Future Year
Significance of Impact (DMB vs DMF)	
Significance of Impact (DMB vs DSB)	
Significance of Impact (DMB vs DSF)	

DMB = Do Minimum Baseline Year  
 DMF = Do Minimum Future Year  
 DSB = Do Something Baseline Year  
 DSF = Do Something Future Year

\* Actual shape of pond/basin will be subject to detailed design  
 \*\* Predicted noise levels at the least beneficial façade for each scenario comparison

Rev.	Rev. Date	Purpose of revision	OrigDwnl	Checkd	Rev'd	Apprv'd
0	NOV 2016	ES Preparation	KA	KF	BMCK	EHO

**JACOBS**  
 36 Belford Street, Glasgow, G2 7HX, UK  
 Tel: +44(0)141 243 8000 Fax: +44(0)141 226 3109  
 www.jacobs.com



**A96 DUALLING**  
 INVERNESS TO NAIRN  
 (Incl. Nairn Bypass)

Drawing title  
**Figure 8.15k**  
**Environmental Statement**  
**Sample Receptor Predicted Daytime Noise Levels**  
**(First Floor)**

Drawing Status	FINAL	Sheet 11 of 12
Scale	1:10,000 @ A3	DO NOT SCALE
Jacobs No.	B2103500	
BIM No.		
Drawing number	B2103500/EN/EIA/DR/815k	Rev 0





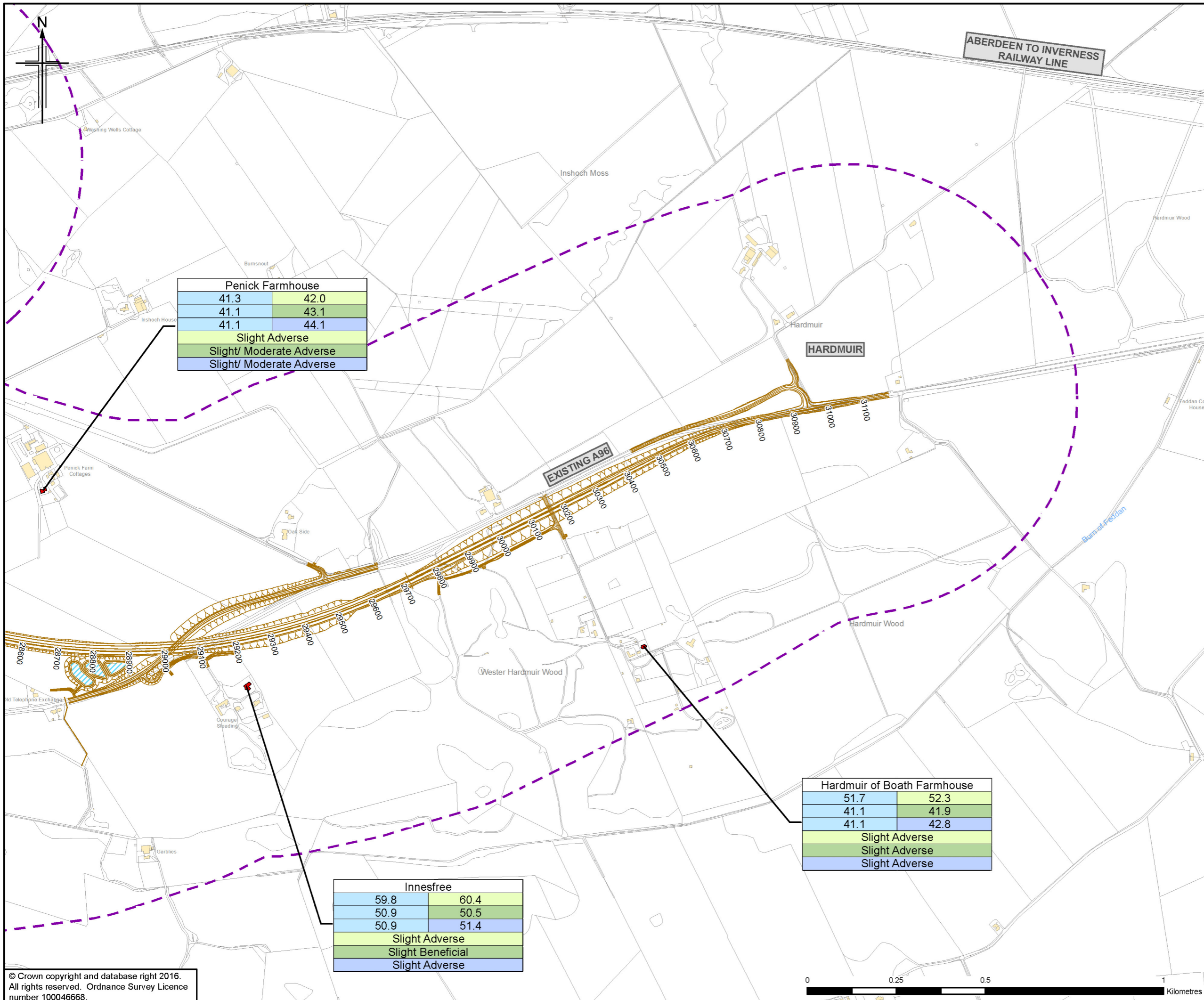

Penick Farmhouse	
41.3	42.0
41.1	43.1
41.1	44.1
Slight Adverse	
Slight/ Moderate Adverse	
Slight/ Moderate Adverse	

Hardmuir of Boath Farmhouse	
51.7	52.3
41.1	41.9
41.1	42.8
Slight Adverse	
Slight Adverse	
Slight Adverse	

Innesfree	
59.8	60.4
50.9	50.5
50.9	51.4
Slight Adverse	
Slight Beneficial	
Slight Adverse	

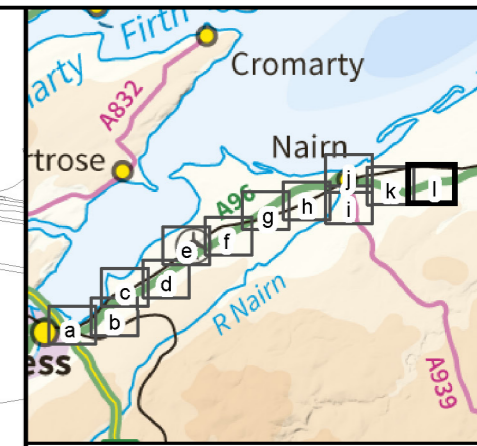

- Legend**
- Proposed Scheme (as per Draft Orders)
  - SUDS (e.g. Basin or Pond)\*
  - Calculation Area
  - Sample Receptor

Location Name**	
Do Minimum Baseline Year	Do Minimum Future Year
Do Minimum Baseline Year	Do Something Baseline Year
Do Minimum Baseline Year	Do Something Future Year
Significance of Impact (DMB vs DMF)	
Significance of Impact (DMB vs DSB)	
Significance of Impact (DMB vs DSF)	

DMB = Do Minimum Baseline Year  
 DMF = Do Minimum Future Year  
 DSB = Do Something Baseline Year  
 DSF = Do Something Future Year

\* Actual shape of pond/basin will be subject to detailed design  
 \*\* Predicted noise levels at the least beneficial façade for each scenario comparison

Rev.	Rev. Date	Purpose of revision	Orig'Dwnl	Check'd	Rev'd	Apprv'd
0	NOV 2016	ES Preparation	KA	KF	BMCK	EHO

**JACOBS**  
 36 Belford Street, Glasgow, G2 7HE, UK  
 Tel: +44(0)141 243 8000 Fax: +44(0)141 226 3109  
 www.jacobs.com

Client  
  
 TRANSPORT SCOTLAND  
 COMH-DHÀIL ALBA

Project  
  
**A96**  
 DUALLING  
 INVERNESS TO NAIRN  
 (Incl. Nairn Bypass)

Drawing title  
**Figure 8.151**  
**Environmental Statement**  
**Sample Receptor Predicted Daytime Noise Levels**  
**(First Floor)**

Drawing Status	FINAL		Sheet 12 of 12
Scale	1:10,000	@ A3	DO NOT SCALE
Jacobs No.	B2103500		
BIM No.			
Drawing number	B2103500/EN/EIA/DR/8151	Rev	0

