

- Legend**
- Proposed Scheme (as per Draft Orders)
 - SUDS (e.g. Basin or Pond)*
 - Calculation Area
 - Sample Receptor
 - Noise Mitigation Barrier

Location Name**	
Do Minimum Baseline Year	Do Minimum Future Year
Do Minimum Baseline Year	Do Something Baseline Year
Do Minimum Baseline Year	Do Something Future Year
Significance of Impact (DMB vs DMF)	
Significance of Impact (DMB vs DSB)	
Significance of Impact (DMB vs DSF)	

DMB = Do Minimum Baseline Year
 DMF = Do Minimum Future Year
 DSB = Do Something Baseline Year
 DSF = Do Something Future Year

* Actual shape of pond/basin will be subject to detailed design
 ** Predicted noise levels at the least beneficial façade for each scenario comparison

Rev.	Rev. Date	Purpose of revision	Orig/Dwnl	Checkd	Rev'd	Apprv'd
0	NOV 2016	BB Publication	KA	KF	BMCK	EHO

JACOBS
 36 Bellfield Street, Glasgow, G2 7HX, UK
 Tel: +44(0)141 243 8000 Fax: +44(0)141 226 3109
 www.jacobs.com

Client

 TRANSPORT SCOTLAND
 COMHDAHL ALBA

Project

A96
 DUALLING
 INVERNESS TO NAIRN
 (Incl. Nairn Bypass)

Drawing title
Figure 8.17a
Environmental Statement
Sample Receptor Predicted Daytime Noise Levels
(First Floor) (With Mitigation)

Drawing Status	FINAL		Sheet 1 of 12
Scale	1:10,000 @ A3	DO NOT SCALE	
Jacobs No.	B2103500		
BIM No.			
Drawing number	B2103500/EN/EIA/DR/817a	Rev	0

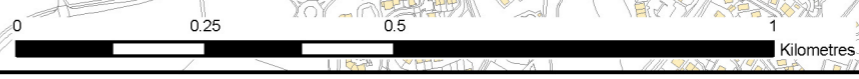

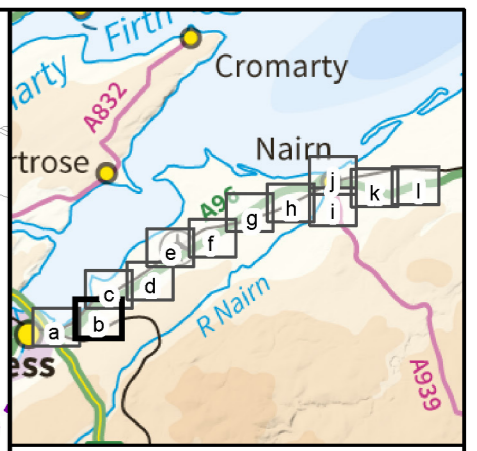
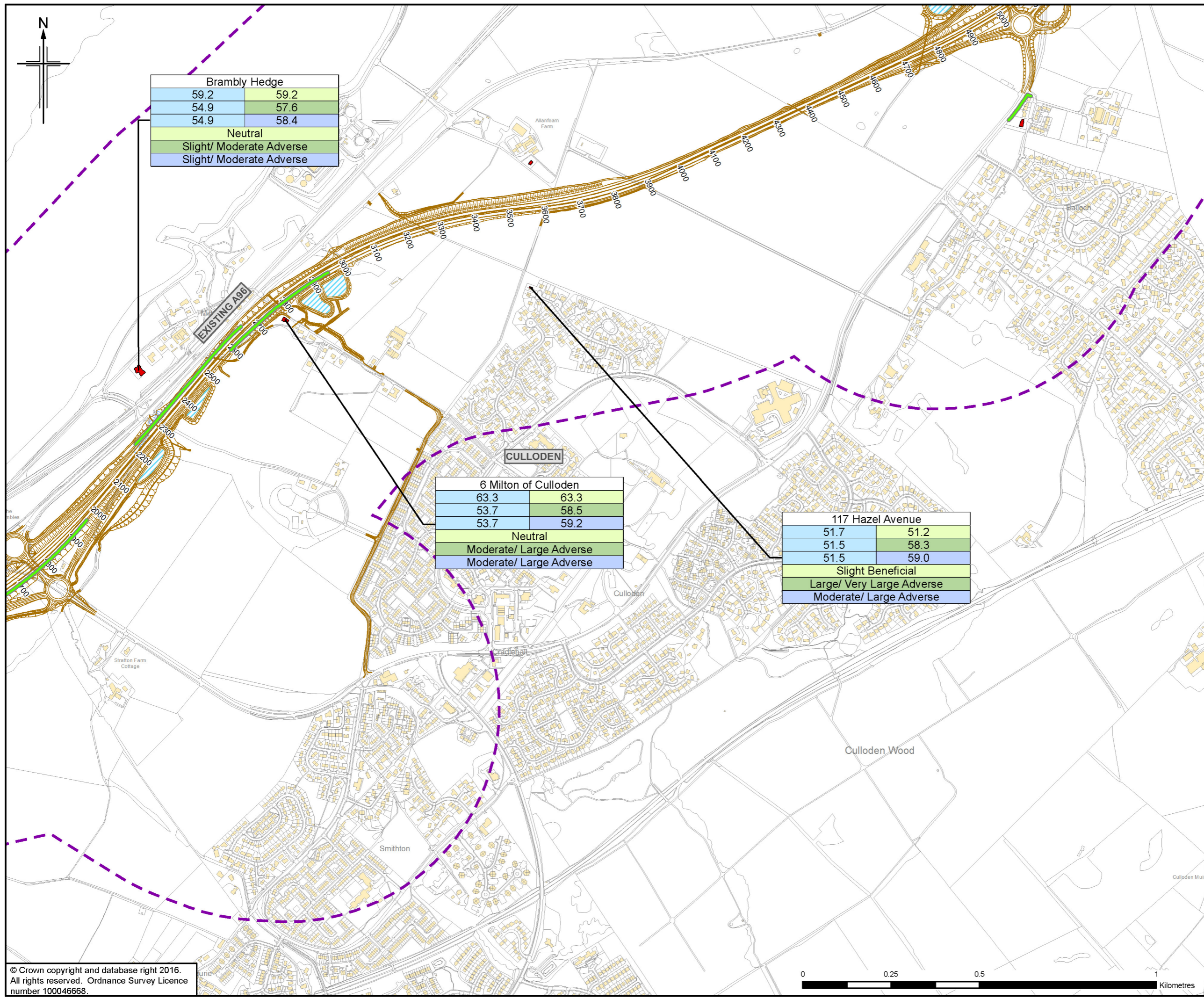

- Legend**
- Proposed Scheme (as per Draft Orders)
 - SUDS (e.g. Basin or Pond)*
 - Calculation Area
 - Sample Receptor
 - Noise Mitigation Barrier

Location Name**	
Do Minimum Baseline Year	Do Minimum Future Year
Do Minimum Baseline Year	Do Something Baseline Year
Do Minimum Baseline Year	Do Something Future Year
Significance of Impact (DMB vs DMF)	
Significance of Impact (DMB vs DSB)	
Significance of Impact (DMB vs DSF)	

DMB = Do Minimum Baseline Year
 DMF = Do Minimum Future Year
 DSB = Do Something Baseline Year
 DSF = Do Something Future Year

* Actual shape of pond/basin will be subject to detailed design
 ** Predicted noise levels at the least beneficial façade for each scenario comparison

Rev.	Rev. Date	Purpose of revision	Orig/Dwnl	Check'd	Rev'd	Apprv'd
0	NOV 2016	ES Preparation	KA	KF	BMCK	EHG

JACOBS
 36 Belford Street, Glasgow, G2 7HF, UK
 Tel: +44(0)141 243 8000 Fax: +44(0)141 226 3109
 www.jacobs.com

Client

 TRANSPORT SCOTLAND
 COMHDAHÀ ALBA

Project

A95
 DUALLING
 INVERNESS TO NAIRN
 (Incl. Nairn Bypass)

Drawing title
Figure 8.17b
Environmental Statement
Sample Receptor Predicted Daytime Noise Levels
(First Floor) (With Mitigation)

Drawing Status	FINAL		Sheet 2 of 12
Scale	1:10,000 @ A3	DO NOT SCALE	
Jacobs No.	B2103500		
BIM No.			
Drawing number	B2103500/EN/EIA/DR/817b	Rev	0

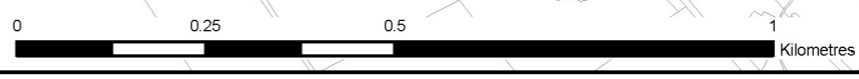



The Bungalow	
50.6	50.3
49.9	58.3
49.9	59.0
Slight Beneficial	
Large/ Very Large Adverse	
Moderate/ Large Adverse	

Thornhill	
60.2	60.5
47.8	50.4
47.8	51.2
Slight Adverse	
Slight/ Moderate Adverse	
Slight/ Moderate Adverse	

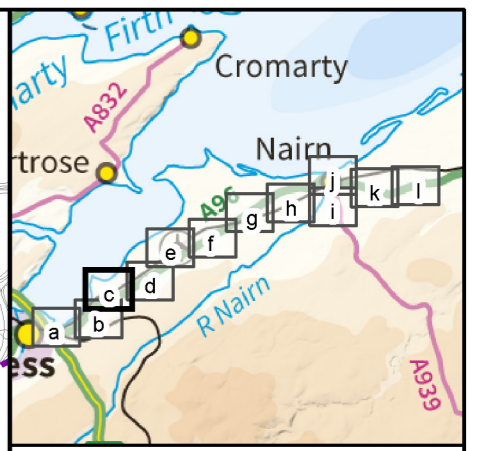

- Legend**
- Proposed Scheme (as per Draft Orders)
 - SUDS (e.g. Basin or Pond)*
 - Calculation Area
 - Sample Receptor
 - Noise Mitigation Barrier

Location Name**	
Do Minimum Baseline Year	Do Minimum Future Year
Do Minimum Baseline Year	Do Something Baseline Year
Do Minimum Baseline Year	Do Something Future Year
Significance of Impact (DMB vs DMF)	
Significance of Impact (DMB vs DSB)	
Significance of Impact (DMB vs DSF)	

DMB = Do Minimum Baseline Year
 DMF = Do Minimum Future Year
 DSB = Do Something Baseline Year
 DSF = Do Something Future Year

* Actual shape of pond/basin will be subject to detailed design
 ** Predicted noise levels at the least beneficial façade for each scenario comparison

Rev.	Rev. Date	Purpose of revision	OrigDwnl	Checkd	Rev'd	Apprv'd
0	NOV 2016	ES Publication	KA	KF	BMCK	EHO



Drawing title: **Figure 8.17c Environmental Statement Sample Receptor Predicted Daytime Noise Levels (First Floor) (With Mitigation)**

Drawing Status	FINAL		Sheet 3 of 12
Scale	1:10,000 @ A3	DO NOT SCALE	
Jacobs No.	B2103500		
BIM No.			
Drawing number	B2103500/EN/EIA/DR/817c	Rev	0

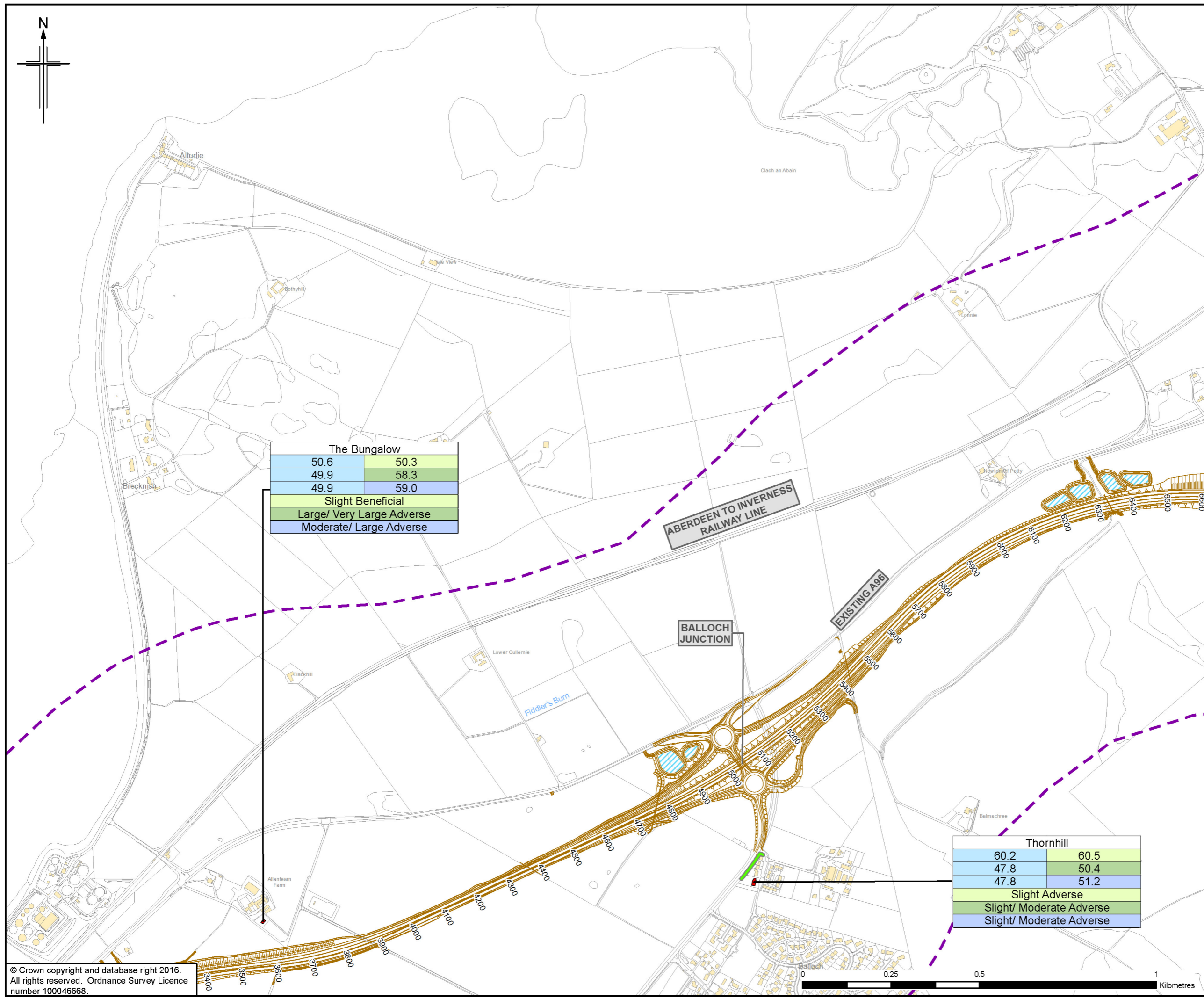

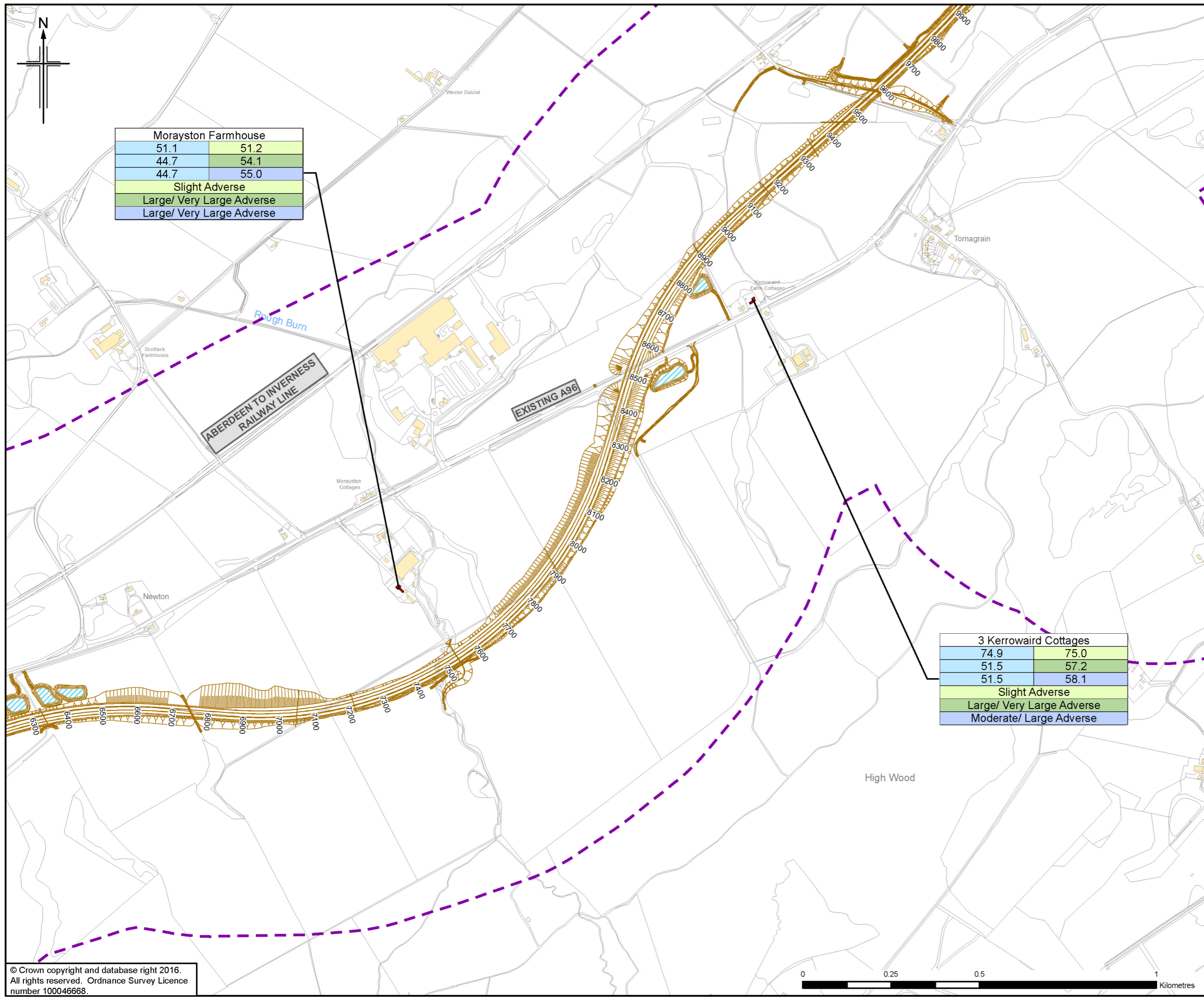

Morayston Farmhouse	
51.1	51.2
44.7	54.1
44.7	55.0
Slight Adverse	
Large/ Very Large Adverse	
Large/ Very Large Adverse	

3 Kerrowaird Cottages	
74.9	75.0
51.5	57.2
51.5	58.1
Slight Adverse	
Large/ Very Large Adverse	
Moderate/ Large Adverse	

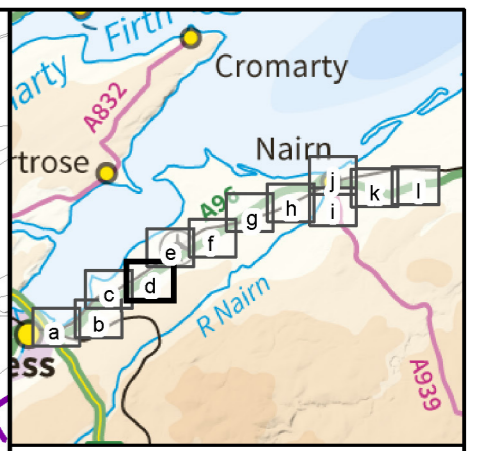

- Legend**
- Proposed Scheme (as per Draft Orders)
 - SUDS (e.g. Basin or Pond)*
 - Calculation Area
 - Sample Receptor
 - Noise Mitigation Barrier

Location Name**	
Do Minimum Baseline Year	Do Minimum Future Year
Do Minimum Baseline Year	Do Something Baseline Year
Do Minimum Baseline Year	Do Something Future Year
Significance of Impact (DMB vs DMF)	
Significance of Impact (DMB vs DSB)	
Significance of Impact (DMB vs DSF)	

DMB = Do Minimum Baseline Year
 DMF = Do Minimum Future Year
 DSB = Do Something Baseline Year
 DSF = Do Something Future Year

* Actual shape of pond/basin will be subject to detailed design
 ** Predicted noise levels at the least beneficial façade for each scenario comparison

0	NOV 2016	ES Preparation	KA	KF	BMCK	EHO
Rev.	Rev. Date	Purpose of revision	Orig/Dwnl	Checkd	Rev'd	Apprv'd

JACOBS
 36 Bellfield Street, Glasgow, G2 7NY, UK
 Tel: +44(0)141 243 8000 Fax: +44(0)141 226 3109
 www.jacobs.com

Client

 TRANSPORT SCOTLAND
 COMHDAHAE ALBA

Project

A96
 DUALLING
 INVERNESS TO NAIRN
 (Incl. Nairn Bypass)

Drawing title
Figure 8.17d
Environmental Statement
Sample Receptor Predicted Daytime Noise Levels
(First Floor) (With Mitigation)

Sheet 4 of 12		
Drawing Status	FINAL	
Scale	1:10,000 @ A3	DO NOT SCALE
Jacobs No.	B2103500	
BIM No.		
Drawing number	B2103500/EN/EIA/DR/817d	Rev 0

This drawing is not to be used in whole or part other than for the intended purpose and project as defined on this drawing. Refer to the contract for full terms and conditions.

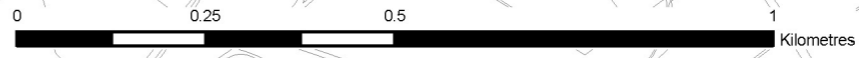

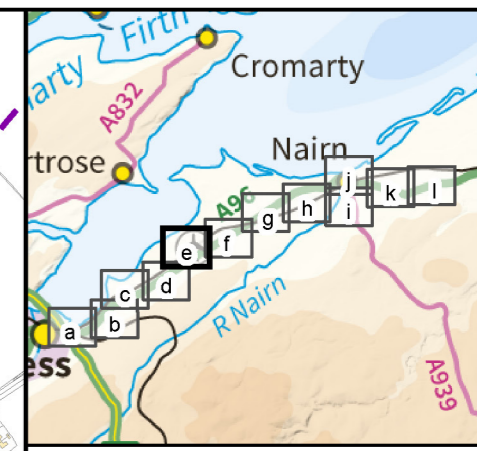
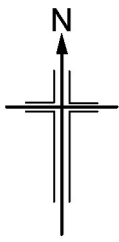

- Legend**
- Proposed Scheme (as per Draft Orders)
 - SUDS (e.g. Basin or Pond)*
 - Calculation Area
 - Sample Receptor
 - Noise Mitigation Barrier

Location Name**	
Do Minimum Baseline Year	Do Minimum Future Year
Do Minimum Baseline Year	Do Something Baseline Year
Do Minimum Baseline Year	Do Something Future Year
Significance of Impact (DMB vs DMF)	
Significance of Impact (DMB vs DSB)	
Significance of Impact (DMB vs DSF)	

DMB = Do Minimum Baseline Year
 DMF = Do Minimum Future Year
 DSB = Do Something Baseline Year
 DSF = Do Something Future Year

* Actual shape of pond/basin will be subject to detailed design
 ** Predicted noise levels at the least beneficial façade for each scenario comparison

Rev.	Rev. Date	Purpose of revision	OrigDwnl	Checkd	Rev'd	Apprv'd
0	NOV 2016	ES Publication	KA	KF	BMCK	EHO



Drawing title
**Figure 8.17e
 Environmental Statement
 Sample Receptor Predicted Daytime Noise Levels
 (First Floor) (With Mitigation)**

Sheet 5 of 12

Drawing Status: FINAL

Scale: 1:10,000 @ A3 DO NOT SCALE

Jacobs No. B2103500

BIM No.

Drawing number: B2103500/EN/EIA/DR/817e Rev 0

This drawing is not to be used in whole or part other than for the intended purpose and project as defined on this drawing. Refer to the contract for full terms and conditions.

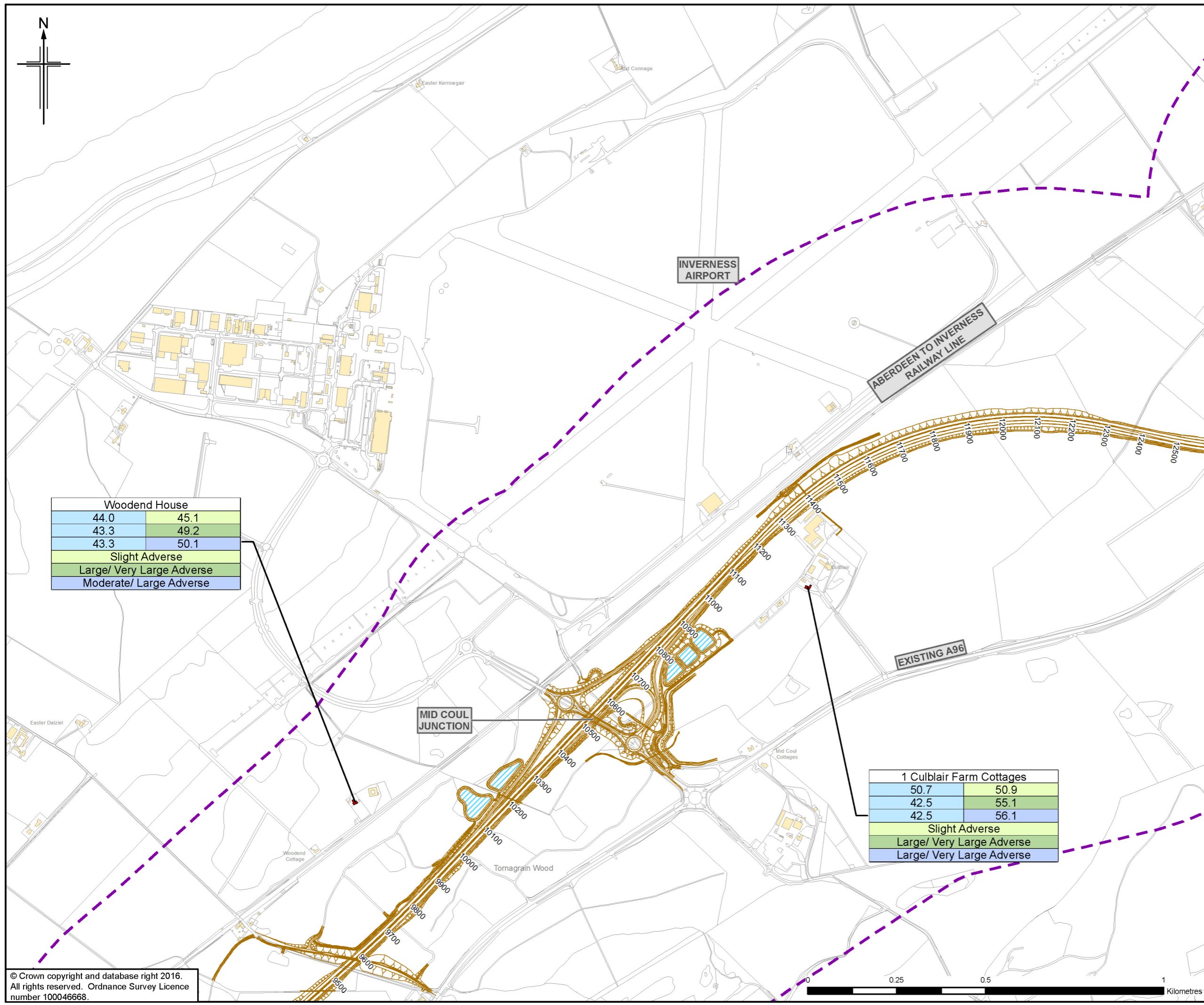

Woodend House	
44.0	45.1
43.3	49.2
43.3	50.1
Slight Adverse	
Large/ Very Large Adverse	
Moderate/ Large Adverse	

1 Culblair Farm Cottages	
50.7	50.9
42.5	55.1
42.5	56.1
Slight Adverse	
Large/ Very Large Adverse	
Large/ Very Large Adverse	

© Crown copyright and database right 2016.
 All rights reserved. Ordnance Survey Licence number 100046668.



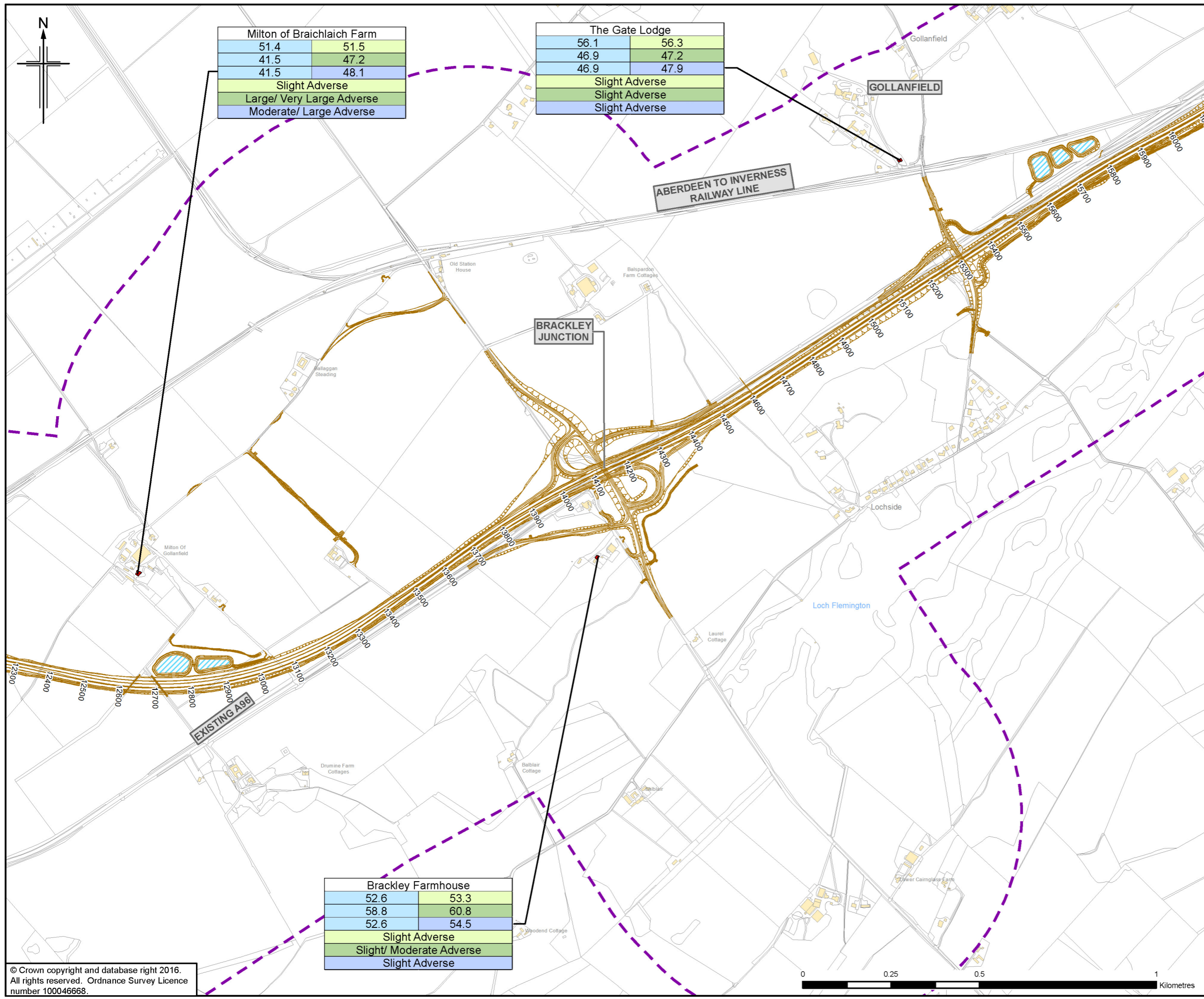

Milton of Braichlaich Farm	
51.4	51.5
41.5	47.2
41.5	48.1
Slight Adverse	
Large/ Very Large Adverse	
Moderate/ Large Adverse	

The Gate Lodge	
56.1	56.3
46.9	47.2
46.9	47.9
Slight Adverse	
Slight Adverse	
Slight Adverse	

Brackley Farmhouse	
52.6	53.3
58.8	60.8
52.6	54.5
Slight Adverse	
Slight/ Moderate Adverse	
Slight Adverse	

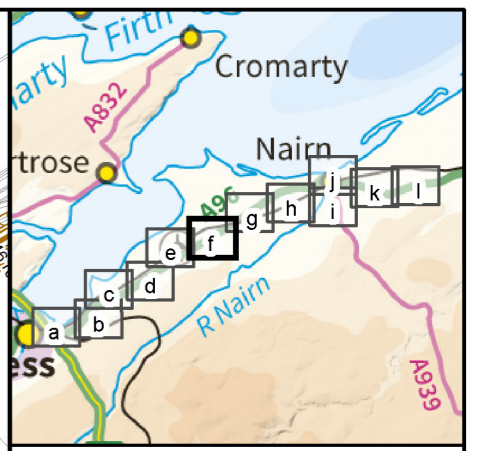

- Legend**
- Proposed Scheme (as per Draft Orders)
 - SUDS (e.g. Basin or Pond)*
 - Calculation Area
 - Sample Receptor
 - Noise Mitigation Barrier

Location Name**	
Do Minimum Baseline Year	Do Minimum Future Year
Do Minimum Baseline Year	Do Something Baseline Year
Do Minimum Baseline Year	Do Something Future Year
Significance of Impact (DMB vs DMF)	
Significance of Impact (DMB vs DSB)	
Significance of Impact (DMB vs DSF)	

DMB = Do Minimum Baseline Year
 DMF = Do Minimum Future Year
 DSB = Do Something Baseline Year
 DSF = Do Something Future Year

* Actual shape of pond/basin will be subject to detailed design
 ** Predicted noise levels at the least beneficial façade for each scenario comparison

Rev.	Rev. Date	Purpose of revision	OrigDwnl	Checkd	Rev'd	Apprv'd
0	NOV 2016	ES Publication	KA	KF	BMCK	EHO

JACOBS
 36 Belford Street, Glasgow, G2 7HF, UK
 Tel: +44(0)141 243 8000 Fax: +44(0)141 226 3109
 www.jacobs.com

Client

 TRANSPORT SCOTLAND
 COMHDAE ALBA

Project

A96
 DUALLING
 INVERNESS TO NAIRN
 (Incl. Nairn Bypass)

Drawing title
Figure 8.17f
Environmental Statement
Sample Receptor Predicted Daytime Noise Levels
(First Floor) (With Mitigation)

Drawing Status	FINAL		
Scale	1:10,000 @ A3	DO NOT SCALE	
Jacobs No.	B2103500		
BIM No.			
Drawing number	B2103500/EN/EIA/DR/817f	Rev	0

This drawing is not to be used in whole or part other than for the intended purpose and project as defined on this drawing. Refer to the contract for full terms and conditions.