

Blackcastle Cottage	
54.2	54.4
40.9	46.4
40.9	47.2
Slight Adverse	
Large/ Very Large Adverse	
Moderate/ Large Adverse	

New House, Easter Glackton Road	
43.6	43.7
41.8	44.6
41.8	45.3
Slight Adverse	
Slight/ Moderate Adverse	
Slight/ Moderate Adverse	

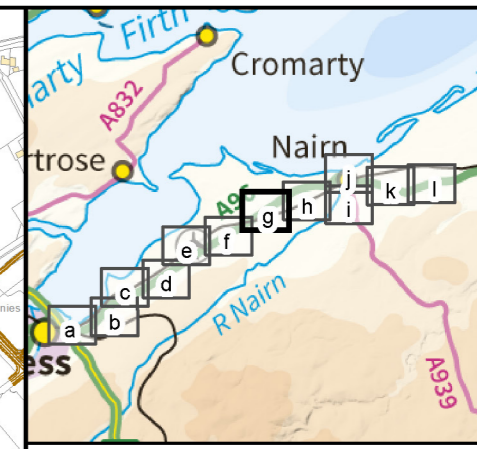

- Legend**
- Proposed Scheme (as per Draft Orders)
 - SUDS (e.g. Basin or Pond)*
 - Calculation Area
 - Sample Receptor

Location Name**	
Do Minimum Baseline Year	Do Minimum Future Year
Do Minimum Baseline Year	Do Something Baseline Year
Do Minimum Baseline Year	Do Something Future Year
Significance of Impact (DMB vs DMF)	
Significance of Impact (DMB vs DSB)	
Significance of Impact (DMB vs DSF)	

DMB = Do Minimum Baseline Year
 DMF = Do Minimum Future Year
 DSB = Do Something Baseline Year
 DSF = Do Something Future Year

* Actual shape of pond/basin will be subject to detailed design
 ** Predicted noise levels at the least beneficial façade for each scenario comparison

Rev.	Rev. Date	Purpose of revision	Orig'Dwnl	Check'd	Rev'd	Apprv'd
0	NOV 2016	BB Plotting	KA	KF	BMCK	EHO

JACOBS
 36 Belford Street, Glasgow, G2 7HF, UK
 Tel: +44(0)141 243 8000 Fax: +44(0)141 226 3109
 www.jacobs.com

Client

 TRANSPORT SCOTLAND
 COMHDAIL ALBA

Project

A95
 DUALLING
 INVERNESS TO NAIRN
 (Incl. Nairn Bypass)

Drawing title
Figure 8.18g
Environmental Statement
Sample Receptor Predicted Night-time Noise Levels
(Ground Floor)

Sheet 7 of 12

Drawing Status	FINAL	
Scale	1:10,000 @ A3	DO NOT SCALE
Jacobs No.	B2103500	
BIM No.		
Drawing number	B2103500/EN/EIA/DR/818g	Rev 0

This drawing is not to be used in whole or part other than for the intended purpose and project as defined on this drawing. Refer to the contract for full terms and conditions.

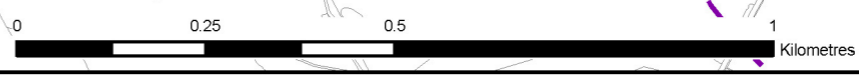

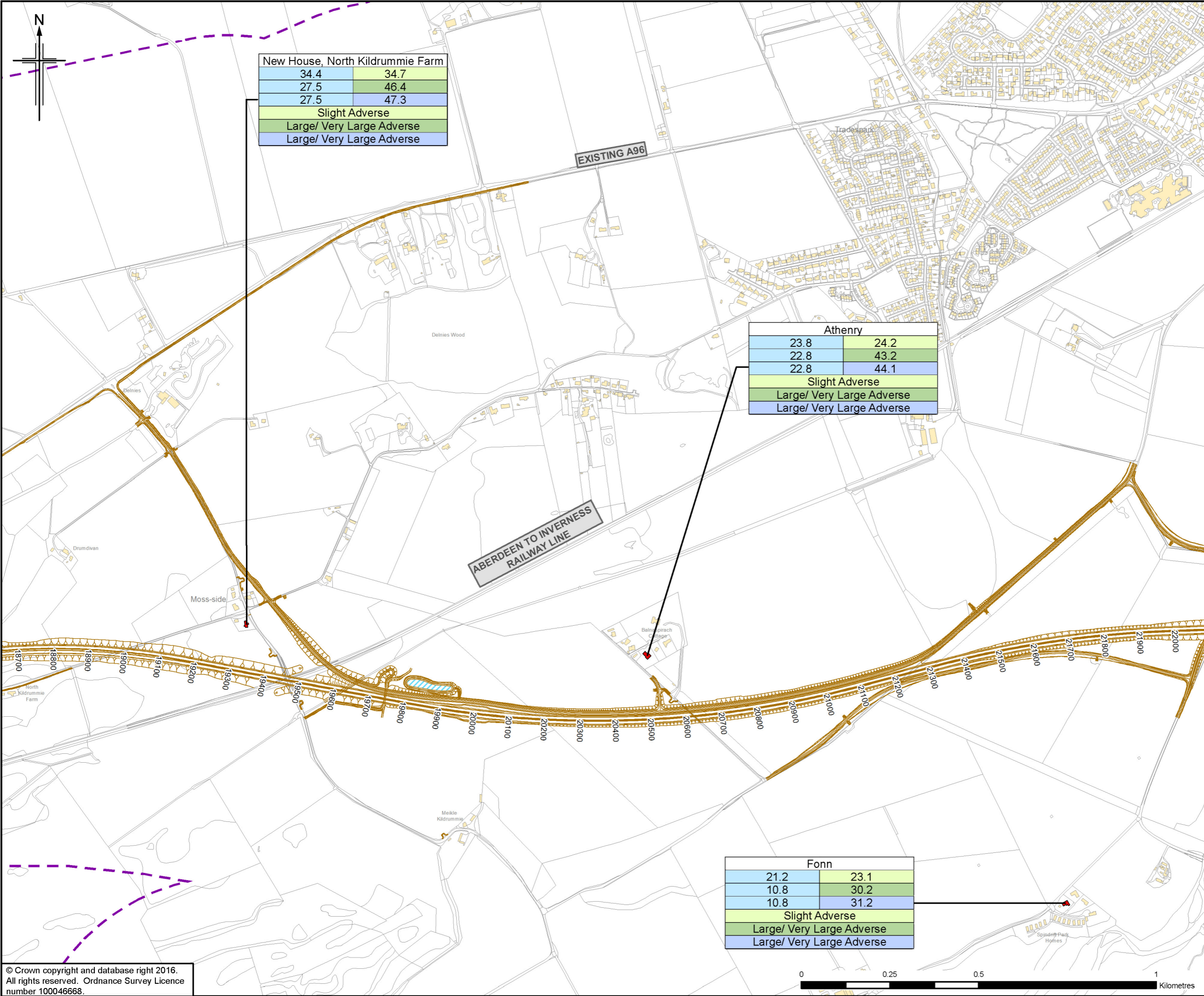

New House, North Kildrummie Farm	
34.4	34.7
27.5	46.4
27.5	47.3
Slight Adverse	
Large/ Very Large Adverse	
Large/ Very Large Adverse	

Athenry	
23.8	24.2
22.8	43.2
22.8	44.1
Slight Adverse	
Large/ Very Large Adverse	
Large/ Very Large Adverse	

Fonn	
21.2	23.1
10.8	30.2
10.8	31.2
Slight Adverse	
Large/ Very Large Adverse	
Large/ Very Large Adverse	

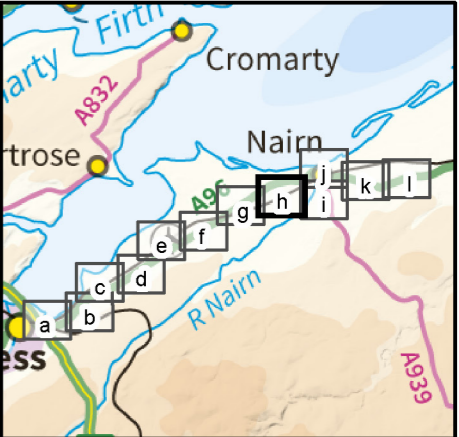

- Legend**
- Proposed Scheme (as per Draft Orders)
 - SUDS (e.g. Basin or Pond)*
 - Calculation Area
 - Sample Receptor

Location Name**	
Do Minimum Baseline Year	Do Minimum Future Year
Do Minimum Baseline Year	Do Something Baseline Year
Do Minimum Baseline Year	Do Something Future Year
Significance of Impact (DMB vs DMF)	
Significance of Impact (DMB vs DSB)	
Significance of Impact (DMB vs DSF)	

DMB = Do Minimum Baseline Year
 DMF = Do Minimum Future Year
 DSB = Do Something Baseline Year
 DSF = Do Something Future Year

* Actual shape of pond/basin will be subject to detailed design
 ** Predicted noise levels at the least beneficial façade for each scenario comparison

Rev.	Rev. Date	Purpose of revision	Orig/Dwnl	Check'd	Rev'd	Apprv'd
0	NOV 2016	ES Publication	KA	KF	BMCK	EHG

JACOBS
 36 Bellfield Street, Glasgow, G2 7HX, UK
 Tel: +44(0)141 243 8000 Fax: +44(0)141 226 3109
 www.jacobs.com

Client: **TRANSPORT SCOTLAND**
 COMHDAH ALBA

Project: **A96 DUALLING**
 INVERNESS TO NAIRN
 (Incl. Nairn Bypass)

Drawing title: **Figure 8.18h Environmental Statement Sample Receptor Predicted Night-time Noise Levels (Ground Floor)**

Drawing Status	FINAL	Sheet 8 of 12
Scale	1:10,000 @ A3	DO NOT SCALE
Jacobs No.	B2103500	
BIM No.		
Drawing number	B2103500/EN/EIA/DR/818h	Rev 0

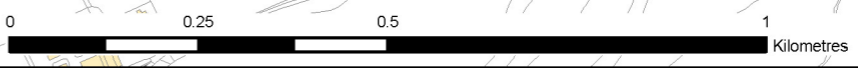

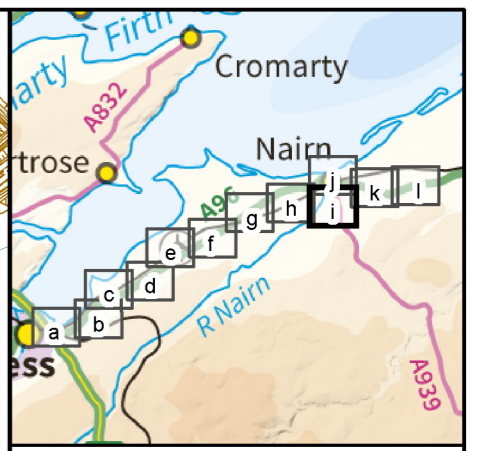
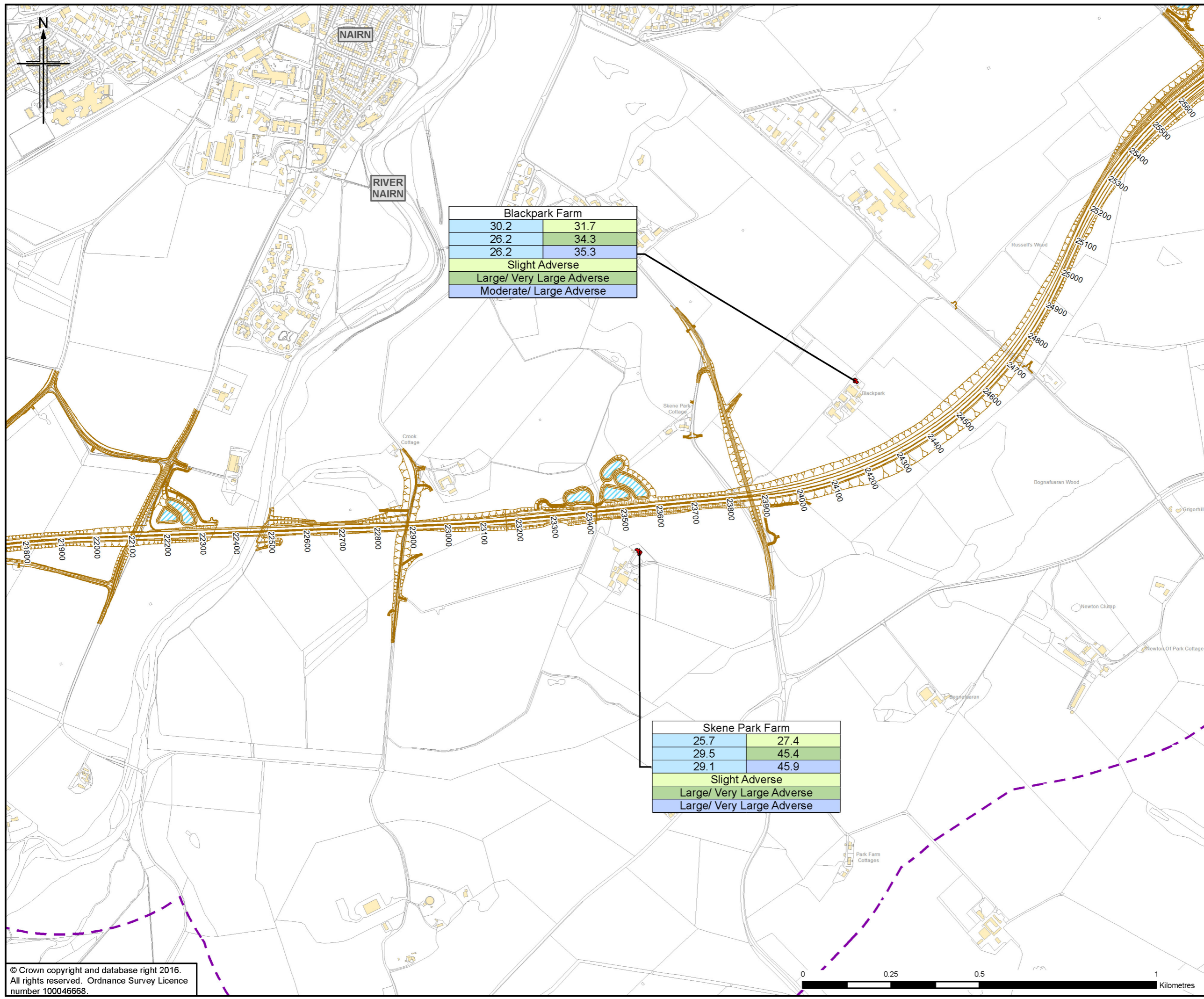

- Legend**
- Proposed Scheme (as per Draft Orders)
 - SUDS (e.g. Basin or Pond)*
 - Calculation Area
 - Sample Receptor

Location Name**	
Do Minimum Baseline Year	Do Minimum Future Year
Do Minimum Baseline Year	Do Something Baseline Year
Do Minimum Baseline Year	Do Something Future Year
Significance of Impact (DMB vs DMF)	
Significance of Impact (DMB vs DSB)	
Significance of Impact (DMB vs DSF)	

DMB = Do Minimum Baseline Year
 DMF = Do Minimum Future Year
 DSB = Do Something Baseline Year
 DSF = Do Something Future Year

* Actual shape of pond/basin will be subject to detailed design
 ** Predicted noise levels at the least beneficial façade for each scenario comparison

Rev.	Rev. Date	Purpose of revision	OrigDwnl	Checkd	Rev'd	Apprv'd
0	NOV 2016	ES Preparation	KA	KF	BMCK	EHO

JACOBS
 36 Belford Street, Glasgow, G2 7HX, UK
 Tel: +44(0)141 243 8000 Fax: +44(0)141 226 3109
 www.jacobs.com



Drawing title
Figure 8.18i
Environmental Statement
Sample Receptor Predicted Night-time Noise Levels
(Ground Floor)

Drawing Status	FINAL		Sheet 9 of 12
Scale	1:10,000	@ A3	DO NOT SCALE
Jacobs No.	B2103500		
BIM No.			
Drawing number	B2103500/EN/EIA/DR/818i	Rev	0

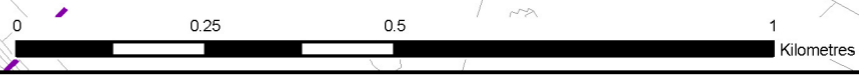

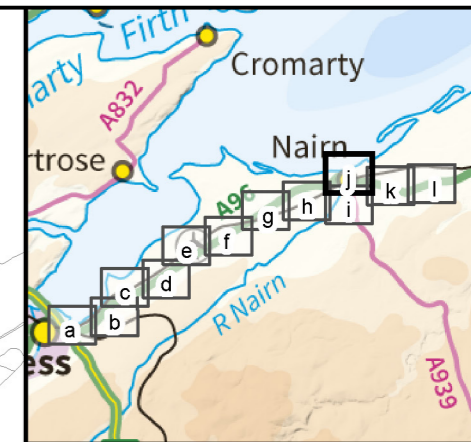
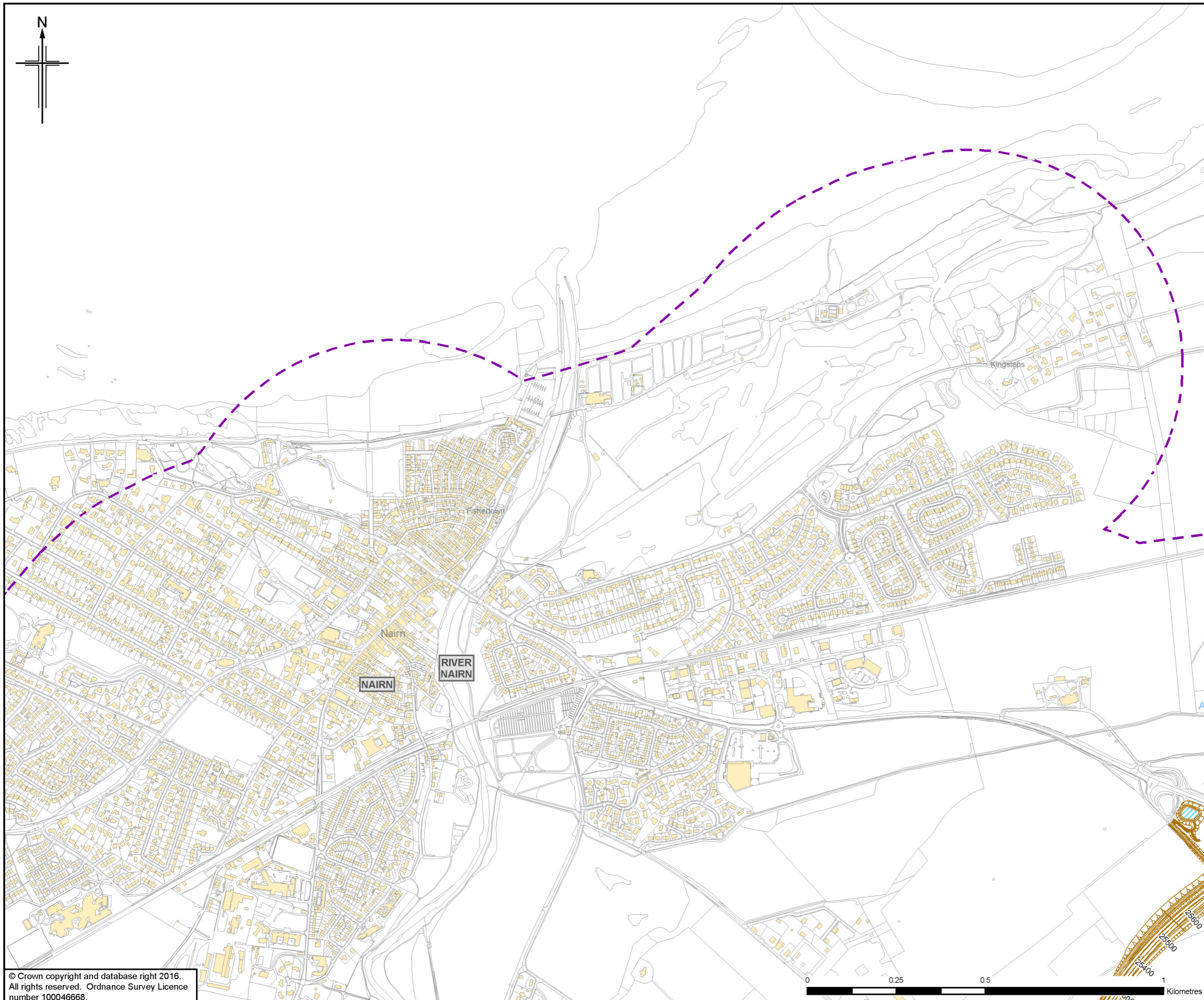
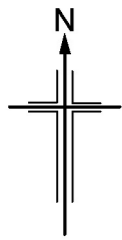

- Legend**
- Proposed Scheme (as per Draft Orders)
 - SUDS (e.g. Basin or Pond)*
 - - - Calculation Area
 - Sample Receptor

Location Name**	
Do Minimum Baseline Year	Do Minimum Future Year
Do Minimum Baseline Year	Do Something Baseline Year
Do Minimum Baseline Year	Do Something Future Year
Significance of Impact (DMB vs DMF)	
Significance of Impact (DMB vs DSB)	
Significance of Impact (DMB vs DSF)	

DMB = Do Minimum Baseline Year
 DMF = Do Minimum Future Year
 DSB = Do Something Baseline Year
 DSF = Do Something Future Year

* Actual shape of pond/basin will be subject to detailed design
 ** Predicted noise levels at the least beneficial façade for each scenario comparison

Rev.	Rev. Date	Purpose of revision	OrigDwnl	Checkd	Rev'd	Apprv'd
0	NOV 2016	BB Publication	KA	KF	BMCK	EHG



Drawing title
**Figure 8.18j
 Environmental Statement
 Sample Receptor Predicted Night-time Noise Levels
 (Ground Floor)**

Drawing Status	FINAL			Sheet 10 of 12
Scale	1:10,000	@ A3	DO NOT SCALE	
Jacobs No.	B2103500			
BIM No.				
Drawing number	B2103500/EN/EIA/DR/818j			Rev 0

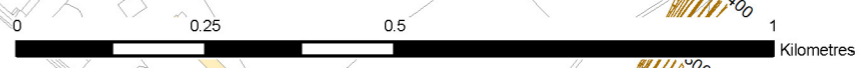

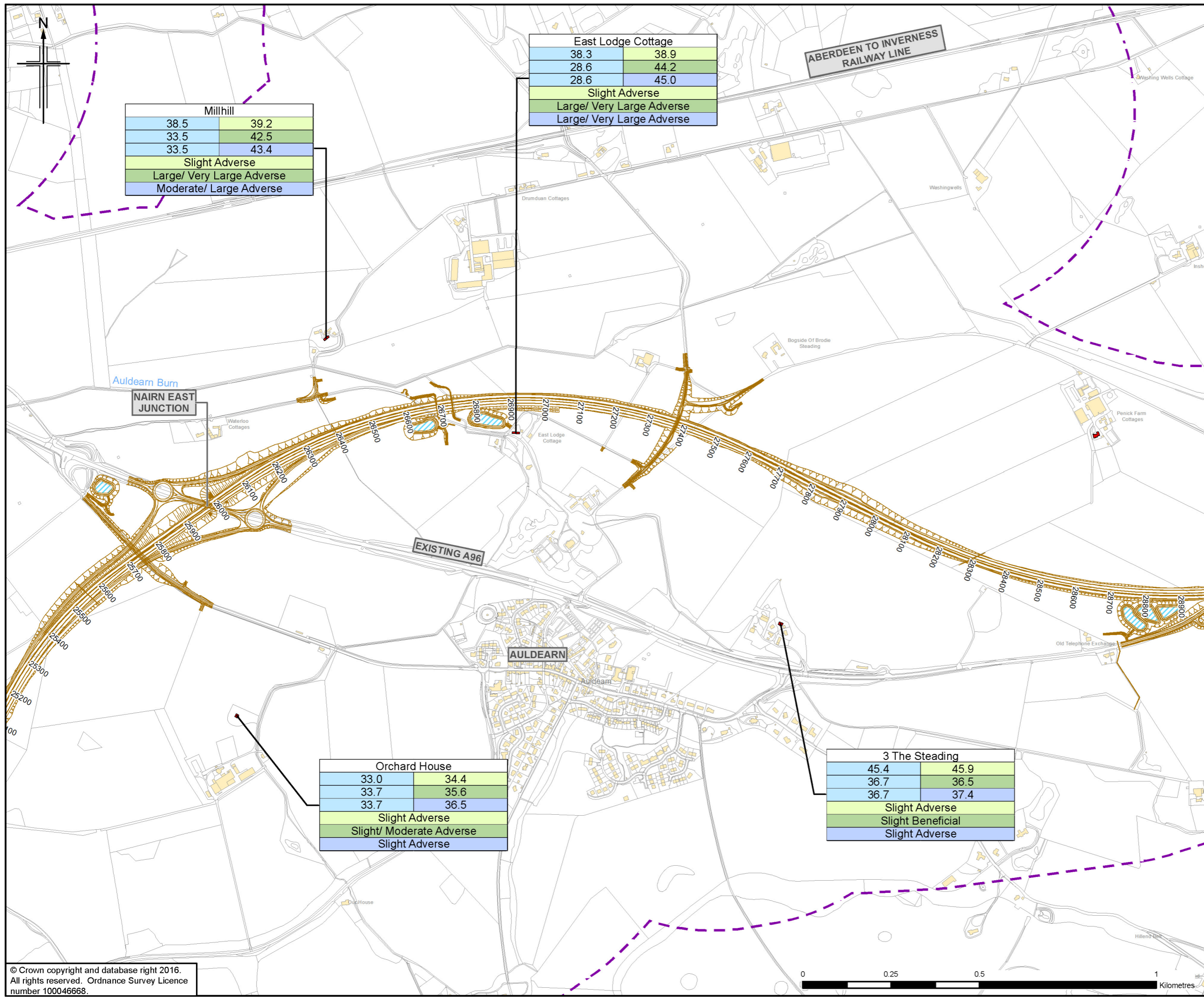

Millhill	
38.5	39.2
33.5	42.5
33.5	43.4
Slight Adverse	
Large/ Very Large Adverse	
Moderate/ Large Adverse	

East Lodge Cottage	
38.3	38.9
28.6	44.2
28.6	45.0
Slight Adverse	
Large/ Very Large Adverse	
Large/ Very Large Adverse	

Orchard House	
33.0	34.4
33.7	35.6
33.7	36.5
Slight Adverse	
Slight/ Moderate Adverse	
Slight Adverse	

3 The Steading	
45.4	45.9
36.7	36.5
36.7	37.4
Slight Adverse	
Slight Beneficial	
Slight Adverse	

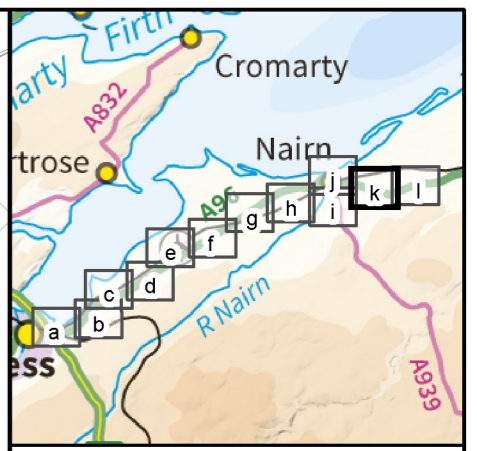

- Legend**
- Proposed Scheme (as per Draft Orders)
 - SUDS (e.g. Basin or Pond)*
 - Calculation Area
 - Sample Receptor

Location Name**	
Do Minimum Baseline Year	Do Minimum Future Year
Do Minimum Baseline Year	Do Something Baseline Year
Do Minimum Baseline Year	Do Something Future Year
Significance of Impact (DMB vs DMF)	
Significance of Impact (DMB vs DSB)	
Significance of Impact (DMB vs DSF)	

DMB = Do Minimum Baseline Year
 DMF = Do Minimum Future Year
 DSB = Do Something Baseline Year
 DSF = Do Something Future Year

* Actual shape of pond/basin will be subject to detailed design
 ** Predicted noise levels at the least beneficial façade for each scenario comparison

Rev.	Rev. Date	Purpose of revision	OrigDwnl	Checkd	Rev'd	Apprv'd
0	NOV 2016	ES Preparation	KA	KF	BMCK	EHO

JACOBS
 36 Belford Street, Glasgow, G2 7HF, UK
 Tel: +44(0)141 243 8000 Fax: +44(0)141 226 3109
 www.jacobs.com

Client

 TRANSPORT SCOTLAND
 COMHDAIL ALBA

Project

A96
 DUALLING
 INVERNESS TO NAIRN
 (Incl. Nairn Bypass)

Drawing title
Figure 8.18k
Environmental Statement
Sample Receptor Predicted Night-time Noise Levels
(Ground Floor)

Drawing Status	FINAL		Sheet 11 of 12
Scale	1:10,000 @ A3	DO NOT SCALE	
Jacobs No.	B2103500		
BIM No.			
Drawing number	B2103500/EN/EIA/DR/818k	Rev	0



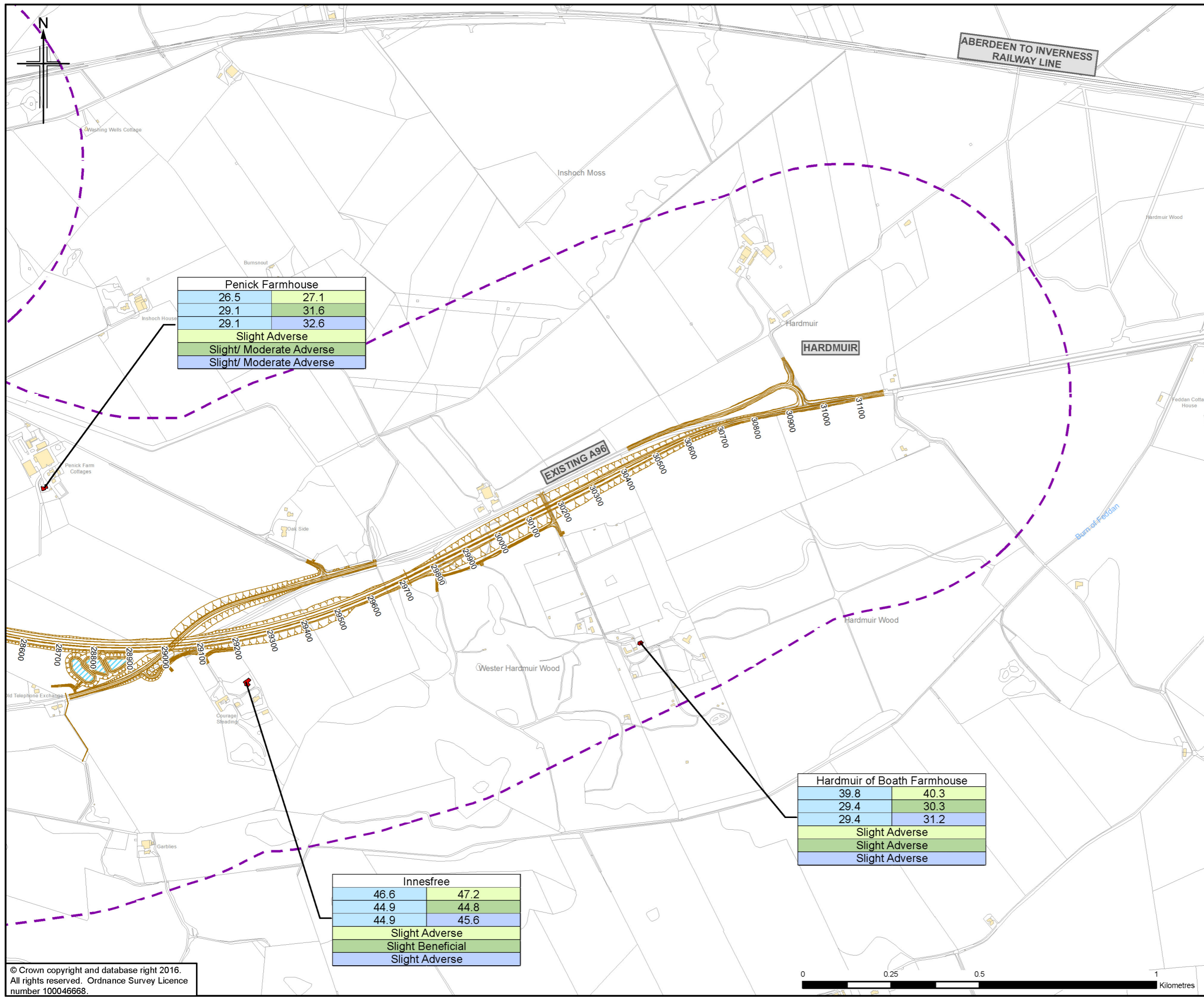

Penick Farmhouse	
26.5	27.1
29.1	31.6
29.1	32.6
Slight Adverse	
Slight/ Moderate Adverse	
Slight/ Moderate Adverse	

Hardmuir of Boath Farmhouse	
39.8	40.3
29.4	30.3
29.4	31.2
Slight Adverse	
Slight Adverse	
Slight Adverse	

Innesfree	
46.6	47.2
44.9	44.8
44.9	45.6
Slight Adverse	
Slight Beneficial	
Slight Adverse	

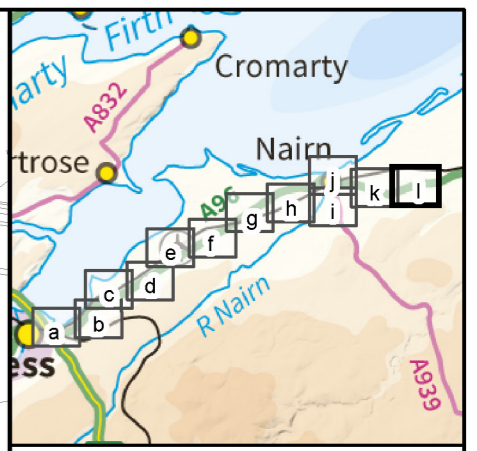

- Legend**
- Proposed Scheme (as per Draft Orders)
 - SUDS (e.g. Basin or Pond)*
 - Calculation Area
 - Sample Receptor

Location Name**	
Do Minimum Baseline Year	Do Minimum Future Year
Do Minimum Baseline Year	Do Something Baseline Year
Do Minimum Baseline Year	Do Something Future Year
Significance of Impact (DMB vs DMF)	
Significance of Impact (DMB vs DSB)	
Significance of Impact (DMB vs DSF)	

DMB = Do Minimum Baseline Year
 DMF = Do Minimum Future Year
 DSB = Do Something Baseline Year
 DSF = Do Something Future Year

* Actual shape of pond/basin will be subject to detailed design
 ** Predicted noise levels at the least beneficial façade for each scenario comparison

Rev.	Rev. Date	Purpose of revision	Orig'Dwnl	Check'd	Rev'd	Apprv'd
0	NOV 2016	ES Publication	KA	KF	BMCK	EHO



Figure 8.181
 Environmental Statement
 Sample Receptor Predicted Night-time Noise Levels (Ground Floor)

Drawing Status	FINAL		
Scale	1:10,000	@ A3	DO NOT SCALE
Jacobs No.	B2103500		
BIM No.			
Drawing number	B2103500/EN/EIA/DR/8181	Rev	0

