

Roseacre	
44.7	44.8
44.7	46.3
44.7	46.7
Slight Adverse	
Slight/ Moderate Adverse	
Slight Adverse	

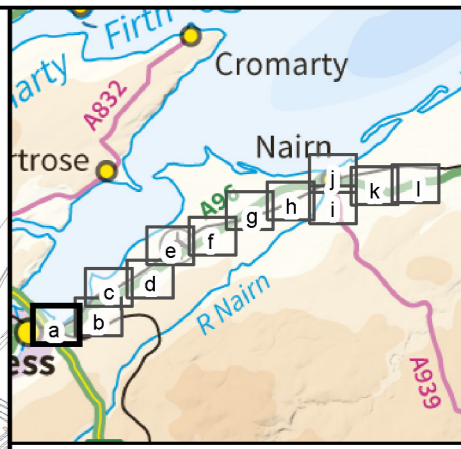

- Legend**
- Proposed Scheme (as per Draft Orders)
 - SUDS (e.g. Basin or Pond)*
 - Calculation Area
 - Sample Receptor
 - Noise Mitigation Barrier

Location Name**	
Do Minimum Baseline Year	Do Minimum Future Year
Do Minimum Baseline Year	Do Something Baseline Year
Do Minimum Baseline Year	Do Something Future Year
Significance of Impact (DMB vs DMF)	
Significance of Impact (DMB vs DSB)	
Significance of Impact (DMB vs DSF)	

DMB = Do Minimum Baseline Year
 DMF = Do Minimum Future Year
 DSB = Do Something Baseline Year
 DSF = Do Something Future Year

* Actual shape of pond/basin will be subject to detailed design
 ** Predicted noise levels at the least beneficial façade for each scenario comparison

Rev.	Rev. Date	Purpose of revision	OrigDwnl	Checkd	Rev'd	Apprv'd
0	NOV 2016	ES Publication	KA	SG	GK	DP

JACOBS
 36 Belford Street, Glasgow, G2 7HW, UK
 Tel: +44(0)141 243 8000 Fax: +44(0)141 226 3109
 www.jacobs.com

Client

 TRANSPORT SCOTLAND
 COMHDAHL ALBA

Project

A96
 DUALLING
 INVERNESS TO NAIRN
 (Incl. Nairn Bypass)

Drawing title
Figure 8.21a
 Environmental Statement
 Sample Receptor Predicted Night-time Noise Levels
 (First Floor) (With Mitigation)

Sheet 1 of 12

Drawing Status	FINAL
Scale	1:10,000 @ A3 DO NOT SCALE
Jacobs No.	B2103500
BIM No.	
Drawing number	B2103500/EN/EIA/DR/821a
Rev	0

This drawing is not to be used in whole or part other than for the intended purpose and project as defined on this drawing. Refer to the contract for full terms and conditions.

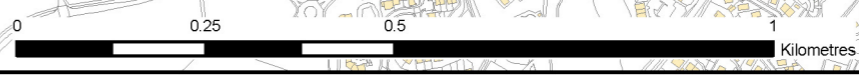

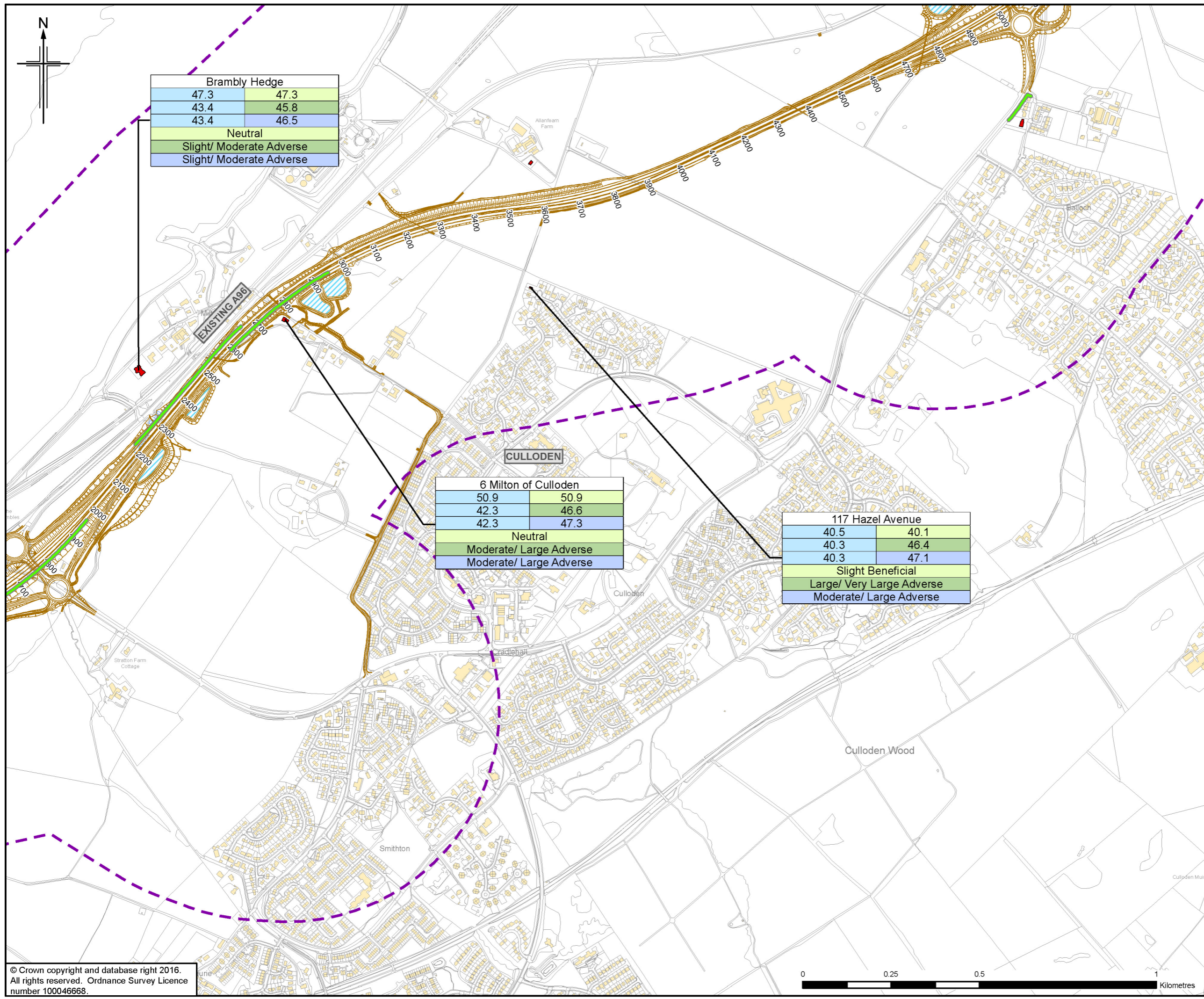

Brambly Hedge	
47.3	47.3
43.4	45.8
43.4	46.5
Neutral	
Slight/ Moderate Adverse	
Slight/ Moderate Adverse	

6 Milton of Culloiden	
50.9	50.9
42.3	46.6
42.3	47.3
Neutral	
Moderate/ Large Adverse	
Moderate/ Large Adverse	

117 Hazel Avenue	
40.5	40.1
40.3	46.4
40.3	47.1
Slight Beneficial	
Large/ Very Large Adverse	
Moderate/ Large Adverse	

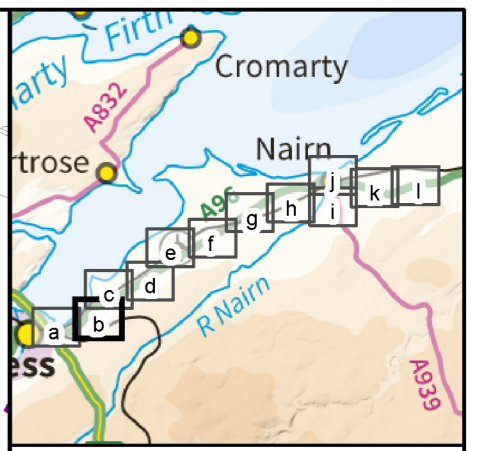

- Legend**
- Proposed Scheme (as per Draft Orders)
 - SUDS (e.g. Basin or Pond)*
 - Calculation Area
 - Sample Receptor
 - Noise Mitigation Barrier

Location Name**	
Do Minimum Baseline Year	Do Minimum Future Year
Do Minimum Baseline Year	Do Something Baseline Year
Do Minimum Baseline Year	Do Something Future Year
Significance of Impact (DMB vs DMF)	
Significance of Impact (DMB vs DSB)	
Significance of Impact (DMB vs DSF)	

DMB = Do Minimum Baseline Year
 DMF = Do Minimum Future Year
 DSB = Do Something Baseline Year
 DSF = Do Something Future Year

* Actual shape of pond/basin will be subject to detailed design
 ** Predicted noise levels at the least beneficial façade for each scenario comparison

0	NOV 2016	ES Preparation	KA	SG	GK	DP
Rev.	Rev. Date	Purpose of revision	Orig/Dwnl	Checkd	Rev'd	Apprv'd

JACOBS
 36 Belford Street, Glasgow, G2 7HX, UK
 Tel: +44(0)141 243 8000 Fax: +44(0)141 226 3109
 www.jacobs.com

Client

 TRANSPORT SCOTLAND
 COMHDAH ALBA

Project

A96
 DUALLING
 INVERNESS TO NAIRN
 (Incl. Nairn Bypass)

Drawing title
Figure 8.21b
Environmental Statement
Sample Receptor Predicted Night-time Noise Levels
(First Floor) (With Mitigation)

Sheet 2 of 12		
Drawing Status	FINAL	
Scale	1:10,000 @ A3	DO NOT SCALE
Jacobs No.	B2103500	
BIM No.		
Drawing number	B2103500/EN/EIA/DR/821b	Rev 0

This drawing is not to be used in whole or part other than for the intended purpose and project as defined on this drawing. Refer to the contract for full terms and conditions.

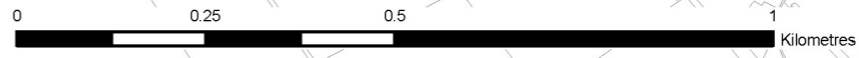



The Bungalow	
39.5	39.2
38.9	46.4
38.9	47.1
Slight Beneficial	
Large/ Very Large Adverse	
Moderate/ Large Adverse	

Thornhill	
48.2	48.4
37.0	39.3
37.0	40.1
Slight Adverse	
Slight/ Moderate Adverse	
Slight/ Moderate Adverse	

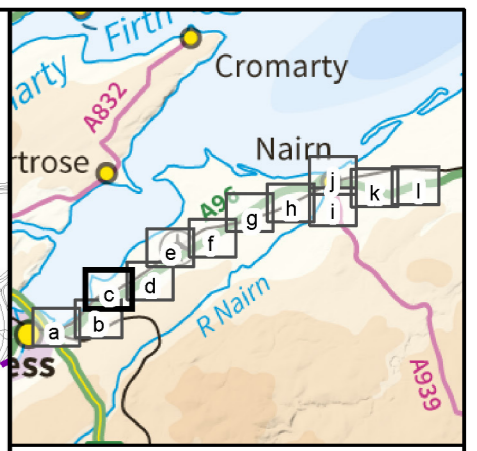

- Legend**
- Proposed Scheme (as per Draft Orders)
 - SUDS (e.g. Basin or Pond)*
 - Calculation Area
 - Sample Receptor
 - Noise Mitigation Barrier

Location Name**	
Do Minimum Baseline Year	Do Minimum Future Year
Do Minimum Baseline Year	Do Something Baseline Year
Do Minimum Baseline Year	Do Something Future Year
Significance of Impact (DMB vs DMF)	
Significance of Impact (DMB vs DSB)	
Significance of Impact (DMB vs DSF)	

DMB = Do Minimum Baseline Year
 DMF = Do Minimum Future Year
 DSB = Do Something Baseline Year
 DSF = Do Something Future Year

* Actual shape of pond/basin will be subject to detailed design
 ** Predicted noise levels at the least beneficial façade for each scenario comparison

Rev.	Rev. Date	Purpose of revision	OrigDwnl	Checkd	Rev'd	Apprv'd
0	NOV 2016	ES Preparation	KA	SG	GK	DP

JACOBS
 36 Belford Street, Glasgow, G2 7HL, UK
 Tel: +44(0)141 243 8000 Fax: +44(0)141 226 3109
 www.jacobs.com

Client

 TRANSPORT SCOTLAND
 COMHDAHL ALBA

Project

A96
 DUALLING
 INVERNESS TO NAIRN
 (Incl. Nairn Bypass)

Drawing title
Figure 8.21c
 Environmental Statement
 Sample Receptor Predicted Night-time Noise Levels
 (First Floor) (With Mitigation)

Drawing Status	FINAL		Sheet 3 of 12
Scale	1:10,000	@ A3	DO NOT SCALE
Jacobs No.	B2103500		
BIM No.			
Drawing number	B2103500/EN/EIA/DR/821c	Rev	0

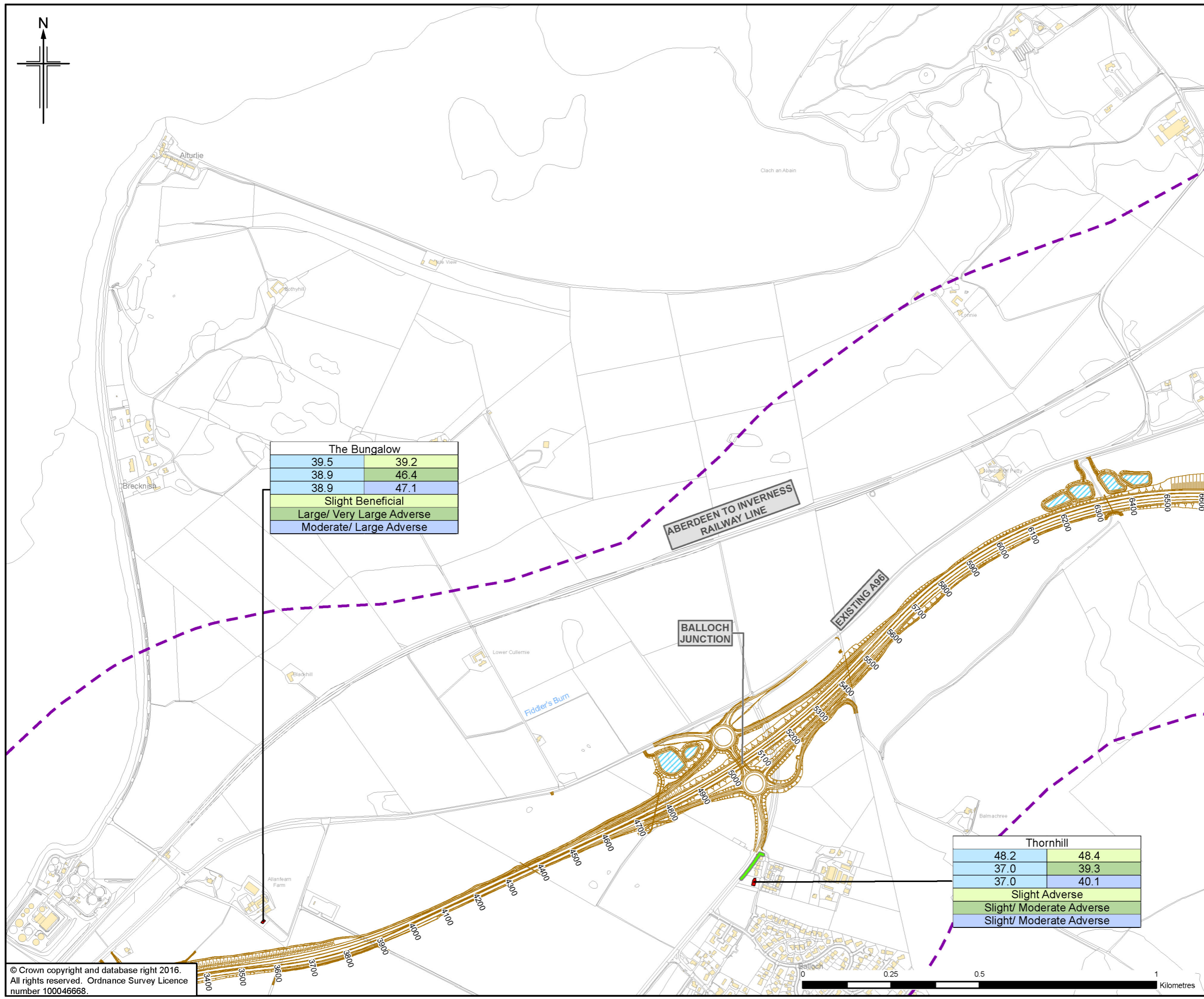

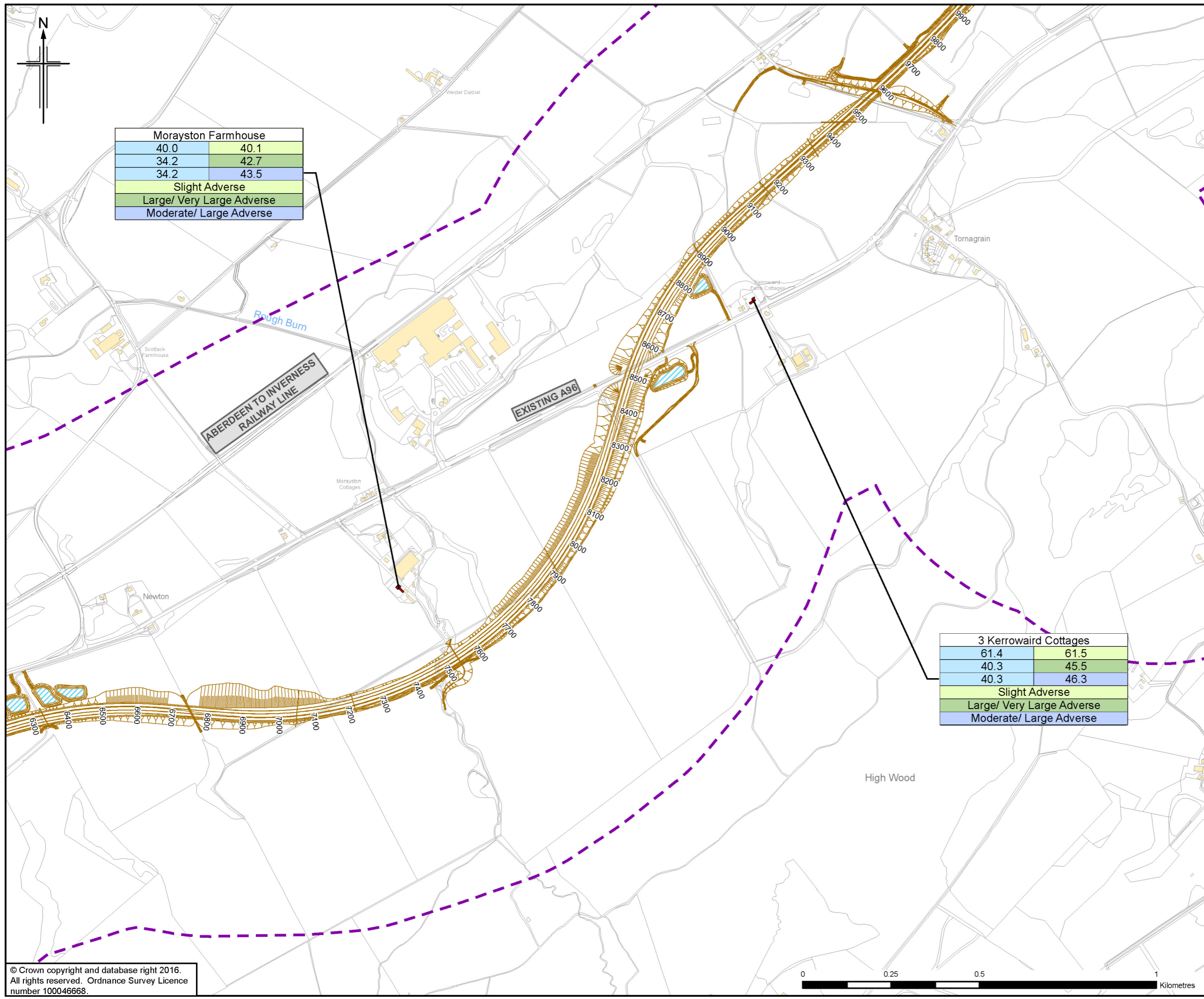

Morayston Farmhouse	
40.0	40.1
34.2	42.7
34.2	43.5
Slight Adverse	
Large/ Very Large Adverse	
Moderate/ Large Adverse	

3 Kerrowaird Cottages	
61.4	61.5
40.3	45.5
40.3	46.3
Slight Adverse	
Large/ Very Large Adverse	
Moderate/ Large Adverse	

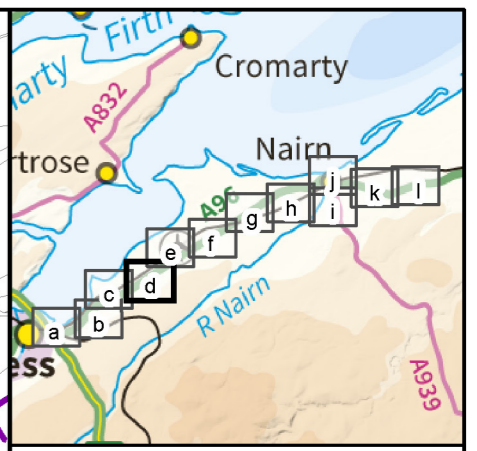

- Legend**
- Proposed Scheme (as per Draft Orders)
 - SUDS (e.g. Basin or Pond)*
 - Calculation Area
 - Sample Receptor
 - Noise Mitigation Barrier

Location Name**	
Do Minimum Baseline Year	Do Minimum Future Year
Do Minimum Baseline Year	Do Something Baseline Year
Do Minimum Baseline Year	Do Something Future Year
Significance of Impact (DMB vs DMF)	
Significance of Impact (DMB vs DSB)	
Significance of Impact (DMB vs DSF)	

DMB = Do Minimum Baseline Year
 DMF = Do Minimum Future Year
 DSB = Do Something Baseline Year
 DSF = Do Something Future Year

* Actual shape of pond/basin will be subject to detailed design
 ** Predicted noise levels at the least beneficial façade for each scenario comparison

0	NOV 2016	SB Planning	KA	SG	GK	DP
Rev.	Rev. Date	Purpose of revision	OrigDwnl	Checkd	Rev'd	Apprv'd

JACOBS
 36 Belford Street, Glasgow, G2 7NE, UK
 Tel: +44(0)141 243 8000 Fax: +44(0)141 226 3109
 www.jacobs.com

Client

Project

 INVERNESS TO NAIRN
 (Incl. Nairn Bypass)

Drawing title
Figure 8.21d
Environmental Statement
Sample Receptor Predicted Night-time Noise Levels
(First Floor) (With Mitigation)

Sheet 4 of 12		
Drawing Status	FINAL	
Scale	1:10,000 @ A3	DO NOT SCALE
Jacobs No.	B2103500	
BIM No.		
Drawing number	B2103500/EN/EIA/DR/821d	Rev 0

This drawing is not to be used in whole or part other than for the intended purpose and project as defined on this drawing. Refer to the contract for full terms and conditions.

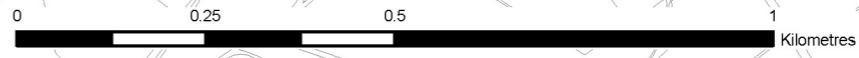

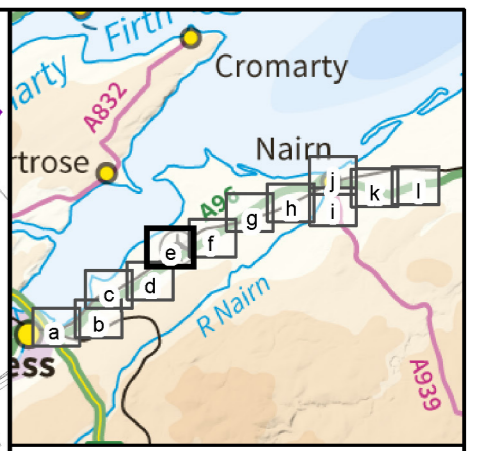
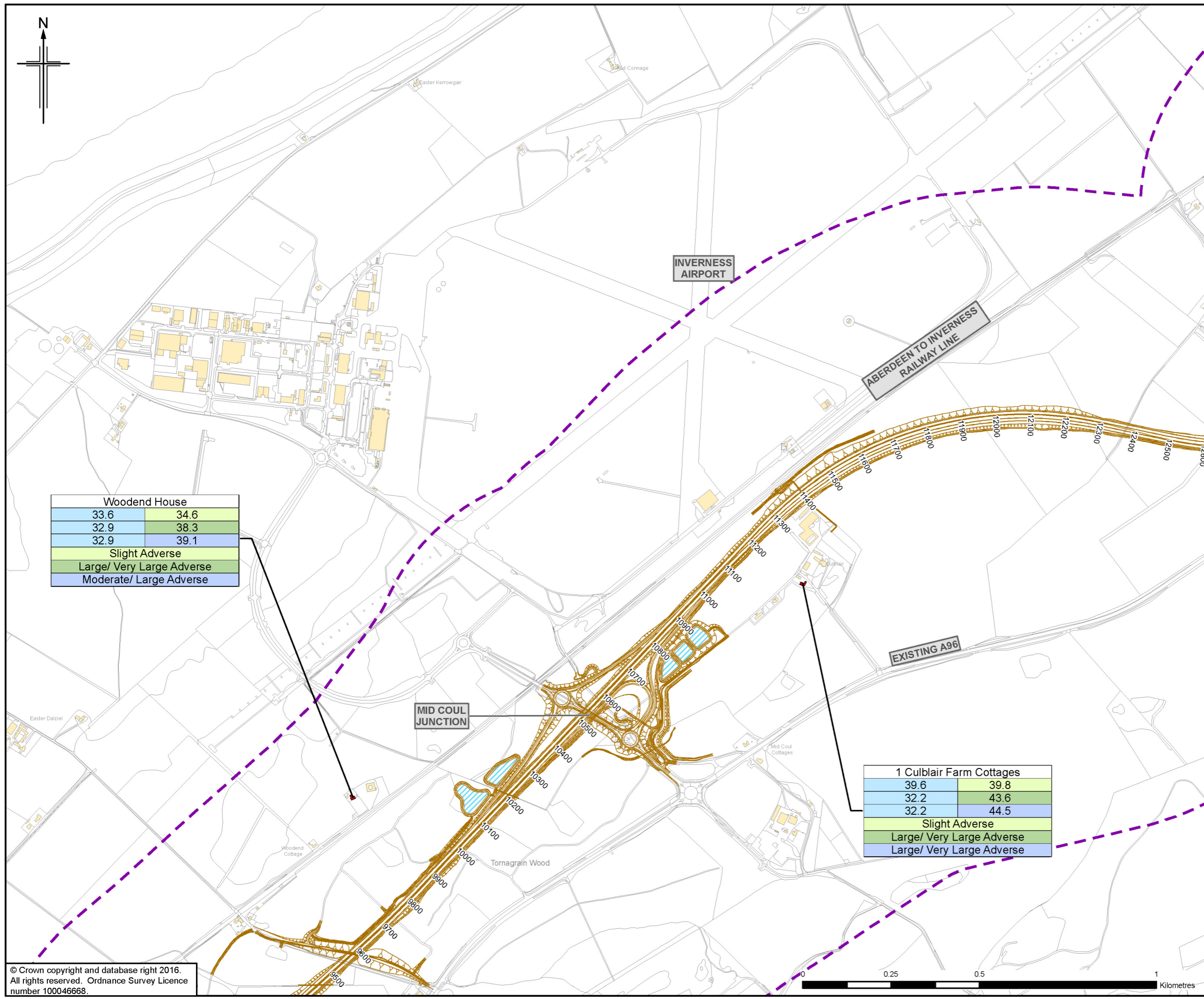

- Legend**
- Proposed Scheme (as per Draft Orders)
 - SUDS (e.g. Basin or Pond)*
 - - - Calculation Area
 - Sample Receptor
 - Noise Mitigation Barrier

Woodend House	
33.6	34.6
32.9	38.3
32.9	39.1
Slight Adverse	
Large/ Very Large Adverse	
Moderate/ Large Adverse	

1 Culblair Farm Cottages	
39.6	39.8
32.2	43.6
32.2	44.5
Slight Adverse	
Large/ Very Large Adverse	
Large/ Very Large Adverse	

Location Name**	
Do Minimum Baseline Year	Do Minimum Future Year
Do Minimum Baseline Year	Do Something Baseline Year
Do Minimum Baseline Year	Do Something Future Year
Significance of Impact (DMB vs DMF)	
Significance of Impact (DMB vs DSB)	
Significance of Impact (DMB vs DSF)	

DMB = Do Minimum Baseline Year
 DMF = Do Minimum Future Year
 DSB = Do Something Baseline Year
 DSF = Do Something Future Year

* Actual shape of pond/basin will be subject to detailed design
 ** Predicted noise levels at the least beneficial façade for each scenario comparison

Rev.	Rev. Date	Purpose of revision	OrigDwnl	Checkd	Rev'd	Apprv'd
0	NOV 2016	ED Preparation	KA	SG	GK	DP

JACOBS
 36 Belford Street, Glasgow, G2 7HX, UK
 Tel: +44(0)141 243 8000 Fax: +44(0)141 226 3109
 www.jacobs.com

Client

 TRANSPORT SCOTLAND
 COMHDAHL ALBA

Project

A96
 DUALLING
 INVERNESS TO NAIRN
 (Incl. Nairn Bypass)

Drawing title
Figure 8.21e
Environmental Statement
Sample Receptor Predicted Night-time Noise Levels
(First Floor) (With Mitigation)

Drawing Status	FINAL		Sheet 5 of 12
Scale	1:10,000	@ A3	DO NOT SCALE
Jacobs No.	B2103500		
BIM No.			
Drawing number	B2103500/EN/EIA/DR/821e	Rev	0

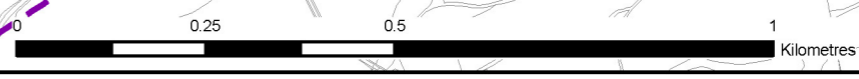

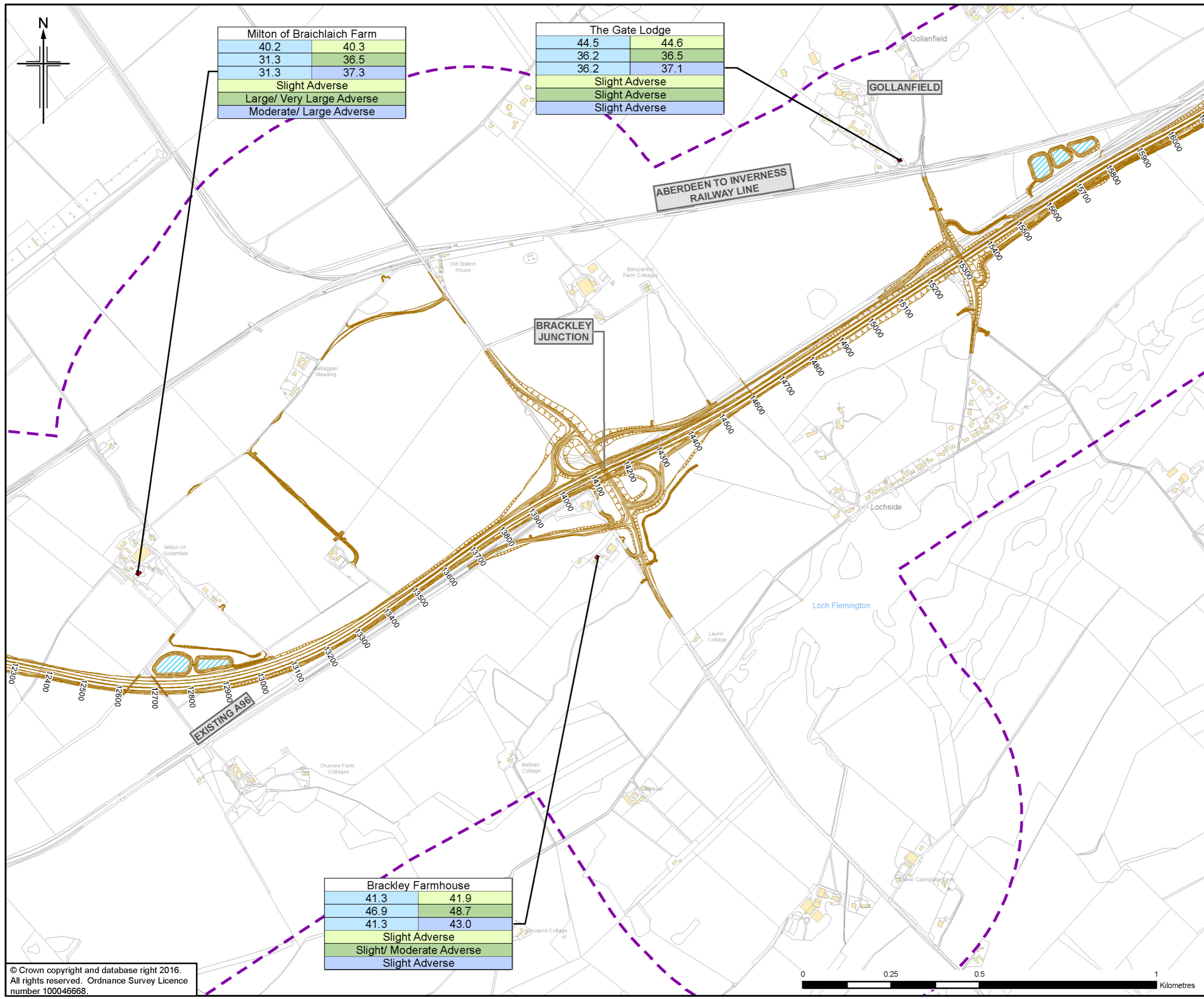

Milton of Braichlaich Farm	
40.2	40.3
31.3	36.5
31.3	37.3
Slight Adverse	
Large/ Very Large Adverse	
Moderate/ Large Adverse	

The Gate Lodge	
44.5	44.6
36.2	36.5
36.2	37.1
Slight Adverse	
Slight Adverse	
Slight Adverse	

Brackley Farmhouse	
41.3	41.9
46.9	48.7
41.3	43.0
Slight Adverse	
Slight/ Moderate Adverse	
Slight Adverse	

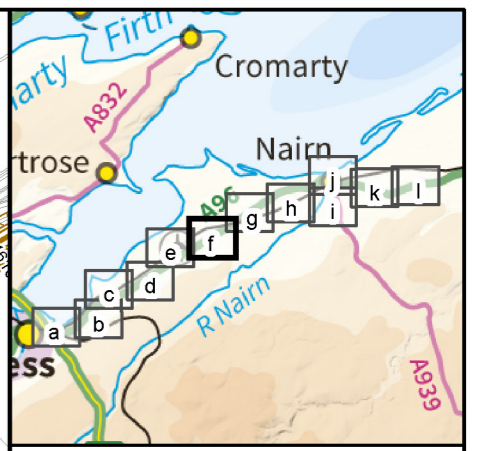

- Legend**
- Proposed Scheme (as per Draft Orders)
 - SUDS (e.g. Basin or Pond)*
 - Calculation Area
 - Sample Receptor
 - Noise Mitigation Barrier

Location Name**	
Do Minimum Baseline Year	Do Minimum Future Year
Do Minimum Baseline Year	Do Something Baseline Year
Do Minimum Baseline Year	Do Something Future Year
Significance of Impact (DMB vs DMF)	
Significance of Impact (DMB vs DSB)	
Significance of Impact (DMB vs DSF)	

DMB = Do Minimum Baseline Year
 DMF = Do Minimum Future Year
 DSB = Do Something Baseline Year
 DSF = Do Something Future Year

* Actual shape of pond/basin will be subject to detailed design
 ** Predicted noise levels at the least beneficial façade for each scenario comparison

Rev.	Rev. Date	Purpose of revision	OrigDwnl	Checkd	Rev'd	Apprv'd
0	NOV 2016	ES Publication	KA	SG	GK	DP

JACOBS
 36 Belford Street, Glasgow, G2 7HF, UK
 Tel: +44(0)141 243 8000 Fax: +44(0)141 226 3109
 www.jacobs.com

Client

 TRANSPORT SCOTLAND
 COMHDAHL ALBA

Project

A96
 DUALLING
 INVERNESS TO NAIRN
 (Incl. Nairn Bypass)

Drawing title
Figure 8.21f
Environmental Statement
Sample Receptor Predicted Night-time Noise Levels
(First Floor) (With Mitigation)

Drawing Status	FINAL	
Scale	1:10,000 @ A3	DO NOT SCALE
Jacobs No.	B2103500	
BIM No.		
Drawing number	B2103500/EN/EIA/DR/821f	Rev 0

This drawing is not to be used in whole or part other than for the intended purpose and project as defined on this drawing. Refer to the contract for full terms and conditions.