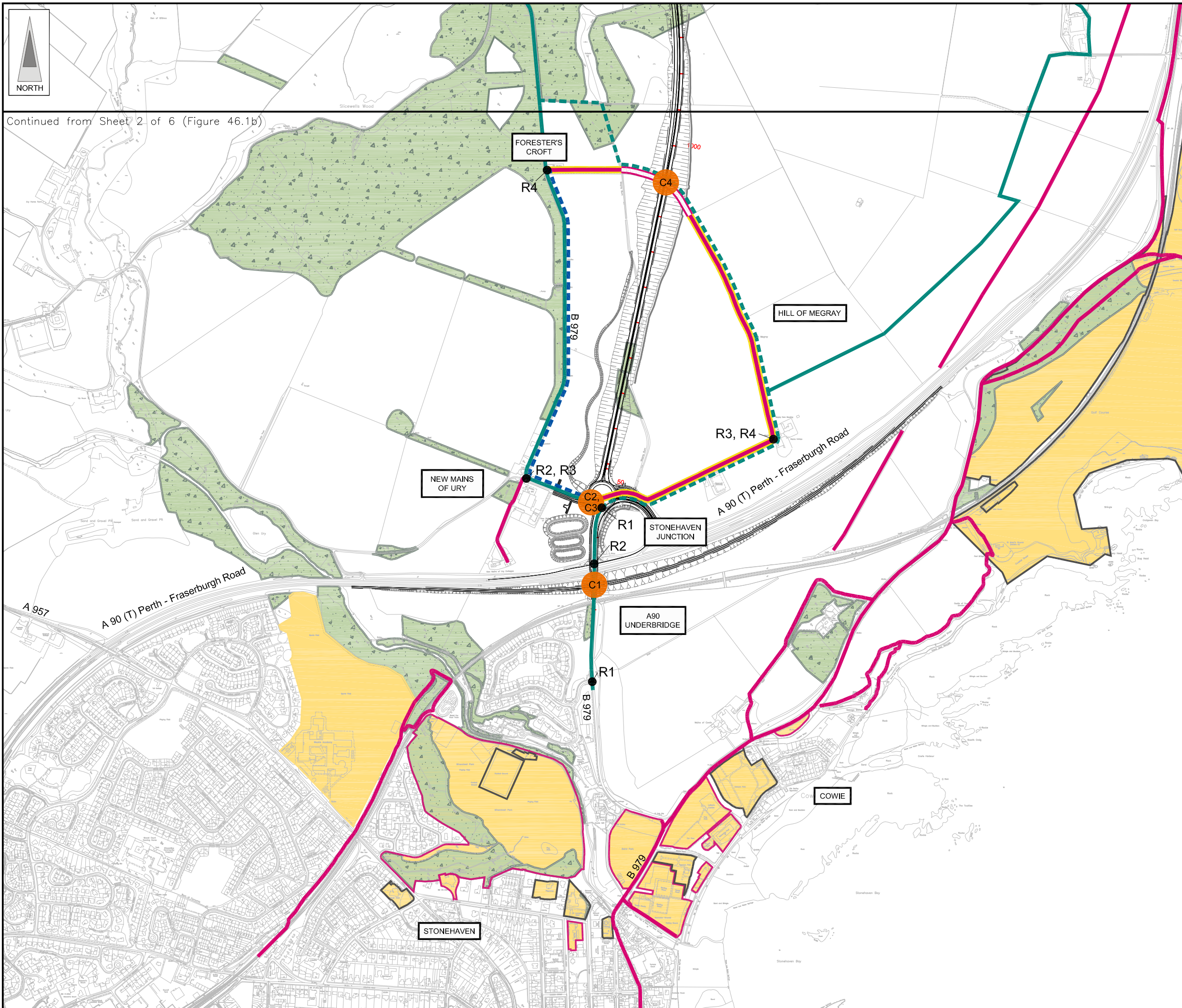
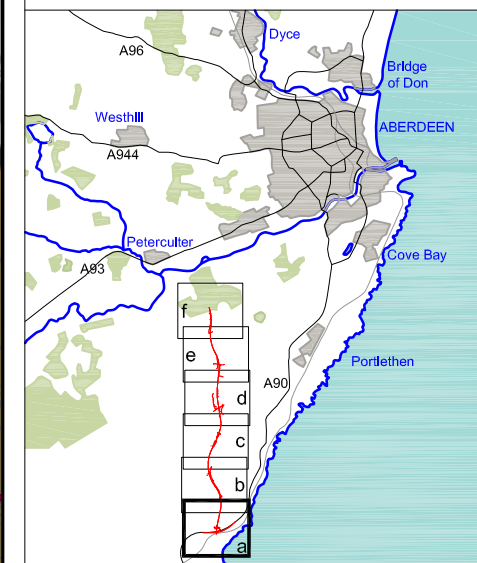

FIGURE 46.1a



- LEGEND**
- Proposed Route (Engineering Profile 04/05/07)
  - Woodland
  - Educational, Public / Recreational, Commercial } Community Facilities
  - Pedestrian Routes / Right of Way
  - Cycleway / Proposed Cycleway
  - Equestrian Routes
  - Pedestrian, Cycle, Equestrian } Route lost to AWPR
  - Proposed Route Diversion
  - Area of Conflict with Proposed AWPR Route
  - Journey Length End Point
  - R12 Route Number
  - BS / BS Bus Stop / Proposed New Bus Stop

Rev	Date	Purpose of Revision	Drwn	Chkd	Appd

**JE JACOBS**  
 95 Bothwell Street, Glasgow, G2 7HX, UK  
 Tel: 0141 204 2511 Fax: 0141 226 3109  
 www.jacobstabtle.com

Client					
Project	Aberdeen Western Peripheral Route Environmental Statement, Part D - Fastlink				
Title	Pedestrians, Cyclists and Equestrians Sheet 1 of 6				

Drawing Status	FINAL	Revisions	
JB No.	0010332	Date	July 2007
Figure No.	FIGURE 46.1a	Checked	
Scale	1:10,000	Approved	
Drawn	MY	Checked	FB
			SH

FIGURE 46.1b

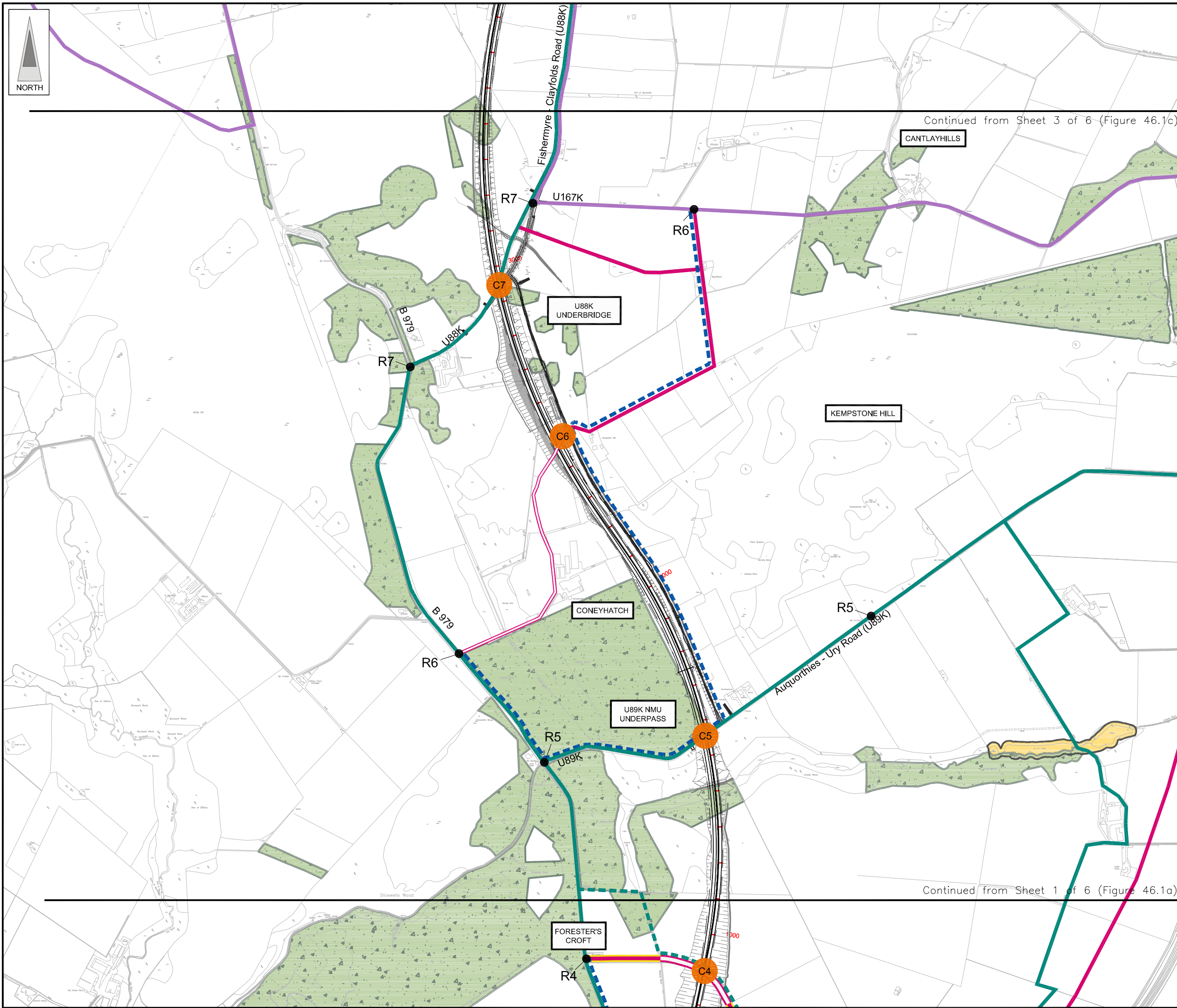
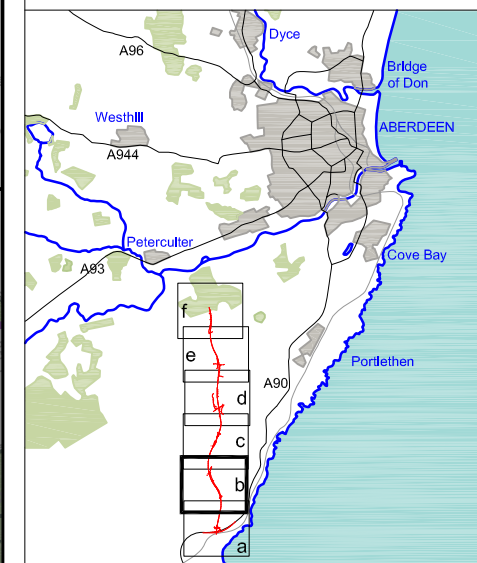

- LEGEND**
- Proposed Route (Engineering Profile 04/05/07)
  - Woodland
  - Community Facilities
  - Pedestrian Routes / Right of Way
  - Cycleway / Proposed Cycleway
  - Equestrian Routes
  - Route lost to AWPR
  - Proposed Route Diversion
  - Area of Conflict with Proposed AWPR Route
  - Journey Length End Point
  - Route Number
  - Bus Stop / Proposed New Bus Stop

Rev	Date	Purpose of Revision	Drwn	Chkd	Appd

**JE JACOBS**  
 95 Bothwell Street, Glasgow, G2 7HX, UK  
 Tel: 0141 204 2511 Fax: 0141 226 3109  
 www.jacobsbattle.com

Client: **Aberdeen Western Peripheral Route**

Project: **Aberdeen Western Peripheral Route Environmental Statement, Part D - Fastlink**

Title: **Pedestrians, Cyclists and Equestrians Sheet 2 of 6**

Drawing Status: FINAL	Revisions:
JB No. 0010332	Date: July 2007
Figure No. FIGURE 46.1b	Checked: FB
Scale: 1:10,000	Approved: SH
Drawn: MY	Signature:

FIGURE 46.1c

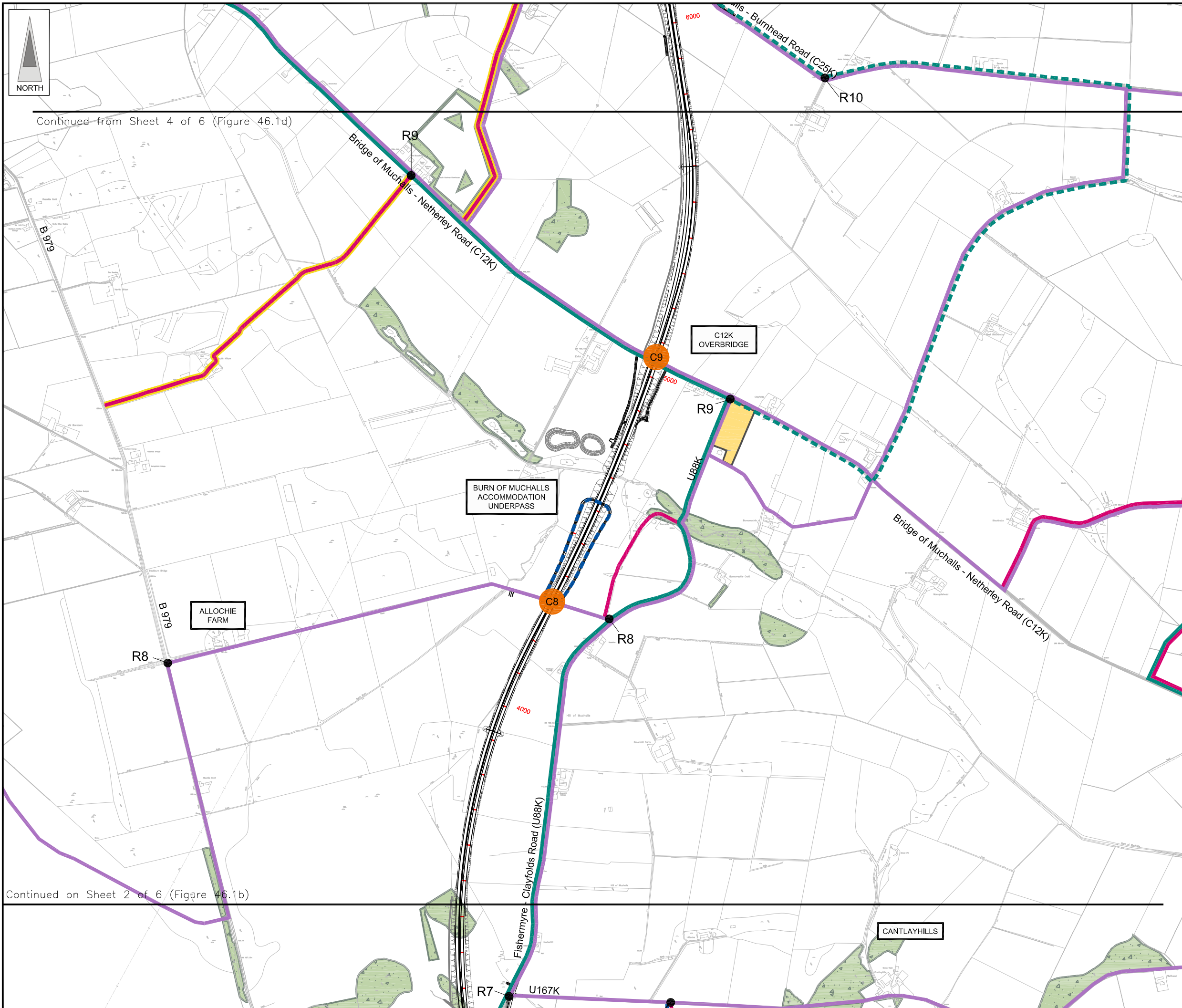
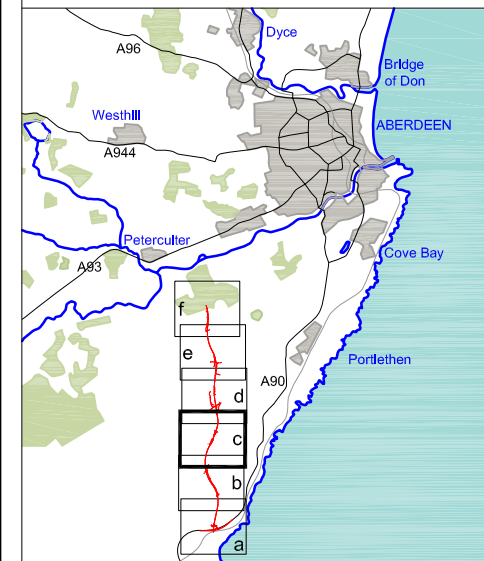

Continued from Sheet 4 of 6 (Figure 46.1d)

Continued on Sheet 2 of 6 (Figure 46.1b)

- LEGEND**
- Proposed Route (Engineering Profile 04/05/07)
  - Woodland
  - Community Facilities
  - Pedestrian Routes / Right of Way
  - Cycleway / Proposed Cycleway
  - Equestrian Routes
  - Route lost to AWPR
  - Proposed Route Diversion
  - Area of Conflict with Proposed AWPR Route
  - Journey Length End Point
  - Route Number
  - Bus Stop / Proposed New Bus Stop

Rev	Date	Purpose of Revision	Drwn	Chkd	Appd

**JE JACOBS**  
 95 Bothwell Street, Glasgow, G2 7HX, UK  
 Tel: 0141 204 2511 Fax: 0141 226 3109  
 www.jacobsbattle.com

Client: **Aberdeen Western Peripheral Route**

Project: **Aberdeen Western Peripheral Route Environmental Statement, Part D - Fastlink**

Title: **Pedestrians, Cyclists and Equestrians Sheet 3 of 6**

Drawing Status	FINAL	Revisions	
JB No.	0010332	Date	July 2007
Figure No.	FIGURE 46.1c	Checked	
Scale	1:10,000	Approved	SH
Drawn	MY		

This map is based on Ordnance Survey material with the permission of Ordnance Survey on behalf of the controller of Her Majesty's Stationery Office. Unauthorised reproduction infringes Crown copyright and may lead to prosecution or civil proceedings. Scottish Executive Licence Number, 100020540 (2007). Maps produced by Jacobs UK Ltd. This map should NOT be rescaled. Copyright reserved.

FIGURE 46.1d

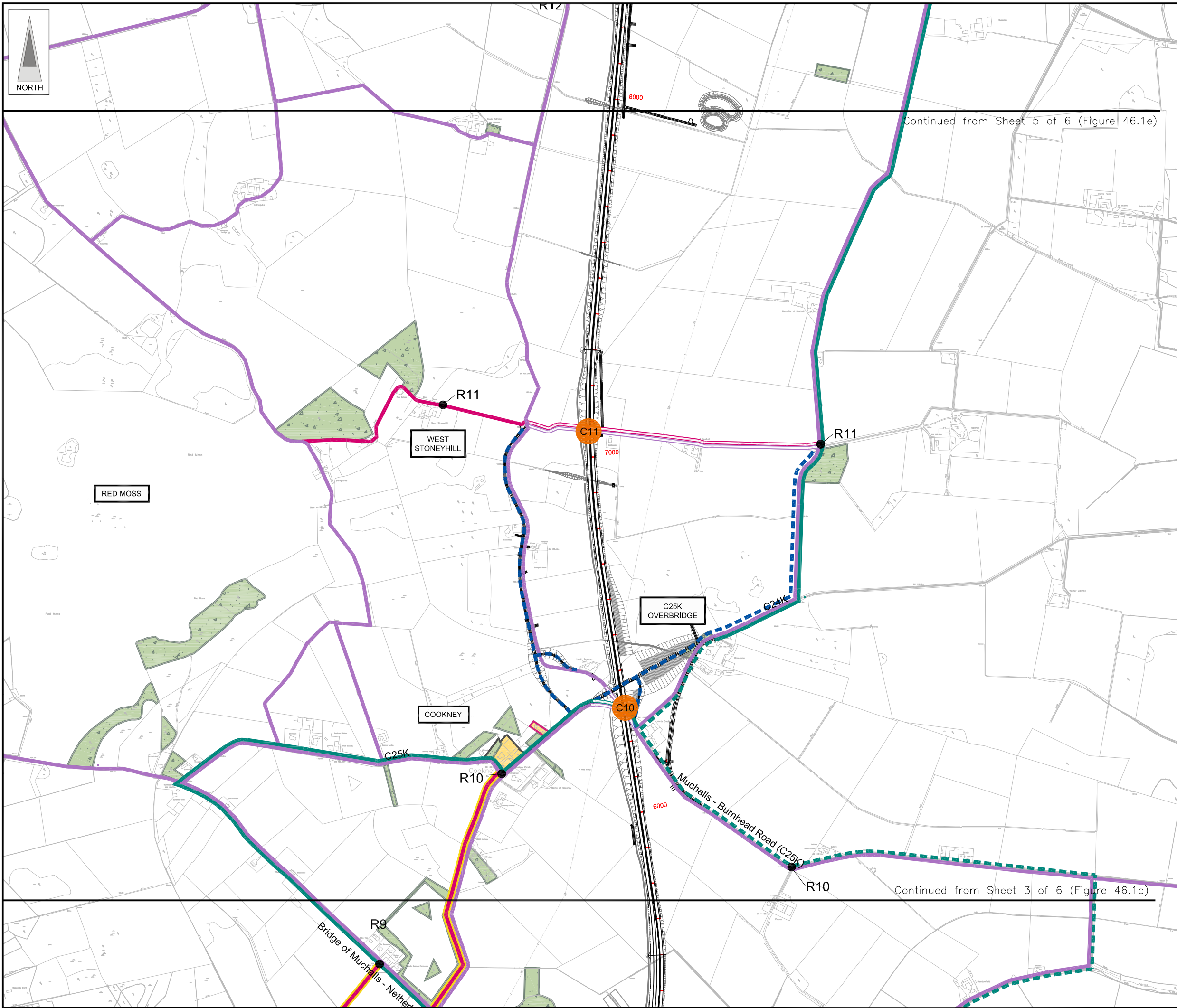
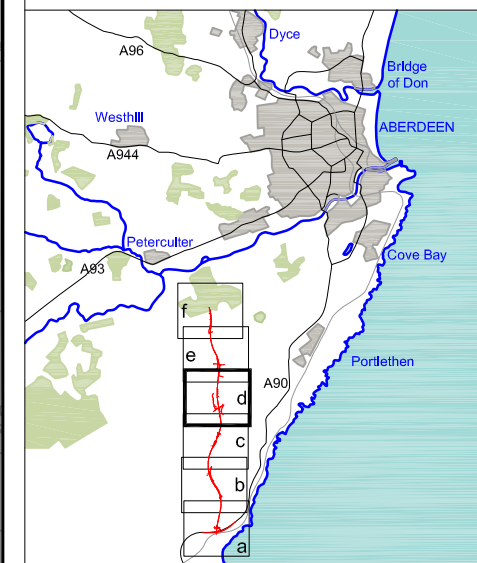

Continued from Sheet 5 of 6 (Figure 46.1e)

Continued from Sheet 3 of 6 (Figure 46.1c)

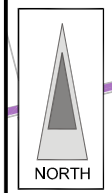

- LEGEND**
- Proposed Route (Engineering Profile 04/05/07)
  - Woodland
  - Community Facilities
  - Pedestrian Routes / Right of Way
  - Cycleway / Proposed Cycleway
  - Equestrian Routes
  - Route lost to AWPR
  - Proposed Route Diversion
  - Area of Conflict with Proposed AWPR Route
  - Journey Length End Point
  - Route Number
  - Bus Stop / Proposed New Bus Stop

Rev	Date	Purpose of Revision	Drwn	Chkd	Appd

**JE JACOBS**  
 95 Bothwell Street, Glasgow, G2 7HX, UK  
 Tel: 0141 204 2511 Fax: 0141 226 3109  
 www.jacobsbattle.com

Client: **Aberdeen Western Peripheral Route**

Project: **Aberdeen Western Peripheral Route Environmental Statement, Part D - Fastlink**

Title: **Pedestrians, Cyclists and Equestrians Sheet 4 of 6**

Drawing Status	FINAL	Revisions	
JB No.	0010332	Date	July 2007
Figure No.	FIGURE 46.1d	Checked	
Scale	1:10,000	Approved	SH
Drawn	MY	Checked	FB

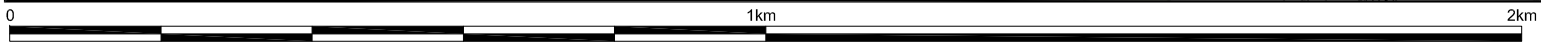

This map is based on Ordnance Survey material with the permission of Ordnance Survey on behalf of the controller of Her Majesty's Stationary Office. Unauthorised reproduction infringes Crown copyright and may lead to prosecution or civil proceedings. Scottish Executive Licence Number, 100020540 (2007).

This drawing is not to be used in whole or part other than for the intended purpose and project as defined on this drawing. Refer to the contract for full terms and conditions. Maps produced by Jacobs UK Ltd. This map should NOT be rescaled. Copyright reserved.

FIGURE 46.1e

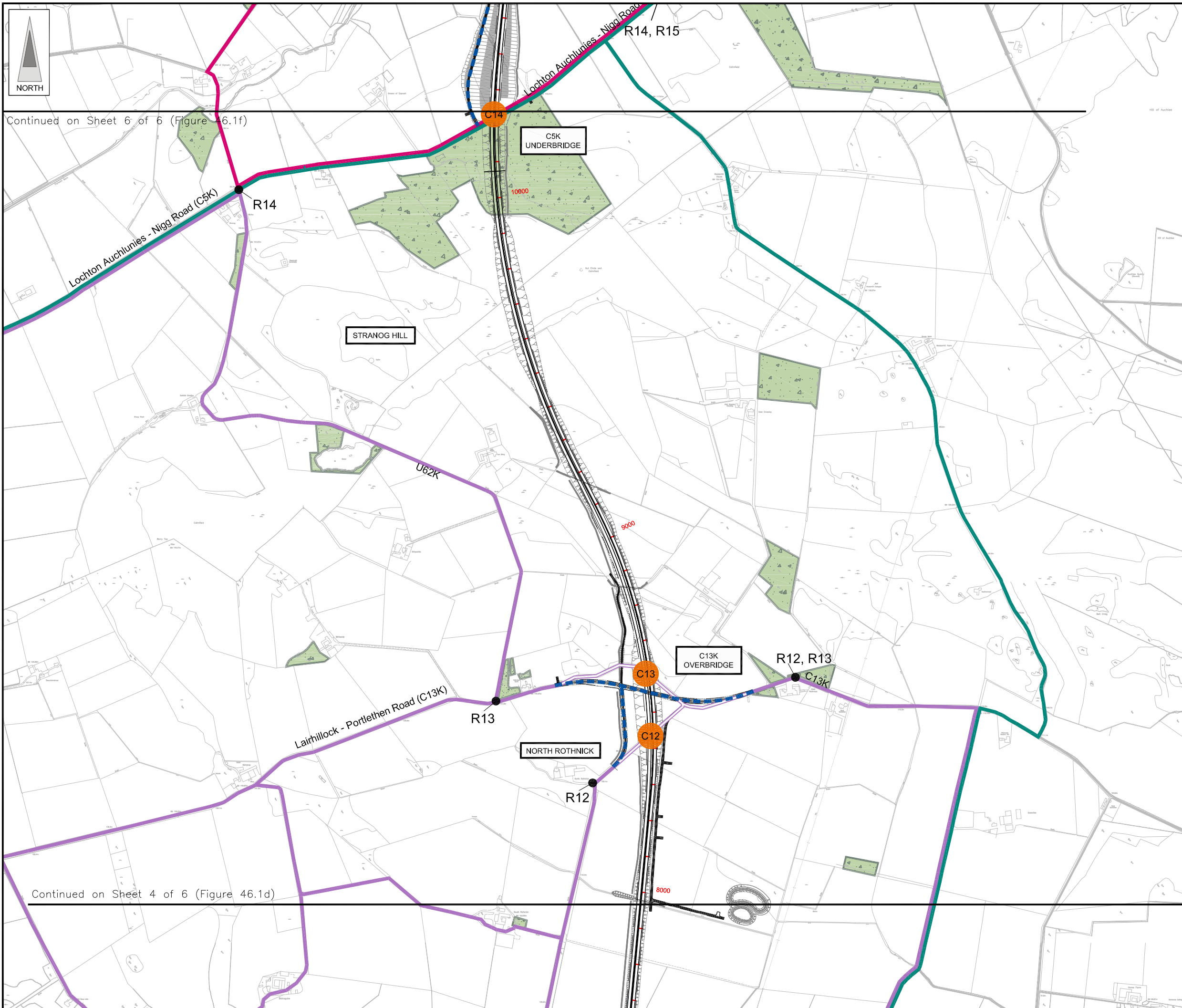
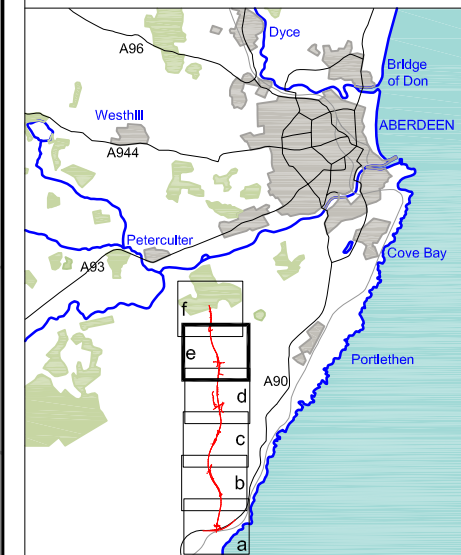

Continued on Sheet 6 of 6 (Figure 46.1f)

Continued on Sheet 4 of 6 (Figure 46.1d)

- LEGEND**
- Proposed Route (Engineering Profile 04/05/07)
  - Woodland
  - Community Facilities
  - Pedestrian Routes / Right of Way
  - Cycleway / Proposed Cycleway
  - Equestrian Routes
  - Route lost to AWPR
  - Proposed Route Diversion
  - Area of Conflict with Proposed AWPR Route
  - Journey Length End Point
  - Route Number
  - Bus Stop / Proposed New Bus Stop

Rev	Date	Purpose of Revision	Drwn	Chkd	Appd

**JE JACOBS**  
 95 Bothwell Street, Glasgow, G2 7HX, UK  
 Tel: 0141 204 2511 Fax: 0141 226 3109  
 www.jacobsbattle.com

Client: **Aberdeen Western Peripheral Route**

Project: **Aberdeen Western Peripheral Route Environmental Statement, Part D - Fastlink**

Title: **Pedestrians, Cyclists and Equestrians Sheet 5 of 6**

Drawing Status	FINAL	Revisions	
JB No.	0010332	Date	July 2007
Figure No.	FIGURE 46.1e	Drawn	MY
Scale	1:10,000	Checked	FB
		Approved	SH

FIGURE 46.1f

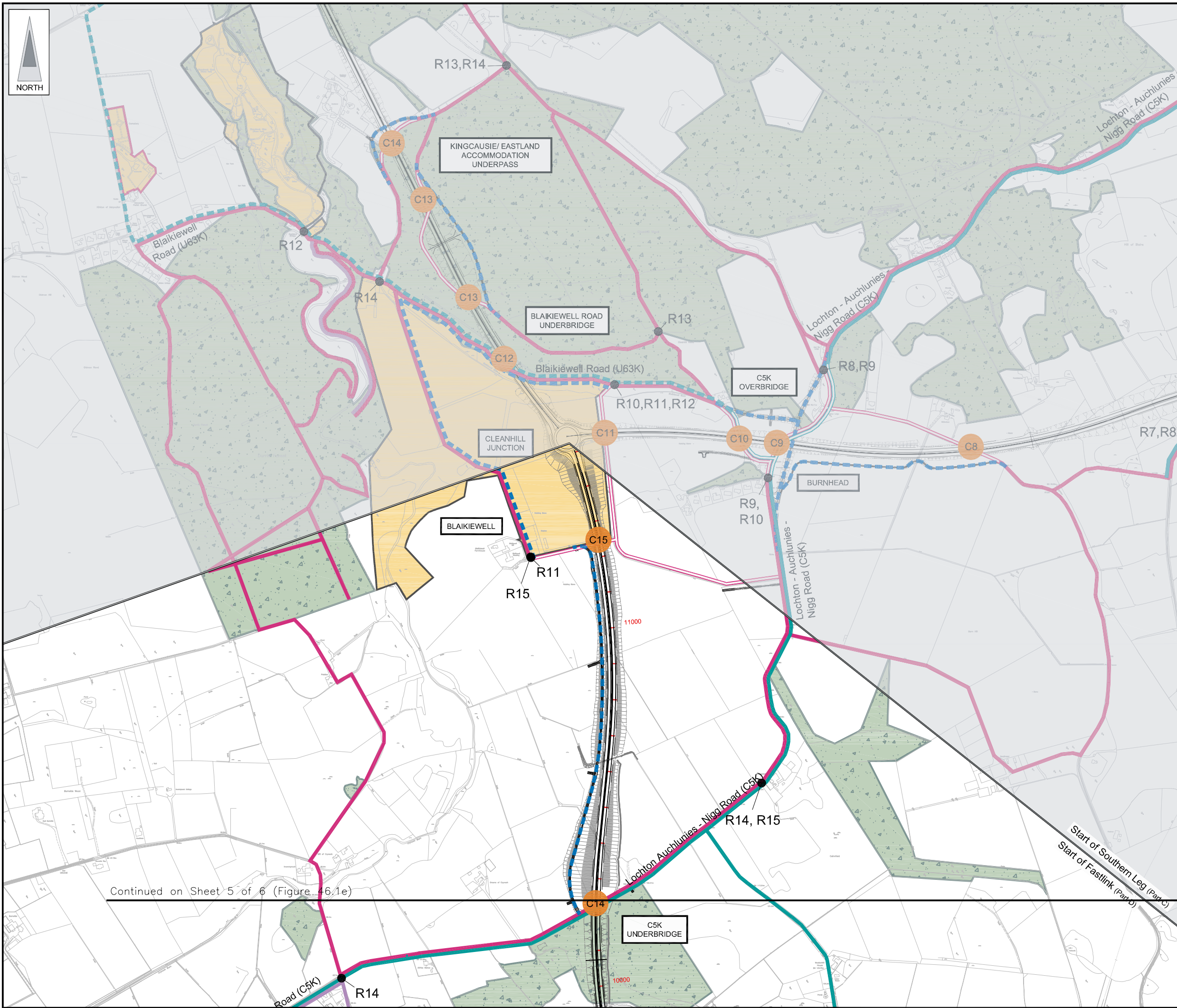
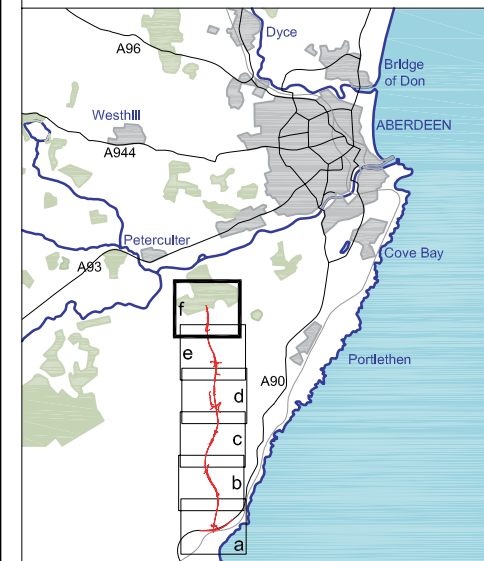

- LEGEND**
- Proposed Route (Engineering Profile 04/05/07)
  - Woodland
  - Educational, Public / Recreational, Commercial } Community Facilities
  - Pedestrian Routes / Right of Way
  - Cycleway / Proposed Cycleway
  - Equestrian Routes
  - Pedestrian, Cycle, Equestrian } Route lost to AWPR
  - Proposed Route Diversion
  - Area of Conflict with Proposed AWPR Route
  - Journey Length End Point
  - Route Number
  - Bus Stop / Proposed New Bus Stop

Rev	Date	Purpose of Revision	Drwn	Chkd	Appd

**JE JACOBS**  
 95 Bothwell Street, Glasgow, G2 7HX, UK  
 Tel: 0141 204 2511 Fax: 0141 226 3109  
 www.jacobsabtie.com

Client: **Aberdeen Western Peripheral Route**

Project: **Aberdeen Western Peripheral Route Environmental Statement, Part D - Fastlink**

Title: **Pedestrians, Cyclists and Equestrians Sheet 6 of 6**

Drawing Status	FINAL	Revisions	
JB No.	0010332	Date	July 2007
Figure No.	FIGURE 46.1f	Checked	
Scale	1:10,000	Approved	
Drawn	MY	Checked	FB
		Approved	SH

This drawing is not to be used in whole or part other than for the intended purpose and project as defined on this drawing. Refer to the contract for full terms and conditions. Maps produced by Jacobs UK Ltd. This map should NOT be rescaled. Copyright reserved.

Continued on Sheet 5 of 6 (Figure 46.1e)

Start of Southern Leg (Part B)  
 Start of Fastlink (Part B)

This map is based on Ordnance Survey material with the permission of Ordnance Survey on behalf of the controller of Her Majesty's Stationery Office. Crown copyright. Unauthorised reproduction infringes Crown copyright and may lead to prosecution or civil proceedings. Scottish Executive Licence Number, 100020540 (2007).