

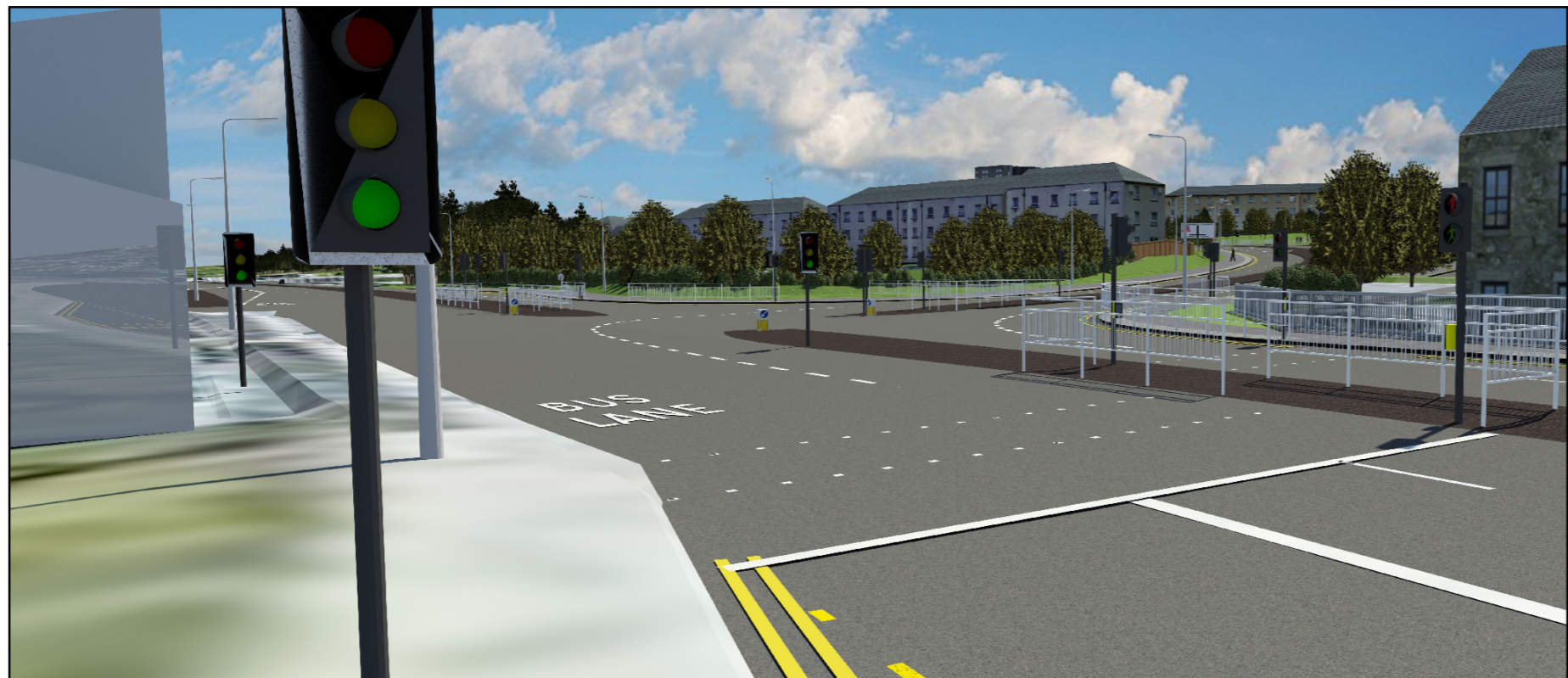

Viewpoint Location 6 - Existing photograph looking south east towards Manor Drive junction onto A96 Auchmill Road

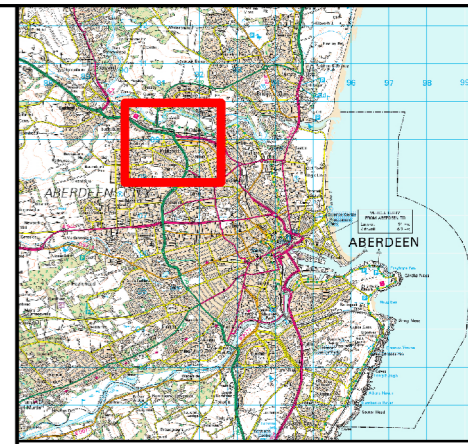

Viewpoint Location 6 - VRM Still - Representative view looking south east towards proposed link road junction onto A96 Auchmill Road



VIEWPOINT LOCATION PLAN

Rev.	Rev. Date	Purpose of revision	Orig/Dwn	Checked	Rev'd	Appr'd
0	28/05/2016	FINAL	SHF	KS	ML	CH

JACOBS
 65 Bothwell Street, Glasgow, G2 7HX, UK.
 Tel: +44(0)141 243 8000 Fax: +44(0)141 226 3109
 www.jacobs.com



Client
TRANSPORT SCOTLAND
 COMHAIL ALBA

Project
A90/A96 HAUDAGAIN IMPROVEMENT STAGE 3 EIA

Drawing title
EXISTING PHOTOGRAPH AND INDICATIVE VIEW (VRM) VIEWPOINT 6

Drawing Status: FINAL
 Scale: N/A DO NOT SCALE
 Jacobs No.: B1557630
 Client No.:
 Drawing number: **Figure 11.5f** Rev **0**

This drawing is not to be used in whole or part other than for the intended purpose and project as defined on this drawing. Refer to the contract for full terms and conditions.