

GENERAL NOTES

1. ALL DIMENSIONS IN METRES UNLESS STATED OTHERWISE.
2. THE MAINLINE ALIGNMENT INCORPORATES VARIED EARTHWORKS SLOPES. WHERE POSSIBLE EARTHWORKS SLOPES HAVE BEEN ADJUSTED TO ACCOMMODATE LANDSCAPING CONSIDERATIONS. IN SOME PLACES, EARTHWORKS SLOPES HAVE BEEN STEEPENED WHERE NECESSARY TO MINIMISE IMPACTS ON ADJACENT CONSTRAINTS SUCH AS THE AQUEDUCT, RAILWAY AND WHERE ROCK CUTS ARE ANTICIPATED.

LEGEND:

- EARTHWORKS CUTTING
- EARTHWORKS EMBANKMENT
- SLOPE BETWEEN CARRIAGEWAYS
- RIVER / STREAM / LOCH
- CFJV FLOOD MAPPING (1:200 YEAR)
- MINOR WATERCOURSE STRUCTURE REFS
- MAJOR WATERCOURSE STRUCTURE REFS
- WATERCOURSE DIVERSION
- FOOTWAY/CYCLEWAY
- CARRIAGEWAY
- CENTRAL RESERVE / VERGE
- RAILWAY
- BUILDINGS
- EXISTING ROAD / FOOTPATH / CYCLE ROUTE
- EXISTING ACCESS (TIER 1 A OR B)
- EXISTING ACCESS (TIER 3 PRIVATE)

KEY ENVIRONMENTAL CONSTRAINTS

- SSSI (SNH)
- LISTED BUILDINGS (HS)
- SAC (SNH)
- SCHEDULED MONUMENTS (HS)
- SPA (SNH)

UTILITIES

- BEAULTY TO DENNY POWER LINE, PYLONS AND EXCLUSION ZONE
- SSE PIPE
- PROPOSED CULVERT LOCATIONS

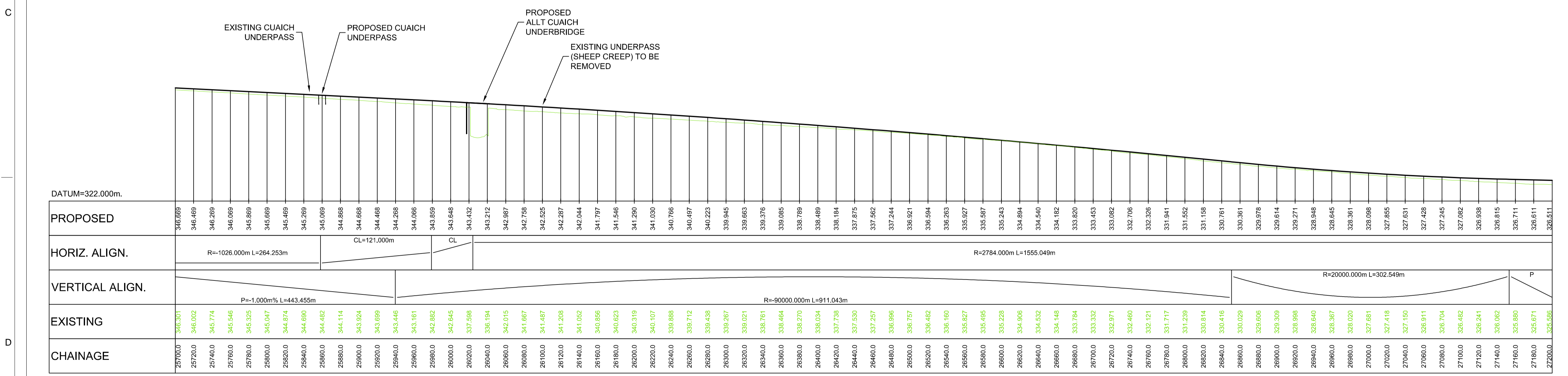
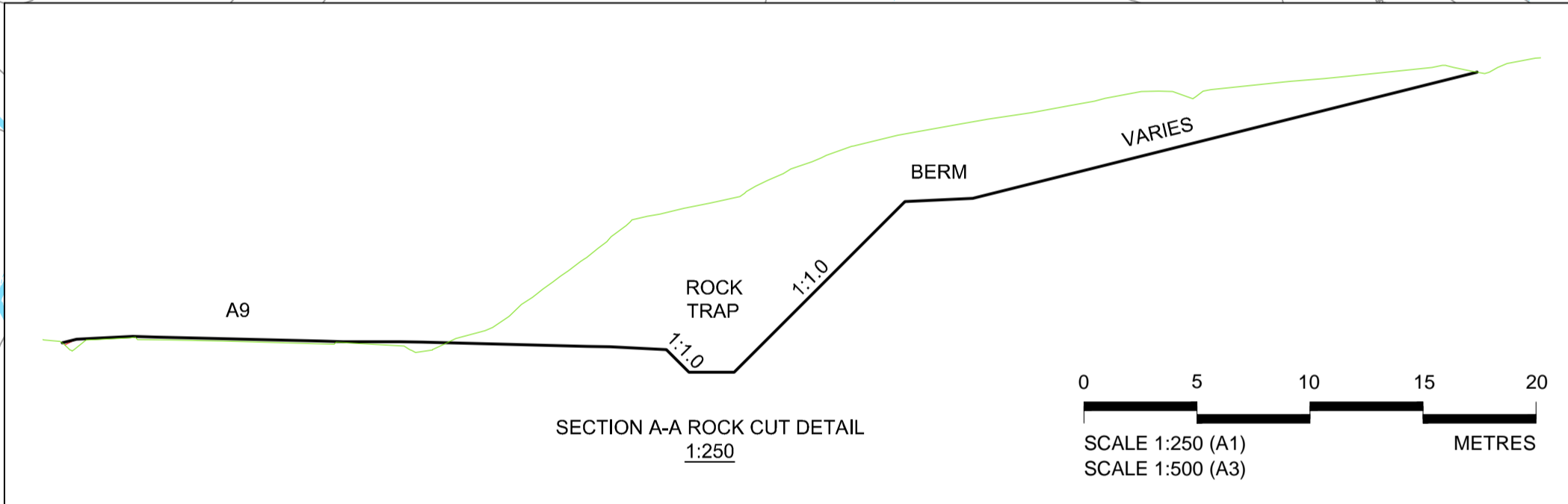

LONGITUDINAL SECTION
Scale 1:2500 H / 1:500 V

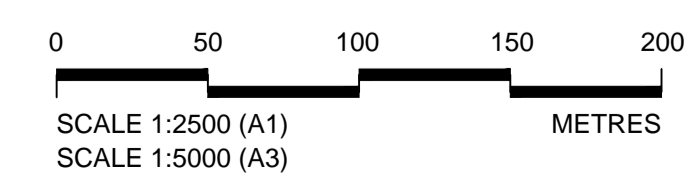

REV	SUIT	DATE	DESCRIPTION	BY	APP

ch2m FAIRHURST
CH2M HILL Fairhurst JV
C/O: City Park 368 Alexandra Parade Glasgow G3 1AU
Tel +44 (0)141 552 2000 Fax +44 (0)141 552 2525

TRANSPORT SCOTLAND
A9 DUALLING
PERTH TO INVERNESS
Determine to Create more

PROJECT 08 - DALWHINNIE TO CRUBENMORE
PUBLIC EVENT MAY 2017
DMRB STAGE 3
PLAN AND PROFILE

DESIGN:	DRAWN:	CHK:	APP:
KC	RM	GK	MT

1:2500 @ A1 (1:5000 @ A3)

DATE:	10/05/17
PROJ:	495298
DWG:	A9P08-CFJ-HML-J_ML200_ML-DR-RD-0026
SHEET:	6 of 9
REVISION:	P01
SUITABILITY:	S4

Reproduced by permission of Ordnance Survey on behalf of Her Majesty's Stationery Office, © Crown copyright and database right 2016. All rights reserved. Ordnance Survey Licence Number: 100046668.

A9P08-CFJ-HML-J_ML200_ML-DR-RD-0026.dwg