

- Legend**
- Proposed scheme (DMRB Stage 3 design)
 - SuDS
 - 500m Study area
 - Planning application
 - Community land
 - Community facilities
 - Primary School Catchment
 - Pitlochry Primary School
 - Perth and Kinross Local Development Plan
 - Open space
 - Housing proposal
 - Employment
 - Tourism

Rev.	Rev. Date	Purpose of revision	Orig/Dwn	Check'd	Rev'd	Appr'd
0	DEC 2017	ES Publication		EM	AN	GK A.JG

JACOBS
 95 Bothwell Street, Glasgow, G2 7HX, UK.
 Tel: +44(0) 141 243 8000
 www.jacobs.com

Client

 TRANSPORT SCOTLAND
 CÙRRIHAL ALBA

Project

A9
 DUALLING
 PERTH TO INVERNESS
 Pitlochry to Killiecrankie

Drawing title
**Environmental Statement
 Community Assets and Development Land**

Sheet 1 of 3

Drawing Status	FINAL		
Scale	1:10,000	@ A3	DO NOT SCALE
Jacobs No.	B2140004		
BIM No.			
Drawing number	Figure 8.1a	Rev	0

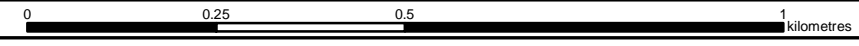

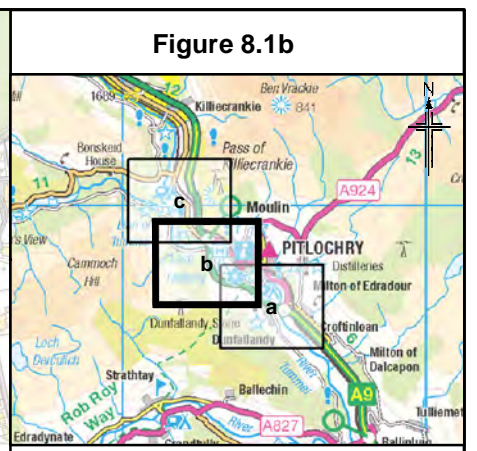
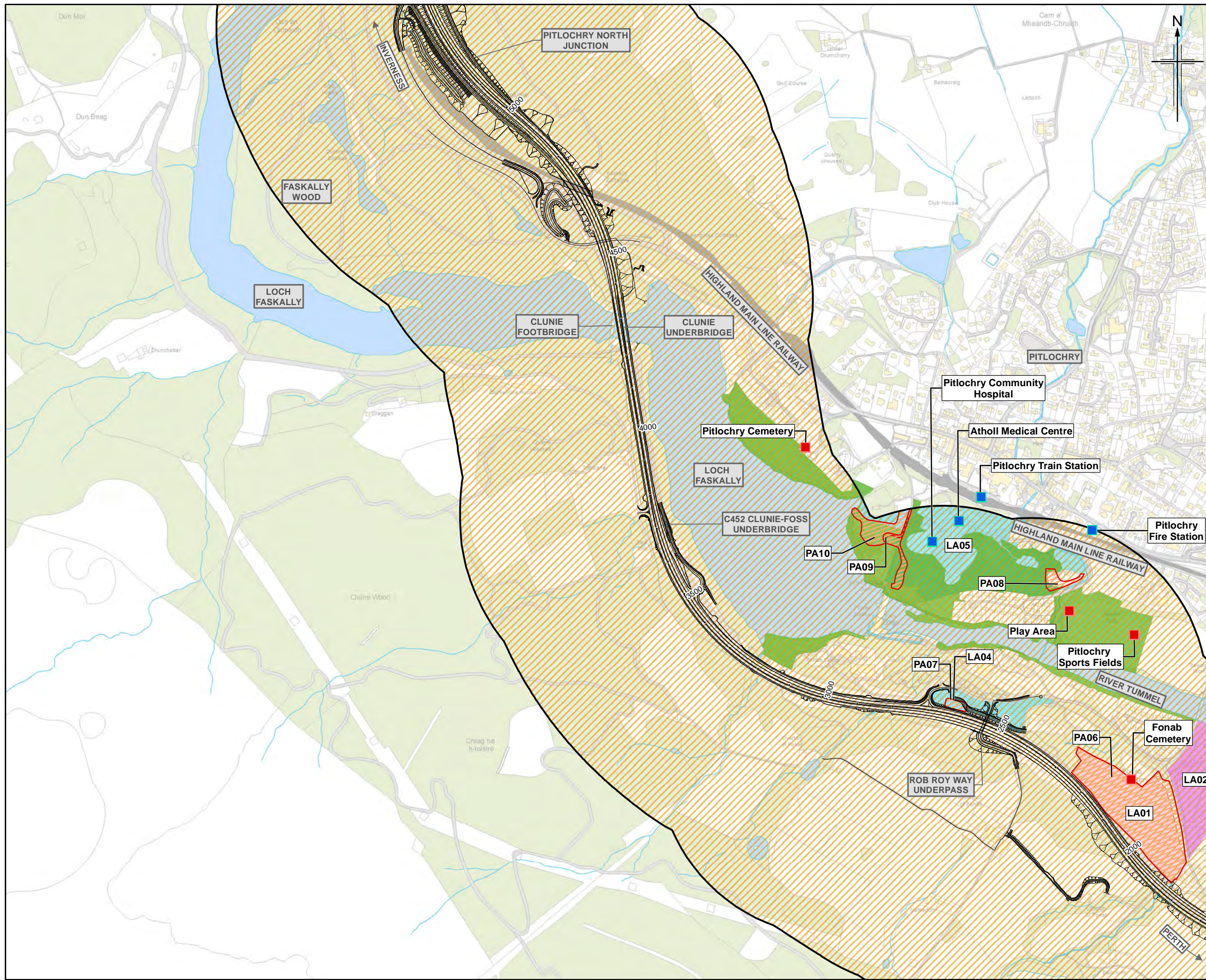

- Legend**
- Proposed scheme (DMRB Stage 3 design)
 - SuDS
 - 500m Study area
 - Planning application
 - Community land
 - Community facilities
 - Primary School Catchment
 - Pitlochry Primary School
 - Perth and Kinross Local Development Plan
 - Open space
 - Housing proposal
 - Employment
 - Tourism

0	DEC 2017	ES Publication	EM	AN	OK	AJG
Rev.	Rev. Date	Purpose of revision	Orig/Dwn	Checked	Rev'd	Apprv'd

JACOBS
 95 Bothwell Street, Glasgow, G2 7HX, UK.
 Tel: +44(0) 141 243 8000
 www.jacobs.com

Client

 TRANSPORT SCOTLAND
 CÙRRIHAL ALBA

Project

A9
 DUALLING
 PERTH TO INVERNESS
 Pitlochry to Killiecrankie

Drawing title
**Environmental Statement
 Community Assets and Development Land**

Drawing Status	FINAL	Sheet 2 of 3
Scale	1:10,000 @ A3	DO NOT SCALE
Jacobs No.	B2140004	
BIM No.		
Drawing number	Figure 8.1b	Rev 0

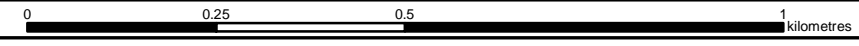

This drawing is not to be used in whole or part other than for the intended purpose and project as defined on this drawing. Refer to the contract for full terms and conditions.

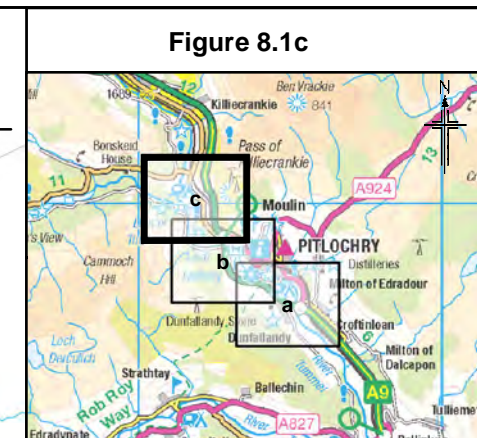
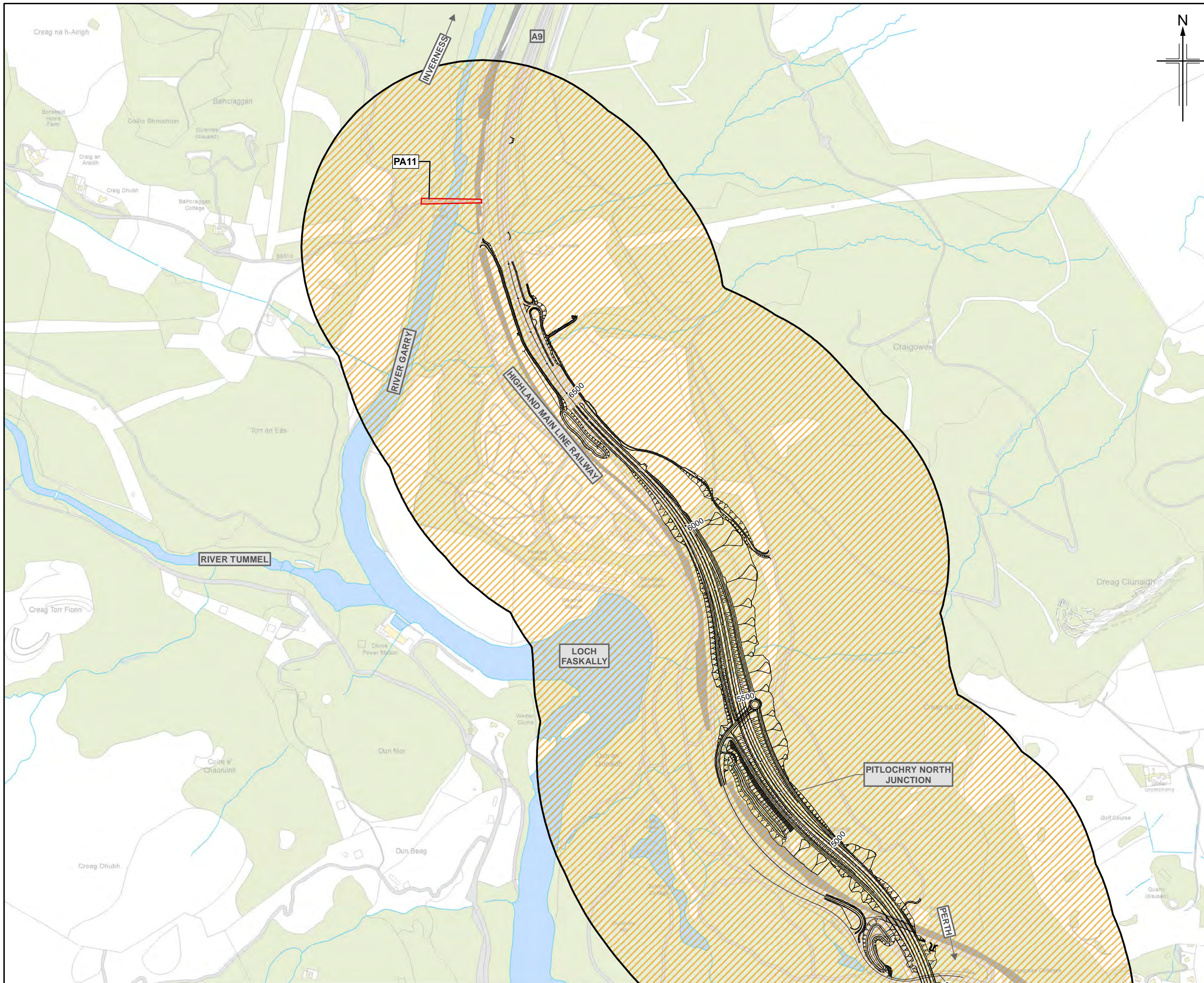

- Legend**
- Proposed scheme (DMRB Stage 3 design)
 - SuDS
 - 500m Study area
 - Planning application
 - Community land
 - Community facilities
 - Primary School Catchment
 - Pitlochry Primary School
 - Perth and Kinross Local Development Plan
 - Open space
 - Housing proposal
 - Employment
 - Tourism

0	DEC 2017	ES Publication	EM	AN	OK	AJG
Rev.	Rev. Date	Purpose of revision	Orig/Dwn	Checkd	Rev'd	Apprv'd

JACOBS
 95 Bothwell Street, Glasgow, G2 7HX, UK.
 Tel: +44(0) 141 243 8000
 www.jacobs.com

Client

 TRANSPORT SCOTLAND
 CÙRRAIDH ALBA

Project

A9
 DUALLING
 PERTH TO INVERNESS
 Pitlochry to Killiecrankie

Drawing title
**Environmental Statement
 Community Assets and Development Land**
 Sheet 3 of 3

Drawing Status	FINAL
Scale	1:10,000 @ A3 DO NOT SCALE
Jacobs No.	B2140004
BIM No.	
Drawing number	Figure 8.1c
Rev	0

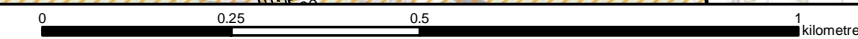

This drawing is not to be used in whole or part other than for the intended purpose and project as defined on this drawing. Refer to the contract for full terms and conditions.