

- Legend**
- Proposed scheme (DMRB Stage 3 design)
 - SuDS
 - 500m Study area
 - Site of Special Scientific Interest (SSSI)
 - Special Area of Conservation (SAC)
 - Special Protection Area (SPA)
 - Ancient Woodland Inventory**
 - Ancient (of semi-natural origin) category 1a/2a
 - Long-established (of plantation origin) category 1b/2b
 - Other (on Roy map) category 3
 - Native Woodland Survey Scotland**
 - Native Woodland
 - Nearly-Native Woodland
 - Open Land Habitat

Rev.	Rev. Date	Purpose of revision	Orig/Dwn	Check'd	Rev'd	Apprv'd
0	DEC 2017	ES Publication	JCr	NG	PG	AJG

JACOBS
 95 Bothwell Street, Glasgow, G2 7HX, UK.
 Tel: +44(0)141 243 8000
 www.jacobs.com

Client

 TRANSPORT SCOTLAND
 COMHIDHAL ALBA

Project

A9
 DUALLING
 PERTH TO INVERNESS
 Pitlochry to Killiecrankie

Drawing title
**Environmental Statement
 Ecological Designations**

Drawing Status	FINAL	Sheet 1 of 3
Scale	1:10,000 @ A3	DO NOT SCALE
Jacobs No.	B2140004	
BIM No.		
Drawing number	Figure 12.1a	Rev 0

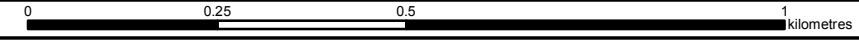

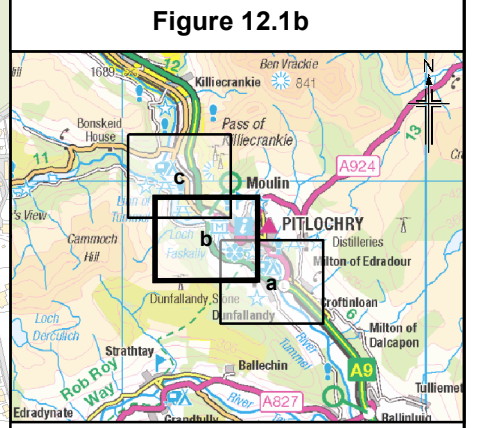
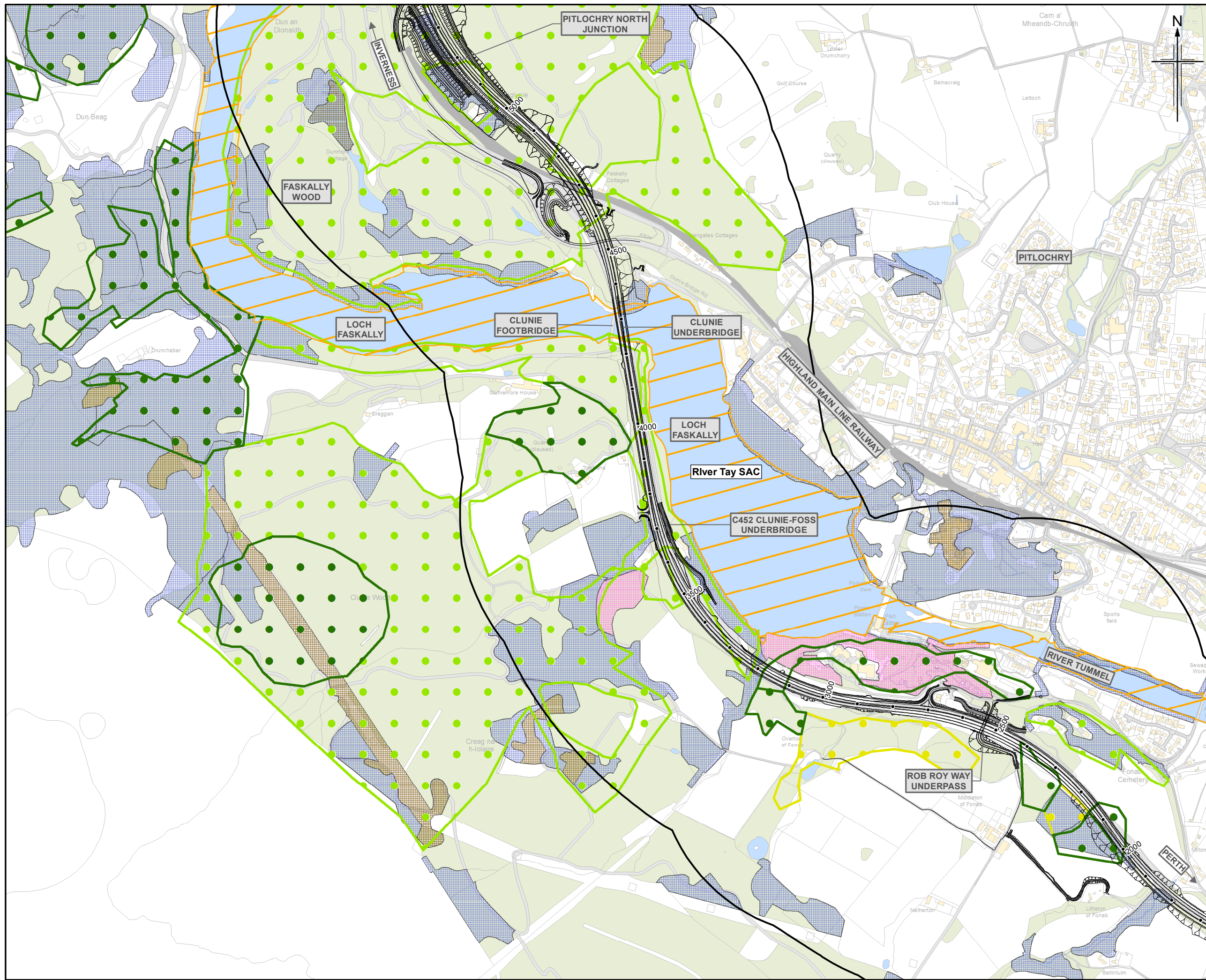

- Legend**
- Proposed scheme (DMRB Stage 3 design)
 - SuDS
 - 500m Study area
 - Site of Special Scientific Interest (SSSI)
 - Special Area of Conservation (SAC)
 - Special Protection Area (SPA)
 - Ancient Woodland Inventory**
 - Ancient (of semi-natural origin) category 1a/2a
 - Long-established (of plantation origin) category 1b/2b
 - Other (on Roy map) category 3
 - Native Woodland Survey Scotland**
 - Native Woodland
 - Nearly-Native Woodland
 - Open Land Habitat

0	DEC 2017	ES Publication	JCr	NG	PG	AJG
Rev.	Rev. Date	Purpose of revision	Orig/Dwn	Checkd	Rev'd	Apprv'd

JACOBS
 95 Bothwell Street, Glasgow, G2 7HX, UK.
 Tel: +44(0)141 243 8000
 www.jacobs.com

Client

 TRANSPORT SCOTLAND
 COMHISHAL ALBA

Project

A9
 DUALLING
 PERTH TO INVERNESS
 Pitlochry to Killiecrankie

Drawing title
**Environmental Statement
 Ecological Designations**

Drawing Status	FINAL	Sheet 2 of 3	
Scale	1:10,000 @ A3	DO NOT SCALE	
Jacobs No.	B2140004		
BIM No.			
Drawing number	Figure 12.1b	Rev	0

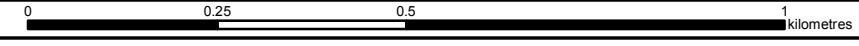

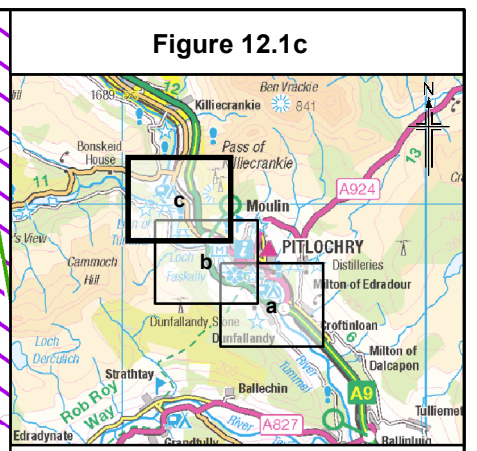
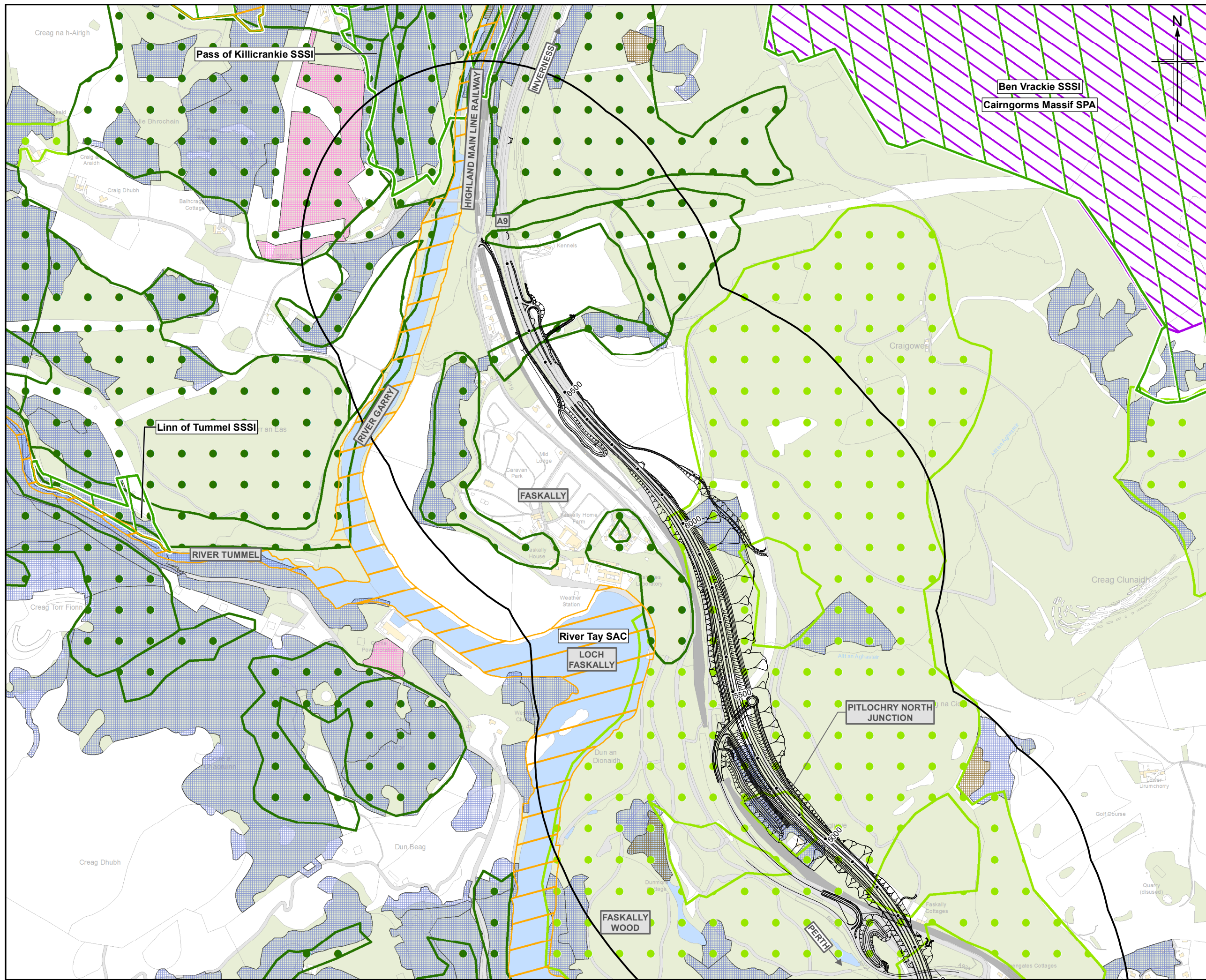

- Legend**
- Proposed scheme (DMRB Stage 3 design)
 - SuDS
 - 500m Study area
 - Site of Special Scientific Interest (SSSI)
 - Special Area of Conservation (SAC)
 - Special Protection Area (SPA)
 - Ancient Woodland Inventory**
 - Ancient (of semi-natural origin) category 1a/2a
 - Long-established (of plantation origin) category 1b/2b
 - Other (on Roy map) category 3
 - Native Woodland Survey Scotland**
 - Native Woodland
 - Nearly-Native Woodland
 - Open Land Habitat

0	DEC 2017	ES Publication	JCr	NG	PG	AJG
Rev.	Rev. Date	Purpose of revision	Org/Dwn	Checkd	Rev'd	Apprv'd

JACOBS
 95 Bothwell Street, Glasgow, G2 7HX, UK.
 Tel: +44(0)141 243 8000
 www.jacobs.com

Client

 TRANSPORT SCOTLAND
 COMHIAL ALBA

Project

A9
 DUALLING
 PERTH TO INVERNESS
 Pitlochry to Killcrankie

Drawing title
**Environmental Statement
 Ecological Designations**

Sheet 3 of 3

Drawing Status	FINAL
Scale	1:10,000 @ A3 DO NOT SCALE
Jacobs No.	B2140004
BIM No.	
Drawing number	Figure 12.1c
Rev	0

