

The A9 and A889 Trunk Roads (Dalwhinnie to Crubenmore)  
(Side Roads) Order 201[ ]

SCALE

KEY PLAN: \_\_\_\_\_ 1:20,000  
ORDER PLAN: SR1, SR2, SR3, SR4, SR5, SR6, SR7  
SR1A & SR2A \_\_\_\_\_ 1:2,500

LEGEND

ASSOCIATED ROAD PROPOSALS \_\_\_\_\_

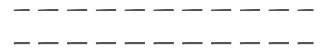

PRIVATE MEANS OF ACCESS TO BE STOPPED UP \_\_\_\_\_



NEW MEANS OF ACCESS \_\_\_\_\_



ROAD TO BE STOPPED UP \_\_\_\_\_





Reproduced by permission of Ordnance Survey on behalf of Her Majesty's Stationery Office, © Crown copyright and database right 2017. All rights reserved. Ordnance Survey Licence Number: 100046668.



Legend : Associated Road Proposals -----

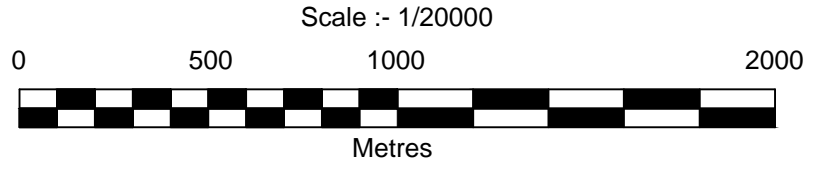

The A9 and A889 Trunk Roads (Dalwhinnie to Crubenmore)  
(Side Roads) Order 201[ ]

Key Plan

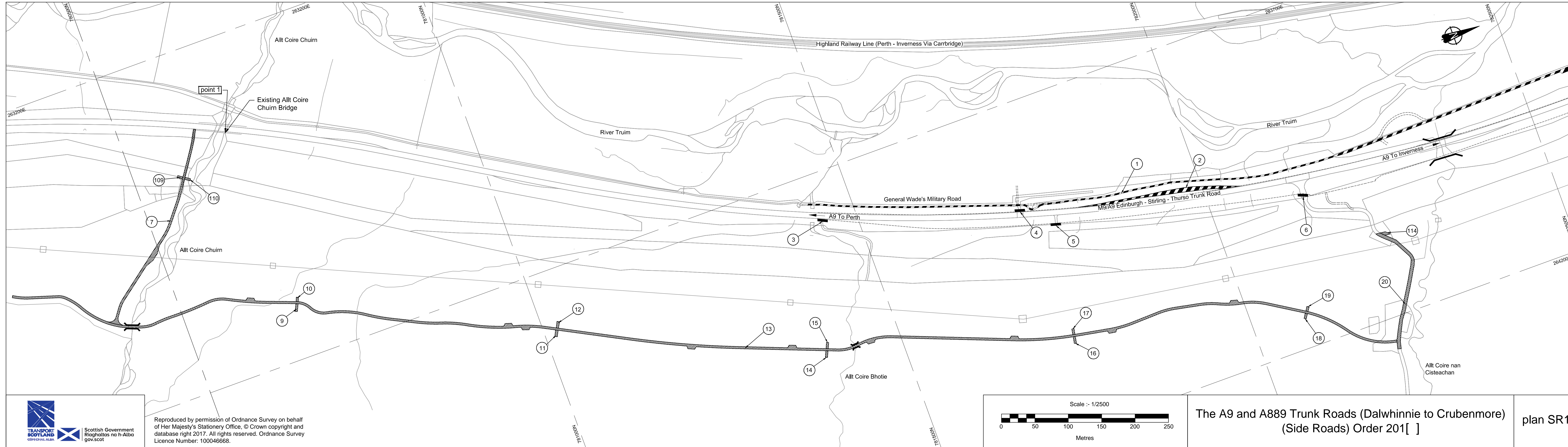

Reproduced by permission of Ordnance Survey on behalf of Her Majesty's Stationery Office, © Crown copyright and database right 2017. All rights reserved. Ordnance Survey Licence Number: 100046668.



The A9 and A889 Trunk Roads (Dalwhinnie to Crubenmore)  
(Side Roads) Order 201[ ]

plan SR1

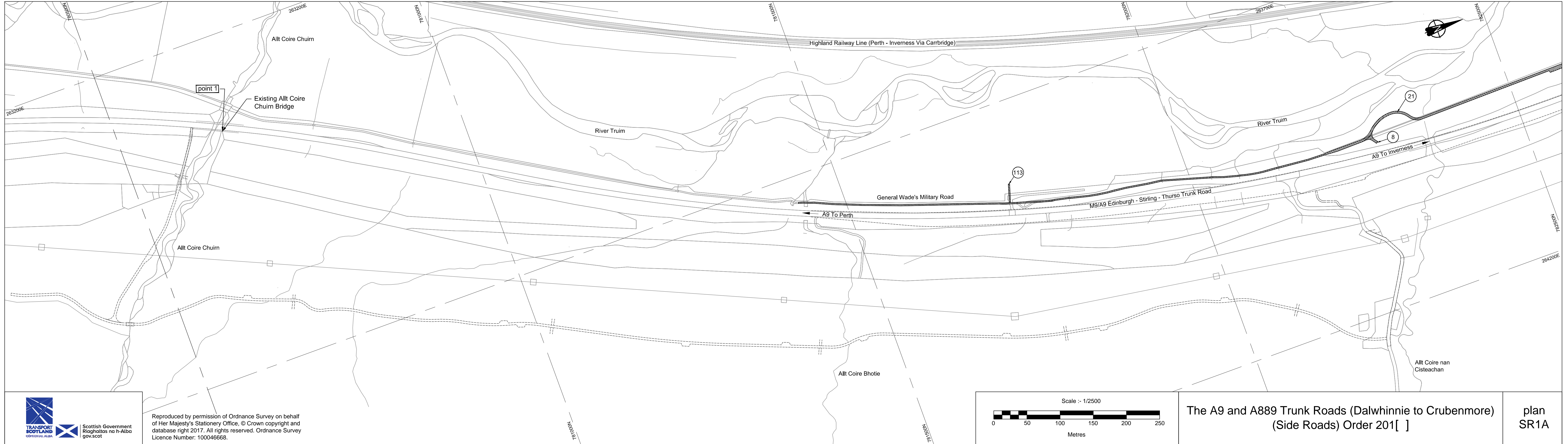

Scottish Government  
Riaghaltas na h-Alba  
gov.scot

Reproduced by permission of Ordnance Survey on behalf of Her Majesty's Stationery Office, © Crown copyright and database right 2017. All rights reserved. Ordnance Survey Licence Number: 100046668.

The A9 and A889 Trunk Roads (Dalwhinnie to Crubenmore)  
(Side Roads) Order 201[ ]

plan  
SR1A

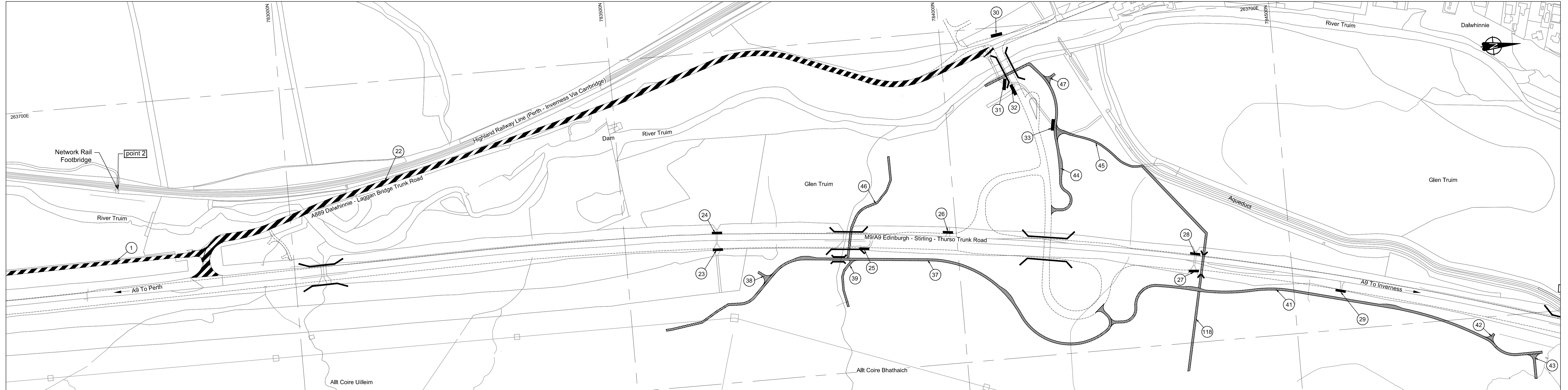

Reproduced by permission of Ordnance Survey on behalf of Her Majesty's Stationery Office, © Crown copyright and database right 2017. All rights reserved. Ordnance Survey Licence Number: 100046668.

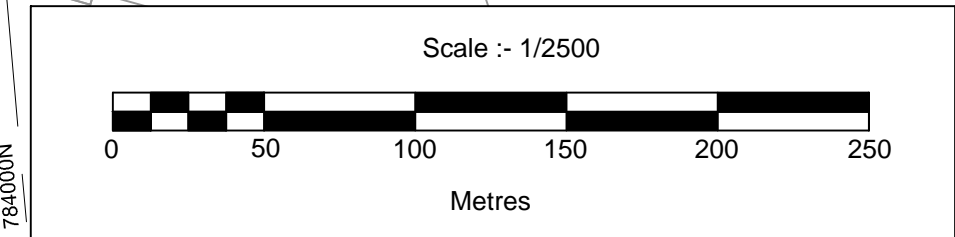

The A9 and A889 Trunk Roads (Dalwhinnie to Crubenmore)  
(Side Roads) Order 201[ ]

plan SR2

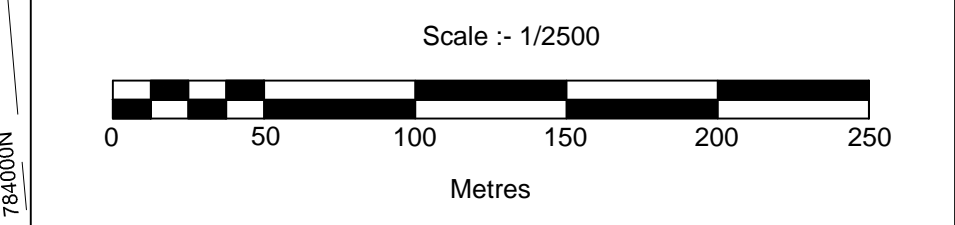
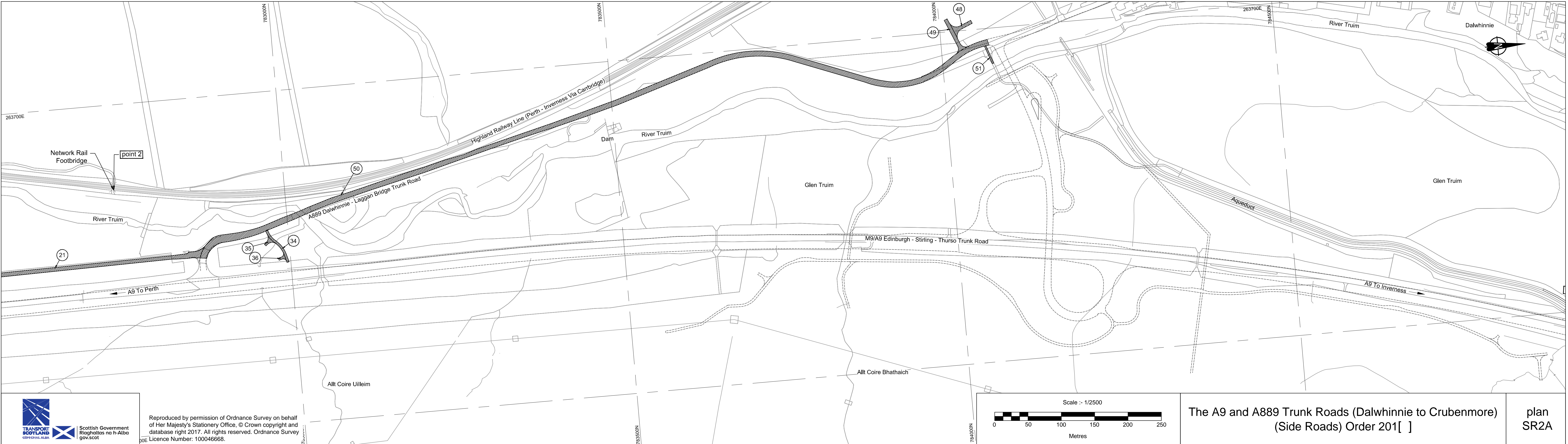

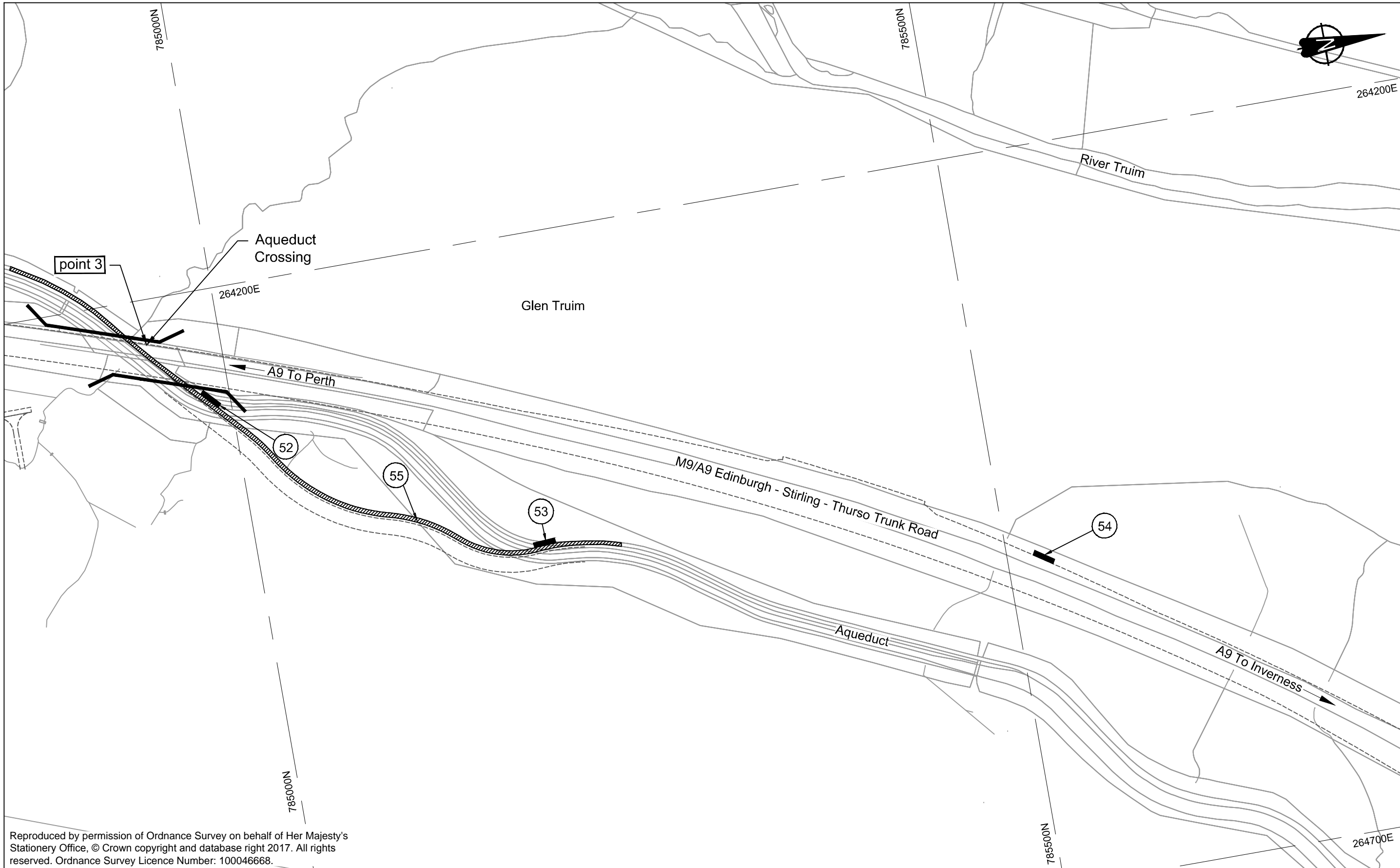

Reproduced by permission of Ordnance Survey on behalf of Her Majesty's Stationery Office, © Crown copyright and database right 2017. All rights reserved. Ordnance Survey Licence Number: 100046668.



Scottish Government  
Riaghaltas na h-Alba  
gov.scot

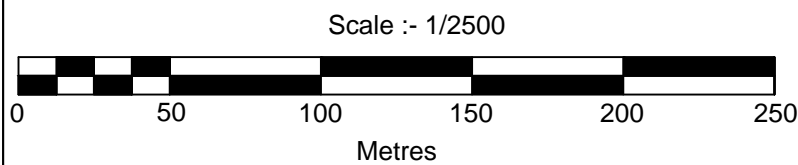

The A9 and A889 Trunk Roads (Dalwhinnie to Crubenmore)  
(Side Roads) Order 201[ ]

plan SR3

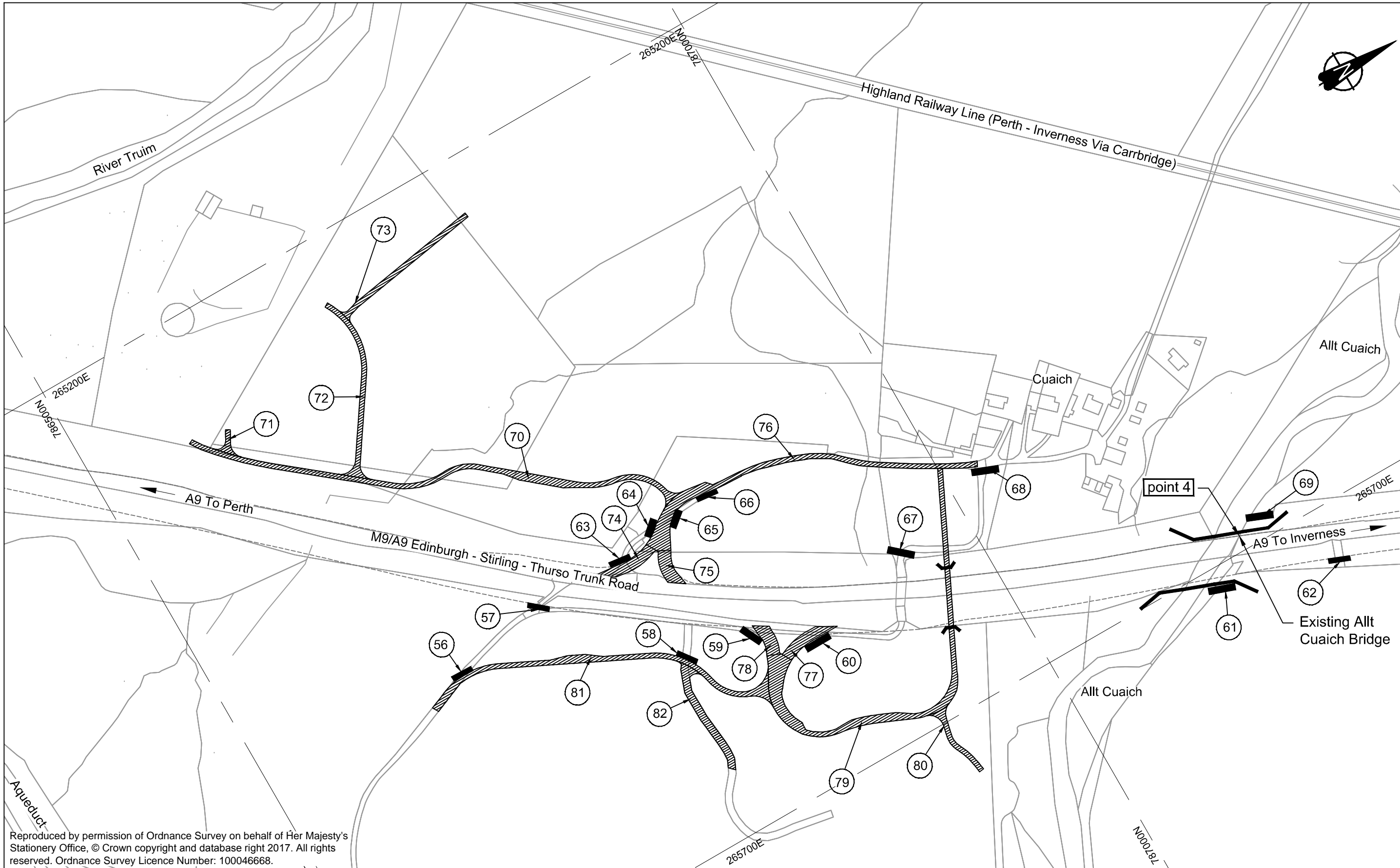

Reproduced by permission of Ordnance Survey on behalf of Her Majesty's Stationery Office, © Crown copyright and database right 2017. All rights reserved. Ordnance Survey Licence Number: 100046668.



Scottish Government  
Riaghaltas na h-Alba  
gov.scot

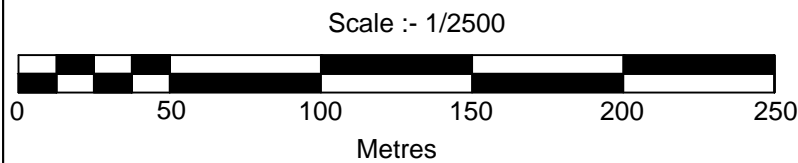

The A9 and A889 Trunk Roads (Dalwhinnie to Crubenmore)  
(Side Roads) Order 201[ ]

plan SR4



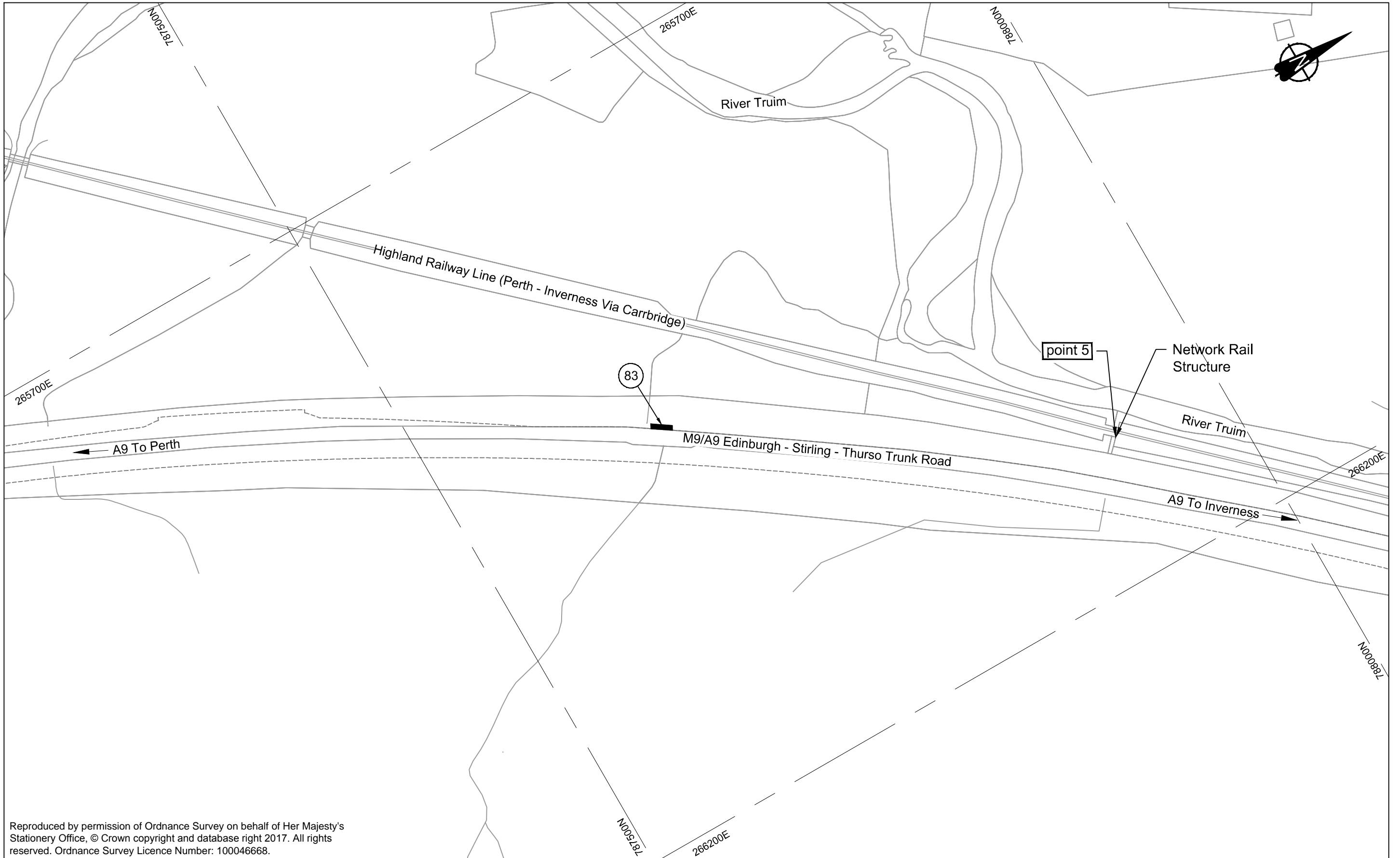

Reproduced by permission of Ordnance Survey on behalf of Her Majesty's Stationery Office, © Crown copyright and database right 2017. All rights reserved. Ordnance Survey Licence Number: 100046668.



Scottish Government  
Riaghaltas na h-Alba  
gov.scot

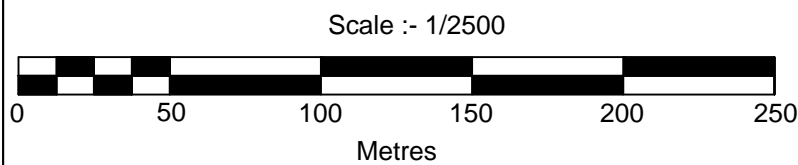

The A9 and A889 Trunk Roads (Dalwhinnie to Crubenmore)  
(Side Roads) Order 201[ ]

plan SR5

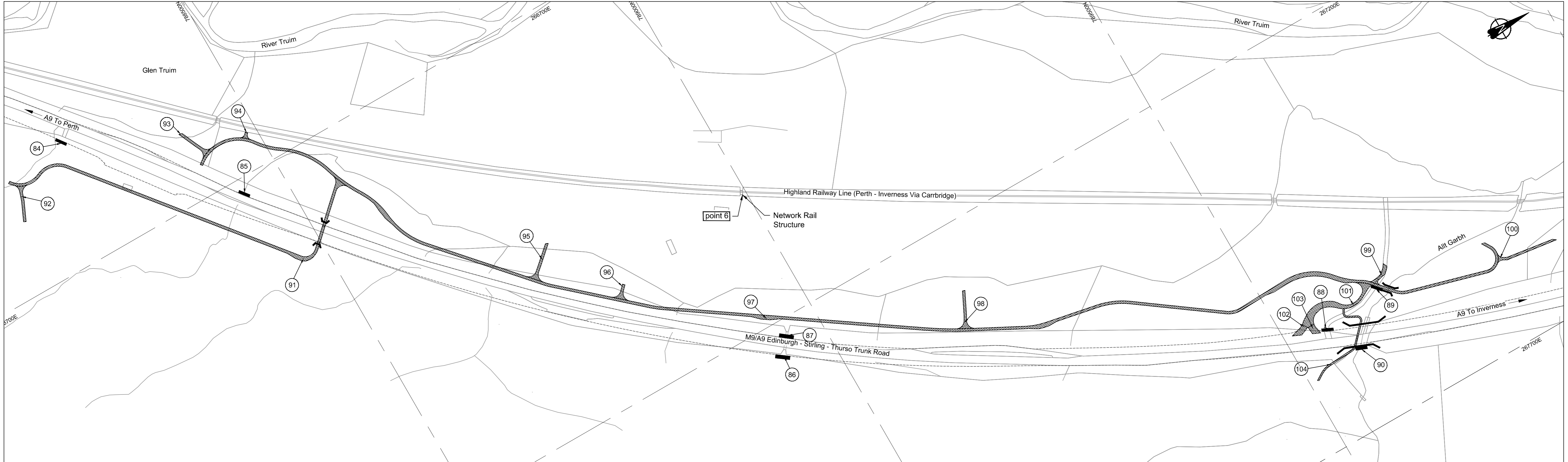

Reproduced by permission of Ordnance Survey on behalf of Her Majesty's Stationery Office, © Crown copyright and database right 2017. All rights reserved. Ordnance Survey Licence Number: 100046668.

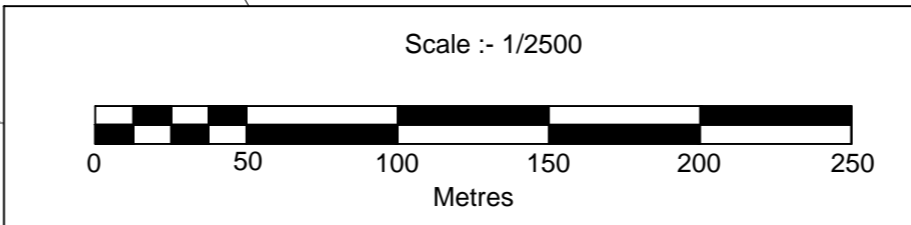

The A9 and A889 Trunk Roads (Dalwhinnie to Crubenmore)  
 (Side Roads) Order 201[ ]

plan SR6

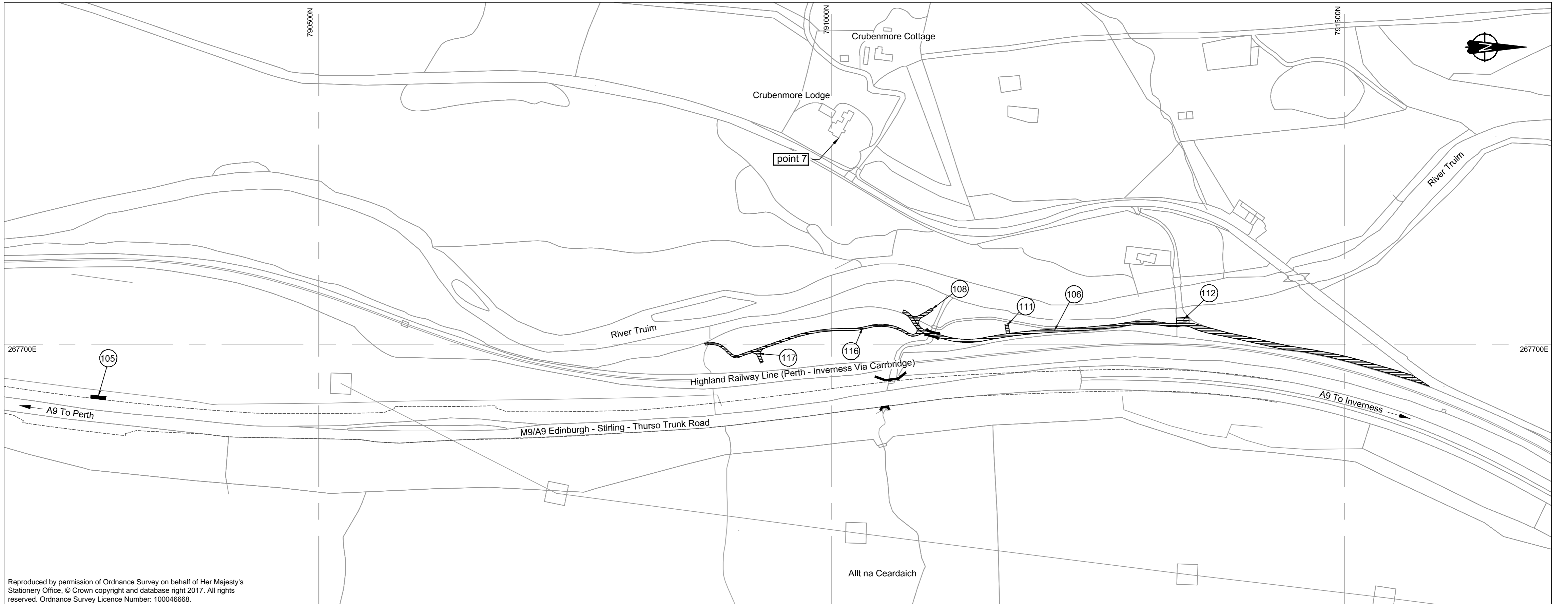

Reproduced by permission of Ordnance Survey on behalf of Her Majesty's Stationery Office, © Crown copyright and database right 2017. All rights reserved. Ordnance Survey Licence Number: 100046668.

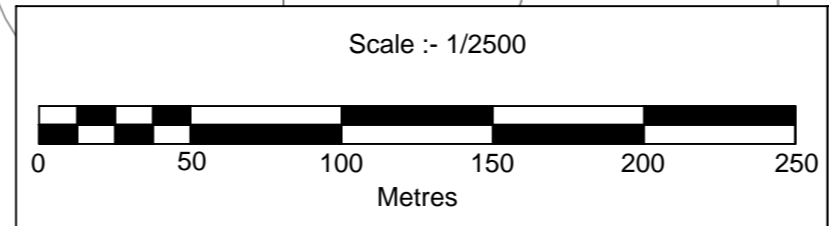

The A9 and A889 Trunk Roads (Dalwhinnie to Crubenmore)  
(Side Roads) Order 201[ ]

plan SR7