

100  
Millimetres  
0 10  
DO NOT SCALE

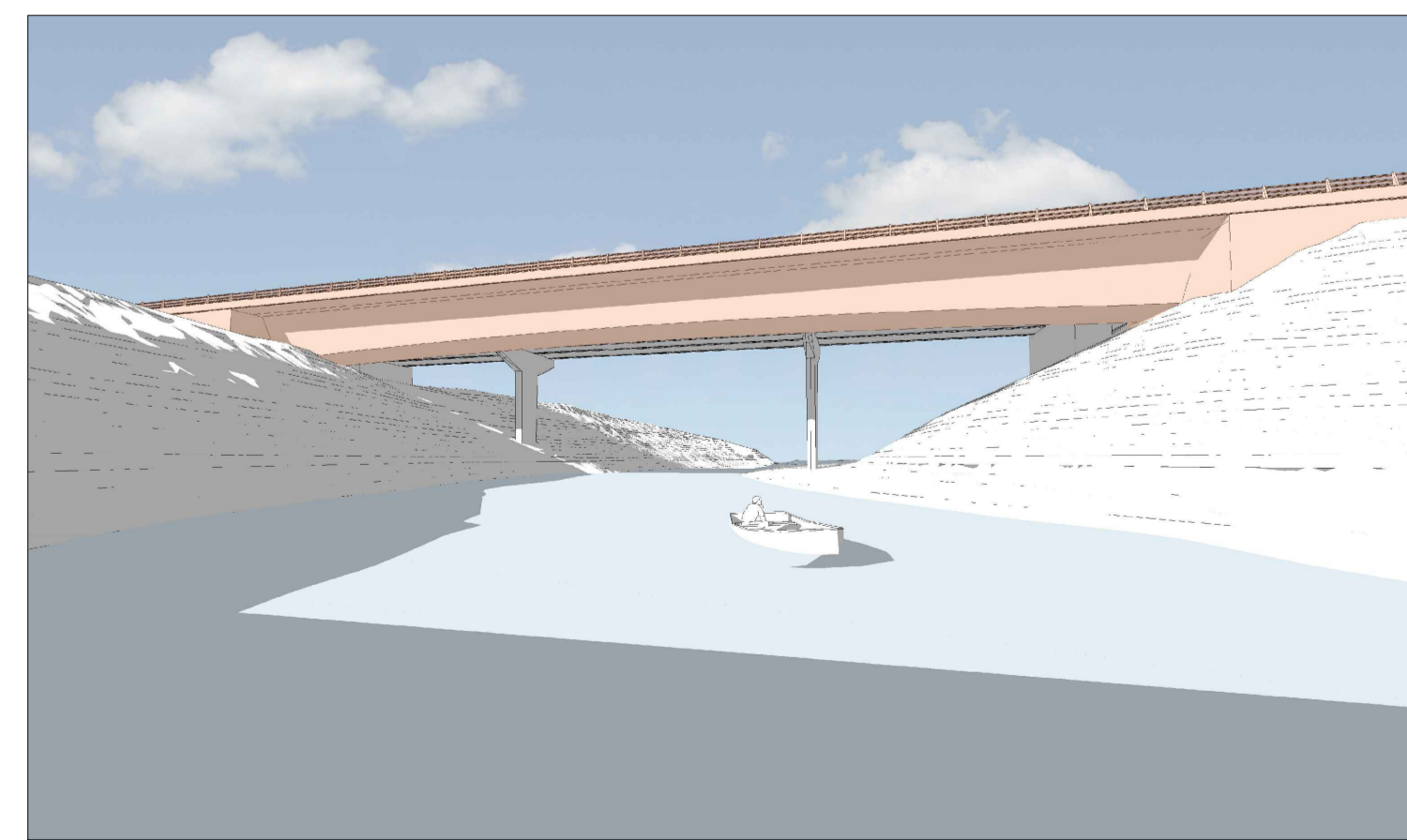
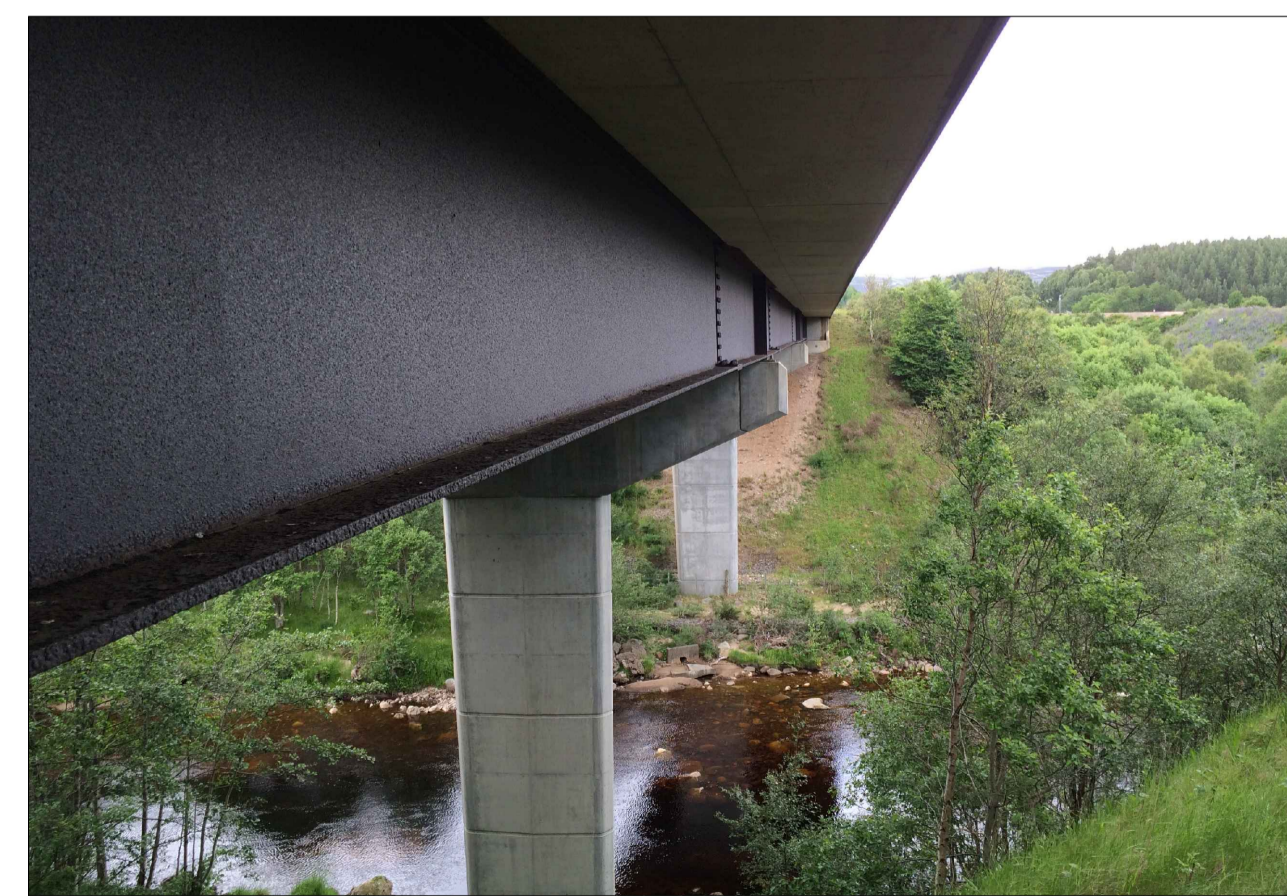
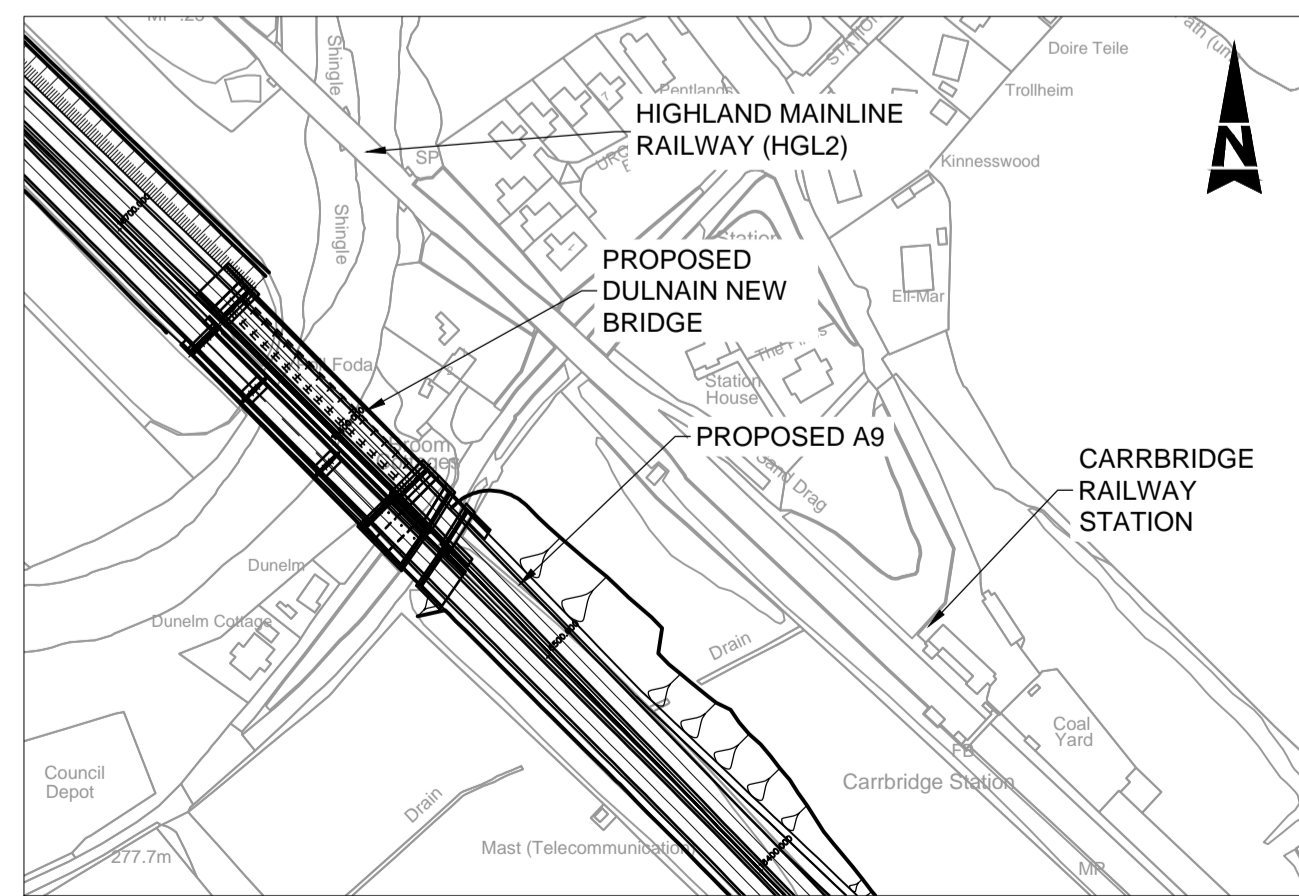
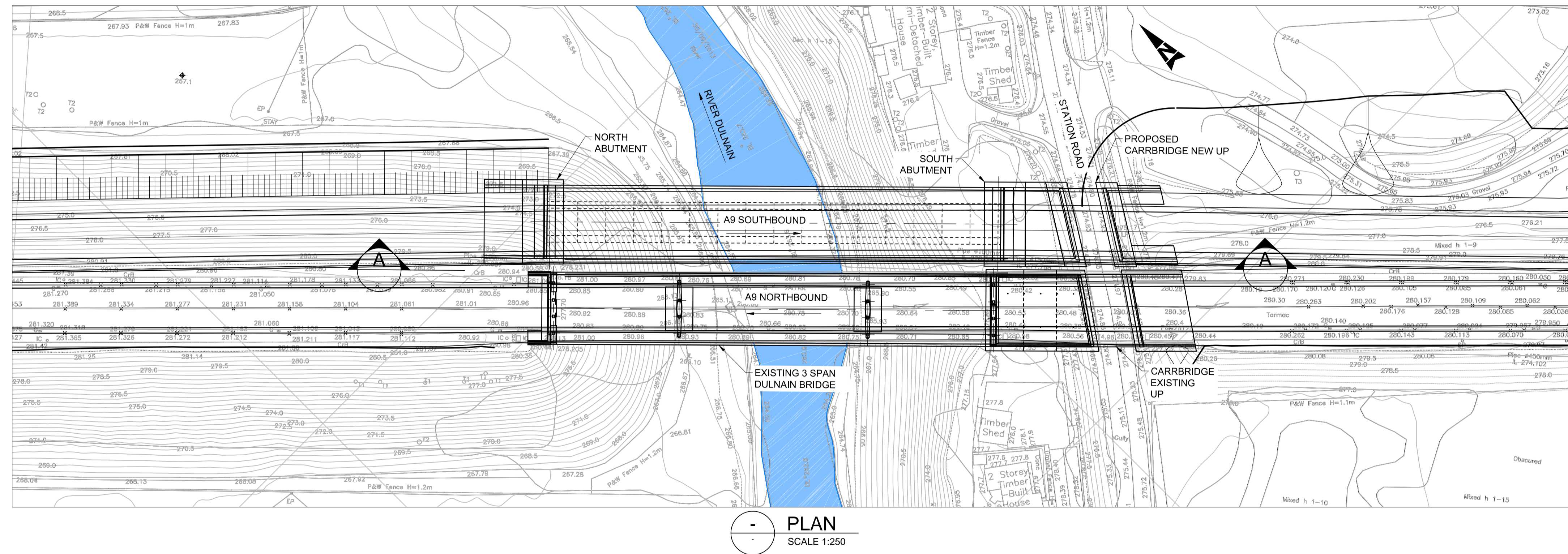
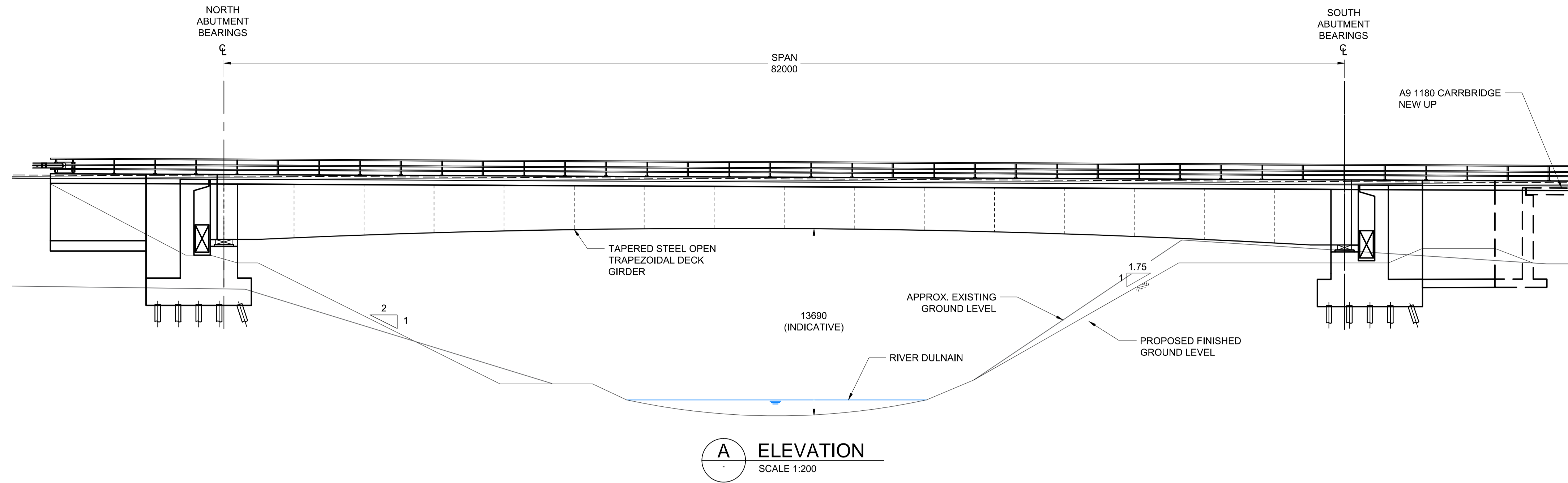

- INDICATIVE CONSTRUCTION SEQUENCE**
1. CONSTRUCT EARTHWORKS TO NORTH ABUTMENT FOUNDATION LEVEL.
  2. EXCAVATE TO SOUTH ABUTMENT FOUNDATION LEVEL.
  3. PREPARE WORKING PLATFORM FOR CRANE.
  4. INSTALL ABUTMENT PILED FOUNDATIONS.
  5. CONSTRUCT ABUTMENTS (BASE, STEM AND WING WALLS).
  6. BACKFILL BEHIND ABUTMENT AND WING WALLS.
  7. INSTALL BEARINGS.
  8. DELIVER AND ASSEMBLE DECK SECTIONS.
  9. MOBILISE THE CRANE.
  10. LIFT DECK INTO FINAL POSITION ON BEARINGS.
  11. POUR DECK CONCRETE IN STAGES.
  12. INSTALL WATERPROOFING, DECK DRAINAGE, PAVEMENT AND PARAPETS

P01.1					---
<b>FIRST ISSUE</b>					
Rev	Drawn / Des	Checked	Approved	Date	
Description					
Drawing Status					Suitability
FINAL					B

Client  
**TRANSPORT SCOTLAND**  
CÒMHDHAIL ALBA



**ATKINS mouchel**

Drawing Title: **FIGURE 5.7 DULNAIN BRIDGE INDICATIVE DESIGN**

Scale	Designed / Drawn	Checked	Approved	Authorised
AS SHOWN	LF	PM	PM	DM
Original Size	Date	Date	Date	Date
A1	MAR 18	MAR 18	MAR 18	MAR 18
Drawing Number	Project	Originator	Volume	Revision
A9P11-AMJ-EGN-H_ZZZZZ_XX-DR-GI-0003				P04
Location	Type	Role	Number	

Printed: Mar 06, 2018 - 1:46pm by: UKLBF600

Reproduced by permission of Ordnance Survey on behalf of HMSO. © Crown copyright and database right 2017. All rights reserved. Ordnance Survey Licence number 100046668.