

- Proposed Scheme
 250m Study Area
- SBL Priority Habitat**
- Blanket Bog
 - Lowland Fens
 - Native Pinewoods
 - Reedbeds
 - Upland Birchwoods
 - Upland Calcareous Grassland
 - Upland Flushes, Fens and Swamps
 - Upland Heathland
 - Upland Heathland/Blanket Bog
 - Upland Oakwood
 - Wet Woodland
 - Unable to be Classified from Aerial Imagery
- Aspen**
- Aspen scattered throughout woodland
 - Locations of individual / small groups of Aspen

Labels relate to corresponding NVC code (e.g. M20)

Areas are displayed according to the dominant SBL habitat type. Due to habitat mosaics many areas may only contain a small percentage of SBL habitat, whereas others may contain multiple SBL habitats. Please cross-reference the NVC types in SBL areas to Technical Appendix 12.2 for further information.

Kilometres
 0 0.1 0.2

Status	FINAL	Suitability	B
--------	-------	-------------	---



Figure 12.7
 Scottish Biodiversity List Habitat
 and Aspen Locations
 Sheet 10 of 17

Scale	1:5,000	Drawn	RM	Checked	DK	Approved	ROB	Authorised	SB	
Document Number	A9P11-AMJ-EBD-H_ZZZZZ_XX-DR-GI-0114								Revision	P04
Project	Originator		Volume							
Location	Type	Role	Number							

Reproduced by permission of Ordnance Survey on behalf of HMSO.
 © Crown copyright and database right 2017. All rights reserved.
 Ordnance Survey Licence number 100046668

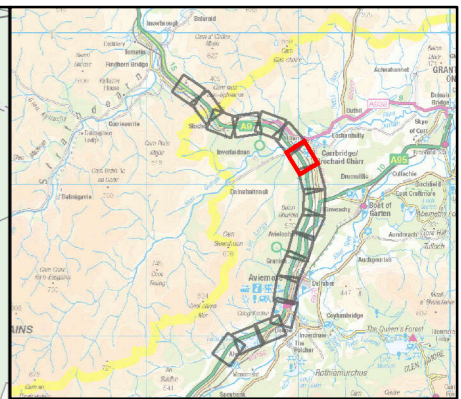
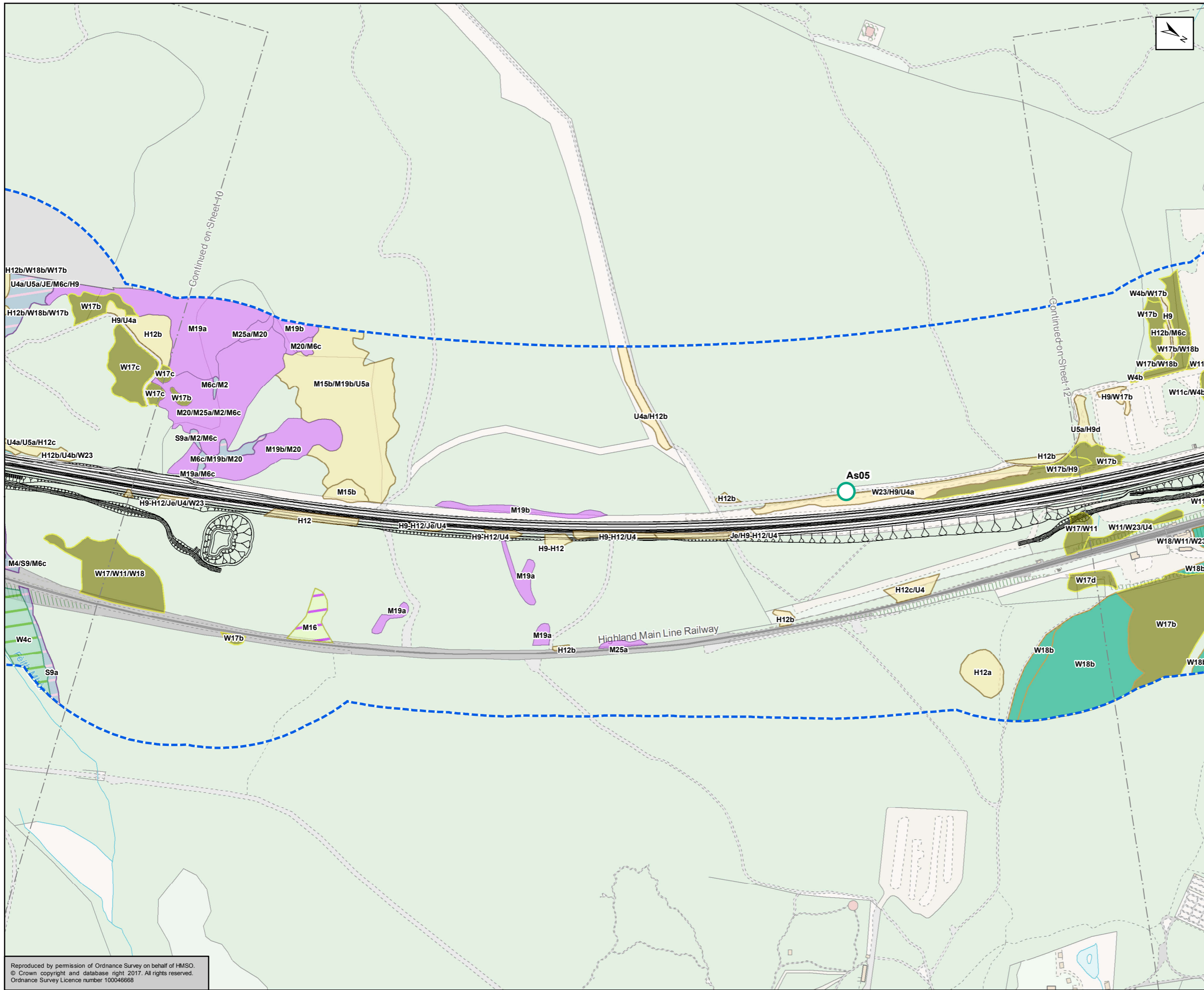

- Proposed Scheme
- 250m Study Area
- SBL Priority Habitat**
- Blanket Bog
- Lowland Fens
- Native Pinewoods
- Reedbeds
- Upland Birchwoods
- Upland Calcareous Grassland
- Upland Flushes, Fens and Swamps
- Upland Heathland
- Upland Heathland/Blanket Bog
- Upland Oakwood
- Wet Woodland
- Unable to be Classified from Aerial Imagery

- Aspen**
- Aspen scattered throughout woodland
- Locations of individual / small groups of Aspen

Labels relate to corresponding NVC code (e.g. M20)

Areas are displayed according to the dominant SBL habitat type. Due to habitat mosaics many areas may only contain a small percentage of SBL habitat, whereas others may contain multiple SBL habitats. Please cross-reference the NVC types in SBL areas to Technical Appendix 12.2 for further information.

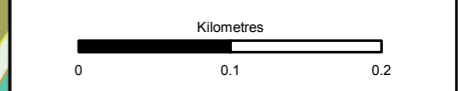

Status	FINAL	Subsidiary	B
--------	-------	------------	---



Figure 12.7
 Scottish Biodiversity List Habitat
 and Aspen Locations
 Sheet 11 of 17

Scale	1:5,000	Drawn	RM	Checked	DK	Approved	ROB	Authorised	SB	
Document Number	A9P11-AMJ-EBD-H_ZZZZZ_XX-DR-GI-0115								Revision	P04
Project	Originator	Volume								
Location	Type	Role	Number							

Reproduced by permission of Ordnance Survey on behalf of HMSO.
 © Crown copyright and database right 2017. All rights reserved.
 Ordnance Survey Licence number 100046668

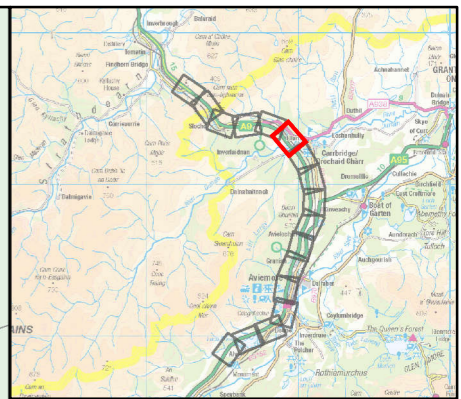
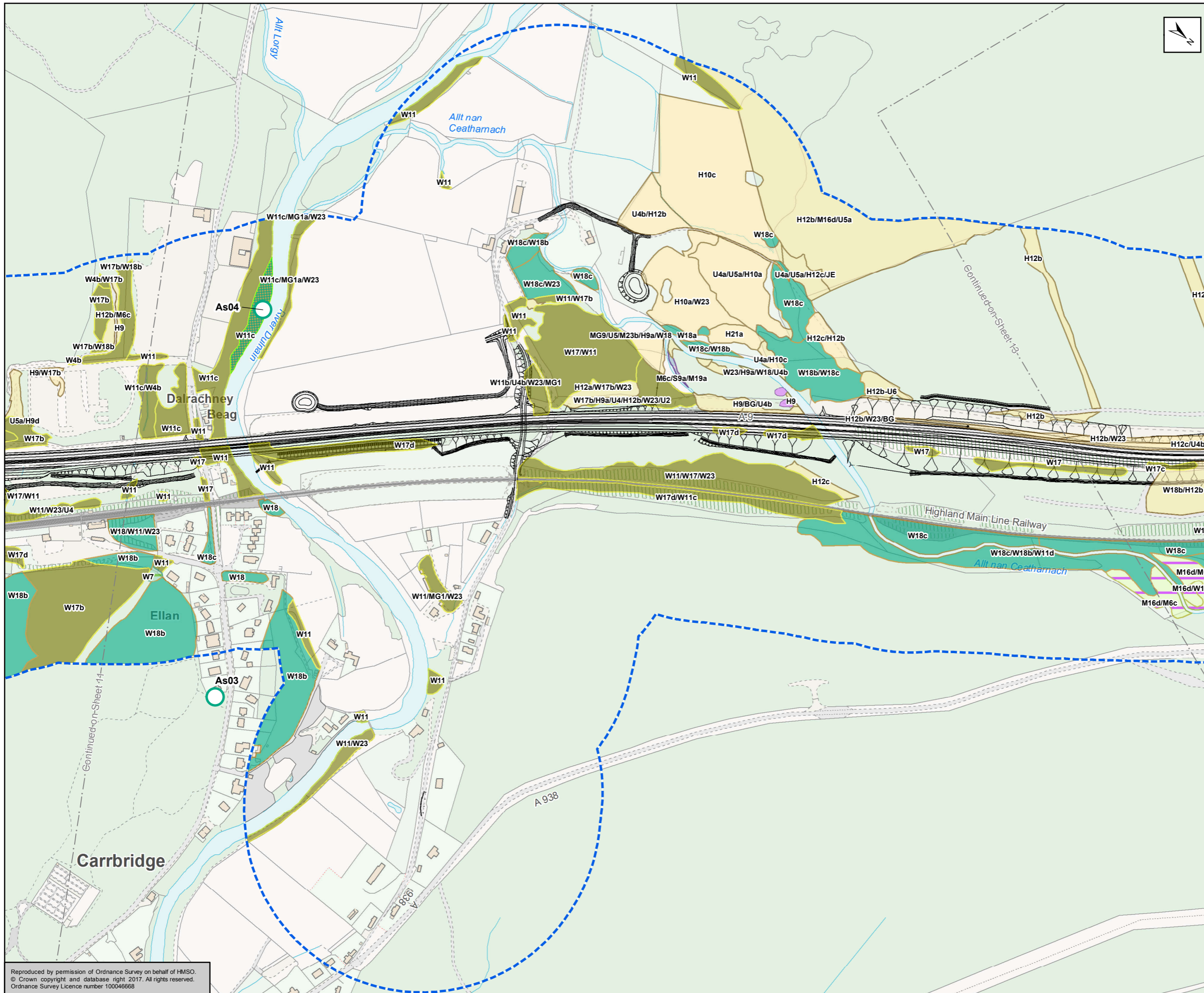

- Proposed Scheme
 250m Study Area
- SBL Priority Habitat**
- Blanket Bog
 - Lowland Fens
 - Native Pinewoods
 - Reedbeds
 - Upland Birchwoods
 - Upland Calcareous Grassland
 - Upland Flushes, Fens and Swamps
 - Upland Heathland
 - Upland Heathland/Blanket Bog
 - Upland Oakwood
 - Wet Woodland
 - Unable to be Classified from Aerial Imagery

- Aspen**
- Aspen scattered throughout woodland
 - Locations of individual / small groups of Aspen

Labels relate to corresponding NVC code (e.g. M20)

Areas are displayed according to the dominant SBL habitat type. Due to habitat mosaics many areas may only contain a small percentage of SBL habitat, whereas others may contain multiple SBL habitats. Please cross-reference the NVC types in SBL areas to Technical Appendix 12.2 for further information.

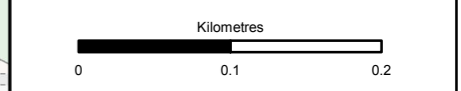

Status	FINAL	Suitability	B
--------	-------	-------------	---



Figure 12.7
 Scottish Biodiversity List Habitat
 and Aspen Locations
 Sheet 12 of 17

Scale	1:5,000	Drawn	RM	Checked	DK	Approved	ROB	Authorised	SB	
Document Number	A9P11-AMJ-EBD-H_ZZZZZ_XZ-DR-GI-0116								Revision	P04
Project	A9P11-AMJ-EBD-H_ZZZZZ_XZ-DR-GI-0116								Location	
Originator									Type	
Volume									Role	
									Number	

Reproduced by permission of Ordnance Survey on behalf of HMSO.
 © Crown copyright and database right 2017. All rights reserved.
 Ordnance Survey Licence number 100046668

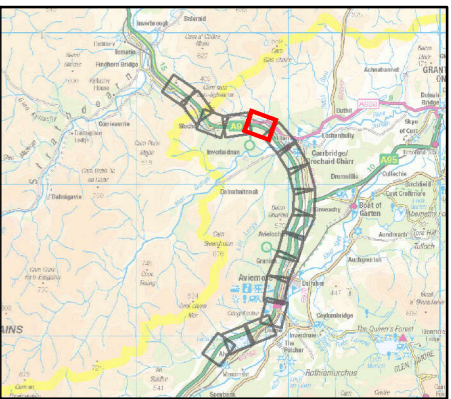
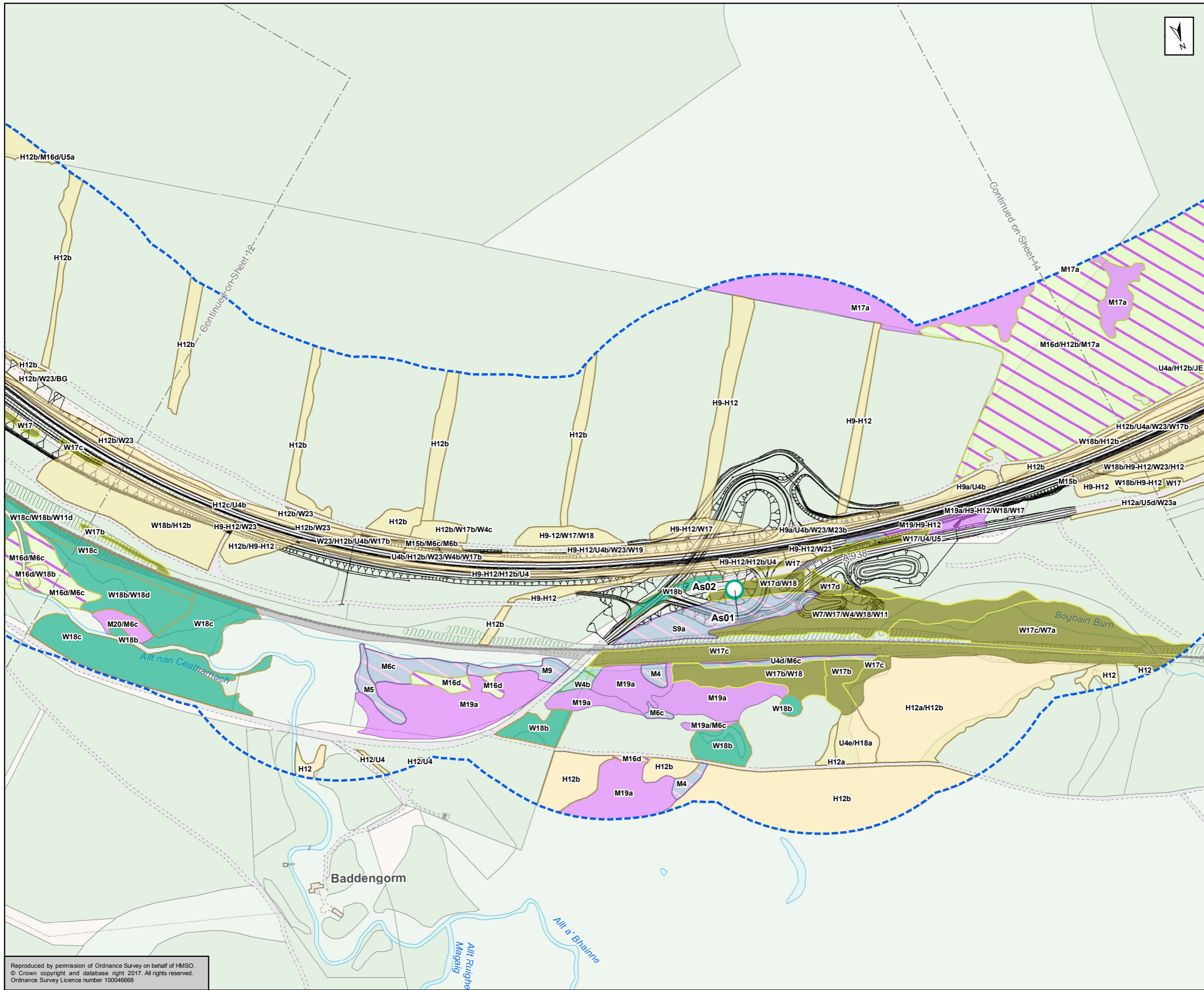

- Proposed Scheme
- 250m Study Area
- SBL Priority Habitat**
- Blanket Bog
- Lowland Fens
- Native Pinewoods
- Reedbeds
- Upland Birchwoods
- Upland Calcareous Grassland
- Upland Flushes, Fens and Swamps
- Upland Heathland
- Upland Heathland/Blanket Bog
- Upland Oakwood
- Wet Woodland
- Unable to be Classified from Aerial Imagery
- Aspen**
- Aspen scattered throughout woodland
- Locations of individual / small groups of Aspen

Labels relate to corresponding NVC code (e.g. M20)

Areas are displayed according to the dominant SBL habitat type. Due to habitat mosaics many areas may only contain a small percentage of SBL habitat, whereas others may contain multiple SBL habitats. Please cross-reference the NVC types in SBL areas to Technical Appendix 12.2 for further information.

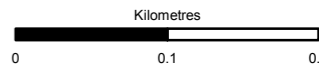

Status	FINAL	Subsidiary	B
--------	-------	------------	---



Figure 12.7
 Scottish Biodiversity List Habitat
 and Aspen Locations
 Sheet 13 of 17

Scale	1:5,000	Drawn	RM	Checked	DK	Approved	ROB	Authorised	SB	
Document Number	A9P11-AMJ-EBD-H_ZZZZZ_XX-DR-GI-0117							Revision	P04	
Project	Originator	Volume					Location	Type	Role	Number

Reproduced by permission of Ordnance Survey on behalf of HMSO. © Crown copyright and database right 2017. All rights reserved. Ordnance Survey Licence number 100046668

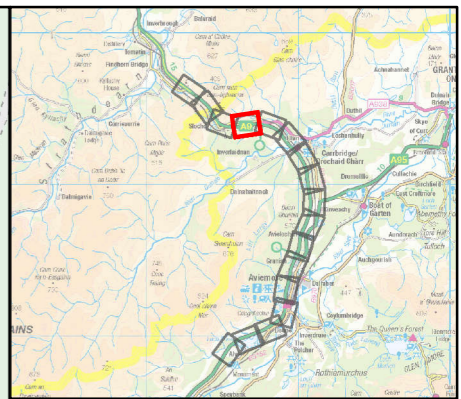
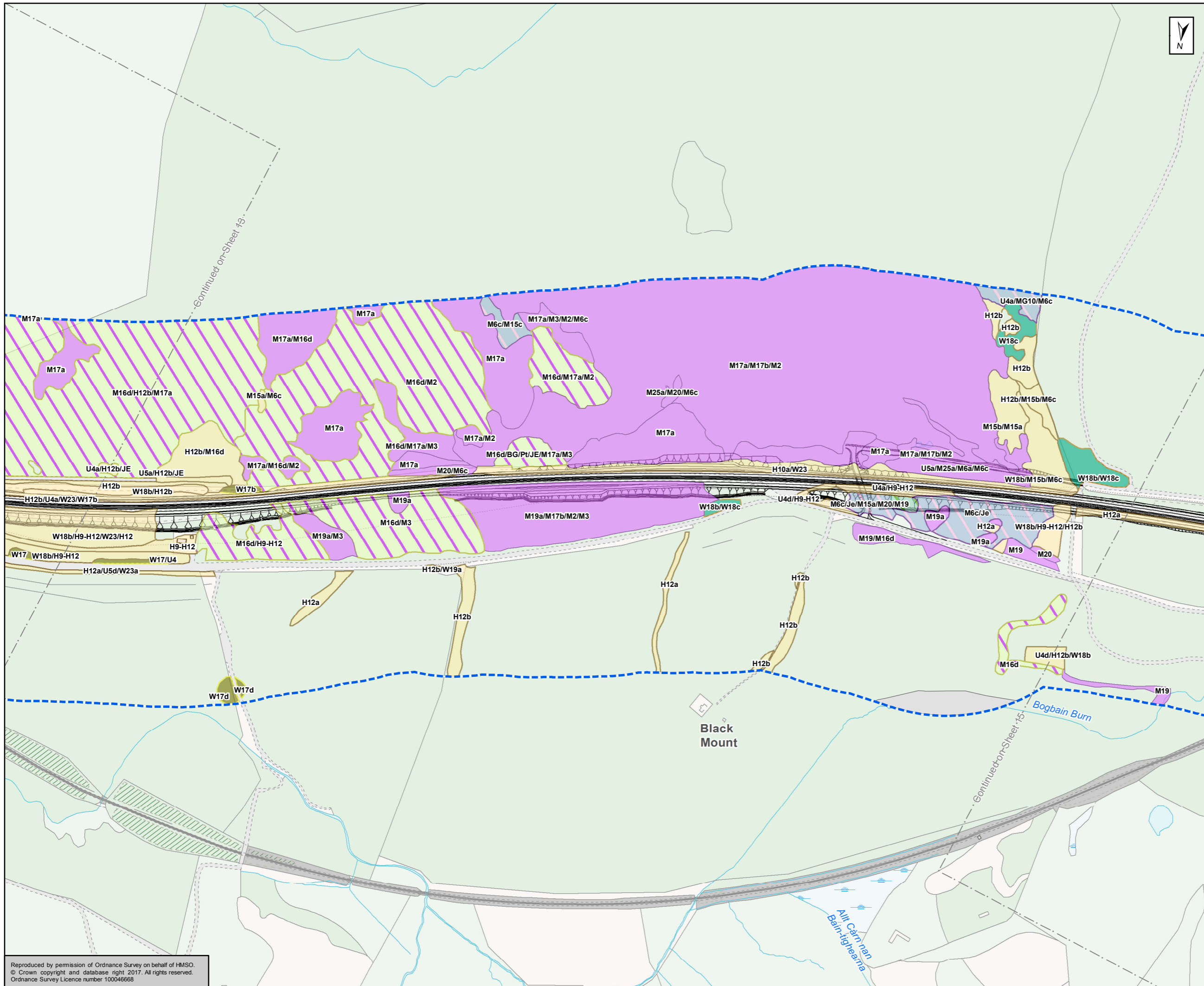

- Proposed Scheme
- 250m Study Area
- SBL Priority Habitat**
- Blanket Bog
 - Lowland Fens
 - Native Pinewoods
 - Reedbeds
 - Upland Birchwoods
 - Upland Calcareous Grassland
 - Upland Flushes, Fens and Swamps
 - Upland Heathland
 - Upland Heathland/Blanket Bog
 - Upland Oakwood
 - Wet Woodland
 - Unable to be Classified from Aerial Imagery

- Aspen**
- Aspen scattered throughout woodland
 - Locations of individual / small groups of Aspen

Labels relate to corresponding NVC code (e.g. M20)

Areas are displayed according to the dominant SBL habitat type. Due to habitat mosaics many areas may only contain a small percentage of SBL habitat, whereas others may contain multiple SBL habitats. Please cross-reference the NVC types in SBL areas to Technical Appendix 12.2 for further information.

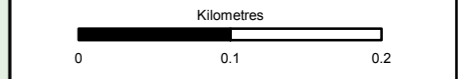

Status	FINAL	Suitability	B
--------	-------	-------------	---



Figure 12.7
 Scottish Biodiversity List Habitat
 and Aspen Locations
 Sheet 14 of 17

Scale	1:5,000	Drawn	RM	Checked	DK	Approved	ROB	Authorised	SB
Document Number	A9P11-AMJ-EBD-H_ZZZZZ_XX-DR-GI-0118							Revision	P04
Project	Originator	Volume							
Location	Type	Role	Number						

Reproduced by permission of Ordnance Survey on behalf of HMSO.
 © Crown copyright and database right 2017. All rights reserved.
 Ordnance Survey Licence number 100046668

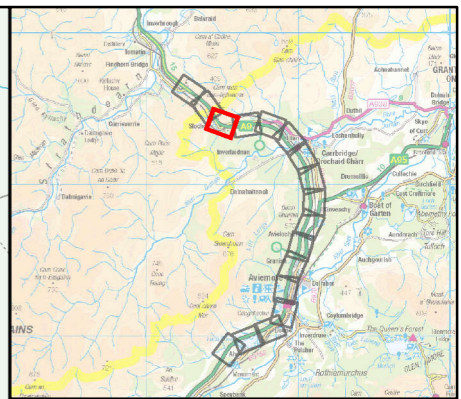
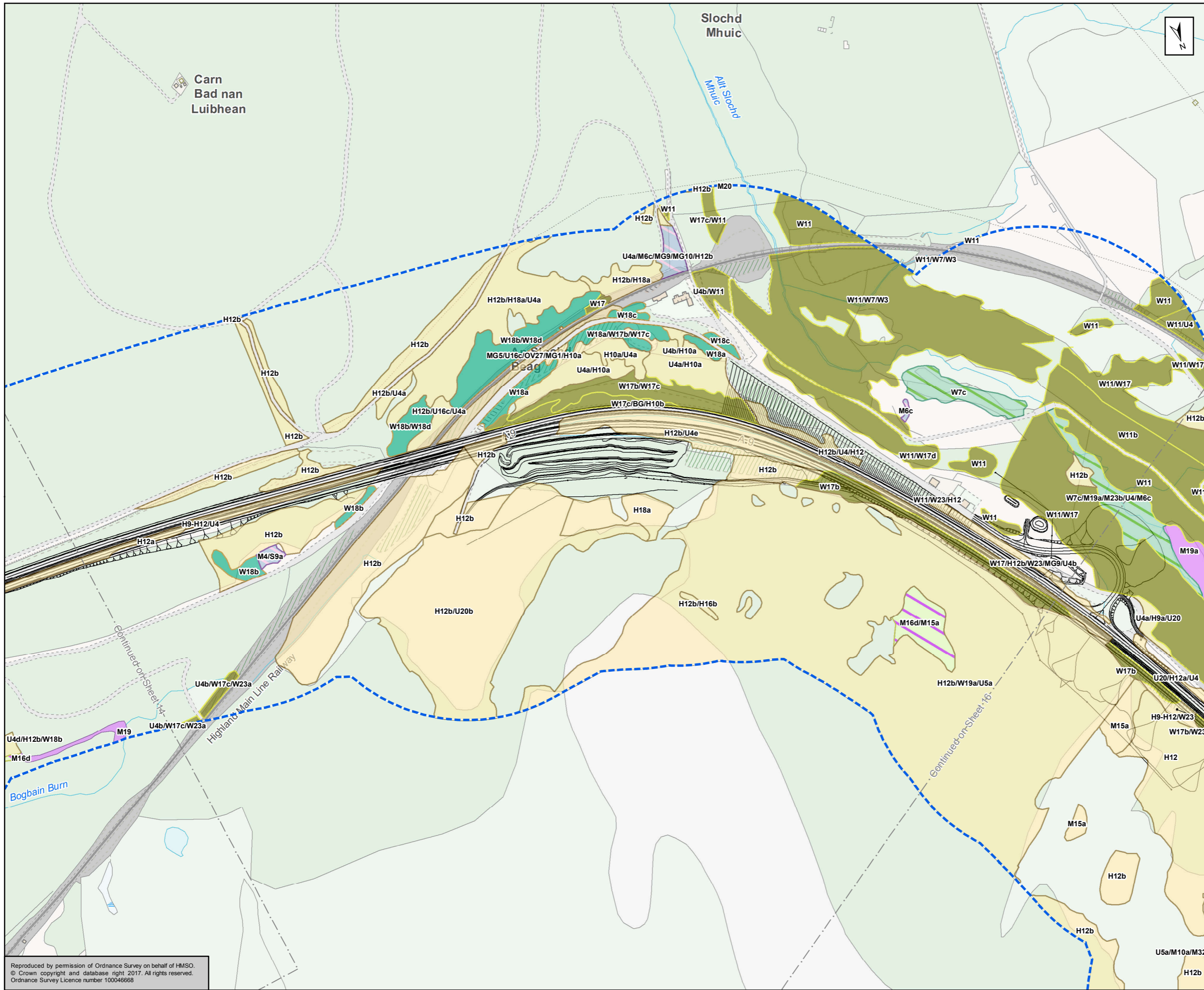

- Proposed Scheme
- 250m Study Area
- SBL Priority Habitat**
- Blanket Bog
- Lowland Fens
- Native Pinewoods
- Reedbeds
- Upland Birchwoods
- Upland Calcareous Grassland
- Upland Flushes, Fens and Swamps
- Upland Heathland
- Upland Heathland/Blanket Bog
- Upland Oakwood
- Wet Woodland
- Unable to be Classified from Aerial Imagery

- Aspen**
- Aspen scattered throughout woodland
- Locations of individual / small groups of Aspen

Labels relate to corresponding NVC code (e.g. M20)

Areas are displayed according to the dominant SBL habitat type. Due to habitat mosaics many areas may only contain a small percentage of SBL habitat, whereas others may contain multiple SBL habitats. Please cross-reference the NVC types in SBL areas to Technical Appendix 12.2 for further information.

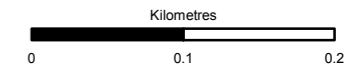

Status	FINAL	Suitability	B
--------	-------	-------------	---



Figure 12.7
Scottish Biodiversity List Habitat
and Aspen Locations
Sheet 15 of 17

Scale	1:5,000	Drawn	RM	Checked	DK	Approved	ROB	Authorised	SB
Document Number	Project		Originator		Volume		Revision		
	A9P11-AMJ-EBD-H_ZZZZZ_XX-DR-GI-0119							P04	
Location	Type	Role	Number						

Reproduced by permission of Ordnance Survey on behalf of HMSO.
© Crown copyright and database right 2017. All rights reserved.
Ordnance Survey Licence number 100046668

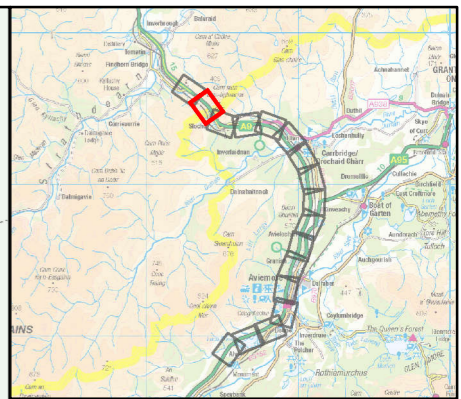
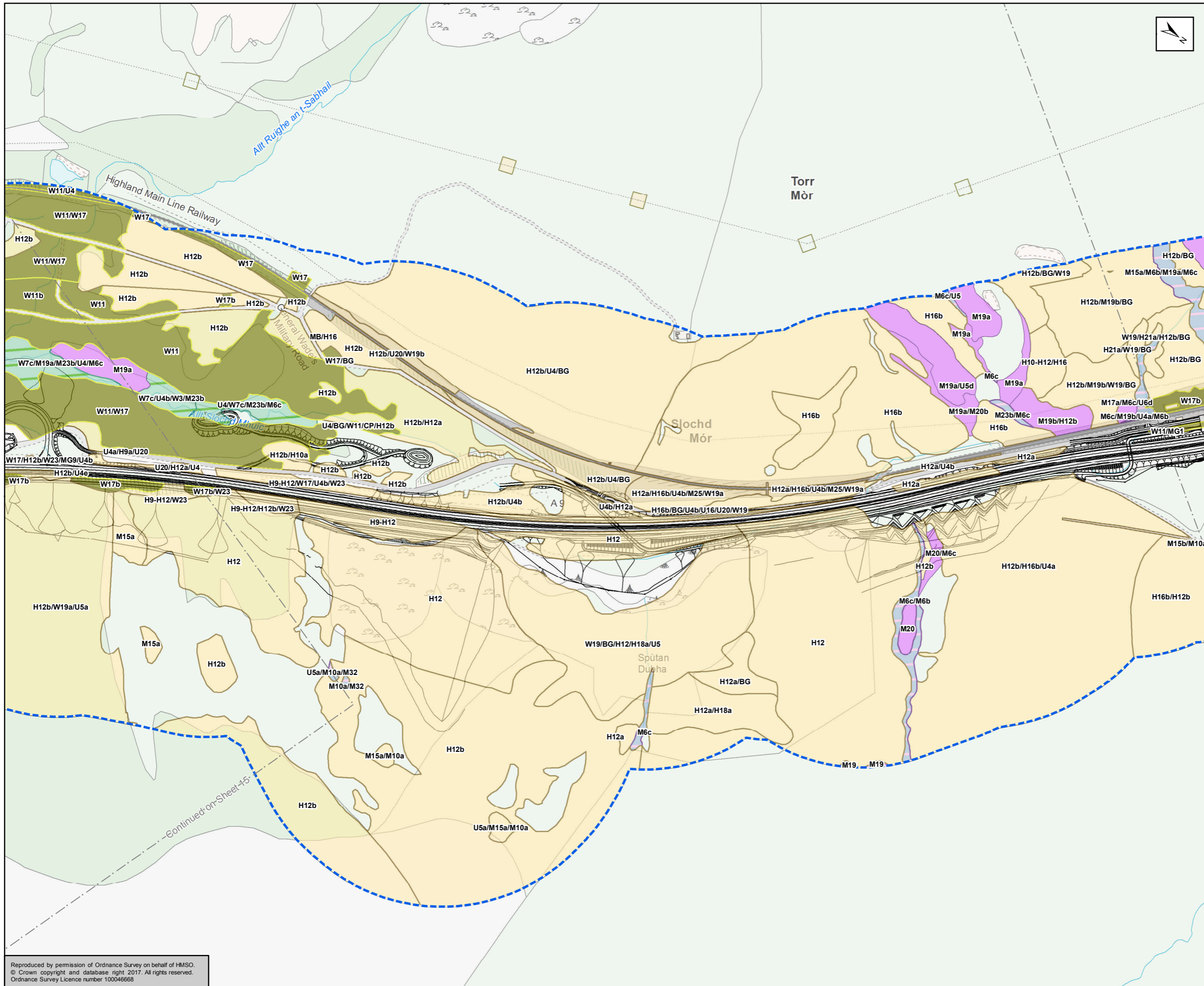

- Proposed Scheme
- 250m Study Area
- SBL Priority Habitat**
- Blanket Bog
- Lowland Fens
- Native Pinewoods
- Reedbeds
- Upland Birchwoods
- Upland Calcareous Grassland
- Upland Flushes, Fens and Swamps
- Upland Heathland
- Upland Heathland/Blanket Bog
- Upland Oakwood
- Wet Woodland
- Unable to be Classified from Aerial Imagery
- Aspen**
- Aspen scattered throughout woodland
- Locations of individual / small groups of Aspen

Labels relate to corresponding NVC code (e.g. M20)

Areas are displayed according to the dominant SBL habitat type. Due to habitat mosaics many areas may only contain a small percentage of SBL habitat, whereas others may contain multiple SBL habitats. Please cross-reference the NVC types in SBL areas to Technical Appendix 12.2 for further information.

Status	FINAL	Suitability	B
--------	-------	-------------	---



Figure 12.7
 Scottish Biodiversity List Habitat
 and Aspen Locations
 Sheet 16 of 17

Scale	1:5,000	Drawn	RM	Checked	DK	Approved	ROB	Authorised	SB
Document Number	A9P11-AMJ-EBD-H_ZZZZZ_XX-DR-GI-0120							Revision	P04
Project	Originator	Volume							
Location	Type	Role	Number						

Reproduced by permission of Ordnance Survey on behalf of HMSO.
 © Crown copyright and database right 2017. All rights reserved.
 Ordnance Survey Licence number 100046668

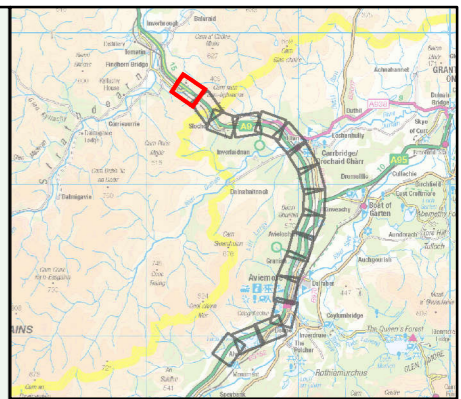
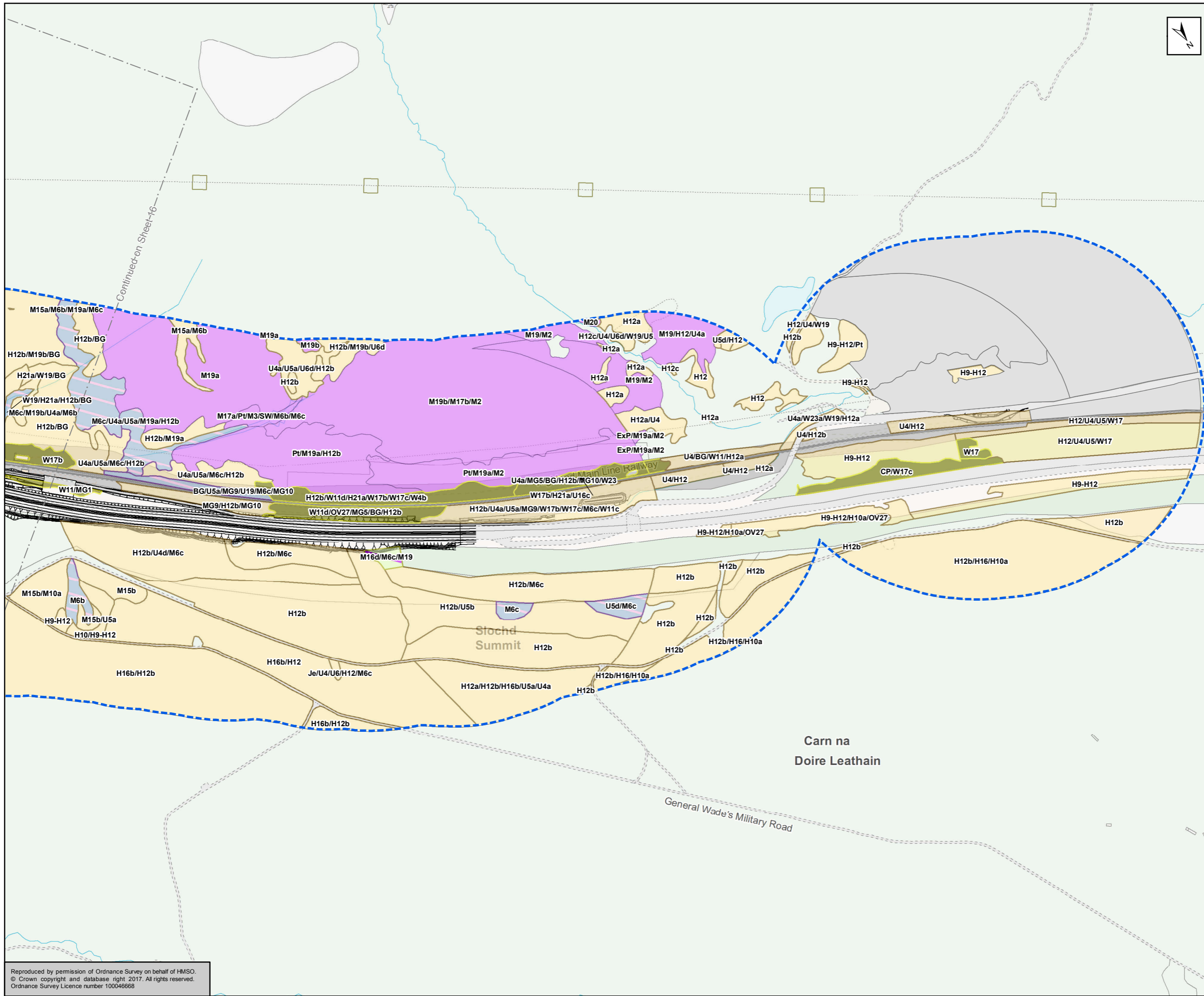

- Proposed Scheme
- 250m Study Area
- SBL Priority Habitat**
 - Blanket Bog
 - Lowland Fens
 - Native Pinewoods
 - Reedbeds
 - Upland Birchwoods
 - Upland Calcareous Grassland
 - Upland Flushes, Fens and Swamps
 - Upland Heathland
 - Upland Heathland/Blanket Bog
 - Upland Oakwood
 - Wet Woodland
 - Unable to be Classified from Aerial Imagery
- Aspen**
 - Aspen scattered throughout woodland
 - Locations of individual / small groups of Aspen

Labels relate to corresponding NVC code (e.g. M20)

Areas are displayed according to the dominant SBL habitat type. Due to habitat mosaics many areas may only contain a small percentage of SBL habitat, whereas others may contain multiple SBL habitats. Please cross-reference the NVC types in SBL areas to Technical Appendix 12.2 for further information.

Kilometres
0 0.1 0.2

Status	FINAL	Suitability	B
--------	-------	-------------	---



Figure 12.7
Scottish Biodiversity List Habitat
and Aspen Locations
Sheet 17 of 17

Scale	1:5,000	Drawn	RM	Checked	DK	Approved	ROB	Authorised	SB
Document Number	A9P11-AMJ-EBD-H_ZZZZZ_XX-DR-GI-0121							Revision	P04
Project	Originator	Volume							
Location	Type	Role	Number						

Reproduced by permission of Ordnance Survey on behalf of HMSO.
© Crown copyright and database right 2017. All rights reserved.
Ordnance Survey Licence number 100046668