

Proposed Scheme  
 250m Study Area  
 Peat Stability Risk Assessment

**Initial Risk**

- High
- Moderate
- Low
- Negligible
- N/A

**Revised Risk**

- High
- Low
- Negligible
- N/A

Kilometres

0      0.15      0.3

|        |            |
|--------|------------|
| Status | Subsidiary |
| FINAL  | B          |

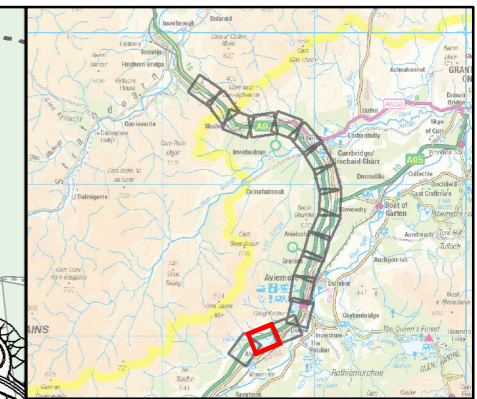
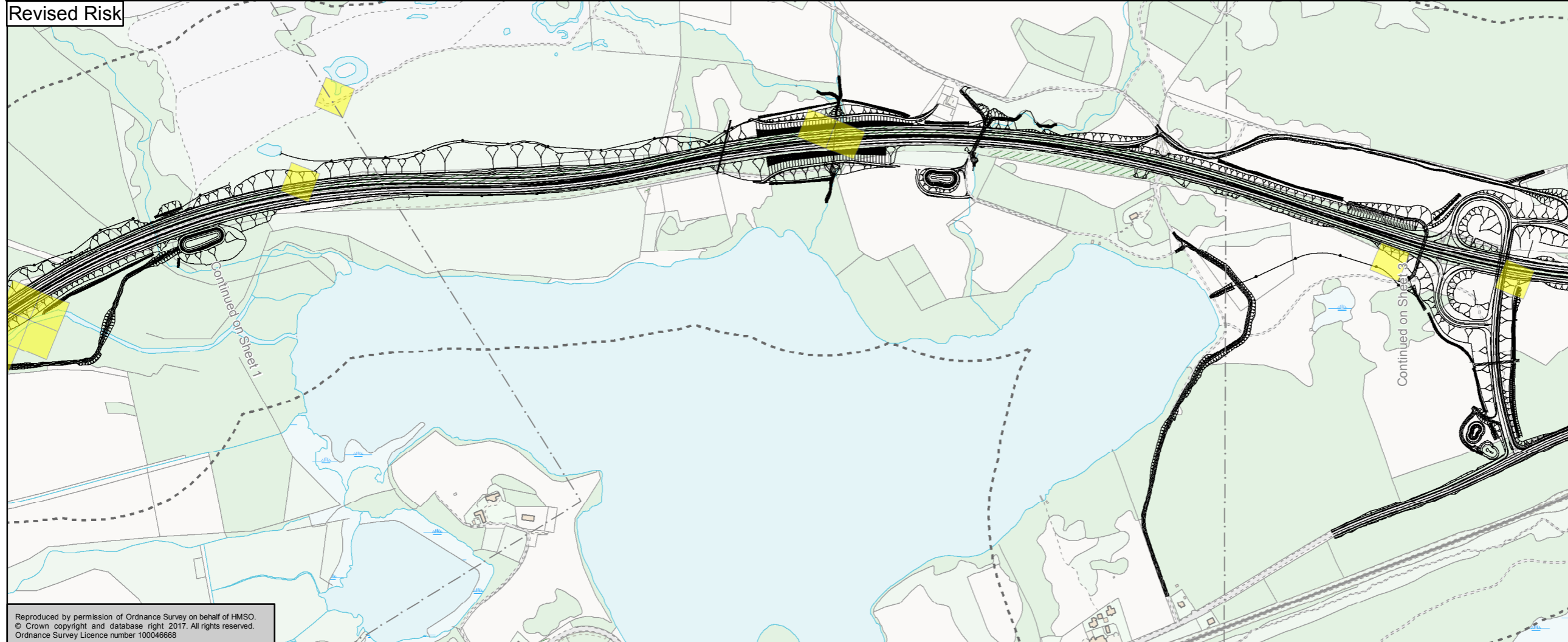
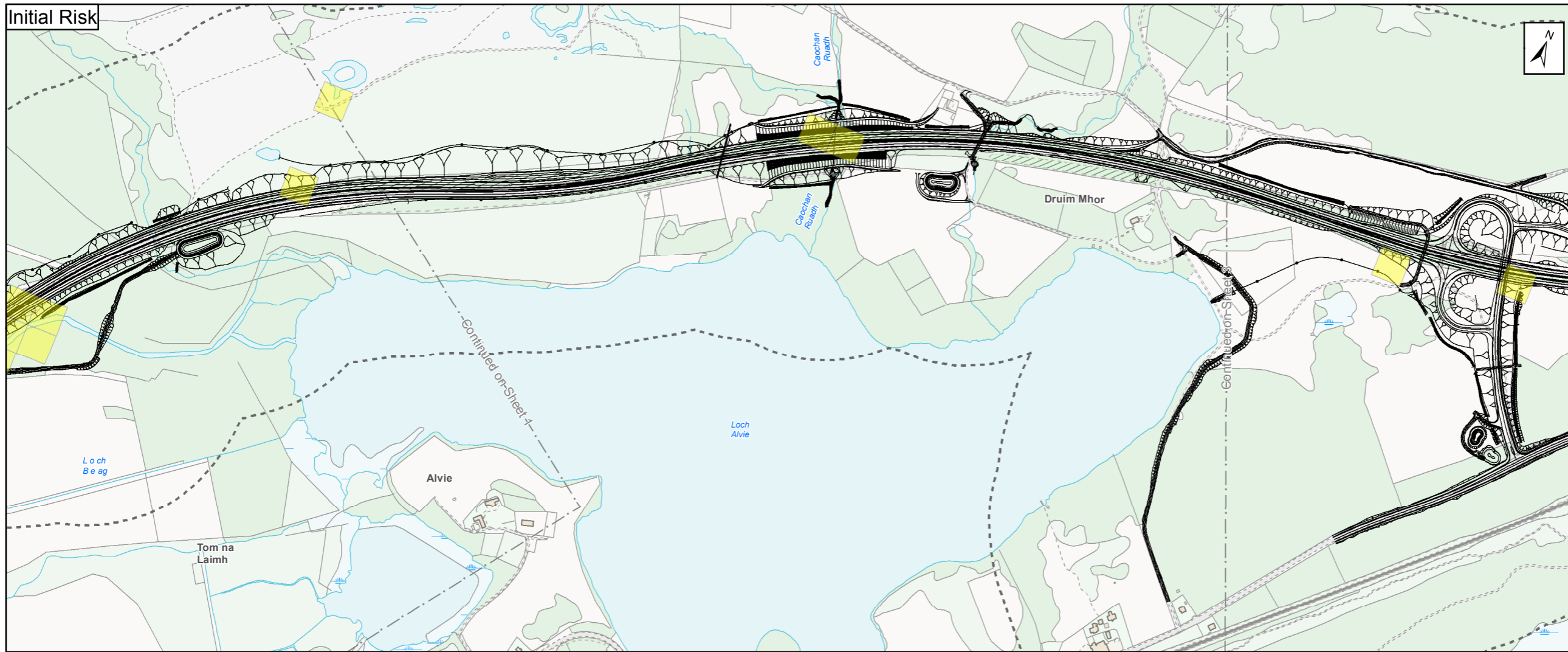

**Figure A10.2.4**  
 Initial Risk and Revised Risk Areas  
 Sheet 1 of 17

|                                     |         |            |          |            |
|-------------------------------------|---------|------------|----------|------------|
| Scale                               | Drawn   | Checked    | Approved | Authorised |
| 1:7,500                             | MM      | RS         | ROB      | SB         |
| Document Number                     | Project | Originator | Volume   | Revision   |
| A9P11-AMJ-EGT-H_ZZZZZ_XX-DR-GI-0195 |         |            |          | P04        |
| Location                            | Type    | Role       | Number   |            |

Reproduced by permission of Ordnance Survey on behalf of HMSO.  
 © Crown copyright and database right 2017. All rights reserved.  
 Ordnance Survey Licence number 100046668





Proposed Scheme  
 250m Study Area  
 Peat Stability Risk Assessment

**Initial Risk**

- High
- Moderate
- Low
- Negligible
- N/A

**Revised Risk**

- High
- Low
- Negligible
- N/A

Kilometres

0      0.15      0.3

Status: FINAL      Subtitle: B

Client: **TRANSPORT SCOTLAND**  
COMHDHAIL ALBA



**ATKINS** mouchel

Figure A10.2.4  
Initial Risk and Revised Risk Areas  
Sheet 2 of 17

|  |  |   |   |                |
|--|--|---|---|----------------|
| Scale: 1:7,500                                       | Drawn: MM                                    | Checked: RS                                     | Approved: ROB                               | Authorised: SB |
| Document Number: A9P11-AMJ-EGT-H_ZZZZZ_XX-DR-GI-0196 | Project: A9P11-AMJ-EGT-H_ZZZZZ_XX-DR-GI-0196 | Originator: A9P11-AMJ-EGT-H_ZZZZZ_XX-DR-GI-0196 | Volume: A9P11-AMJ-EGT-H_ZZZZZ_XX-DR-GI-0196 | Revision: P04  |
| Location:  | Type:  | Role:   | Number:                                     |                |

Reproduced by permission of Ordnance Survey on behalf of HMSO.  
© Crown copyright and database right 2017. All rights reserved.  
Ordnance Survey Licence number 100046668



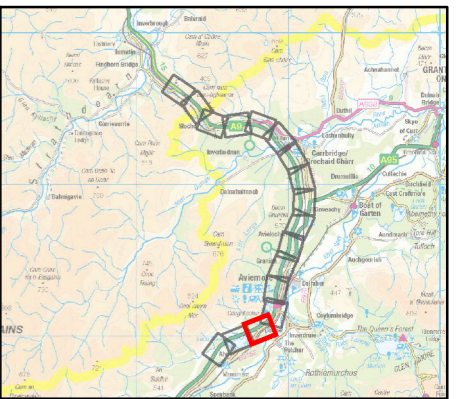
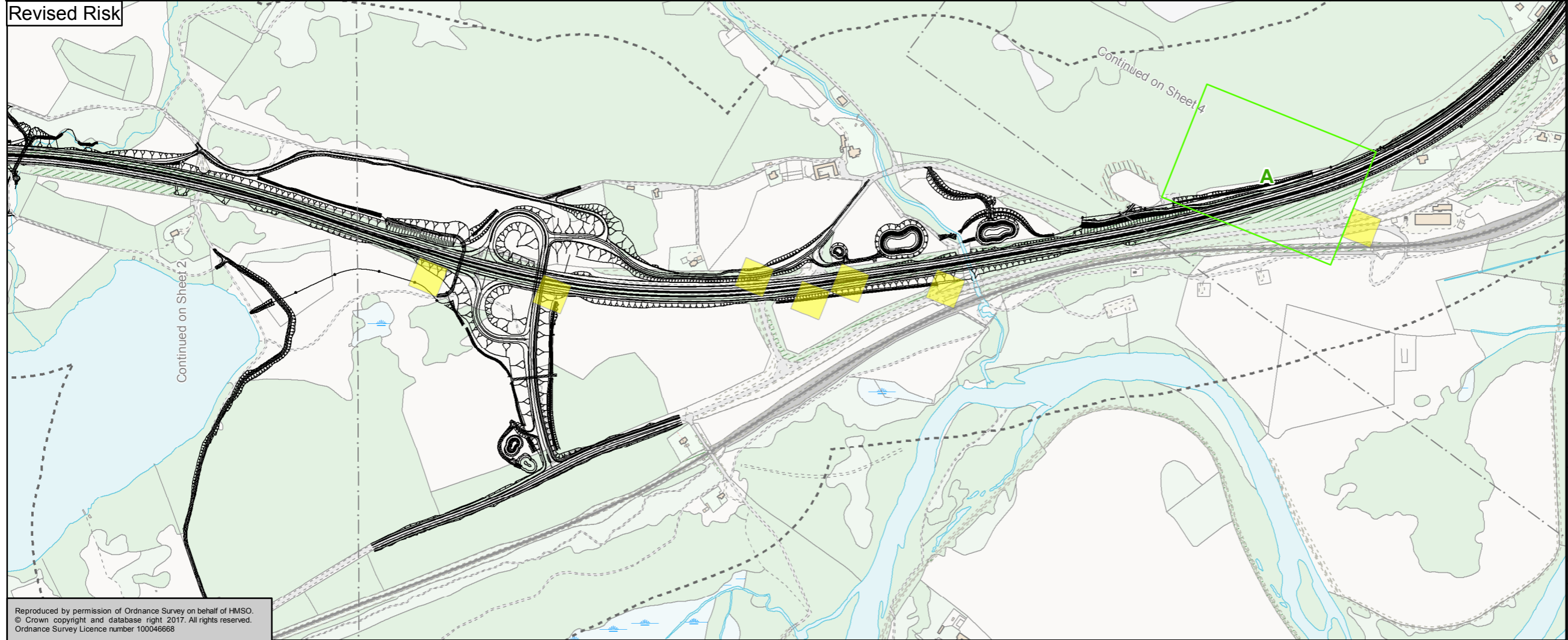
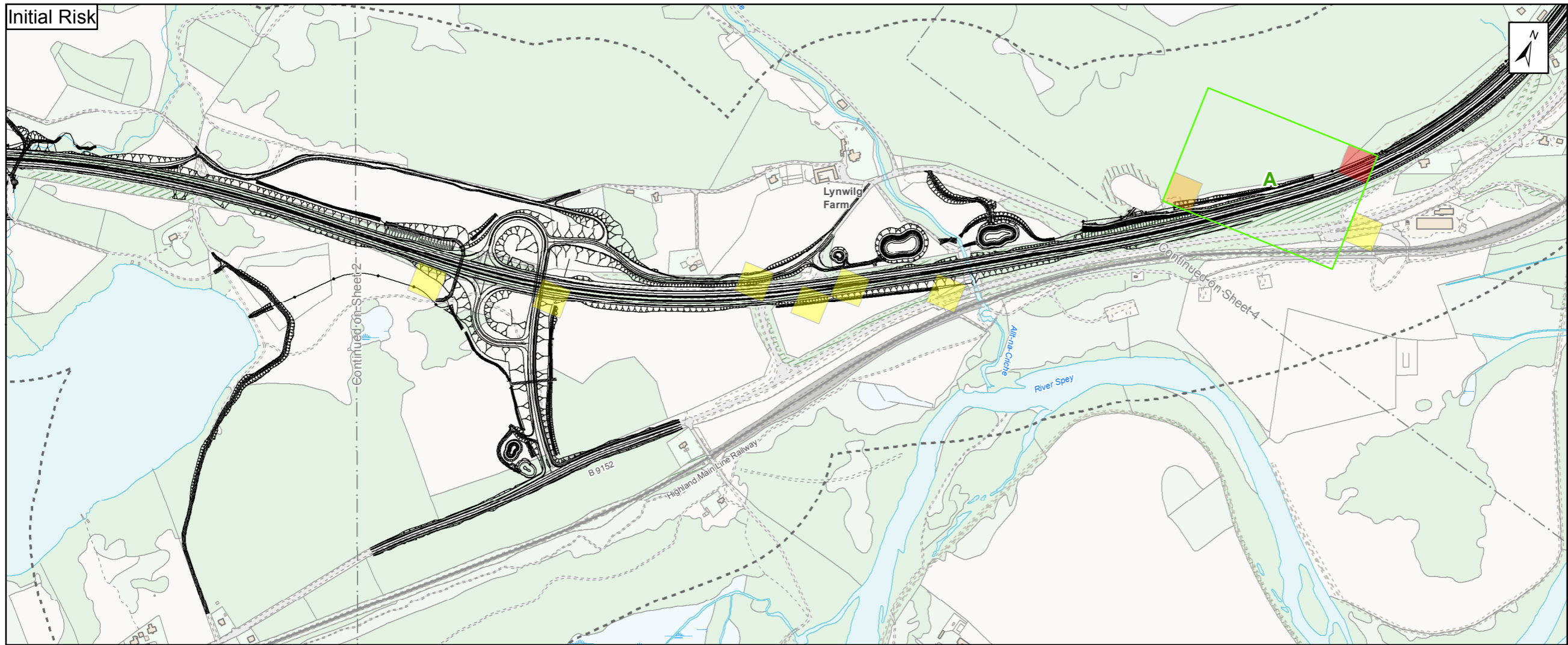

Proposed Scheme  
 250m Study Area  
 Peat Stability Risk Assessment

**Initial Risk**

High  
 Moderate  
 Low  
 Negligible  
 N/A

**Revised Risk**

High  
 Low  
 Negligible  
 N/A

Kilometres

0 0.15 0.3

Status: FINAL Subtitle: B

Client: TRANSPORT SCOTLAND COMHDHAIL ALBA



ATKINS mouchel

Figure A10.2.4  
Initial Risk and Revised Risk Areas  
Sheet 3 of 17

|   |   |                     |                 |                |
|---|---|---------------------|-----------------|----------------|
| Scale: 1:7,500                                      | Drawn: MM                                   | Checked: RS         | Approved: ROB   | Authorised: SB |
| Document Number: A9P11-AMJ-EGT-H_ZZZZ_XX-DR-GI-0197 | Project: A9P11-AMJ-EGT-H_ZZZZ_XX-DR-GI-0197 | Originator: [Blank] | Volume: [Blank] | Revision: P04  |
| Location: [Blank]                                   | Type: [Blank]                               | Role: [Blank]       | Number: [Blank] | [Blank]        |

Reproduced by permission of Ordnance Survey on behalf of HMSO. © Crown copyright and database right 2017. All rights reserved. Ordnance Survey Licence number 100046668



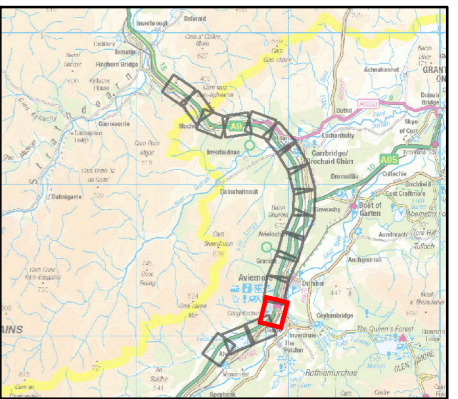
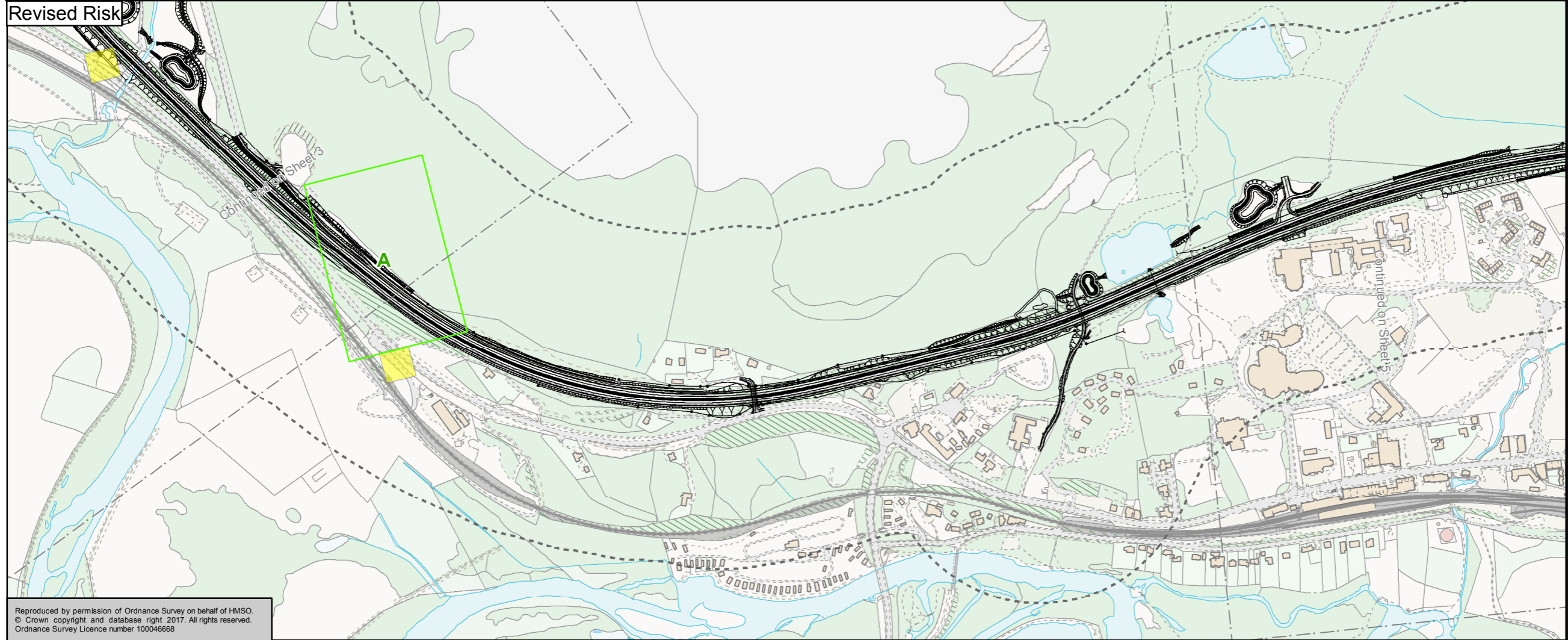
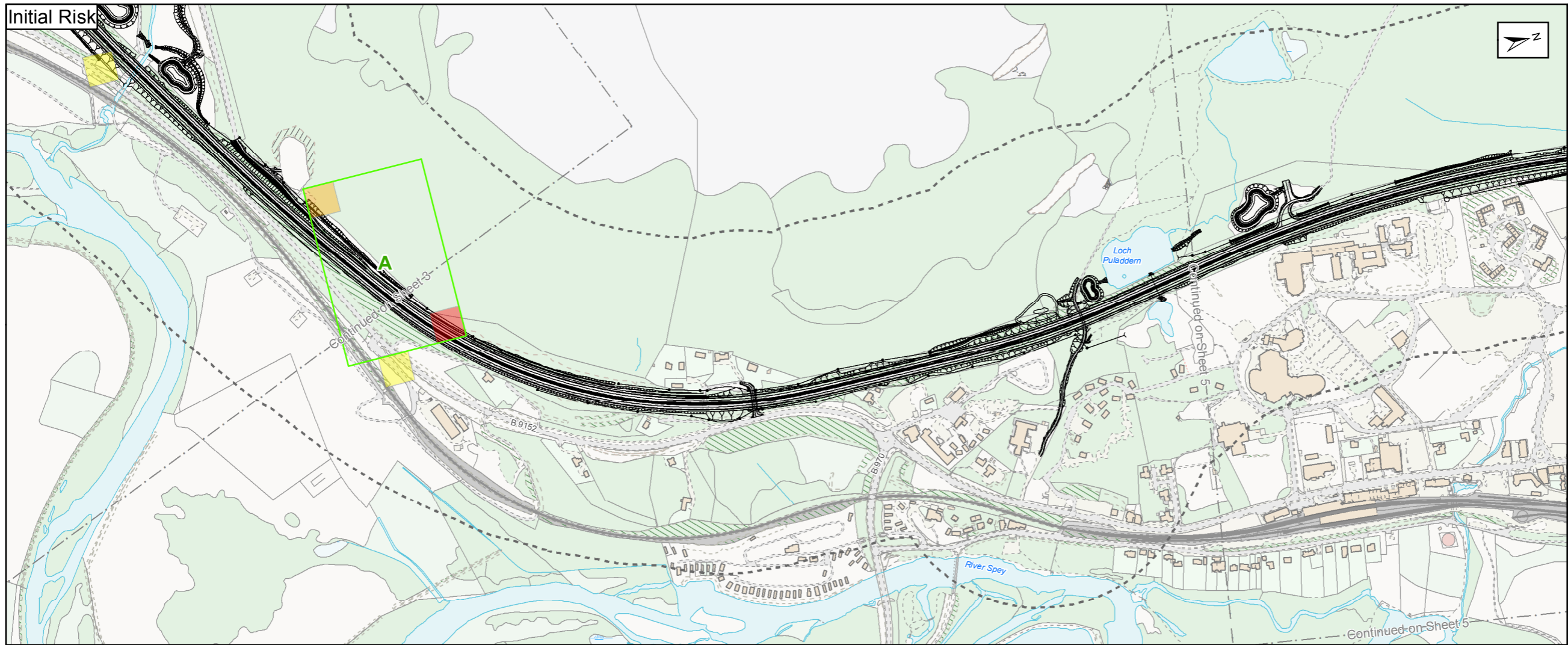

Proposed Scheme  
 250m Study Area  
 Peat Stability Risk Assessment

**Initial Risk**

- High
- Moderate
- Low
- Negligible
- N/A

**Revised Risk**

- High
- Low
- Negligible
- N/A

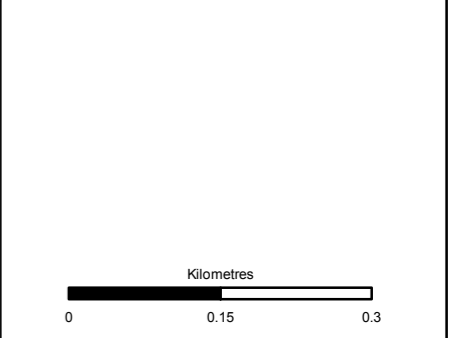

Status: FINAL      Suitability: B

Client: **TRANSPORT SCOTLAND**  
COMHDHAIL ALBA



ATKINS mouchel

Figure A10.2.4  
Initial Risk and Revised Risk Areas  
Sheet 4 of 17

|   |   |                  |               |                |
|---|---|------------------|---------------|----------------|
| Scale: 1:7,500                                      | Drawn: MM                                   | Checked: RS      | Approved: ROB | Authorised: SB |
| Document Number: A9P11-AMJ-EGT-H_ZZZZ_XX-DR-GI-0198 | Project: A9P11-AMJ-EGT-H_ZZZZ_XX-DR-GI-0198 | Originator: ZZZZ | Volume: XX    | Revision: P04  |
| Location:   | Type:                                       | Role:            | Number:       |                |

Reproduced by permission of Ordnance Survey on behalf of HMSO.  
© Crown copyright and database right 2017. All rights reserved.  
Ordnance Survey Licence number 100046668



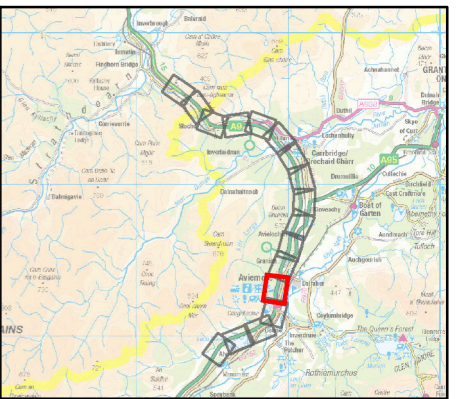
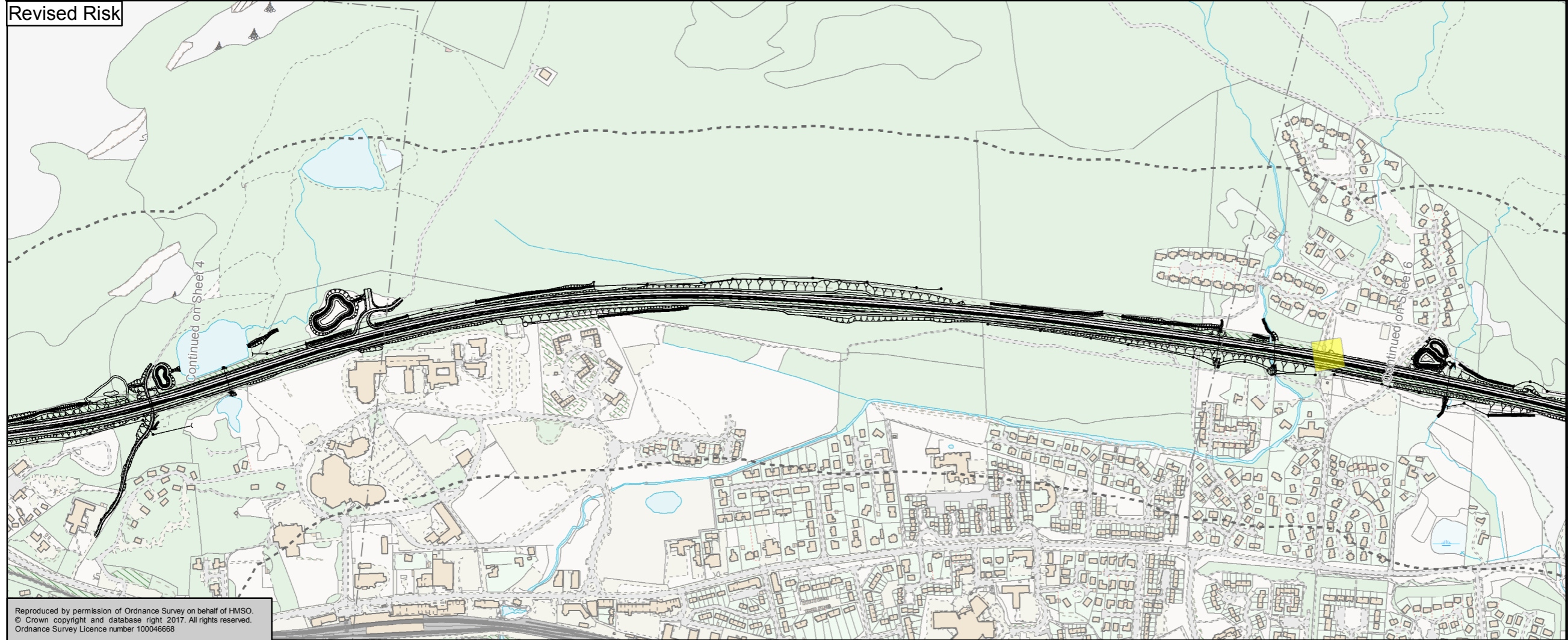
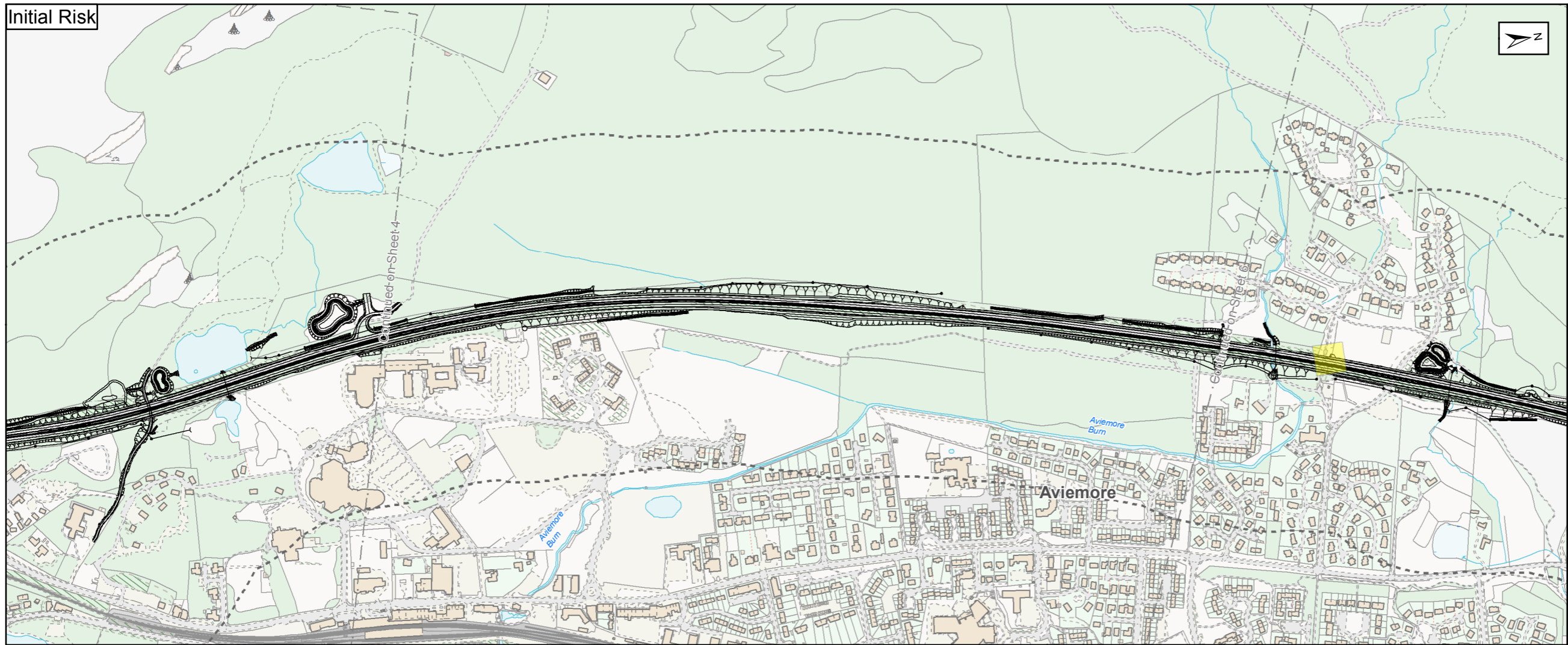

- Proposed Scheme
- 250m Study Area
- Peat Stability Risk Assessment
- Initial Risk**
- High
- Moderate
- Low
- Negligible
- N/A
- Revised Risk**
- High
- Low
- Negligible
- N/A

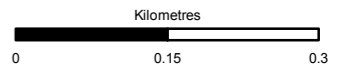

|        |       |            |   |
|--------|-------|------------|---|
| Status | FINAL | Subsidiary | B |
|--------|-------|------------|---|

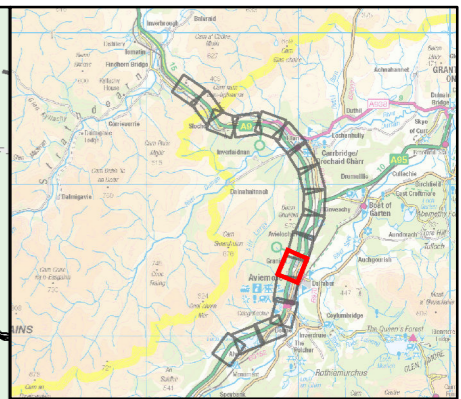
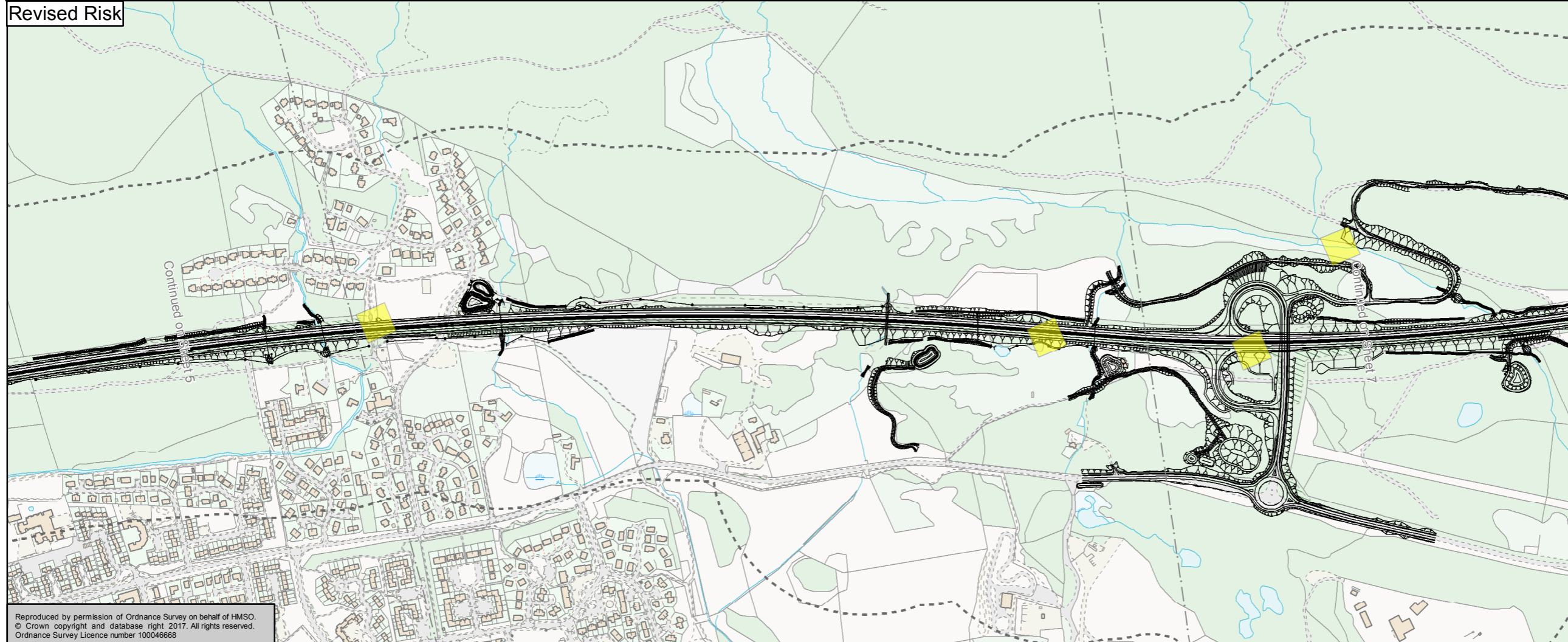
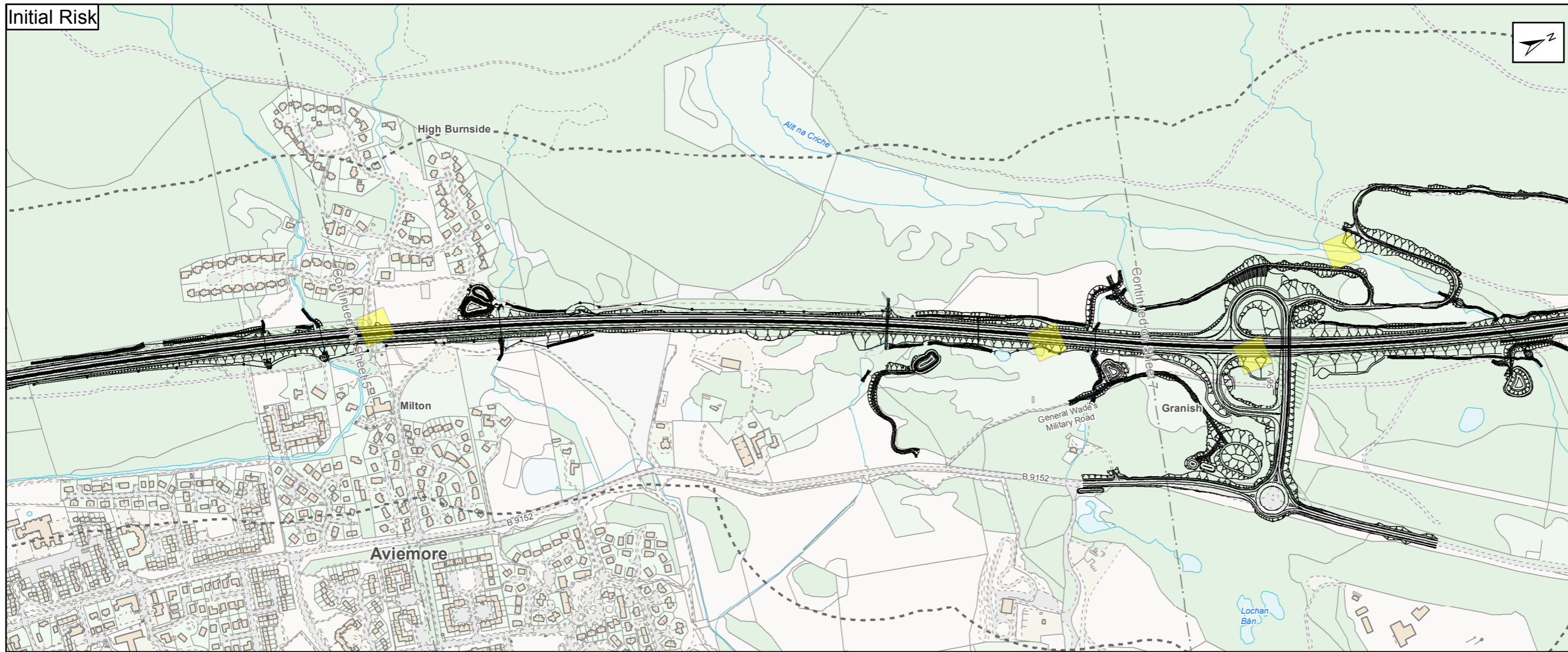

Figure A10.2.4  
Initial Risk and Revised Risk Areas  
Sheet 5 of 17

|                                    |         |      |            |         |        |          |          |            |    |
|------------------------------------|---------|------|------------|---------|--------|----------|----------|------------|----|
| Scale                              | 1:7,500 | Draw | MM         | Checked | RS     | Approved | ROB      | Authorised | SB |
| Document Number                    | Project |      | Originator |         | Volume |          | Revision |            |    |
| A9P11-AMJ-EGT-H_ZZZZ_XX-DR-GI-0199 |         |      |            |         |        |          |          | P04        |    |
| Location                           | Type    | Role | Number     |         |        |          |          |            |    |

Reproduced by permission of Ordnance Survey on behalf of HMSO.  
© Crown copyright and database right 2017. All rights reserved.  
Ordnance Survey Licence number 100046668





Proposed Scheme  
 250m Study Area  
 Peat Stability Risk Assessment

**Initial Risk**

- High
- Moderate
- Low
- Negligible
- N/A

**Revised Risk**

- High
- Low
- Negligible
- N/A

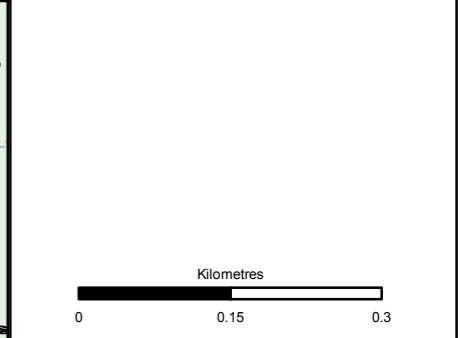

|        |       |            |   |
|--------|-------|------------|---|
| Status | FINAL | Subsidiary | B |
|--------|-------|------------|---|

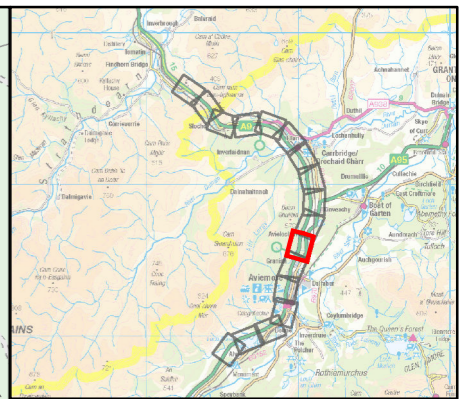
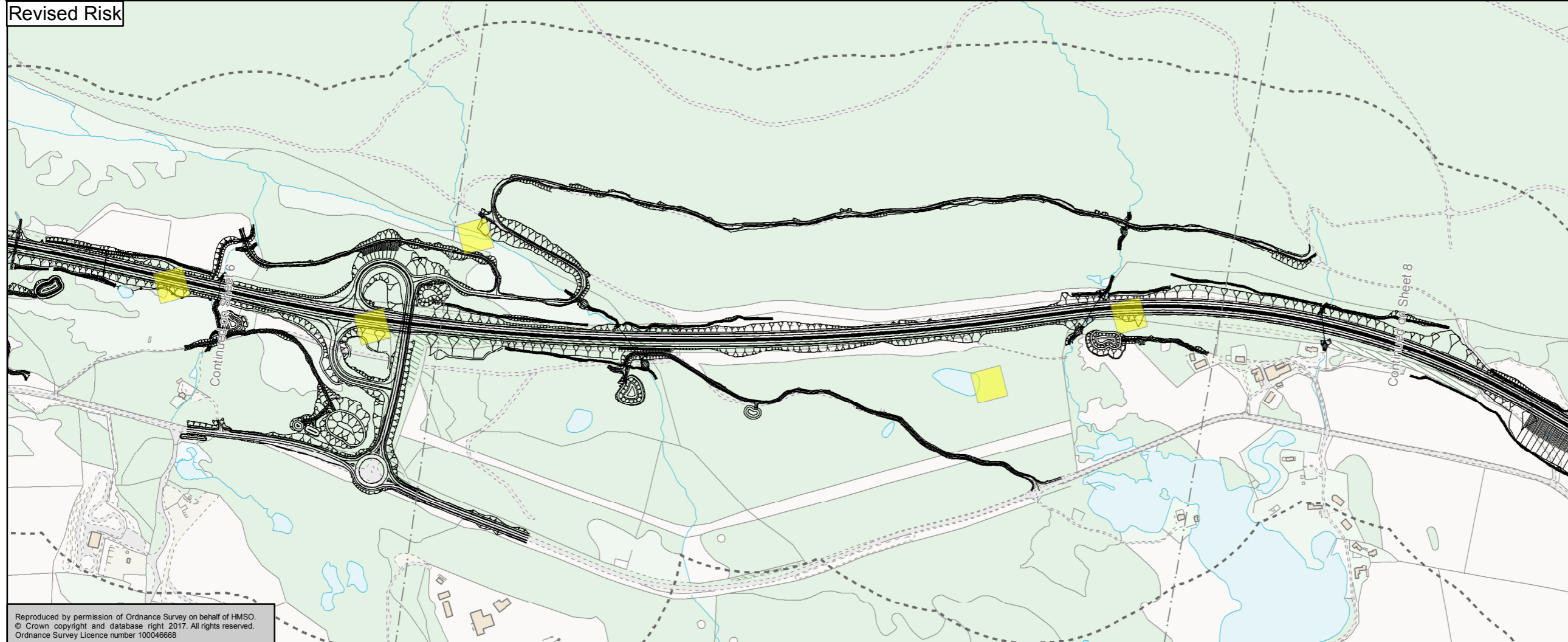
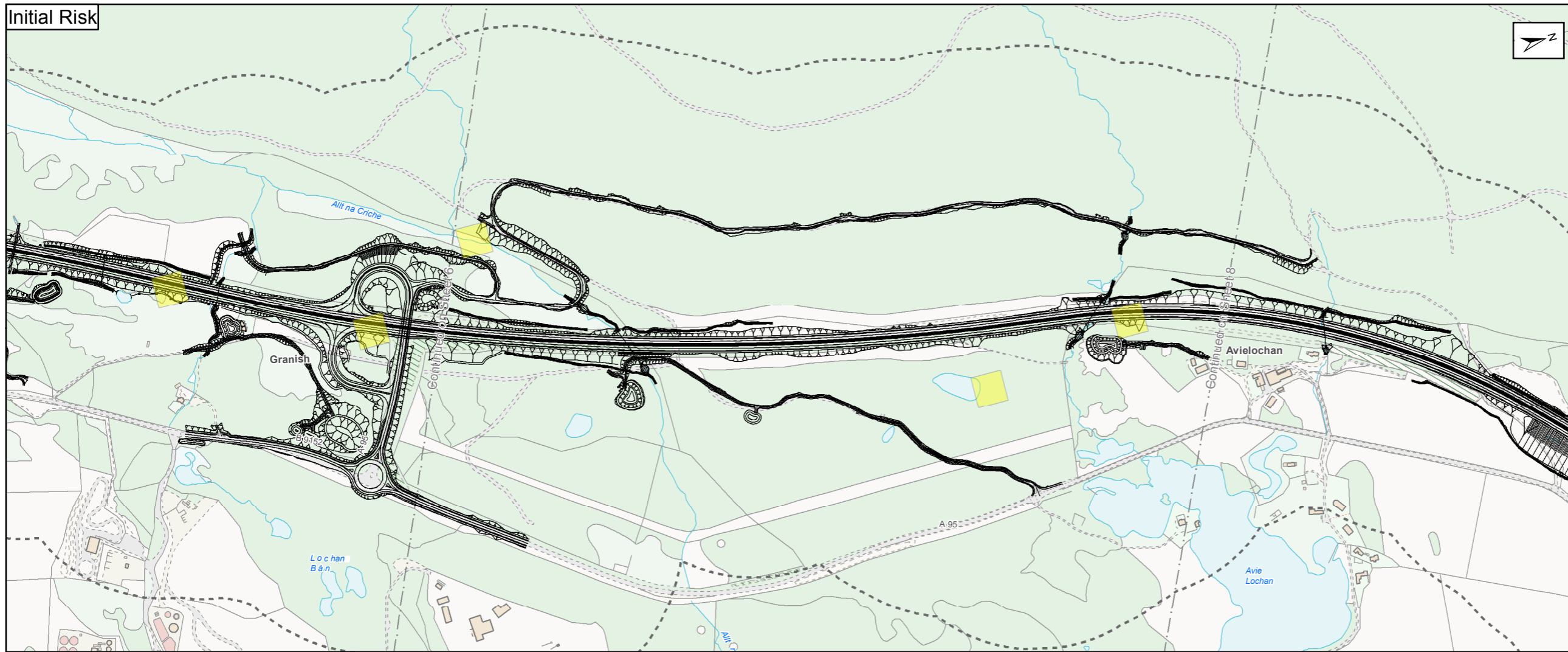

Figure A10.2.4  
Initial Risk and Revised Risk Areas  
Sheet 6 of 17

|                                     |         |       |            |         |        |          |          |            |    |
|-------------------------------------|---------|-------|------------|---------|--------|----------|----------|------------|----|
| Scale                               | 1:7,500 | Drawn | MM         | Checked | RS     | Approved | ROB      | Authorised | SB |
| Document Number                     | Project |       | Originator |         | Volume |          | Revision |            |    |
| A9P11-AMJ-EGT-H_ZZZZZ_XZ-DR-GI-0200 |         |       |            |         |        |          | P04      |            |    |
| Location                            | Type    | Role  | Number     |         |        |          |          |            |    |

Reproduced by permission of Ordnance Survey on behalf of HMSO.  
© Crown copyright and database right 2017. All rights reserved.  
Ordnance Survey Licence number 100046668





Proposed Scheme  
 250m Study Area  
 Peat Stability Risk Assessment

**Initial Risk**

- High
- Moderate
- Low
- Negligible
- N/A

**Revised Risk**

- High
- Low
- Negligible
- N/A

Kilometres

|        |       |            |   |
|--------|-------|------------|---|
| Status | FINAL | Subsidiary | B |
|--------|-------|------------|---|

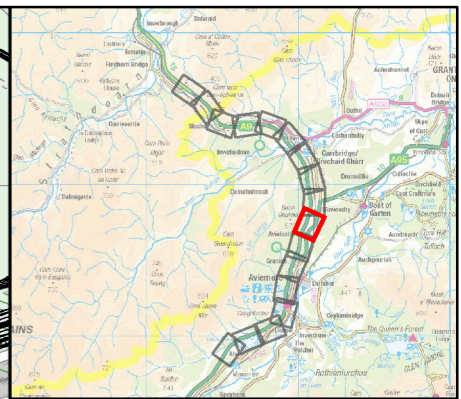
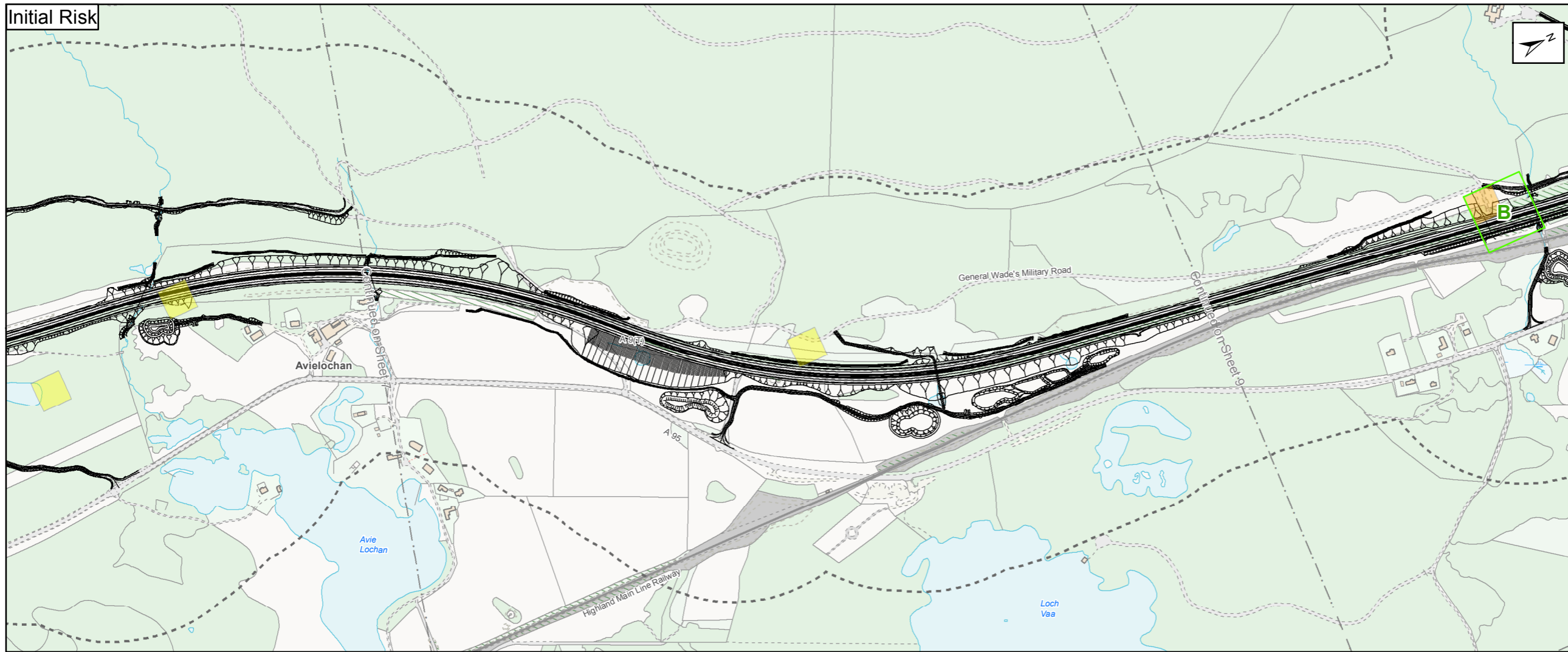

**Figure A10.2.4**  
 Initial Risk and Revised Risk Areas  
 Sheet 7 of 17

|                 |                                     |        |    |         |    |          |     |            |     |
|-----------------|-------------------------------------|--------|----|---------|----|----------|-----|------------|-----|
| Scale           | 1:7,500                             | Drawn  | MM | Checked | RS | Approved | ROB | Authorised | SB  |
| Document Number | A9P11-AMJ-EGT-H_ZZZZZ_XX-DR-GI-0201 |        |    |         |    |          |     | Revision   | P04 |
| Project         | Originator                          | Volume |    |         |    |          |     |            |     |
| Location        | Type                                | Role   |    |         |    |          |     |            |     |

Reproduced by permission of Ordnance Survey on behalf of HMSO.  
 © Crown copyright and database right 2017. All rights reserved.  
 Ordnance Survey Licence number 100046668





Proposed Scheme  
 250m Study Area  
 Peat Stability Risk Assessment

**Initial Risk**

- High
- Moderate
- Low
- Negligible
- N/A

**Revised Risk**

- High
- Low
- Negligible
- N/A

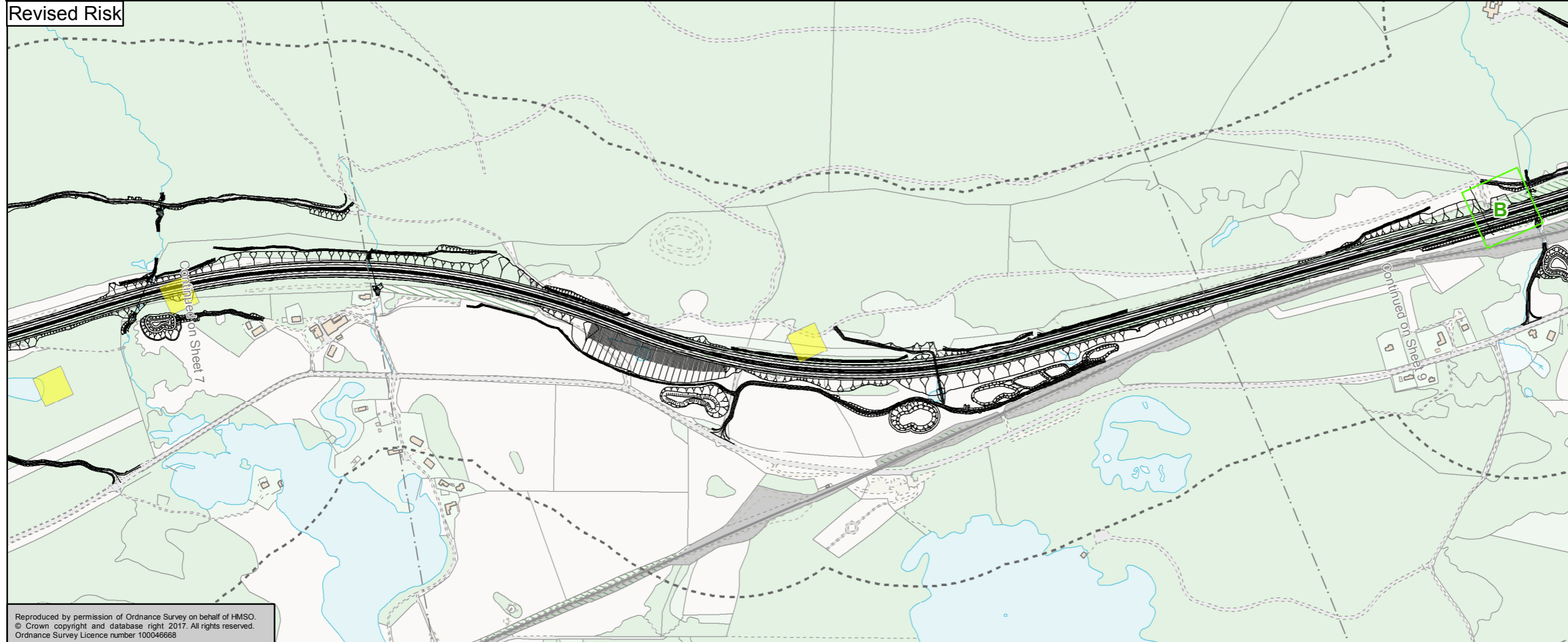

Kilometres

0      0.15      0.3

|        |       |            |   |
|--------|-------|------------|---|
| Status | FINAL | Subsidiary | B |
|--------|-------|------------|---|

Client

TRANSPORT SCOTLAND  
COMHDHAIL ALBA

A9  
DUALLING  
PERTH TO INVERNESS  
Dalraddy to Stochd

ATKINS mouchel

Figure A10.2.4  
Initial Risk and Revised Risk Areas  
Sheet 8 of 17

|                 |                                     |        |    |         |    |          |     |            |     |
|-----------------|-------------------------------------|--------|----|---------|----|----------|-----|------------|-----|
| Scale           | 1:7,500                             | Drawn  | MM | Checked | RS | Approved | ROB | Authorised | SB  |
| Document Number | A9P11-AMJ-EGT-H_ZZZZZ_XX-DR-GI-0202 |        |    |         |    |          |     | Revision   | P04 |
| Project         | Originator                          | Volume |    |         |    |          |     |            |     |
| Location        | Type                                | Role   |    |         |    |          |     |            |     |

Reproduced by permission of Ordnance Survey on behalf of HMSO.  
© Crown copyright and database right 2017. All rights reserved.  
Ordnance Survey Licence number 100046668



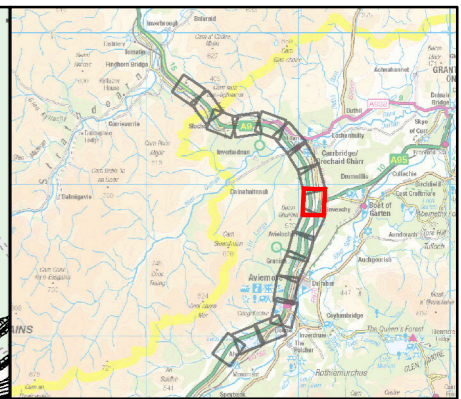
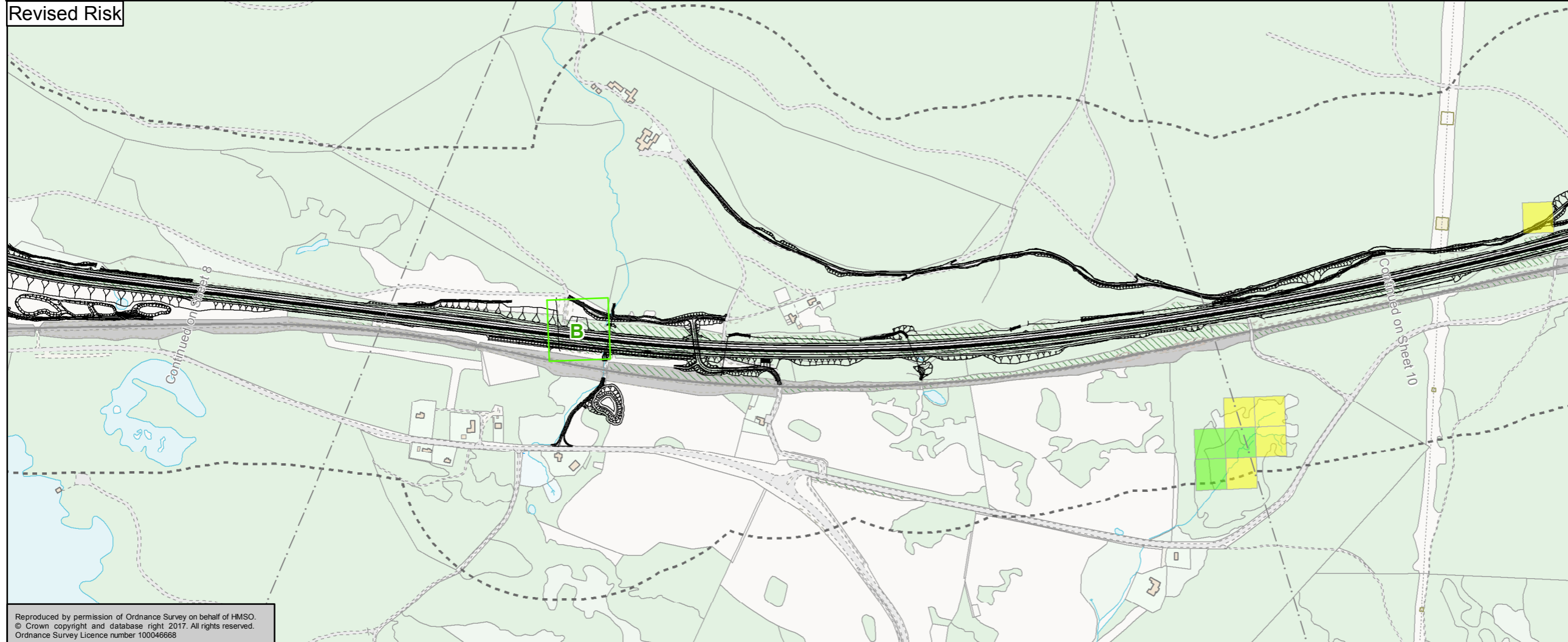
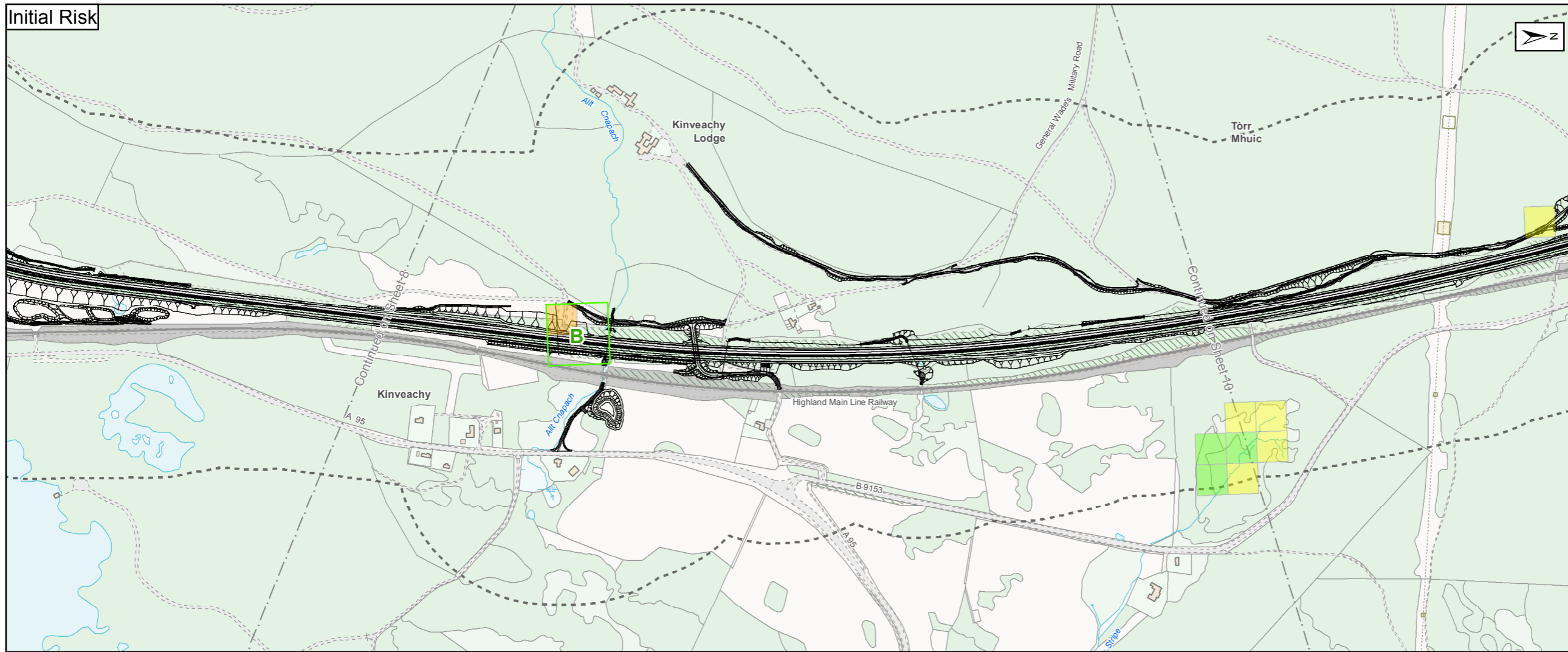

- Proposed Scheme
  - 250m Study Area
  - Peat Stability Risk Assessment
- Initial Risk**
- High
  - Moderate
  - Low
  - Negligible
  - N/A
- Revised Risk**
- High
  - Low
  - Negligible
  - N/A

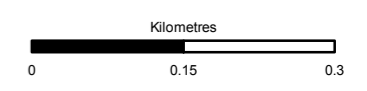

Status: FINAL Subtitle: B

Client: **TRANSPORT SCOTLAND**  
COMHDHAIL ALBA



ATKINS mouchel

Figure A10.2.4  
Initial Risk and Revised Risk Areas  
Sheet 9 of 17

|  |  |                     |                 |                |
|--|--|---------------------|-----------------|----------------|
| Scale: 1:7,500                                       | Drawn: MM                                    | Checked: RS         | Approved: ROB   | Authorised: SB |
| Document Number: A9P11-AMJ-EGT-H_ZZZZZ_XX-DR-GI-0203 | Project: A9P11-AMJ-EGT-H_ZZZZZ_XX-DR-GI-0203 | Originator: [Blank] | Volume: [Blank] | Revision: P04  |
| Location: [Blank]                                    | Type: [Blank]                                | Role: [Blank]       | Number: [Blank] | [Blank]        |

Reproduced by permission of Ordnance Survey on behalf of HMSO.  
© Crown copyright and database right 2017. All rights reserved.  
Ordnance Survey Licence number 100046668