

## The Proposed Scheme Part 1

Drawing No.	Drawing Type	Drawing Title	Projectwise Drawing Reference	Software
5.1	BASELINE PLAN	ENVIRONMENTAL DESIGNATIONS AND CONSTRAINTS	A9P09-CFJ-EGN-M_MLZZZ_ZZ-DR-EN-0001	GIS
5.2	PROPOSED SCHEME PLAN	PROPOSED SCHEME PLAN chainage 40000 to 41200	A9P09-CFJ-EGN-M_ML400_ZZ-DR-EN-0004	GIS
5.3	PROPOSED SCHEME PLAN	PROPOSED SCHEME PLAN chainage 41200 to 42800	A9P09-CFJ-EGN-M_ML412_ZZ-DR-EN-0001	GIS
5.4	PROPOSED SCHEME PLAN	PROPOSED SCHEME PLAN chainage 42800 to 44200	A9P09-CFJ-EGN-M_ML428_ZZ-DR-EN-0001	GIS
5.5	PROPOSED SCHEME PLAN	PROPOSED SCHEME PLAN chainage 44200 to 45600	A9P09-CFJ-EGN-M_ML442_ZZ-DR-EN-0001	GIS
5.6	PROPOSED SCHEME PLAN	PROPOSED SCHEME PLAN chainage 45600 to 47200	A9P09-CFJ-EGN-M_ML456_ZZ-DR-EN-0004	GIS
5.7	PROPOSED SCHEME PLAN	PROPOSED SCHEME PLAN chainage 47200 to 48600	A9P09-CFJ-EGN-M_ML472_ZZ-DR-EN-0003	GIS
5.8	PROPOSED SCHEME PLAN	PROPOSED SCHEME PLAN chainage 48600 to 50000	A9P09-CFJ-EGN-M_ZZ486_ZZ-DR-EN-0001	GIS
5.9	PROPOSED SCHEME PLAN	PROPOSED SCHEME PLAN chainage 50000 to 51800	A9P09-CFJ-EGN-M_ML500_ZZ-DR-EN-0001	GIS
5.10	PROPOSED SCHEME PLAN	PROPOSED SCHEME PLAN chainage 51800 to 53200	A9P09-CFJ-EGN-M_ML518_ZZ-DR-EN-0005	GIS
5.11	PROPOSED SCHEME PLAN	PROPOSED SCHEME PLAN chainage 53200 to 54600	A9P09-CFJ-EGN-M_ML532_ZZ-DR-EN-0003	GIS
5.12	PROPOSED SCHEME PLAN	PROPOSED SCHEME PLAN chainage 54600 to 56000	A9P09-CFJ-EGN-M_ML546_ZZ-DR-EN-0003	GIS
5.13	PROPOSED SCHEME PLAN	PROPOSED SCHEME PLAN chainage 56000 to 56645	A9P09-CFJ-EGN-M_ML560_ZZ-DR-EN-0001	GIS

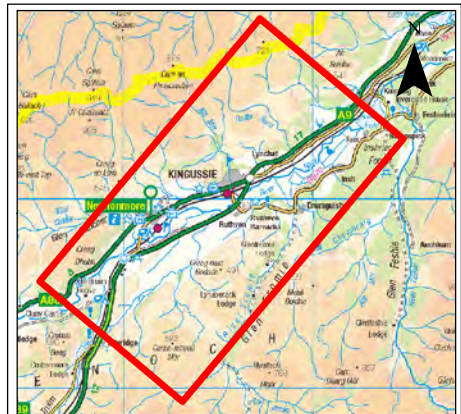
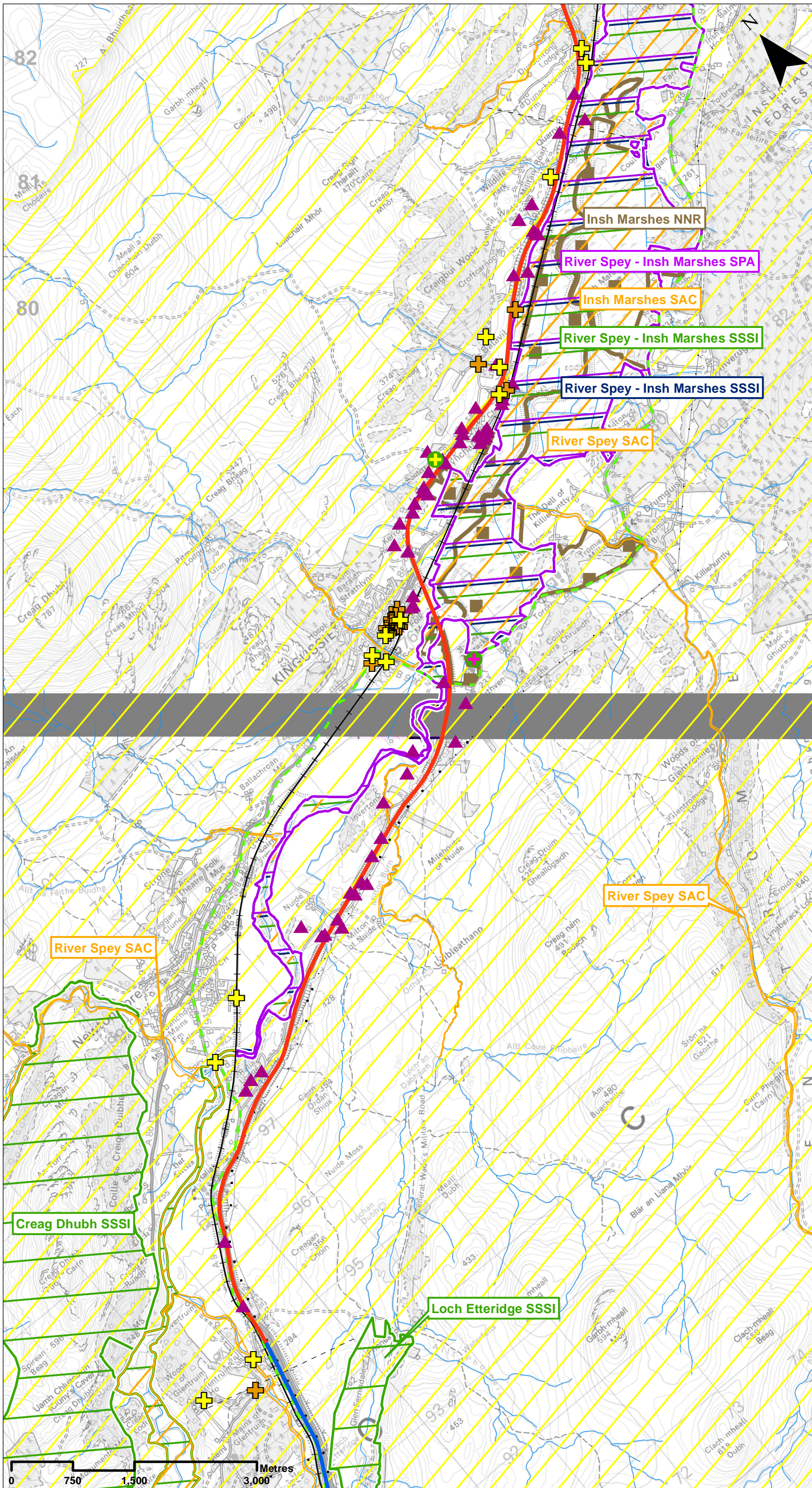

### Legend

- Existing Dualled
- Existing Single
- Proposed Scheme Extents
- Detailed River Network (CEH)
- Special Protection Area (SPA)
- Special Area of Conservation (SAC)
- Site of Special Scientific Interest (SSSI)
- Ramsar
- National Nature Reserve (NNR)
- Cairngorms National Park
- Sustrans NCN Route 7
- Highland Mainline Railway
- Decommissioned Pylon

### Cultural Heritage Assets:

- Scheduled Monument / A Listed Building
- Scheduled Monument
- B Listed Building
- C Listed Building
- Undesignated Cultural Heritage Asset

SCALE 1:400000

P03	S3	JUNE 18	FINAL REVISIONS	EV	JF
P02	S3	MAY 18	DESIGN UPDATE	EV	JF
P01	S3	APR 18	DRAFT FOR COMMENT	EV	JF
REV	SUIT	DATE	DESCRIPTION	BY	APP

**ch2m** **FAIRHURST**

CH2MHILL Fairhurst JV  
 CO: City Park 368 Alexandra Parade Glasgow G31 3AU  
 Tel + 44 (0) 141 552 2000 Fax +44 (0) 141 552 2525







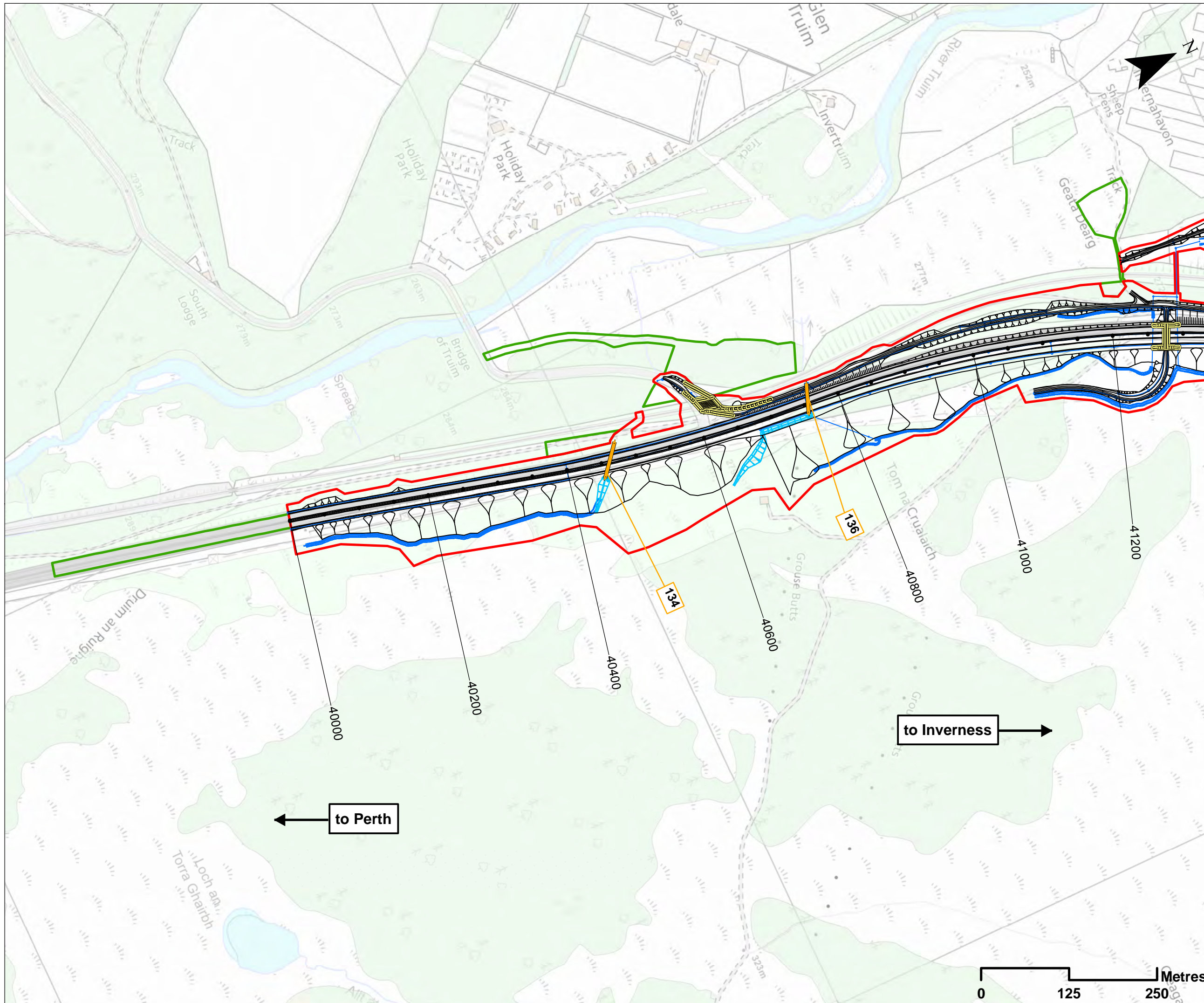

**PROJECT 9 CRUBENMORE TO KINCRAIG EIA  
 BASELINE PLAN  
 DRAWING 5.1  
 ENVIRONMENTAL DESIGNATIONS AND CONSTRAINTS**

DESIGN: MJ	DRAWN: EV	CHK: GG	APP: JF
DATE: 13/07/2018			

PRJ: 495298	DWG: A9P09-CF3-EGN-M_MLZZ_ZZ-DR-EN-0001
SHEET: 1 of 13	SUITABILITY: A3



### Legend

-  Proposed Scheme Details
-  Watercourse Diversions
-  Drainage
-  Proposed Culverts
-  Structures
-  100 Hydro ID
-  Assessment Boundary - Permanent Works
-  Assessment Boundary - Temporary Works

SCALE 1:5000

P03	S3	JUNE 18	FINAL REVISIONS	EV	JF
P02	S3	MAY 18	DESIGN UPDATE	EV	JF
P01	S3	APR 18	DRAFT FOR COMMENT	EV	JF
REV	SUI	DATE	DESCRIPTION	BY	APP

**ch2m: FAIRHURST**

CH2MHILL Fairhurst JV  
 C/O: City Park 368 Alexandra Parade Glasgow G31 3AU  
 Tel + 44 (0) 141 552 2000 Fax +44 (0) 141 552 2525



**PROJECT 9 CRUBENMORE TO KINCRAG EIA  
 PROPOSED SCHEME PLAN  
 DRAWING 5.2  
 chainage 40000 to 41200**

DESIGN: MJ	DRAWN: EV	CHK: GG	APP: JF
---------------	--------------	------------	------------

DATE: 13/07/2018

PROJ: 495298

DWG: A9P09-CFJ-EGN-M\_ML400\_ZZ-DR-EN-0004

SHEET: 2 OF 13	REVISION: C01	SUITABILITY: A3
-------------------	------------------	--------------------

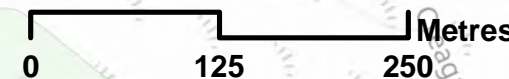

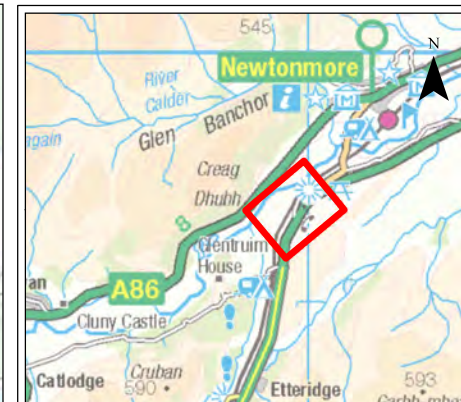
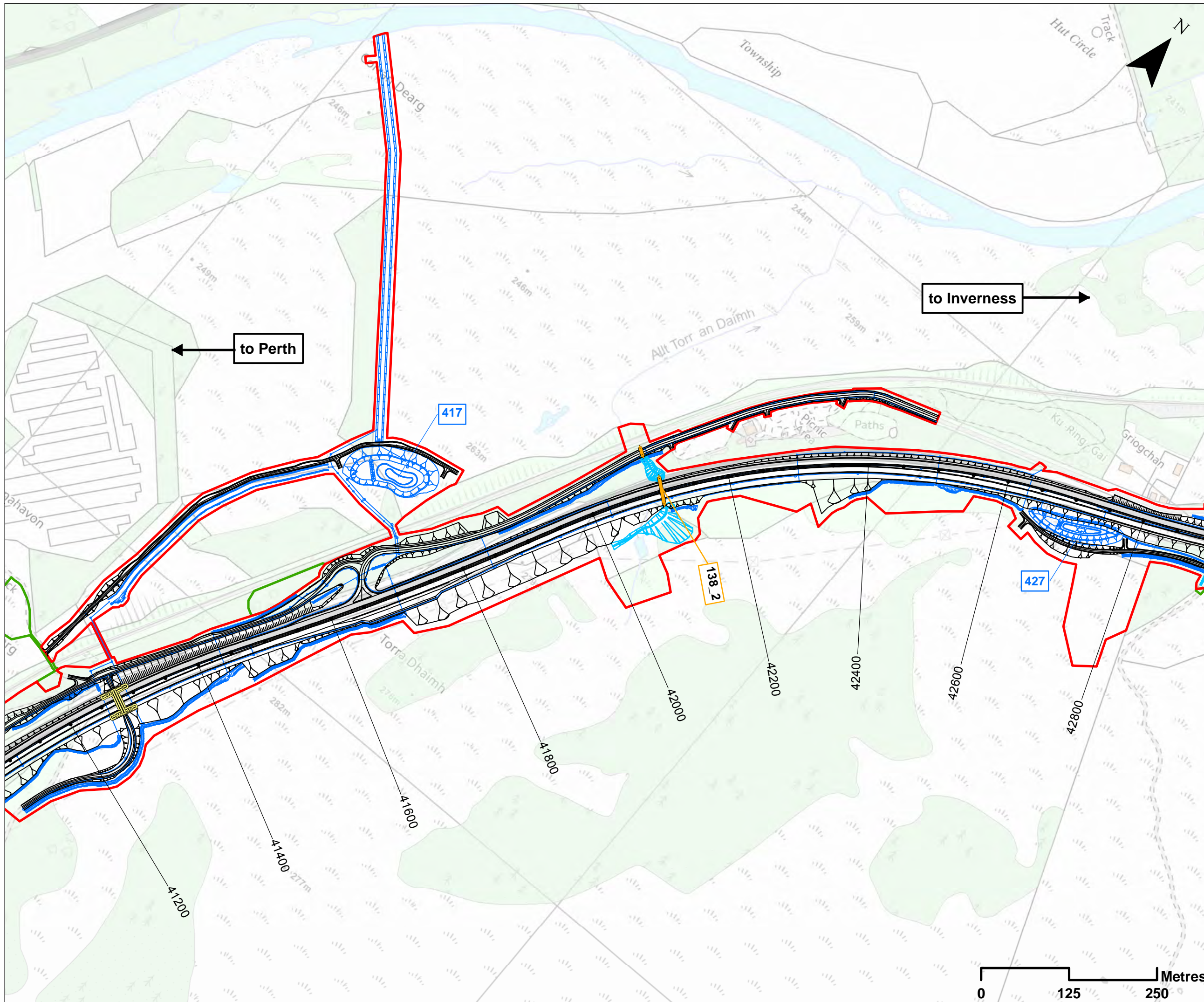

### Legend

- Proposed Scheme Details
- Watercourse Diversions
- Drainage
- Proposed Culverts
- Structures
- 100 Hydro ID
- 400 SuDS ID
- Assessment Boundary - Permanent Works
- Assessment Boundary - Temporary Works

SCALE 1:5000

P03	S3	JUNE 18	FINAL REVISIONS	EV	JF
P02	S3	MAY 18	DESIGN UPDATE	EV	JF
P01	S3	APR 18	DRAFT FOR COMMENT	EV	JF
REV	SUIT	DATE	DESCRIPTION	BY	APP

**ch2m. FAIRHURST**

CH2MHILL Fairhurst JV  
 C/O: City Park 368 Alexandra Parade Glasgow G31 3AU  
 Tel + 44 (0) 141 552 2000 Fax +44 (0) 141 552 2525



**PROJECT 9 CRUBENMORE TO KINRAIG EIA  
 PROPOSED SCHEME PLAN  
 DRAWING 5.3  
 chainage 41200 to 42800**

DESIGN: MJ	DRAWN: EV	CHK: GG	APP: JF
---------------	--------------	------------	------------

DATE: 13/07/2018

PROJ: 495298

DWG: A9P09-CFJ-EGN-M\_ML412\_ZZ-DR-EN-0001

SHEET: 3 OF 13	REVISION: C01	SUITABILITY: A3
-------------------	------------------	--------------------

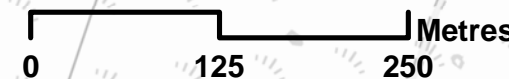

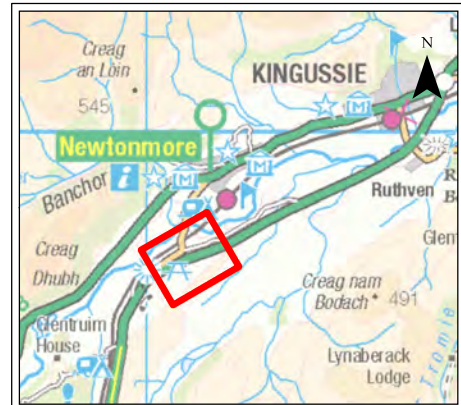
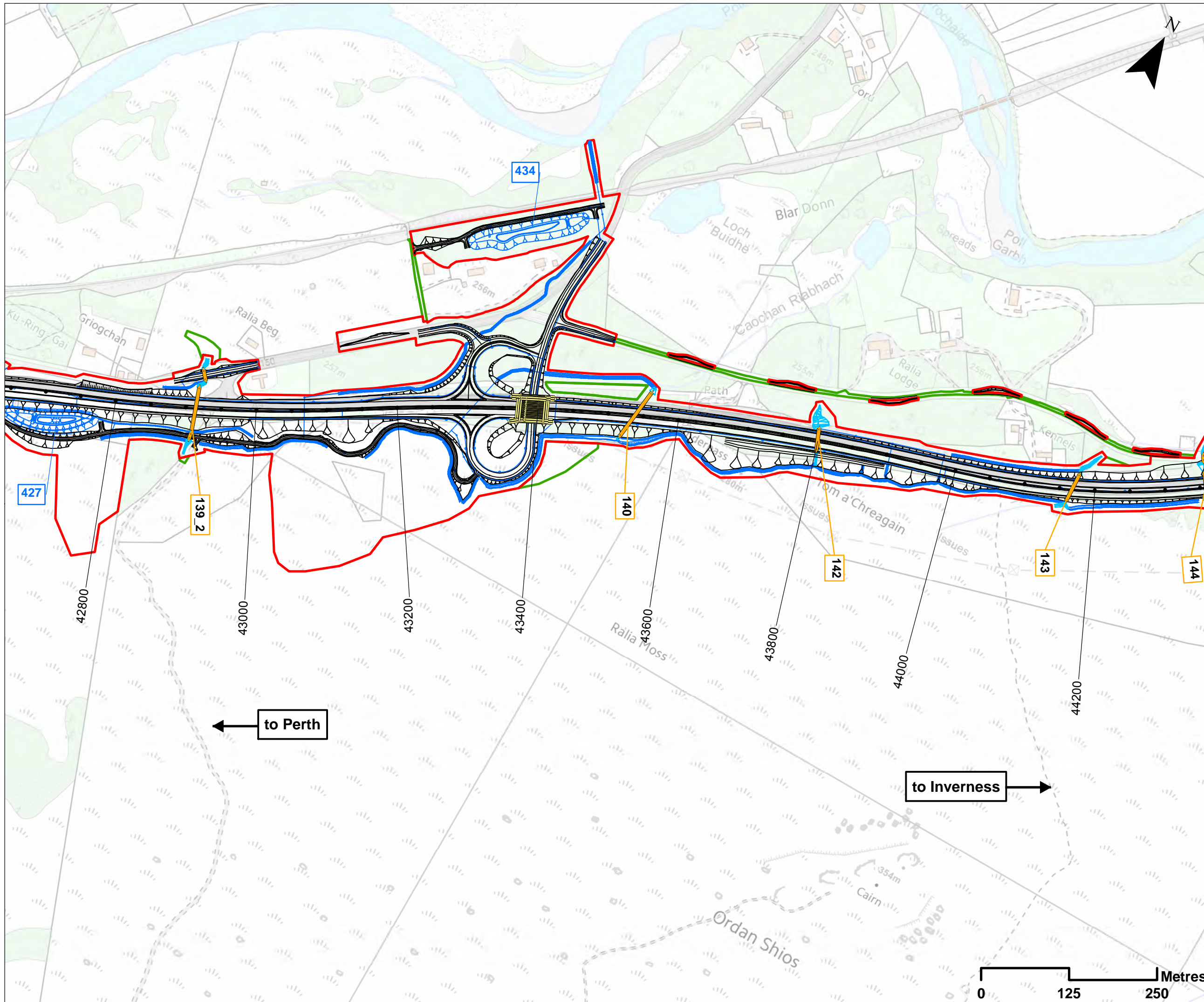

### Legend

- Proposed Scheme Details
- Watercourse Diversions
- Drainage
- Proposed Culverts
- Structures
- 100 Hydro ID
- 400 SuDS ID
- Assessment Boundary - Permanent Works
- Assessment Boundary - Temporary Works

SCALE 1:5000

P03	S3	JUNE 18	FINAL REVISIONS	EV	JF
P02	S3	MAY 18	DESIGN UPDATE	EV	JF
P01	S3	APR 18	DRAFT FOR COMMENT	EV	JF
REV	SUI	DATE	DESCRIPTION	BY	APP



CH2MHILL Fairhurst JV  
 C/O: City Park 368 Alexandra Parade Glasgow G31 3AU  
 Tel + 44 (0) 141 552 2000 Fax +44 (0) 141 552 2525



**PROJECT 9 CRUBENMORE TO KINRAIG EIA  
 PROPOSED SCHEME PLAN  
 DRAWING 5.4  
 chainage 42800 to 44200**

DESIGN: MJ	DRAWN: EV	CHK: GG	APP: JF
---------------	--------------	------------	------------

DATE: 13/07/2018  
 PROJ: 495298

DWG: A9P09-CFJ-EGN-M\_ML428\_ZZ-DR-EN-0001

SHEET: 4 OF 13	REVISION: C01	SUITABILITY: A3
-------------------	------------------	--------------------

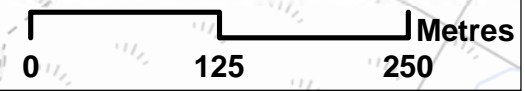

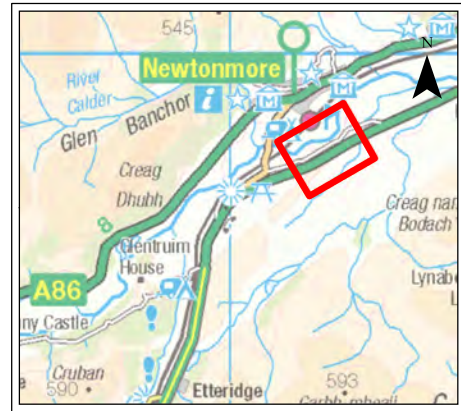
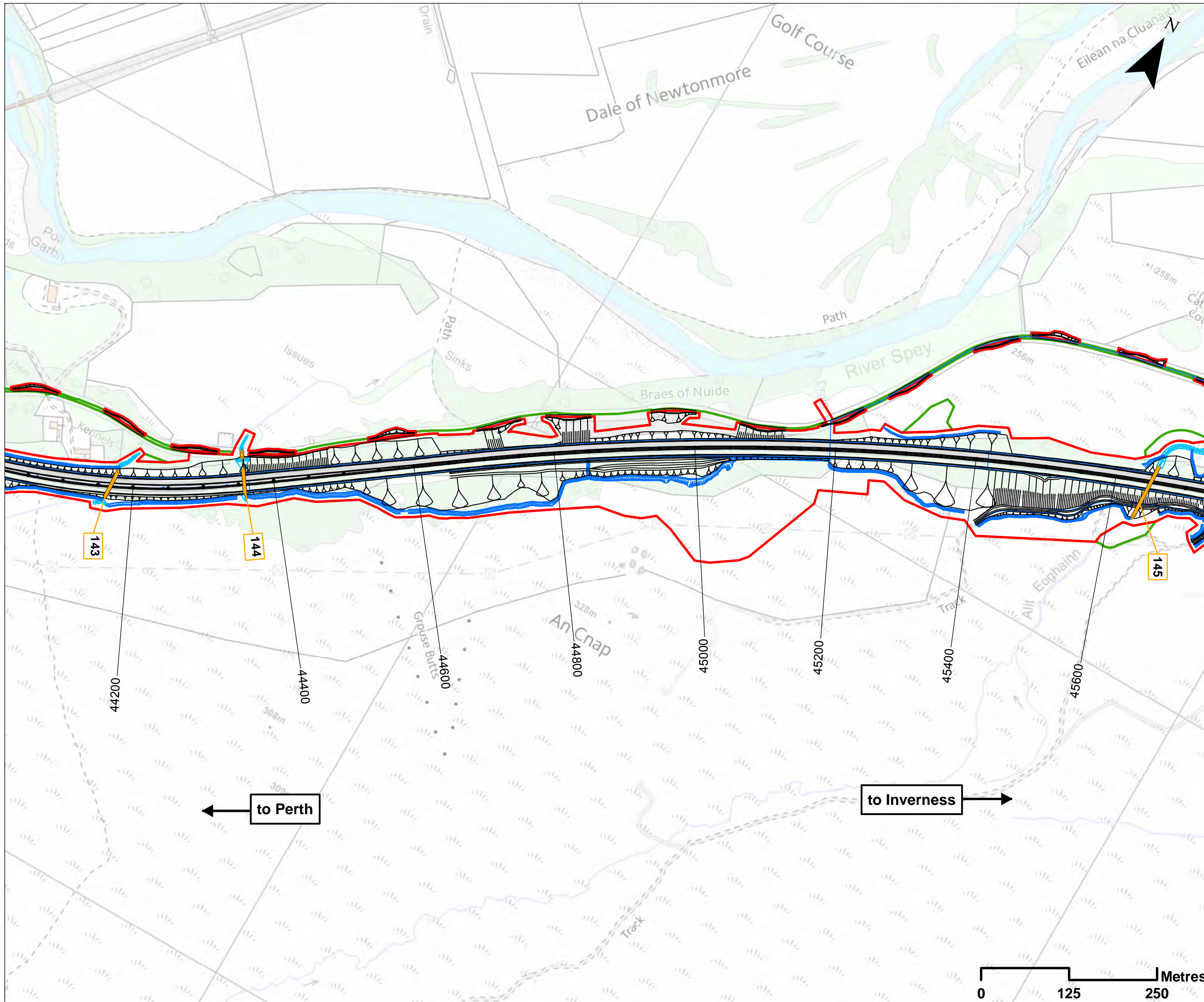

### Legend

- Proposed Scheme Details
- Watercourse Diversions
- Drainage
- Proposed Culverts
- Hydro ID
- Assessment Boundary - Permanent Works
- Assessment Boundary - Temporary Works

SCALE 1:5000

P03	S3	JUNE 18	FINAL REVISIONS	EV	JF
P02	S3	MAY 18	DESIGN UPDATE	EV	JF
P01	S3	APR 18	DRAFT FOR COMMENT	EV	JF
REV	SUIT	DATE	DESCRIPTION	BY	APP



CH2MHILL Fairhurst JV  
 C/O: City Park 368 Alexandra Parade Glasgow G31 3AU  
 Tel + 44 (0) 141 552 2000 Fax +44 (0) 141 552 2525



**PROJECT 9 CRUBENMORE TO KINCRAIG EIA  
 PROPOSED SCHEME PLAN  
 DRAWING 5.5  
 chainage 44200 to 45600**

DESIGN: MJ	DRAWN: EV	CHK: GG	APP: JF
---------------	--------------	------------	------------

DATE: 13/07/2018  
 PROJ: 495298

DWG: A9P09-CFJ-EGN-M\_ML442\_ZZ-DR-EN-0001

SHEET: 5 OF 13	REVISION: C01	SUITABILITY: A3
-------------------	------------------	--------------------

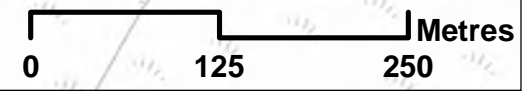

Document Path: \\g:\p09\Geospatial\Projects\A9\_Dualling\_ML442\_ZZ-DR-EN-0001\Drawings\5.5\_V2.mxd

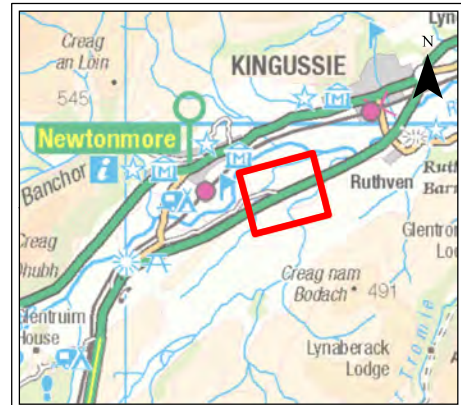
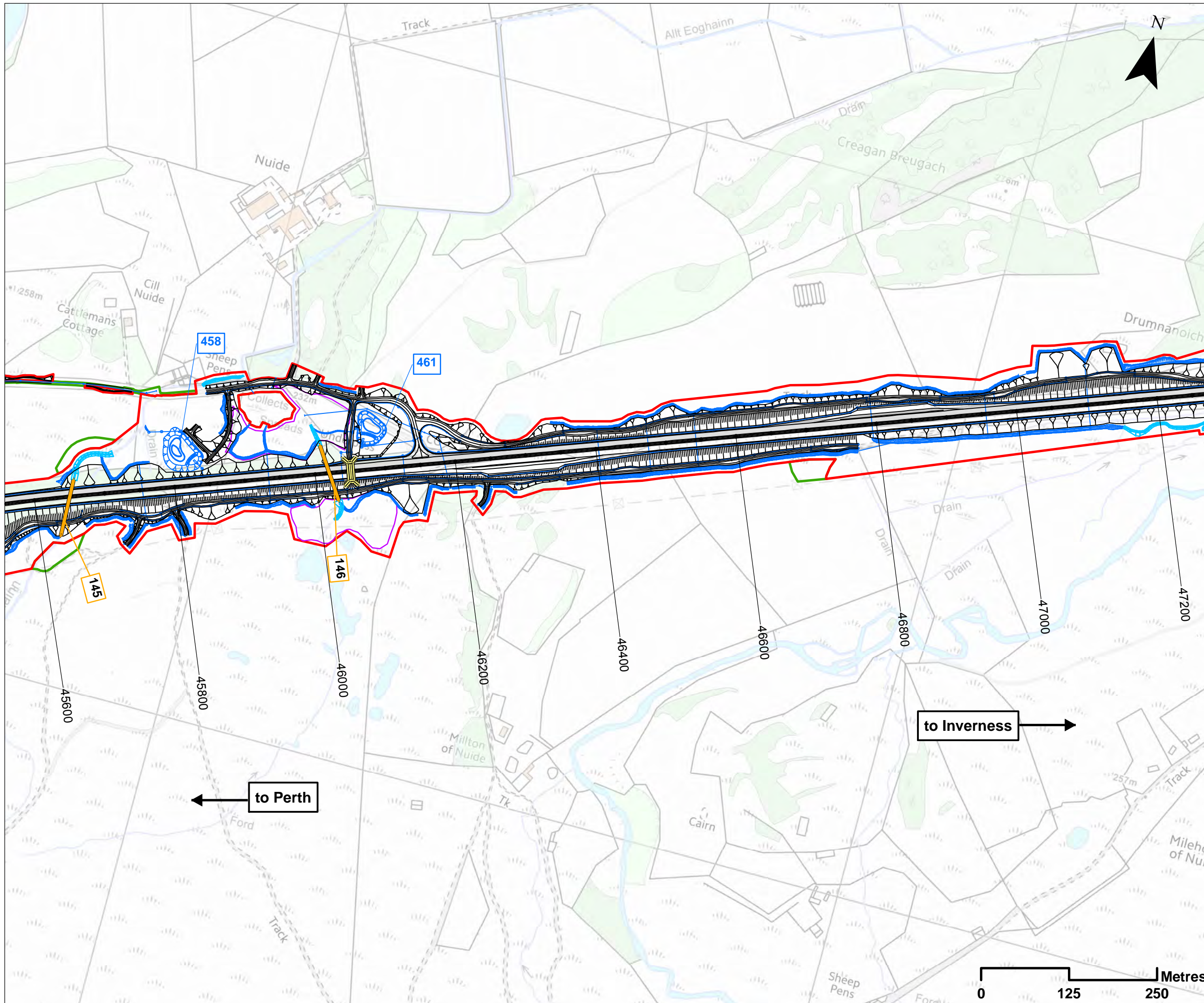

### Legend

- Proposed Scheme Details
- Watercourse Diversions
- Drainage
- Proposed Culverts
- Structures
- 100 Hydro ID
- 400 SuDS ID
- Compensatory Storage Area
- Assessment Boundary - Permanent Works
- Assessment Boundary - Temporary Works

**SCALE 1:5000**

P03	S3	JUNE 18	FINAL REVISIONS	EV	JF
P02	S3	MAY 18	DESIGN UPDATE	EV	JF
P01	S3	APR 18	DRAFT FOR COMMENT	EV	JF
REV	SUI	DATE	DESCRIPTION	BY	APP

**ch2m: FAIRHURST**  
 CH2MHILL Fairhurst JV  
 C/O: City Park 368 Alexandra Parade Glasgow G31 3AU  
 Tel + 44 (0) 141 552 2000 Fax +44 (0) 141 552 2525



**PROJECT 9 CRUBENMORE TO KINCRAIG EIA  
 PROPOSED SCHEME PLAN  
 DRAWING 5.6  
 chainage 45600 to 47200**

DESIGN: MJ	DRAWN: EV	CHK: GG	APP: JF
DATE: 19/07/2018			
PROJ: 495298			
DWG: A9P09-CFJ-EGN-M_ML456_ZZ-DR-EN-0004			
SHEET: 6 OF 13	REVISION: C01	SUITABILITY: A3	

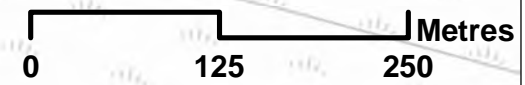

Document Path: \\[filepath]Geospatial\Projects\A9\_Dualling\Misc\DR\Chapter\_05\_Proposed\_Scheme\05000DRAWING\_5\_6\_V2.mxd

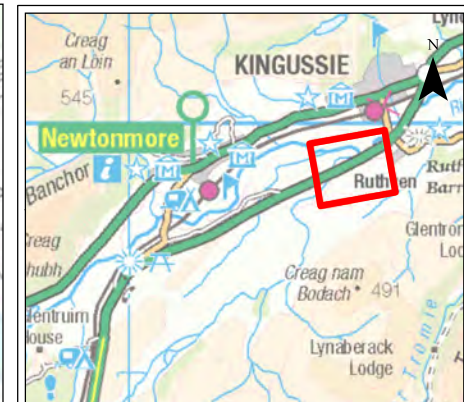
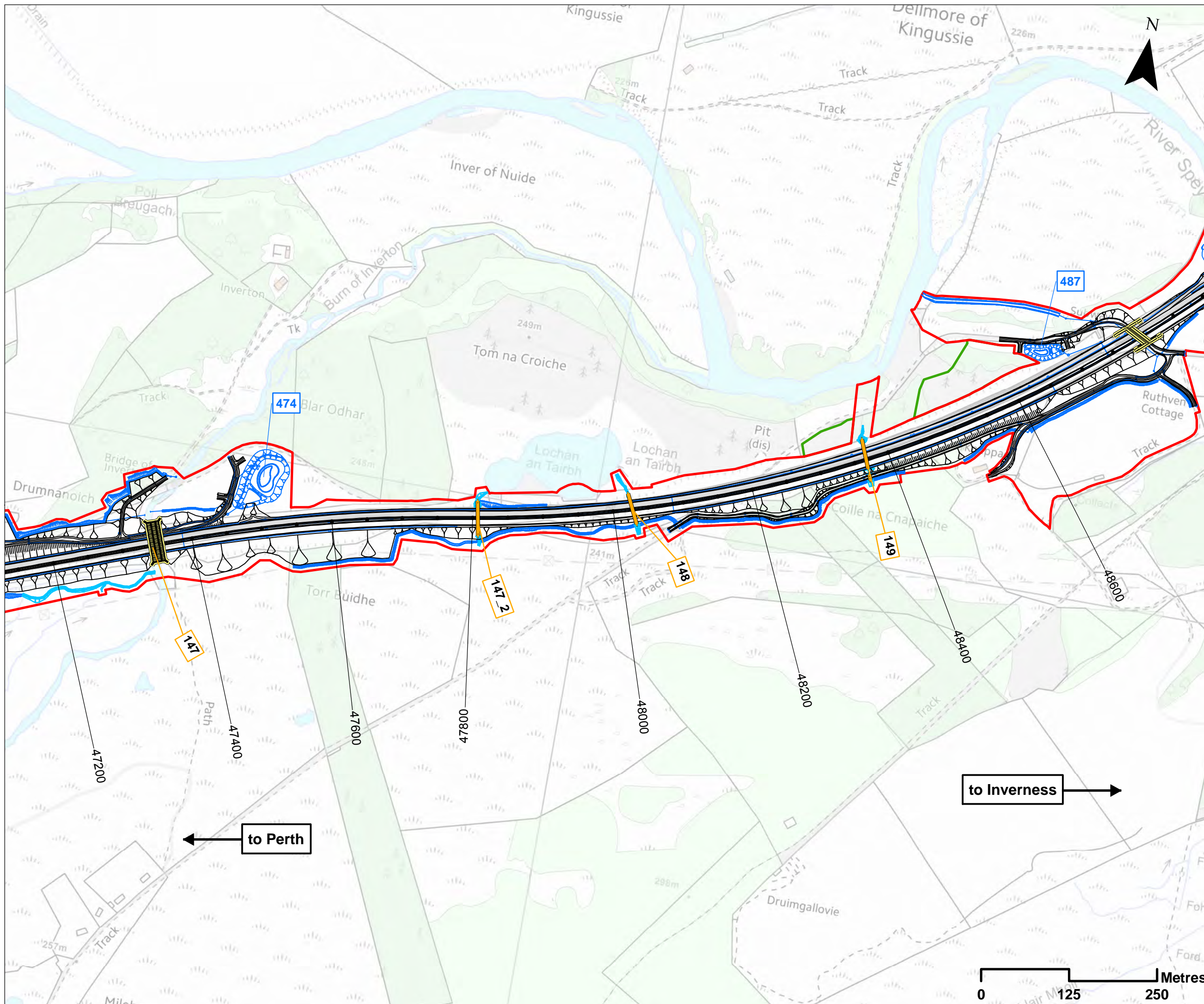

### Legend

- Proposed Scheme Details
- Watercourse Diversions
- Drainage
- Proposed Culverts
- Structures
- 100 Hydro ID
- 400 SuDS ID
- Assessment Boundary - Permanent Works
- Assessment Boundary - Temporary Works

SCALE 1:5000

P03	S3	JUNE 18	FINAL REVISIONS	EV	JF
P02	S3	MAY 18	DESIGN UPDATE	EV	JF
P01	S3	APR 18	DRAFT FOR COMMENT	EV	JF
REV	SUIT	DATE	DESCRIPTION	BY	APP

**ch2m: FAIRHURST**

CH2MHILL Fairhurst JV  
 C/O: City Park 368 Alexandra Parade Glasgow G31 3AU  
 Tel + 44 (0) 141 552 2000 Fax +44 (0) 141 552 2525



**PROJECT 9 CRUBENMORE TO KINCRAG EIA  
 PROPOSED SCHEME PLAN  
 DRAWING 5.7  
 chainage 47200 to 48600**

DESIGN: MJ	DRAWN: EV	CHK: GG	APP: JF
---------------	--------------	------------	------------

DATE: 13/07/2018

PROJ: 495298

DWG: A9P09-CFJ-EGN-M\_ML472\_ZZ-DR-EN-0003

SHEET: 7 OF 13	REVISION: C01	SUITABILITY: A3
-------------------	------------------	--------------------

to Inverness →

← to Perth

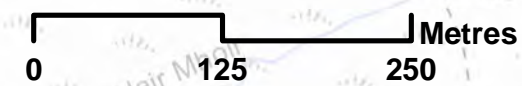



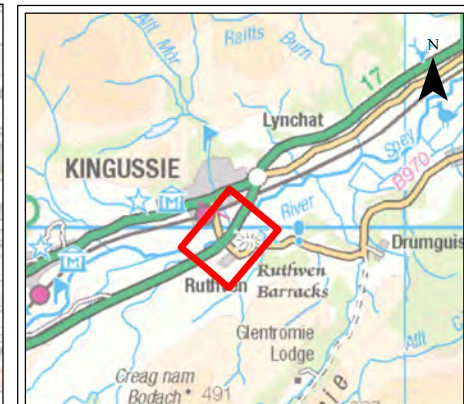
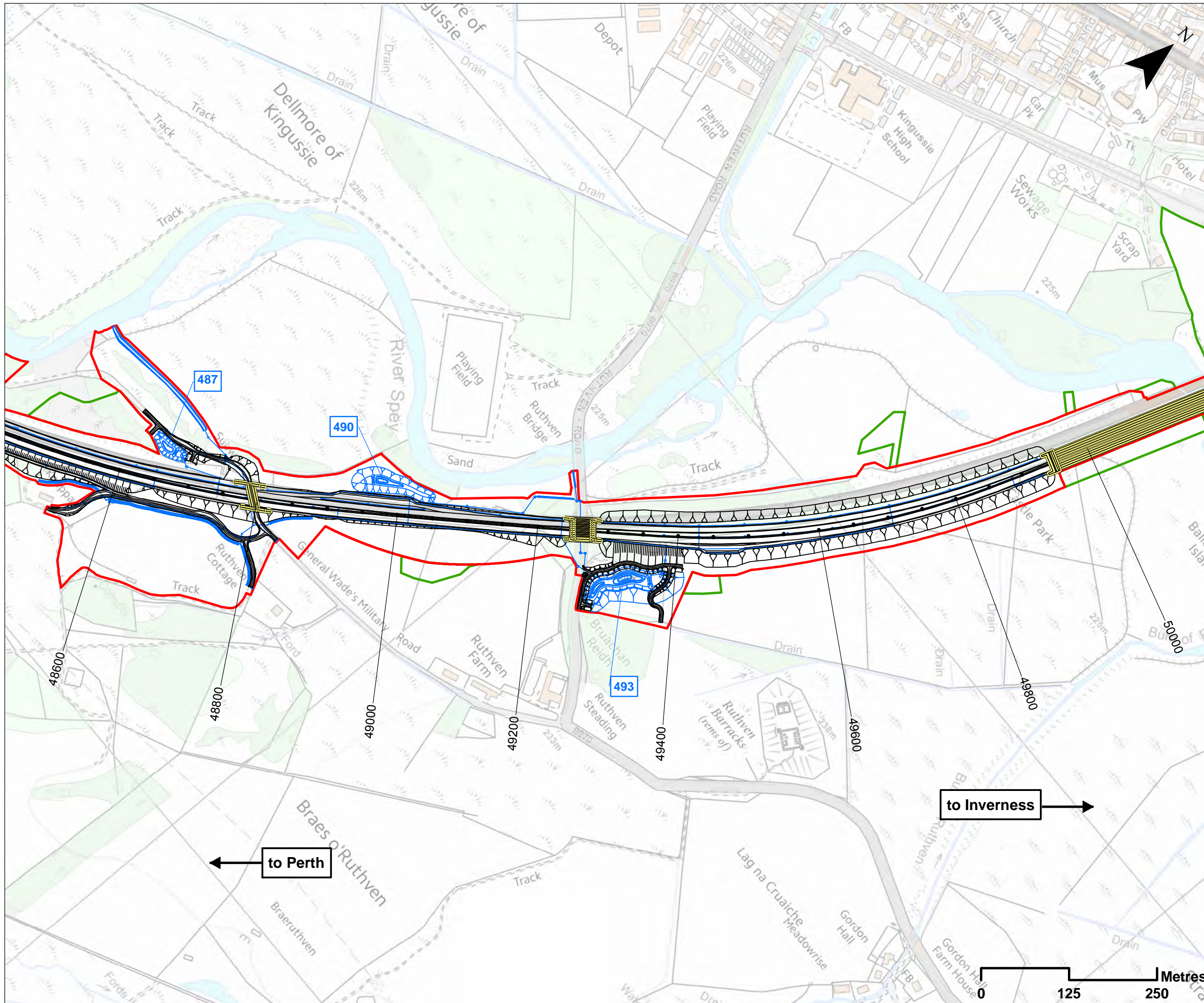

### Legend

- Proposed Scheme Details
- Drainage
- Structures
- SuDS ID
- Assessment Boundary - Permanent Works
- Assessment Boundary - Temporary Works

SCALE 1:5000

P03	S3	JUNE 18	FINAL REVISIONS	EV	JF
P02	S3	MAY 18	DESIGN UPDATE	EV	JF
P01	S3	APR 18	DRAFT FOR COMMENT	EV	JF
REV	SUI	DATE	DESCRIPTION	BY	APP



CH2MHILL Fairhurst JV  
 C/O: City Park 368 Alexandra Parade Glasgow G31 3AU  
 Tel + 44 (0) 141 552 2000 Fax +44 (0) 141 552 2525



**PROJECT 9 CRUBENMORE TO KINRAIG EIA  
 PROPOSED SCHEME PLAN  
 DRAWING 5.8  
 chainage 48600 to 50000**

DESIGN: MJ	DRAWN: EV	CHK: GG	APP: JF
---------------	--------------	------------	------------

DATE: 13/07/2018

PROJ: 495298

DWG: A9P09-CFJ-EGN-M\_ZZ486\_ZZ-DR-EN-0001

SHEET: 8 OF 13	REVISION: C01	SUITABILITY: A3
-------------------	------------------	--------------------

to Inverness →

← to Perth

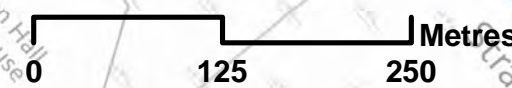

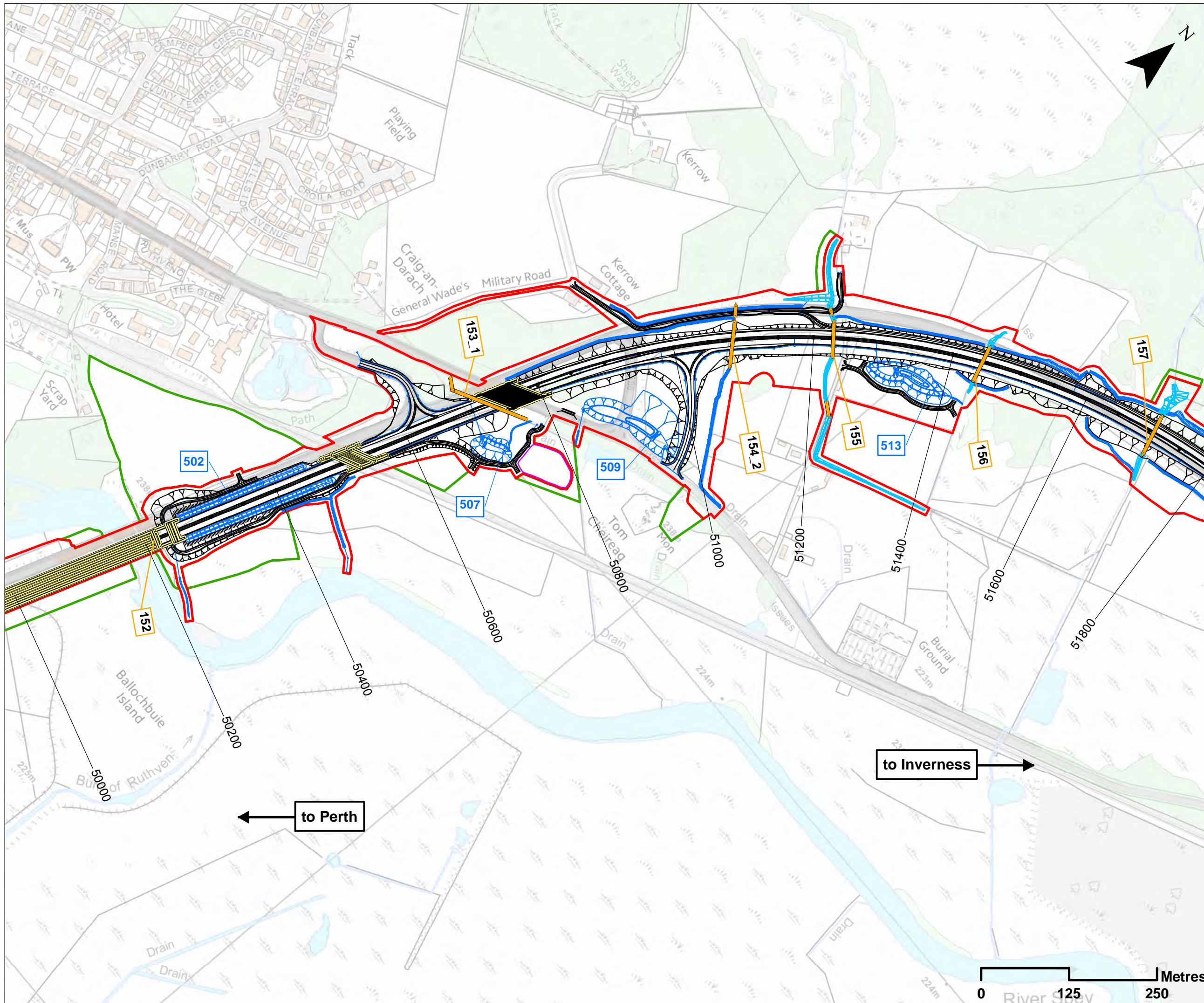

### Legend

- Proposed Scheme Details
- Watercourse Diversions
- Drainage
- Proposed Culverts
- Structures
- 100 Hydro ID
- 400 SuDS ID
- Compensatory Storage Area
- Assessment Boundary - Permanent Works
- Assessment Boundary - Temporary Works

SCALE 1:5000

P03	S3	JUNE 18	FINAL REVISIONS	EV	JF
P02	S3	MAY 18	DESIGN UPDATE	EV	JF
P01	S3	APR 18	DRAFT FOR COMMENT	EV	JF
REV	SUIT	DATE	DESCRIPTION	BY	APP



CH2MHILL Fairhurst JV  
 C/O: City Park 368 Alexandra Parade Glasgow G31 3AU  
 Tel + 44 (0) 141 552 2000 Fax +44 (0) 141 552 2525



**PROJECT 9 CRUBENMORE TO KINCRAIG EIA  
 PROPOSED SCHEME PLAN  
 DRAWING 5.9  
 chainage 50000 to 51800**

DESIGN: MJ	DRAWN: EV	CHK: GG	APP: JF
---------------	--------------	------------	------------

DATE: 13/07/2018

PROJ: 495298

DWG: A9P09-CFJ-EGN-M\_ML500\_ZZ-DR-EN-0001

SHEET: 9 OF 13	REVISION: C01	SUITABILITY: A3
-------------------	------------------	--------------------

to Inverness →

← to Perth

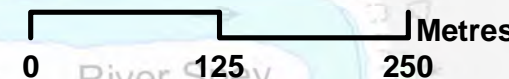

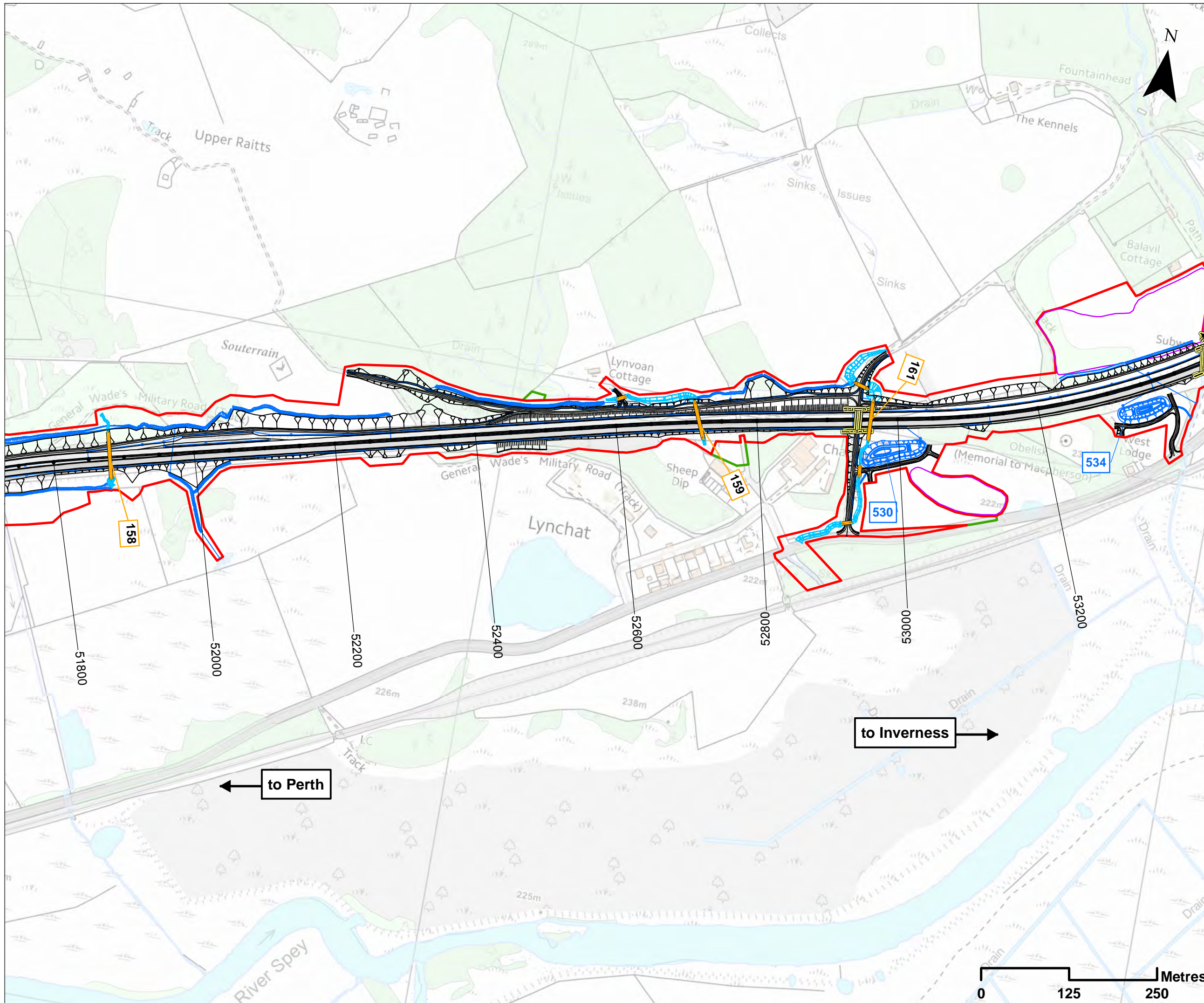

### Legend

- Proposed Scheme Details
- Watercourse Diversions
- Drainage
- Proposed Culverts
- Structures
- 100 Hydro ID
- 400 SuDS ID
- Compensatory Storage Area
- Assessment Boundary - Permanent Works
- Assessment Boundary - Temporary Works

SCALE 1:5000

P03	S3	JUNE 18	FINAL REVISIONS	EV	JF
P02	S3	MAY 18	DESIGN UPDATE	EV	JF
P01	S3	APR 18	DRAFT FOR COMMENT	EV	JF
REV	SUI	DATE	DESCRIPTION	BY	APP



CH2MHILL Fairhurst JV  
 C/O: City Park 368 Alexandra Parade Glasgow G31 3AU  
 Tel + 44 (0) 141 552 2000 Fax +44 (0) 141 552 2525



**PROJECT 9 CRUBENMORE TO KINCAIG EIA  
 PROPOSED SCHEME PLAN  
 DRAWING 5.10  
 chainage 51800 to 53200**

DESIGN: MJ	DRAWN: EV	CHK: GG	APP: JF
---------------	--------------	------------	------------

DATE: 09/08/2018

PROJ: 495298

DWG: A9P09-CFJ-EGN-M\_ML518\_ZZ-DR-EN-0005

SHEET: 10 OF 13	REVISION: C01	SUITABILITY: A3
--------------------	------------------	--------------------

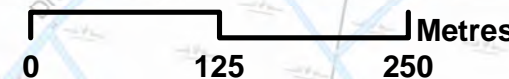

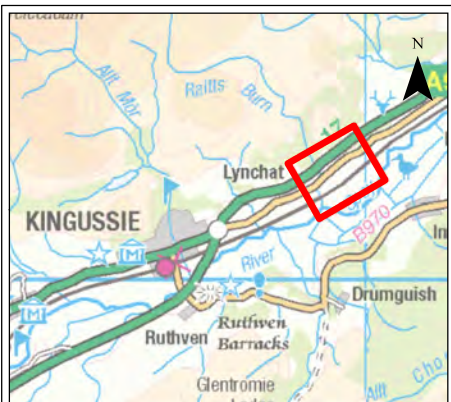
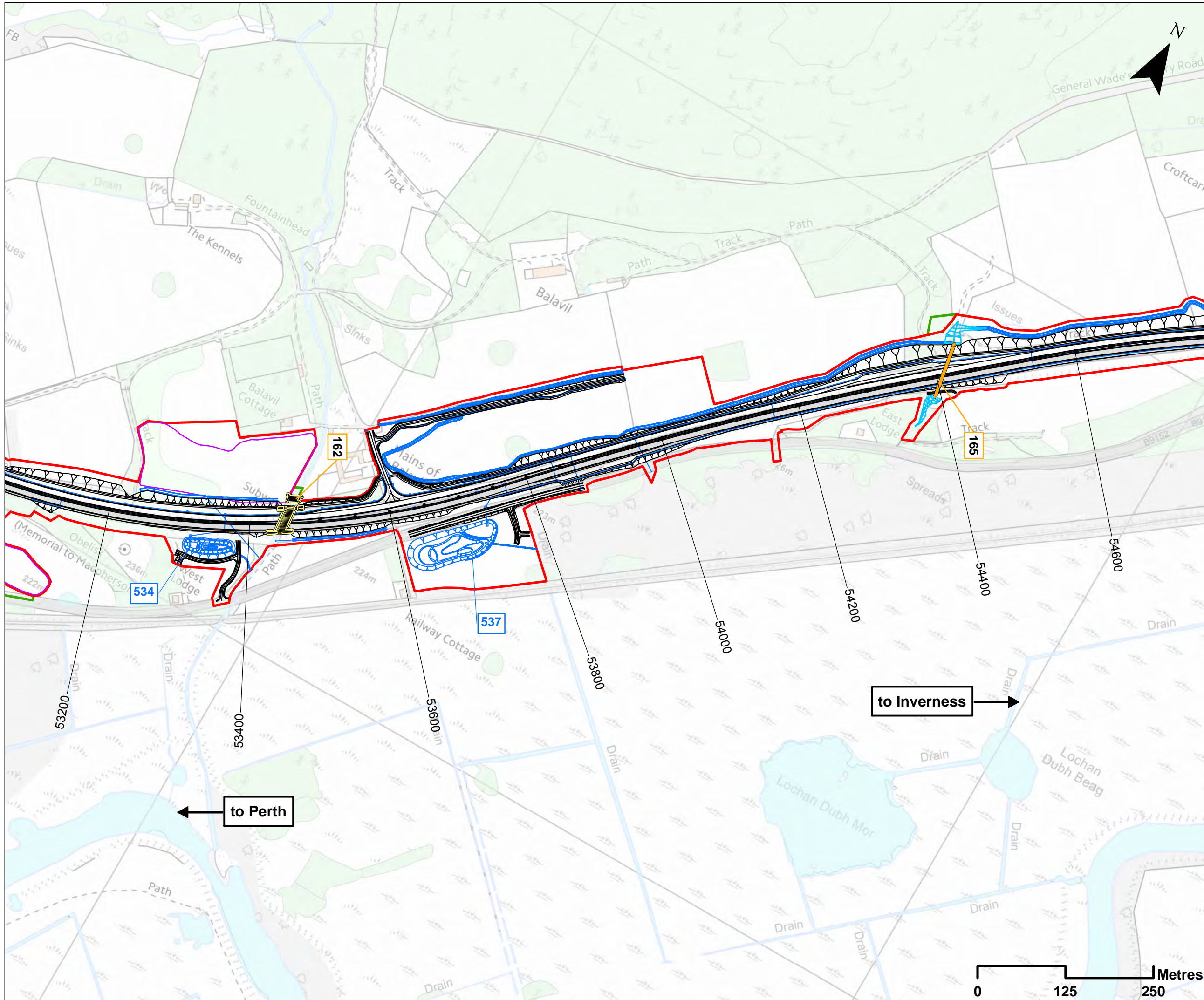

**Legend**

- Proposed Scheme Details
- Watercourse Diversions
- Drainage
- Proposed Culverts
- Structures
- Hydro ID
- SuDS ID
- Compensatory Storage Area
- Assessment Boundary - Permanent Works
- Assessment Boundary - Temporary Works

SCALE 1:5000						
P03	S3	JUNE 18	FINAL REVISIONS	EV	JF	
P02	S3	MAY 18	DESIGN UPDATE	EV	JF	
P01	S3	APR 18	DRAFT FOR COMMENT	EV	JF	
REV	SUIT	DATE	DESCRIPTION	BY	APP	

**ch2m: FAIRHURST**  
 CH2MHILL Fairhurst JV  
 C/O: City Park 368 Alexandra Parade Glasgow G31 3AU  
 Tel + 44 (0) 141 552 2000 Fax +44 (0) 141 552 2525



**PROJECT 9 CRUBENMORE TO KINRAIG EIA  
 PROPOSED SCHEME PLAN  
 DRAWING 5.11  
 chainage 53200 to 54600**

DESIGN: MJ	DRAWN: EV	CHK: GG	APP: JF
---------------	--------------	------------	------------

DATE: 13/07/2018

PROJ: 495298







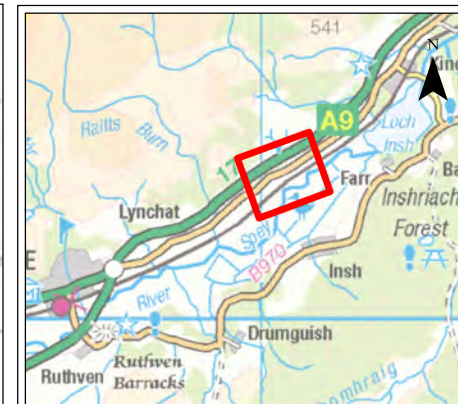
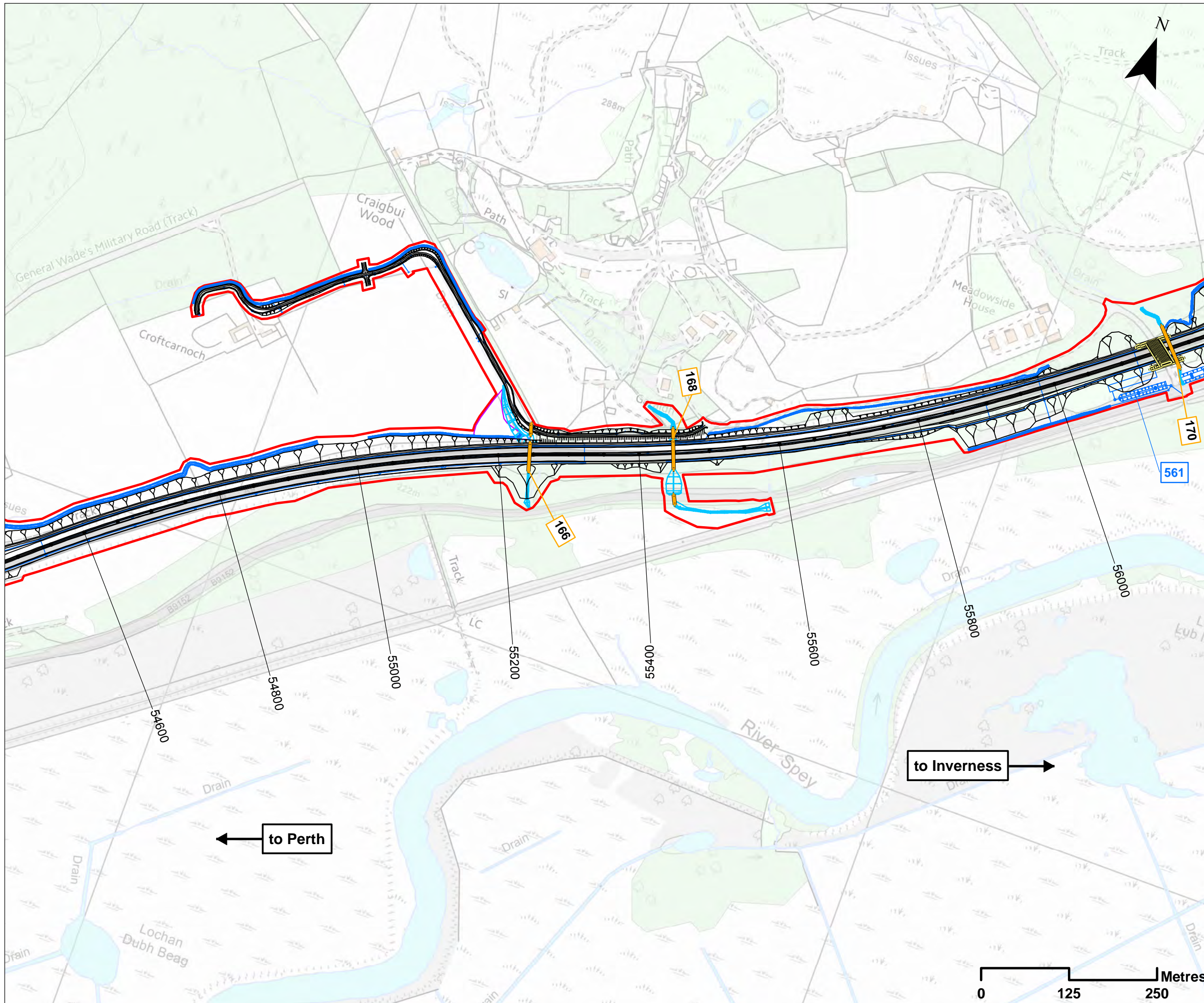

DWG: A9P09-CFJ-EGN-M\_ML532-ZZ-DR-EN-0003

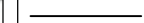
SHEET: 11 OF 13	REVISION: C01	SUITABILITY: A3
--------------------	------------------	--------------------

Document Path: \\g:\p09\Cross-sectional\Project\A9\_Dualling\GIS\DRM\3\4\_2\_ML532\_ZZ-DR-EN-0003.DWG; Chapter: 05\_Progress: Schemes\0000\DRAWING\_5\_11\_V2.mxd

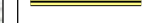

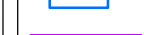
**Legend**

-  Proposed Scheme Details
-  Watercourse Diversions
-  Drainage
-  Proposed Culverts
-  Structures
-  Hydro ID
-  SuDS ID
-  Compensatory Storage Area
-  Assessment Boundary - Permanent Works

SCALE 1:5000

P03	S3	JUNE 18	FINAL REVISIONS	EV	JF
P02	S3	MAY 18	DESIGN UPDATE	EV	JF
P01	S3	APR 18	DRAFT FOR COMMENT	EV	JF
REV	SUI	DATE	DESCRIPTION	BY	APP

**ch2m FAIRHURST**

CH2MHILL Fairhurst JV  
 C/O: City Park 368 Alexandra Parade Glasgow G31 3AU  
 Tel + 44 (0) 141 552 2000 Fax +44 (0) 141 552 2525



**PROJECT 9 CRUBENMORE TO KINCRAG EIA  
 PROPOSED SCHEME PLAN  
 DRAWING 5.12  
 chainage 54600 to 56000**

DESIGN: MJ	DRAWN: EV	CHK: GG	APP: JF
---------------	--------------	------------	------------

DATE: 13/07/2018

PROJ: 495298





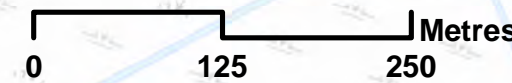

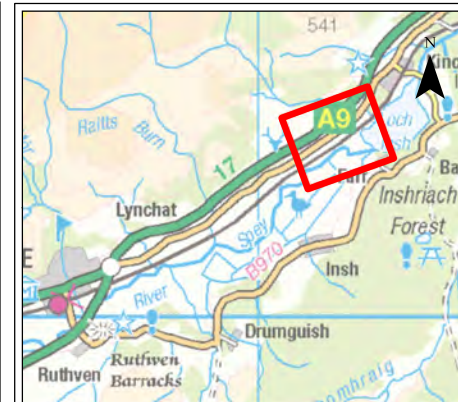
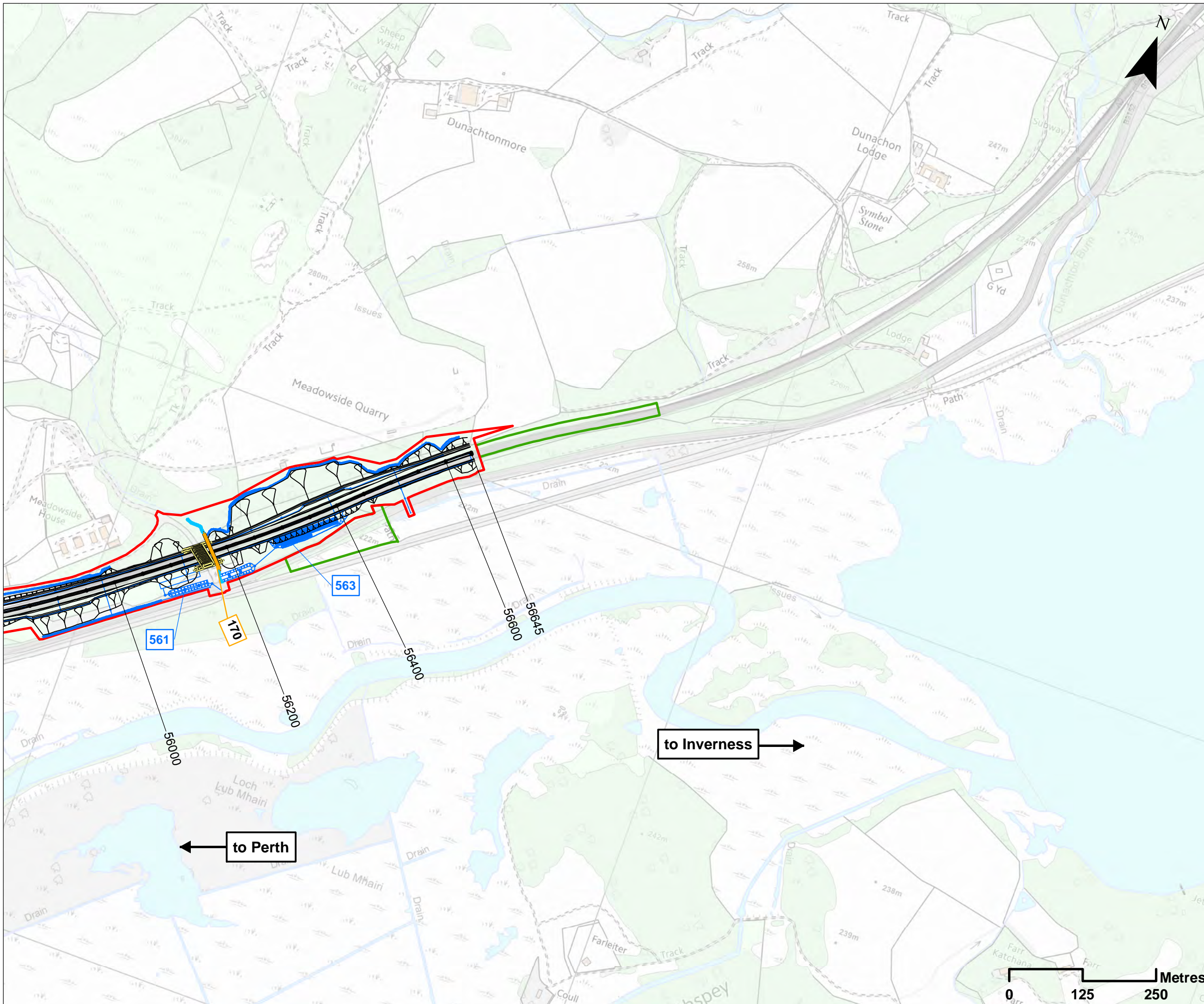

DWG: A9P09-CFJ-EGN-M\_ML546\_ZZ-DR-EN-0003

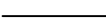
SHEET: 12 OF 13	REVISION: C01	SUITABILITY: A3
--------------------	------------------	--------------------



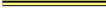

### Legend

-  Proposed Scheme Details
-  Watercourse Diversions
-  Drainage
-  Proposed Culverts
-  Structures
-  Hydro ID
-  SuDS ID
-  Assessment Boundary - Permanent Works
-  Assessment Boundary - Temporary Works

SCALE 1:6000

P03	S3	JUNE 18	FINAL REVISIONS	EV	JF
P02	S3	MAY 18	DESIGN UPDATE	EV	JF
P01	S3	APR 18	DRAFT FOR COMMENT	EV	JF
REV	SUIT	DATE	DESCRIPTION	BY	APP



CH2MHILL Fairhurst JV  
 C/O: City Park 368 Alexandra Parade Glasgow G31 3AU  
 Tel + 44 (0) 141 552 2000 Fax +44 (0) 141 552 2525



**PROJECT 9 CRUBENMORE TO KINCRAIG EIA**  
**PROPOSED SCHEME PLAN**  
**DRAWING 5.13**  
**chainage 56000 to 56645**

DESIGN: MJ	DRAWN: EV	CHK: GG	APP: JF
---------------	--------------	------------	------------

DATE: 13/07/2018

PROJ: 495298

DWG: A9P09-CFJ-EGN-M\_ML560\_ZZ-DR-EN-0001

SHEET: 13 OF 13	REVISION: C01	SUITABILITY: A3
--------------------	------------------	--------------------

