

## Ecology and Nature Conservation Part 3

Drawing No.	Drawing Type	Drawing Title	Projectwise Drawing Reference	Software
12.61	ASSESSMENT PLAN	ASSESSMENT FOR GREAT CRESTED NEWT chainage 44800 to 48000	A9P09-CFJ-EBD-M_ML448_ZZ-DR-EN-0001	GIS
12.62	ASSESSMENT PLAN	ASSESSMENT FOR GREAT CRESTED NEWT chainage 48000 to 51200	A9P09-CFJ-EBD-M_ML480_ZZ-DR-EN-0001	GIS
12.63	ASSESSMENT PLAN	ASSESSMENT FOR GREAT CRESTED NEWT chainage 51200 to 54400	A9P09-CFJ-EBD-M_ML512_ZZ-DR-EN-0002	GIS
12.64	ASSESSMENT PLAN	ASSESSMENT FOR GREAT CRESTED NEWT chainage 54400 to 56645	A9P09-CFJ-EBD-M_ML544_ZZ-DR-EN-0002	GIS
12.65	ASSESSMENT PLAN	ECOLOGY NOISE MODELLING LOCATIONS chainage 40000 to 42200	A9P09-CFJ-EBD-M_ML400_ZZ-DR-EN-0006	GIS
12.66	ASSESSMENT PLAN	ECOLOGY NOISE MODELLING LOCATIONS chainage 42400 to 45600	A9P09-CFJ-EBD-M_ML424_ZZ-DR-EN-0003	GIS
12.67	ASSESSMENT PLAN	ECOLOGY NOISE MODELLING LOCATIONS chainage 45600 to 48600	A9P09-CFJ-EBD-M_ML456_ZZ-DR-EN-0006	GIS
12.68	ASSESSMENT PLAN	ECOLOGY NOISE MODELLING LOCATIONS chainage 48600 to 51800	A9P09-CFJ-EBD-M_ML486_ZZ-DR-EN-0006	GIS
12.69	ASSESSMENT PLAN	ECOLOGY NOISE MODELLING LOCATIONS chainage 51800 to 55000	A9P09-CFJ-EBD-M_ML518_ZZ-DR-EN-0006	GIS
12.70	ASSESSMENT PLAN	ECOLOGY NOISE MODELLING LOCATIONS chainage 55000 to 55645	A9P09-CFJ-EBD-M_ML550_ZZ-DR-EN-0003	GIS
12.71	ASSESSMENT PLAN	ECOLOGY MITIGATION (MAMMAL) chainage 40000 to 41200	A9P09-CFJ-EBD-M_ML400_ZZ-DR-EN-0008	GIS
12.72	ASSESSMENT PLAN	ECOLOGY MITIGATION (MAMMAL) chainage 41200 to 42800	A9P09-CFJ-EBD-M_ML412_ZZ-DR-EN-0004	GIS
12.73	ASSESSMENT PLAN	ECOLOGY MITIGATION (MAMMAL) chainage 42800 to 44200	A9P09-CFJ-EBD-M_ML428_ZZ-DR-EN-0004	GIS
12.74	ASSESSMENT PLAN	ECOLOGY MITIGATION (MAMMAL) chainage 44200 to 45600	A9P09-CFJ-EBD-M_ML442_ZZ-DR-EN-0004	GIS
12.75	ASSESSMENT PLAN	ECOLOGY MITIGATION (MAMMAL) chainage 45600 to 47200	A9P09-CFJ-EBD-M_ML456_ZZ-DR-EN-0007	GIS
12.76	ASSESSMENT PLAN	ECOLOGY MITIGATION (MAMMAL) chainage 47200 to 48600	A9P09-CFJ-EBD-M_ML472_ZZ-DR-EN-0004	GIS
12.77	ASSESSMENT PLAN	ECOLOGY MITIGATION (MAMMAL) chainage 48600 to 50000	A9P09-CFJ-EBD-M_ML486_ZZ-DR-EN-0007	GIS
12.78	ASSESSMENT PLAN	ECOLOGY MITIGATION (MAMMAL) chainage 50000 to 51800	A9P09-CFJ-EBD-M_ML500_ZZ-DR-EN-0004	GIS
12.79	ASSESSMENT PLAN	ECOLOGY MITIGATION (MAMMAL) chainage 51800 to 53200	A9P09-CFJ-EBD-M_ML518_ZZ-DR-EN-0007	GIS
12.80	ASSESSMENT PLAN	ECOLOGY MITIGATION (MAMMAL) chainage 53200 to 54600	A9P09-CFJ-EBD-M_ML532_ZZ-DR-EN-0004	GIS
12.81	ASSESSMENT PLAN	ECOLOGY MITIGATION (MAMMAL) chainage 54600 to 56000	A9P09-CFJ-EBD-M_ML546_ZZ-DR-EN-0004	GIS
12.82	ASSESSMENT PLAN	ECOLOGY MITIGATION (MAMMAL) chainage 56000 to 56645	A9P09-CFJ-EBD-M_ML560_ZZ-DR-EN-0004	GIS

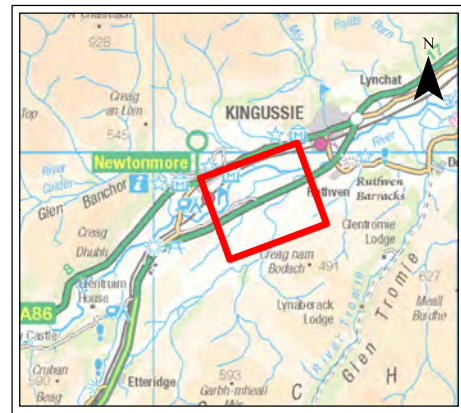
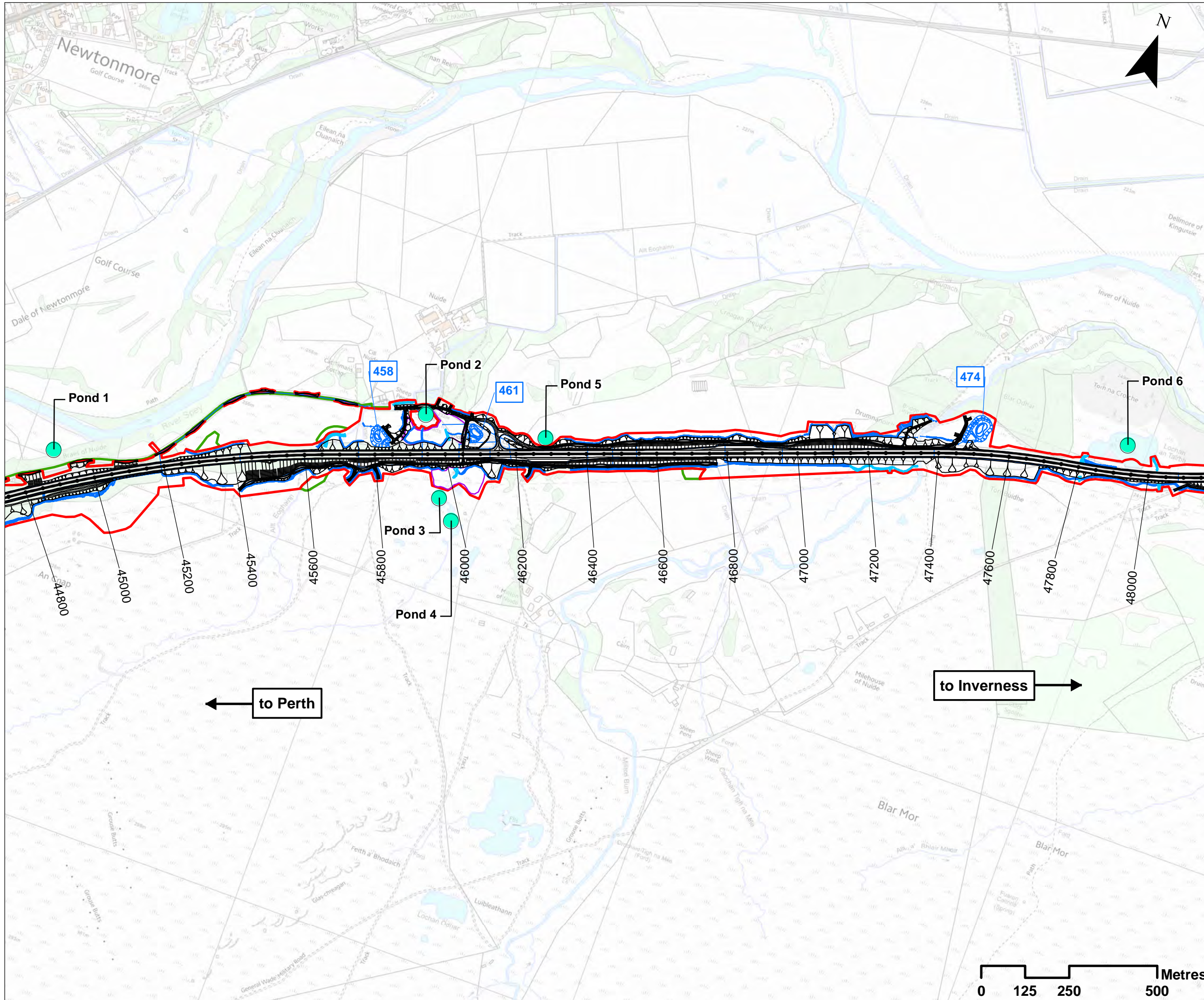

### Legend

- Proposed Scheme Details
- Watercourse Diversions
- Drainage
- SuDS ID
- Compensatory Storage Area
- Assessment Boundary - Permanent Works
- Assessment Boundary - Temporary Works
- Ponds within 250m of existing A9 road

**SCALE 1:10000**

P03	S3	JUNE 18	FINAL REVISIONS	EV	JF
P02	S3	MAY 18	DESIGN UPDATE	EV	JF
P01	S3	APR 18	DRAFT FOR COMMENT	EV	JF
REV	SUI	DATE	DESCRIPTION	BY	APP

**ch2m. FAIRHURST**  
 CH2MHILL Fairhurst JV  
 C/O: City Park 368 Alexandra Parade Glasgow G31 3AU  
 Tel + 44 (0) 141 552 2000 Fax +44 (0) 141 552 2525



**PROJECT 9 CRUBENMORE TO KINCRAIG EIA ASSESSMENT PLAN**  
**DRAWING 12.61**  
**ASSESSMENT FOR GREAT CRESTED NEWT chainage 44800 to 48000**

DESIGN: MR	DRAWN: EV	CHK: GG	APP: JF
---------------	--------------	------------	------------

DATE: 23/07/2018  
 PROJ: 495298

DWG: A9P09-CFJ-EBD-M_ML448_ZZ-DR-EN-0001	SHEET: 1 OF 4	REVISION: C01	SUITABILITY: A3
--	------------------	------------------	--------------------

Document Path: \\g:\p09\Geospatial\Projects\A9\_Dualling\A9\_Dualling\GIS\BIM\BIM\_2\_Maps\Map\Chapter\_12\_61\_V3.mxd



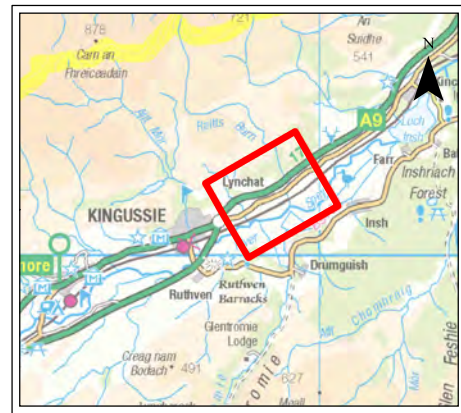
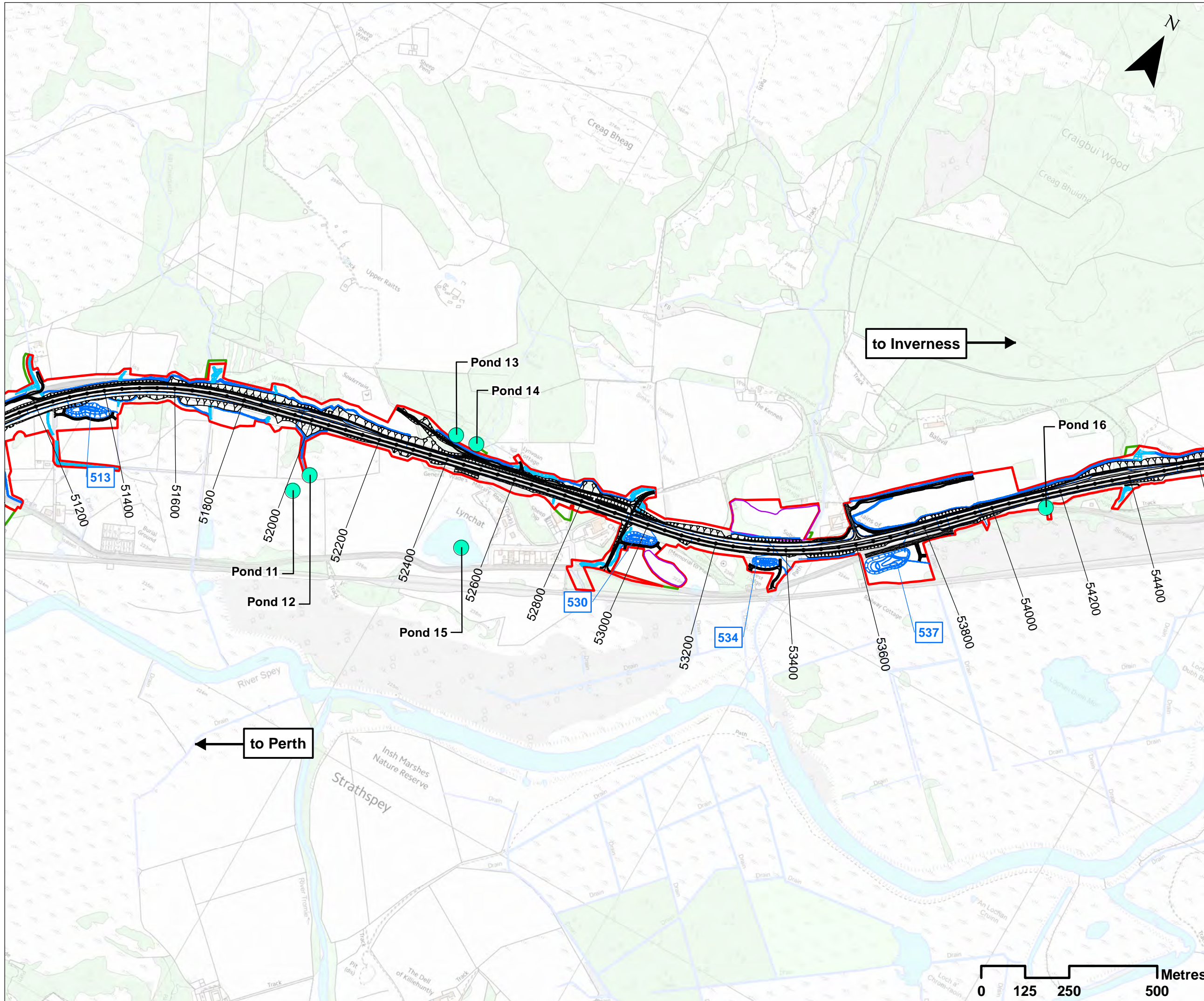

### Legend

- Proposed Scheme Details
- Watercourse Diversions
- Drainage
- SuDS ID
- Compensatory Storage Area
- Assessment Boundary - Permanent Works
- Assessment Boundary - Temporary Works
- Ponds within 250m of existing A9 road

**SCALE 1:10000**

P03	S3	JUNE 18	FINAL REVISIONS	EV	JF
P02	S3	MAY 18	DESIGN UPDATE	EV	JF
P01	S3	APR 18	DRAFT FOR COMMENT	EV	JF
REV	SUI	DATE	DESCRIPTION	BY	APP

**ch2m: FAIRHURST**  
 CH2MHILL Fairhurst JV  
 C/O: City Park 368 Alexandra Parade Glasgow G31 3AU  
 Tel + 44 (0) 141 552 2000 Fax +44 (0) 141 552 2525



**PROJECT 9 CRUBENMORE TO KINRAIG EIA ASSESSMENT PLAN**  
**ASSESSMENT PLAN**  
**DRAWING 12.63**  
**ASSESSMENT FOR GREAT CRESTED NEWT**  
**chainage 51200 to 54400**

DESIGN: MR	DRAWN: EV	CHK: GG	APP: JF
---------------	--------------	------------	------------

DATE: 23/07/2018  
 PROJ: 495298

DWG: A9P09-CFJ-EBD-M_ML512_ZZ-DR-EN-0002		
SHEET: 3 OF 4	REVISION: C01	SUITABILITY: A3







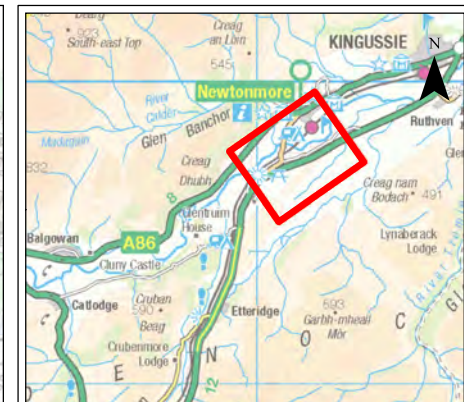
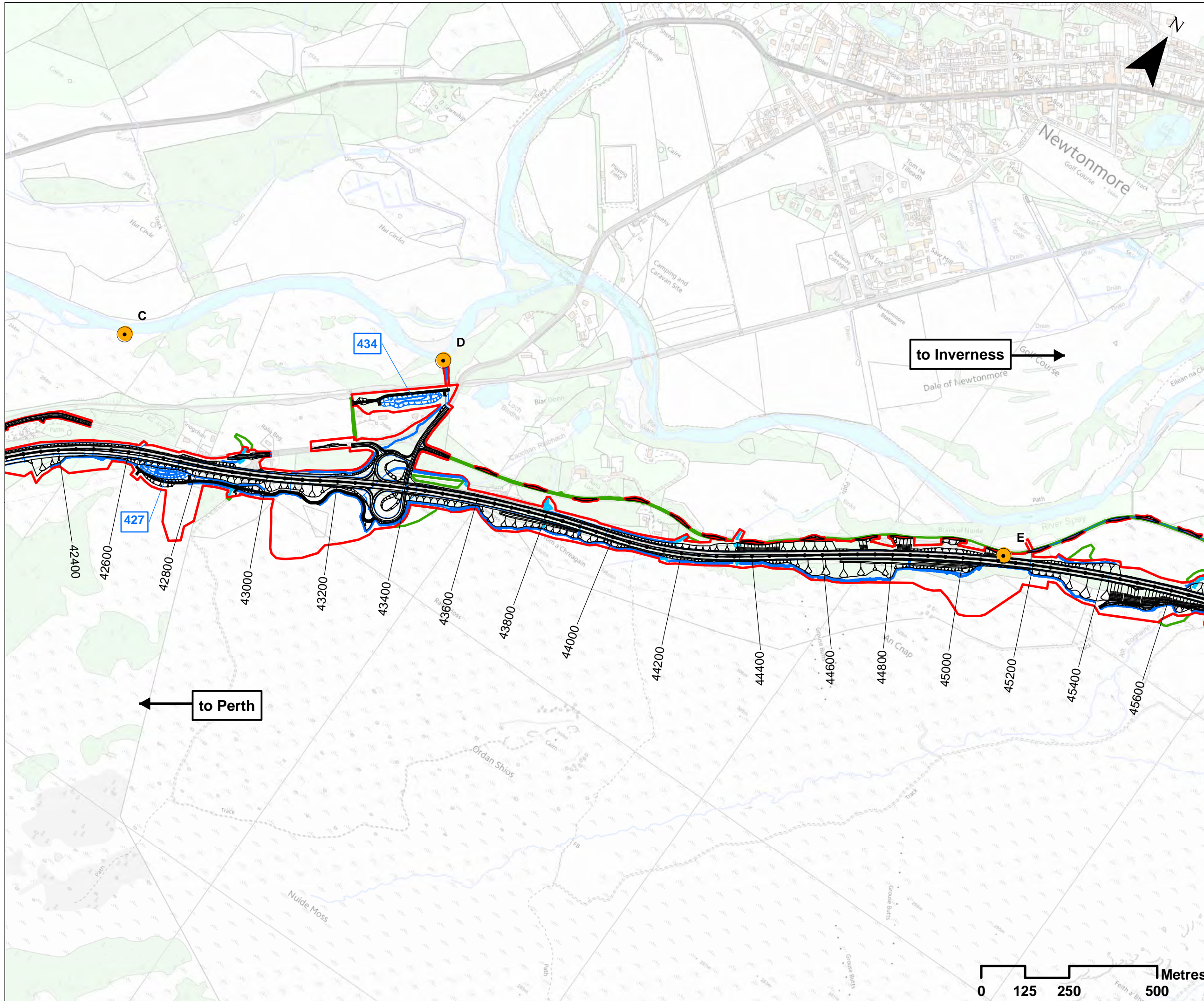

### Legend

- Proposed Scheme Details
- Watercourse Diversions
- Drainage
- SuDS ID
- Assessment Boundary - Permanent Works
- Assessment Boundary - Temporary Works
- Noise Model Location
- A Noise Model Reference

SCALE 1:10000

P03	S3	JUNE 18	FINAL REVISIONS	EV	JF
P02	S3	MAY 18	DESIGN UPDATE	EV	JF
P01	S3	APR 18	DRAFT FOR COMMENT	EV	JF
REV	SUIT	DATE	DESCRIPTION	BY	APP



CH2MHILL Fairhurst JV  
 C/O: City Park 368 Alexandra Parade Glasgow G31 3AU  
 Tel + 44 (0) 141 552 2000 Fax +44 (0) 141 552 2525



**PROJECT 9 CRUBENMORE TO KINCRAIG EIA ASSESSMENT PLAN**  
**DRAWING 12.66**  
**ECOLOGY NOISE MODELLING LOCATIONS**  
 chainage 42400 to 45600

DESIGN: MR	DRAWN: EV	CHK: GG	APP: JF
---------------	--------------	------------	------------

DATE: 23/07/2018

PROJ: 495298

DWG: A9P09-CFJ-EBD-M\_ML424\_ZZ-DR-EN-0003

SHEET: 2 OF 6	REVISION: C01	SUITABILITY: A3
------------------	------------------	--------------------

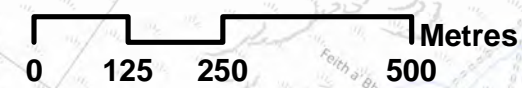

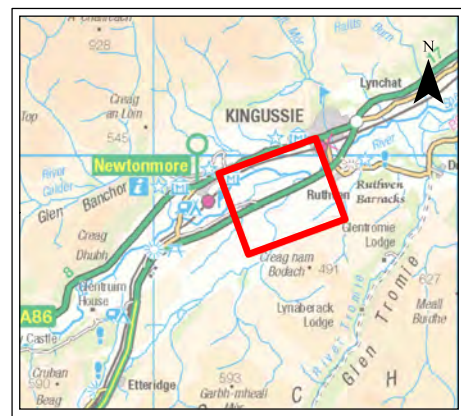
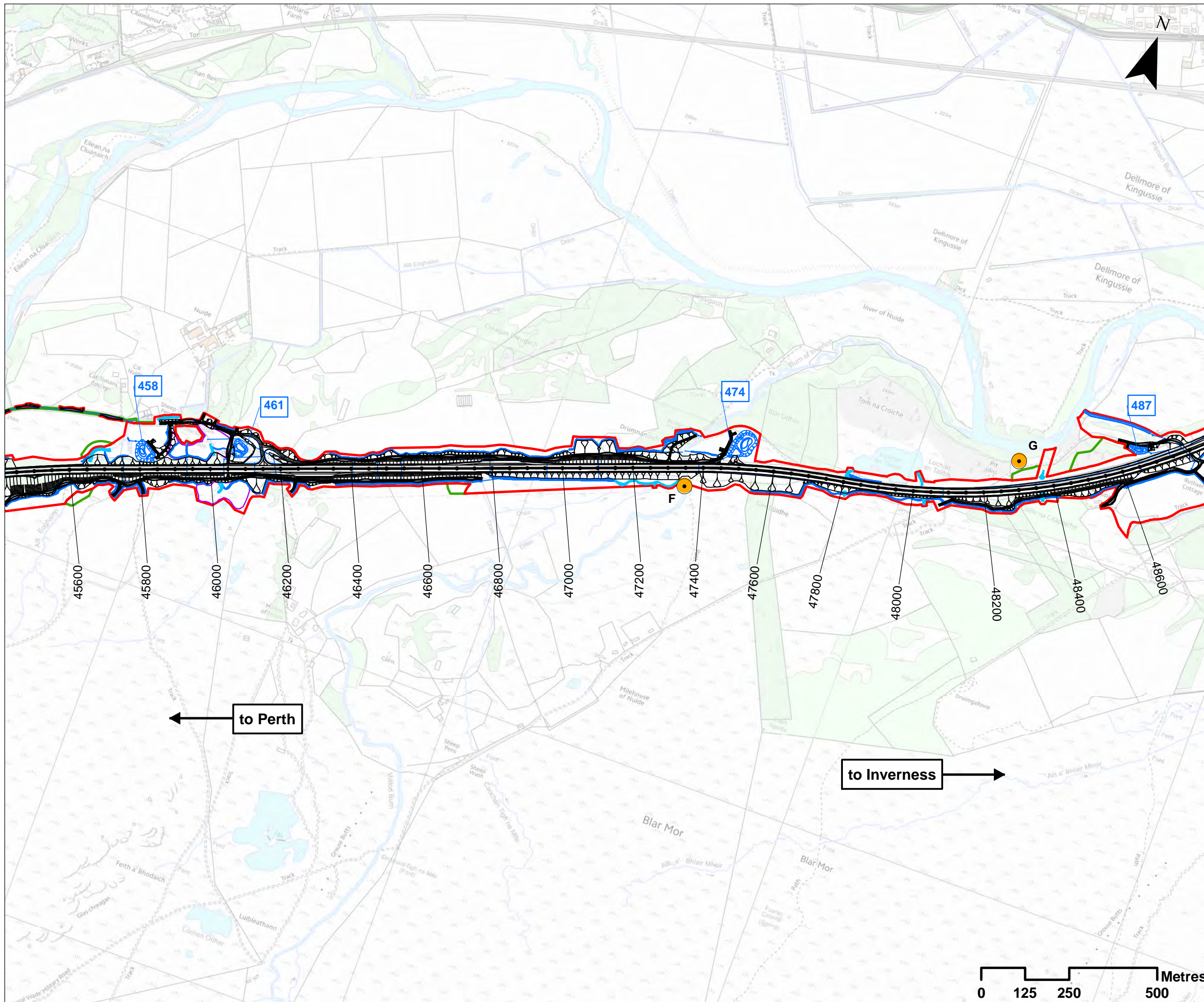

### Legend

- Proposed Scheme Details
- Watercourse Diversions
- Drainage
- SuDS ID
- Compensatory Storage Area
- Assessment Boundary - Permanent Works
- Assessment Boundary - Temporary Works
- Noise Model Location
- Noise Model Reference

to Perth ←

to Inverness →



**SCALE 1:10000**

P03	S3	JUNE 18	FINAL REVISIONS	EV	JF
P02	S3	MAY 18	DESIGN UPDATE	EV	JF
P01	S3	APR 18	DRAFT FOR COMMENT	EV	JF
REV	SUI	DATE	DESCRIPTION	BY	APP

**ch2m FAIRHURST**  
 CH2MHILL Fairhurst JV  
 C/O: City Park 368 Alexandra Parade Glasgow G31 3AU  
 Tel + 44 (0) 141 552 2000 Fax +44 (0) 141 552 2525



**PROJECT 9 CRUBENMORE TO KINCRAIG EIA ASSESSMENT PLAN**  
**DRAWING 12.67**  
**ECOLGY NOISE MODELLING LOCATIONS**  
**chainage 45600 to 48600**

DESIGN: MR	DRAWN: EV	CHK: GG	APP: JF
---------------	--------------	------------	------------

DATE: 23/07/2018  
 PROJ: 495298

DWG: A9P09-CFJ-EBD-M_ML456_ZZ-DR-EN-0006		
SHEET: 3 OF 6	REVISION: C01	SUITABILITY: A3





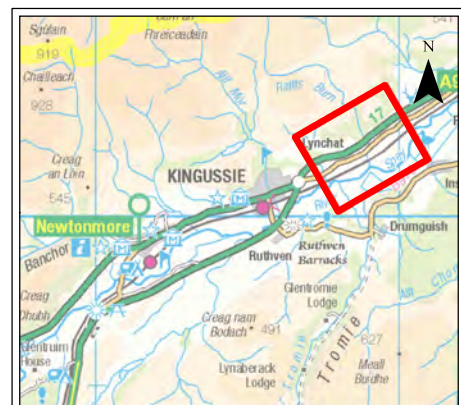
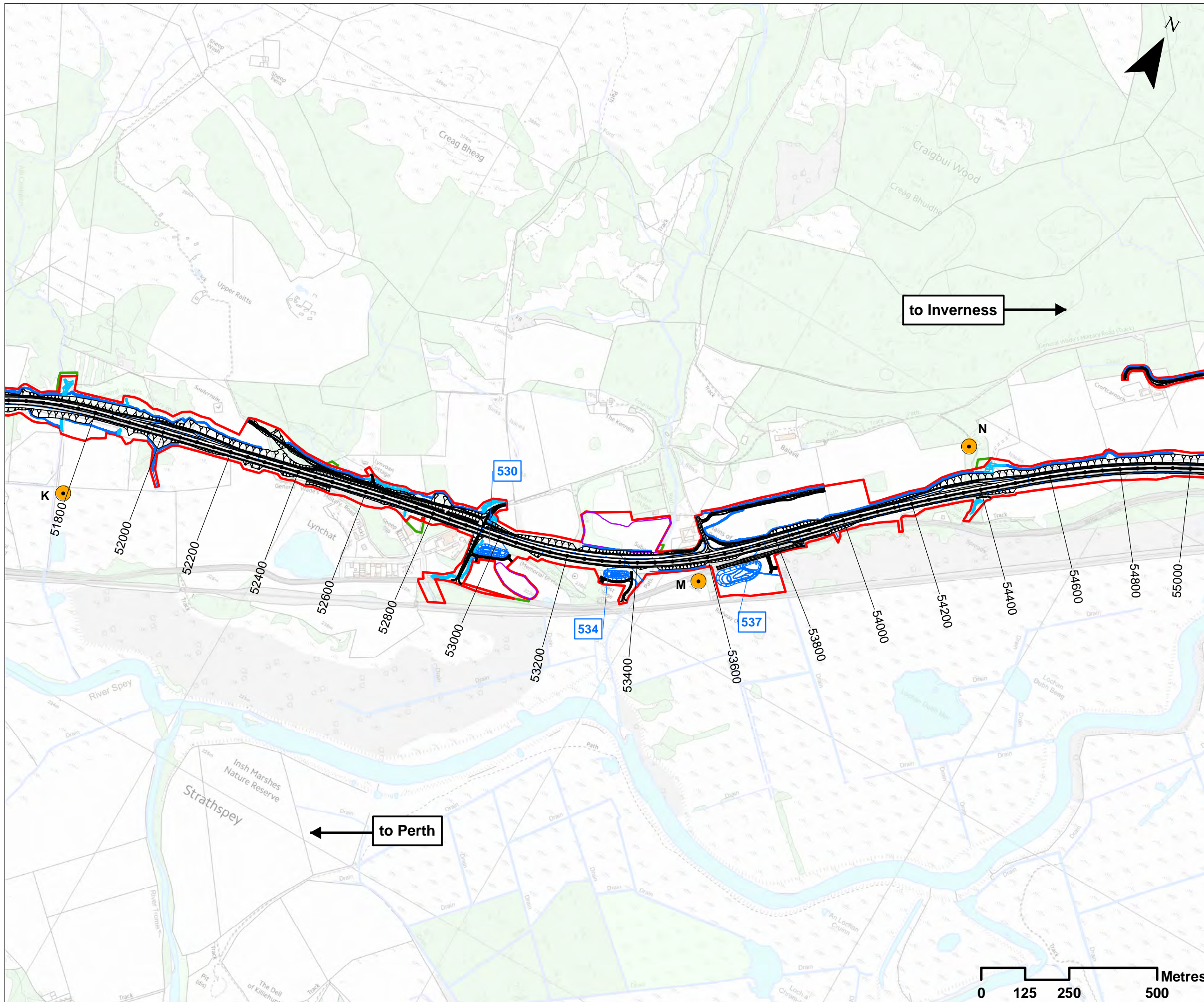

- ### Legend
- Proposed Scheme Details
  - Watercourse Diversions
  - Drainage
  - SuDS ID
  - Compensatory Storage Area
  - Assessment Boundary - Permanent Works
  - Assessment Boundary - Temporary Works
  - Noise Model Location
  - Noise Model Reference

to Inverness →

← to Perth

SCALE 1:10000

P03	S3	JUNE 18	FINAL REVISIONS	EV	JF
P02	S3	MAY 18	DESIGN UPDATE	EV	JF
P01	S3	APR 18	DRAFT FOR COMMENT	EV	JF
REV	SUIT	DATE	DESCRIPTION	BY	APP



CH2MHILL Fairhurst JV  
 C/O: City Park 368 Alexandra Parade Glasgow G31 3AU  
 Tel + 44 (0) 141 552 2000 Fax +44 (0) 141 552 2525



**PROJECT 9 CRUBENMORE TO KINCRAIG EIA ASSESSMENT PLAN**  
**DRAWING 12.69**  
**ECOLOGY NOISE MODELLING LOCATIONS**  
 chainage 51800 to 55000

DESIGN: MR	DRAWN: EV	CHK: GG	APP: JF
---------------	--------------	------------	------------

DATE: 23/07/2018  
 PROJ: 495298

DWG: A9P09-CFJ-EBD-M\_ML518\_ZZ-DR-EN-0006

SHEET: 5 OF 6	REVISION: C01	SUITABILITY: A3
------------------	------------------	--------------------



Document Path: \\g:\projects\geospatial\projects\A9\_Dualling\A9\_Dualling\GIS\BIM\BIM\_2\_Maps\Map\Chapter\_12\_Ecology\Drawing\_12.69\_V3.mxd

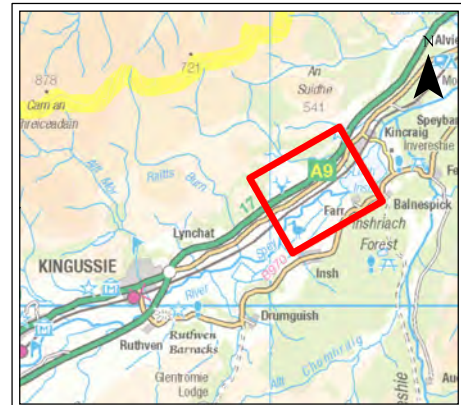
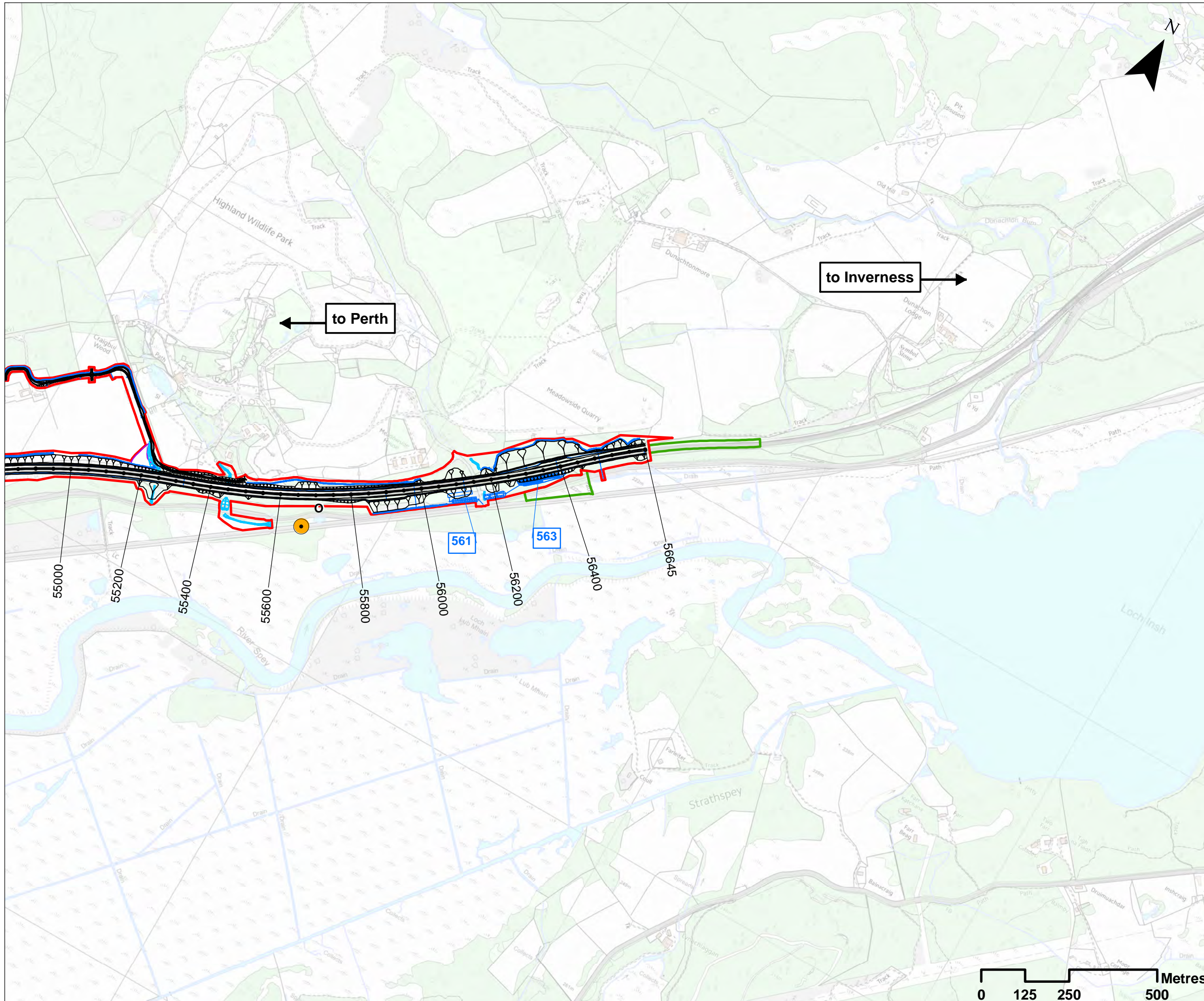

### Legend

- Proposed Scheme Details
- Drainage
- Watercourse Diversions
- SuDS ID
- Compensatory Storage Area
- Assessment Boundary - Permanent Works
- Assessment Boundary - Temporary Works
- Noise Model Location
- Noise Model Reference

SCALE 1:10000

P03	S3	JUNE 18	FINAL REVISIONS	EV	JF
P02	S3	MAY 18	DESIGN UPDATE	EV	JF
P01	S3	APR 18	DRAFT FOR COMMENT	EV	JF
REV	SUI	DATE	DESCRIPTION	BY	APP



CH2MHILL Fairhurst JV  
 C/O: City Park 368 Alexandra Parade Glasgow G31 3AU  
 Tel + 44 (0) 141 552 2000 Fax +44 (0) 141 552 2525



**PROJECT 9 CRUBENMORE TO KINCRAIG EIA  
 ASSESSMENT PLAN  
 DRAWING 12.70  
 ECOLOGY NOISE MODELLING LOCATIONS  
 chainage 55000 to 55645**

DESIGN: MR	DRAWN: EV	CHK: GG	APP: JF
---------------	--------------	------------	------------

DATE: 23/07/2018  
 PROJ: 495298

DWG: A9P09-CFJ-EBD-M\_ML550\_ZZ-DR-EN-0003

SHEET: 6 OF 6	REVISION: C01	SUITABILITY: A3
------------------	------------------	--------------------

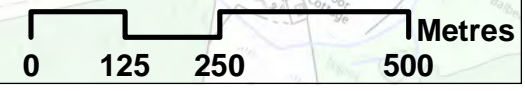

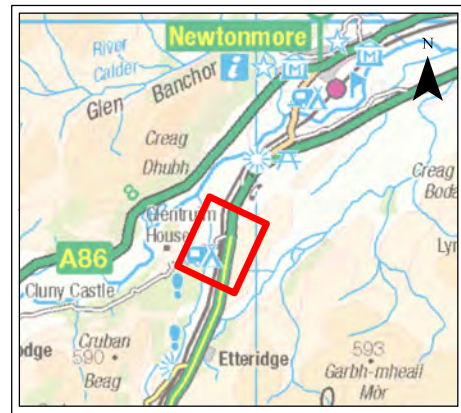
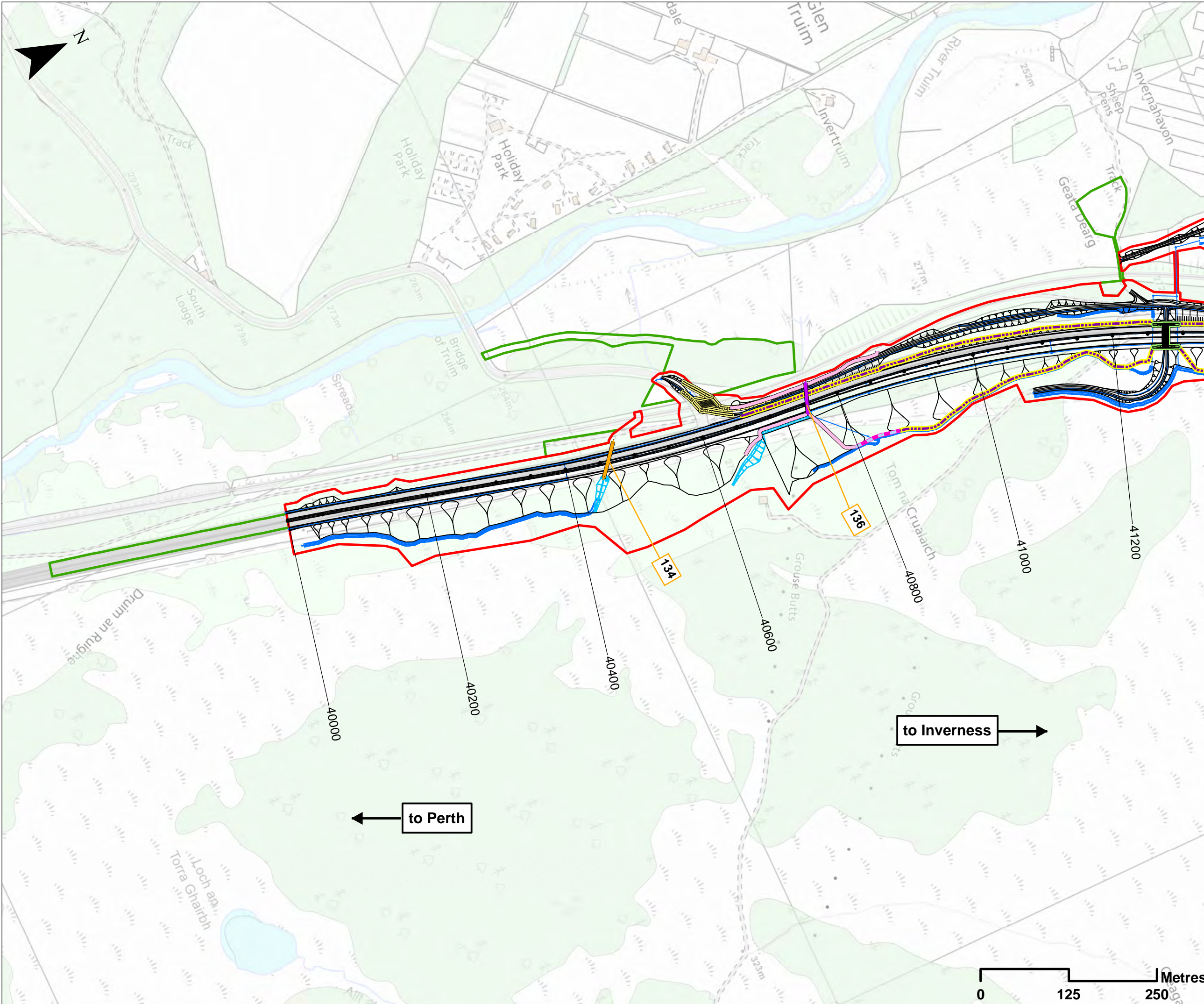

**Legend**

- Proposed Scheme Details
- Watercourse Diversions
- Drainage
- Proposed Culverts
- Structures
- 100 Hydro ID
- Assessment Boundary - Permanent Works
- Assessment Boundary - Temporary Works
- Mammal Fencing**
- Combined Deer - Otter Fence
- Deer Fencing
- Otter Fencing
- Mammal Crossings**
- Dry underpass suitable for large sized mammals
- Proposed culvert with ledge suitable for medium sized mammals

**SCALE 1:5000**

REV	SUI	DATE	DESCRIPTION	EV	JF
P04	S3	AUG 18	FINAL REVISIONS	HA	JF
P03	S3	JUNE 18	DESIGN UPDATE	EV	JF
P02	S3	MAY 18	DESIGN UPDATE	EV	JF
P01	S3	APR 18	DRAFT FOR COMMENT	EV	JF

**ch2m FAIRHURST**  
 CH2MHILL Fairhurst JV  
 C/O: City Park 368 Alexandra Parade Glasgow G31 3AU  
 Tel + 44 (0) 141 552 2000 Fax +44 (0) 141 552 2525



**PROJECT 9 CRUBENMORE TO KINRAIG EIA ASSESSMENT PLAN  
 DRAWING 12.71  
 ECOLOGY MITIGATION (MAMMAL)  
 chainage 40000 to 41200**

DESIGN: MR	DRAWN: EV	CHK: GG	APP: JF
---------------	--------------	------------	------------

DATE: 23/08/2018  
 PROJ: 495298  
 DWG: A9P09-CFJ-EBD-M\_ML400\_ZZ-DR-EN-0008

SHEET: 1 OF 12	REVISION: C01	SUITABILITY: A3
-------------------	------------------	--------------------

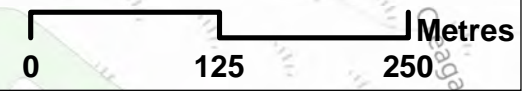



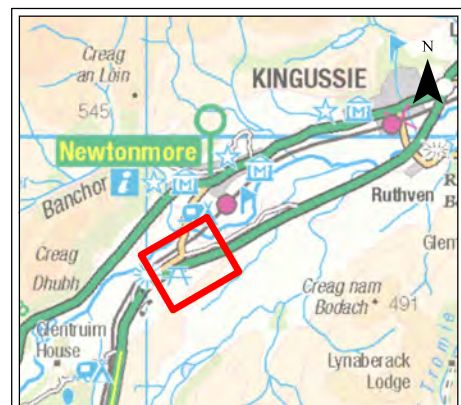
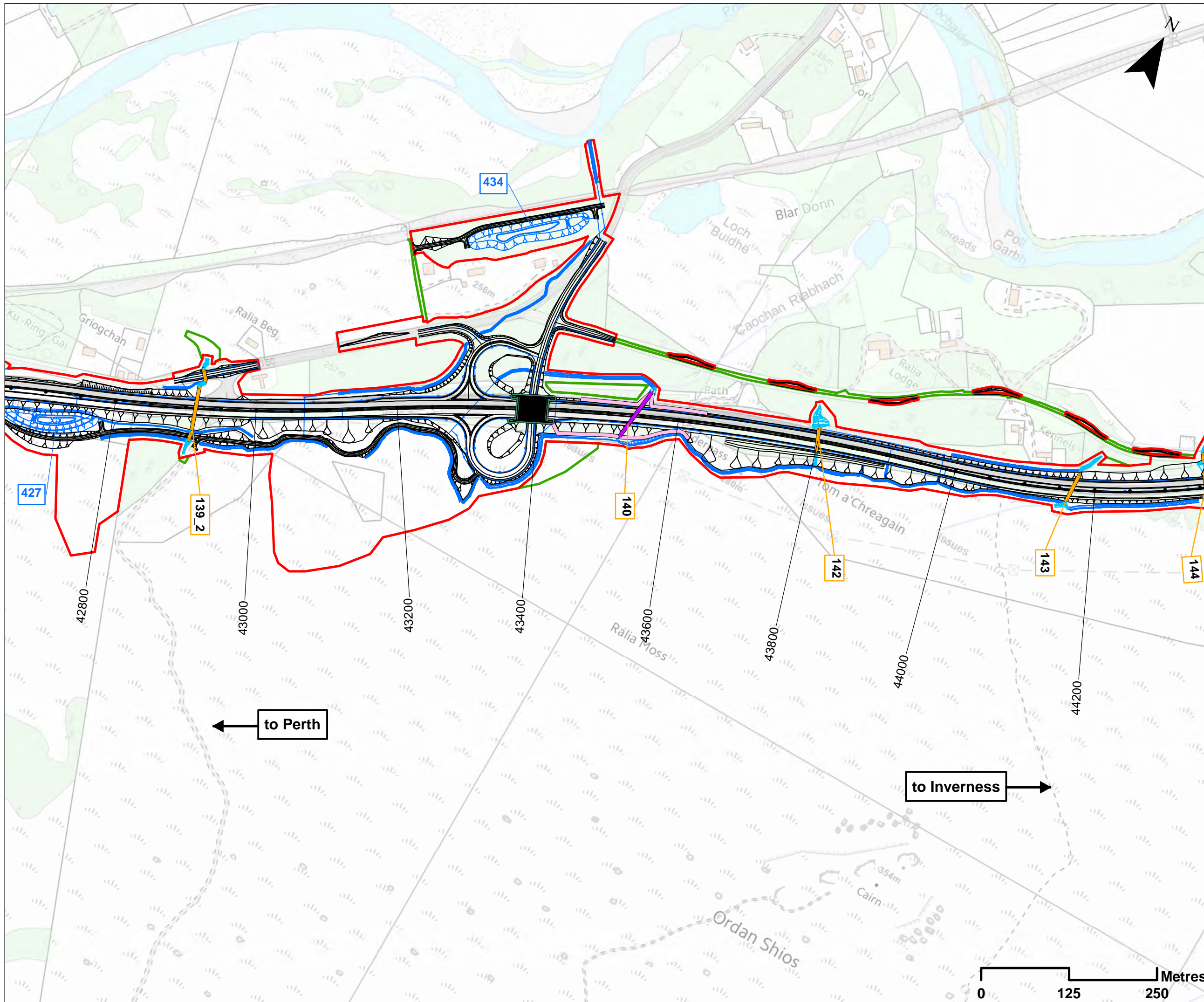

### Legend

- Proposed Scheme Details
- Watercourse Diversions
- Drainage
- Proposed Culverts
- Structures
- 100 Hydro ID
- 400 SuDS ID
- Assessment Boundary - Permanent Works
- Assessment Boundary - Temporary Works
- Mammal Fencing**
- Otter Fencing
- Mammal Crossings**
- Proposed culvert with ledge suitable for medium sized mammals
- Proposed structure suitable for large sized mammals

**SCALE 1:5000**

REV	SUI	DATE	DESCRIPTION	EV	JF
P04	S3	AUG 18	FINAL REVISIONS	HA	JF
P03	S3	JUNE 18	DESIGN UPDATE	EV	JF
P02	S3	MAY 18	DESIGN UPDATE	EV	JF
P01	S3	APR 18	DRAFT FOR COMMENT	EV	JF

**ch2m: FAIRHURST**  
 CH2MHILL Fairhurst JV  
 C/O: City Park 368 Alexandra Parade Glasgow G31 3AU  
 Tel + 44 (0) 141 552 2000 Fax +44 (0) 141 552 2525



**PROJECT 9 CRUBENMORE TO KINRAIG EIA ASSESSMENT PLAN**  
**DRAWING 12.73**  
**ECOLOGY MITIGATION (MAMMAL)**  
 chainage 42800 to 44200

DESIGN: MR	DRAWN: EV	CHK: GG	APP: JF
---------------	--------------	------------	------------

DATE: 23/08/2018  
 PROJ: 495298

DWG: A9P09-CFJ-EBD-M\_ML428\_ZZ-DR-EN-0004

SHEET: 3 OF 12	REVISION: C01	SUITABILITY: A3
-------------------	------------------	--------------------

Document Path: \\g:\p09\Geospatial\Projects\A9\_Dualling\A9\_Dualling\GIS\DMR\3\4.2\_Maps\09\Chapter\_12\_Ecology\Drawing\_12.73\_V3.mxd













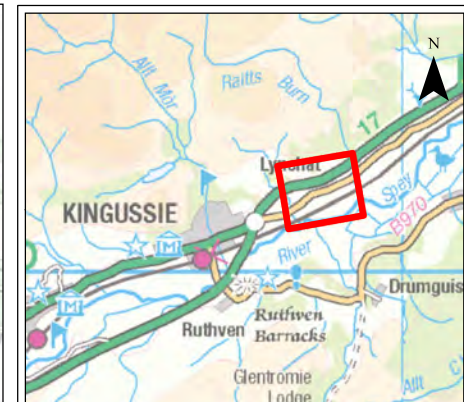
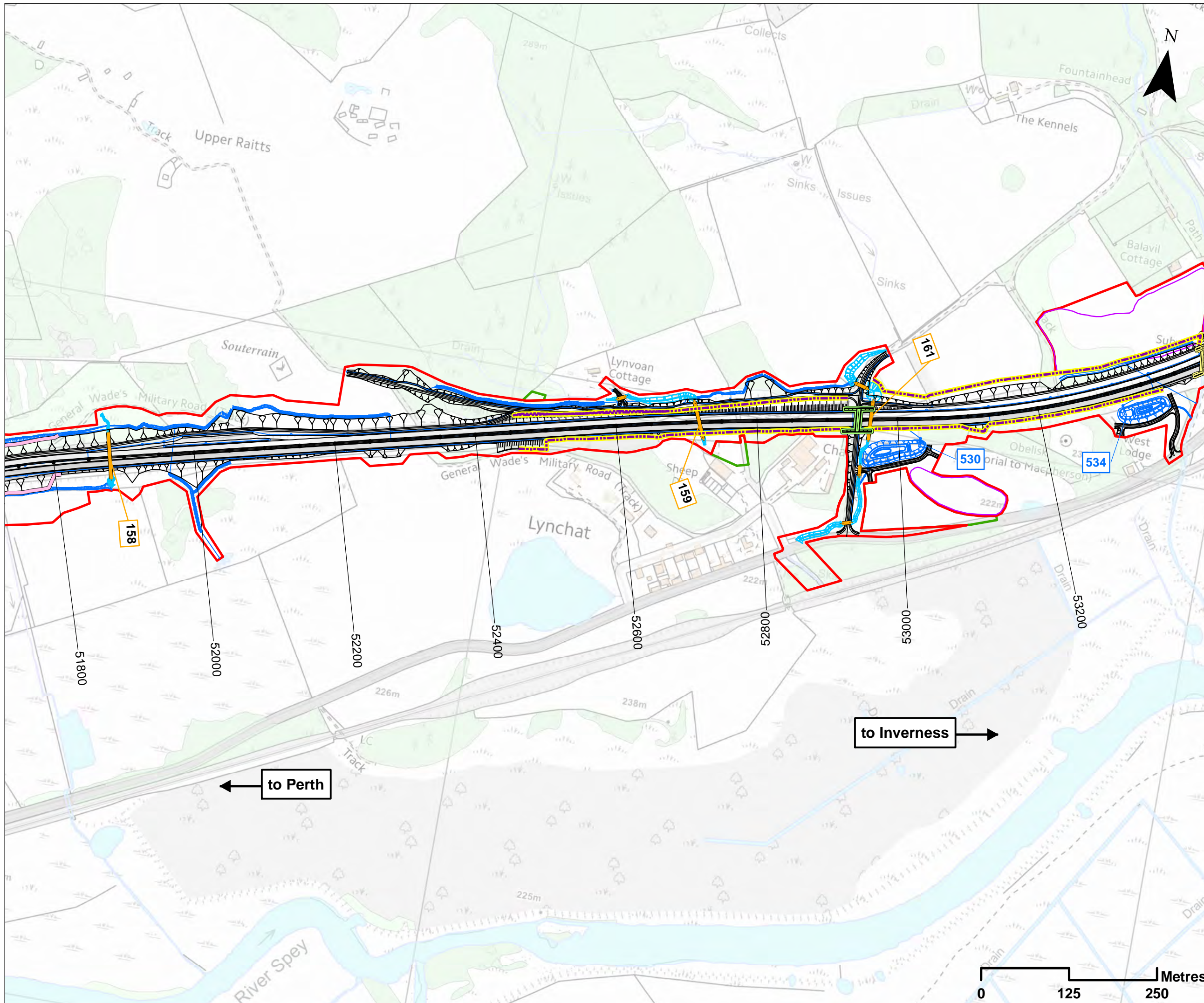

### Legend

- Proposed Scheme Details
- Watercourse Diversions
- Drainage
- Proposed Culverts
- Structures
- 100 Hydro ID
- 400 SuDS ID
- Compensatory Storage Area
- Assessment Boundary - Permanent Works
- Assessment Boundary - Temporary Works
- Mammal Fencing**
- Deer Fencing
- Otter Fencing
- Mammal Crossings**
- Dry underpass suitable for large sized mammals

SCALE 1:5000

P04	S3	AUG 18	FINAL REVISIONS	HA	JF
P03	S3	JUNE 18	DESIGN UPDATE	EV	JF
P02	S3	MAY 18	DESIGN UPDATE	EV	JF
P01	S3	APR 18	DRAFT FOR COMMENT	EV	JF
REV	SUI	DATE	DESCRIPTION	BY	APP

**ch2m: FAIRHURST**

CH2MHILL Fairhurst JV  
 C/O: City Park 368 Alexandra Parade Glasgow G31 3AU  
 Tel + 44 (0) 141 552 2000 Fax +44 (0) 141 552 2525



**PROJECT 9 CRUBENMORE TO KINCRAIG EIA ASSESSMENT PLAN**  
**ASSESSMENT PLAN**  
**DRAWING 12.79**  
**ECOLOGICAL MITIGATION (MAMMAL)**  
 chainage 51800 to 53200

DESIGN: MR	DRAWN: EV	CHK: GG	APP: JF
---------------	--------------	------------	------------

DATE: 23/08/2018

PROJ: 495298

DWG: A9P09-CFJ-EBD-M\_ML518\_ZZ-DR-EN-0007

SHEET: 9 OF 12	REVISION: C01	SUITABILITY: A3
-------------------	------------------	--------------------

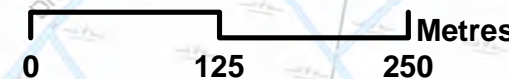



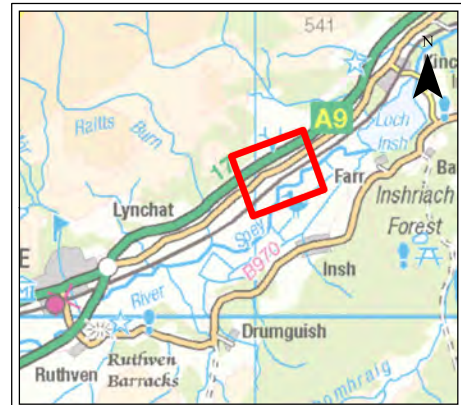
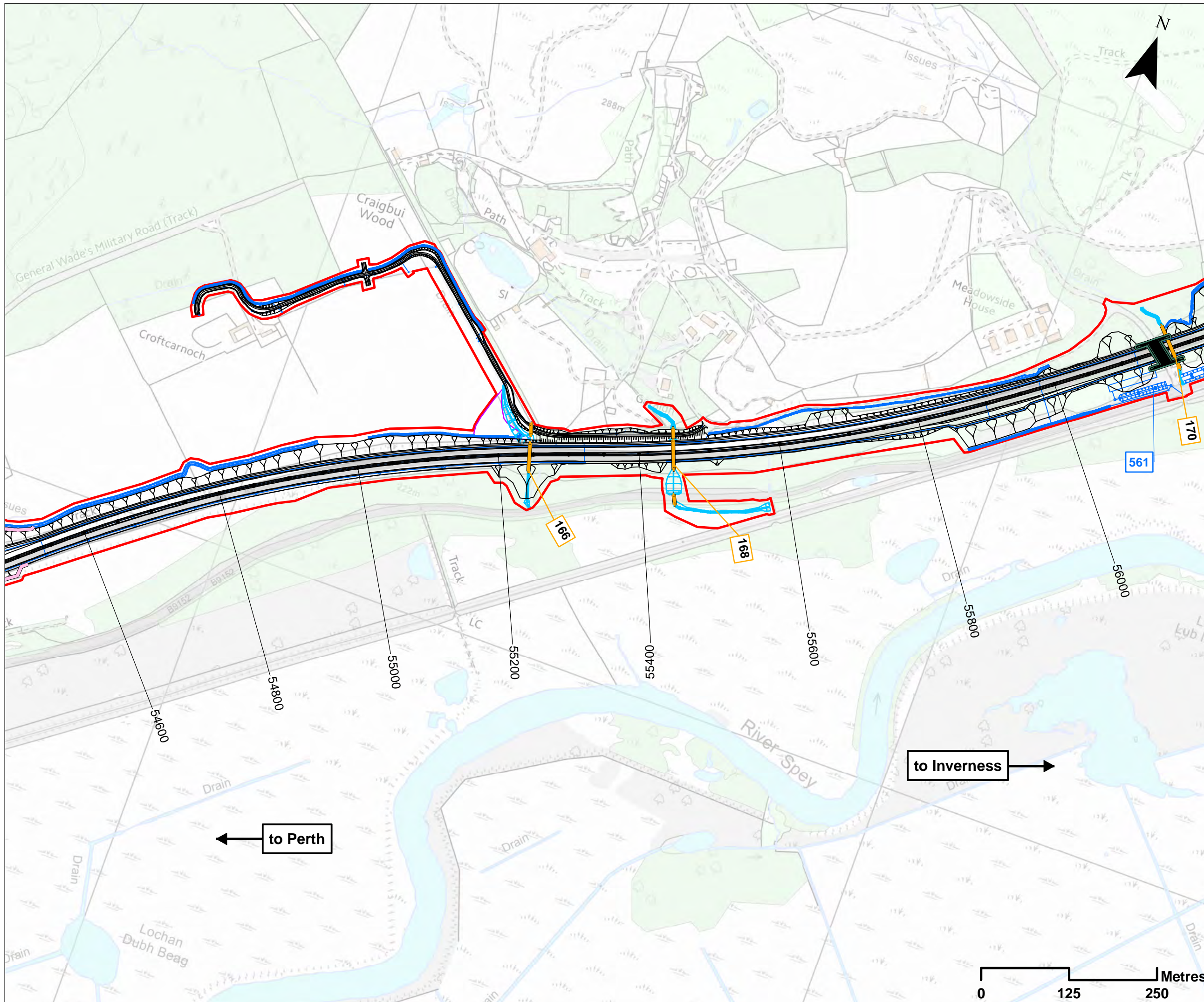

### Legend

- Proposed Scheme Details
- Watercourse Diversions
- Drainage
- Proposed Culverts
- Structures
- 100 Hydro ID
- 400 SuDS ID
- Compensatory Storage Area
- Assessment Boundary - Permanent Works
- Mammal Fencing**
- Otter Fencing
- Mammal Crossings**
- Proposed structure suitable for large sized mammals

**SCALE 1:5000**

P03	S3	JUNE 18	FINAL REVISIONS	EV	JF
P02	S3	MAY 18	DESIGN UPDATE	EV	JF
P01	S3	APR 18	DRAFT FOR COMMENT	EV	JF
REV	SUIT	DATE	DESCRIPTION	BY	APP

**ch2m: FAIRHURST**  
 CH2MHILL Fairhurst JV  
 C/O: City Park 368 Alexandra Parade Glasgow G31 3AU  
 Tel + 44 (0) 141 552 2000 Fax +44 (0) 141 552 2525



**PROJECT 9 CRUBENMORE TO KINRAIG EIA ASSESSMENT PLAN**  
**DRAWING 12.81**  
**ECOLOGY MITIGATION (MAMMAL)**  
 chainage 54600 to 56000

DESIGN: MR	DRAWN: EV	CHK: GG	APP: JF
---------------	--------------	------------	------------

DATE: 31/07/2018  
 PROJ: 495298

SHEET: 11 OF 12	REVISION: C01	SUITABILITY: A3
--------------------	------------------	--------------------

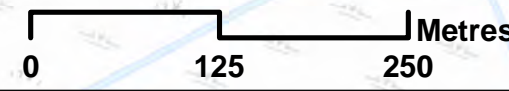

Document Path: \\g:\projects\geospatial\projects\A9\_Dualling\A9\_Dualling\12\_81\_Mammal\Chapter\_12\_Ecology\Drawing\_12\_81\_V3.mxd

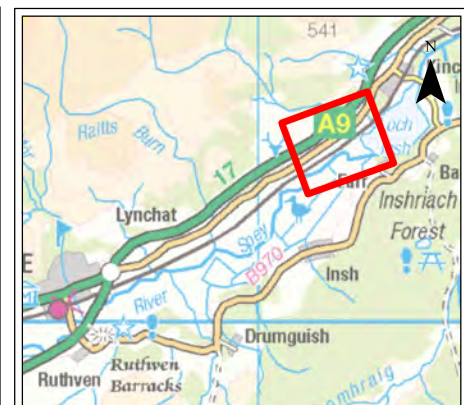
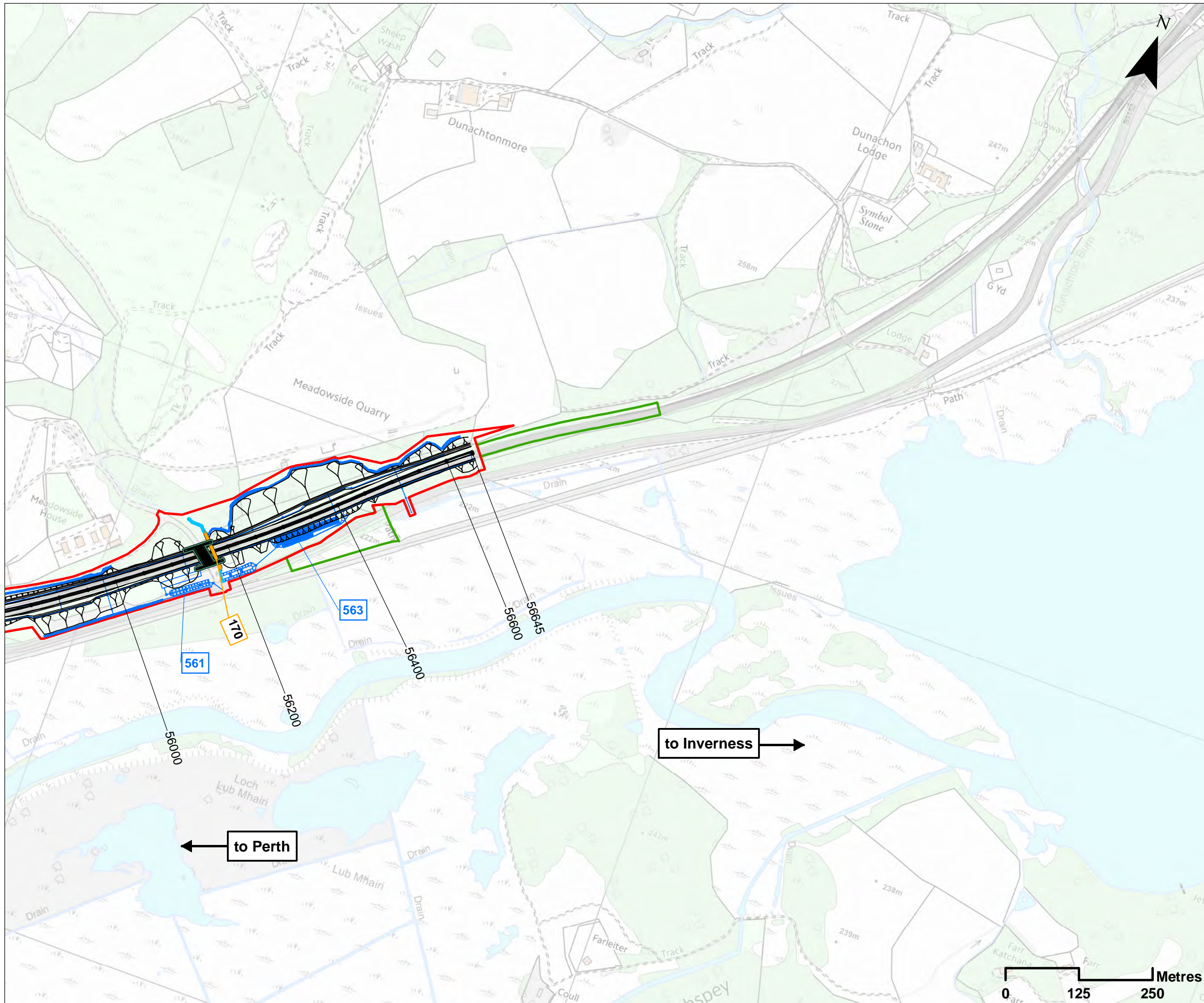

### Legend

- Proposed Scheme Details
- Watercourse Diversions
- Drainage
- Proposed Culverts
- Structures
- 100 Hydro ID
- 400 SuDS ID
- Assessment Boundary - Permanent Works
- Assessment Boundary - Temporary Works
- Mammal Crossings**
- Proposed structure suitable for large sized mammals

SCALE 1:5000

P03	S3	JUNE 18	FINAL REVISIONS	EV	JF
P02	S3	MAY 18	DESIGN UPDATE	EV	JF
P01	S3	APR 18	DRAFT FOR COMMENT	EV	JF
REV	SUI	DATE	DESCRIPTION	BY	APP

**ch2m: FAIRHURST**  
 CH2MHILL Fairhurst JV  
 C/O: City Park 368 Alexandra Parade Glasgow G31 3AU  
 Tel + 44 (0) 141 552 2000 Fax +44 (0) 141 552 2525



**PROJECT 9 CRUBENMORE TO KINCRAIG EIA ASSESSMENT PLAN**  
**DRAWING 12.82**  
**ECOLOGY MITIGATION (MAMMAL)**  
 chainage 56000 to 56645

DESIGN: MR	DRAWN: EV	CHK: GG	APP: JF
---------------	--------------	------------	------------

DATE: 31/07/2018  
 PROJ: 495298

DWG: A9P09-CFJ-EBD-M\_ML560\_ZZ-DR-EN-0004

SHEET: 12 OF 12	REVISION: C01	SUITABILITY: A3
--------------------	------------------	--------------------

