

GENERAL NOTES

1. ALL DIMENSIONS IN METRES UNLESS STATED OTHERWISE.
2. THE MAINLINE ALIGNMENTS INCORPORATE VARIED EARTHWORKS SLOPES. WHERE POSSIBLE EARTHWORKS SLOPES ACCOMMODATE LANDSCAPING CONSIDERATIONS. IN ADDITION, EARTHWORKS SLOPES ARE STEEPENED WHERE NECESSARY TO MINIMISE IMPACTS ON ADJACENT CONSTRAINTS SUCH AS THE RAILWAY AND WHERE ROCK CUTS ARE ANTICIPATED.

- LEGEND:**
- PROPOSED ROAD
 - EARTHWORKS CUTTING
 - EARTHWORKS FILL
 - SLOPE BETWEEN CARRIAGEWAYS
 - CARRIAGEWAY
 - VERGE / CENTRAL RESERVE
- KEY ENGINEERING CONSTRAINTS**
- RIVER / STREAM / LOCH
 - CFJV FLOOD MAPPING (1:200 YEAR)
 - MAJOR CULVERTS / WATERCOURSE STRUCTURE REFS
 - MINOR CULVERTS / WATERCOURSE STRUCTURE REFS
 - OTHER CULVERTS / WATERCOURSE STRUCTURE REFS
 - RAILWAY
 - BUILDINGS
 - EXISTING ROAD / FOOTPATH / CYCLE ROUTE
 - WATERCOURSE DIVERSION
 - EXISTING ROCK CUTTING
 - EXISTING ACCESS (TIER 1 A OR B)
 - EXISTING ACCESS (TIER 2 C OR UNCLASSIFIED)
 - EXISTING ACCESS (TIER 3 PRIVATE)
 - LISTED BUILDINGS (HS)

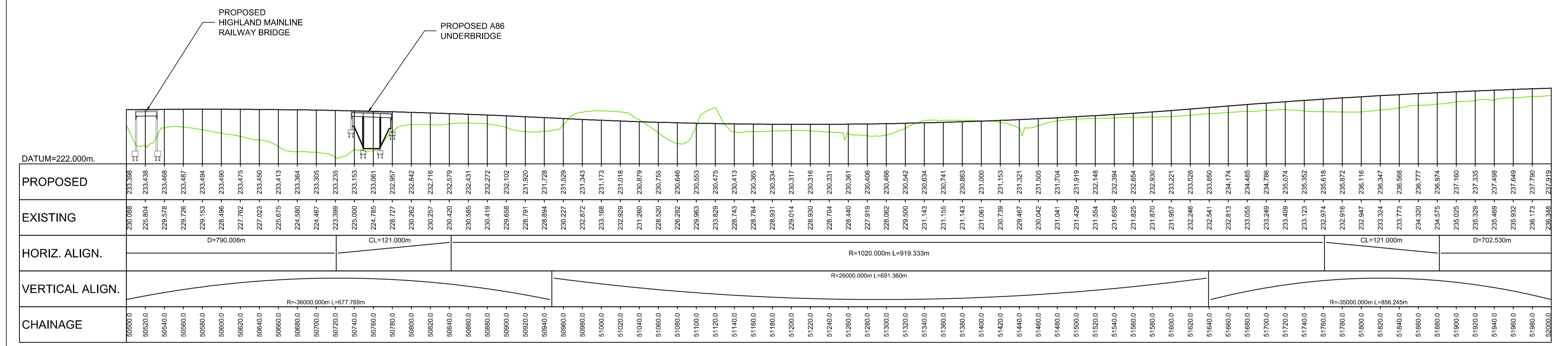

LONG SECTION
SCALE 1:2500H:1:500V

REV	SUIT	DATE	DESCRIPTION	BY	APP
P04	S4	05-09-18	Fourth Issue	PL	RG
P03	S4	09-04-18	Third Issue	PL	RG
P02	S4	22-09-17	Second Issue	AC	RG
P01	S4	10-11-16	First Issue	AC	RG

ch2m FAIRHURST
CH2M HILL Fairhurst JV
C/O: City Park 368 Alexandra Parade Glasgow G3 3AU
Tel +44 (0)141 552 2000 Fax +44 (0)141 552 2525

TRANSPORT SCOTLAND **A9 DUALLING**
COMBINED, ALBA
Perth to Inverness
Crucial to the Kinshirg

PROJECT 09
CRUBENMORE TO KINRAIG
CH 50500 - 52000
PLAN AND PROFILE

DESIGN:	DRAWN:	CHK:	APP:
A Campbell	A Campbell	C Southwell	R Gray

1:2500 at A1 (1:5000 at A3)
DATE: 10/11/16
PROJ: 495298
DWG: A9P09-CFJ-HML-M_ML400_ML-DR-RD-0008
SHEET: 8 of 12 REVISION: P04 SUITABILITY: S4

Reproduced by permission of Ordnance Survey on behalf of Her Majesty's Stationery Office. © Crown copyright and database right 2018. All rights reserved. Ordnance Survey Licence Number: 100046668.

A9P09-CFJ-HML-M_ML400_ML-DR-RD-0008.dwg