

Land-take from:
 - Planning application 17/00574/PPP at Beechbrae for a dwelling house (Major Impact)
 - Planning application 18/00361/APP (pending consideration) at Ardye Steading for conversions to dwelling houses (Minor Impact)

Legend

- Route Option
- 500m Buffer

Moray Local Development Plan 2015 - Designated Sites

- Business Park
- Environmental
- Flood Alleviation
- Industrial
- Long Term Residential
- Opportunity
- Residential
- Amenity
- Tourism

Land-take Land-take from designated sites and planning applications

Note: Refer to Appendix 9.2 and 9.3 for details of sites

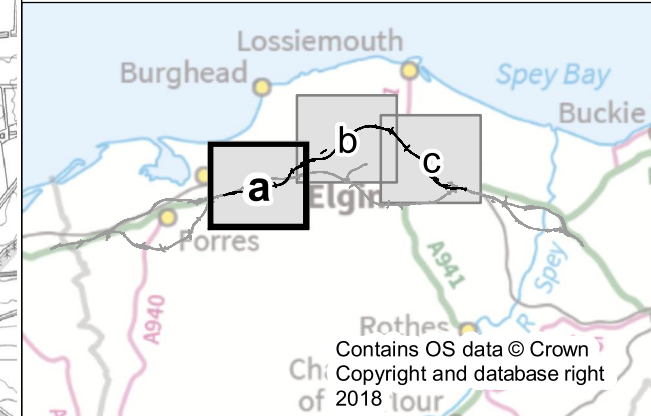
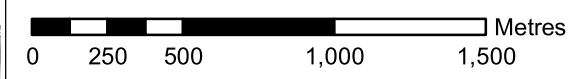

C01	27/11/2018	Approved as Stage Complete	JB	AM
Rev.	Rev. Date	Drawing Suitability	Drawn	Appr'd

Mott MacDonald Sweco



Project
**A96 Dualling
 Hardmuir to Fochabers**

Drawing Title
**Figure 9.2a Local Development Plan (LDP)
 Designated Sites and Planning Applications
 Hillhead to Lhanbryde - North Option**

Scale @ A3	1:25,000	DO NOT SCALE
Project No.	117880	Status
BIM No.	A96PHF-MMS-EGN-00000-DR-GS-00016	

This drawing should not be relied on or used in circumstances other than those for which it was originally prepared and for which the Mott MacDonald Sweco (MMS) Joint Venture was commissioned. MMS accepts no responsibility for this drawing to any party other than the person by whom it was commissioned. Any party which breaches the provisions of this disclaimer shall indemnify MMS for all loss or damage arising therefrom.

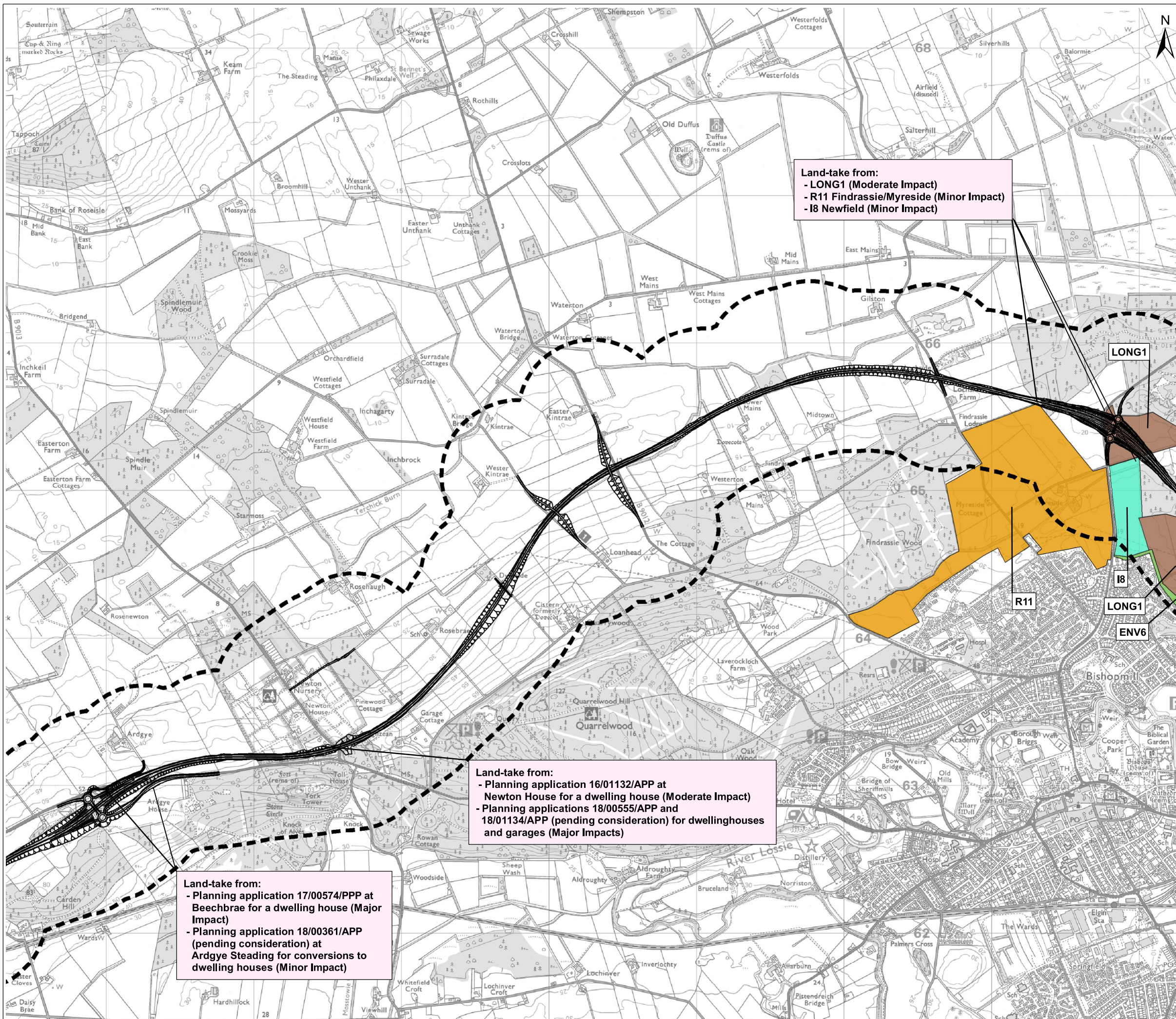

Land-take from:
 - LONG1 (Moderate Impact)
 - R11 Findrassie/Myreside (Minor Impact)
 - I8 Newfield (Minor Impact)

Land-take from:
 - Planning application 16/01132/APP at Newton House for a dwelling house (Moderate Impact)
 - Planning applications 18/00555/APP and 18/01134/APP (pending consideration) for dwellinghouses and garages (Major Impacts)

Land-take from:
 - Planning application 17/00574/PPP at Beechbrae for a dwelling house (Major Impact)
 - Planning application 18/00361/APP (pending consideration) at Ardyge Steading for conversions to dwelling houses (Minor Impact)

Legend

- Route Option
- 500m Buffer
- Moray Local Development Plan 2015 - Designated Sites**
- Business Park
- Environmental
- Flood Alleviation
- Industrial
- Long Term Residential
- Opportunity
- Residential
- Amenity
- Tourism

Land-take Land-take from designated sites and planning applications

Note: Refer to Appendix 9.2 and 9.3 for details of sites

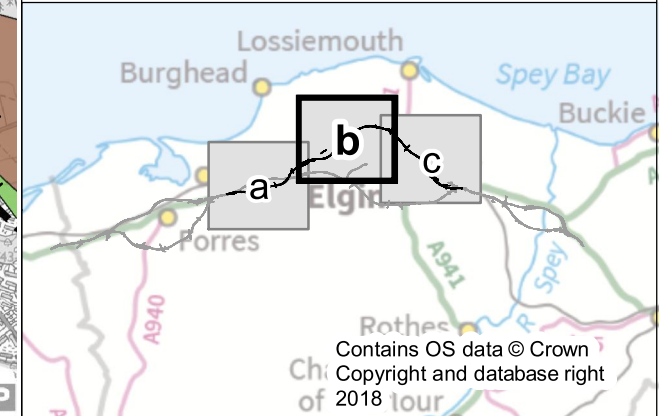
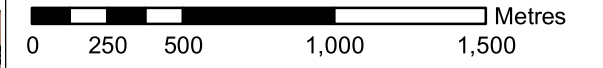

C01	27/11/2018	Approved as Stage Complete	JB	AM
Rev.	Rev. Date	Drawing Suitability	Drawn	Appr'd

Mott MacDonald Sweco



Project
**A96 Dualling
 Hardmuir to Fochabers**

Drawing Title
**Figure 9.2b Local Development Plan (LDP)
 Designated Sites and Planning Applications
 Hillhead to Lhanbryde - North Option**

Scale @ A3	1:25,000	DO NOT SCALE
Project No.	117880	Status
BIM No.	A96PHF-MMS-EGN-00000-DR-GS-00016	

This drawing should not be relied on or used in circumstances other than those for which it was originally prepared and for which the Mott MacDonald Sweco (MMS) Joint Venture was commissioned. MMS accepts no responsibility for this drawing to any party other than the person by whom it was commissioned. Any party which breaches the provisions of this disclaimer shall indemnify MMS for all loss or damage arising therefrom.

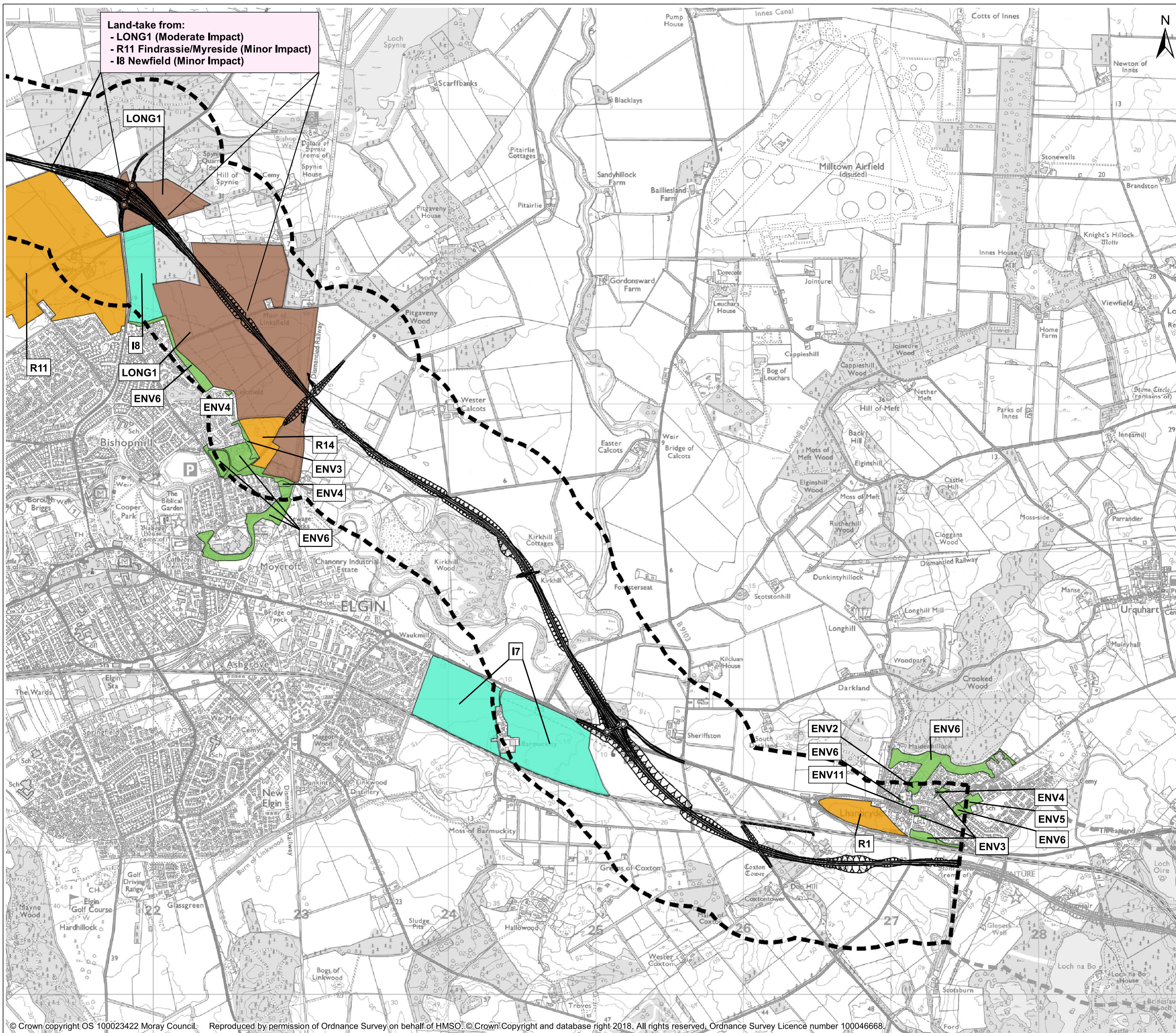

Land-take from:
 - LONG1 (Moderate Impact)
 - R11 Findrassie/Myreside (Minor Impact)
 - I8 Newfield (Minor Impact)

Legend

- Route Option
- 500m Buffer

Moray Local Development Plan 2015 - Designated Sites

- Business Park
- Environmental
- Flood Alleviation
- Industrial
- Long Term Residential
- Opportunity
- Residential
- Amenity
- Tourism

Land-take Land-take from designated sites and planning applications

Note: Refer to Appendix 9.2 and 9.3 for details of sites

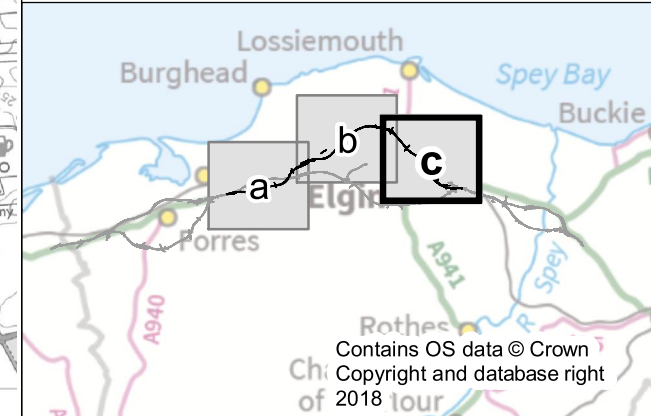
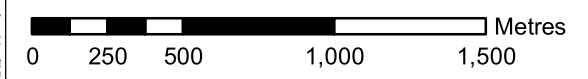

C01	27/11/2018	Approved as Stage Complete	JB	AM
Rev.	Rev. Date	Drawing Suitability	Drawn	Appr'd

Mott MacDonald Sweco

AS9 DUALLING
 HARDMUIR TO FOCHABERS

Project: **A96 Dualling Hardmuir to Fochabers**

Drawing Title: **Figure 9.2c Local Development Plan (LDP) Designated Sites and Planning Applications Hillhead to Lhanbryde - North Option**

Scale @ A3	1:25,000	DO NOT SCALE
Project No.	117880	Status A2
BIM No.	A96PHF-MMS-EGN-00000-DR-GS-00016	

This drawing should not be relied on or used in circumstances other than those for which it was originally prepared and for which the Mott MacDonald Sweco (MMS) Joint Venture was commissioned. MMS accepts no responsibility for this drawing to any party other than the person by whom it was commissioned. Any party which breaches the provisions of this disclaimer shall indemnify MMS for all loss or damage arising therefrom.

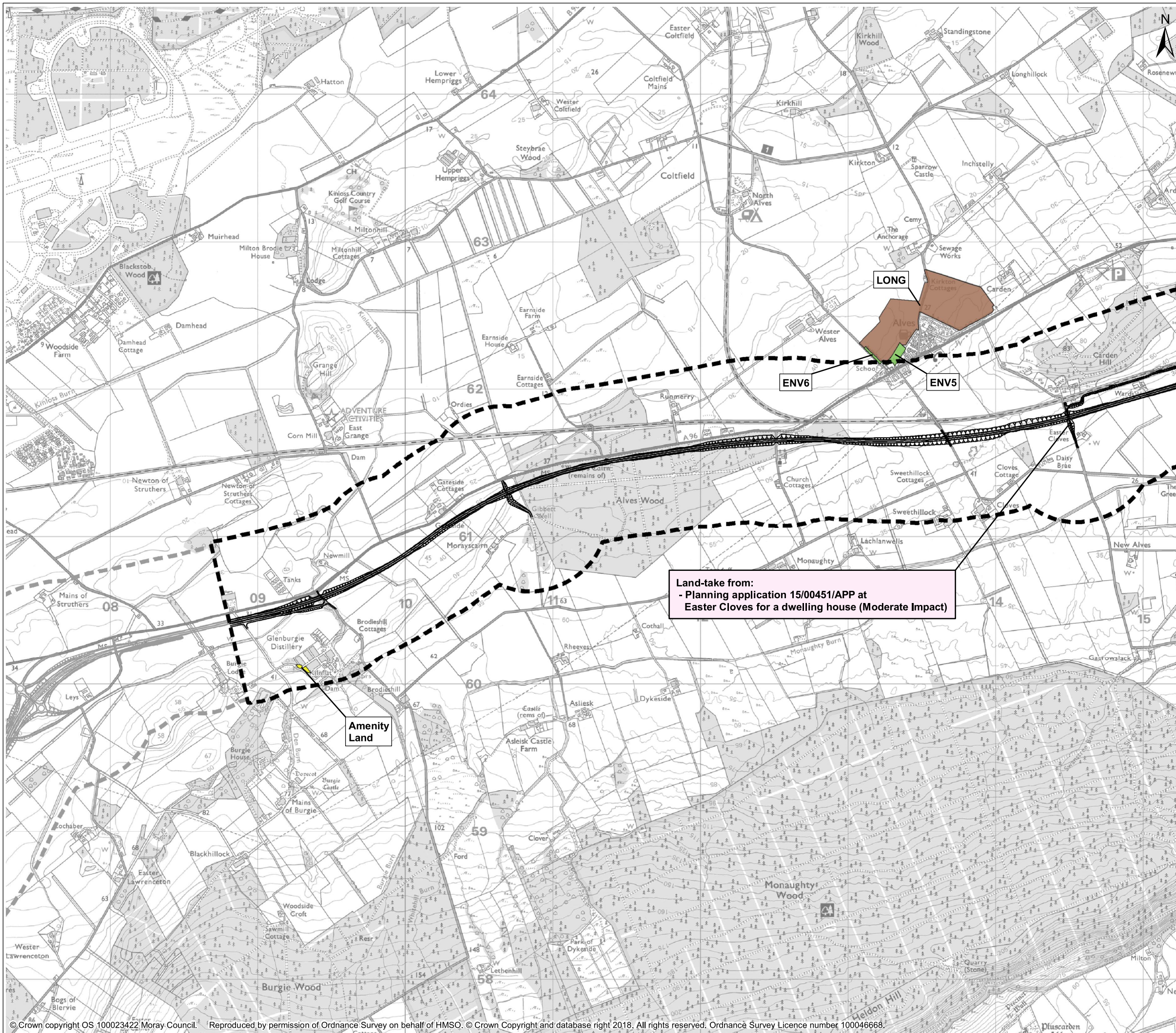

Legend

-  Route Option
-  500m Buffer
- Moray Local Development Plan 2015 - Designated Sites**
-  Business Park
-  Environmental
-  Flood Alleviation
-  Industrial
-  Long Term Residential
-  Opportunity
-  Residential
-  Amenity
-  Tourism
-  Land-take from designated sites and planning applications

Note: Refer to Appendix 9.2 and 9.3 for details of sites

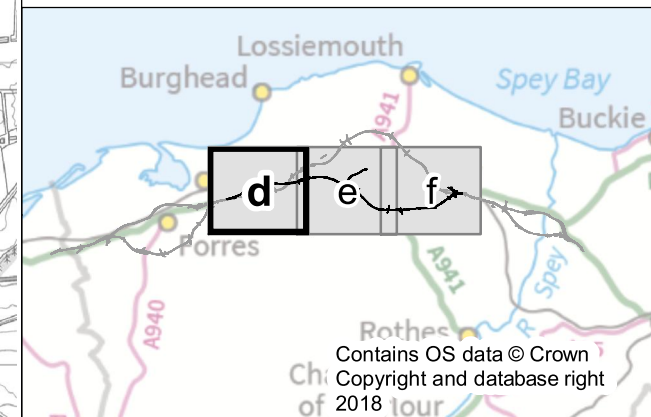

C01	27/11/2018	Approved as Stage Complete	JB	AM
Rev.	Rev. Date	Drawing Suitability	Drawn	Appr'd

Mott MacDonald Sweco



Project
**A96 Dualling
Hardmuir to Fochabers**

Drawing Title
**Figure 9.2d Local Development Plan (LDP)
Designated Sites and Planning Applications
Hillhead to Lhanbryde - South Option**

Scale @ A3	1:25,000	DO NOT SCALE
Project No.	117880	Status A2
BIM No.	A96PHF-MMS-EGN-00000-DR-GS-00016	

This drawing should not be relied on or used in circumstances other than those for which it was originally prepared and for which the Mott MacDonald Sweco (MMS) Joint Venture was commissioned. MMS accepts no responsibility for this drawing to any party other than the person by whom it was commissioned. Any party which breaches the provisions of this disclaimer shall indemnify MMS for all loss or damage arising therefrom.

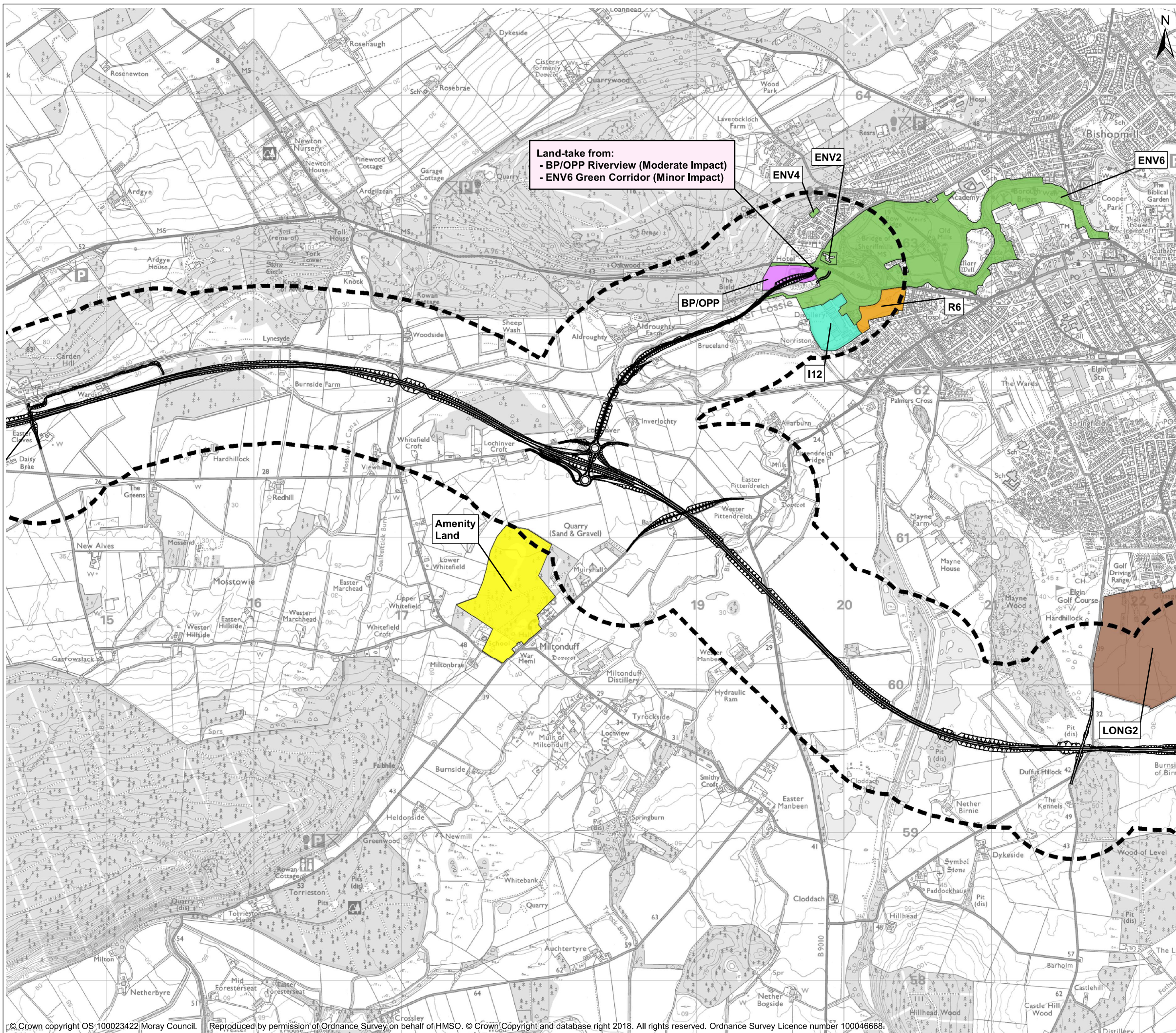

Land-take from:
 - BP/OPP Riverview (Moderate Impact)
 - ENV6 Green Corridor (Minor Impact)

Amenity Land

Legend

- Route Option
 - 500m Buffer
 - Moray Local Development Plan 2015 - Designated Sites**
 - Business Park
 - Environmental
 - Flood Alleviation
 - Industrial
 - Long Term Residential
 - Opportunity
 - Residential
 - Amenity
 - Tourism
 - Land-take
- Land-take from designated sites and planning applications

Note: Refer to Appendix 9.2 and 9.3 for details of sites

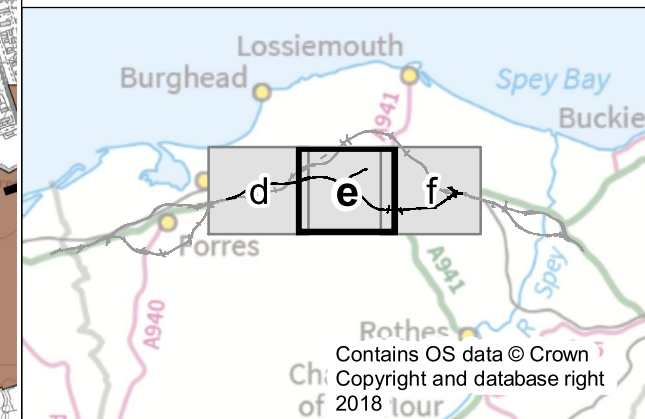

C01	27/11/2018	Approved as Stage Complete	JB	AM
Rev.	Rev. Date	Drawing Suitability	Drawn	Appr'd

Mott MacDonald Sweco



Project
**A96 Dualling
 Hardmuir to Fochabers**

Drawing Title
**Figure 9.2e Local Development Plan (LDP)
 Designated Sites and Planning Applications
 Hillhead to Lhanbryde - South Option**

Scale @ A3	1:25,000	DO NOT SCALE
Project No.	117880	Status A2
BIM No.	A96PHF-MMS-EGN-00000-DR-GS-00016	

This drawing should not be relied on or used in circumstances other than those for which it was originally prepared and for which the Mott MacDonald Sweco (MMS) Joint Venture was commissioned. MMS accepts no responsibility for this drawing to any party other than the person by whom it was commissioned. Any party which breaches the provisions of this disclaimer shall indemnify MMS for all loss or damage arising therefrom.

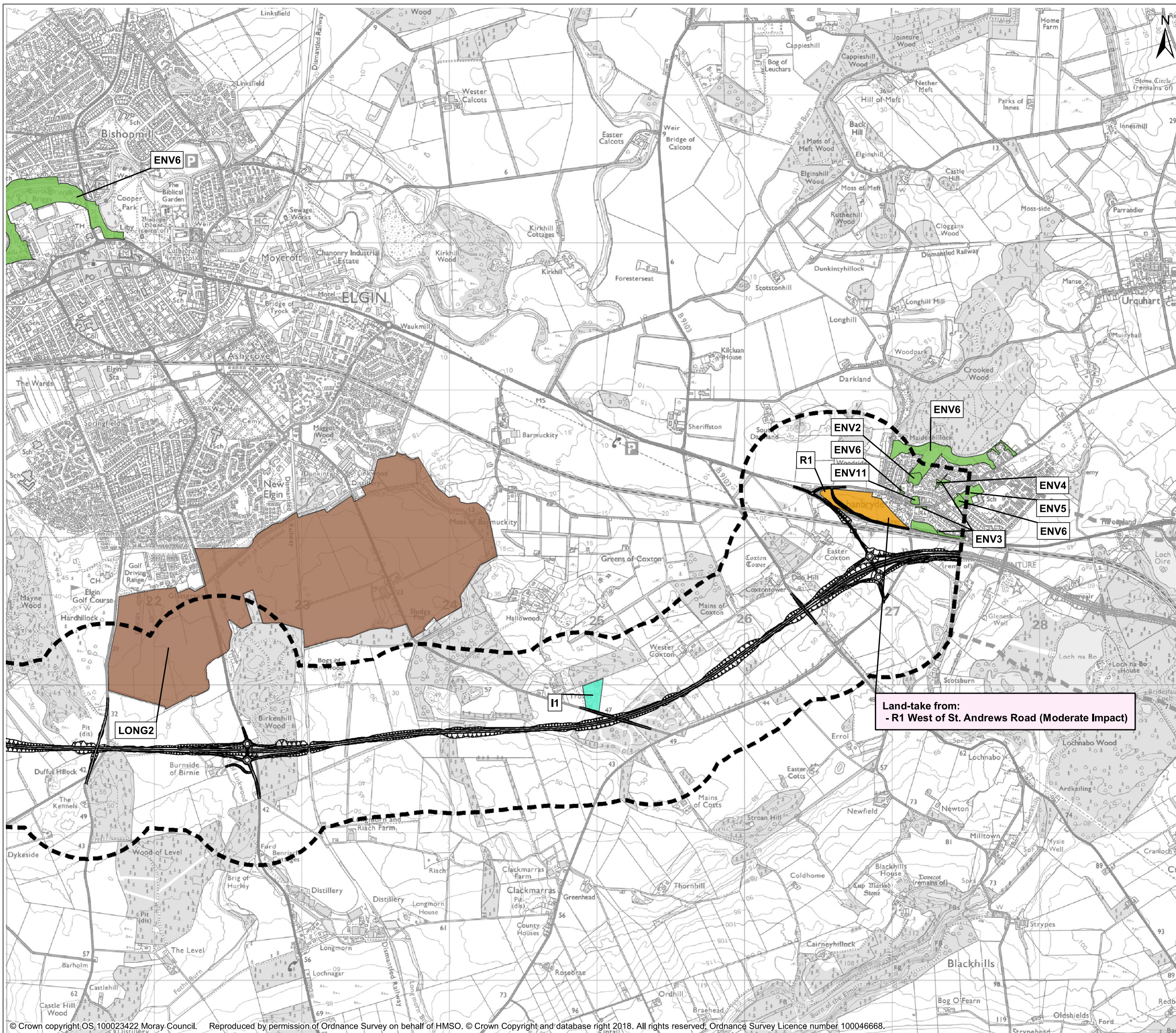

Legend

- Route Option
- 500m Buffer

Moray Local Development Plan 2015 - Designated Sites

- Business Park
- Environmental
- Flood Alleviation
- Industrial
- Long Term Residential
- Opportunity
- Residential
- Amenity
- Tourism

Land-take from designated sites and planning applications

Note: Refer to Appendix 9.2 and 9.3 for details of sites

Contains OS data © Crown Copyright and database right 2018

Land-take from:
- R1 West of St. Andrews Road (Moderate Impact)

C01	27/11/2018	Approved as Stage Complete	JB	AM
Rev.	Rev. Date	Drawing Suitability	Drawn	Appr'd

Mott MacDonald Sweco



Project: **A96 Dualling Hardmuir to Fochabers**

Drawing Title: **Figure 9.2f Local Development Plan (LDP) Designated Sites and Planning Applications Hillhead to Lhanbryde - South Option**

Scale @ A3	1:25,000	DO NOT SCALE
Project No.	117880	Status A2
BIM No.	A96PHF-MMS-EGN-00000-DR-GS-00016	

This drawing should not be relied on or used in circumstances other than those for which it was originally prepared and for which the Mott MacDonald Sweco (MMS) Joint Venture was commissioned. MMS accepts no responsibility for this drawing to any party other than the person by whom it was commissioned. Any party which breaches the provisions of this disclaimer shall indemnify MMS for all loss or damage arising therefrom.