

Legend

- Route Option
- 500m Buffer
- Moray Local Development Plan 2015 - Designated Sites**
- Business Park
- Environmental
- Flood Alleviation
- Industrial
- Long Term Residential
- Opportunity
- Residential
- Amenity
- Tourism
- Land-take

Land-take from designated sites and planning applications

Note: Refer to Appendix 9.2 and 9.3 for details of sites

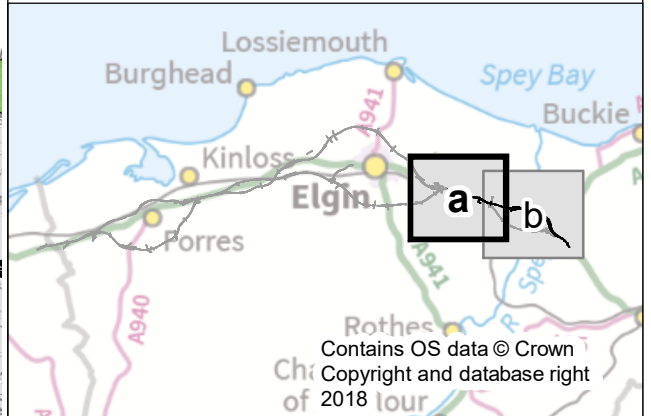

Land-take from:
 - Planning application 18/00392/APP at
 Wester Marchfield for farm buildings (Major Impact)

C01	27/11/2018	Approved as Stage Complete	JB	AM
Rev.	Rev. Date	Drawing Suitability	Drawn	Appr'd

Mott MacDonald Sweco

Project
**A96 Dualling
 Hardmuir to Fochabers**

Drawing Title
**Figure 9.3a Local Development Plan (LDP)
 Designated Sites and Planning Applications
 Lhanbryde to East of Fochabers - North Option**

Scale @ A3	1:25,000	DO NOT SCALE
Project No.	117880	Status A2
BIM No.	A96PHF-MMS-EGN-00000-DR-GS-00017	

This drawing should not be relied on or used in circumstances other than those for which it was originally prepared and for which the Mott MacDonald Sweco (MMS) Joint Venture was commissioned. MMS accepts no responsibility for this drawing to any party other than the person by whom it was commissioned. Any party which breaches the provisions of this disclaimer shall indemnify MMS for all loss or damage arising therefrom.

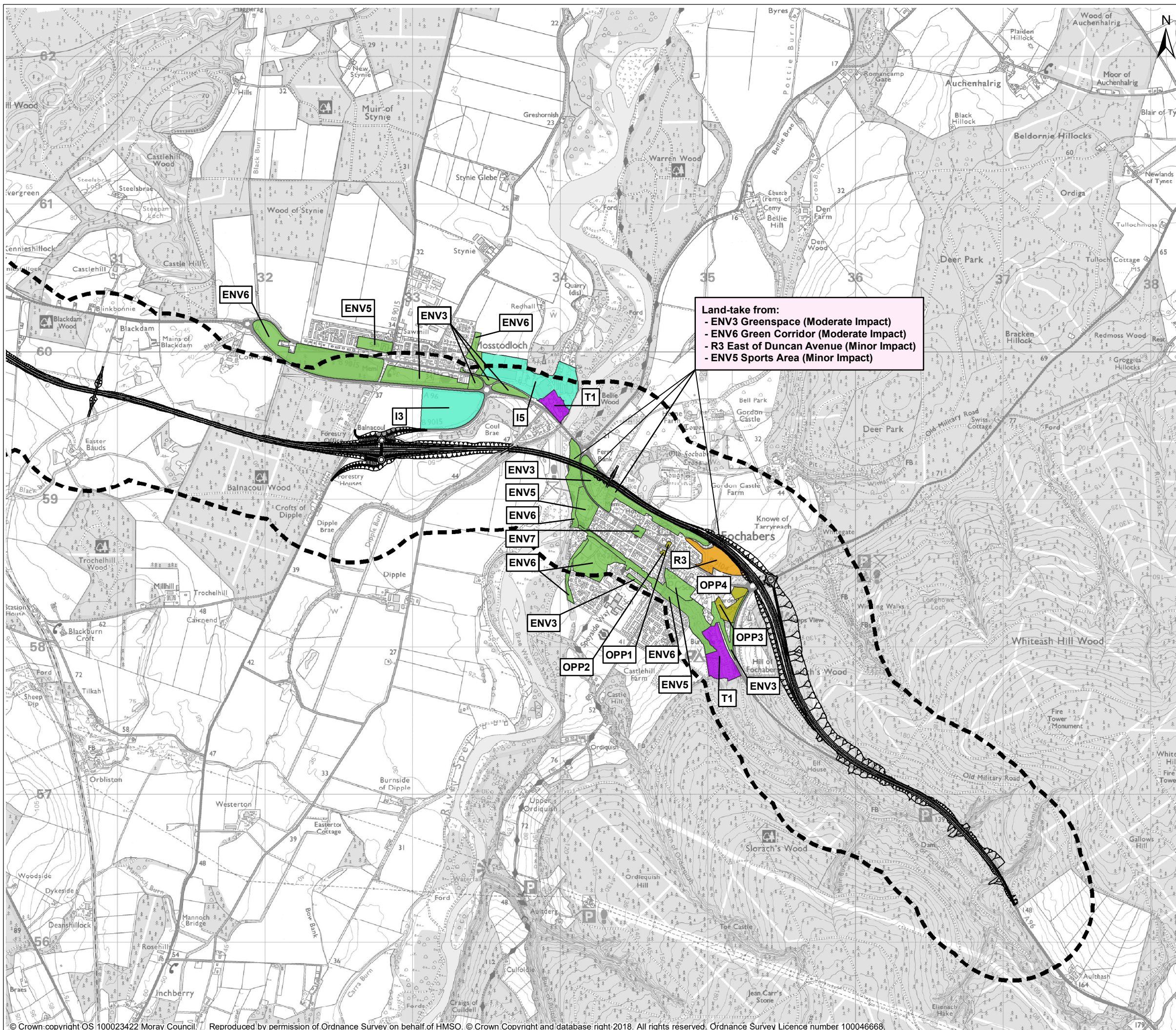

Legend

- Route Option
- ⬜ 500m Buffer

Moray Local Development Plan 2015 - Designated Sites

- Business Park
- Environmental
- Flood Alleviation
- Industrial
- Long Term Residential
- Opportunity
- Residential
- Amenity
- Tourism

Land-take Land-take from designated sites and planning applications

Note: Refer to Appendix 9.2 and 9.3 for details of sites

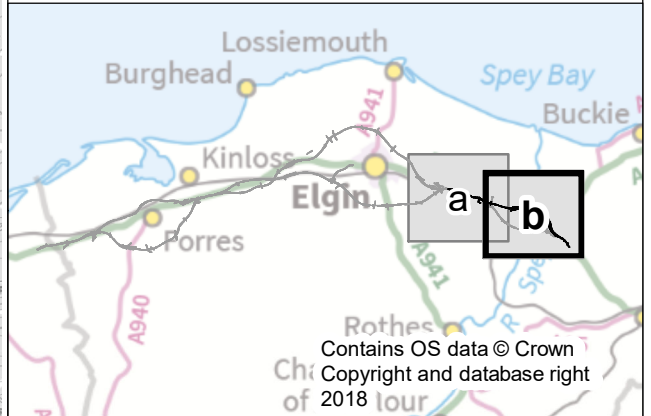
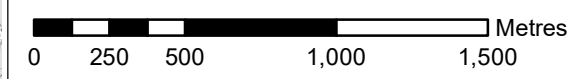

C01	27/11/2018	Approved as Stage Complete	JB	AM
Rev.	Rev. Date	Drawing Suitability	Drawn	Appr'd

Mott MacDonald Sweco



Project
**A96 Dualling
Hardmuir to Fochabers**

Drawing Title
**Figure 9.3b Local Development Plan (LDP)
Designated Sites and Planning Applications
Lhanbryde to East of Fochabers - North Option**

Scale @ A3	1:25,000	DO NOT SCALE
Project No.	117880	Status A2
BIM No.	A96PHF-MMS-EGN-0000-DR-GS-00017	

This drawing should not be relied on or used in circumstances other than those for which it was originally prepared and for which the Mott MacDonald Sweco (MMS) Joint Venture was commissioned. MMS accepts no responsibility for this drawing to any party other than the person by whom it was commissioned. Any party which breaches the provisions of this disclaimer shall indemnify MMS for all loss or damage arising therefrom.

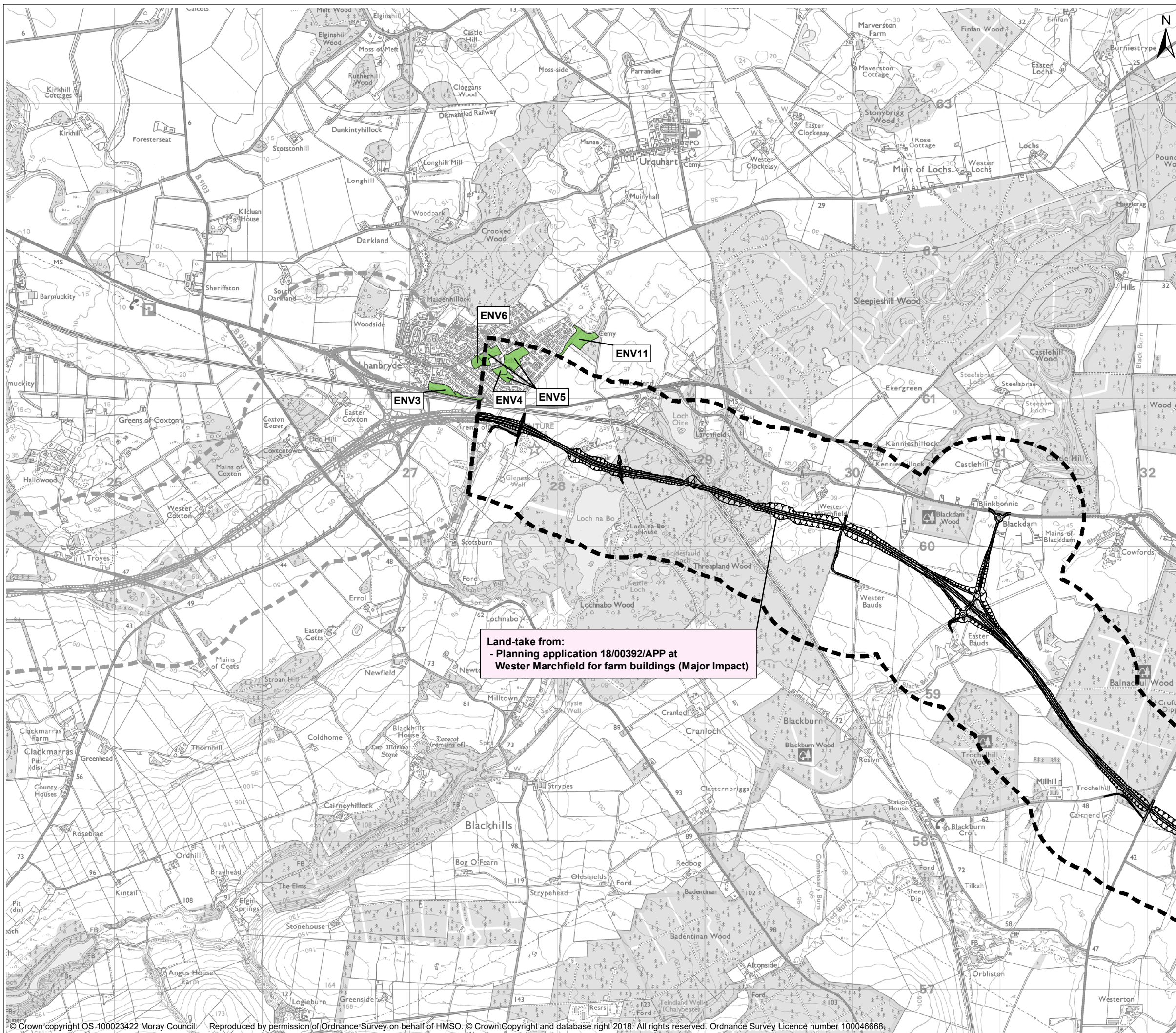

Legend

- Route Option
- 500m Buffer
- Moray Local Development Plan 2015 - Designated Sites
- Business Park
- Environmental
- Flood Alleviation
- Industrial
- Long Term Residential
- Opportunity
- Residential
- Amenity
- Tourism
- Land-take

Land-take from designated sites and planning applications

Note: Refer to Appendix 9.2 and 9.3 for details of sites

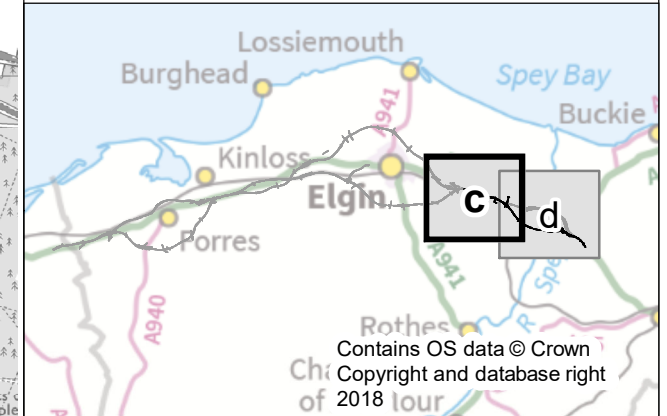
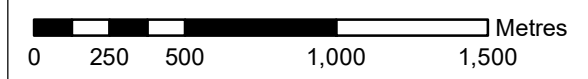

C01	27/11/2018	Approved as Stage Complete	JB	AM
Rev.	Rev. Date	Drawing Suitability	Drawn	Appr'd

Mott MacDonald Sweco

ASS DUALING
HARDMUIR TO FOCHABERS

Project **A96 Dualling
Hardmuir to Fochabers**

Drawing Title **Figure 9.3c Local Development Plan (LDP)
Designated Sites and Planning Applications
Lhanbryde to East of Fochabers - South Option**

Scale @ A3	1:25,000	DO NOT SCALE
Project No.	117880	Status A2
BIM No.	A96PHF-MMS-EGN-00000-DR-GS-00017	

This drawing should not be relied on or used in circumstances other than those for which it was originally prepared and for which the Mott MacDonald Sweco (MMS) Joint Venture was commissioned. MMS accepts no responsibility for this drawing to any party other than the person by whom it was commissioned. Any party which breaches the provisions of this disclaimer shall indemnify MMS for all loss or damage arising therefrom.

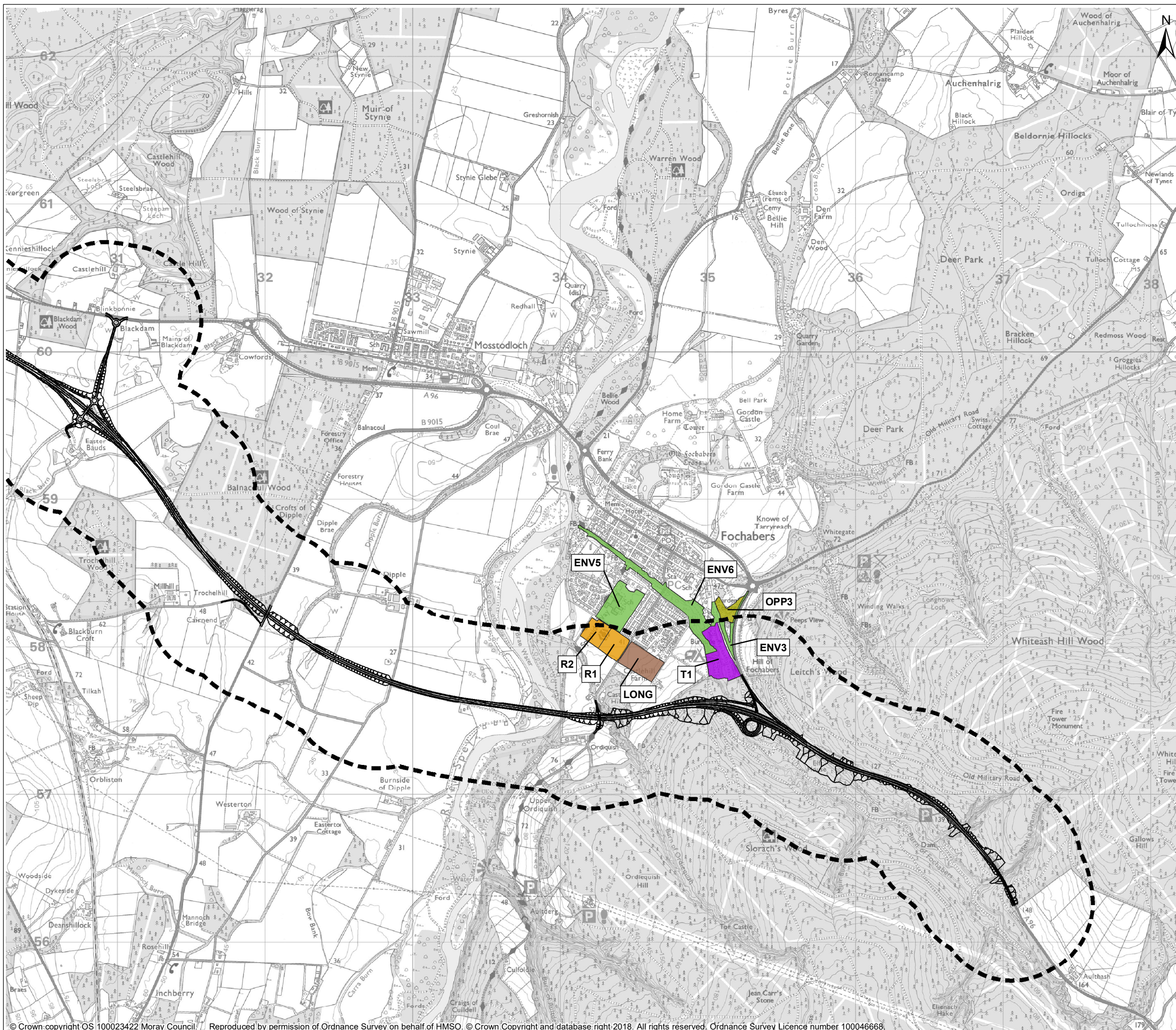

Legend

- Route Option
- 500m Buffer

Moray Local Development Plan 2015 - Designated Sites

- Business Park
- Environmental
- Flood Alleviation
- Industrial
- Long Term Residential
- Opportunity
- Residential
- Amenity
- Tourism

Land-take from designated sites and planning applications

Note: Refer to Appendix 9.2 and 9.3 for details of sites

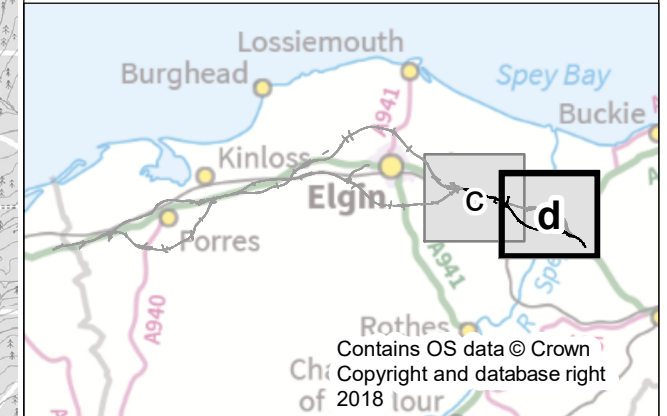
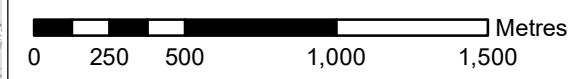

C01	27/11/2018	Approved as Stage Complete	JB	AM
Rev.	Rev. Date	Drawing Suitability	Drawn	Appr'd

Mott MacDonald Sweco



Project
**A96 Dualling
Hardmuir to Fochabers**

Drawing Title
**Figure 9.3d Local Development Plan (LDP)
Designated Sites and Planning Applications
Lhanbryde to East of Fochabers - South Option**

Scale @ A3	1:25,000	DO NOT SCALE
Project No.	117880	Status A2
BIM No.	A96PHF-MMS-EGN-0000-DR-GS-00017	

This drawing should not be relied on or used in circumstances other than those for which it was originally prepared and for which the Mott MacDonald Sweco (MMS) Joint Venture was commissioned. MMS accepts no responsibility for this drawing to any party other than the person by whom it was commissioned. Any party which breaches the provisions of this disclaimer shall indemnify MMS for all loss or damage arising therefrom.