

Reproduced by permission of Ordnance Survey on behalf of HMSO © Crown copyright and database right (2018). All rights reserved. Ordnance Survey Licence number 100046668
 Contains public sector information licensed under the Open Government Licence v3.0.

CN01_002- LONGSECTION
 SCALE: H 1:10000, V 1:2000. DATUM= 149.000

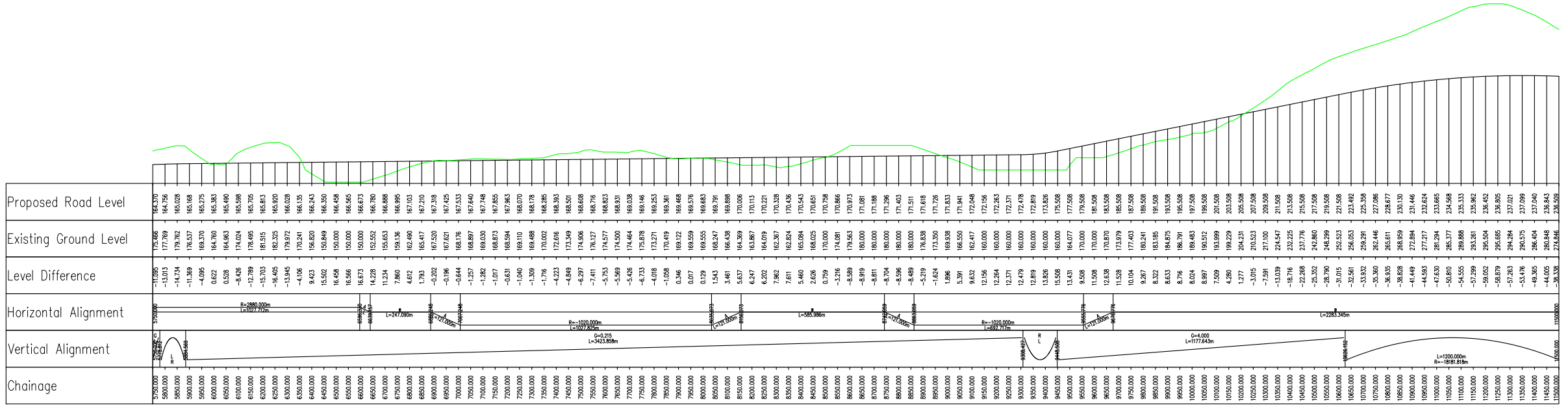

P01	Fit For Information - First Fix Alignment				
	SM	GK	CL	CB	GMacD
	02/03/18	02/03/18	02/03/18	02/03/18	02/03/18
Revision	Revision details				
	Created	Checked	Reviewed	Approved	Authorised
	dd/mm/yy	dd/mm/yy	dd/mm/yy	dd/mm/yy	dd/mm/yy

Designer
 Precision House
 McNeil Drive
 Motherwell
 ML1 4UR



Client
 58 Port Dundas Road
 Glasgow
 G4 0HF



Project Name
 A96 Dualling East of Huntly to Aberdeen

Drawing Title
 CN01_002 First Fix Alignment
 Plan and Profile
 Sheet 2 of 5

Project Ref. No.	Stage	Scale: 1:10000H 1:2000V @ A1
250002-92	2	Dimensions: m

Drawing Number
 Project | Originator | Volume |
 A69PEA - AMAR - HGN -
 CC - DR-CH- 001202
 Location | Type | Role | Number

Suitability	Suitability Description	Revision
S2	Fit For Information	P01

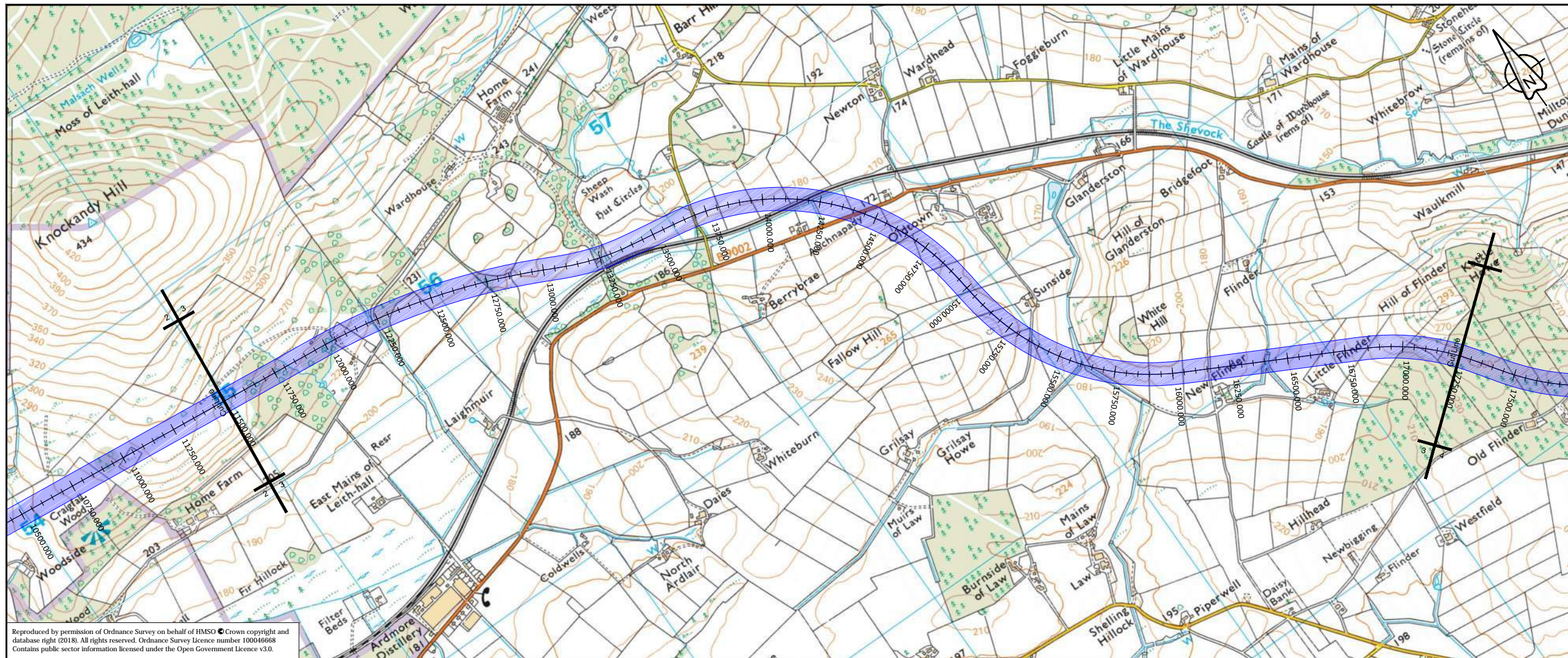

Reproduced by permission of Ordnance Survey on behalf of HMSO © Crown copyright and database right (2018). All rights reserved. Ordnance Survey Licence number 100046668. Contains public sector information licensed under the Open Government Licence v3.0.

CN01_002- LONGSECTION
SCALE: H 1:10000, V 1:2000. DATUM= 169.000

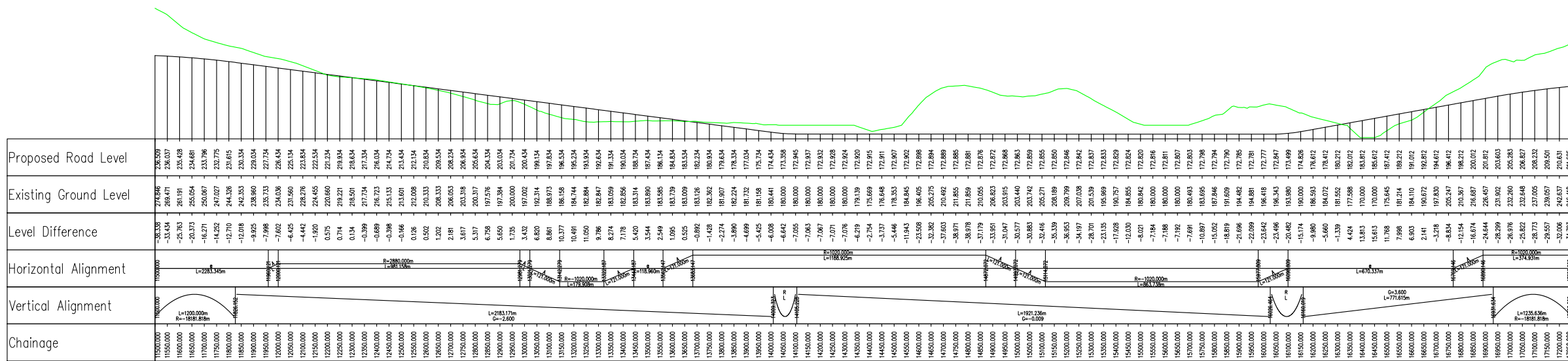

P01	Fit For Information - First Fix Alignment				
	SM	GK	CL	CB	GMacD
	02/03/18	02/03/18	02/03/18	02/03/18	02/03/18
Revision	Revision details				
	Created	Checked	Reviewed	Approved	Authorised
	dd/mm/yy	dd/mm/yy	dd/mm/yy	dd/mm/yy	dd/mm/yy

Designer
Precision House
McNeil Drive
Motherwell
ML1 4UR



Client
58 Port Dundas Road
Glasgow
G4 0HF



Project Name
A96 Dualling East of Huntly to
Aberdeen

Drawing Title
CN01_002 First Fix Alignment
Plan and Profile

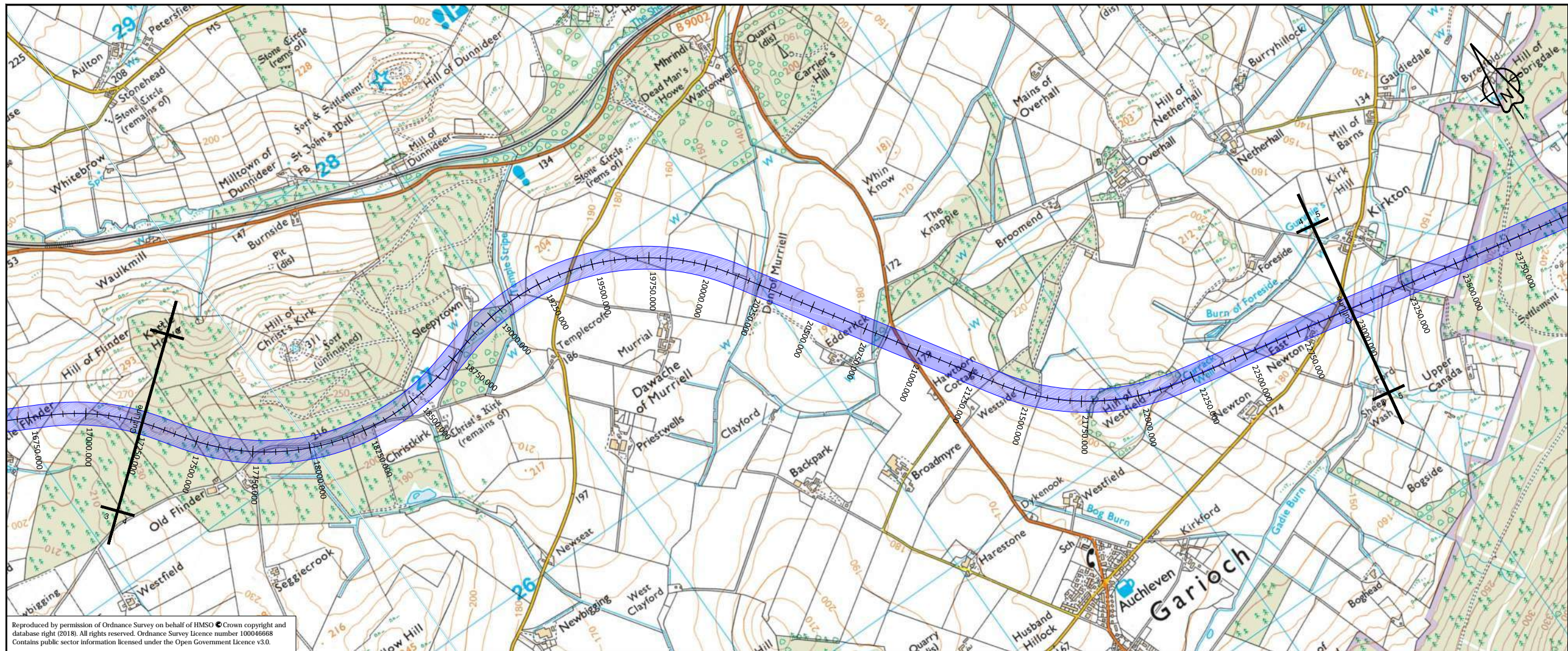

Reproduced by permission of Ordnance Survey on behalf of HMSO © Crown copyright and database right (2018). All rights reserved. Ordnance Survey Licence number 100046668
Contains public sector information licensed under the Open Government Licence v3.0.

CN01_002-LONGSECTION
SCALE: H 1:10000, V 1:2000, DATUM= 149.000

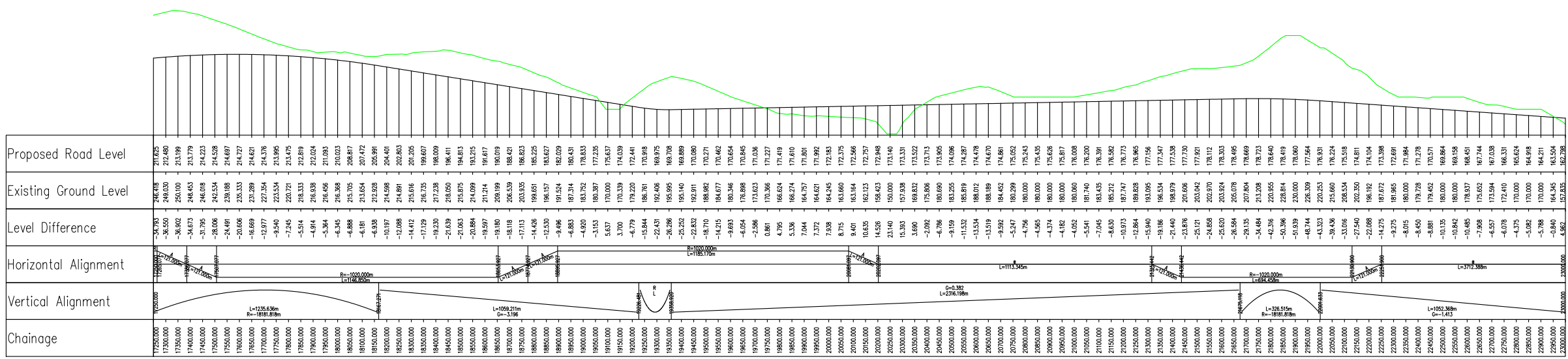

P01	Fit For Information - First Fix Alignment				
	SM	GK	CL	CB	GMacD
	02/03/18	02/03/18	02/03/18	02/03/18	02/03/18

Revision details

Created	Checked	Reviewed	Approved	Authorised
dd/mm/yy	dd/mm/yy	dd/mm/yy	dd/mm/yy	dd/mm/yy

Designer
Precision House
McNeil Drive
Motherwell
ML1 4UR

Client
58 Port Dundas Road
Glasgow
G4 0HF

Project Name
A96 Dualling East of Huntly to Aberdeen

Drawing Title
CN01_002 First Fix Alignment
Plan and Profile
Sheet 4 of 5

Project Ref. No.	Stage	Scale
250002-92	2	1:10000H 1:2000V @ A1

Dimensions: m

Project	Originator	Volume
A69PEA	AMAR	HGN

CC -DR-CH-001204
Location | Type | Role | Number

Suitability	Suitability Description	Revision
S2	Fit For Information	P01



Reproduced by permission of Ordnance Survey on behalf of HMSO © Crown copyright and database right (2018). All rights reserved. Ordnance Survey Licence number 100046668
 Contains public sector information licensed under the Open Government Licence v3.0.

CN01_002- LONGSECTION
 SCALE: H 1:10000, V 1:2000. DATUM= 139.000

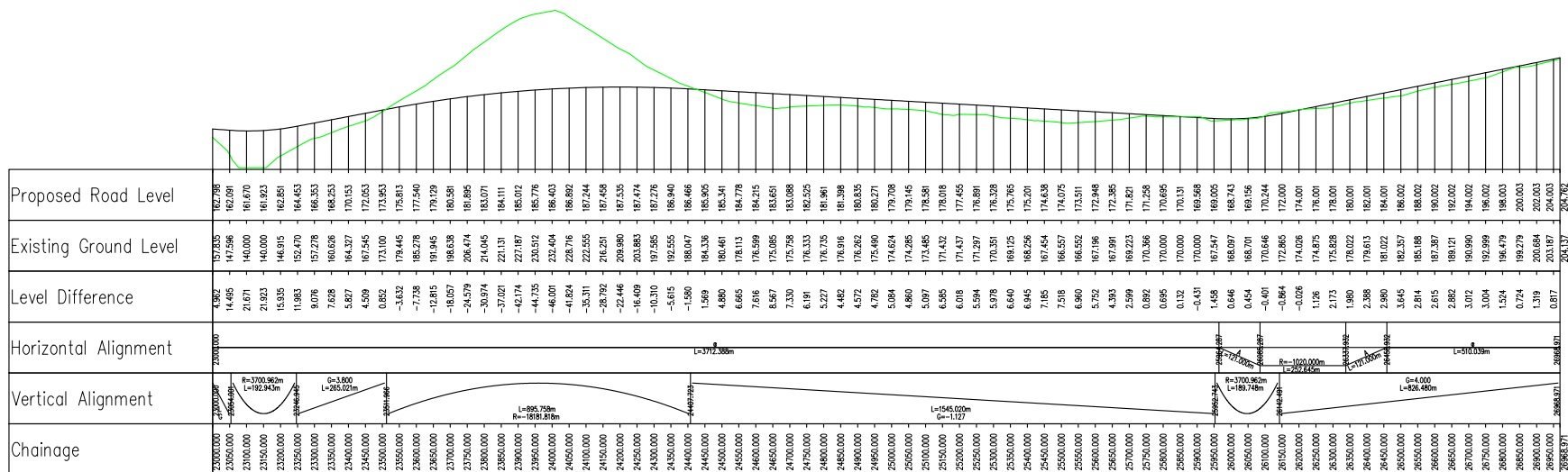

P01	Fit For Information - First Fix Alignment				
	SM	GK	CL	CB	GMacD
	02/03/18	02/03/18	02/03/18	02/03/18	02/03/18
Revision	Revision details				
	Created	Checked	Reviewed	Approved	Authorised
	dd/mm/yy	dd/mm/yy	dd/mm/yy	dd/mm/yy	dd/mm/yy

Designer
 Precision House
 McNeil Drive
 Motherwell
 ML1 4UR



Client
 58 Port Dundas Road
 Glasgow
 G4 0HF



Project Name
 A96 Dualling East of Huntly to Aberdeen

Drawing Title
 CN01_002 First Fix Alignment
 Plan and Profile
 Sheet 5 of 5

Project Ref. No. 250002-92
 Stage 2
 Scale: 1:10000H 1:2000V @ A1
 Dimensions: m

Drawing Number
 Project | Originator | Volume |
 A69PEA - AMAR - HGN -
 CC - DR-CH- 001205
 Location | Type | Role | Number

Suitability	Suitability Description	Revision
S2	Fit For Information	P01

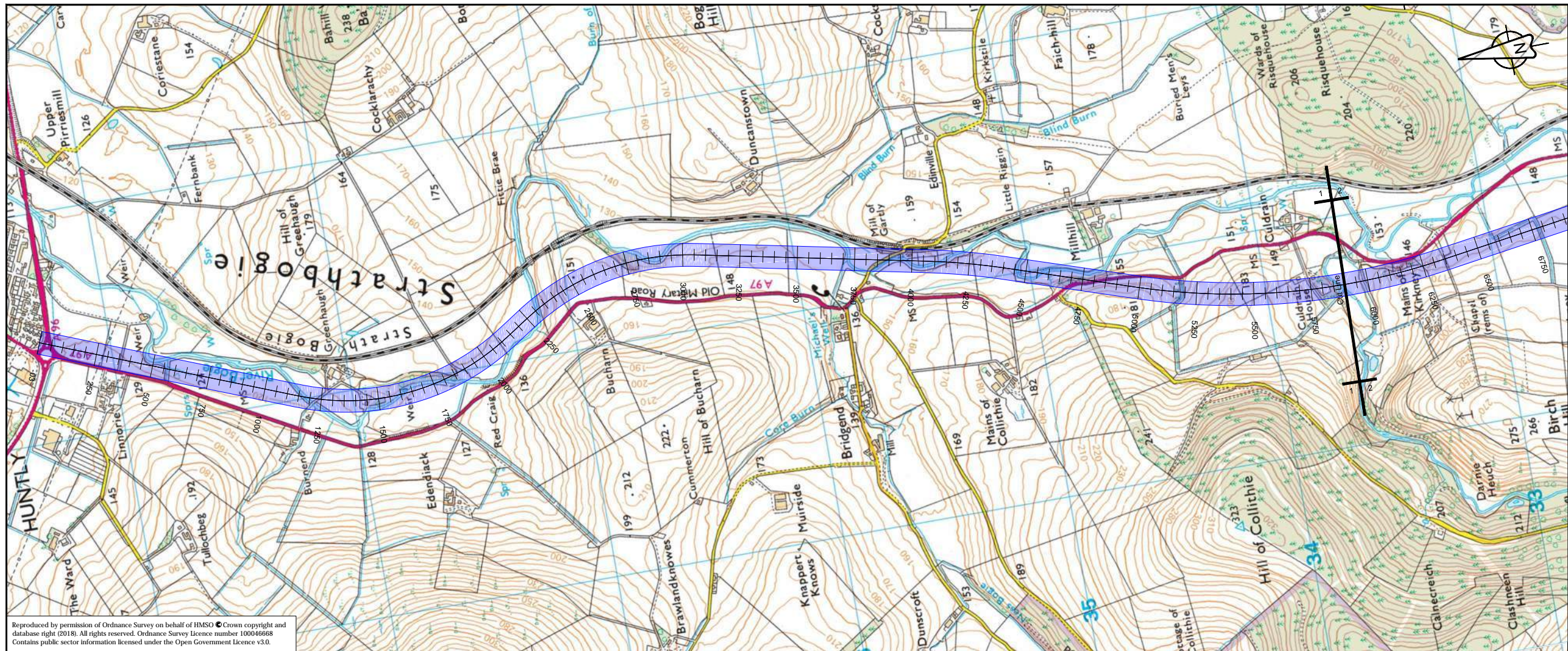

Reproduced by permission of Ordnance Survey on behalf of HMSO © Crown copyright and database right (2018). All rights reserved. Ordnance Survey Licence number 100046668
 Contains public sector information licensed under the Open Government Licence v3.0.

CN01_003- LONGSECTION
 SCALE: H 1:10000, V 1:2000, DATUM=115.000

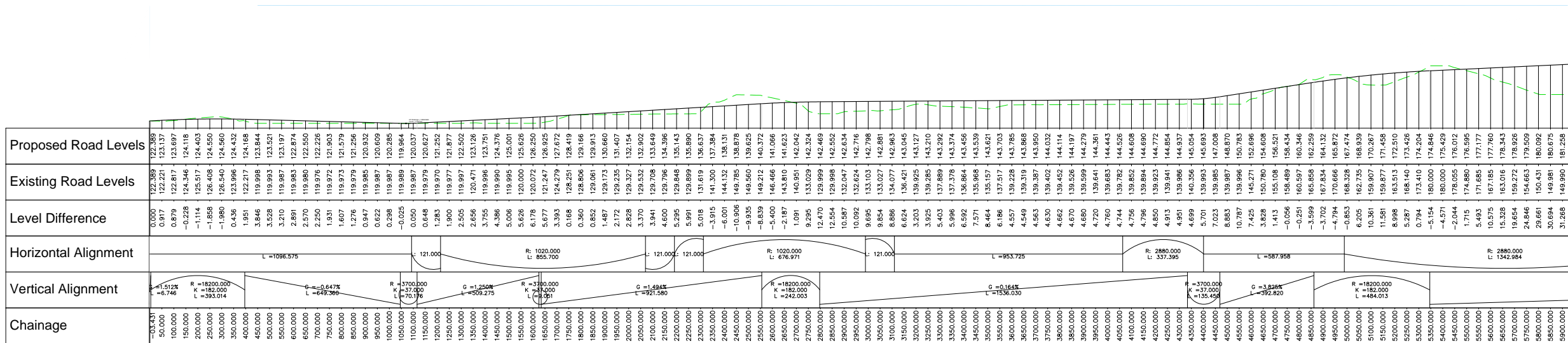

P01	Fit For Information - First Fix Alignment				
	SM	GK	CL	CB	GMacD
	02/03/18	02/03/18	02/03/18	02/03/18	02/03/18
Revision	Revision details				
	Created	Checked	Reviewed	Approved	Authorised
	dd/mm/yy	dd/mm/yy	dd/mm/yy	dd/mm/yy	dd/mm/yy

Designer
 Precision House
 McNeil Drive
 Motherwell
 ML1 4UR

Client
 58 Port Dundas Road
 Glasgow
 G4 0HF

Project Name
A96 Dualling East of Huntly to Aberdeen

Drawing Title
**CN01_003 First Fix Alignment
 Plan and Profile
 Sheet 1 of 5**

Project Ref. No.	Stage	Scale
250002-92	2	1:10000H 1:2000V @ A1
Dimensions : m		

Drawing Number	Project	Originator	Volume
CC	A96PEA	- AMAR - HGN -	
	Location	Type	Role
			Number

Suitability	Suitability Description	Revision
S2	Fit For Information	P01

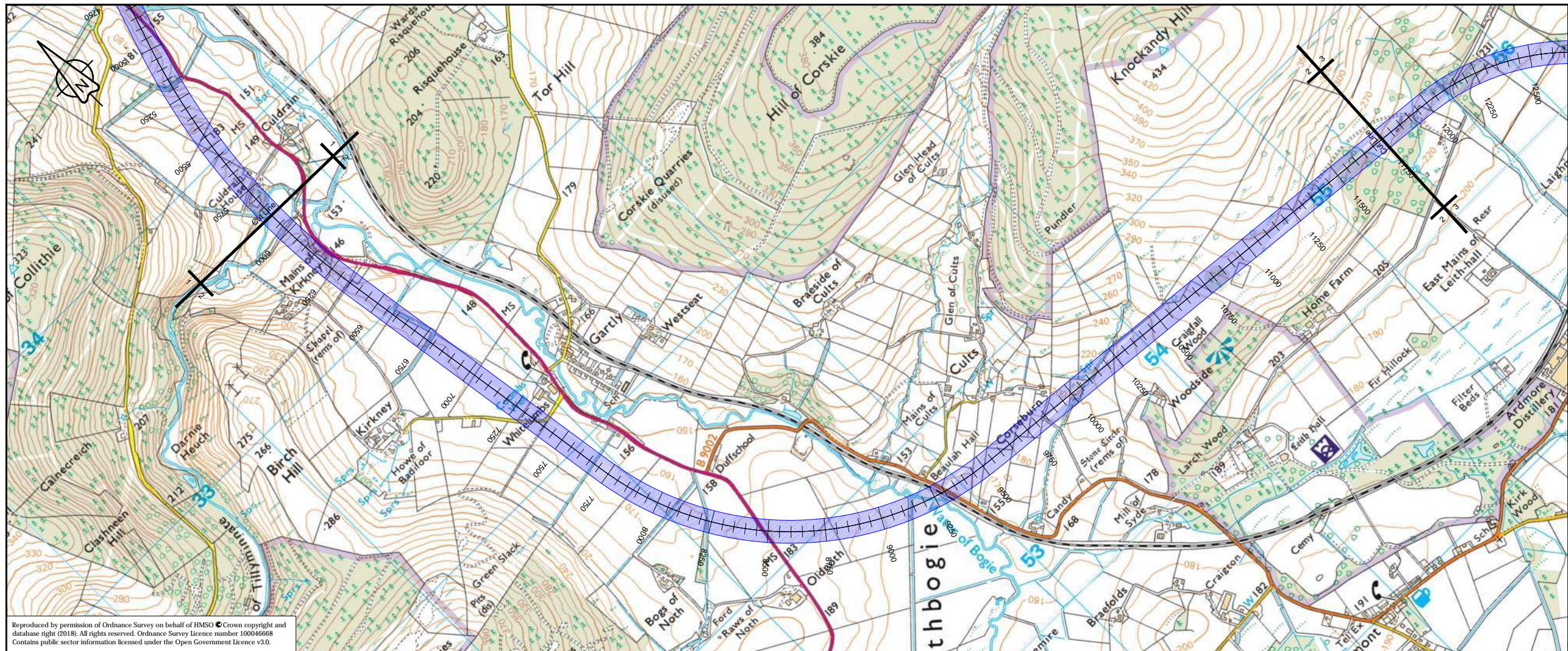

Reproduced by permission of Ordnance Survey on behalf of HMSO © Crown copyright and database right (2018). All rights reserved. Ordnance Survey Licence number 100046668
Contains public sector information licensed under the Open Government Licence v3.0.

CN01_003-LONGSECTION
SCALE: H 1:10000, V 1:2000, DATUM=115.000

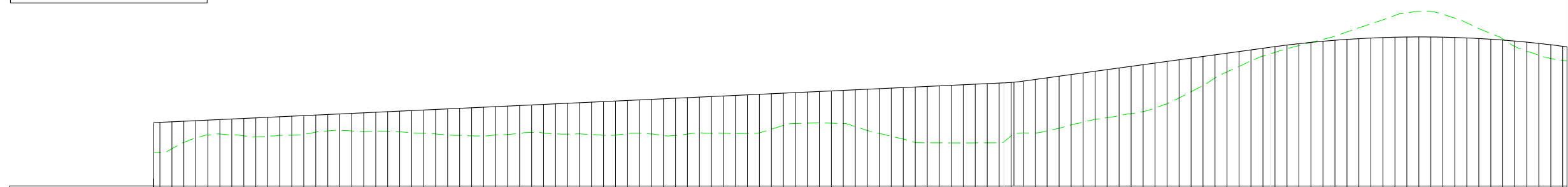

Chainage	Existing Road Levels	Proposed Road Levels	Level Difference
5900.000	149.990	161.206	11.216
5950.000	153.710	161.841	8.131
6000.000	160.384	162.424	2.040
6050.000	165.013	163.007	-1.794
6100.000	168.646	163.590	-5.056
6150.000	169.147	164.173	-4.974
6200.000	167.947	164.756	-3.191
6250.000	167.232	165.339	-1.907
6300.000	166.070	165.922	-0.152
6350.000	166.832	166.505	-0.673
6400.000	167.817	167.088	-0.271
6450.000	167.880	167.671	-0.791
6500.000	168.882	168.254	-0.372
6550.000	171.206	168.837	-2.369
6600.000	172.346	169.419	-2.927
6650.000	173.006	170.002	-3.004
6700.000	172.271	170.585	-1.686
6750.000	171.742	171.168	-0.426
6800.000	172.109	171.751	-0.358
6850.000	172.162	172.334	0.172
6900.000	171.382	172.917	1.535
6950.000	170.340	173.500	3.160
7000.000	169.988	174.083	4.095
7050.000	169.235	174.666	5.431
7100.000	168.184	175.249	7.065
7150.000	167.749	175.832	8.083
7200.000	167.181	176.415	9.234
7250.000	166.862	176.998	10.136
7300.000	168.124	177.581	9.457
7350.000	168.596	178.164	9.568
7400.000	169.741	178.747	9.006
7450.000	170.766	179.330	8.564
7500.000	170.112	179.913	9.801
7550.000	169.302	200.496	31.194
7600.000	169.037	201.079	32.041
7650.000	169.317	201.662	32.344
7700.000	168.967	202.245	33.278
7750.000	167.868	202.828	34.960
7800.000	167.971	203.411	35.439
7850.000	169.516	203.994	34.477
7900.000	170.079	204.576	34.498
7950.000	169.141	205.159	36.018
8000.000	167.865	205.742	37.876
8050.000	167.607	206.325	38.718
8100.000	169.050	206.908	37.858
8150.000	170.321	207.491	37.170
8200.000	169.865	208.074	38.209
8250.000	169.973	208.657	38.683
8300.000	169.552	209.240	39.688
8350.000	169.778	209.823	40.045
8400.000	170.441	210.406	39.964
8450.000	174.187	210.989	36.802
8500.000	178.649	211.572	33.523
8550.000	180.065	212.155	32.090
8600.000	180.393	212.738	32.345
8650.000	180.704	213.320	32.616
8700.000	180.391	213.903	33.513
8750.000	180.069	214.486	34.418
8800.000	178.830	215.069	36.239
8850.000	172.825	215.652	42.827
8900.000	169.802	216.235	46.433
8950.000	166.775	216.818	50.043
9000.000	163.941	217.401	53.460
9050.000	160.249	217.984	57.735
9100.000	159.948	218.567	58.619
9150.000	159.893	219.150	59.257
9200.000	159.839	219.733	59.894
9250.000	159.810	220.316	60.506
9300.000	159.861	220.899	61.037
9350.000	159.916	221.482	61.564
9400.000	159.981	222.065	62.084
9450.000	167.200	222.773	55.573
9500.000	170.229	223.405	53.877
9550.000	170.187	224.038	53.850
9600.000	172.620	224.671	54.907
9650.000	175.191	225.304	54.048
9700.000	178.550	225.937	52.401
9750.000	181.448	226.570	51.214
9800.000	184.352	227.203	50.022
9850.000	186.148	227.836	49.693
9900.000	188.198	228.469	49.257
9950.000	190.251	229.102	48.857
10000.000	192.363	229.735	47.048
10050.000	195.883	230.368	44.005
10100.000	200.637	231.001	39.707
10150.000	206.647	231.634	35.010
10200.000	213.055	232.267	30.293
10250.000	219.864	232.900	24.037
10300.000	227.461	233.533	19.405
10350.000	233.796	234.166	15.331
10400.000	239.381	234.800	11.480
10450.000	245.143	235.433	8.231
10500.000	250.104	236.066	5.926
10550.000	254.111	236.700	3.735
10600.000	257.895	237.333	1.961
10650.000	261.125	237.966	0.062
10700.000	264.343	238.600	-1.933
10750.000	267.519	239.233	-4.279
10800.000	270.906	239.866	-7.769
10850.000	273.506	240.500	-11.324
10900.000	279.629	241.133	-14.846
10950.000	283.783	241.766	-18.502
11000.000	287.933	242.400	-22.577
11050.000	292.365	243.033	-24.874
11100.000	294.881	243.666	-26.601
11150.000	296.691	244.300	-28.548
11200.000	298.583	244.933	-29.753
11250.000	299.956	245.566	-29.193
11300.000	299.706	246.200	-15.705
11350.000	284.750	246.833	-10.394
11400.000	278.835	247.466	-5.967
11450.000	273.665	248.100	-1.182
11500.000	268.002	248.733	5.627
11550.000	260.175	249.366	9.503
11600.000	255.145	250.000	12.342
11650.000	251.015	250.633	14.207
11700.000	247.721	251.266	14.658
11750.000	245.704	251.900	14.658

P01	Fit For Information - First Fix Alignment				
	SM	GK	CL	CB	GMacD
	02/03/18	02/03/18	02/03/18	02/03/18	02/03/18

Revision	Revision details				
	Created	Checked	Reviewed	Approved	Authorised
	dd/mm/yy	dd/mm/yy	dd/mm/yy	dd/mm/yy	dd/mm/yy

Designer
Precision House
McNeill Drive
Motherwell
ML1 4UR



Client
58 Port Dundas Road
Glasgow
G4 0HF



Project Name
A96 Dualling East of Huntly to Aberdeen

Drawing Title
CN01_003 First Fix Alignment
Plan and Profile
Sheet 2 of 5

Project Ref. No. 250002-92	Stage 2	Scale: 1:10000H 1:2000V @ A1 Dimensions: m
-------------------------------	------------	-----------------------------------------------

Drawing Number	Project	Originator	Volume
	A96PEA	- AMAR -	HGN -
	CC	-DR-CH-	001302
	Location	Type	Role

Suitability S2	Suitability Description Fit For Information	Revision P01
-------------------	------------------------------------------------	-----------------

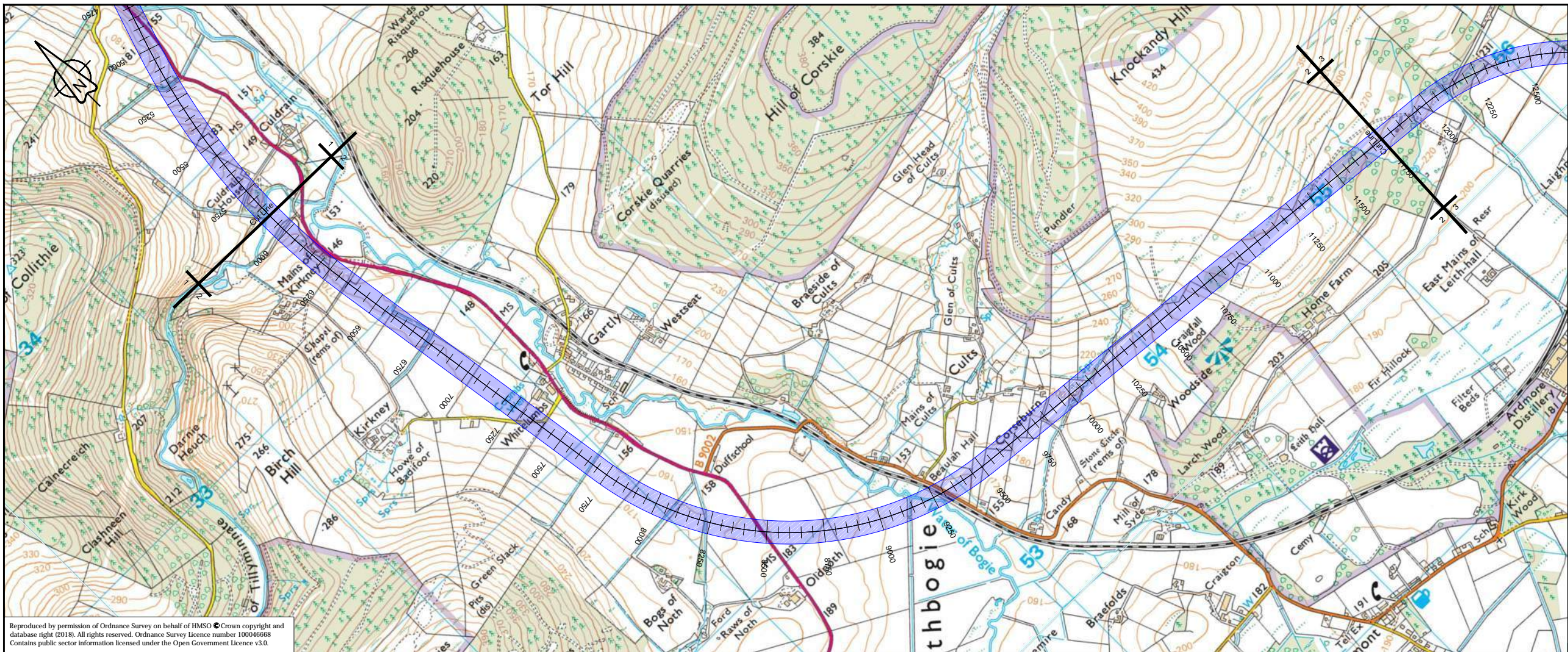

Reproduced by permission of Ordnance Survey on behalf of HMSO © Crown copyright and database right (2018). All rights reserved. Ordnance Survey Licence number 100046668
 Contains public sector information licensed under the Open Government Licence v3.0.

CN01_003-LONGSECTION
 SCALE: H 1:10000, V 1:2000, DATUM=115.000

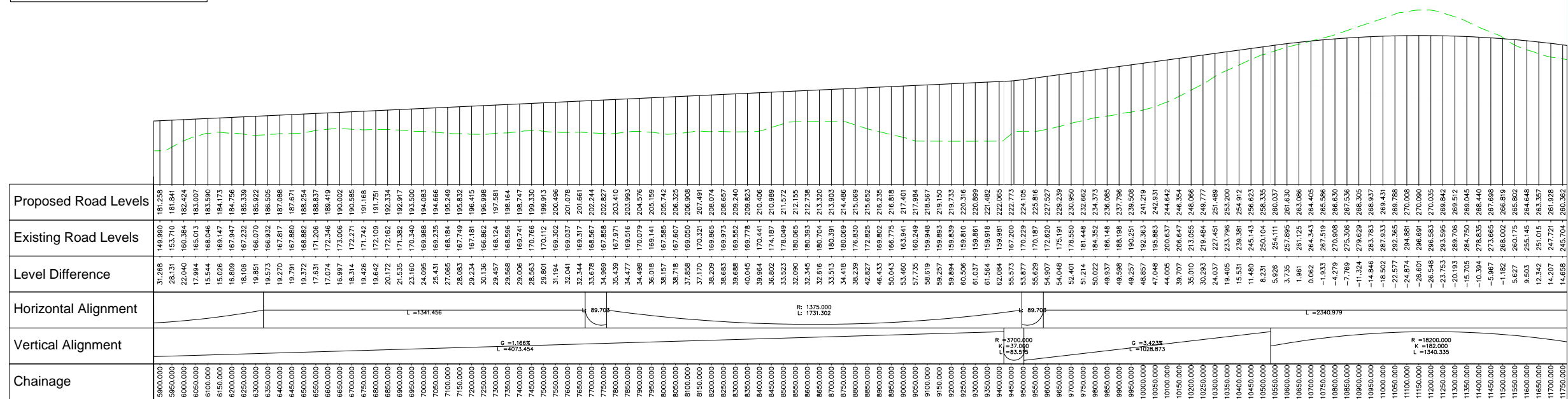

Chainage	Proposed Road Levels	Existing Road Levels	Level Difference
5900.000	161.265	149.995	11.270
5950.000	161.841	153.710	18.131
6000.000	162.424	160.384	22.040
6050.000	163.007	165.013	17.994
6100.000	163.590	168.646	15.544
6150.000	164.173	169.147	15.026
6200.000	164.756	167.947	16.809
6250.000	165.339	167.232	18.106
6300.000	165.922	166.070	19.851
6350.000	166.505	166.832	19.573
6400.000	167.088	167.817	19.270
6450.000	167.671	167.880	19.791
6500.000	168.254	168.882	19.372
6550.000	168.837	171.206	17.631
6600.000	169.419	172.346	17.074
6650.000	170.002	173.006	16.997
6700.000	170.585	172.271	18.314
6750.000	171.168	171.742	19.426
6800.000	171.751	172.109	19.642
6850.000	172.334	172.162	20.172
6900.000	172.917	171.382	21.535
6950.000	173.500	170.340	23.160
7000.000	174.083	169.988	24.095
7050.000	174.666	169.235	25.431
7100.000	175.249	168.184	27.065
7150.000	175.832	167.749	28.083
7200.000	176.415	167.181	29.234
7250.000	176.998	166.862	30.136
7300.000	177.581	166.524	31.057
7350.000	178.164	166.596	31.568
7400.000	178.747	166.741	32.008
7450.000	179.330	170.766	28.563
7500.000	179.913	170.112	29.801
7550.000	180.496	169.302	31.194
7600.000	181.079	169.037	32.041
7650.000	181.662	169.317	32.344
7700.000	182.245	168.967	33.278
7750.000	182.828	167.858	34.969
7800.000	183.411	167.971	35.439
7850.000	183.994	169.516	34.477
7900.000	184.577	170.079	34.498
7950.000	185.160	169.141	36.018
8000.000	185.743	167.885	37.857
8050.000	186.326	167.607	38.718
8100.000	186.909	169.050	37.858
8150.000	187.492	170.321	37.170
8200.000	188.075	169.865	38.209
8250.000	188.658	169.973	38.683
8300.000	189.241	169.552	39.688
8350.000	189.824	169.778	40.045
8400.000	190.407	170.441	39.966
8450.000	190.990	174.187	36.802
8500.000	191.573	178.049	33.523
8550.000	192.156	180.065	32.090
8600.000	192.739	180.393	32.345
8650.000	193.322	180.704	32.616
8700.000	193.905	180.391	33.513
8750.000	194.488	180.069	34.418
8800.000	195.071	179.830	35.239
8850.000	195.654	179.625	36.027
8900.000	196.237	179.482	36.754
8950.000	196.820	179.981	36.839
9000.000	197.403	180.222	37.186
9050.000	197.986	180.224	37.769
9100.000	198.569	179.229	39.340
9150.000	199.152	178.227	40.925
9200.000	199.735	177.227	42.508
9250.000	200.318	176.229	44.089
9300.000	200.901	175.191	45.710
9350.000	201.484	174.150	47.331
9400.000	202.067	173.150	48.912
9450.000	202.650	172.227	50.493
9500.000	203.233	171.342	52.074
9550.000	203.816	170.487	53.655
9600.000	204.399	169.660	55.236
9650.000	204.982	168.860	56.817
9700.000	205.565	168.087	58.478
9750.000	206.148	167.342	60.139
9800.000	206.731	166.625	61.800
9850.000	207.314	165.936	63.461
9900.000	207.897	165.275	65.122
9950.000	208.480	164.642	66.783
10000.000	209.063	164.037	68.444
10050.000	209.646	163.460	70.105
10100.000	210.229	162.911	71.766
10150.000	210.812	162.388	73.427
10200.000	211.395	161.891	75.088
10250.000	211.978	161.420	76.749
10300.000	212.561	160.975	78.410
10350.000	213.144	160.556	80.071
10400.000	213.727	160.163	81.732
10450.000	214.310	159.796	83.393
10500.000	214.893	159.455	85.054
10550.000	215.476	159.139	86.715
10600.000	216.059	158.848	88.376
10650.000	216.642	158.581	90.037
10700.000	217.225	158.338	91.698
10750.000	217.808	158.119	93.359
10800.000	218.391	157.924	95.020
10850.000	218.974	157.753	96.681
10900.000	219.557	157.605	98.342
10950.000	220.140	157.480	100.003
11000.000	220.723	157.377	101.664
11050.000	221.306	157.295	103.325
11100.000	221.889	157.234	104.986
11150.000	222.472	157.193	106.647
11200.000	223.055	157.172	108.308
11250.000	223.638	157.171	109.969
11300.000	224.221	157.190	111.630
11350.000	224.804	157.229	113.291
11400.000	225.387	157.288	114.952
11450.000	225.970	157.357	116.613
11500.000	226.553	157.436	118.274
11550.000	227.136	157.525	119.935
11600.000	227.719	157.624	121.596
11650.000	228.302	157.733	123.257
11700.000	228.885	157.852	124.918
11750.000	229.468	157.981	126.579

Fit For Information - First Fix Alignment					
P01	SM	GK	CL	CB	GMacD
	02/03/18	02/03/18	02/03/18	02/03/18	02/03/18

Revision details					
Revision	Created	Checked	Reviewed	Approved	Authorised
	dd/mm/yy	dd/mm/yy	dd/mm/yy	dd/mm/yy	dd/mm/yy

Designer
 Precision House
 McNeill Drive
 Motherwell
 ML1 4UR

Client
 58 Port Dundas Road
 Glasgow
 G4 0HF

Project Name
 A96 Dualling East of Huntly to Aberdeen

Drawing Title
 CN01_003 First Fix Alignment
 Plan and Profile
 Sheet 2 of 5

Project Ref. No.	Stage	Scale:
250002-92	2	1:10000H 1:2000V @ A1
		Dimensions: m

Drawing Number
 Project | Originator | Volume |
 A96PEA - AMAR - HGN -
 CC -DR-CH- 001302
 Location | Type | Role | Number

Suitability	Suitability Description	Revision
S2	Fit For Information	P01



Reproduced by permission of Ordnance Survey on behalf of HMSO © Crown copyright and database right (2018). All rights reserved. Ordnance Survey Licence number 100046668
Contains public sector information licensed under the Open Government Licence v3.0.

CN01_003-LONGSECTION
SCALE: H 1:10000, V 1:2000, DATUM=115.000

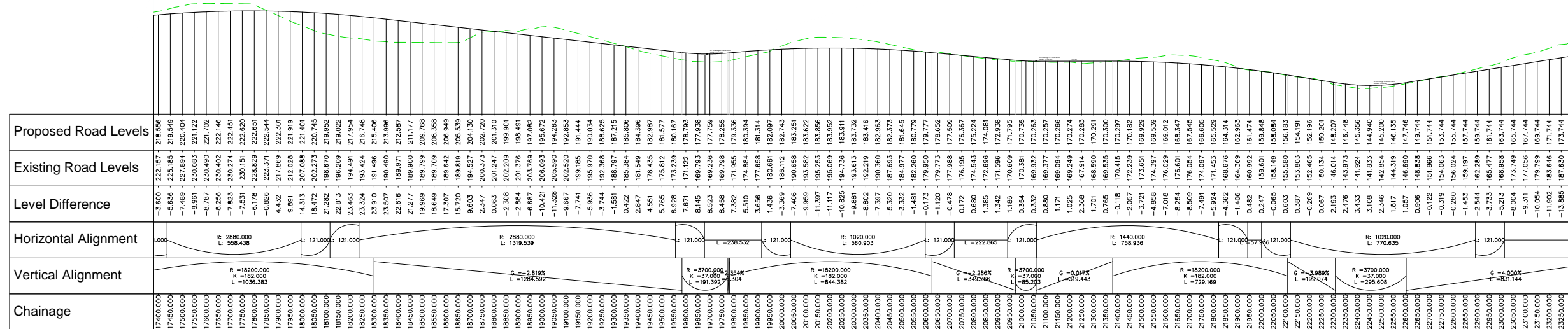

P01	Fit For Information - First Fix Alignment				
	SM	GK	CL	CB	GMacD
	02/03/18	02/03/18	02/03/18	02/03/18	02/03/18
Revision	Revision details				
	Created	Checked	Reviewed	Approved	Authorised
	dd/mm/yy	dd/mm/yy	dd/mm/yy	dd/mm/yy	dd/mm/yy

Designer
Precision House
McNeil Drive
Motherwell
ML1 4UR

Client
58 Port Dundas Road
Glasgow
G4 0HF

Project Name
A96 Dualling East of Huntly to Aberdeen

Drawing Title
CN01_003 First Fix Alignment Plan and Profile Sheet 4 of 5

Project Ref. No.	Stage	Scale
250002-92	2	1:10000H 1:2000V @ A1
Dimensions : m		

Drawing Number	Project	Originator	Volume
A96PEA - AMAR - HGN - CC	- DR - CH - 001304		
Location		Type	Role

Suitability	Suitability Description	Revision
S2	Fit For Information	P01

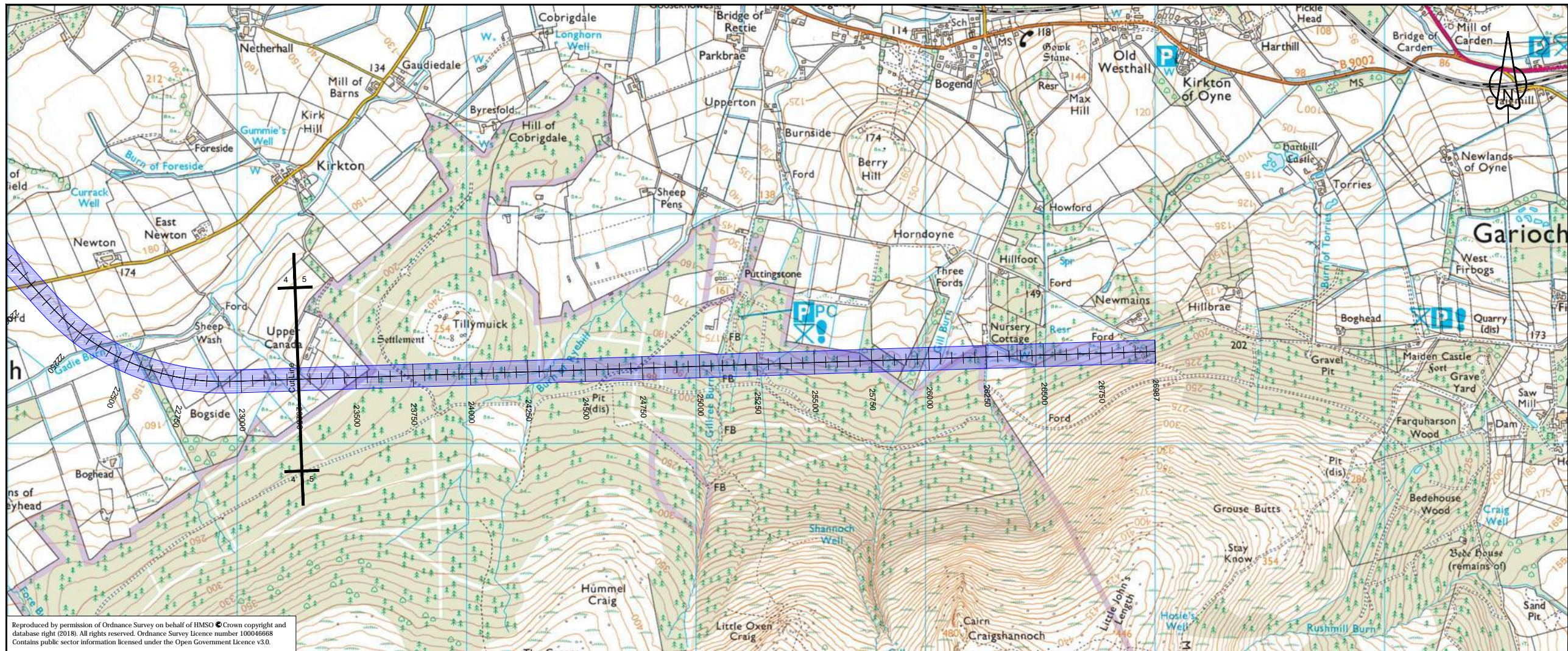

Reproduced by permission of Ordnance Survey on behalf of HMSO © Crown copyright and database right (2018). All rights reserved. Ordnance Survey Licence number 100046668
Contains public sector information licensed under the Open Government Licence v3.0.

CN01_003-LONGSECTION
SCALE: H 1:10000, V 1:2000, DATUM=115.000

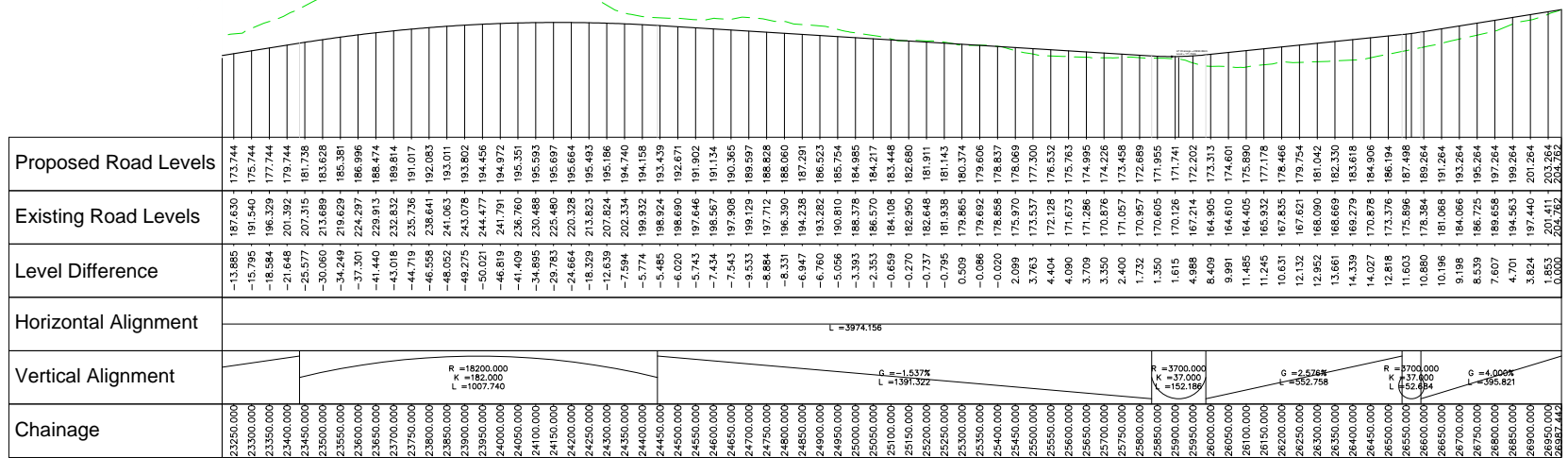

P01	Fit For Information - First Fix Alignment				
	SM	GK	CL	CB	GMacD
	02/03/18	02/03/18	02/03/18	02/03/18	02/03/18

Revision	Revision details				
	Created	Checked	Reviewed	Approved	Authorised
	dd/mm/yy	dd/mm/yy	dd/mm/yy	dd/mm/yy	dd/mm/yy

Designer
Precision House
McNeil Drive
Motherwell
ML1 4UR

Client
58 Port Dundas Road
Glasgow
G4 0HF

Project Name
A96 Dualling East of Huntly to Aberdeen

Drawing Title
CN01_003 First Fix Alignment
Plan and Profile
Sheet 5 of 5

Project Ref. No.	Stage	Scale
250002-92	2	1:10000H 1:2000V @ A1

Dimensions : m

Drawing Number	Project	Originator	Volume
A96PEA - AMAR - HGN - CC			

Location	Type	Role	Number

Suitability	Suitability Description	Revision
S2	Fit For Information	P01

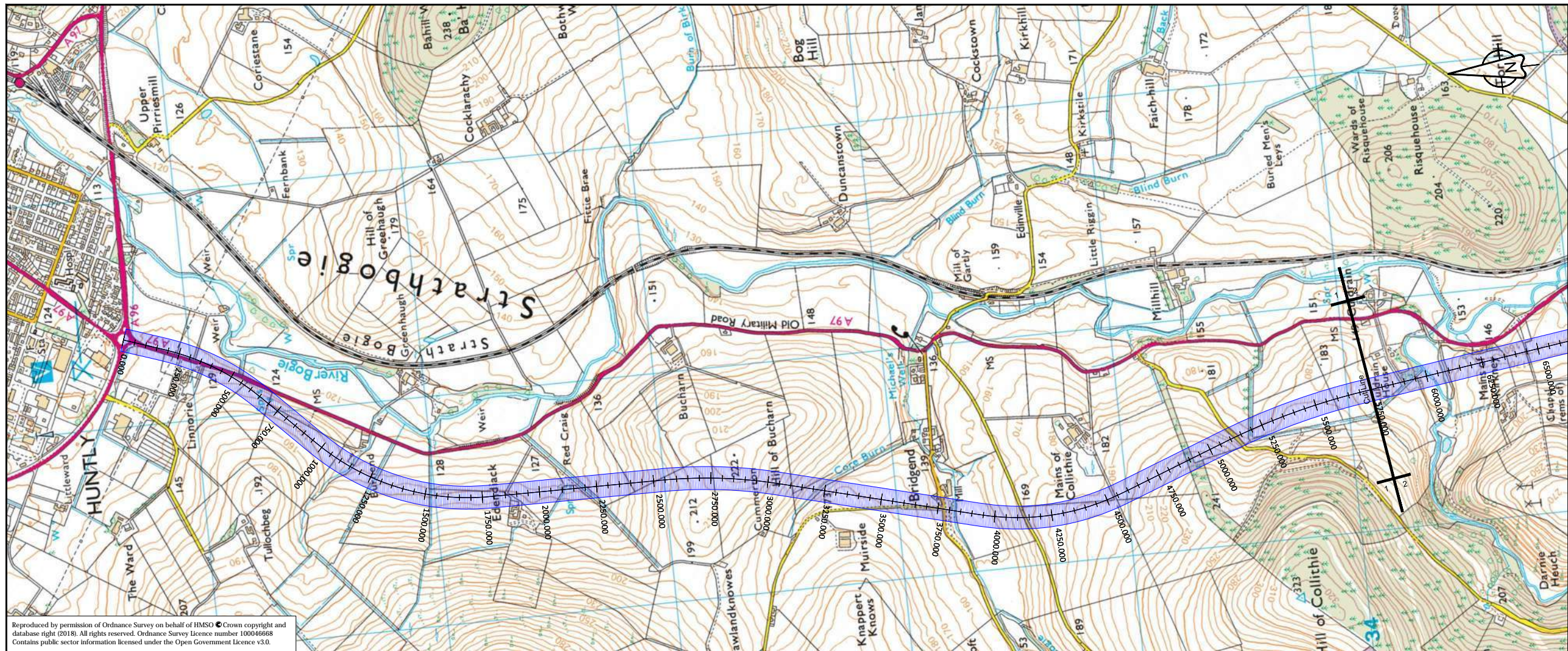

Reproduced by permission of Ordnance Survey on behalf of HMSO © Crown copyright and database right (2018). All rights reserved. Ordnance Survey Licence number 100046668
 Contains public sector information licensed under the Open Government Licence v3.0.

CN01_004- LONGSECTION
 SCALE: H 1:10000, V 1:2000, DATUM=153.000

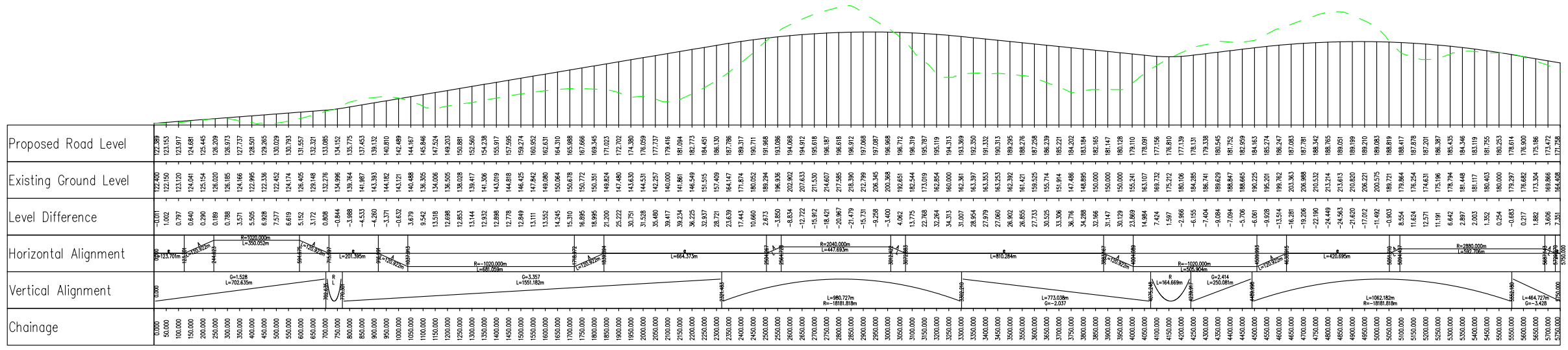

P01	Fit For Information - First Fix Alignment				
	SM	GK	CL	CB	GMacD
	02/03/18	02/03/18	02/03/18	02/03/18	02/03/18
Revision	Revision details				
	Created	Checked	Reviewed	Approved	Authorised
	dd/mm/yy	dd/mm/yy	dd/mm/yy	dd/mm/yy	dd/mm/yy

Designer
 Precision House
 McNeil Drive
 Motherwell
 ML1 4UR

Client
 58 Port Dundas Road
 Glasgow
 G4 0HF

Project Name
A96 Dualling East of Huntly to Aberdeen

Drawing Title
CN01_004 First Fix Alignment
Plan and Profile
Sheet 1 of 5

Project Ref. No.	Stage	Scale:
250002-92	2	1:10000H 1:2000V @ A1
Dimensions: m		

Drawing Number	Project	Originator	Volume
CC	A96PEA	AMAR	HGN
Location	-DR-CH-001401		Number
	Type	Role	

Suitability	Suitability Description	Revision
S2	Fit For Information	P01

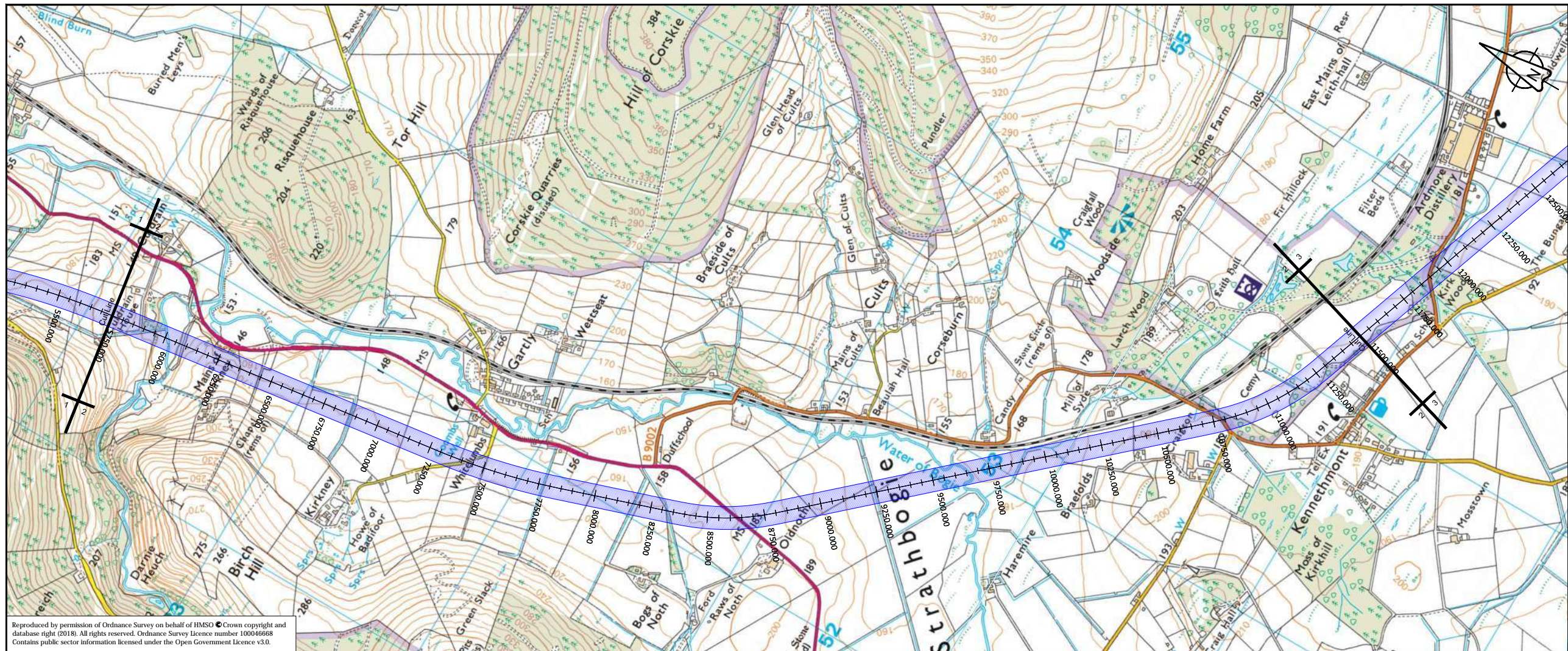

Reproduced by permission of Ordnance Survey on behalf of HMSO © Crown copyright and database right (2018). All rights reserved. Ordnance Survey Licence number 100046668
Contains public sector information licensed under the Open Government Licence v3.0.

CN01_004- LONGSECTION
SCALE: H 1:10000, V 1:2000. DATUM=149.000

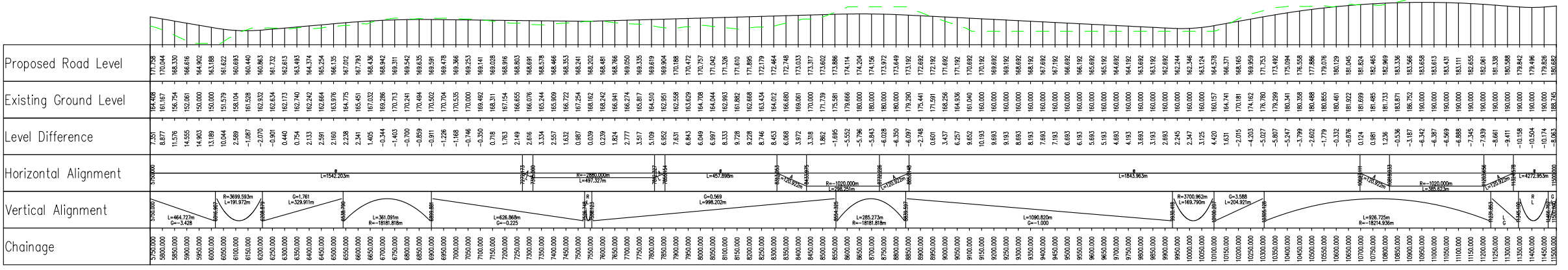

P01	Fit For Information - First Fix Alignment				
	SM	GK	CL	CB	GMacD
	02/03/18	02/03/18	02/03/18	02/03/18	02/03/18
Revision	Revision details				
	Created	Checked	Reviewed	Approved	Authorised
	dd/mm/yy	dd/mm/yy	dd/mm/yy	dd/mm/yy	dd/mm/yy

Designer
Precision House
McNeil Drive
Motherwell
ML1 4UR

Client
58 Port Dundas Road
Glasgow
G4 0HF

Project Name
A96 Dualling East of Huntly to Aberdeen

Drawing Title
**CN01_004 First Fix Alignment
Plan and Profile
Sheet 2 of 5**

Project Ref. No.	Stage	Scale: 1:10000H 1:2000V @ A1
250002-92	2	Dimensions : m

Drawing Number			
Project	Originator	Volume	
A96PEA - AMAR - HGN -			
CC		-DR-CH- 001402	
Location	Type	Role	Number

Suitability	Suitability Description	Revision
S2	Fit For Information	P01