

Reproduced by permission of Ordnance Survey on behalf of HMSO © Crown copyright and database right (2018). All rights reserved. Ordnance Survey Licence number 100046668
 Contains public sector information licensed under the Open Government Licence v3.0.

CN01_004- LONGSECTION
 SCALE: H 1:10000, V 1:2000. DATUM=139.000

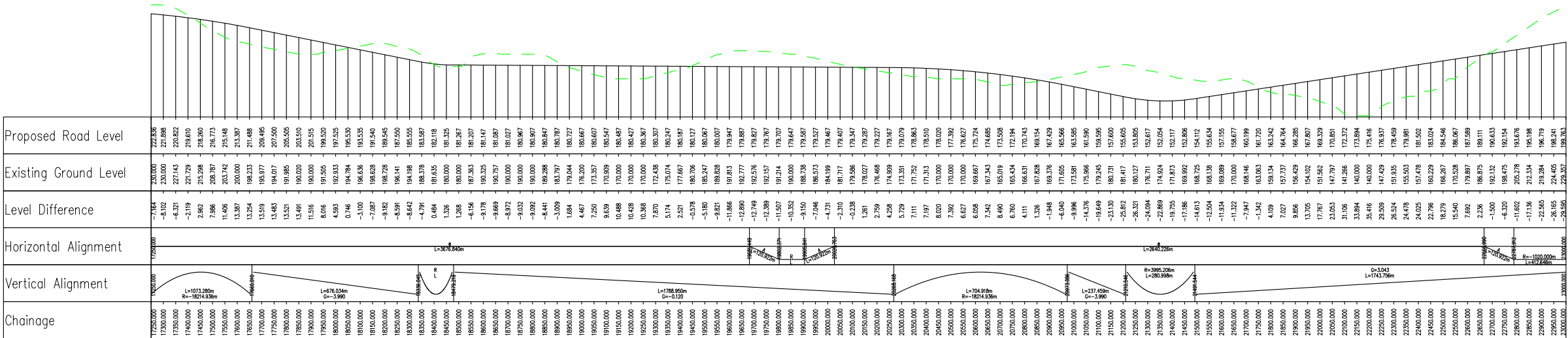

P01	Fit For Information - First Fix Alignment				
	SM	GK	CL	CB	GMacD
	02/03/18	02/03/18	02/03/18	02/03/18	02/03/18
Revision	Revision details				
	Created	Checked	Reviewed	Approved	Authorised
	dd/mm/yy	dd/mm/yy	dd/mm/yy	dd/mm/yy	dd/mm/yy

Designer
 Precision House
 McNeil Drive
 Motherwell
 ML1 4UR

Client
 58 Port Dundas Road
 Glasgow
 G4 0HF

Project Name
A96 Dualling East of Huntly to Aberdeen

Drawing Title
**CN01_004 First Fix Alignment
 Plan and Profile
 Sheet 4 of 5**

Project Ref. No.	Stage	Scale: 1:10000H 1:2000V @ A1
250002-92	2	Dimensions: m

Project	Originator	Volume
A96PEA	- AMAR - HGN -	
CC	-DR-CH-	001404
Location	Type	Role
		Number

Suitability	Suitability Description	Revision
S2	Fit For Information	P01

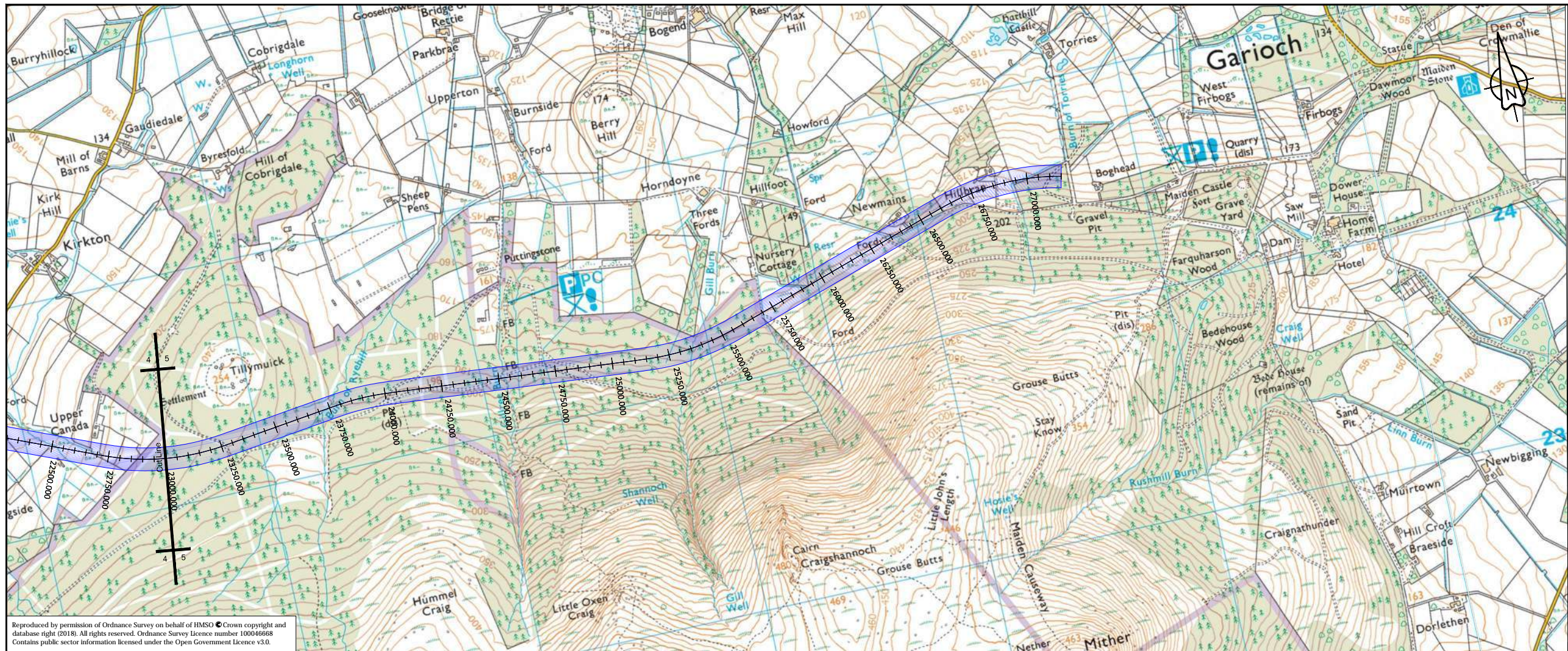

Reproduced by permission of Ordnance Survey on behalf of HMSO © Crown copyright and database right (2018). All rights reserved. Ordnance Survey Licence number 100046668
Contains public sector information licensed under the Open Government Licence v3.0.

CN01_004- LONGSECTION
SCALE: H 1:10000, V 1:2000, DATUM=175.000

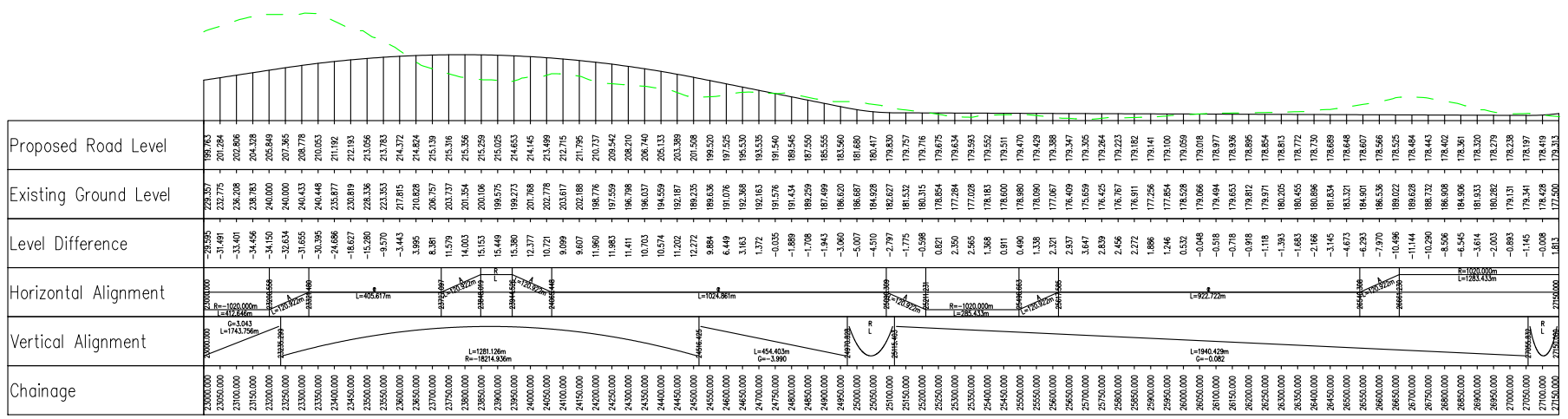

P01	Fit For Information - First Fix Alignment				
	SM	GK	CL	CB	GMacD
	02/03/18	02/03/18	02/03/18	02/03/18	02/03/18
Revision	Revision details				
	Created	Checked	Reviewed	Approved	Authorised
	dd/mm/yy	dd/mm/yy	dd/mm/yy	dd/mm/yy	dd/mm/yy

Designer
Precision House
McNeil Drive
Motherwell
ML1 4UR



Client
58 Port Dundas Road
Glasgow
G4 0HF



Project Name
A96 Dualling East of Huntly to Aberdeen

Drawing Title
CN01_004 First Fix Alignment
Plan and Profile
Sheet 5 of 5

Project Ref. No.	Stage	Scale: 1:10000H 1:2000V @ A1
250002-92	2	Dimensions: m

Drawing Number	Project	Originator	Volume
	A96PEA	- AMAR - HGN -	
	CC	- DR-CH -	001405
	Location	Type	Role

Suitability	Suitability Description	Revision
S2	Fit For Information	P01

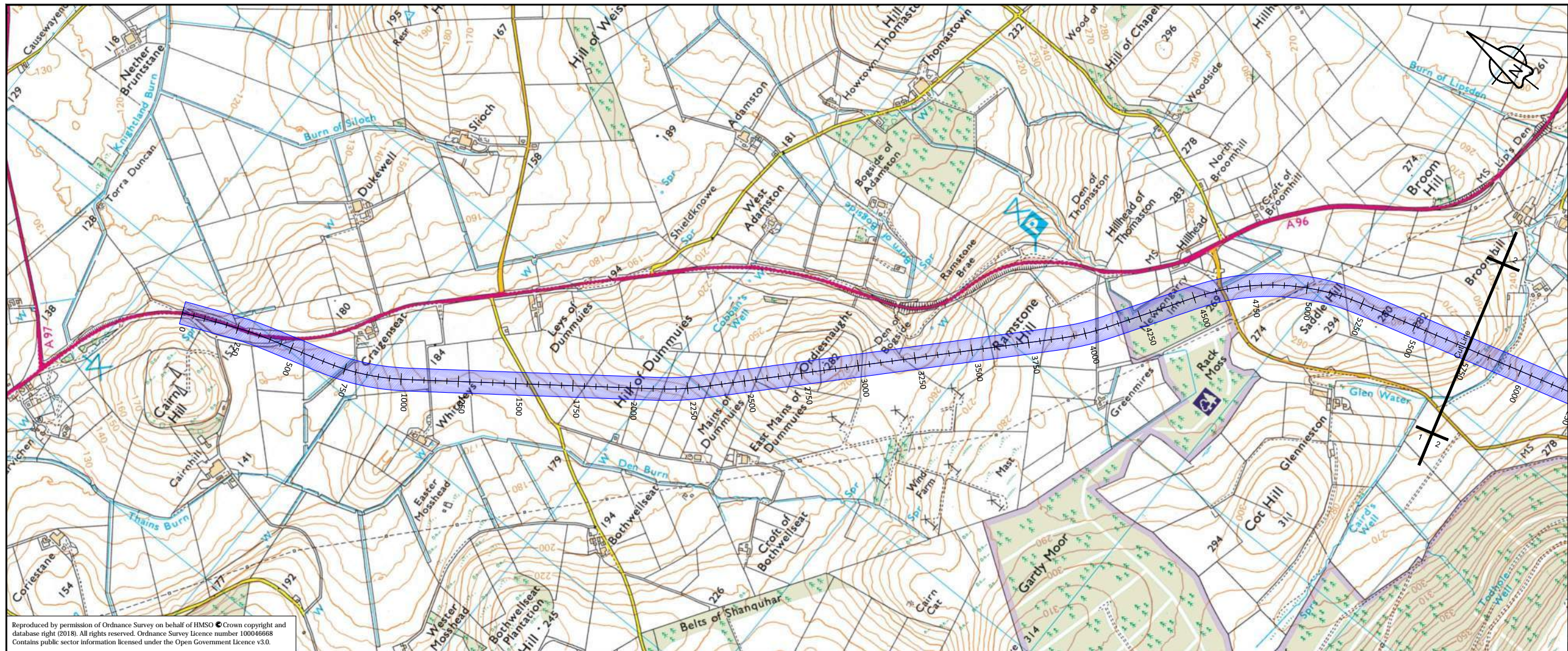

Reproduced by permission of Ordnance Survey on behalf of HMSO © Crown copyright and database right (2018). All rights reserved. Ordnance Survey Licence number 100046668
Contains public sector information licensed under the Open Government Licence v3.0.

CN02_001 - LONGSECTION
SCALE: H 1:10000, V 1:2000. DATUM=151.000

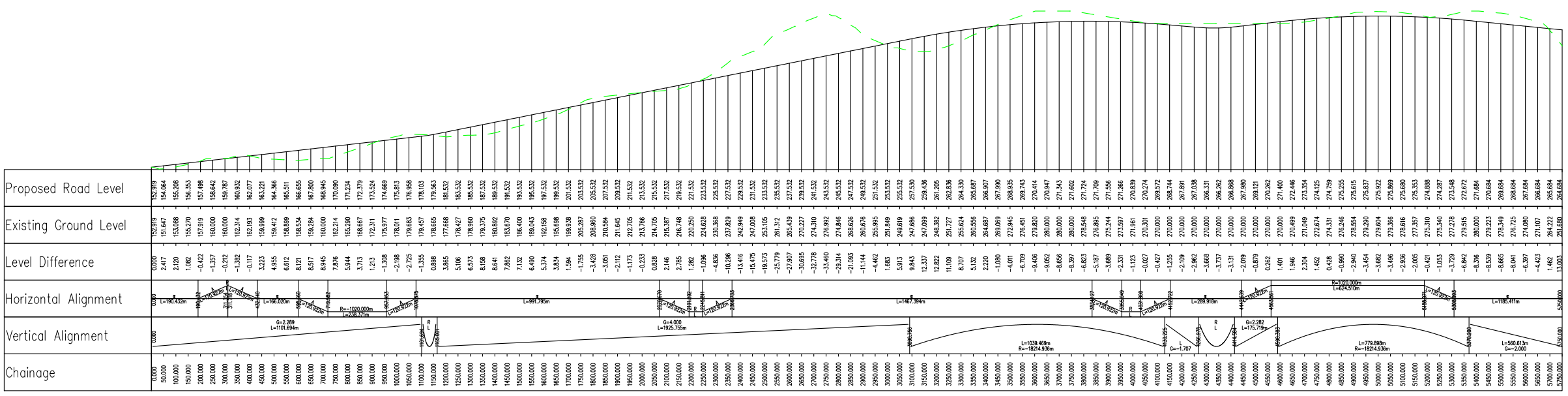

Chainage	Proposed Road Level	Existing Ground Level	Level Difference
0+000	152.919	152.919	0.000
50+000	151.647	151.664	2.417
100+000	153.088	155.208	2.120
150+000	155.270	156.353	1.082
200+000	157.919	157.498	-0.822
250+000	160.000	158.642	-1.357
300+000	160.000	159.787	-0.212
350+000	162.314	160.000	-1.382
400+000	162.193	162.077	-0.117
450+000	159.999	163.321	3.323
500+000	159.412	164.366	4.955
550+000	158.899	165.511	6.612
600+000	158.534	166.655	8.121
650+000	158.284	167.800	9.517
700+000	160.000	168.945	8.945
750+000	162.714	170.090	7.376
800+000	165.296	171.234	5.944
850+000	168.687	172.379	3.713
900+000	172.311	173.524	1.213
950+000	175.977	174.669	-1.308
1000+000	178.011	175.813	-2.196
1050+000	179.683	176.958	-2.725
1100+000	179.457	178.103	-1.355
1150+000	178.653	179.247	0.888
1200+000	177.668	180.392	3.865
1250+000	176.477	181.537	5.106
1300+000	175.960	182.682	6.723
1350+000	176.375	183.827	7.452
1400+000	180.892	184.972	4.081
1450+000	183.670	186.117	2.447
1500+000	186.400	187.262	0.862
1550+000	188.043	188.407	-0.364
1600+000	192.158	189.552	-2.607
1650+000	195.068	190.697	-4.911
1700+000	199.038	191.842	-7.196
1750+000	205.287	192.987	-10.300
1800+000	208.960	194.132	-14.828
1850+000	210.594	195.277	-15.317
1900+000	212.705	196.422	-16.283
1950+000	213.786	197.567	-16.218
2000+000	214.792	198.712	-16.083
2050+000	215.397	199.857	-16.060
2100+000	215.397	201.002	-15.605
2150+000	215.397	202.147	-14.750
2200+000	215.397	203.292	-13.895
2250+000	215.397	204.437	-13.040
2300+000	215.397	205.582	-12.185
2350+000	215.397	206.727	-11.330
2400+000	215.397	207.872	-10.475
2450+000	215.397	209.017	-9.620
2500+000	215.397	210.162	-8.765
2550+000	215.397	211.307	-7.910
2600+000	215.397	212.452	-7.055
2650+000	215.397	213.597	-6.200
2700+000	215.397	214.742	-5.345
2750+000	215.397	215.887	-4.490
2800+000	215.397	217.032	-3.635
2850+000	215.397	218.177	-2.780
2900+000	215.397	219.322	-1.925
2950+000	215.397	220.467	-1.070
3000+000	215.397	221.612	-0.215
3050+000	215.397	222.757	0.640
3100+000	215.397	223.902	1.495
3150+000	215.397	225.047	2.350
3200+000	215.397	226.192	3.205
3250+000	215.397	227.337	4.060
3300+000	215.397	228.482	4.915
3350+000	215.397	229.627	5.770
3400+000	215.397	230.772	6.625
3450+000	215.397	231.917	7.480
3500+000	215.397	233.062	8.335
3550+000	215.397	234.207	9.190
3600+000	215.397	235.352	10.045
3650+000	215.397	236.497	10.900
3700+000	215.397	237.642	11.755
3750+000	215.397	238.787	12.610
3800+000	215.397	239.932	13.465
3850+000	215.397	241.077	14.320
3900+000	215.397	242.222	15.175
3950+000	215.397	243.367	16.030
4000+000	215.397	244.512	16.885
4050+000	215.397	245.657	17.740
4100+000	215.397	246.802	18.595
4150+000	215.397	247.947	19.450
4200+000	215.397	249.092	20.305
4250+000	215.397	250.237	21.160
4300+000	215.397	251.382	22.015
4350+000	215.397	252.527	22.870
4400+000	215.397	253.672	23.725
4450+000	215.397	254.817	24.580
4500+000	215.397	255.962	25.435
4550+000	215.397	257.107	26.290
4600+000	215.397	258.252	27.145
4650+000	215.397	259.397	28.000
4700+000	215.397	260.542	28.855
4750+000	215.397	261.687	29.710
4800+000	215.397	262.832	30.565
4850+000	215.397	263.977	31.420
4900+000	215.397	265.122	32.275
4950+000	215.397	266.267	33.130
5000+000	215.397	267.412	33.985
5050+000	215.397	268.557	34.840
5100+000	215.397	269.702	35.695
5150+000	215.397	270.847	36.550
5200+000	215.397	271.992	37.405
5250+000	215.397	273.137	38.260
5300+000	215.397	274.282	39.115
5350+000	215.397	275.427	39.970
5400+000	215.397	276.572	40.825
5450+000	215.397	277.717	41.680
5500+000	215.397	278.862	42.535
5550+000	215.397	280.007	43.390
5600+000	215.397	281.152	44.245
5650+000	215.397	282.297	45.100
5700+000	215.397	283.442	45.955
5750+000	215.397	284.587	46.810
5800+000	215.397	285.732	47.665
5850+000	215.397	286.877	48.520
5900+000	215.397	288.022	49.375
5950+000	215.397	289.167	50.230
6000+000	215.397	290.312	51.085

P01	Fit For Information - First Fix Alignments				
	SC	CP	CL	CB	GMacD
	02/03/18	02/03/18	02/03/18	02/03/18	02/03/18
Revision	Revision details				
	Created	Checked	Reviewed	Approved	Authorised
	dd/mm/yy	dd/mm/yy	dd/mm/yy	dd/mm/yy	dd/mm/yy

Designer
Precision House
McNeil Drive
Motherwell
ML1 4UR

Client
58 Port Dundas Road
Glasgow
G4 0HF

Project Name
A96 Dualling East of Huntly to Aberdeen

Drawing Title
CN02_001 First Fix Alignment Plan and Profile
Sheet 1 of 4

Project Ref. No.	Stage	Scale: 1:10000H 1:2000V @ A1
250002-92	2	Dimensions: m

Drawing Number	Project	Originator	Volume
	A96PEA - AMAR - HGN -		
	CC	-DR-CH-	002101
	Location	Type	Role
			Number

Suitability	Suitability Description	Revision
S2	Fit For Information	P01

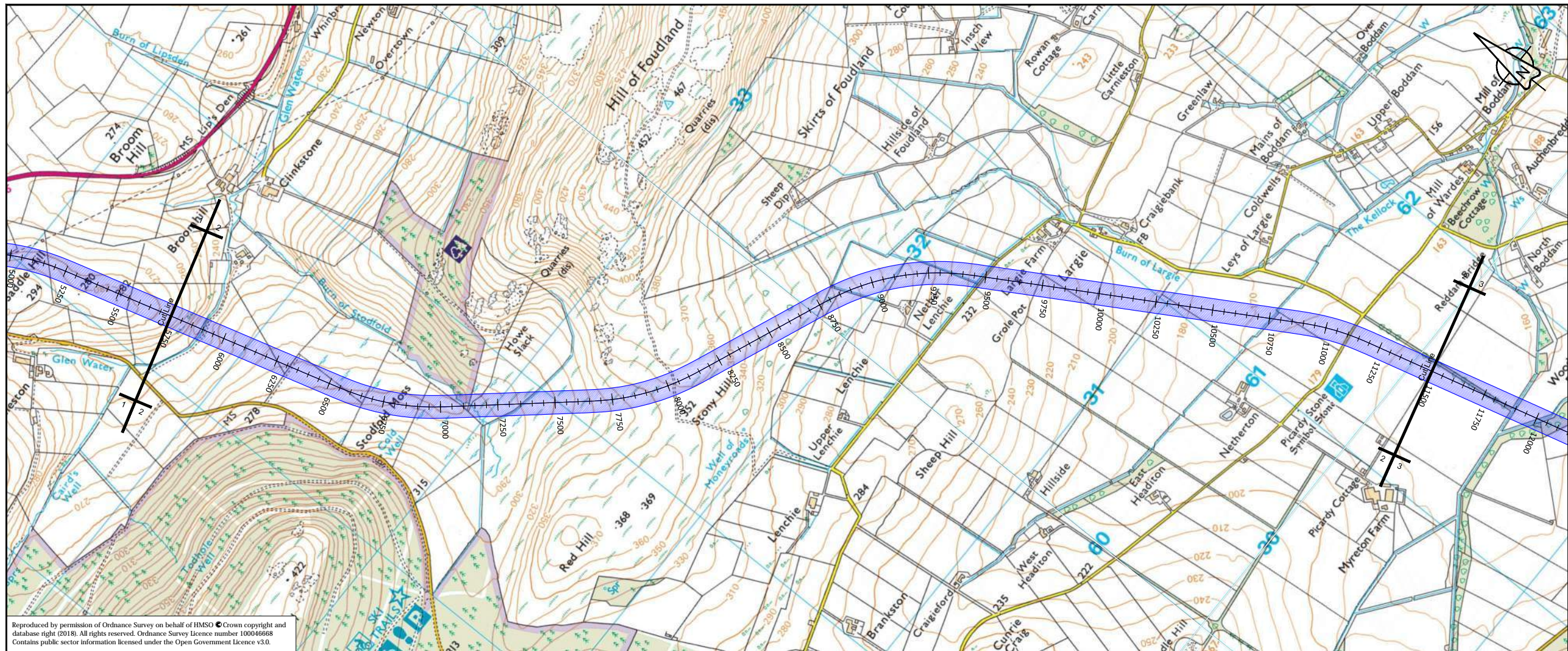

Reproduced by permission of Ordnance Survey on behalf of HMSO © Crown copyright and database right (2018). All rights reserved. Ordnance Survey Licence number 100046668. Contains public sector information licensed under the Open Government Licence v3.0.

CN02_001 - LONGSECTION
SCALE: H 1:10000, V 1:2000. DATUM=166.000

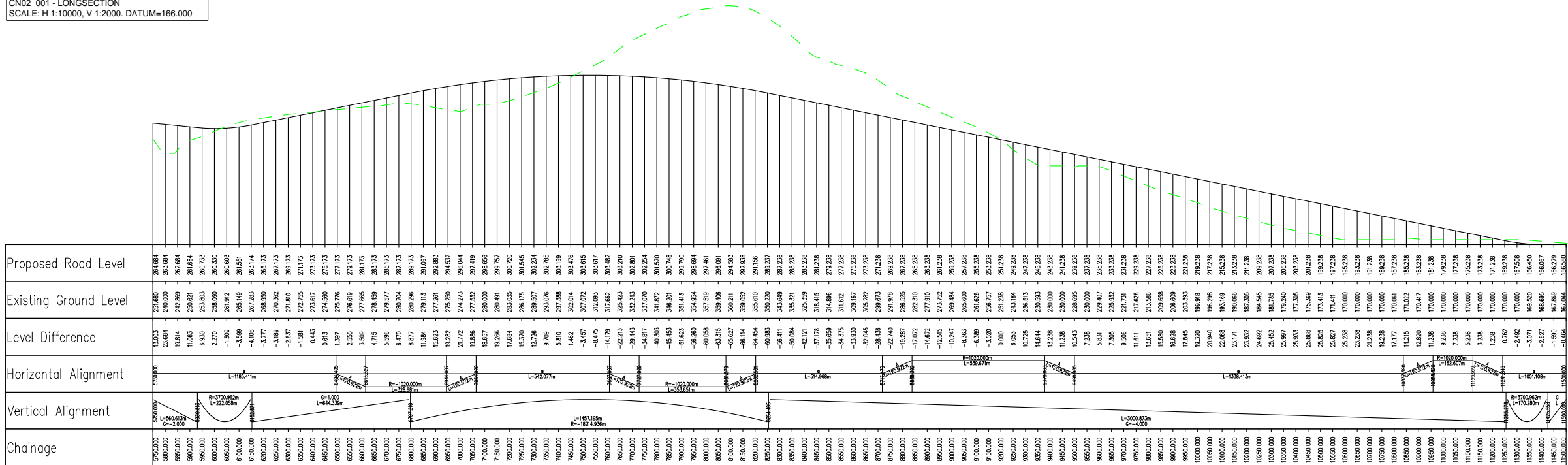

P01	Fit For Information - First Fix Alignments				
	SC	CP	CL	CB	GMacD
	02/03/18	02/03/18	02/03/18	02/03/18	02/03/18
Revision	Revision details				
	Created	Checked	Reviewed	Approved	Authorised
	dd/mm/yy	dd/mm/yy	dd/mm/yy	dd/mm/yy	dd/mm/yy

Designer
Precision House
McNeil Drive
Motherwell
ML1 4UR

Client
58 Port Dundas Road
Glasgow
G4 0HF

Project Name
A96 Dualling East of Huntly to Aberdeen

Drawing Title
CN02_001 First Fix Alignment
Plan and Profile
Sheet 2 of 4

Project Ref. No.	Stage	Scale: 1:10000H 1:2000V @ A1
250002-92	2	Dimensions: m

Drawing Number
Project | Originator | Volume |
A96PEA - AMAR - HGN -
CC - DR-CH- 002102
Location | Type | Role | Number

Suitability	Suitability Description	Revision
S2	Fit For Information	P01

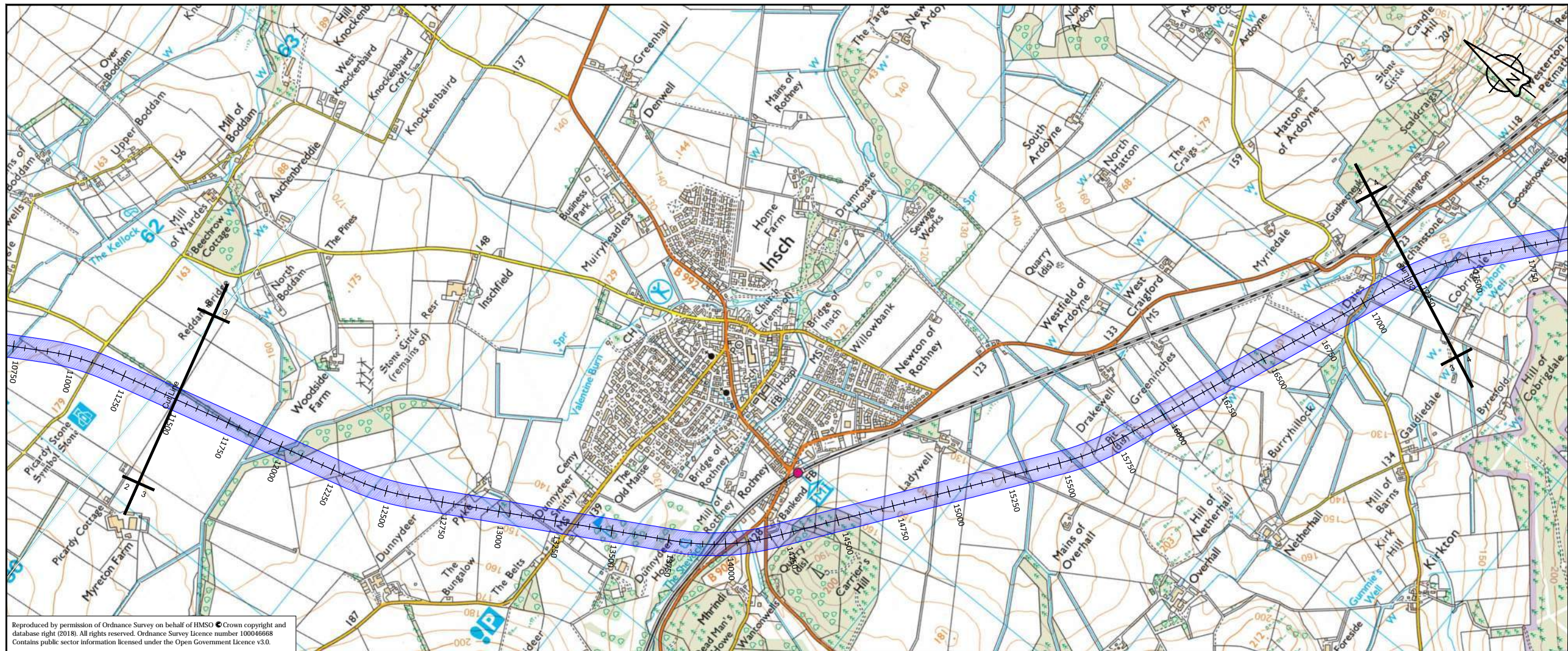

Reproduced by permission of Ordnance Survey on behalf of HMSO © Crown copyright and database right (2018). All rights reserved. Ordnance Survey Licence number 100046668. Contains public sector information licensed under the Open Government Licence v3.0.

CN02_001 - LONGSECTION
SCALE: H 1:10000, V 1:2000. DATUM=122.000

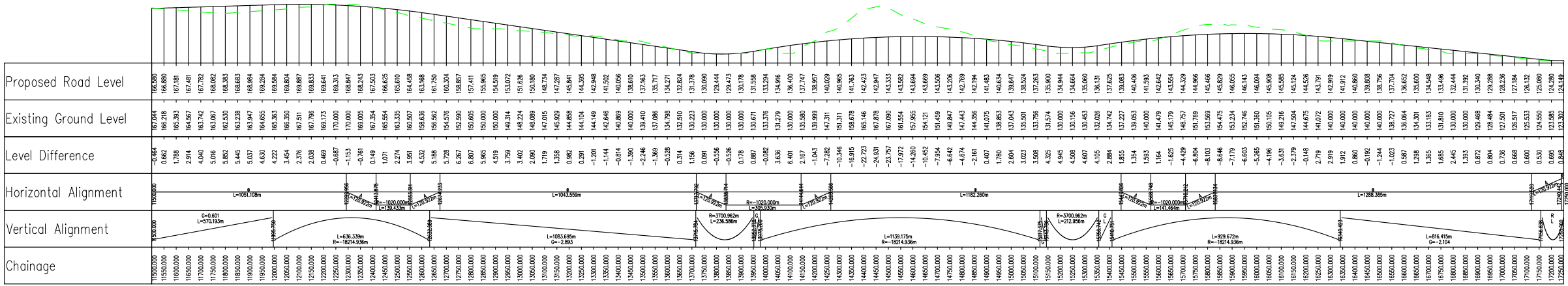

P01	Fit For Information - First Fix Alignments				
	SC	CP	CL	CB	GMacD
	02/03/18	02/03/18	02/03/18	02/03/18	02/03/18

Revision	Revision details				
	Created	Checked	Reviewed	Approved	Authorised
	dd/mm/yy	dd/mm/yy	dd/mm/yy	dd/mm/yy	dd/mm/yy

Designer
Precision House
McNeil Drive
Motherwell
ML1 4UR



Client
58 Port Dundas Road
Glasgow
G4 0HF



Project Name
A96 Dualling East of Huntly to Aberdeen

Drawing Title
CN02_001 First Fix Alignment Plan and Profile Sheet 3 of 4

Project Ref. No. 250002-92	Stage 2	Scale: 1:10000H 1:2000V @ A1 Dimensions: m
-------------------------------	------------	---

Drawing Number	Project	Originator	Volume
CC	A96PEA	AMAR	HGN
Location	-DR-CH-	002103	
Type	Role	Number	

Suitability	Suitability Description	Revision
S2	Fit For Information	P01

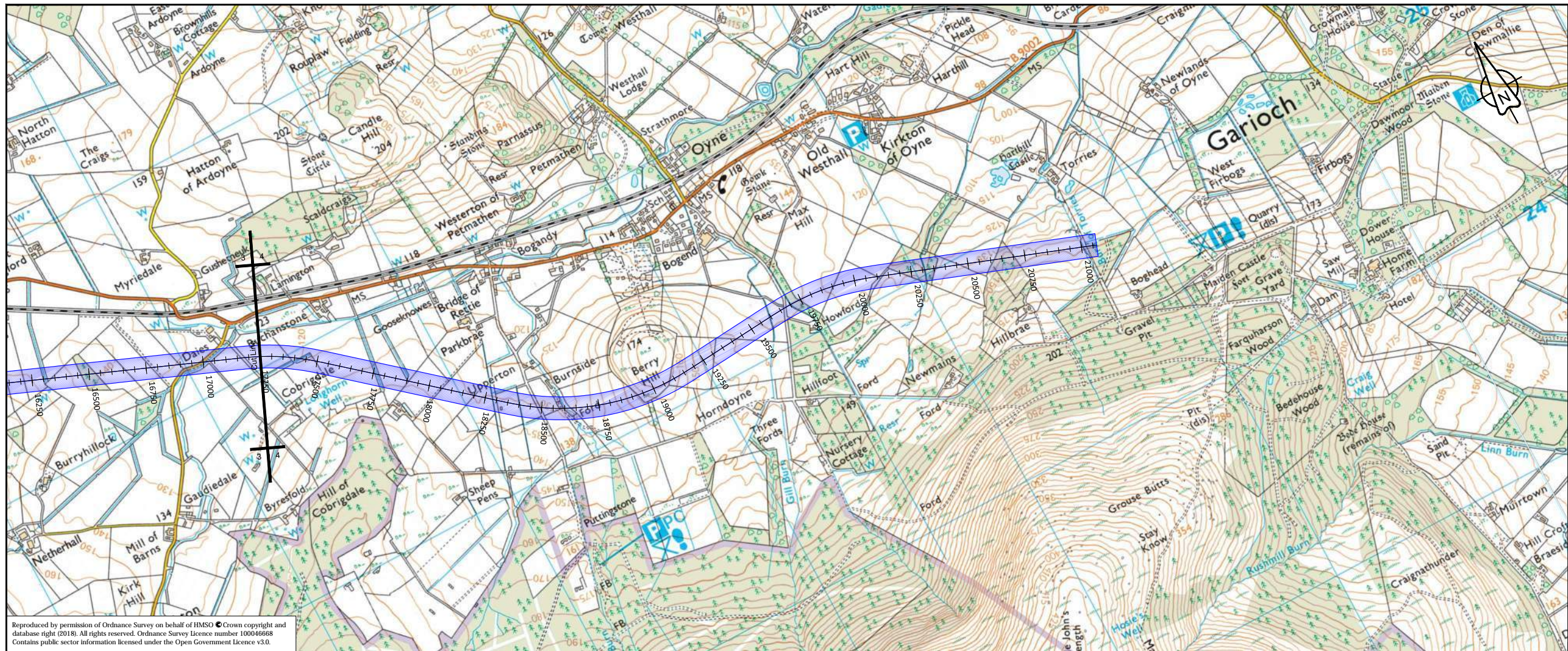

Reproduced by permission of Ordnance Survey on behalf of HMSO © Crown copyright and database right (2018). All rights reserved. Ordnance Survey Licence number 100046668
Contains public sector information licensed under the Open Government Licence v3.0.

CN02_001 - LONGSECTION
SCALE: H 1:10000, V 1:2000, DATUM=120.000

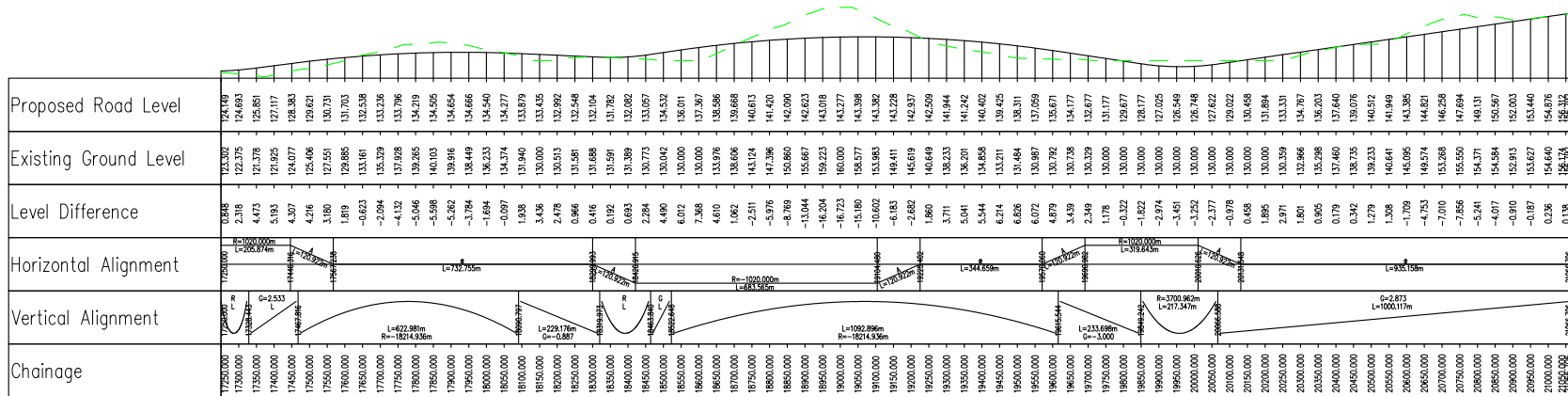

P01	Fit For Information - First Fix Alignments				
	SC	CP	CL	CB	GMacD
	02/03/18	02/03/18	02/03/18	02/03/18	02/03/18

Revision	Revision details				
	Created	Checked	Reviewed	Approved	Authorised
	dd/mm/yy	dd/mm/yy	dd/mm/yy	dd/mm/yy	dd/mm/yy

Designer
Precision House
McNeil Drive
Motherwell
ML1 4UR



Client
58 Port Dundas Road
Glasgow
G4 0HF



Project Name
A96 Dualling East of Huntly to Aberdeen

Drawing Title
CN02_001 First Fix Alignment
Plan and Profile
Sheet 4 of 4

Project Ref. No. 250002-92	Stage 2	Scale: 1:10000H 1:2000V @ A1 Dimensions: m
-------------------------------	------------	---

Drawing Number A96PEA - AMAR - HGN - CC - DR-CH - 002104	Project Originator Volume Location Type Role Number
--	--

Suitability	Suitability Description	Revision
S2	Fit For Information	P01

