

Reproduced by permission of Ordnance Survey on behalf of HMSO © Crown copyright and database right (2018). All rights reserved. Ordnance Survey Licence number 100046668  
 Contains public sector information licensed under the Open Government Licence v3.0.

CN02\_002 - LONGSECTION  
 SCALE: H 1:10000, V 1:2000, DATUM=126.000

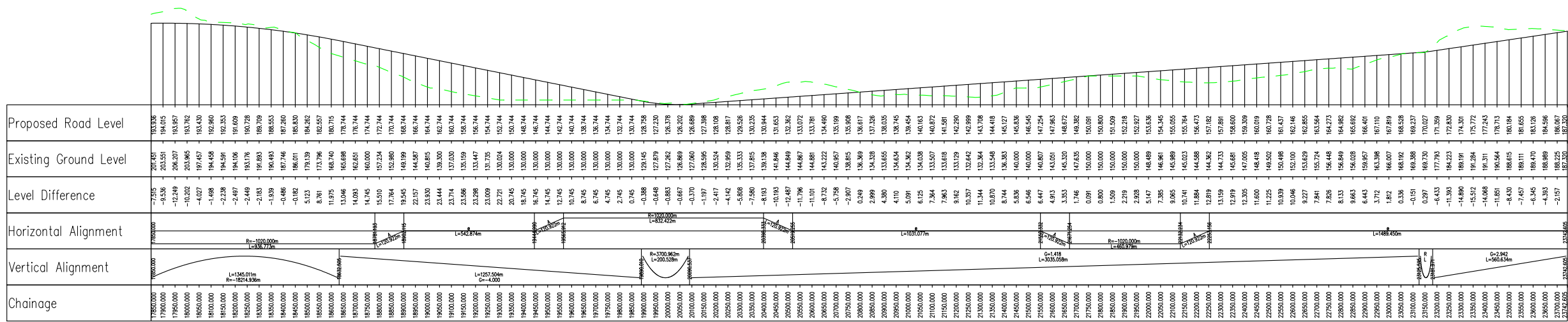

P01	Fit For Information - First Fix Alignments				
	SC	CP	CL	CB	GMacD
	02/03/18	02/03/18	02/03/18	02/03/18	02/03/18
Revision	Revision details				
	Created	Checked	Reviewed	Approved	Authorised
	dd/mm/yy	dd/mm/yy	dd/mm/yy	dd/mm/yy	dd/mm/yy

Designer  
 Precision House  
 McNeil Drive  
 Motherwell  
 ML1 4UR

Client  
 58 Port Dundas Road  
 Glasgow  
 G4 0HF

Project Name  
**A96 Dualling East of Huntly to Aberdeen**

Drawing Title  
**CN02\_002 First Fix Alignment  
 Plan and Profile  
 Sheet 4 of 4**

Project Ref. No.	Stage	Scale: 1:10000H 1:2000V @ A1
250002-92	2	Dimensions: m

Drawing Number	Project	Originator	Volume
A96PEA - AMAR - HGN - CC	- DR - CH - 002204		
	Location	Type	Role
			Number

Suitability	Suitability Description	Revision
S2	Fit For Information	P01

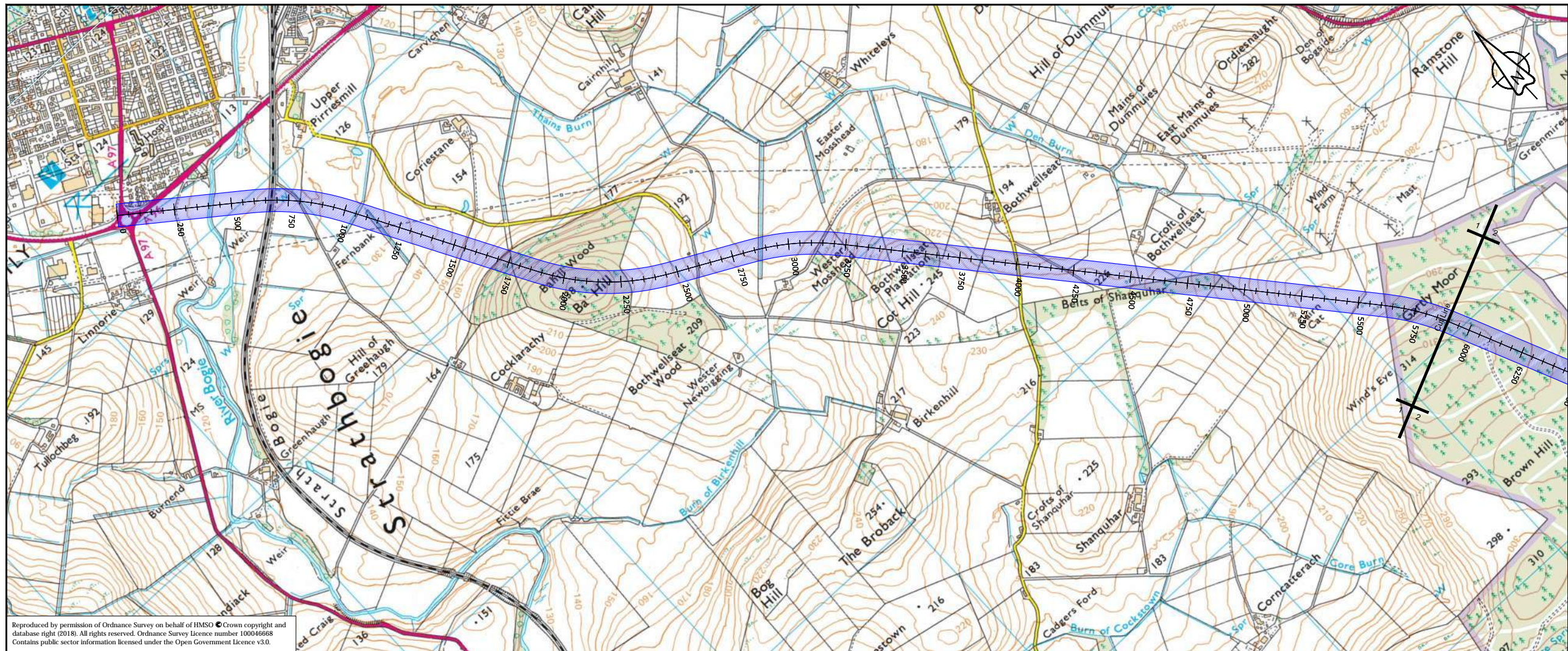

Reproduced by permission of Ordnance Survey on behalf of HMSO © Crown copyright and database right (2018). All rights reserved. Ordnance Survey Licence number 100046668. Contains public sector information licensed under the Open Government Licence v3.0.

CN02\_003 - LONGSECTION  
SCALE: H 1:10000, V 1:2000, DATUM=119.000

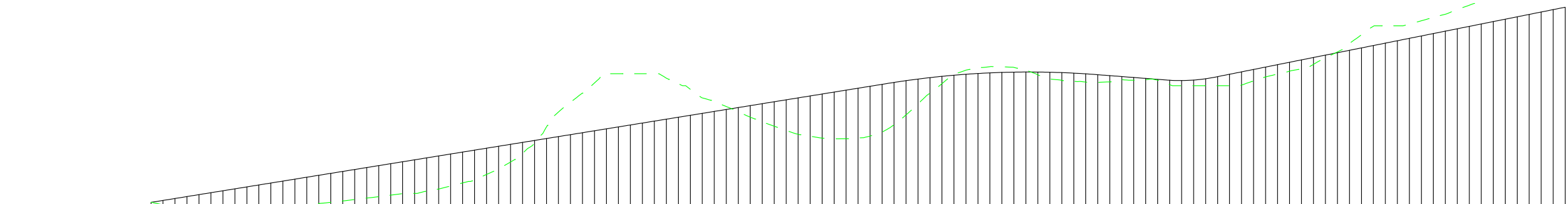

Chainage	Proposed Road Level	Existing Ground Level	Level Difference
0+000	124.177	125.200	1.023
0+100	124.177	125.200	1.023
0+200	124.177	125.200	1.023
0+300	124.177	125.200	1.023
0+400	124.177	125.200	1.023
0+500	124.177	125.200	1.023
0+600	124.177	125.200	1.023
0+700	124.177	125.200	1.023
0+800	124.177	125.200	1.023
0+900	124.177	125.200	1.023
1+000	124.177	125.200	1.023
1+100	124.177	125.200	1.023
1+200	124.177	125.200	1.023
1+300	124.177	125.200	1.023
1+400	124.177	125.200	1.023
1+500	124.177	125.200	1.023
1+600	124.177	125.200	1.023
1+700	124.177	125.200	1.023
1+800	124.177	125.200	1.023
1+900	124.177	125.200	1.023
2+000	124.177	125.200	1.023
2+100	124.177	125.200	1.023
2+200	124.177	125.200	1.023
2+300	124.177	125.200	1.023
2+400	124.177	125.200	1.023
2+500	124.177	125.200	1.023
2+600	124.177	125.200	1.023
2+700	124.177	125.200	1.023
2+800	124.177	125.200	1.023
2+900	124.177	125.200	1.023
3+000	124.177	125.200	1.023
3+100	124.177	125.200	1.023
3+200	124.177	125.200	1.023
3+300	124.177	125.200	1.023
3+400	124.177	125.200	1.023
3+500	124.177	125.200	1.023
3+600	124.177	125.200	1.023
3+700	124.177	125.200	1.023
3+800	124.177	125.200	1.023
3+900	124.177	125.200	1.023
4+000	124.177	125.200	1.023
4+100	124.177	125.200	1.023
4+200	124.177	125.200	1.023
4+300	124.177	125.200	1.023
4+400	124.177	125.200	1.023
4+500	124.177	125.200	1.023
4+600	124.177	125.200	1.023
4+700	124.177	125.200	1.023
4+800	124.177	125.200	1.023
4+900	124.177	125.200	1.023
5+000	124.177	125.200	1.023

P01	Fit For Information - First Fix Alignments				
	SC	CP	CL	CB	GMaD
	02/03/18	02/03/18	02/03/18	02/03/18	02/03/18
Revision	Revision details				
	Created	Checked	Reviewed	Approved	Authorised
	dd/mm/yy	dd/mm/yy	dd/mm/yy	dd/mm/yy	dd/mm/yy

Designer  
Precision House  
McNeill Drive  
Motherwell  
ML1 4UR



Client  
58 Port Dundas Road  
Glasgow  
G4 0HF



Project Name  
A96 Dualling East of Huntly to Aberdeen

Drawing Title  
CN02\_003 First Fix Alignment  
Plan and Profile  
Sheet 1 of 4

Project Ref. No. 250002-92	Stage 2	Scale: 1:10000H 1:2000V @ A1 Dimensions: m
-------------------------------	------------	---

Drawing Number  
Project | Originator | Volume |  
A96PEA - AMAR - HGN -  
CC - DR-CH- 002301  
Location | Type | Role | Number

Suitability S2	Suitability Description Fit For Information	Revision P01
-------------------	--	-----------------

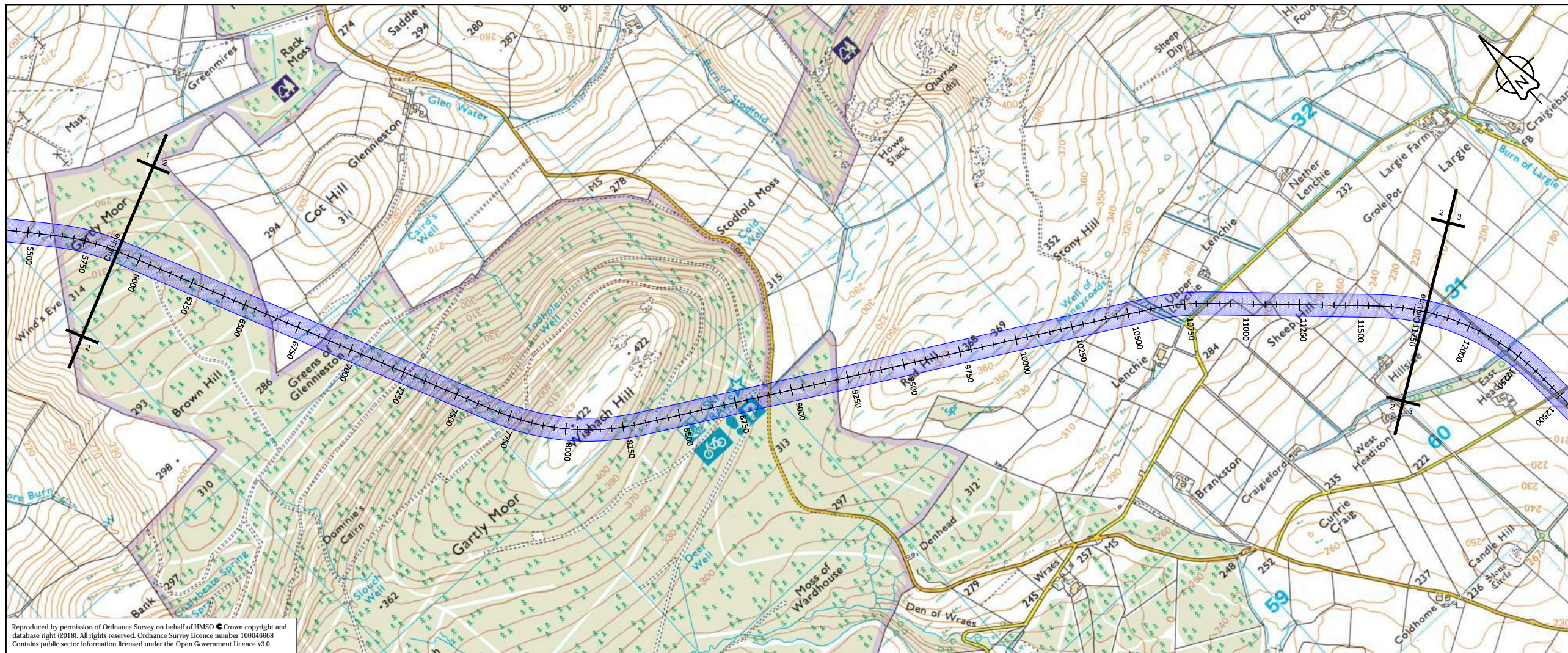

Reproduced by permission of Ordnance Survey on behalf of HMSO © Crown copyright and database right (2018). All rights reserved. Ordnance Survey Licence number 100046668. Contains public sector information licensed under the Open Government Licence v3.0.

CN02\_003 - LONGSECTION  
SCALE: H 1:10000, V 1:2000. DATUM=201.000

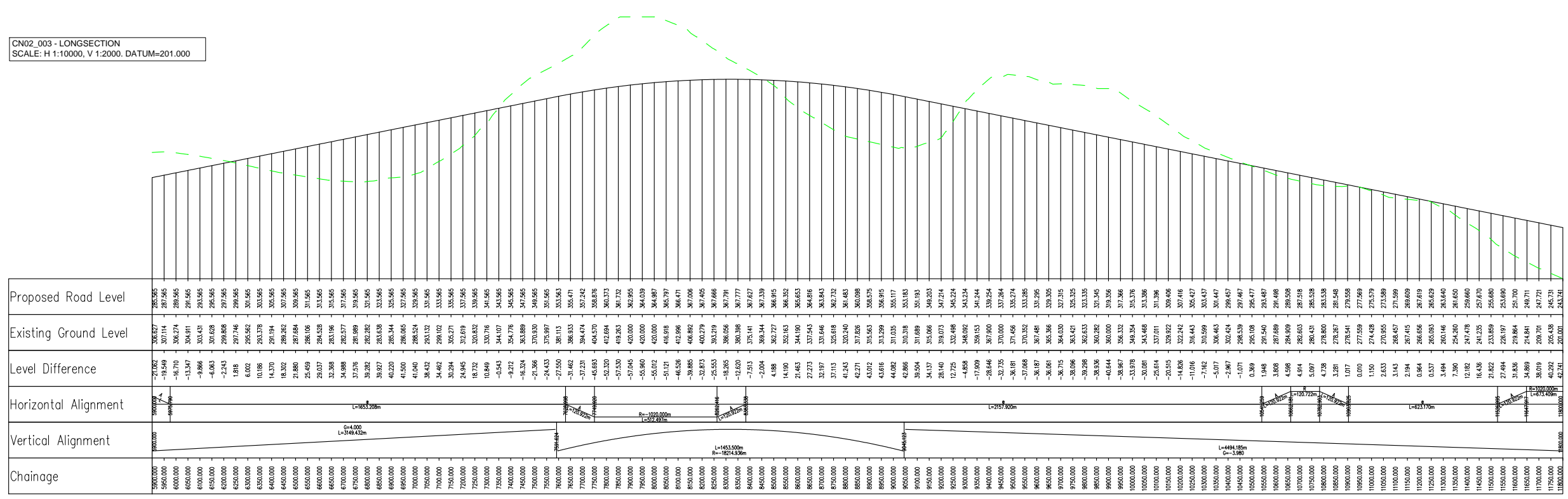

P01	Fit For Information - First Fix Alignments				
	SC	CP	CL	CB	GMacD
	02/03/18	02/03/18	02/03/18	02/03/18	02/03/18
Revision	Revision details				
	Created	Checked	Reviewed	Approved	Authorised
	dd/mm/yy	dd/mm/yy	dd/mm/yy	dd/mm/yy	dd/mm/yy

Designer  
Precision House  
McNeil Drive  
Motherwell  
ML1 4UR



Client  
58 Port Dundas Road  
Glasgow  
G4 0HF



Project Name  
A96 Dualling East of Huntly to Aberdeen

Drawing Title  
CN02\_003 First Fix Alignment  
Plan and Profile  
Sheet 2 of 4

Project Ref. No.	Stage	Scale: 1:10000H 1:2000V @ A1
250002-92	2	Dimensions: m

Drawing Number  
Project | Originator | Volume |  
A96PEA - AMAR - HGN -  
CC -DR-CH- 002302  
Location | Type | Role | Number

Suitability	Suitability Description	Revision
S2	Fit For Information	P01





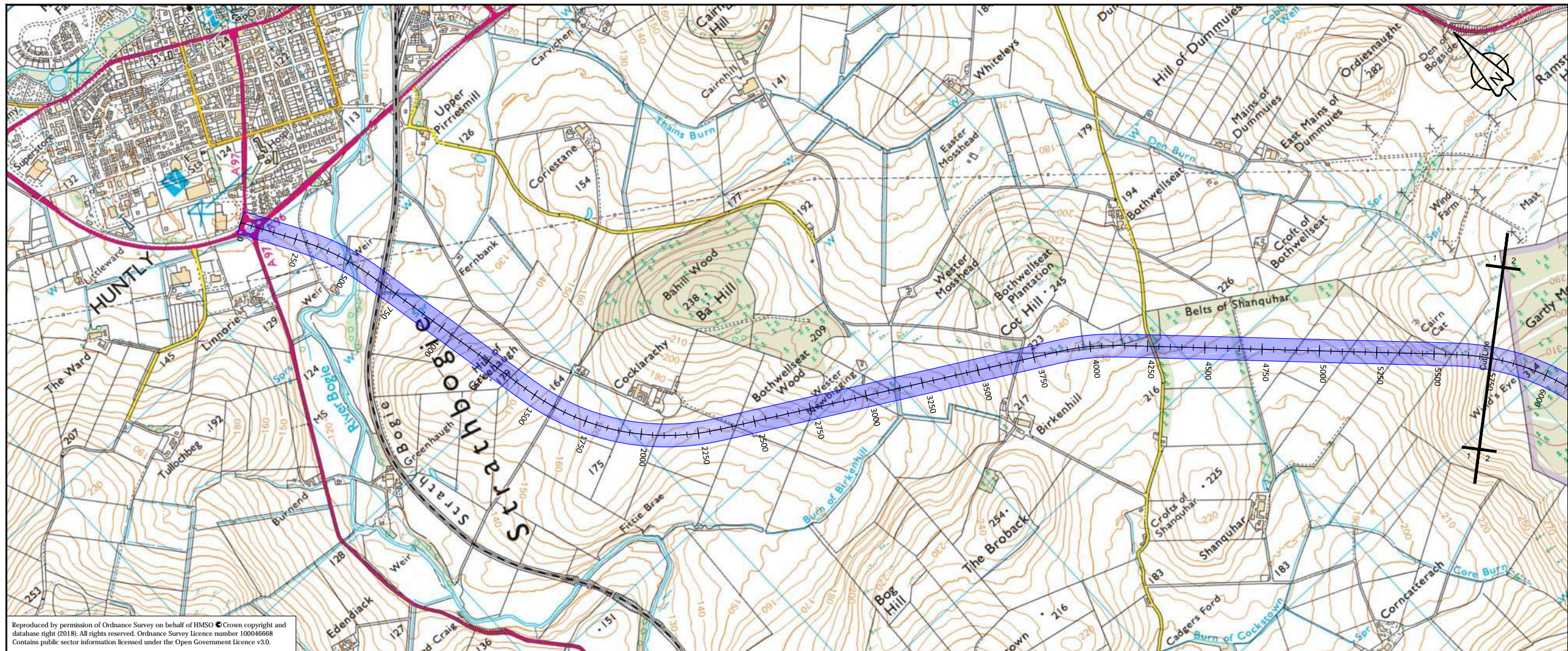

Reproduced by permission of Ordnance Survey on behalf of HMSO © Crown copyright and database right (2018). All rights reserved. Ordnance Survey Licence number 100046668  
 Contains public sector information licensed under the Open Government Licence v3.0.

CN02\_004 - LONGSECTION  
 SCALE: H 1:10000, V 1:2000. DATUM=119.000

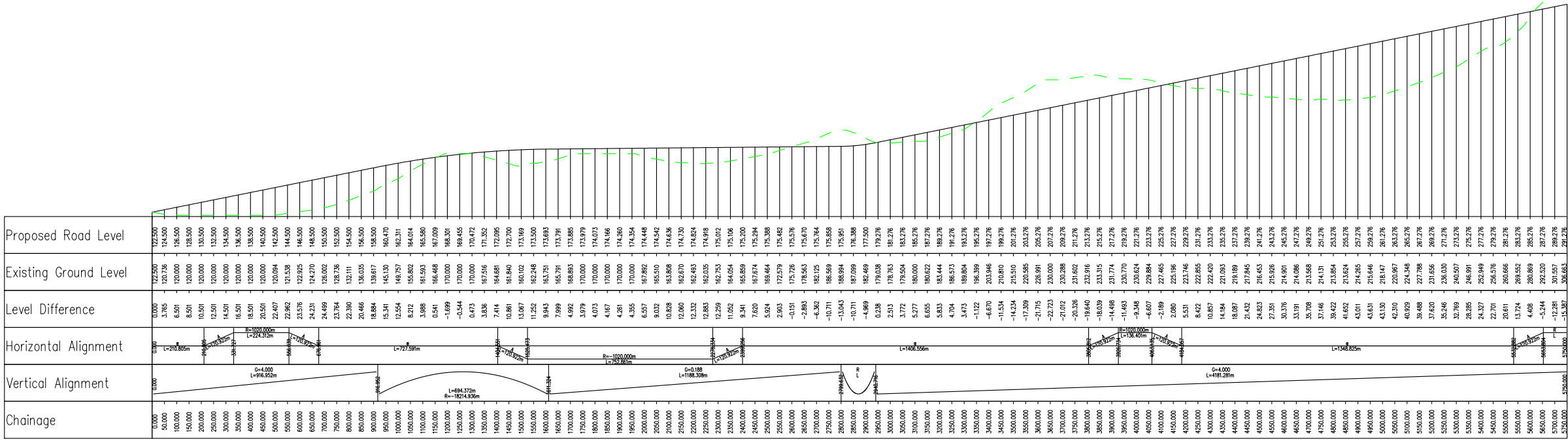

P01	Fit For Information - First Fix Alignments				
	SC	CP	CL	CB	GMacD
	02/03/18	02/03/18	02/03/18	02/03/18	02/03/18

Designer  
 Precision House  
 McNeil Drive  
 Motherwell  
 ML1 4UR



Client  
 58 Port Dundas Road  
 Glasgow  
 G4 0HF



Project Name  
 A96 Dualling East of Huntly to Aberdeen

Drawing Title  
 CN02\_004 First Fix Alignment  
 Plan and Profile  
 Sheet 1 of 5

Project Ref. No. 250002-92	Stage 2	Scale: 1:10000H 1:2000V @ A1 Dimensions: m
-------------------------------	------------	---

Drawing Number  
 Project | Originator | Volume |  
 A96PEA - AMAR - HGN -  
 CC - DR-CH- 002401  
 Location | Type | Role | Number

Suitability S2	Suitability Description Fit For Information	Revision P01
-------------------	--	-----------------



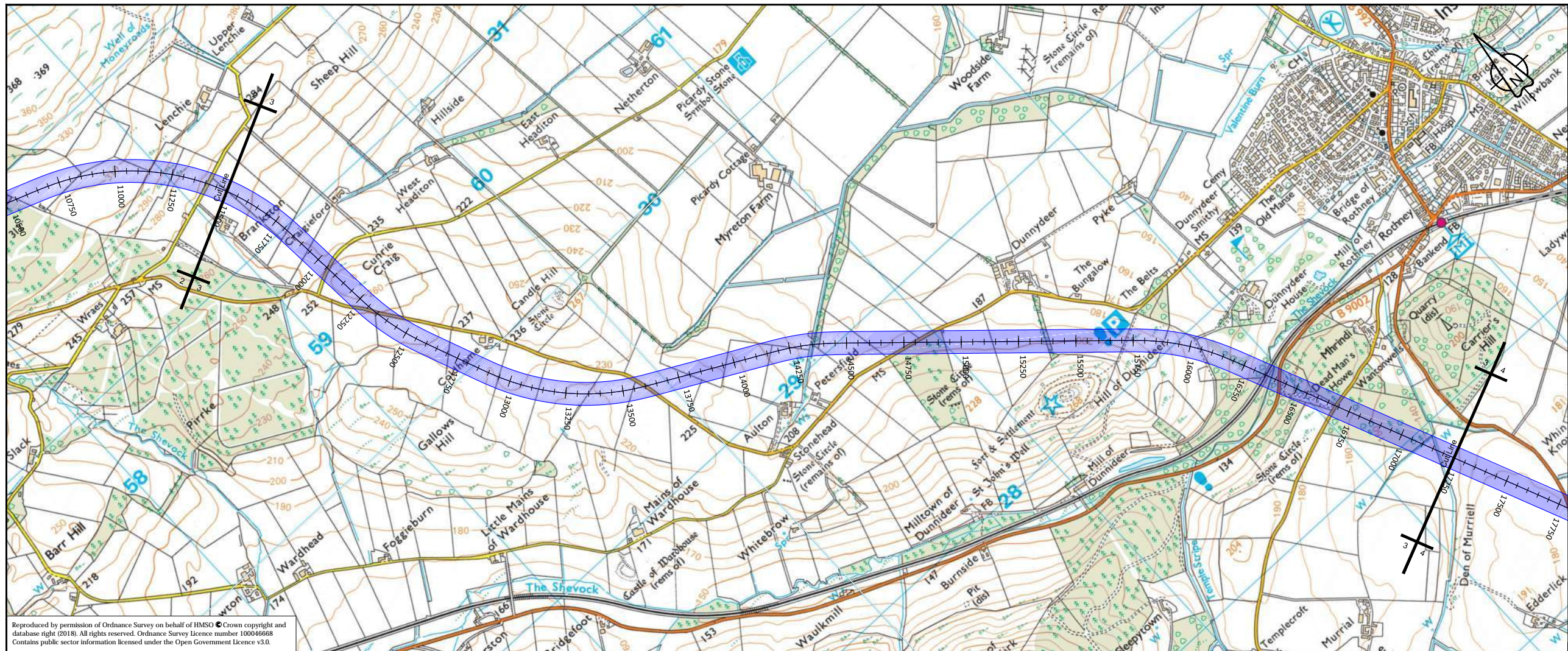

Reproduced by permission of Ordnance Survey on behalf of HMSO © Crown copyright and database right (2018). All rights reserved. Ordnance Survey Licence number 100046668  
 Contains public sector information licensed under the Open Government Licence v3.0.

CN02\_004 - LONGSECTION  
 SCALE: H 1:10000, V 1:2000, DATUM=129.000

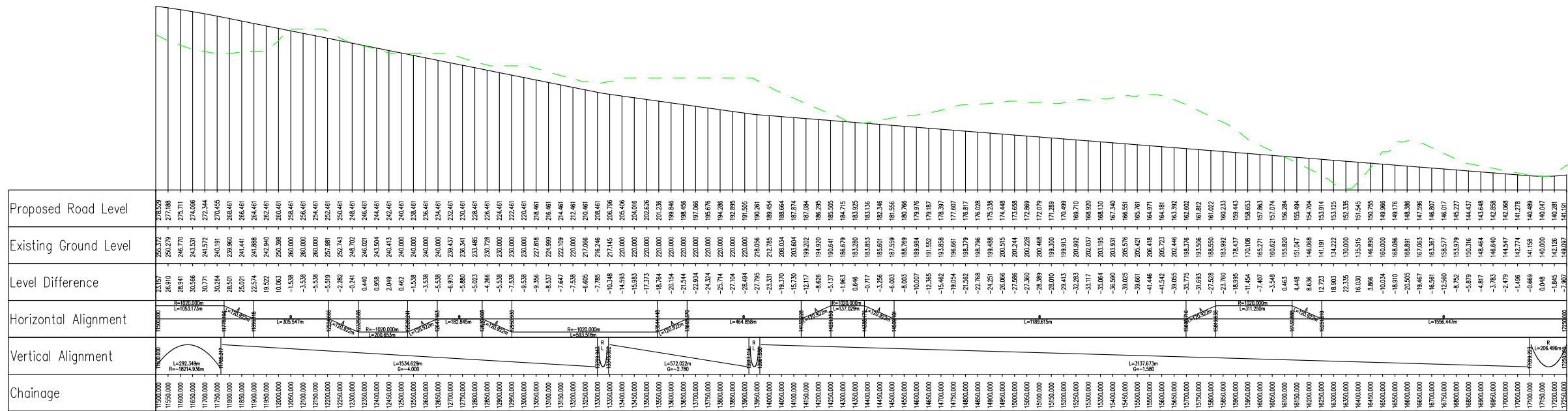

P01	Fit For Information - First Fix Alignments				
	SC	CP	CL	CB	GMacD
	02/03/18	02/03/18	02/03/18	02/03/18	02/03/18

Revision details

Revision	Created	Checked	Reviewed	Approved	Authorised
	dd/mm/yy	dd/mm/yy	dd/mm/yy	dd/mm/yy	dd/mm/yy

Designer  
 Precision House  
 McNeil Drive  
 Motherwell  
 ML1 4UR

Client  
 58 Port Dundas Road  
 Glasgow  
 G4 0HF

Project Name  
**A96 Dualling East of Huntly to Aberdeen**

Drawing Title  
**CN02\_004 First Fix Alignment Plan and Profile**  
 Sheet 3 of 5

Project Ref. No. 250002-92	Stage 2	Scale: 1:10000H 1:2000V @ A1 Dimensions: m
-------------------------------	------------	---

Drawing Number	Project	Originator	Volume
	A96PEA	- AMAR - HGN -	
	CC	-DR-CH-	002403
	Location	Type	Role

Suitability S2	Suitability Description Fit For Information	Revision P01
-------------------	--	-----------------



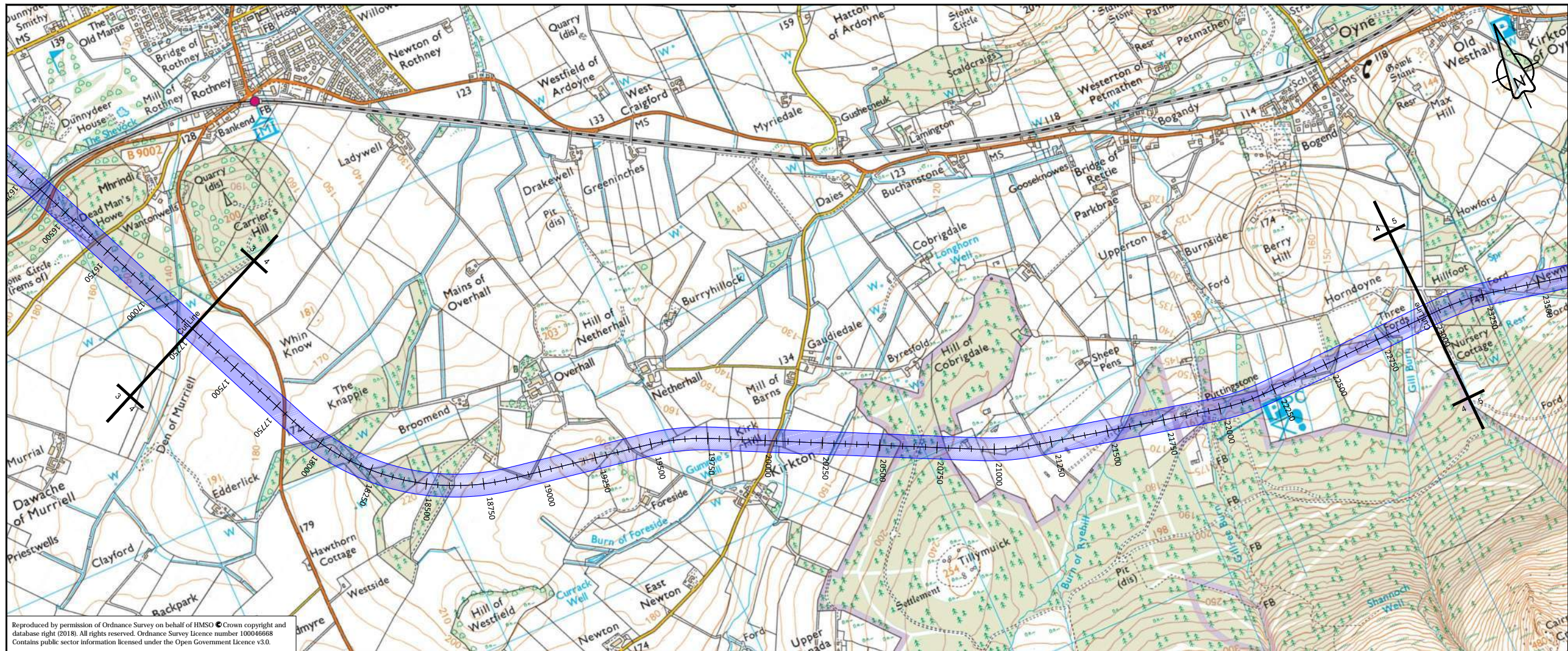

Reproduced by permission of Ordnance Survey on behalf of HMSO © Crown copyright and database right (2018). All rights reserved. Ordnance Survey Licence number 100046668  
 Contains public sector information licensed under the Open Government Licence v3.0.

CN02\_004 - LONGSECTION  
 SCALE: H 1:10000, V 1:2000, DATUM=139.000

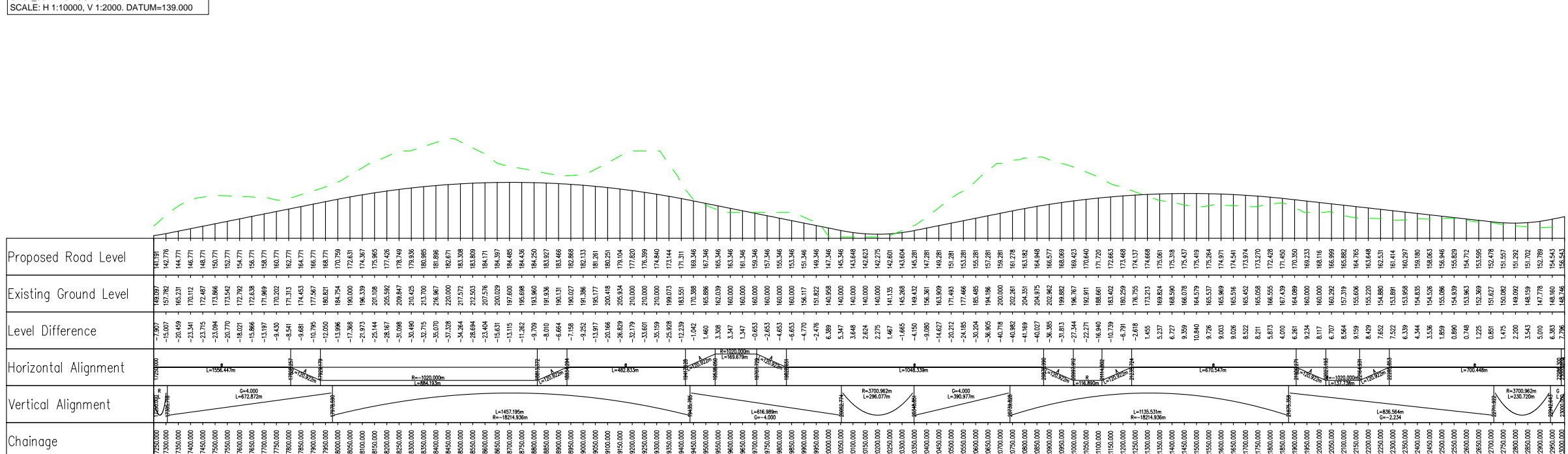

Fit For Information - First Fix Alignments					
SC	CP	CL	CB	GMacD	
02/03/18	02/03/18	02/03/18	02/03/18	02/03/18	02/03/18

Designer  
 Precision House  
 McNeil Drive  
 Motherwell  
 ML1 4UR

Client  
 58 Port Dundas Road  
 Glasgow  
 G4 0HF

Project Name  
**A96 Dualling East of Huntly to Aberdeen**

Drawing Title  
**CN02\_004 First Fix Alignment Plan and Profile**  
 Sheet 4 of 5

Project Ref. No.	Stage	Scale
250002-92	2	1:10000H:1:2000V @ A1

Drawing Number	Project	Originator	Volume
CC	A96PEA	AMAR	HGN
	-DR-CH-	002404	

Suitability	Suitability Description	Revision
S2	Fit For Information	P01



Reproduced by permission of Ordnance Survey on behalf of HMSO © Crown copyright and database right (2018). All rights reserved. Ordnance Survey Licence number 100046668  
 Contains public sector information licensed under the Open Government Licence v3.0.

CN02\_004 - LONGSECTION  
 SCALE: H 1:10000, V 1:2000, DATUM=148.000

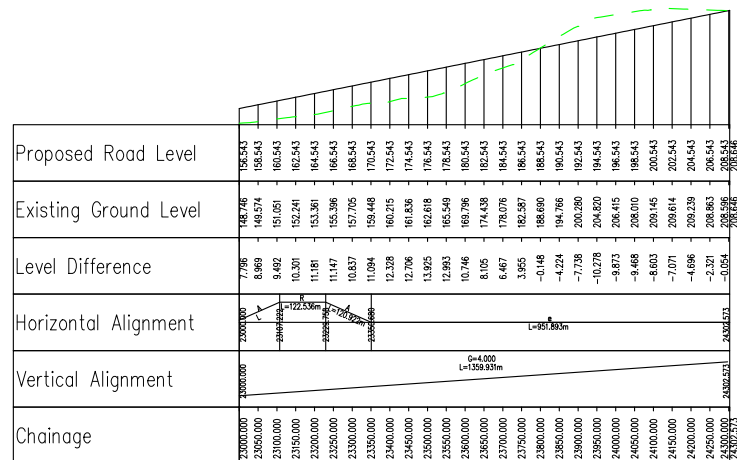

P01	Fit For Information - First Fix Alignments				
	SC	CP	CL	CB	GMacD
	02/03/18	02/03/18	02/03/18	02/03/18	02/03/18

Revision	Revision details				
	Created	Checked	Reviewed	Approved	Authorised
	dd/mm/yy	dd/mm/yy	dd/mm/yy	dd/mm/yy	dd/mm/yy

Designer  
 Precision House  
 McNeil Drive  
 Motherwell  
 ML1 4UR

Client  
 58 Port Dundas Road  
 Glasgow  
 G4 0HF

Project Name  
**A96 Dualling East of Huntly to Aberdeen**

Drawing Title  
**CN02\_004 First Fix Alignment Plan and Profile Sheet 5 of 5**

Project Ref. No. 250002-92	Stage 2	Scale: 1:10000H:1:2000V @ A1 Dimensions: m
-------------------------------	------------	---

Drawing Number	Project	Originator	Volume
	A96PEA	- AMAR -	HGN -
	CC	- DR - CH -	002405
	Location	Type	Role

Suitability	Suitability Description	Revision
S2	Fit For Information	P01