

Reproduced by permission of Ordnance Survey on behalf of HMSO © Crown copyright and database right (2018). All rights reserved. Ordnance Survey Licence number 1000466688. Contains public sector information licensed under the Open Government Licence v3.0.

CN03_001-LONGSECTION
SCALE: H 1:10000, V 1:2000

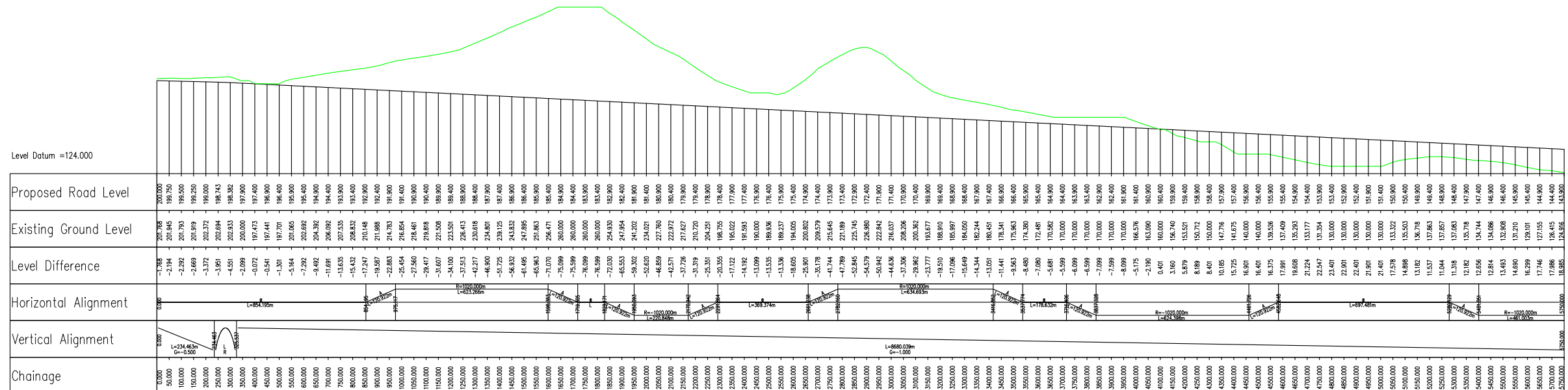

P01	Fit For Information - First Fix Alignments				
	TD	SC	CL	CB	GMacD
	02/03/18	02/03/18	02/03/18	02/03/18	02/03/18

Designer
Precision House
McNeil Drive
Motherwell
ML1 4UR



Client
58 Port Dundas Road
Glasgow
G4 0HF



Project Name
A96 Dualling East of Huntly to Aberdeen

Drawing Title
CN03_001 First Fix Alignment
Plan and Profile
Sheet 1 of 3

Project Ref. No. 250002-92	Stage 2	Scale: 1:10000H 1:2000V @ A1 Dimensions: M
-------------------------------	------------	---

Drawing Number
Project | Originator | Volume |
A96PEA - AMAR - HGN -
CC - DR-CH- 003101
Location | Type | Role | Number

Suitability S2	Suitability Description Fit For Information	Revision P01
-------------------	--	-----------------

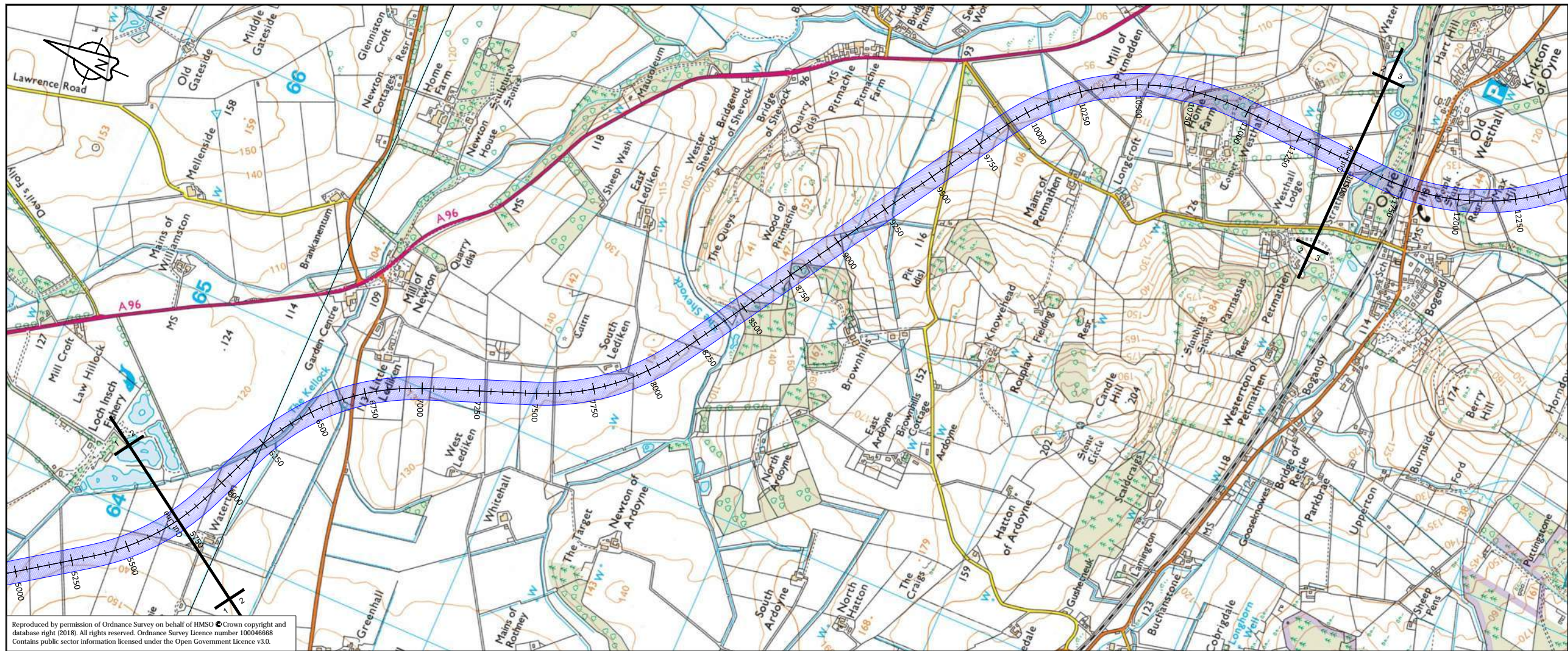

Reproduced by permission of Ordnance Survey on behalf of HMSO © Crown copyright and database right (2018). All rights reserved. Ordnance Survey Licence number 100046668
 Contains public sector information licensed under the Open Government Licence v3.0.

CN03_001-LONGSECTION
 SCALE: H 1:10000, V 1:2000

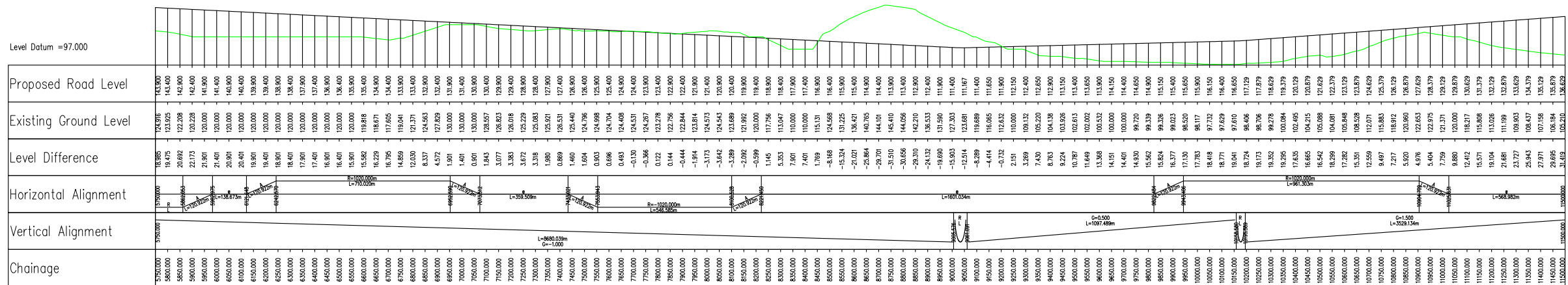

P01	Fit For Information - First Fix Alignments				
	TD	SC	CL	CB	GMacD
	02/03/18	02/03/18	02/03/18	02/03/18	02/03/18
Revision	Revision details				
	Created	Checked	Reviewed	Approved	Authorised
	dd/mm/yy	dd/mm/yy	dd/mm/yy	dd/mm/yy	dd/mm/yy

Designer
 Precision House
 McNeil Drive
 Motherwell
 ML1 4UR



Client
 58 Port Dundas Road
 Glasgow
 G4 0HF



Project Name
A96 Dualling East of Huntly to Aberdeen

Drawing Title
**CN03_001 First Fix Alignment
 Plan and Profile
 Sheet 2 of 3**

Project Ref. No.	Stage	Scale: 1:10000H 1:2000V @ A1
250002-92	2	Dimensions: M

Drawing Number	Project	Originator	Volume
CC	A96PEA	- AMAR - HGN -	
Location	Role	Number	

Suitability	Suitability Description	Revision
S2	Fit For Information	P01

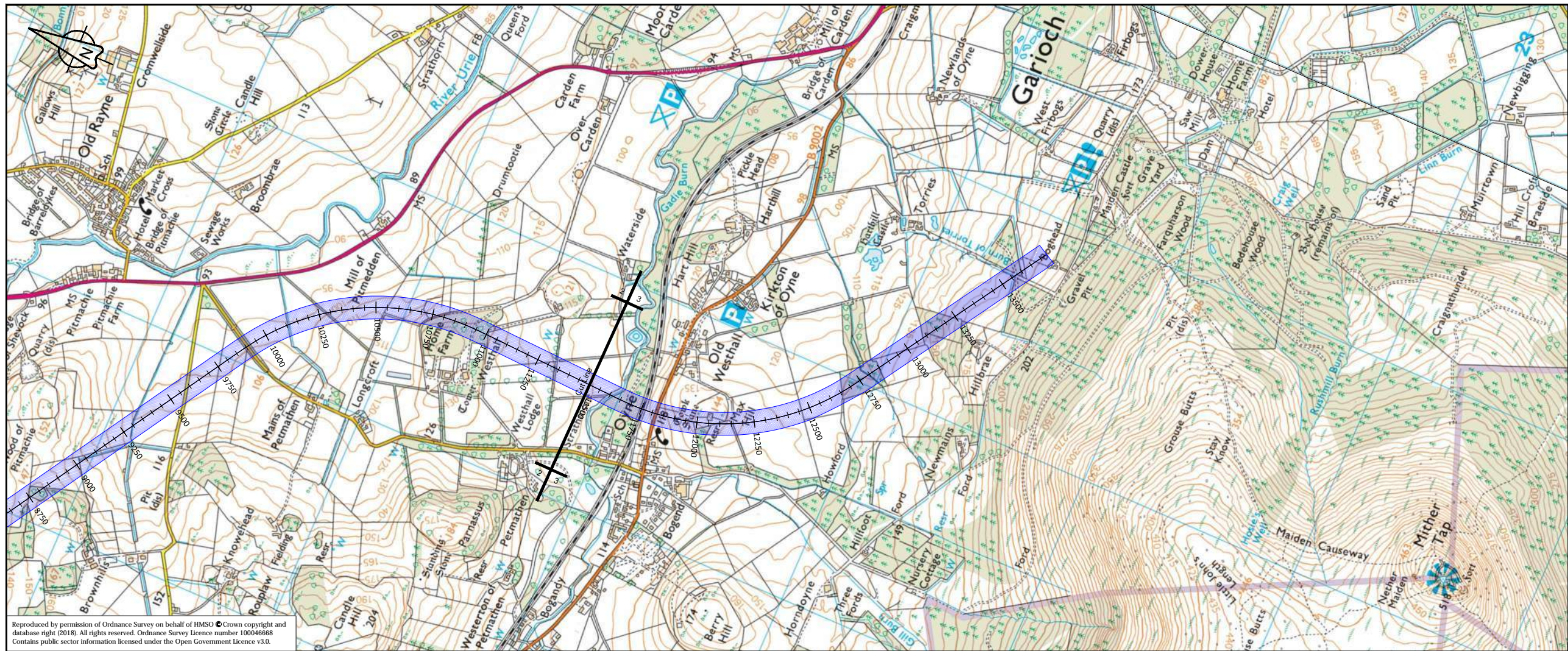

Reproduced by permission of Ordnance Survey on behalf of HMSO © Crown copyright and database right (2018). All rights reserved. Ordnance Survey Licence number 100046668
 Contains public sector information licensed under the Open Government Licence v3.0.

CN03_001- LONGSECTION
 SCALE: H 1:10000, V 1:2000

Level Datum =102.000

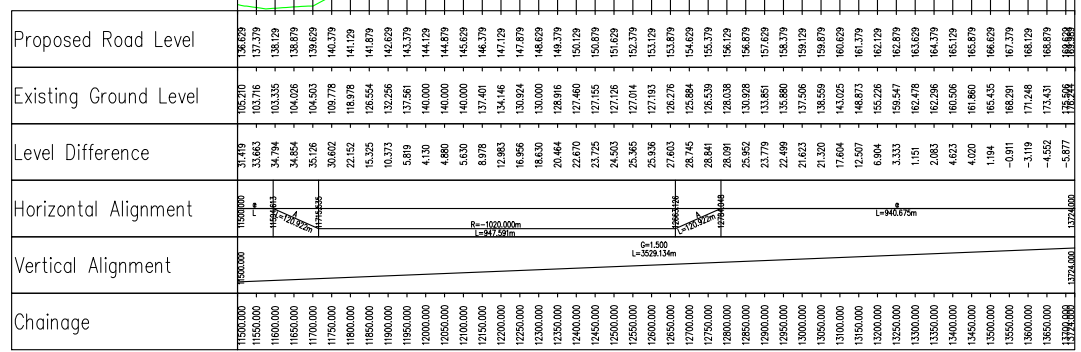

P01	Fit For Information - First Fix Alignments				
	TD	SC	CL	CB	GMacD
	02/03/18	02/03/18	02/03/18	02/03/18	02/03/18
Revision	Revision details				
	Created	Checked	Reviewed	Approved	Authorised
	dd/mm/yy	dd/mm/yy	dd/mm/yy	dd/mm/yy	dd/mm/yy

Designer
 Precision House
 McNeil Drive
 Motherwell
 ML1 4UR



Client
 58 Port Dundas Road
 Glasgow
 G4 0HF



Project Name
A96 Dualling East of Huntly to Aberdeen

Drawing Title
CN03_001 First Fix Alignment Plan and Profile Sheet 3 of 3

Project Ref. No. 250002-92	Stage 2	Scale : 1:10000H 1:2000V @ A1 Dimensions : M
-------------------------------	------------	---

Drawing Number	Project	Originator	Volume
A96PEA - AMAR - HGN - CC			
	Location	Type	Role
			Number

Suitability	Suitability Description	Revision
S2	Fit For Information	P01

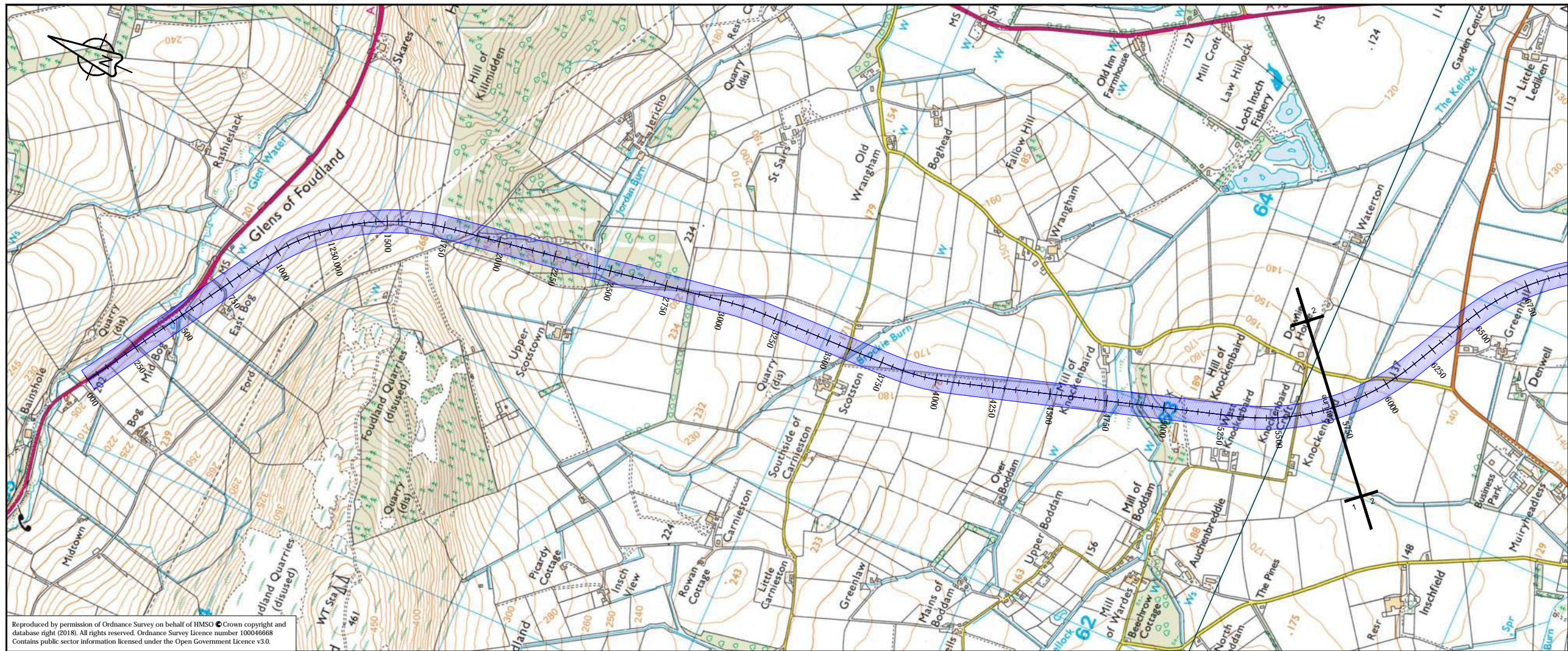

Reproduced by permission of Ordnance Survey on behalf of HMSO © Crown copyright and database right (2018). All rights reserved. Ordnance Survey Licence number 100046688. Contains public sector information licensed under the Open Government Licence v3.0.

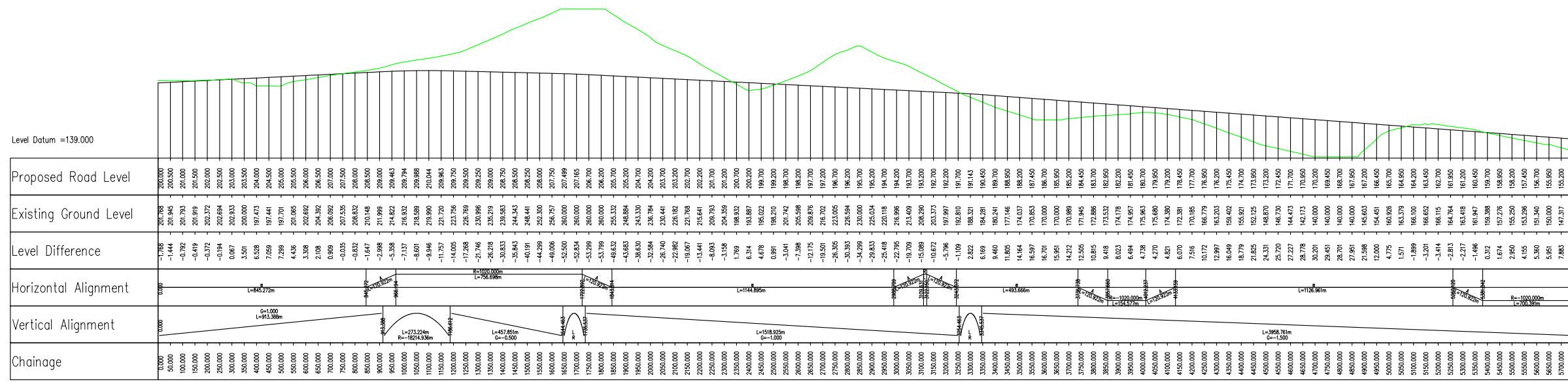

Chainage	Proposed Road Level	Existing Ground Level	Level Difference
0+000	200.000	207.785	-7.785
50.000	200.500	201.845	-1.444
100.000	201.000	201.793	-0.792
150.000	201.500	201.819	-0.419
200.000	202.000	202.372	-0.372
250.000	202.500	202.694	-0.194
300.000	203.000	202.933	0.067
350.000	203.500	203.000	0.500
400.000	204.000	197.441	6.559
450.000	204.500	197.701	7.799
500.000	205.000	201.065	4.435
550.000	205.500	202.692	3.308
600.000	206.000	204.392	2.108
650.000	206.500	206.932	0.969
700.000	207.000	207.535	-0.035
750.000	207.500	208.832	-1.332
800.000	208.000	210.146	-2.146
850.000	208.500	211.999	-3.499
900.000	209.000	214.622	-5.622
950.000	209.500	218.794	-9.294
1000.000	210.000	218.589	-8.589
1050.000	210.500	218.990	-8.490
1100.000	211.000	221.720	-10.720
1150.000	211.500	223.756	-12.256
1200.000	212.000	226.769	-14.769
1250.000	212.500	230.966	-18.466
1300.000	213.000	235.219	-22.219
1350.000	213.500	239.583	-26.083
1400.000	214.000	244.143	-30.143
1450.000	214.500	248.441	-33.941
1500.000	215.000	252.300	-37.300
1550.000	215.500	256.757	-41.257
1600.000	216.000	260.000	-44.000
1650.000	216.500	263.834	-47.334
1700.000	217.000	267.000	-50.000
1750.000	217.500	269.793	-52.293
1800.000	218.000	272.000	-54.000
1850.000	218.500	273.532	-55.032
1900.000	219.000	274.684	-55.684
1950.000	219.500	274.700	-55.200
2000.000	220.000	273.700	-53.700
2050.000	220.500	271.700	-51.200
2100.000	221.000	268.700	-47.700
2150.000	221.500	264.700	-42.700
2200.000	222.000	260.000	-36.000
2250.000	222.500	254.700	-28.700
2300.000	223.000	249.000	-21.000
2350.000	223.500	242.800	-12.800
2400.000	224.000	236.200	-3.800
2450.000	224.500	229.200	5.300
2500.000	225.000	221.800	13.200
2550.000	225.500	214.000	21.500
2600.000	226.000	205.800	30.200
2650.000	226.500	197.200	39.300
2700.000	227.000	188.200	48.800
2750.000	227.500	178.700	58.800
2800.000	228.000	168.700	69.300
2850.000	228.500	158.200	79.300
2900.000	229.000	147.200	88.800
2950.000	229.500	135.700	97.800
3000.000	230.000	123.700	106.300
3050.000	230.500	111.200	119.300
3100.000	231.000	98.200	132.800
3150.000	231.500	84.700	146.800
3200.000	232.000	70.700	161.300
3250.000	232.500	56.200	176.300
3300.000	233.000	41.200	191.800
3350.000	233.500	25.700	207.800
3400.000	234.000	10.700	224.300
3450.000	234.500	-4.800	241.300
3500.000	235.000	-20.800	258.800
3550.000	235.500	-37.300	276.800
3600.000	236.000	-54.300	295.300
3650.000	236.500	-71.800	314.300
3700.000	237.000	-89.800	333.800
3750.000	237.500	-108.300	353.800
3800.000	238.000	-127.300	374.300
3850.000	238.500	-146.800	395.300
3900.000	239.000	-166.800	416.800
3950.000	239.500	-187.300	438.800
4000.000	240.000	-208.300	461.300
4050.000	240.500	-229.800	484.300
4100.000	241.000	-251.800	507.800
4150.000	241.500	-274.300	531.800
4200.000	242.000	-297.300	556.300
4250.000	242.500	-320.800	581.300
4300.000	243.000	-344.800	606.800
4350.000	243.500	-369.300	632.800
4400.000	244.000	-394.300	659.300
4450.000	244.500	-419.800	686.300
4500.000	245.000	-445.800	713.800
4550.000	245.500	-472.300	741.800
4600.000	246.000	-499.300	770.300
4650.000	246.500	-526.800	799.300
4700.000	247.000	-554.800	828.800
4750.000	247.500	-583.300	858.800
4800.000	248.000	-612.300	889.300
4850.000	248.500	-641.800	920.300
4900.000	249.000	-671.800	951.800
4950.000	249.500	-702.300	983.800
5000.000	250.000	-733.300	1016.300
5050.000	250.500	-764.800	1049.300
5100.000	251.000	-796.800	1082.800
5150.000	251.500	-829.300	1116.800
5200.000	252.000	-862.300	1151.300
5250.000	252.500	-895.800	1186.300
5300.000	253.000	-929.800	1221.800
5350.000	253.500	-964.300	1257.800
5400.000	254.000	-999.300	1294.300
5450.000	254.500	-1034.800	1331.300
5500.000	255.000	-1070.800	1368.800
5550.000	255.500	-1107.300	1406.800
5600.000	256.000	-1144.300	1445.300
5650.000	256.500	-1181.800	1484.300
5700.000	257.000	-1219.800	1523.800
5750.000	257.500	-1258.300	1563.800
5800.000	258.000	-1297.300	1604.300
5850.000	258.500	-1336.800	1645.300
5900.000	259.000	-1376.800	1686.800
5950.000	259.500	-1417.300	1728.800
6000.000	260.000	-1458.300	1771.300
6050.000	260.500	-1499.800	1814.300
6100.000	261.000	-1541.800	1857.800
6150.000	261.500	-1584.300	1901.800
6200.000	262.000	-1627.300	1946.300
6250.000	262.500	-1670.800	1991.300
6300.000	263.000	-1714.800	2036.800
6350.000	263.500	-1759.300	2082.800
6400.000	264.000	-1804.300	2129.300
6450.000	264.500	-1849.800	2176.300
6500.000	265.000	-1895.800	2223.800
6550.000	265.500	-1942.300	2271.800
6600.000	266.000	-1989.300	2320.300
6650.000	266.500	-2036.800	2369.300
6700.000	267.000	-2084.800	2418.800
6750.000	267.500	-2133.300	2468.800
6800.000	268.000	-2182.300	2519.300
6850.000	268.500	-2231.800	2570.300
6900.000	269.000	-2281.800	2621.800
6950.000	269.500	-2332.300	2673.800
7000.000	270.000	-2383.300	2726.300
7050.000	270.500	-2434.800	2779.300
7100.000	271.000	-2486.800	2832.800
7150.000	271.500	-2539.300	2886.800
7200.000	272.000	-2592.300	2941.300
7250.000	272.500	-2645.800	2996.300
7300.000	273.000	-2699.800	3051.800
7350.000	273.500	-2754.300	3107.800
7400.000	274.000	-2809.300	3164.300
7450.000	274.500	-2864.800	3221.300
7500.000	275.000	-2920.800	3278.800
7550.000	275.500	-2977.300	3336.800
7600.000	276.000	-3034.300	3395.300
7650.000	276.500	-3091.800	3454.300
7700.000	277.000	-3149.800	3513.800
7750.000	277.500	-3208.300	3573.800
7800.000	278.000	-3267.300	3634.300
7850.000	278.500	-3326.800	3695.300
7900.000	279.000	-3386.800	3756.800
7950.000	279.500	-3447.300	3818.800
8000.000	280.000	-3508.300	3881.300
8050.000	280.500	-3569.800	3944.300
8100.000	281.000	-3631.800	4007.800
8150.000	281.500	-3694.300	4071.800
8200.000	282.000	-3757.300	4136.300
8250.000	282.500	-3820.800	4201.300
8300.000	283.000	-3884.800	4266.800
8350.000	283.500	-3949.300	4332.800
8400.000	284.000	-4014.300	4399.300
8450.000	284.500	-4079.800	4466.300
8500.000	285.000	-4145.800	4533.800
8550.000	285.500	-4212.300	4601.800
8600.000	286.000	-4279.300	4670.300
8650.000	286.500	-4346.800	4739.300
8700.000	287.000	-4414.800	4808.800
8750.000	287.500	-4483.300	4878.800
8800.000	288.000	-4552.300	4949.300
8850.000	288.500	-4621.800	5020.300
8900.000	289.000	-4691.800	5091.800
8950.000	289.500	-4762.300	5163.800
9000.000	290.000	-4833.300	5236.300
9050.000	290.500	-4904.800	5309.300
9100.000	291.000	-4976.800	5382.800
9150.000	291.500	-5049.300	5456.800
9200.000	292.000	-5122.300	5531.300
9250.000	292.500	-5195.800	5606.300
9300.000	293.000	-5269.800	5681.800
9350.000	293.500	-5344.300	5757.800
9400.000	294.000	-5419.300	5834.300
9450.000	294.500	-5494.800	5911.300
9500.000	295.000	-5570.800	5988.800
9550.000	295.500	-5647.300	6066.800
9600.000	296.000	-5724.300	6145.300
9650.000	296.500	-5801.800	6224.300
9700.000	297.000	-5879.800	6303.800
9750.000	297.500	-5958.300	6383.800
9800.000	298.000	-6037.300	6464.300
9850.000	298.500	-6116.800	6545.300
9900.000	299.000	-6196.800	6626.800
9950.000	299.500	-6277.300	6708.800
10000.000	300.000	-6358.300	6791.300

P01	Fit For Information - First Fix Alignments				
	TD	SC	CL	CB	GMacD
	02/03/18	02/03/18	02/03/18	02/03/18	02/03/18
Revision	Revision details				
	Created	Checked	Reviewed	Approved	Authorised
	dd/mm/yy	dd/mm/yy	dd/mm/yy	dd/mm/yy	dd/mm/yy

Designer
Precision House
McNeil Drive
Motherwell
ML1 4UR

Client
58 Port Dundas Road
Glasgow
G4 0HF

Project Name
A96 Dualling East of Huntly to Aberdeen

Drawing Title
CN03_002 First Fix Alignment Plan and Profile Sheet 1 of 3

Project Ref. No.	Stage	Scale
250002-92	2	1:10000H:1:2000V @ A1
Dimensions: M		

Drawing Number
Project | Originator | Volume |
A96PEA - AMAR - HGN -
CC -DR-CH- 003201
Location | Type | Role | Number

Suitability	Suitability Description	Revision
S2	Fit For Information	P01

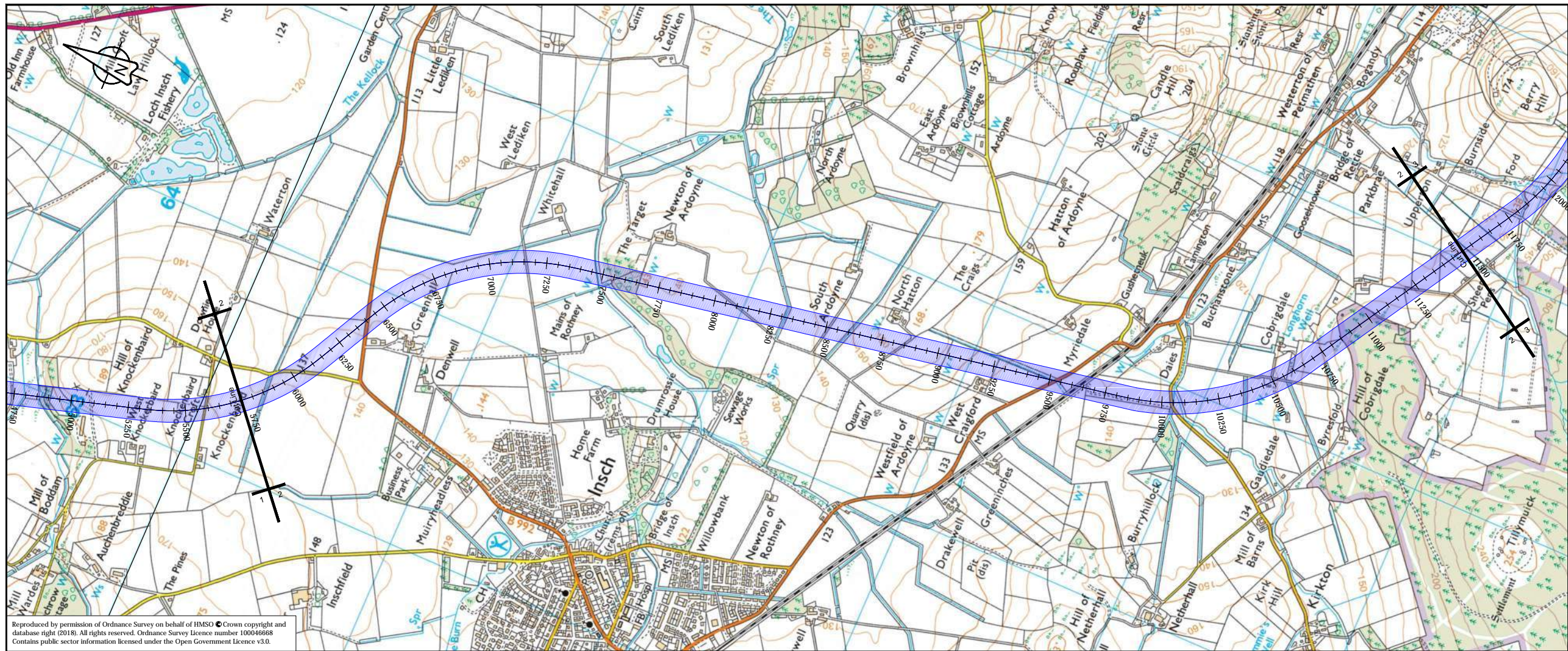

Reproduced by permission of Ordnance Survey on behalf of HMSO © Crown copyright and database right (2018). All rights reserved. Ordnance Survey Licence number 100046668
 Contains public sector information licensed under the Open Government Licence v3.0.

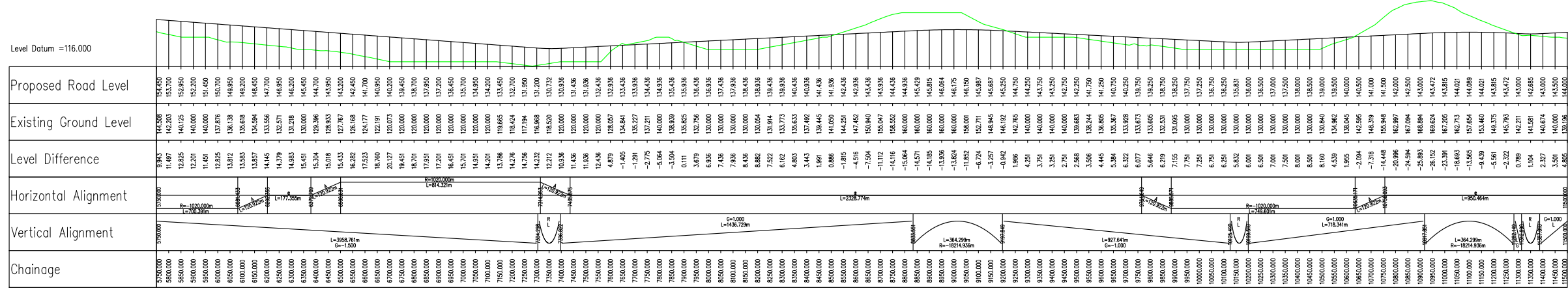

Chainage	Proposed Road Level	Existing Ground Level	Level Difference
9750.000	144.500	144.306	0.194
9800.000	143.700	142.250	1.450
9850.000	142.900	140.200	2.700
9900.000	142.100	138.150	3.950
9950.000	141.300	136.100	5.200
10000.000	140.500	134.050	6.450
10050.000	139.700	132.000	7.700
10100.000	138.900	130.000	8.900
10150.000	138.100	128.000	10.100
10200.000	137.300	126.000	11.300
10250.000	136.500	124.000	12.500
10300.000	135.700	122.000	13.700
10350.000	134.900	120.000	14.900
10400.000	134.100	118.000	16.100
10450.000	133.300	116.000	17.300
10500.000	132.500	114.000	18.500
10550.000	131.700	112.000	19.700
10600.000	130.900	110.000	20.900
10650.000	130.100	108.000	22.100
10700.000	129.300	106.000	23.300
10750.000	128.500	104.000	24.500
10800.000	127.700	102.000	25.700
10850.000	126.900	100.000	26.900
10900.000	126.100	98.000	28.100
10950.000	125.300	96.000	29.300
11000.000	124.500	94.000	30.500
11050.000	123.700	92.000	31.700
11100.000	122.900	90.000	32.900
11150.000	122.100	88.000	34.100
11200.000	121.300	86.000	35.300
11250.000	120.500	84.000	36.500
11300.000	119.700	82.000	37.700
11350.000	118.900	80.000	38.900
11400.000	118.100	78.000	40.100
11450.000	117.300	76.000	41.300
11500.000	116.500	74.000	42.500

P01	Fit For Information - First Fix Alignments				
	TD	SC	CL	CB	GMacD
	02/03/18	02/03/18	02/03/18	02/03/18	02/03/18

Revision details

Revision	Created	Checked	Reviewed	Approved	Authorised
	dd/mm/yy	dd/mm/yy	dd/mm/yy	dd/mm/yy	dd/mm/yy

Designer
 Precision House
 McNeil Drive
 Motherwell
 ML1 4UR

Client
 58 Port Dundas Road
 Glasgow
 G4 0HF

Project Name
A96 Dualling East of Huntly to Aberdeen

Drawing Title
CN03_002 First Fix Alignment Plan and Profile Sheet 2 of 3

Project Ref. No. 250002-92	Stage 2	Scale: 1:10000H 1:2000V @ A1 Dimensions: M
-------------------------------	------------	---

Drawing Number A96PEA - AMAR - HGN - CC - DR-CH- 003202	Project Originator Volume Location Type Role Number
--	---

Suitability S2	Suitability Description Fit For Information	Revision P01
-------------------	--	-----------------

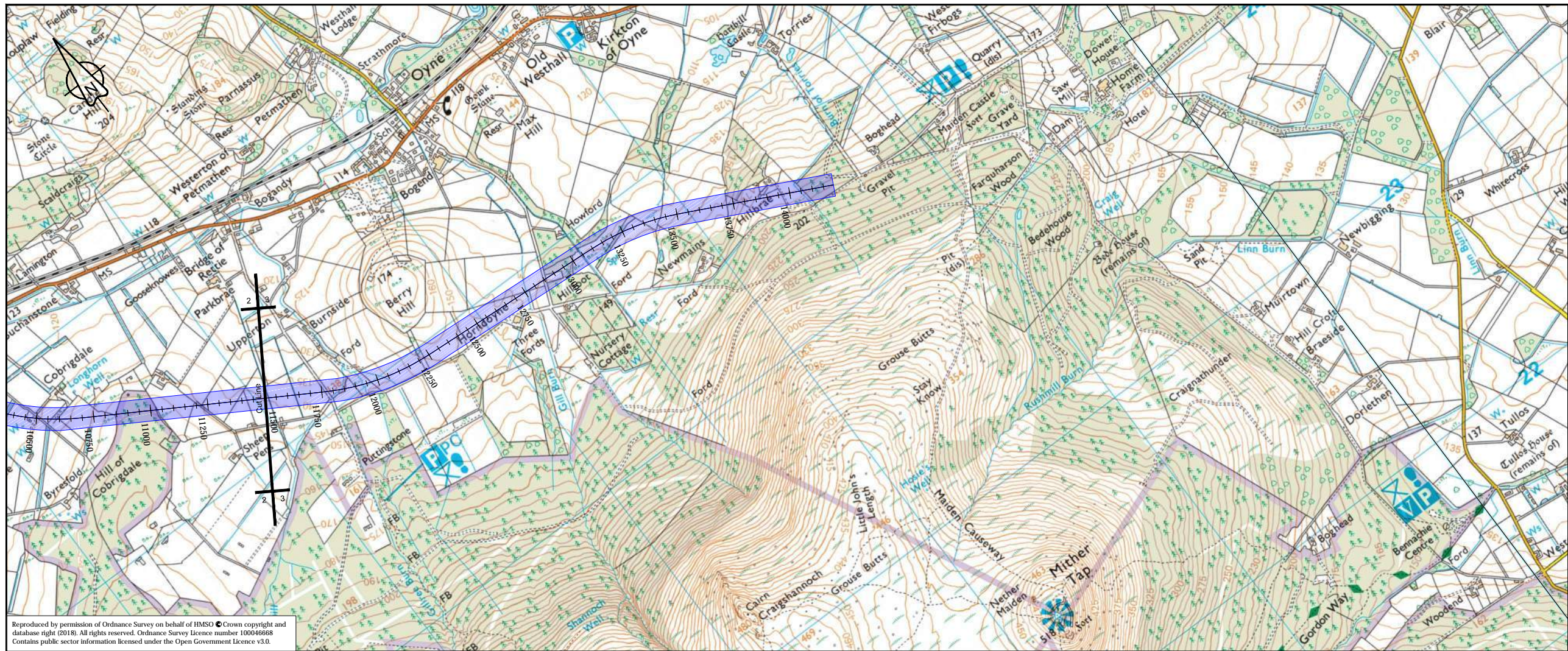

Reproduced by permission of Ordnance Survey on behalf of HMSO © Crown copyright and database right (2018). All rights reserved. Ordnance Survey Licence number 100046668
Contains public sector information licensed under the Open Government Licence v3.0.

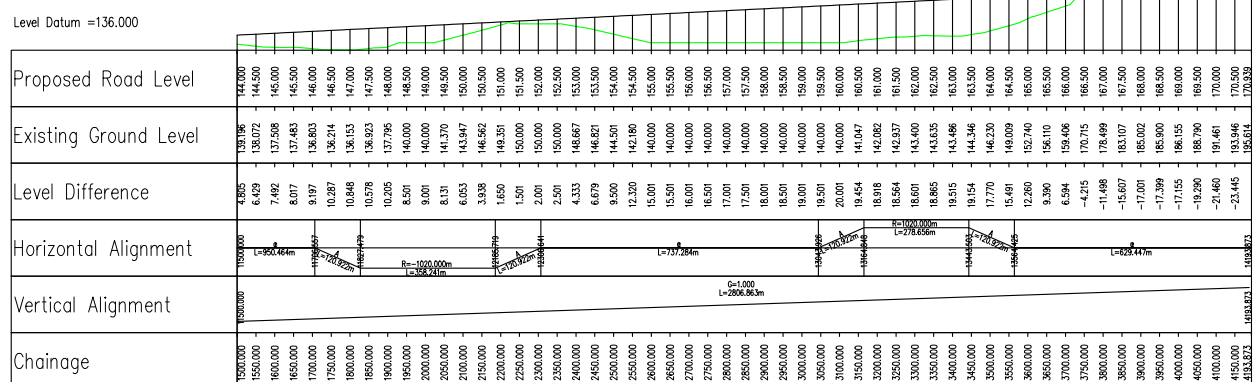

P01	Fit For Information - First Fix Alignments				
	TD	SC	CL	CB	GMacD
	02/03/18	02/03/18	02/03/18	02/03/18	02/03/18
Revision	Revision details				
	Created	Checked	Reviewed	Approved	Authorised
	dd/mm/yy	dd/mm/yy	dd/mm/yy	dd/mm/yy	dd/mm/yy

Designer
Precision House
McNeil Drive
Motherwell
ML1 4UR

Client
58 Port Dundas Road
Glasgow
G4 0HF

Project Name
A96 Dualling East of Huntly to Aberdeen

Drawing Title
CN03_002 First Fix Alignment Plan and Profile Sheet 3 of 3

Project Ref. No.	Stage	Scale
250002-92	2	1:10000H 1:2000V @ A1
Dimensions: M		

Drawing Number	Project	Originator	Volume
CC	A96PEA	- AMAR - HGN -	
Location	Type	Role	Number

Suitability	Suitability Description	Revision
S2	Fit For Information	P01

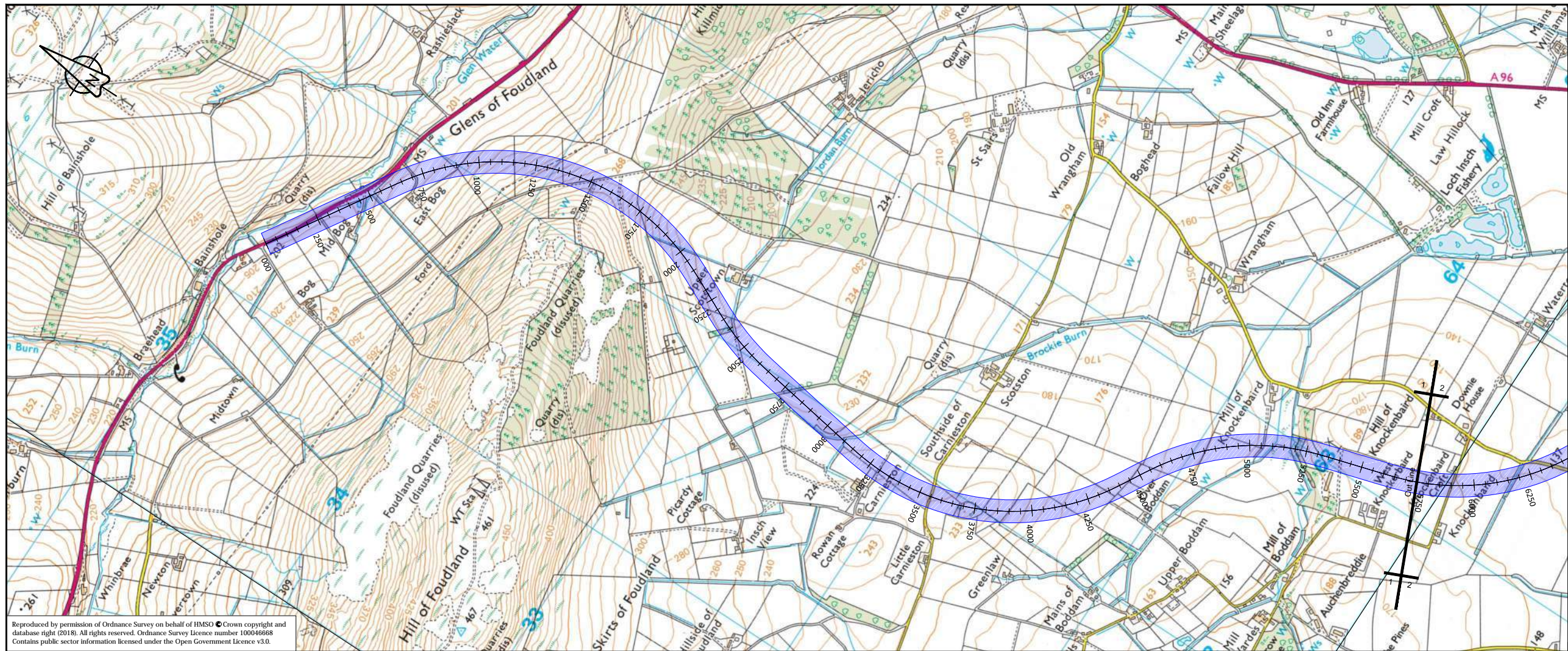

Reproduced by permission of Ordnance Survey on behalf of HMSO © Crown copyright and database right (2018). All rights reserved. Ordnance Survey Licence number 100046688. Contains public sector information licensed under the Open Government Licence v3.0.

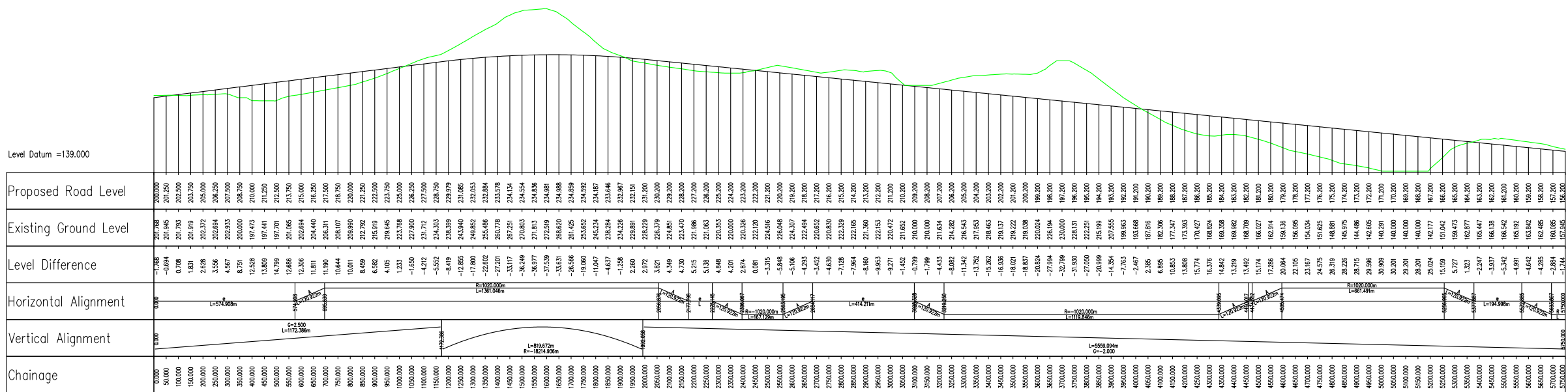

P01	Fit For Information - First Fix Alignments				
	TD	SC	CL	CB	GMacD
	02/03/18	02/03/18	02/03/18	02/03/18	02/03/18

Revision	Revision details				
	Created	Checked	Reviewed	Approved	Authorised
	dd/mm/yy	dd/mm/yy	dd/mm/yy	dd/mm/yy	dd/mm/yy

Designer
Precision House
 McNeil Drive
 Motherwell
 ML1 4UR



Client
 58 Port Dundas Road
 Glasgow
 G4 0HF



Project Name
A96 Dualling East of Huntly to Aberdeen

Drawing Title
CN03_003 First Fix Alignment Plan and Profile Sheet 1 of 3

Project Ref. No. 250002-92	Stage 2	Scale: 1:1000H 1:2000V @ A1 Dimensions: M
-------------------------------	------------	--

Drawing Number A96PEA - AMAR - HGN - CC - DR-CH- 003301	Project Originator Volume Location Type Role Number
--	---

Suitability S2	Suitability Description Fit For Information	Revision P01
-------------------	--	-----------------

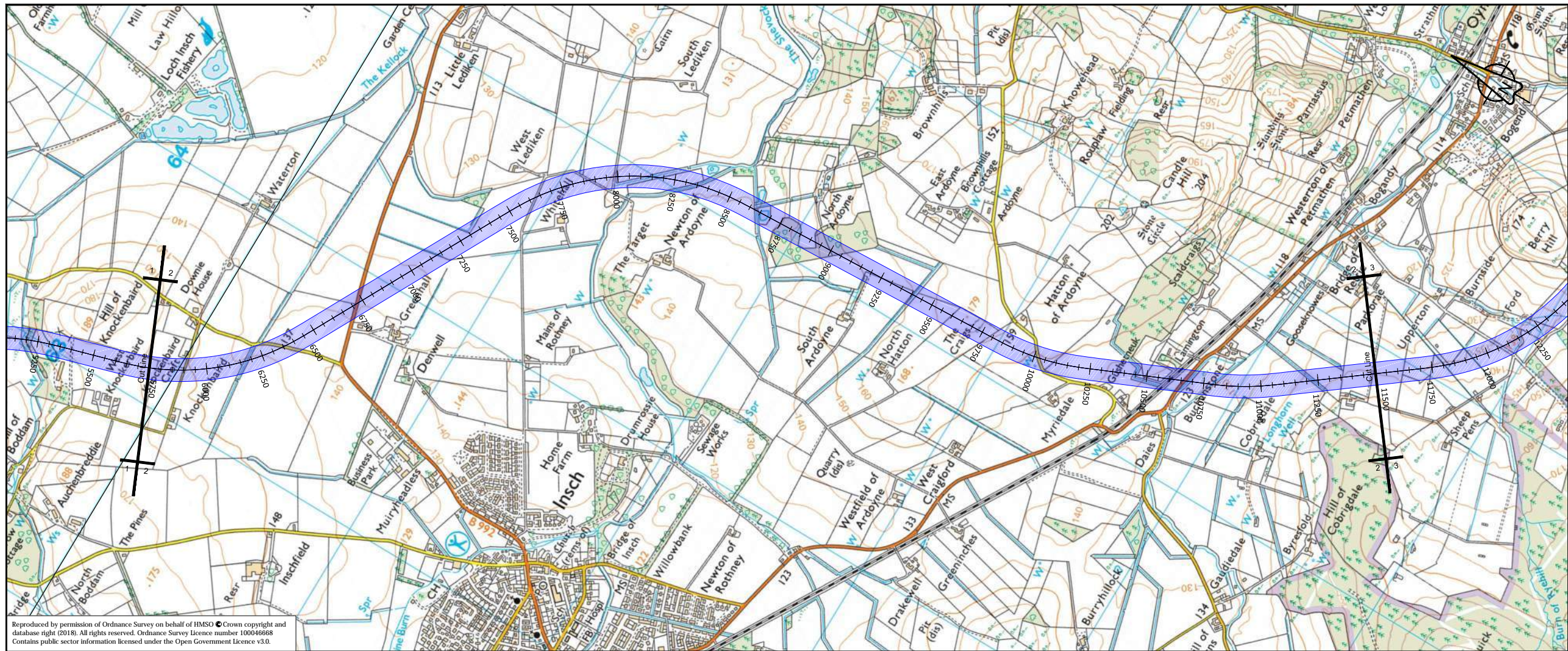

Reproduced by permission of Ordnance Survey on behalf of HMSO © Crown copyright and database right (2018). All rights reserved. Ordnance Survey Licence number 100046668
Contains public sector information licensed under the Open Government Licence v3.0.

Level Datum = 109.000

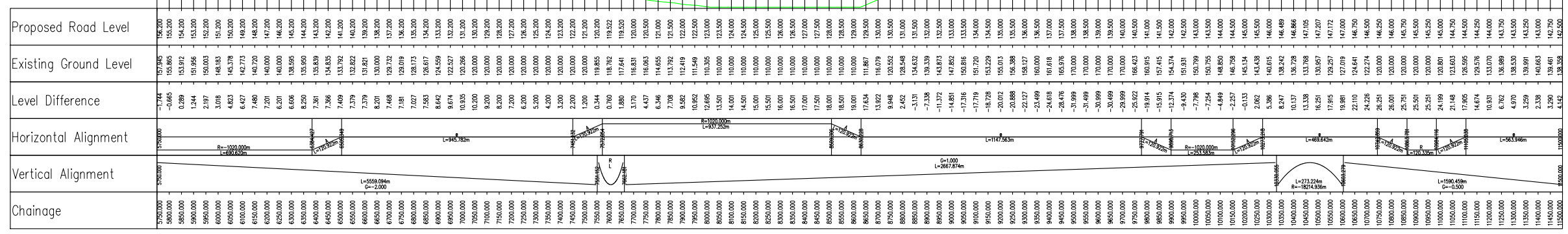

P01	Fit For Information - First Fix Alignments				
	TD	SC	CL	CB	GMacD
	02/03/18	02/03/18	02/03/18	02/03/18	02/03/18
Revision	Revision details				
	Created	Checked	Reviewed	Approved	Authorised
	dd/mm/yy	dd/mm/yy	dd/mm/yy	dd/mm/yy	dd/mm/yy

Designer
Precision House
McNeil Drive
Motherwell
ML1 4UR

Client
58 Port Dundas Road
Glasgow
G4 0HF

Project Name
A96 Dualling East of Huntly to Aberdeen

Drawing Title
CN03_003 First Fix Alignment Plan and Profile Sheet 2 of 3

Project Ref. No. 250002-92	Stage 2	Scale: 1:10000H 1:2000V @ A1 Dimensions: M
-------------------------------	------------	---

Drawing Number	Project	Originator	Volume
A96PEA - AMAR - HGN - CC			
	Location	Type	Role
			Number

Suitability	Suitability Description	Revision
S2	Fit For Information	P01

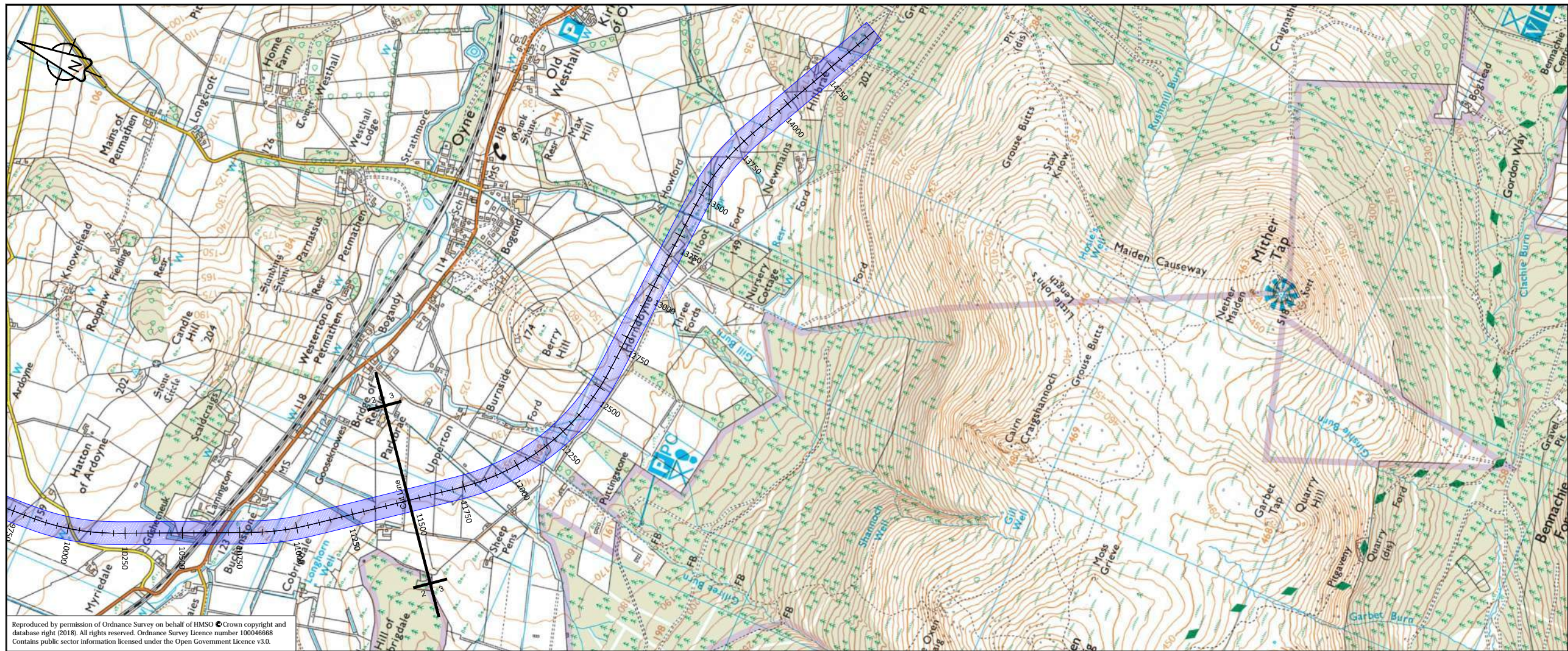

Reproduced by permission of Ordnance Survey on behalf of HMSO © Crown copyright and database right (2018). All rights reserved. Ordnance Survey Licence number 100046668
 Contains public sector information licensed under the Open Government Licence v3.0.

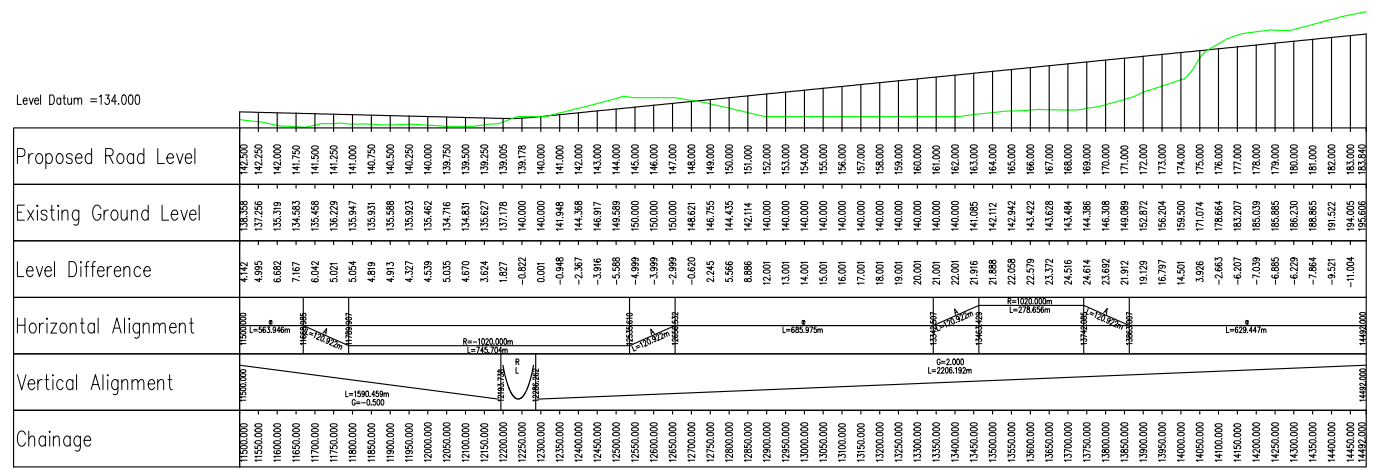

P01	Fit For Information - First Fix Alignments				
	TD	SC	CL	CB	GMacD
	02/03/18	02/03/18	02/03/18	02/03/18	02/03/18

Revision	Revision details				
	Created	Checked	Reviewed	Approved	Authorised
	dd/mm/yy	dd/mm/yy	dd/mm/yy	dd/mm/yy	dd/mm/yy

Designer
 Precision House
 McNeil Drive
 Motherwell
 ML1 4UR

Client
 58 Port Dundas Road
 Glasgow
 G4 0HF

Project Name
A96 Dualling East of Huntly to Aberdeen

Drawing Title
**CN03_003 First Fix Alignment
 Plan and Profile
 Sheet 3 of 3**

Project Ref. No. 250002-92	Stage 2	Scale: 1:10000H 1:2000V @ A1 Dimensions: As shown
-------------------------------	------------	--

Drawing Number	Project	Originator	Volume
A96PEA - AMAR - HGN -	CC	-DR-CH-	003303
	Location	Type	Role

Suitability	Suitability Description	Revision
S2	Fit For Information	P01

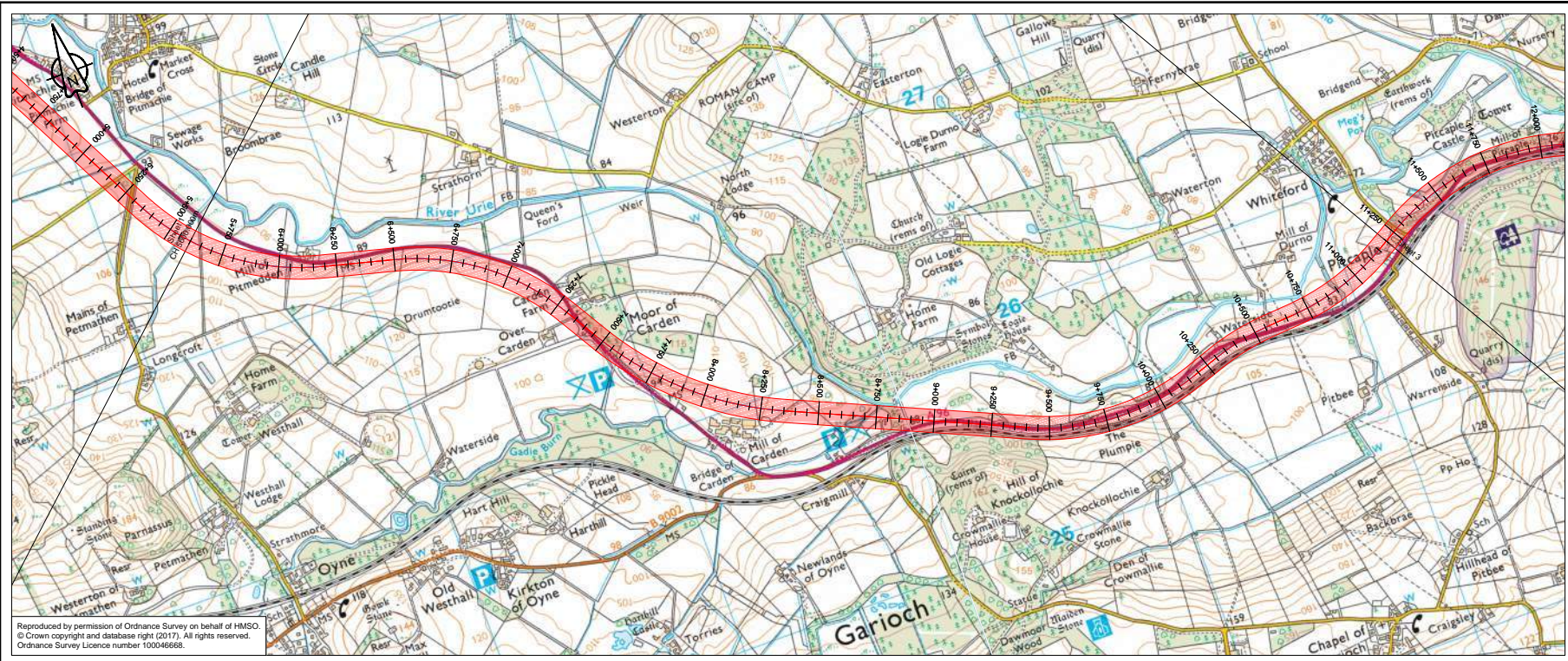

Reproduced by permission of Ordnance Survey on behalf of HMSO. © Crown copyright and database right (2017). All rights reserved. Ordnance Survey Licence number 100046668.

OLC_001 - LONGSECTION
SCALE: H 1:10000, V 1:2000, DATUM: 40,000

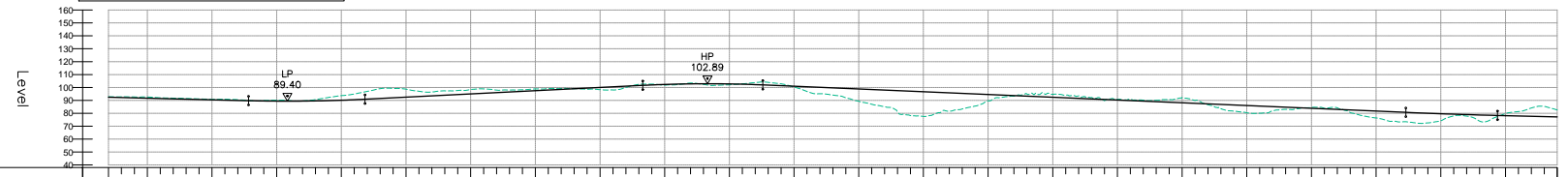

Proposed Road Level	92.484 92.234 91.984 91.734 91.484 91.234 90.984 90.734 90.484 90.234 89.984 89.734 89.484 89.234 88.984 88.734 88.484 88.234 87.984 87.734 87.484 87.234 86.984 86.734 86.484 86.234 85.984 85.734 85.484 85.234 84.984 84.734 84.484 84.234 83.984 83.734 83.484 83.234 82.984 82.734 82.484 82.234 81.984 81.734 81.484 81.234 80.984 80.734 80.484 80.234 79.984 79.734 79.484 79.234 78.984 78.734 78.484 78.234 77.984 77.734 77.484 77.234 76.984 76.734 76.484 76.234 75.984 75.734 75.484 75.234 74.984 74.734 74.484 74.234 73.984 73.734 73.484 73.234 72.984 72.734 72.484 72.234 71.984 71.734 71.484 71.234 70.984 70.734 70.484 70.234 69.984 69.734 69.484 69.234 68.984 68.734 68.484 68.234 67.984 67.734 67.484 67.234 66.984 66.734 66.484 66.234 65.984 65.734 65.484 65.234 64.984 64.734 64.484 64.234 63.984 63.734 63.484 63.234 62.984 62.734 62.484 62.234 61.984 61.734 61.484 61.234 60.984 60.734 60.484 60.234 59.984 59.734 59.484 59.234 58.984 58.734 58.484 58.234 57.984 57.734 57.484 57.234 56.984 56.734 56.484 56.234 55.984 55.734 55.484 55.234 54.984 54.734 54.484 54.234 53.984 53.734 53.484 53.234 52.984 52.734 52.484 52.234 51.984 51.734 51.484 51.234 50.984 50.734 50.484 50.234 49.984 49.734 49.484 49.234 48.984 48.734 48.484 48.234 47.984 47.734 47.484 47.234 46.984 46.734 46.484 46.234 45.984 45.734 45.484 45.234 44.984 44.734 44.484 44.234 43.984 43.734 43.484 43.234 42.984 42.734 42.484 42.234 41.984 41.734 41.484 41.234 40.984 40.734 40.484 40.234 39.984 39.734 39.484 39.234 38.984 38.734 38.484 38.234 37.984 37.734 37.484 37.234 36.984 36.734 36.484 36.234 35.984 35.734 35.484 35.234 34.984 34.734 34.484 34.234 33.984 33.734 33.484 33.234 32.984 32.734 32.484 32.234 31.984 31.734 31.484 31.234 30.984 30.734 30.484 30.234 29.984 29.734 29.484 29.234 28.984 28.734 28.484 28.234 27.984 27.734 27.484 27.234 26.984 26.734 26.484 26.234 25.984 25.734 25.484 25.234 24.984 24.734 24.484 24.234 23.984 23.734 23.484 23.234 22.984 22.734 22.484 22.234 21.984 21.734 21.484 21.234 20.984 20.734 20.484 20.234 19.984 19.734 19.484 19.234 18.984 18.734 18.484 18.234 17.984 17.734 17.484 17.234 16.984 16.734 16.484 16.234 15.984 15.734 15.484 15.234 14.984 14.734 14.484 14.234 13.984 13.734 13.484 13.234 12.984 12.734 12.484 12.234 11.984 11.734 11.484 11.234 10.984 10.734 10.484 10.234 9.984 9.734 9.484 9.234 8.984 8.734 8.484 8.234 7.984 7.734 7.484 7.234 6.984 6.734 6.484 6.234 5.984 5.734 5.484 5.234 4.984 4.734 4.484 4.234 3.984 3.734 3.484 3.234 2.984 2.734 2.484 2.234 1.984 1.734 1.484 1.234 0.984 0.734 0.484 0.234 -0.084 -0.334 -0.584 -0.834 -1.084 -1.334 -1.584 -1.834 -2.084 -2.334 -2.584 -2.834 -3.084 -3.334 -3.584 -3.834 -4.084 -4.334 -4.584 -4.834 -5.084 -5.334 -5.584 -5.834 -6.084 -6.334 -6.584 -6.834 -7.084 -7.334 -7.584 -7.834 -8.084 -8.334 -8.584 -8.834 -9.084 -9.334 -9.584 -9.834 -10.084 -10.334 -10.584 -10.834 -11.084 -11.334 -11.584 -11.834 -12.084 -12.334 -12.584 -12.834 -13.084 -13.334 -13.584 -13.834 -14.084 -14.334 -14.584 -14.834 -15.084 -15.334 -15.584 -15.834 -16.084 -16.334 -16.584 -16.834 -17.084 -17.334 -17.584 -17.834 -18.084 -18.334 -18.584 -18.834 -19.084 -19.334 -19.584 -19.834 -20.084 -20.334 -20.584 -20.834 -21.084 -21.334 -21.584 -21.834 -22.084 -22.334 -22.584 -22.834 -23.084 -23.334 -23.584 -23.834 -24.084 -24.334 -24.584 -24.834 -25.084 -25.334 -25.584 -25.834 -26.084 -26.334 -26.584 -26.834 -27.084 -27.334 -27.584 -27.834 -28.084 -28.334 -28.584 -28.834 -29.084 -29.334 -29.584 -29.834 -30.084 -30.334 -30.584 -30.834 -31.084 -31.334 -31.584 -31.834 -32.084 -32.334 -32.584 -32.834 -33.084 -33.334 -33.584 -33.834 -34.084 -34.334 -34.584 -34.834 -35.084 -35.334 -35.584 -35.834 -36.084 -36.334 -36.584 -36.834 -37.084 -37.334 -37.584 -37.834 -38.084 -38.334 -38.584 -38.834 -39.084 -39.334 -39.584 -39.834 -40.084 -40.334 -40.584 -40.834 -41.084 -41.334 -41.584 -41.834 -42.084 -42.334 -42.584 -42.834 -43.084 -43.334 -43.584 -43.834 -44.084 -44.334 -44.584 -44.834 -45.084 -45.334 -45.584 -45.834 -46.084 -46.334 -46.584 -46.834 -47.084 -47.334 -47.584 -47.834 -48.084 -48.334 -48.584 -48.834 -49.084 -49.334 -49.584 -49.834 -50.084 -50.334 -50.584 -50.834 -51.084 -51.334 -51.584 -51.834 -52.084 -52.334 -52.584 -52.834 -53.084 -53.334 -53.584 -53.834 -54.084 -54.334 -54.584 -54.834 -55.084 -55.334 -55.584 -55.834 -56.084 -56.334 -56.584 -56.834 -57.084 -57.334 -57.584 -57.834 -58.084 -58.334 -58.584 -58.834 -59.084 -59.334 -59.584 -59.834 -60.084 -60.334 -60.584 -60.834 -61.084 -61.334 -61.584 -61.834 -62.084 -62.334 -62.584 -62.834 -63.084 -63.334 -63.584 -63.834 -64.084 -64.334 -64.584 -64.834 -65.084 -65.334 -65.584 -65.834 -66.084 -66.334 -66.584 -66.834 -67.084 -67.334 -67.584 -67.834 -68.084 -68.334 -68.584 -68.834 -69.084 -69.334 -69.584 -69.834 -70.084 -70.334 -70.584 -70.834 -71.084 -71.334 -71.584 -71.834 -72.084 -72.334 -72.584 -72.834 -73.084 -73.334 -73.584 -73.834 -74.084 -74.334 -74.584 -74.834 -75.084 -75.334 -75.584 -75.834 -76.084 -76.334 -76.584 -76.834 -77.084 -77.334 -77.584 -77.834 -78.084 -78.334 -78.584 -78.834 -79.084 -79.334 -79.584 -79.834 -80.084 -80.334 -80.584 -80.834 -81.084 -81.334 -81.584 -81.834 -82.084 -82.334 -82.584 -82.834 -83.084 -83.334 -83.584 -83.834 -84.084 -84.334 -84.584 -84.834 -85.084 -85.334 -85.584 -85.834 -86.084 -86.334 -86.584 -86.834 -87.084 -87.334 -87.584 -87.834 -88.084 -88.334 -88.584 -88.834 -89.084 -89.334 -89.584 -89.834 -90.084 -90.334 -90.584 -90.834 -91.084 -91.334 -91.584 -91.834 -92.084 -92.334 -92.584 -92.834 -93.084 -93.334 -93.584 -93.834 -94.084 -94.334 -94.584 -94.834 -95.084 -95.334 -95.584 -95.834 -96.084 -96.334 -96.584 -96.834 -97.084 -97.334 -97.584 -97.834 -98.084 -98.334 -98.584 -98.834 -99.084 -99.334 -99.584 -99.834 -100.084 -100.334 -100.584 -100.834 -101.084 -101.334 -101.584 -101.834 -102.084 -102.334 -102.584 -102.834 -103.084 -103.334 -103.584 -103.834 -104.084 -104.334 -104.584 -104.834 -105.084 -105.334 -105.584 -105.834 -106.084 -106.334 -106.584 -106.834 -107.084 -107.334 -107.584 -107.834 -108.084 -108.334 -108.584 -108.834 -109.084 -109.334 -109.584 -109.834 -110.084 -110.334 -110.584 -110.834 -111.084 -111.334 -111.584 -111.834 -112.084 -112.334 -112.584 -112.834 -113.084 -113.334 -113.584 -113.834 -114.084 -114.334 -114.584 -114.834 -115.084 -115.334 -115.584 -115.834 -116.084 -116.334 -116.584 -116.834 -117.084 -117.334 -117.584 -117.834 -118.084 -118.334 -118.584 -118.834 -119.084 -119.334 -119.584 -119.834 -120.084 -120.334 -120.584 -120.834 -121.084 -121.334 -121.584 -121.834 -122.084 -122.334 -122.584 -122.834 -123.084 -123.334 -123.584 -123.834 -124.084 -124.334 -124.584 -124.834 -125.084 -125.334 -125.584 -125.834 -126.084 -126.334 -126.584 -126.834 -127.084 -127.334 -127.584 -127.834 -128.084 -128.334 -128.584 -128.834 -129.084 -129.334 -129.584 -129.834 -130.084 -130.334 -130.584 -130.834 -131.084 -131.334 -131.584 -131.834 -132.084 -132.334 -132.584 -132.834 -133.084 -133.334 -133.584 -133.834 -134.084 -134.334 -134.584 -134.834 -135.084 -135.334 -135.584 -135.834 -136.084 -136.334 -136.584 -136.834 -137.084 -137.334 -137.584 -137.834 -138.084 -138.334 -138.584 -138.834 -139.084 -139.334 -139.584 -139.834 -140.084 -140.334 -140.584 -140.834 -141.084 -141.334 -141.584 -141.834 -142.084 -142.334 -142.584 -142.834 -143.084 -143.334 -143.584 -143.834 -144.084 -144.334 -144.584 -144.834 -145.084 -145.334 -145.584 -145.834 -146.084 -146.334 -146.584 -146.834 -147.084 -147.334 -147.584 -147.834 -148.084 -148.334 -148.584 -148.834 -149.084 -149.334 -149.584 -149.834 -150.084 -150.334 -150.584 -150.834 -151.084 -151.334 -151.584 -151.834 -152.084 -152.334 -152.584 -152.834 -153.084 -153.334 -153.584 -153.834 -154.084 -154.334 -154.584 -154.834 -155.084 -155.334 -155.584 -155.834 -156.084 -156.334 -156.584 -156.834 -157.084 -157.334 -157.584 -157.834 -158.084 -158.334 -158.584 -158.834 -159.084 -159.334 -159.584 -159.834 -160.084 -160.334 -160.584 -160.834 -161.084 -161.334 -161.584 -161.834 -162.084 -162.334 -162.584 -162.834 -163.084 -163.334 -163.584 -163.834 -164.084 -164.334 -164.584 -164.834 -165.084 -165.334 -165.584 -165.834 -166.084 -166.334 -166.584 -166.834 -167.084 -167.334 -167.584 -167.834 -168.084 -168.334 -168.584 -168.834 -169.084 -169.334 -169.584 -169.834 -170.084 -170.334 -170.584 -170.834 -171.084 -171.334 -171.584 -171.834 -172.084 -172.334 -172.584 -172.834 -173.084 -173.334 -173.584 -173.834 -174.084 -174.334 -174.584 -174.834 -175.084 -175.334 -175.584 -175.834 -176.084 -176.334 -176.584 -176.834 -177.084 -177.334 -177.584 -177.834 -178.084 -178.334 -178.584 -178.834 -179.084 -179.334 -179.584 -179.834 -180.084 -180.334 -180.584 -180.834 -181.084 -181.334 -181.584 -181.834 -182.084 -182.334 -182.584 -182.834 -183.084 -183.334 -183.584 -183.834 -184.084 -184.334 -184.584 -184.834 -185.084 -185.334 -185.584 -185.834 -186.084 -186.334 -186.584 -186.834 -187.084 -187.334 -187.584 -187.834 -188.084 -188.334 -188.584 -188.834 -189.084 -189.334 -189.584 -189.834 -190.084 -190.334 -190.584 -190.834 -191.084 -191.334 -191.584 -191.834 -192.084 -192.334 -192.584 -192.834 -193.084 -193.334 -193.584 -193.834 -194.084 -194.334 -194.584 -194.834 -195.084 -195.334 -195.584 -195.834 -196.084 -196.334 -196.584 -196.834 -197.084 -197.334 -197.584 -197.834 -198.084 -198.334 -198.584 -198.834 -199.084 -199.334 -199.584 -199.834 -200.084 -200.334 -200.584 -200.834 -201.084 -201.334 -201.584 -201.834 -202.084 -202.334 -202.584 -202.834 -203.084 -203.334 -203.584 -203.834 -204.084 -204.334 -204.584 -204.834 -205.084 -205.334 -205.584 -205.834 -206.084 -206.334 -206.584 -206.834 -207.084 -207.334 -207.584 -207.834 -208.084 -208.334 -208.584 -208.834 -209.084 -209.334 -209.584 -209.834 -210.084 -210.334 -210.584 -210.834 -211.084 -211.334 -211.584 -211.834 -212.084 -212.334 -212.584 -212.834 -213.084 -213.334 -213.584 -213.834 -214.084 -214.334 -214.584 -214.834 -215.084 -215.334 -215.584 -215.834 -216.084 -216.334 -216.584 -216.834 -217.084 -217.334 -217.584 -217.834 -218.084 -218.334 -218.584 -218.834 -219.084 -219.334 -219.584 -219.834 -220.084 -220.334 -220.584 -220.834 -221.084 -221.334 -221.584 -221.834 -222.084 -222.334 -222.584 -222.834 -223.084 -223.334 -223.584 -223.834 -224.084 -224.334 -224.584 -224.834 -225.084 -225.334 -225.584 -225.834 -226.084 -226.334 -226.584 -226.834 -227.084 -227.334 -227.584 -227.834 -228.084 -228.334 -228.584 -228.834 -229.084 -229.334 -229.584 -229.834 -230.084 -230.334 -230.584 -230.834 -231.084 -231.334 -231.584 -231.834 -232.084 -232.334 -232.584 -232.834 -233.084 -233.334 -233.584 -233.834 -234.084 -234.334 -234.584 -234.834 -235.084 -235.334 -235.584 -235.834 -236.084 -236.334 -236.584 -236.834 -237.084 -237.334 -237.58
---------------------	---

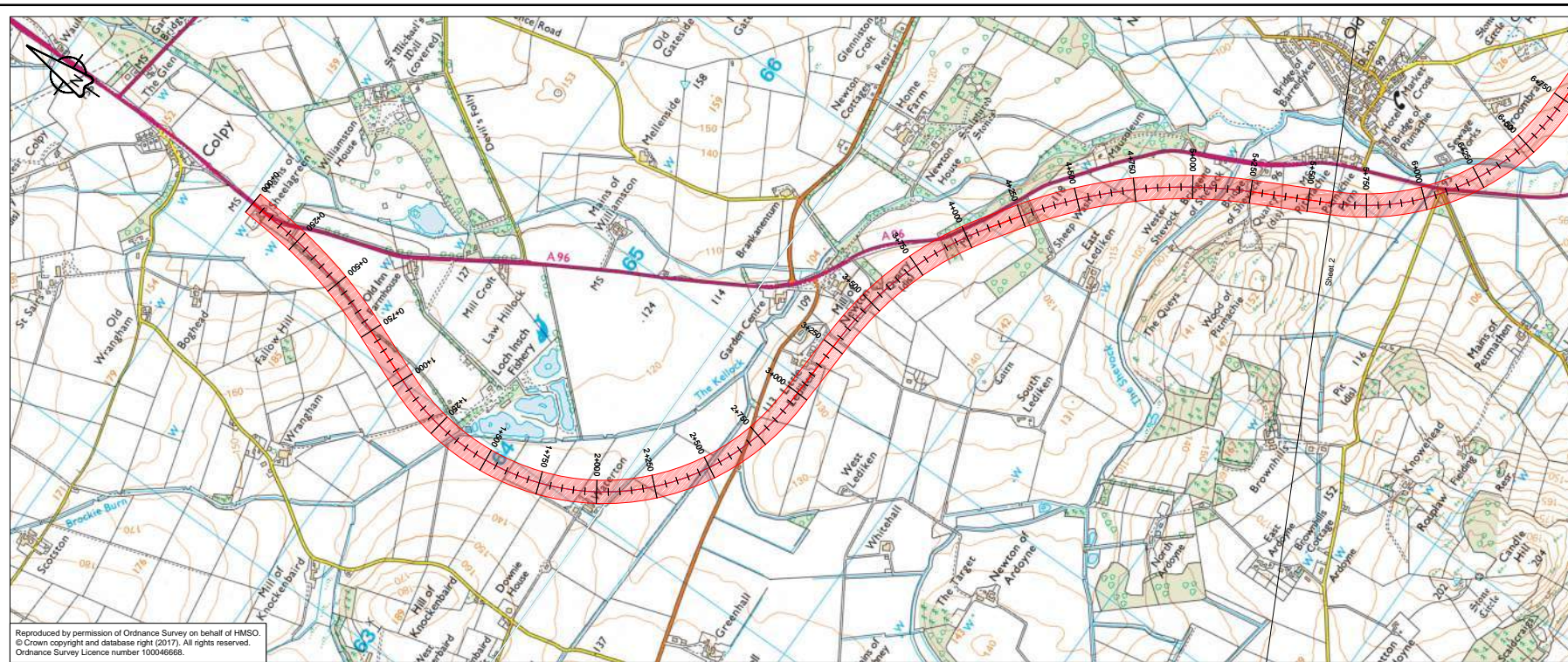

Reproduced by permission of Ordnance Survey on behalf of HMSO.
© Crown copyright and database right (2017). All rights reserved.
Ordnance Survey Licence number 100046668.

OLC_002 - LONGSECTION
SCALE: H 1:10000, V 1:2000, DATUM: 50.000

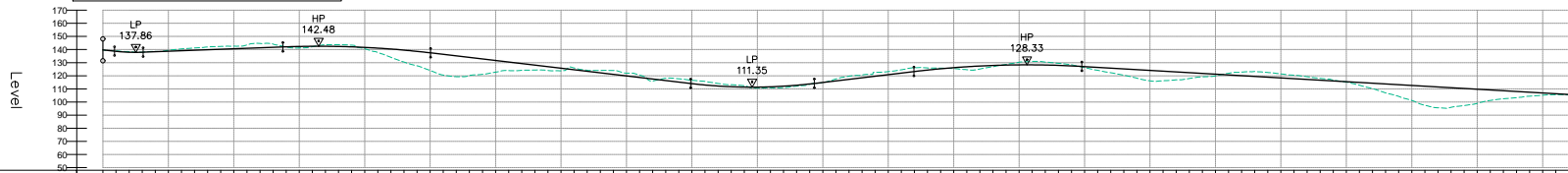

Chainage	Proposed Road Level	Existing Ground Level	Level Difference	Horizontal Alignment	Vertical Alignment
0+000	139.729	139.729	0.000	L=119.571	G=-2.23200000
0+100	138.623	138.990	-0.347	R: 2040.000	G=0.75094
0+200	137.947	138.404	-0.457	L=619.545	L=534.064
0+300	137.537	137.966	-0.048	L=274.555	R=18200.000
0+400	136.310	136.596	-0.275	R: 1020.000	K=182.000
0+500	135.310	136.310	-0.000	L=1991.631	L=564.200
0+600	134.448	135.950	-1.387	L=334.973	G=-2.3700000
0+700	133.435	135.435	-1.768	R: 1440.000	L=350.730
0+800	132.360	134.930	-2.119	L=804.022	K=18200.000
0+900	131.230	134.360	-2.174	L=135.112	L=641.443
1+000	130.050	133.810	-2.188	R: 2040.000	G=-1.151%
1+100	128.820	133.240	-2.420	L=1013.031	L=2381.945
1+200	127.540	132.670	-2.426	L=350.873	
1+300	126.210	132.100	-2.426		
1+400	124.880	131.530	-2.426		
1+500	123.550	130.960	-2.426		
1+600	122.220	130.390	-2.426		
1+700	120.890	129.820	-2.426		
1+800	119.560	129.250	-2.426		
1+900	118.230	128.680	-2.426		
2+000	116.900	128.110	-2.426		
2+100	115.570	127.540	-2.426		
2+200	114.240	126.970	-2.426		
2+300	112.910	126.400	-2.426		
2+400	111.580	125.830	-2.426		
2+500	110.250	125.260	-2.426		
2+600	108.920	124.690	-2.426		
2+700	107.590	124.120	-2.426		
2+800	106.260	123.550	-2.426		
2+900	104.930	122.980	-2.426		
3+000	103.600	122.410	-2.426		
3+100	102.270	121.840	-2.426		
3+200	100.940	121.270	-2.426		
3+300	99.610	120.700	-2.426		
3+400	98.280	120.130	-2.426		
3+500	96.950	119.560	-2.426		
3+600	95.620	118.990	-2.426		
3+700	94.290	118.420	-2.426		
3+800	92.960	117.850	-2.426		
3+900	91.630	117.280	-2.426		
4+000	90.300	116.710	-2.426		
4+100	88.970	116.140	-2.426		
4+200	87.640	115.570	-2.426		
4+300	86.310	115.000	-2.426		
4+400	84.980	114.430	-2.426		
4+500	83.650	113.860	-2.426		
4+600	82.320	113.290	-2.426		
4+700	80.990	112.720	-2.426		
4+800	79.660	112.150	-2.426		
4+900	78.330	111.580	-2.426		
5+000	77.000	111.010	-2.426		
5+100	75.670	110.440	-2.426		
5+200	74.340	109.870	-2.426		
5+300	73.010	109.300	-2.426		
5+400	71.680	108.730	-2.426		
5+500	70.350	108.160	-2.426		

P01	Fit For Information - First Fix Alignments				
	KB	RO	FM	GW	AGF
	23/02/18	23/02/18	23/02/18	19/04/18	19/04/18
Revision	Created	Checked	Reviewed	Approved	Authorised
	dd/mm/yy	dd/mm/yy	dd/mm/yy	dd/mm/yy	dd/mm/yy

Designer
Precision House
McNeil Drive
Glasgow
ML1 4UR

Client
58 Port Dundas Road
Glasgow
G4 0HF

Project Name
A96 Dualling East of Huntly to Aberdeen

Drawing Title
OLC-002 First Fix Alignment Plan and Profile
Sheet 1 of 3

Project Ref. No.	Stage	Scale
250002-92	2	1:10000H 1:2000V @ A1
Dimensions : M		

Drawing Number	Project	Originator	Volume
A96PEA - AMAR - HGN -	CB	-DR-CH-	101201
Location	Type	Role	Number

Suitability	Suitability Description	Revision
S2	Suitable For Information	P01