

Reproduced by permission of Ordnance Survey on behalf of HMSO © Crown copyright and database right (2018). All rights reserved. Ordnance Survey Licence number 100046668
 Contains public sector information licensed under the Open Government Licence v3.0.

CS02_004- LONGSECTION
 SCALE: H 1:10000, V 1:2000. DATUM=76.000

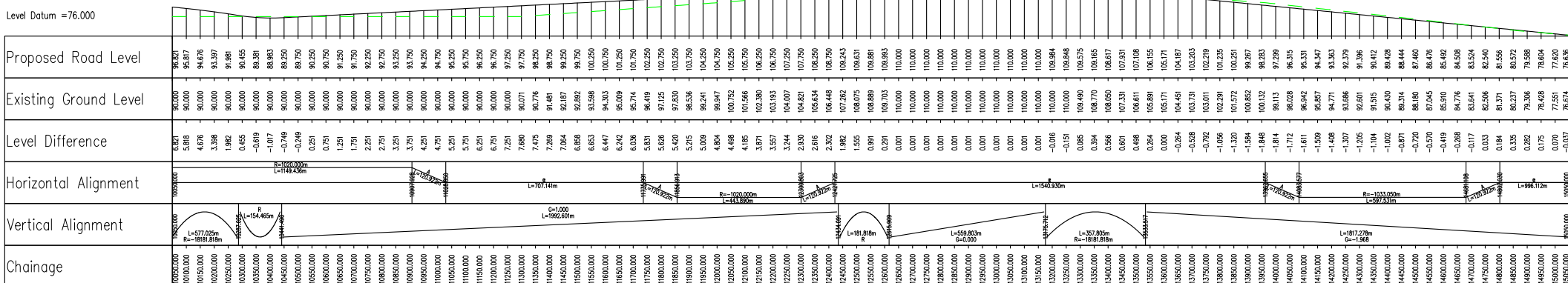

P01	Fit For Information - First Fix Alignments				
	GB	SC	CL	CB	GMacD
	02/03/18	02/03/18	02/03/18	02/03/18	02/03/18

Revision	Revision details				
	Created	Checked	Reviewed	Approved	Authorised
	dd/mm/yy	dd/mm/yy	dd/mm/yy	dd/mm/yy	dd/mm/yy

Designer
 Precision House
 McNeil Drive
 Motherwell
 ML1 4UR



Client
 58 Port Dundas Road
 Glasgow
 G4 0HF



Project Name
 A96 Dualling East of Huntly to Aberdeen

Drawing Title
 CS02_004 First Fix Alignment
 Plan and Profile
 Sheet 3 of 4

Project Ref. No. 250002-92	Stage 2	Scale: 1:10000H 1:2000V @ A1 Dimensions: m
-------------------------------	------------	---

Drawing Number	Project	Originator	Volume
A96PEA - AMAR - HGN - CC			
Location	Type	Role	Number

Suitability S2	Suitability Description Fit For Information	Revision P01
-------------------	--	-----------------

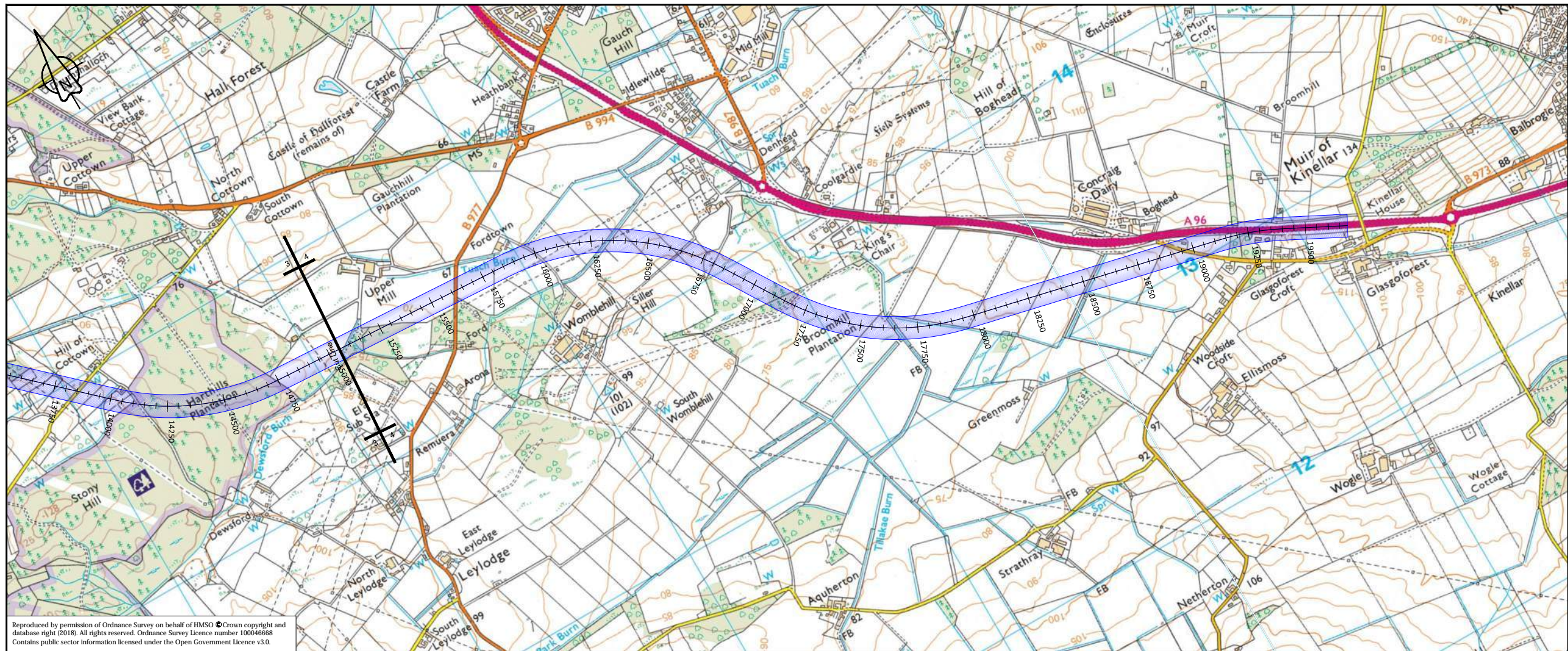

Reproduced by permission of Ordnance Survey on behalf of HMSO © Crown copyright and database right (2018). All rights reserved. Ordnance Survey Licence number 100046668
 Contains public sector information licensed under the Open Government Licence v3.0.

CS02_004- LONGSECTION
 SCALE: H 1:10000, V 1:2000, DATUM=69.000

Level Datum =69.000

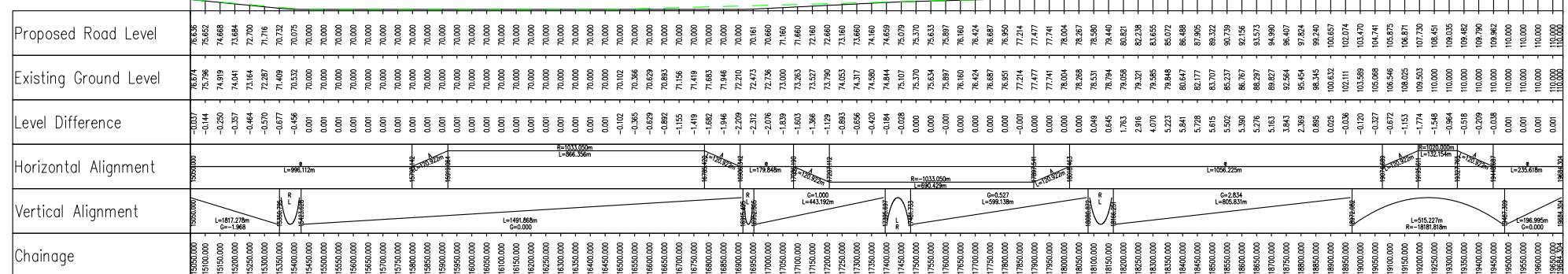

P01	Fit For Information - First Fix Alignments				
	GB	SC	CL	CB	GMacD
	02/03/18	02/03/18	02/03/18	02/03/18	02/03/18
Revision	Revision details				
	Created	Checked	Reviewed	Approved	Authorised
	dd/mm/yy	dd/mm/yy	dd/mm/yy	dd/mm/yy	dd/mm/yy

Designer
 Precision House
 McNeil Drive
 Motherwell
 ML1 4UR



Client
 58 Port Dundas Road
 Glasgow
 G4 0HF



Project Name
 A96 Dualling East of Huntly to Aberdeen

Drawing Title
 CS02_004 First Fix Alignment
 Plan and Profile
 Sheet 4 of 4

Project Ref. No. 250002-92	Stage 2	Scale: 1:10000H 1:2000V @ A1 Dimensions: m
-------------------------------	------------	---

Drawing Number
 Project | Originator | Volume |
 A96PEA - AMAR - HGN -
 CC -DR-CH- 012404
 Location | Type | Role | Number

Suitability S2	Suitability Description Fit For Information	Revision P01
-------------------	--	-----------------

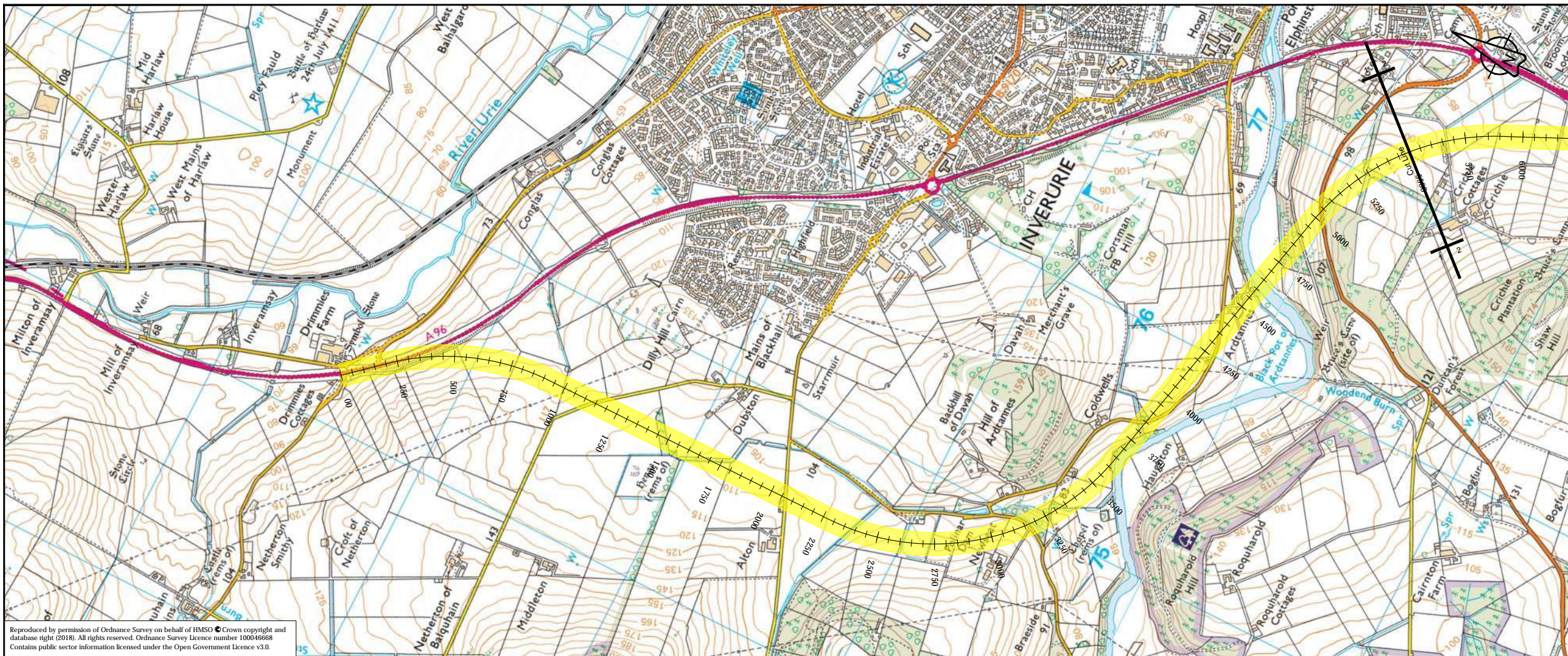

Reproduced by permission of Ordnance Survey on behalf of HMSO © Crown copyright and database right (2018). All rights reserved. Ordnance Survey Licence number 100046668. Contains public sector information licensed under the Open Government Licence v3.0.

BS01_001 - LONGSECTION
SCALE: H 1:10000, V 1:2000. DATUM: 50,000

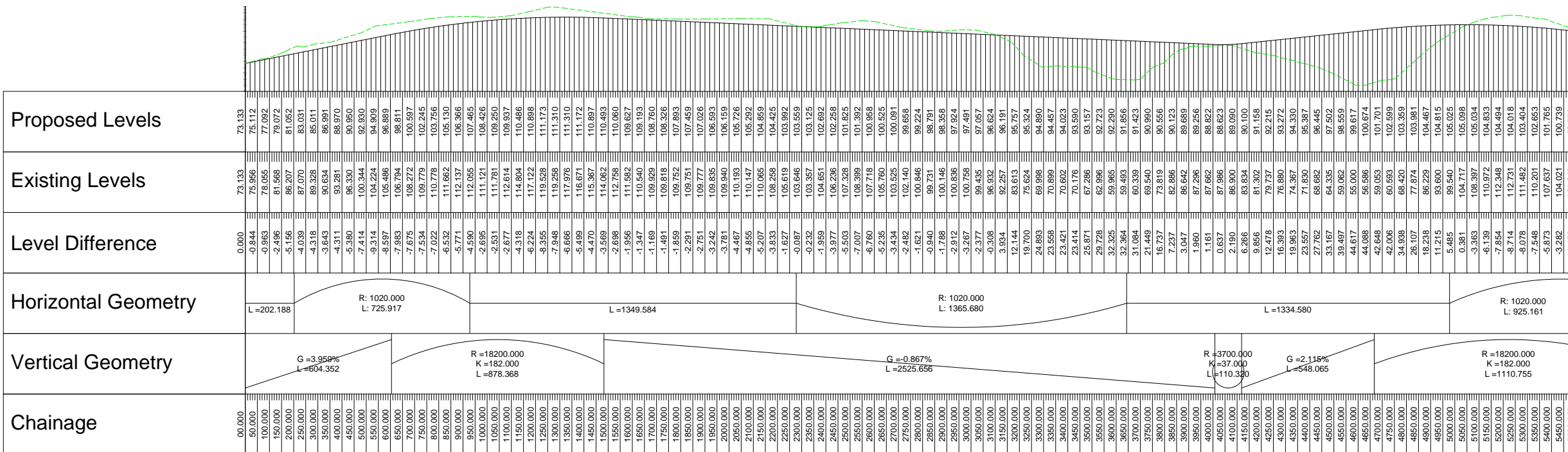

Fit For Information- First Fix Alignments					
P01	CP	SC	CL	CB	GMacD
	02/03/18	02/03/18	02/03/18	02/03/18	02/03/18

Revision details					
Revision	Created	Checked	Reviewed	Approved	Authorised
	dd/mm/yy	dd/mm/yy	dd/mm/yy	dd/mm/yy	dd/mm/yy

Designer
Precision House
McNeil Drive
Motherwell
ML1 4UR

Client
58 Port Dundas Road
Glasgow
G4 0HF

Project Name
A96 Dualling East of Huntly to Aberdeen

Drawing Title
BS01_001 First Fix Alignment Plan and Profile Sheet 1 of 2

Project Ref. No. | Stage | Scale: 1:10000H 1:2000V @ A1
250002-92 | 2 | Dimensions: M

Drawing Number
Project | Originator | Volume |
A96PEA - AMAR - HGN -
CB - DR-CH- 002101
Location | Type | Role | Number

Suitability	Suitability Description	Revision
S2	Fit for Information	P01

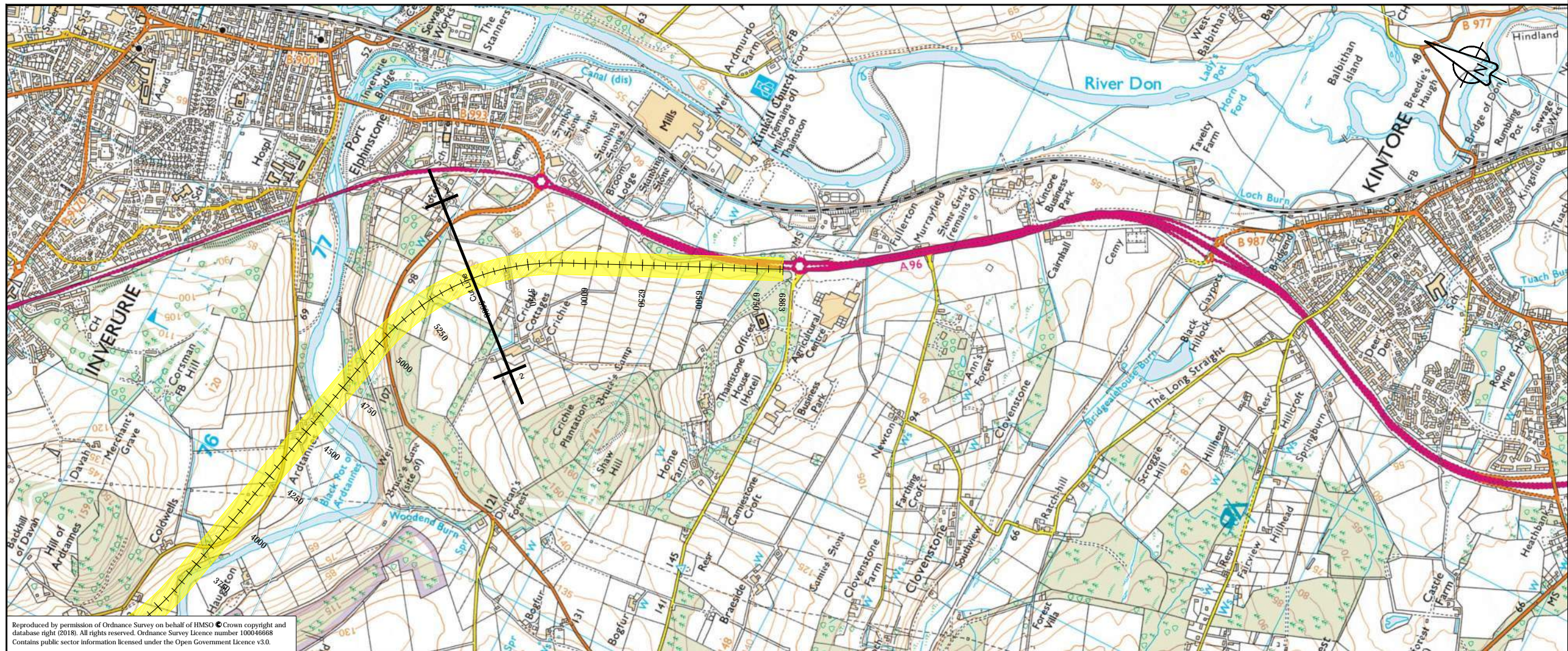

Reproduced by permission of Ordnance Survey on behalf of HMSO © Crown copyright and database right (2018). All rights reserved. Ordnance Survey Licence number 100046668
Contains public sector information licensed under the Open Government Licence v3.0.

BS01_001 - LONGSECTION
SCALE: H 1:10000,V 1:2000. DATUM: 50.000

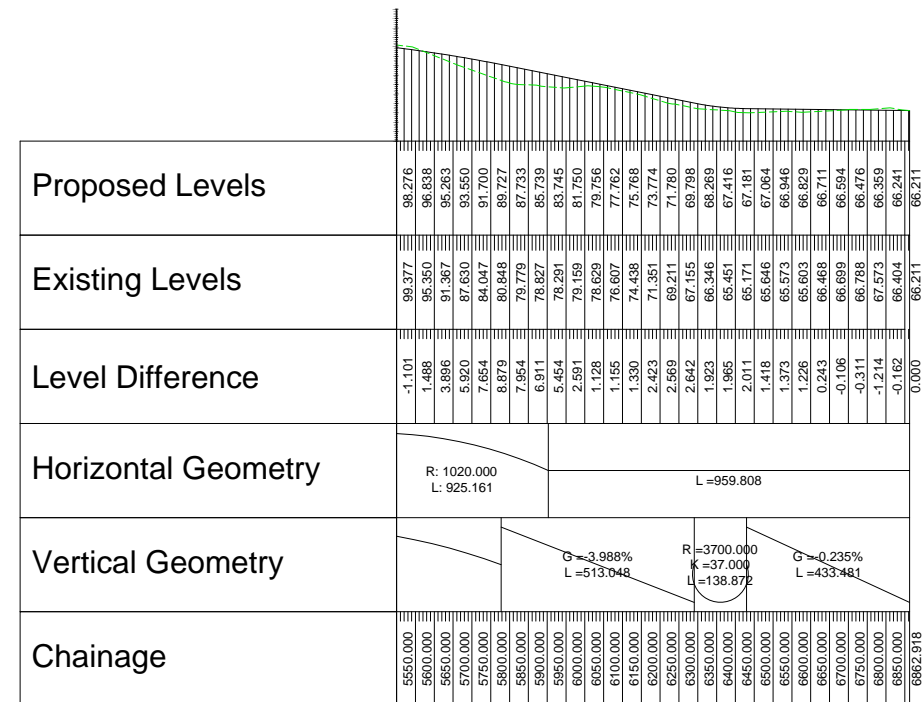

Revision	Fit For Information- First Fix Alignments				
	CP	SC	CL	CB	GMacD
	02/03/18	02/03/18	02/03/18	02/03/18	02/03/18
Revision details					
Created	Checked	Reviewed	Approved	Authorised	
dd/mm/yy	dd/mm/yy	dd/mm/yy	dd/mm/yy	dd/mm/yy	

Designer
Precision House
McNeil Drive
Motherwell
ML1 4UR

Client
58 Port Dundas Road
Glasgow
G4 0HF

Project Name
A96 Dualling: East of Huntly to Aberdeen

Drawing Title
BS01_001 First Fix Alignment Plan and Profile Sheet 2 of 2

Project Ref. No. 250002-92	Stage 2	Scale : 1:10000H 1:2000V @ A1 Dimensions : M
-------------------------------	------------	---

Drawing Number	Project	Originator	Volume
A96PEA - AMAR - HGN -	CB	-DR-CH-	002102
	Location	Type	Role
			Number

Suitability	Suitability Description	Revision
S2	Fit For Information	P01

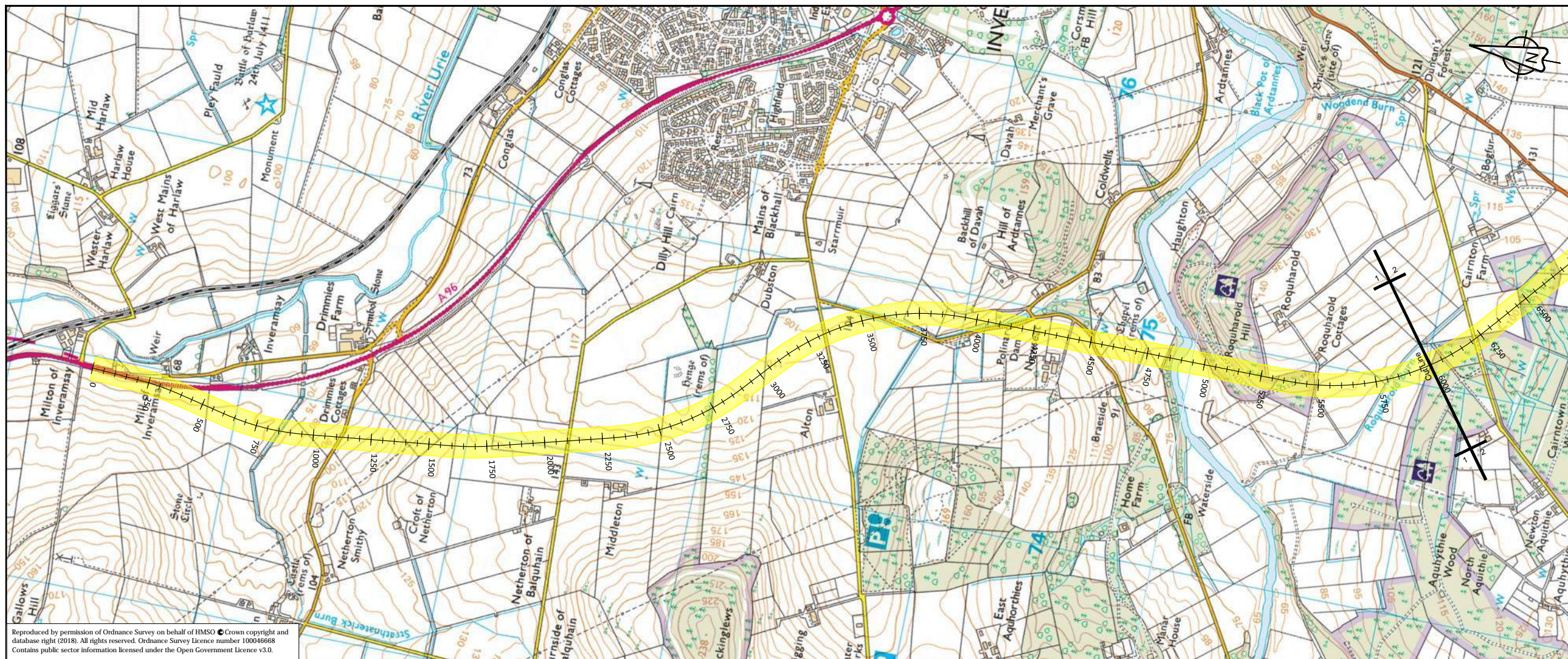

Reproduced by permission of Ordnance Survey on behalf of HMSO © Crown copyright and database right (2018). All rights reserved. Ordnance Survey Licence number 100046668. Contains public sector information licensed under the Open Government Licence v3.0.

BS01_002 - LONGSECTION
SCALE: H 1:10000, V 1:2000, DATUM=59.000

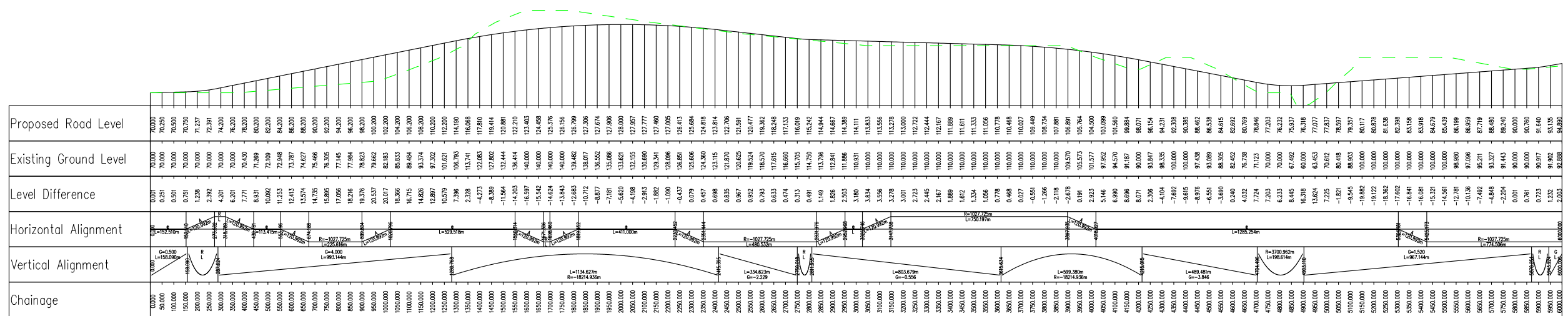

P01	Fit For Information- First Fix Alignments				
	CP	SC	CL	CB	GMacD
	02/03/18	02/03/18	02/03/18	02/03/18	02/03/18
Revision	Revision details				
	Created	Checked	Reviewed	Approved	Authorised
	dd/mm/yy	dd/mm/yy	dd/mm/yy	dd/mm/yy	dd/mm/yy

Designer
Precision House
McNeil Drive
Motherwell
ML1 4UR



Client
58 Port Dundas Road
Glasgow
G4 0HF



Project Name
A96 Dualling East of Huntly to Aberdeen

Drawing Title
BS01_002 First Fix Alignment Plan and Profile Sheet 1 of 2

Project Ref. No.	Stage	Scale
250002-92	2	1:10000H 1:2000V @ A1
Dimensions : M		

Drawing Number	Project	Originator	Volume
A96PEA - AMAR - HGN - CB - DR - CH - 002201			
Location	Type	Role	Number

Suitability	Suitability Description	Revision
S2	Fit For Information	P01

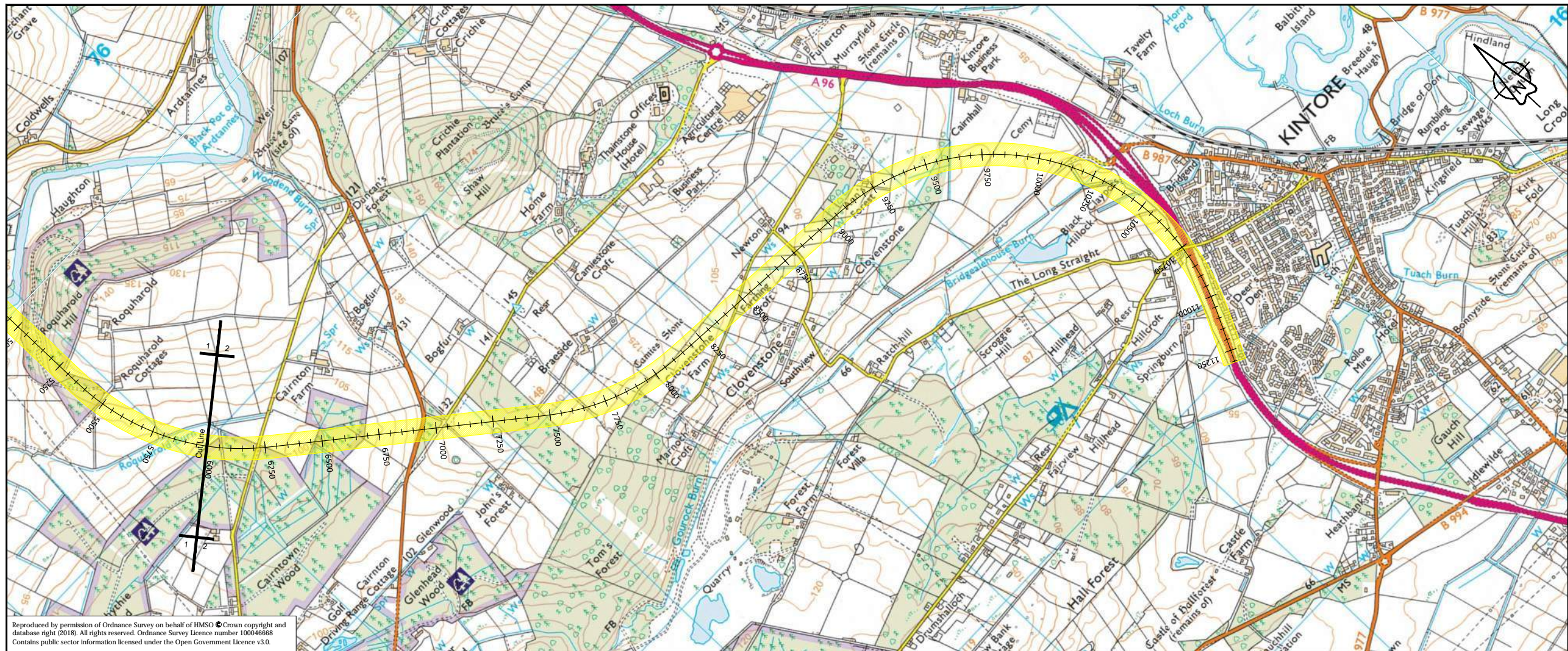

Reproduced by permission of Ordnance Survey on behalf of HMSO © Crown copyright and database right (2018). All rights reserved. Ordnance Survey Licence number 100046668
 Contains public sector information licensed under the Open Government Licence v3.0.

BS01_002: LONGSECTION
 SCALE: H 1:10000, V 1:2000. DATUM=49.000

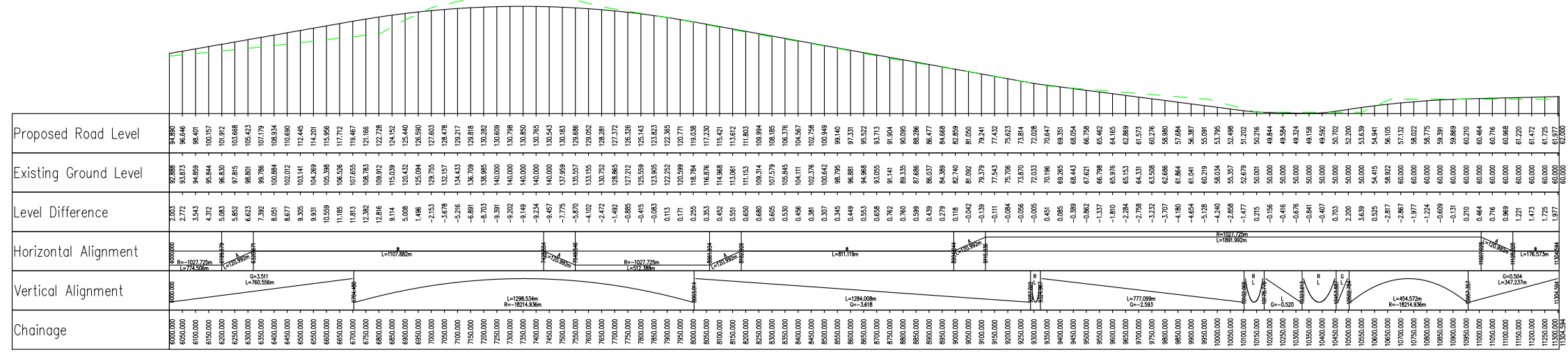

P01	Fit For Information- First Fix Alignments				
	CP	SC	CL	CB	GMacD
	02/03/18	02/03/18	02/03/18	02/03/18	02/03/18
Revision	Revision details				
	Created	Checked	Reviewed	Approved	Authorised
	dd/mm/yy	dd/mm/yy	dd/mm/yy	dd/mm/yy	dd/mm/yy

Designer
 Precision House
 McNeil Drive
 Motherwell
 ML1 4UR

Client
 58 Port Dundas Road
 Glasgow
 G4 0HF

Project Name
A96 Dualling East of Huntly to Aberdeen

Drawing Title
BS01_002 First Fix Alignment Plan and Profile Sheet 2 of 2

Project Ref. No. 250002-92	Stage 2	Scale : 1:10000H 1:2000V @ A1 Dimensions : M
-------------------------------	------------	---

Drawing Number A96PEA - AMAR - HGN - CB	Originator - DR - CH - 002202	Volume -
Location	Type	Role

Suitability S2	Suitability Description Fit For Information	Revision P01
-------------------	--	-----------------

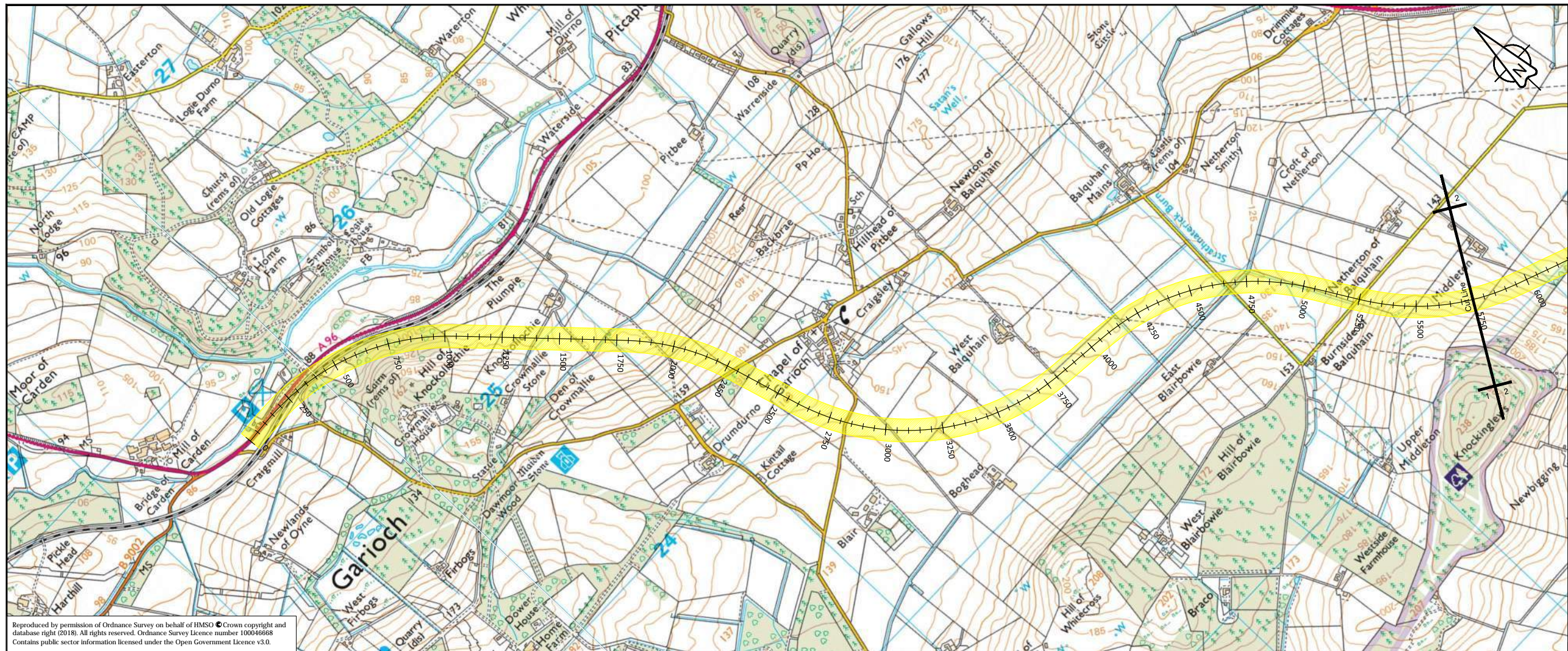

Reproduced by permission of Ordnance Survey on behalf of HMSO © Crown copyright and database right (2018). All rights reserved. Ordnance Survey Licence number 100046668. Contains public sector information licensed under the Open Government Licence v3.0.

BS01_003- LONGSECTION
SCALE: H 1:10000, V 1:2000. DATUM=87.000

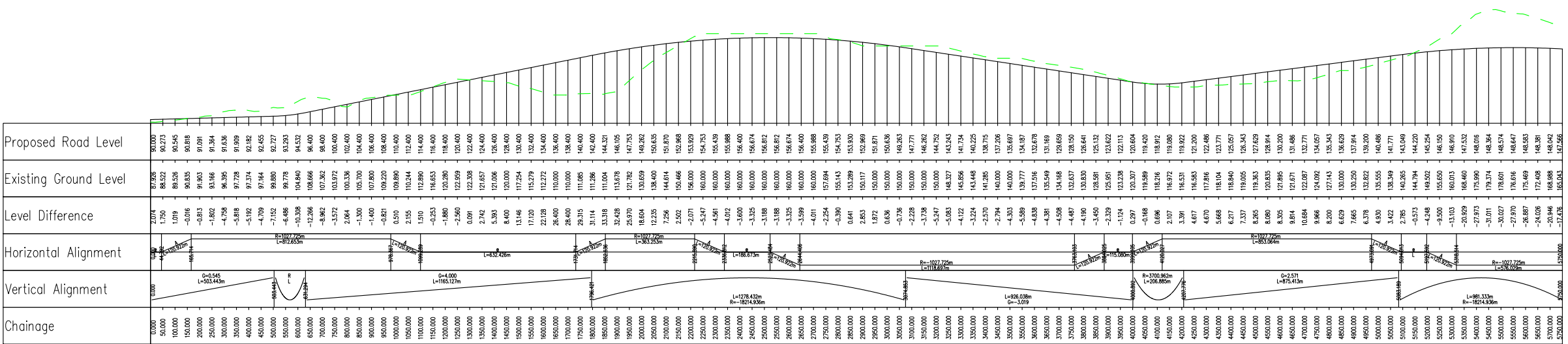

P01	Fit For Information- First Fix Alignments				
	CP	SC	CL	CB	GMacD
	02/03/18	02/03/18	02/03/18	02/03/18	02/03/18
Revision	Revision details				
	Created	Checked	Reviewed	Approved	Authorised
	dd/mm/yy	dd/mm/yy	dd/mm/yy	dd/mm/yy	dd/mm/yy

Designer
Precision House
McNeil Drive
Motherwell
ML1 4UR



Client
58 Port Dundas Road
Glasgow
G4 0HF



Project Name
A96 Dualling East of Huntly to Aberdeen

Drawing Title
BS01_003 First Fix Alignment Plan and Profile Sheet 1 of 2

Project Ref. No.	Stage	Scale
250002-92	2	1:10000H 1:2000V @ A1
Dimensions: M		

Drawing Number	Project	Originator	Volume
A96PEA	- AMAR -	HGN -	
CB	- DR - CH -	002301	
Location	Type	Role	Number

Suitability	Suitability Description	Revision
S2	Fit For Information	P01

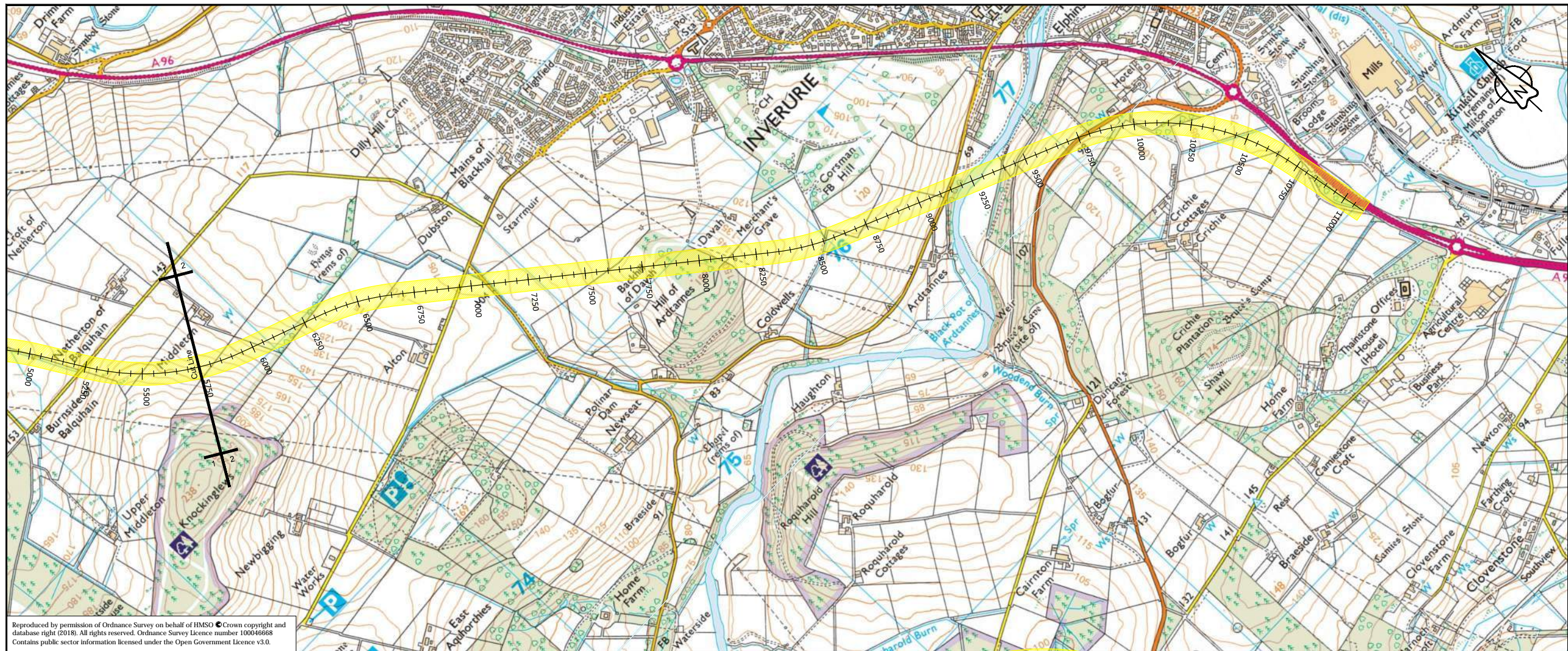

Reproduced by permission of Ordnance Survey on behalf of HMSO © Crown copyright and database right (2018). All rights reserved. Ordnance Survey Licence number 100046668
 Contains public sector information licensed under the Open Government Licence v3.0.

BS01_003-LONGSECTION
 SCALE: H 1:10000, V 1:2000. DATUM=54.000

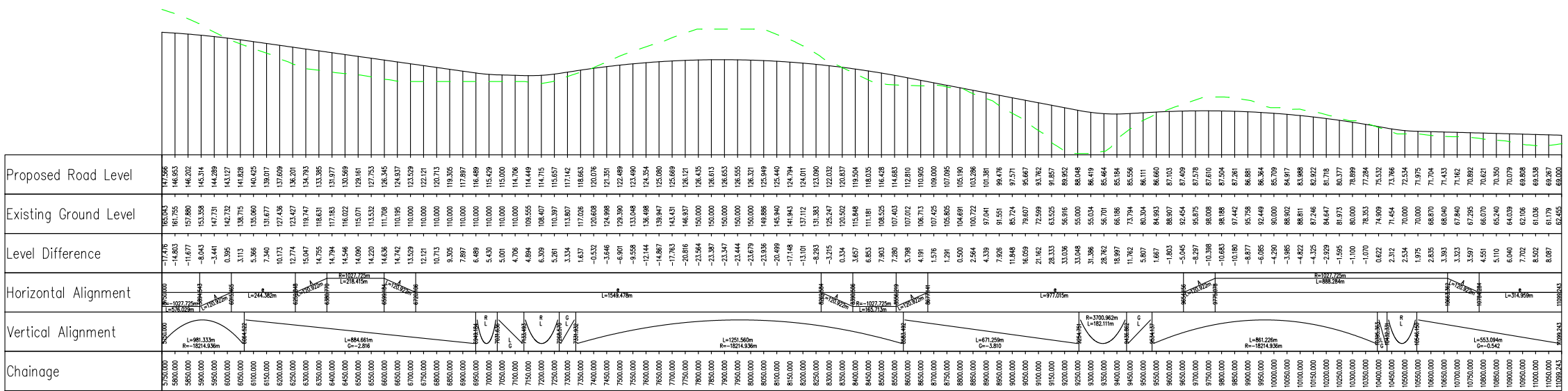

P01	Fit For Information- First Fix Alignments				
	CP	SC	CL	CB	GMacD
	02/03/18	02/03/18	02/03/18	02/03/18	02/03/18

Revision	Revision details				
	Created	Checked	Reviewed	Approved	Authorised
	dd/mm/yy	dd/mm/yy	dd/mm/yy	dd/mm/yy	dd/mm/yy

Designer
 Precision House
 McNeil Drive
 Motherwell
 ML1 4UR

Client
 58 Port Dundas Road
 Glasgow
 G4 0HF

Project Name
A96 Dualling East of Huntly to Aberdeen

Drawing Title
**BS01_003 First Fix Alignment
 Plan and Profile
 Sheet 2 of 2**

Project Ref. No.	Stage	Scale:
250002-92	2	1:100000 1:2000V @ A1 Dimensions: M

Drawing Number
 Project | Originator | Volume |
A96PEA - AMAR - HGN -
 Location | Type | Role | Number
CB -DR-CH- 002302

Suitability	Suitability Description	Revision
S2	Fit For Information	P01

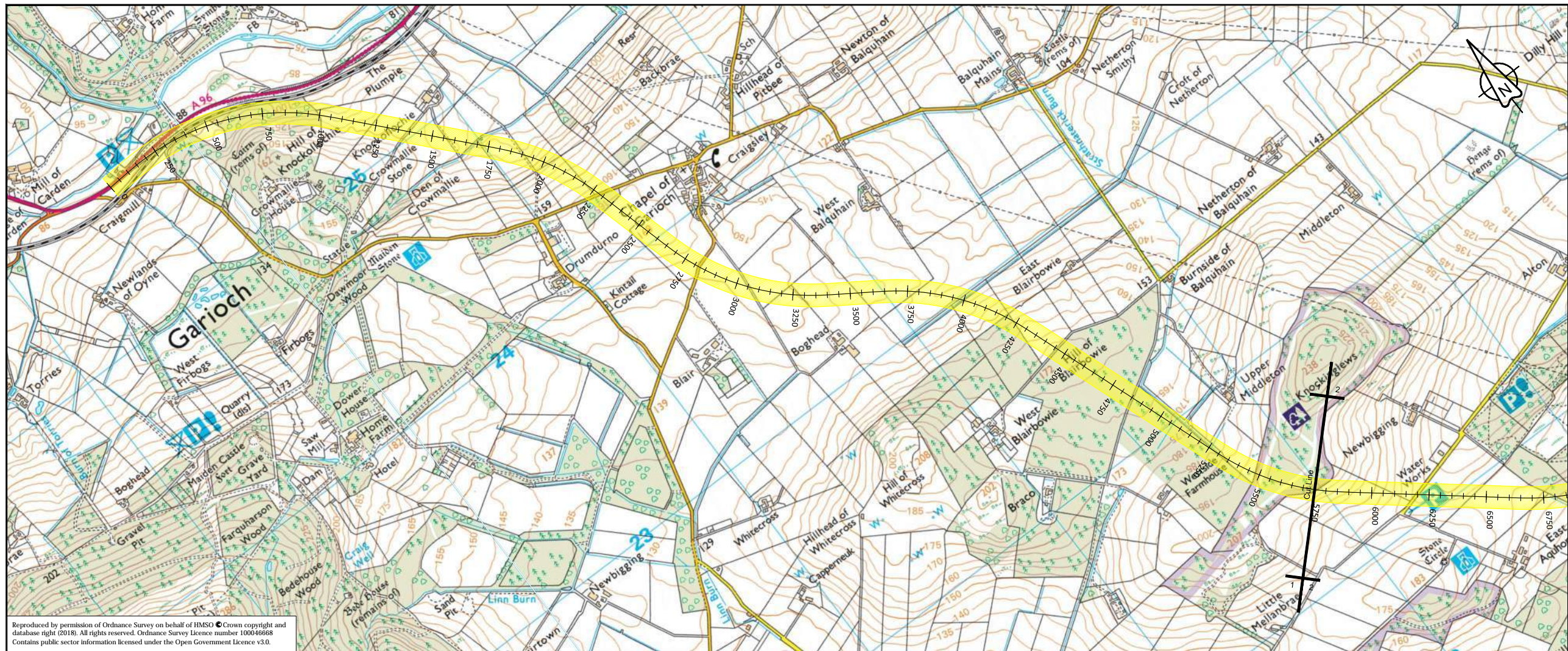

Reproduced by permission of Ordnance Survey on behalf of HMSO © Crown copyright and database right (2018). All rights reserved. Ordnance Survey Licence number 100046668
 Contains public sector information licensed under the Open Government Licence v3.0.

BS01_004- LONGSECTION
 SCALE: H 1:10000, V 1:2000, DATUM=89.000

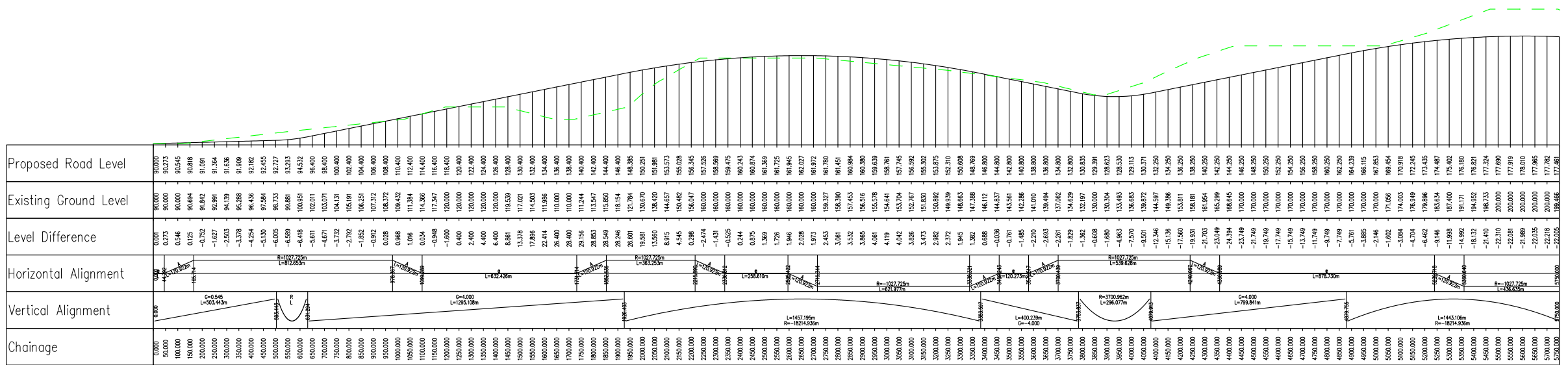

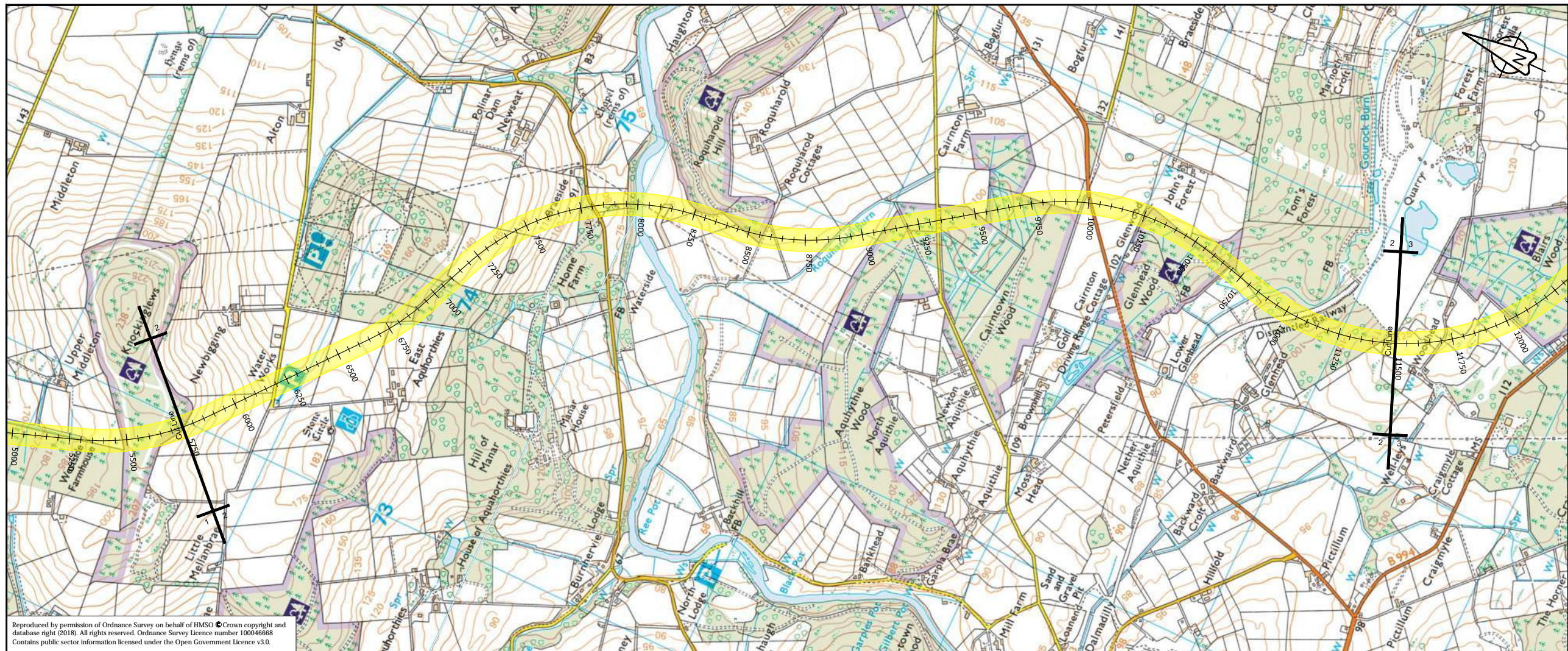

Reproduced by permission of Ordnance Survey on behalf of HMSO © Crown copyright and database right (2018). All rights reserved. Ordnance Survey Licence number 100046668
 Contains public sector information licensed under the Open Government Licence v3.0.

BS01_004- LONGSECTION
 SCALE: H 1:10000, V 1:2000, DATUM=59.000

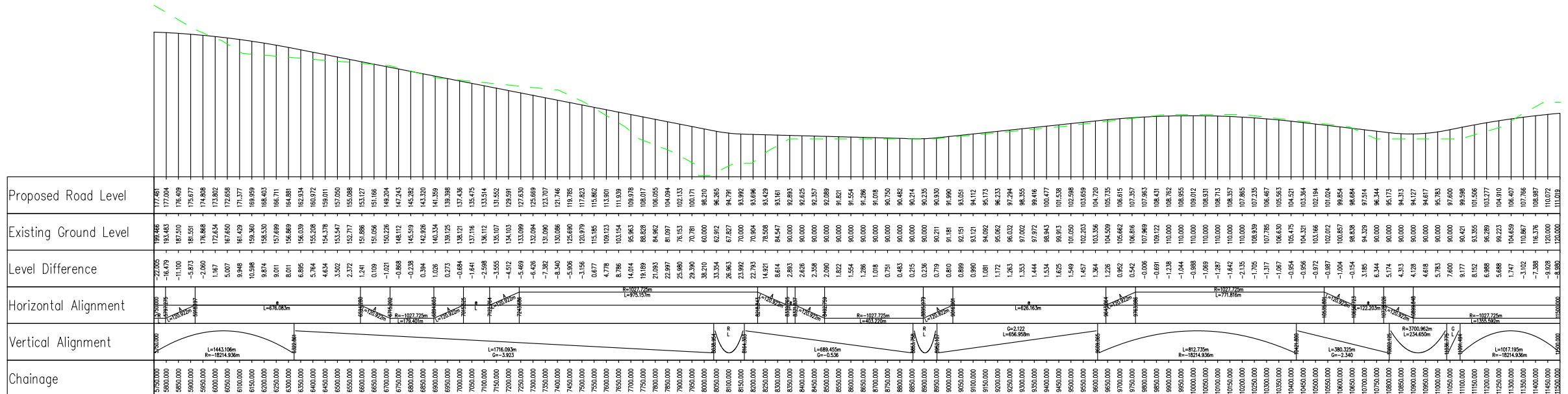

P01	Fit For Information- First Fix Alignments				
	CP	SC	CL	CB	GMacD
	02/03/18	02/03/18	02/03/18	02/03/18	02/03/18

Designer
 Precision House
 McNeil Drive
 Motherwell
 ML1 4UR



Client
 58 Port Dundas Road
 Glasgow
 G4 0HF



Project Name
A96 Dualling East of Huntly to Aberdeen

Drawing Title
BS01_004 First Fix Alignment Plan and Profile Sheet 2 of 3

Project Ref. No. 250002-92	Stage 2	Scale: 1:10000H 1:2000V @ A1 Dimensions: M
-------------------------------	------------	---

Drawing Number
A96PEA - AMAR - HGN - CB - DR-CH- 002402

Suitability S2	Suitability Description Fit For Information	Revision P01
-------------------	--	-----------------

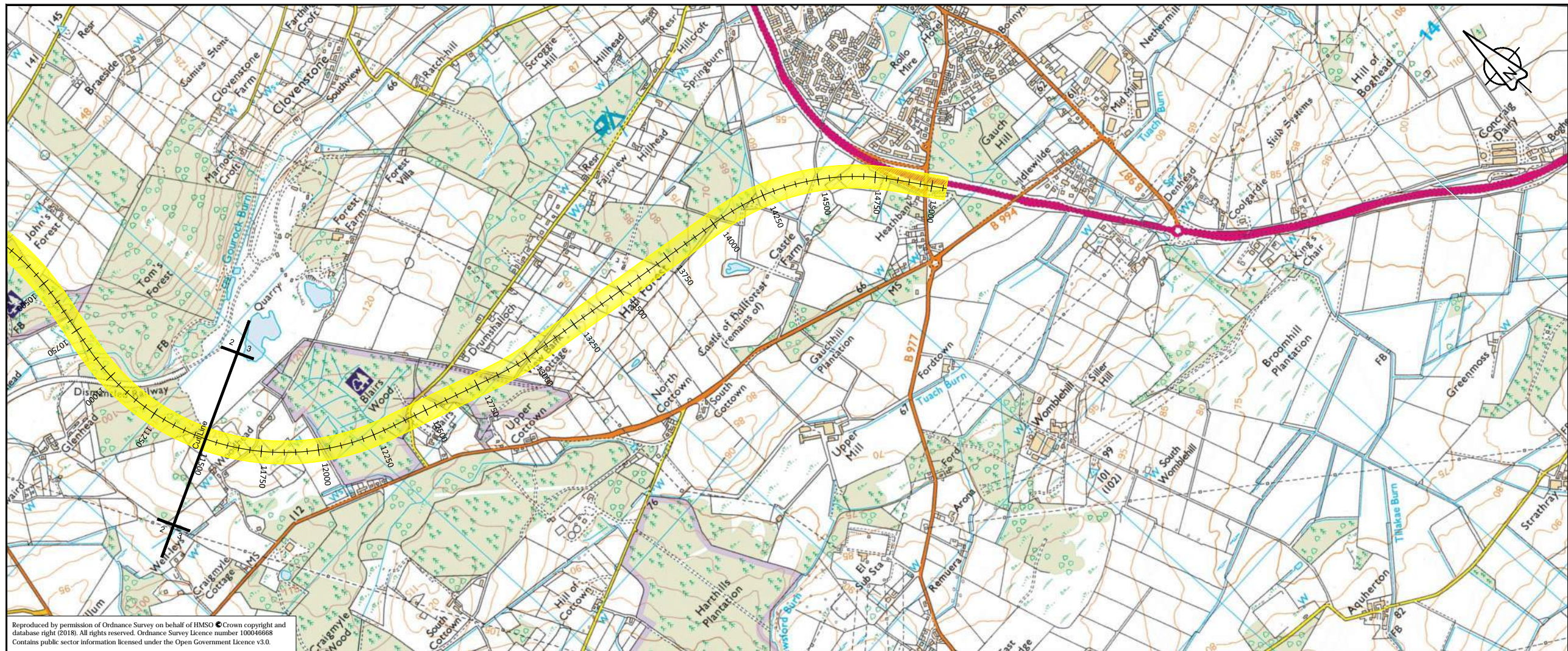

Reproduced by permission of Ordnance Survey on behalf of HMSO © Crown copyright and database right (2018). All rights reserved. Ordnance Survey Licence number 100046668
 Contains public sector information licensed under the Open Government Licence v3.0.

BS01_004- LONGSECTION
 SCALE: H 1:10000, V 1:2000, DATUM=59.000

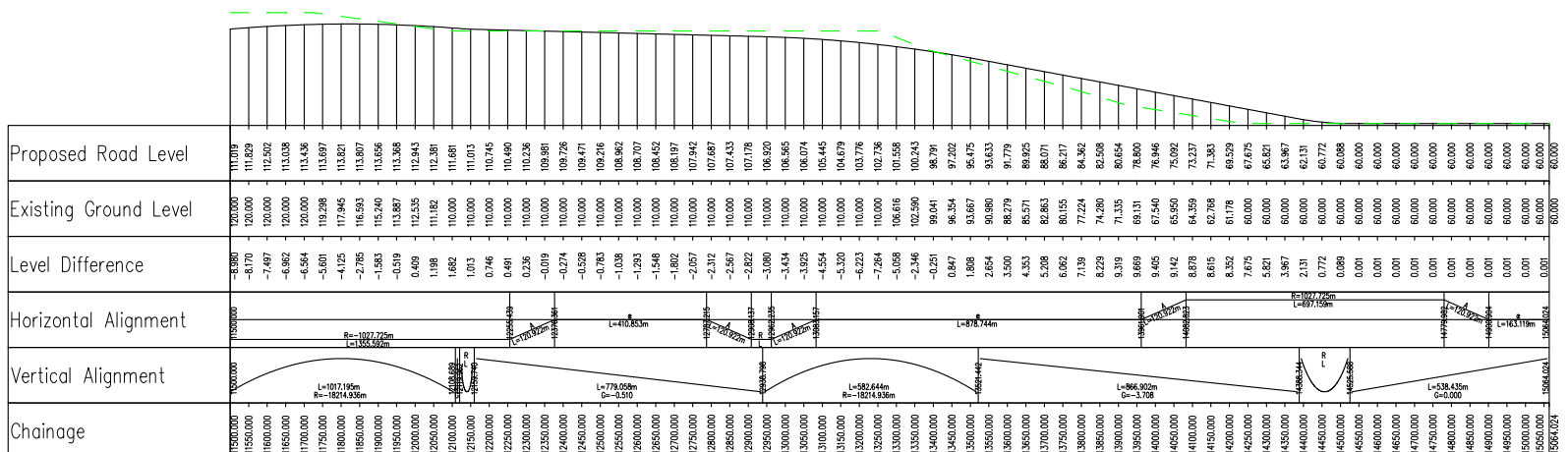



Reproduced by permission of Ordnance Survey on behalf of HMSO © Crown copyright and database right (2018). All rights reserved. Ordnance Survey Licence number 100046668
 Contains public sector information licensed under the Open Government Licence v3.0.

BS01_005- LONGSECTION
 SCALE: H 1:10000, V 1:2000, DATUM=89.000

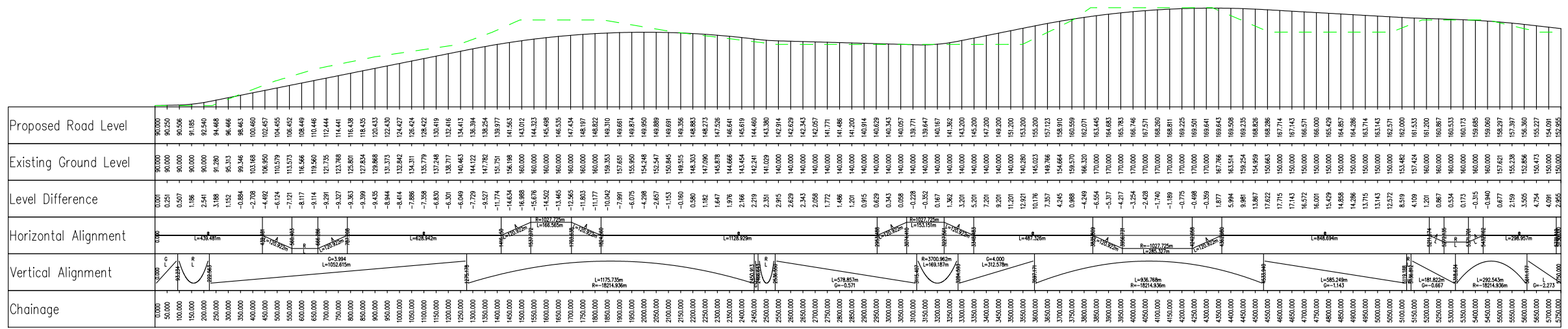

Fit For Information- First Fix Alignments					
CP	SC	CL	CB	GMaC	
02/03/18	02/03/18	02/03/18	02/03/18	02/03/18	02/03/18

Revision details				
Created	Checked	Reviewed	Approved	Authorised
dd/mm/yy	dd/mm/yy	dd/mm/yy	dd/mm/yy	dd/mm/yy

Designer
 Precision House
 McNeil Drive
 Motherwell
 ML1 4UR

Client
 58 Port Dundas Road
 Glasgow
 G4 0HF

Project Name
A96 Dualling East of Huntly to Aberdeen

Drawing Title
BS01_005 First Fix Alignment Plan and Profile Sheet 1 of 3

Project Ref. No. 250002-92	Stage 2	Scale: 1:10000H 1:2000V @ A1 Dimensions: m
-------------------------------	------------	---

Drawing Number			
Project	Originator	Volume	
A96PEA	- AMAR -	HGN -	
CB	-DR-CH-	002501	
Location	Type	Role	Number

Suitability S2	Suitability Description Fit For Information	Revision P01
-------------------	--	-----------------



Reproduced by permission of Ordnance Survey on behalf of HMSO © Crown copyright and database right (2018). All rights reserved. Ordnance Survey Licence number 100046668
Contains public sector information licensed under the Open Government Licence v3.0.

BS01_005- LONGSECTION
SCALE: H 1:10000, V 1:2000. DATUM=63.000

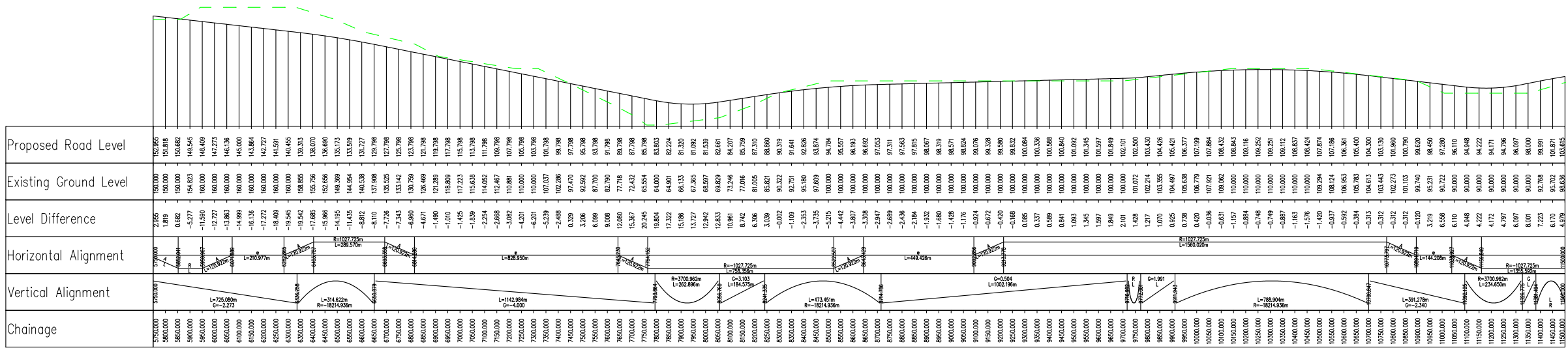

P01	Fit For Information- First Fix Alignments				
	CP	SC	CL	CB	GMacD
	02/03/18	02/03/18	02/03/18	02/03/18	02/03/18
Revision	Revision details				
	Created	Checked	Reviewed	Approved	Authorised
	dd/mm/yy	dd/mm/yy	dd/mm/yy	dd/mm/yy	dd/mm/yy

Designer
Precision House
McNeil Drive
Motherwell
ML1 4UR

Client
58 Port Dundas Road
Glasgow
G4 0HF

Project Name
A96 Dualling East of Huntly to Aberdeen

Drawing Title
BS01_005 First Fix Alignment Plan and Profile Sheet 2 of 3

Project Ref. No.	Stage	Scale: 1:10000 H 1:2000V @ A1
250002-92	2	Dimensions: m

Drawing Number	Project	Originator	Volume
	A96PEA	- AMAR - HGN -	
	CB	-DR-CH- 002502	
	Location	Type	Role
			Number

Suitability	Suitability Description	Revision
S2	Fit For Information	P01