

**SAFETY, HEALTH AND ENVIRONMENTAL INFORMATION BOX**

IT IS ASSUMED THAT ALL WORKS ON THIS DRAWING WILL BE CARRIED OUT BY A COMPETENT CONTRACTOR WORKING, WHERE APPROPRIATE, TO AN APPROPRIATE METHOD STATEMENT.

THIS DRAWING IS TO BE USED ONLY FOR THE PURPOSE OF ISSUE THAT IT WAS ISSUED FOR AND IS SUBJECT TO AMENDMENT.

EXCEPTIONAL RISKS RELATING TO THE WORKS ASSOCIATED WITH THIS DRAWING ARE IDENTIFIED BELOW.

**CONSTRUCTION**

NOT FOR CONSTRUCTION

**MAINTENANCE / OPERATION / DECOMMISSIONING / DEMOLITION**

**NOTES**

1. THIS DRAWING IS TO BE READ IN CONJUNCTION WITH ALL OTHER RELEVANT DOCUMENTATION.
2. DO NOT SCALE FROM THIS DRAWING, USE ONLY PRINTED DIMENSIONS.
3. ALL CHAINAGES, LEVELS AND COORDINATES ARE IN METRES UNLESS DEFINED OTHERWISE.

**KEY**

- PROPOSED DESIGN
- - - EXISTING GROUND

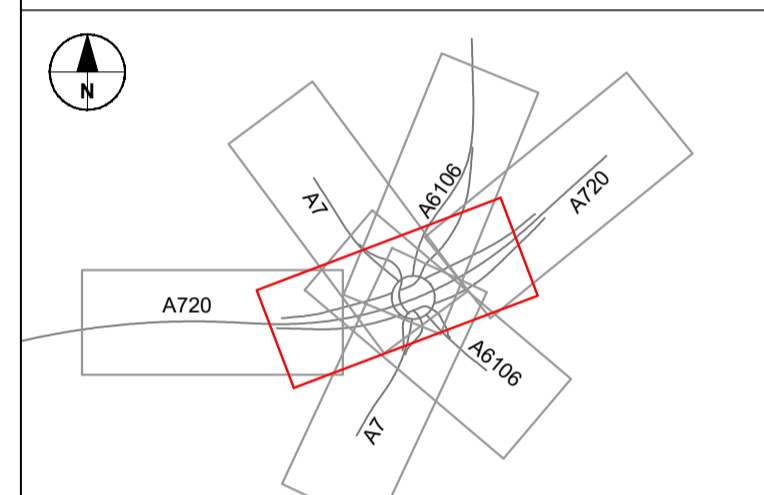

**A720-MAINLINE PROFILE**  
SCALE: H 1:1250,V 1:250. DATUM: 55.000

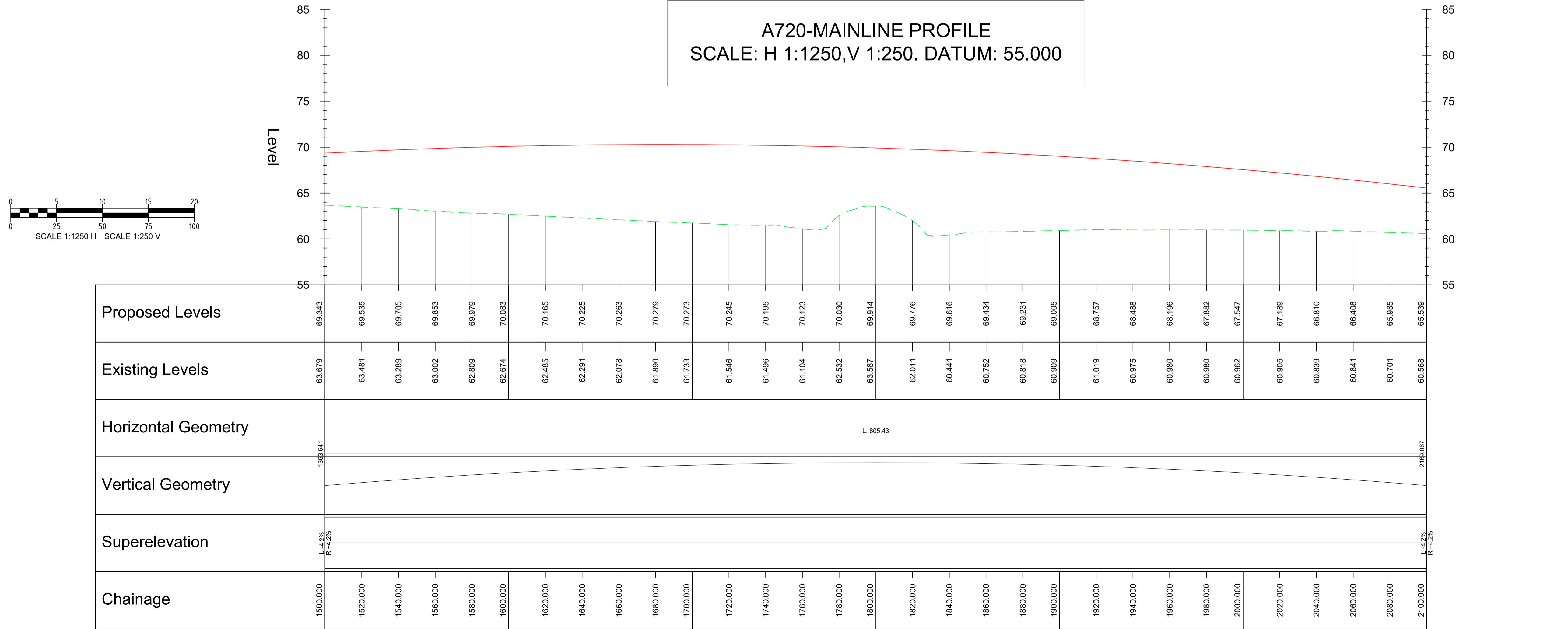

Revision Details	By	Check	Date	Suffix
First Issue	HH	RH	23/01/20	P01
Issued for DMRB Stage 3 Report	HH	RH	31/01/20	A01

**FOR INFORMATION**



**A720 SHERIFFHALL ROUNDABOUT**

**FIGURE 4.2  
A720 MAINLINE  
PLAN & PROFILE  
SHEET 2 OF 3**

Designed	Drawn	Checked	Approved	Date
AR	HH	JL	RH	23/01/20
Internal Project No.	Scale	Zone	Suitability	
60572241	@ A1	-	A1	
1:1250H/1:250V				

THIS DOCUMENT HAS BEEN PREPARED PURSUANT TO AND SUBJECT TO THE TERMS OF AECOM'S APPOINTMENT BY ITS CLIENT. AECOM ACCEPTS NO LIABILITY FOR ANY USE OF THIS DOCUMENT OTHER THAN BY ITS ORIGINAL CLIENT OR FOLLOWING AECOM'S EXPRESS AGREEMENT TO SUCH USE, AND ONLY FOR THE PURPOSES FOR WHICH IT WAS PREPARED AND PROVIDED.

**AECOM**  
Citypoint 2  
25 Tynburn Street  
Glasgow  
Tel: +44 (141) 354 5600  
Fax: +44 (141) 354 5601  
www.aecom.com

**AECOM**  
AECOM Infrastructure & Environment UK Limited  
Registered in England Registered number: 880328  
Registered office: Midpoint, Alencon Link,  
Basingstoke, Hampshire RG21 7FP

Drawing Number	Project No.	Originator	Volume	Rev
60572241	-ACM	-HML	-	A01
SW_ML_M00_Z-DR-CH-0402				
Location	I Type	I Role	I Number	

Plot Date: 03 February 2020 09:12:55  
 Plot Name: C:\P\WORKING\AECOM\_DSZ\JK-CLT\HELVENHAY\AECOM\COMMENTS\70346572241-ACH\ML\_SW\_ML\_M00\_Z-DR-CH-0402