

WESTBOUND DIVERGE PROFILE
SCALE: H 1:500, V 1:100. DATUM: 50.000

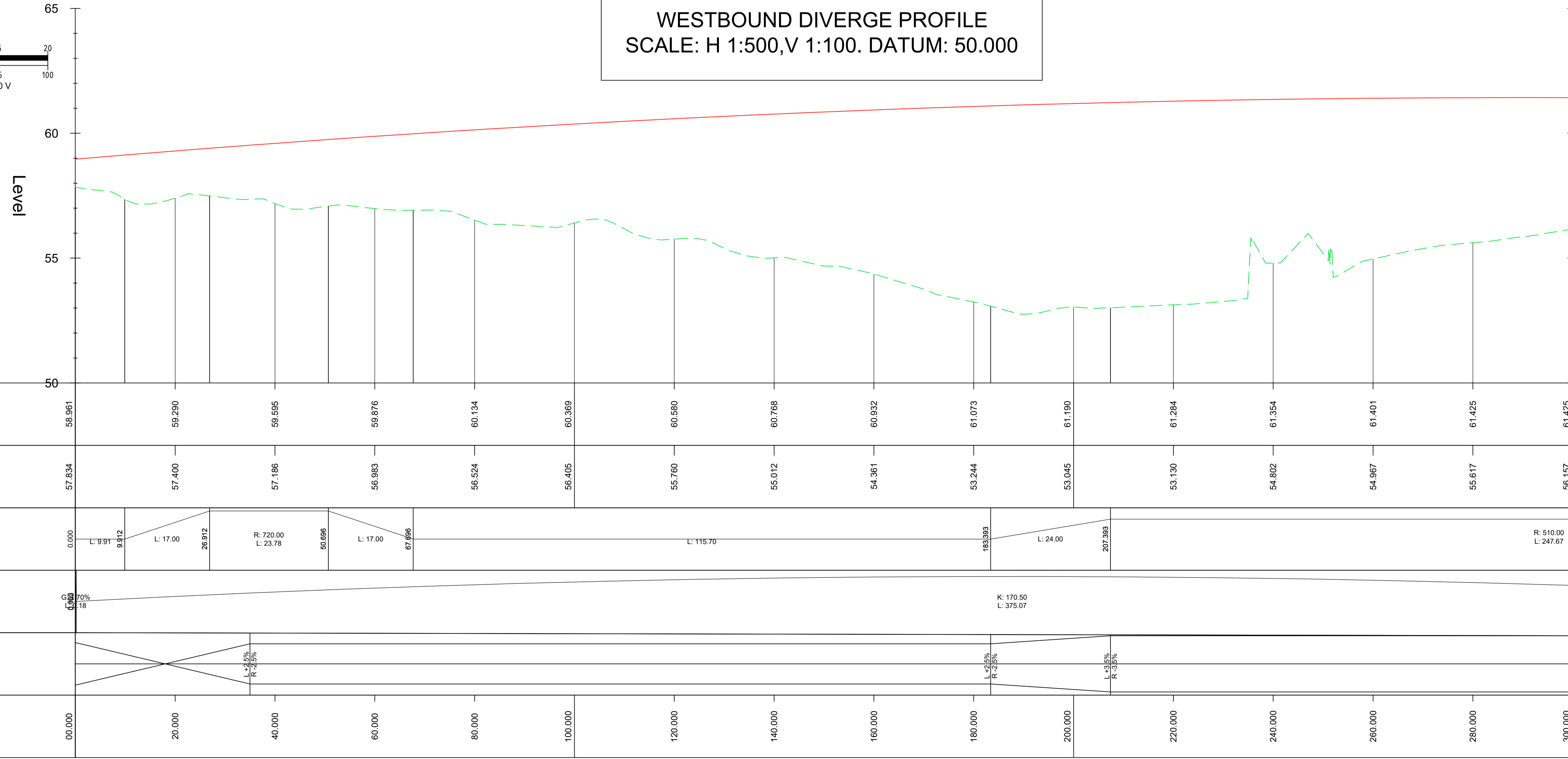
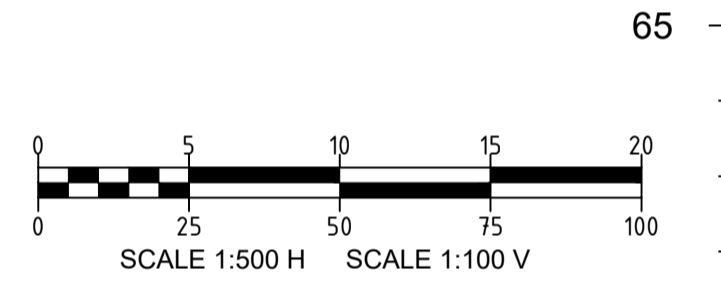

SAFETY, HEALTH AND ENVIRONMENTAL INFORMATION BOX

IT IS ASSUMED THAT ALL WORKS ON THIS DRAWING WILL BE CARRIED OUT BY A COMPETENT CONTRACTOR WORKING, WHERE APPROPRIATE, TO AN APPROPRIATE METHOD STATEMENT.

THIS DRAWING IS TO BE USED ONLY FOR THE PURPOSE OF ISSUE THAT IT WAS ISSUED FOR AND IS SUBJECT TO AMENDMENT.

EXCEPTIONAL RISKS RELATING TO THE WORKS ASSOCIATED WITH THIS DRAWING ARE IDENTIFIED BELOW.

CONSTRUCTION

NOT FOR CONSTRUCTION

MAINTENANCE / OPERATION / DECOMMISSIONING / DEMOLITION

NOTES

- THIS DRAWING IS TO BE READ IN CONJUNCTION WITH ALL OTHER RELEVANT DOCUMENTATION.
- DO NOT SCALE FROM THIS DRAWING, USE ONLY PRINTED DIMENSIONS.
- ALL CHAINAGES, LEVELS AND COORDINATES ARE IN METRES UNLESS DEFINED OTHERWISE.

KEY

— PROPOSED DESIGN

- - - EXISTING GROUND

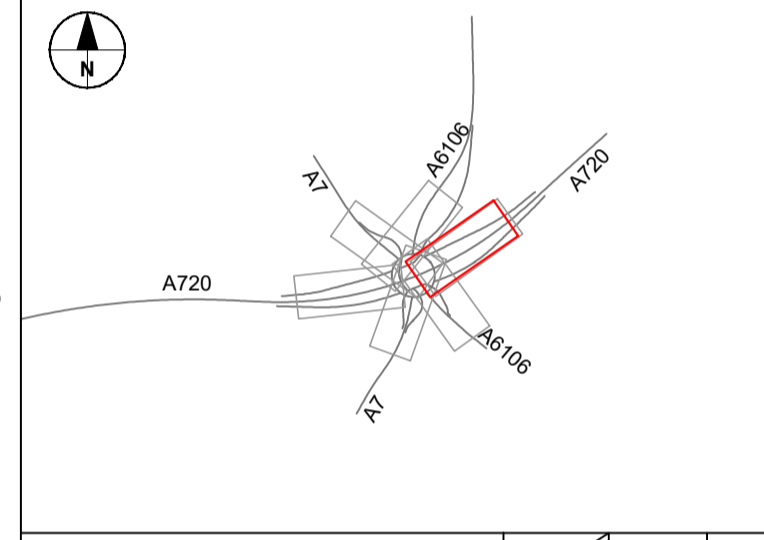

Revision Details	By	Check	Date	Suffix
First Issue	HH	RH	23/01/20	P01
Issued for DMRB Stage 3 Report	HH	RH	31/01/20	A01

FOR INFORMATION

Client
 TRANSPORT SCOTLAND
 Project Title
A720 SHERIFFHALL ROUNDABOUT

Drawing Title
**FIGURE 4.8
 A720 WESTBOUND DIVERGE
 PLAN & PROFILE
 SHEET 1 OF 2**

Designed	Drawn	Checked	Approved	Date
AR	HH	JL	RH	23/01/20

Internal Project No. 60572241
 Scale @ A1 1:500H/1:100V
 Zone -

THIS DOCUMENT HAS BEEN PREPARED PURSUANT TO AND SUBJECT TO THE TERMS OF AECOM'S APPOINTMENT BY ITS CLIENT. AECOM ACCEPTS NO LIABILITY FOR ANY USE OF THIS DOCUMENT OTHER THAN BY ITS ORIGINAL CLIENT OR FOLLOWING AECOM'S EXPRESS AGREEMENT TO SUCH USE, AND ONLY FOR THE PURPOSES FOR WHICH IT WAS PREPARED AND PROVIDED.

AECOM
 Citypoint 2
 25 Tyndrum Street
 Glasgow
 Tel: +44 (141) 354 5600
 Fax: +44 (141) 354 5601
 www.aecom.com

AECOM Infrastructure & Environment UK Limited
 Registered in England Registered number: 880328
 Registered office: Midpoint, Alencon Link,
 Basingstoke, Hampshire RG21 7FP

Drawing Number	Project No.	I Originator	I Volume	Rev
60572241 -ACM -HML -				A01

Location SW_ML_WDO_Z-DR-CH-0408
 I Type I Role I Number

Plot Date: 03 February 2020 09:30:29
 Plot Name: C:\P\WORKING\AECOM\DSZ\JK\CLT\HELVAN\AECOM\CONDMS\7034857241\A720\ML_SW_ML_WDO_Z-DR-CH-0408