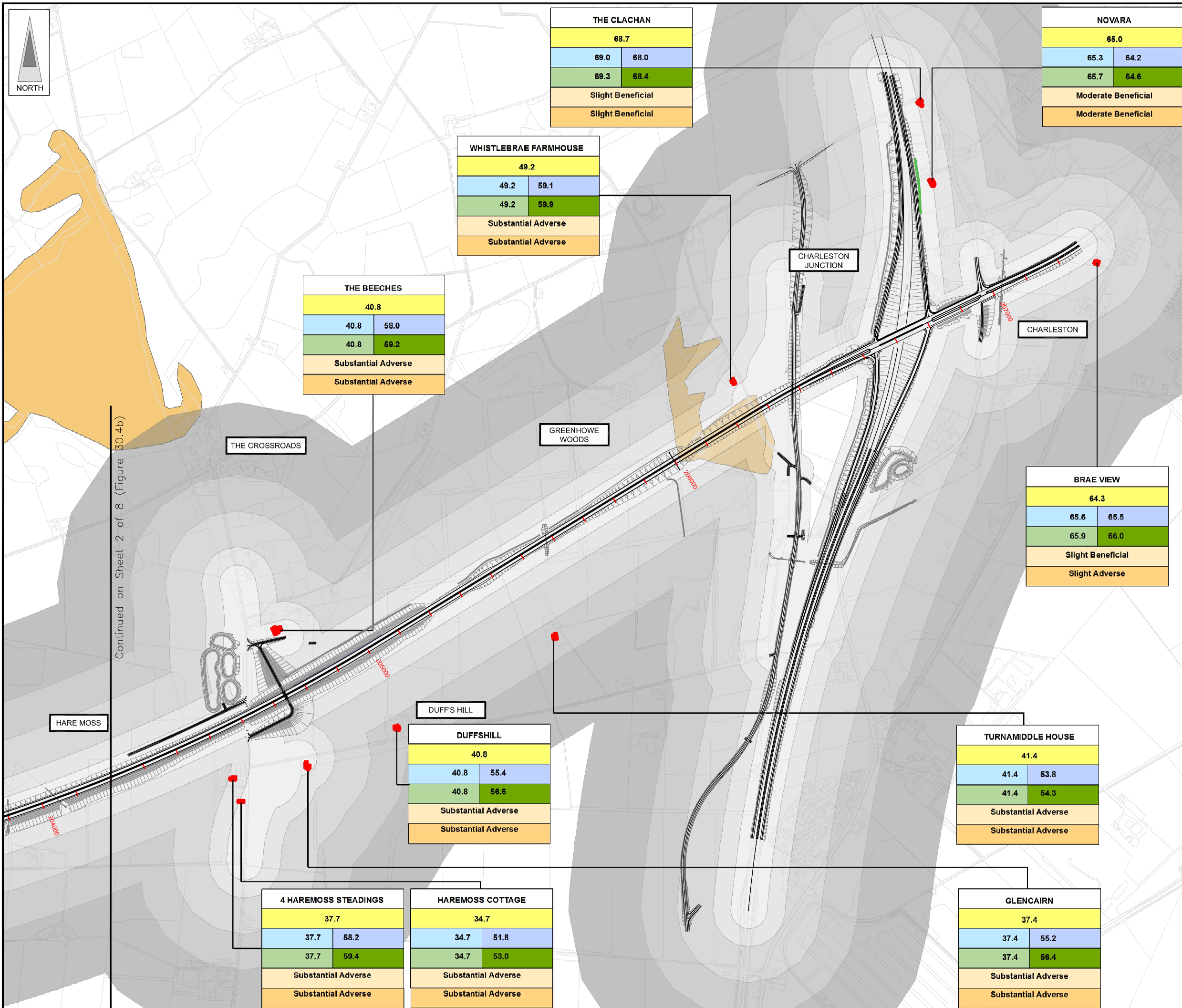
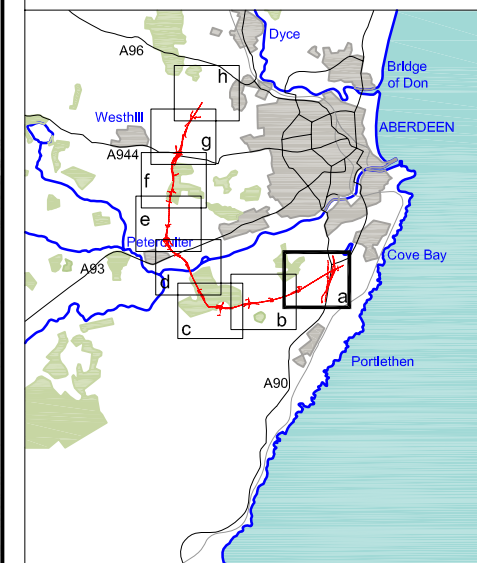


FIGURE 30.4a



**LEGEND**

- Proposed Route (Engineering Profile 04/05/07)
- 0-50m
- >50-100m
- >100-200m
- >200-300m
- >300-500m
- Sample Properties
- Non Residential Receptors
- Barriers

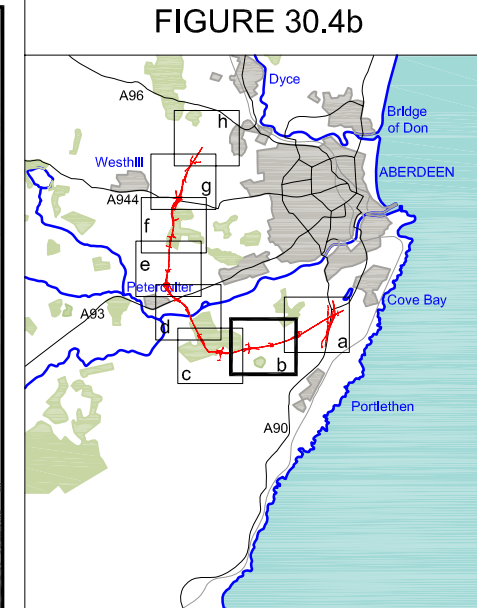
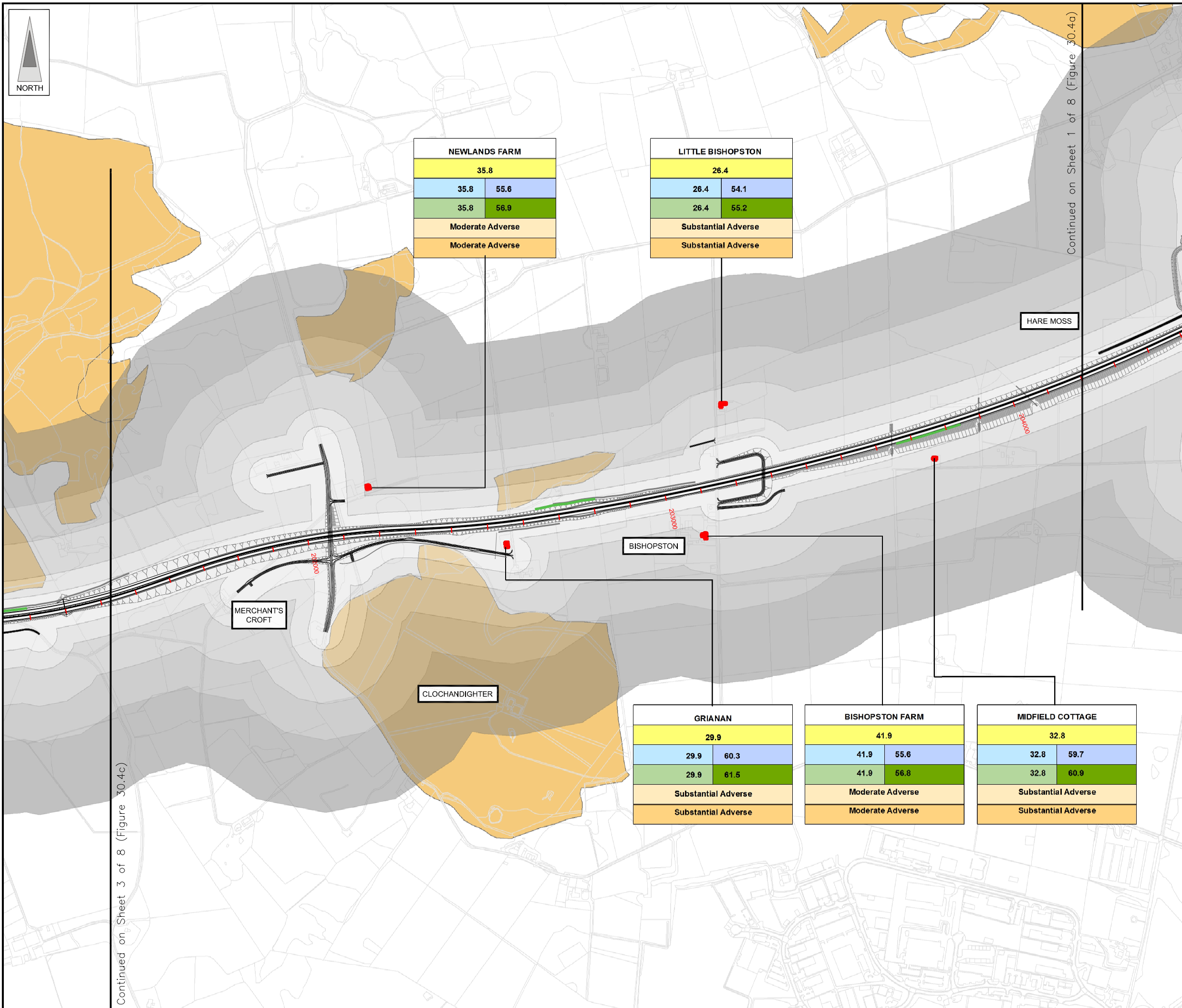
Location Name	
BASE 2005	
Do Minimum Year of Opening	Do Something Year of Opening
Do Minimum Design Year	Do Something Design Year
SIGNIFICANCE OF IMPACT Year of Opening	
SIGNIFICANCE OF IMPACT Design Year	

**JE JACOBS**  
 95 Bothwell Street, Glasgow, G2 7HX, UK  
 Tel: 0141 204 2511 Fax: 0141 226 3109  
 www.jacobsbabtie.com

**Hamilton & McGregor**  
 ACOUSTICS DIVISION

Client	Aberdeen Western Peripheral Route	
Project	Aberdeen Western Peripheral Route Environmental Statement, Part C - Southern Leg	
Title	Predicted LA10(18hours) dB with Mitigation (Receiver Height = 4.5m) Sheet 1 of 8	
Drawing Status	FINAL	
JB No.	0010332	Revisions
Figure No.	FIGURE 30.4a	Date July 2007
Scale	1:10,000	Approved SH
Drawn RB	Checked BMcK	Signature





**LEGEND**

- Proposed Route (Engineering Profile 04/05/07)
- 0-50m
- >50-100m
- >100-200m
- >200-300m
- >300-500m
- Sample Properties
- Non Residential Receptors
- Barriers

Location Name	
BASE 2005	
Do Minimum Year of Opening	Do Something Year of Opening
Do Minimum Design Year	Do Something Design Year
SIGNIFICANCE OF IMPACT Year of Opening	
SIGNIFICANCE OF IMPACT Design Year	

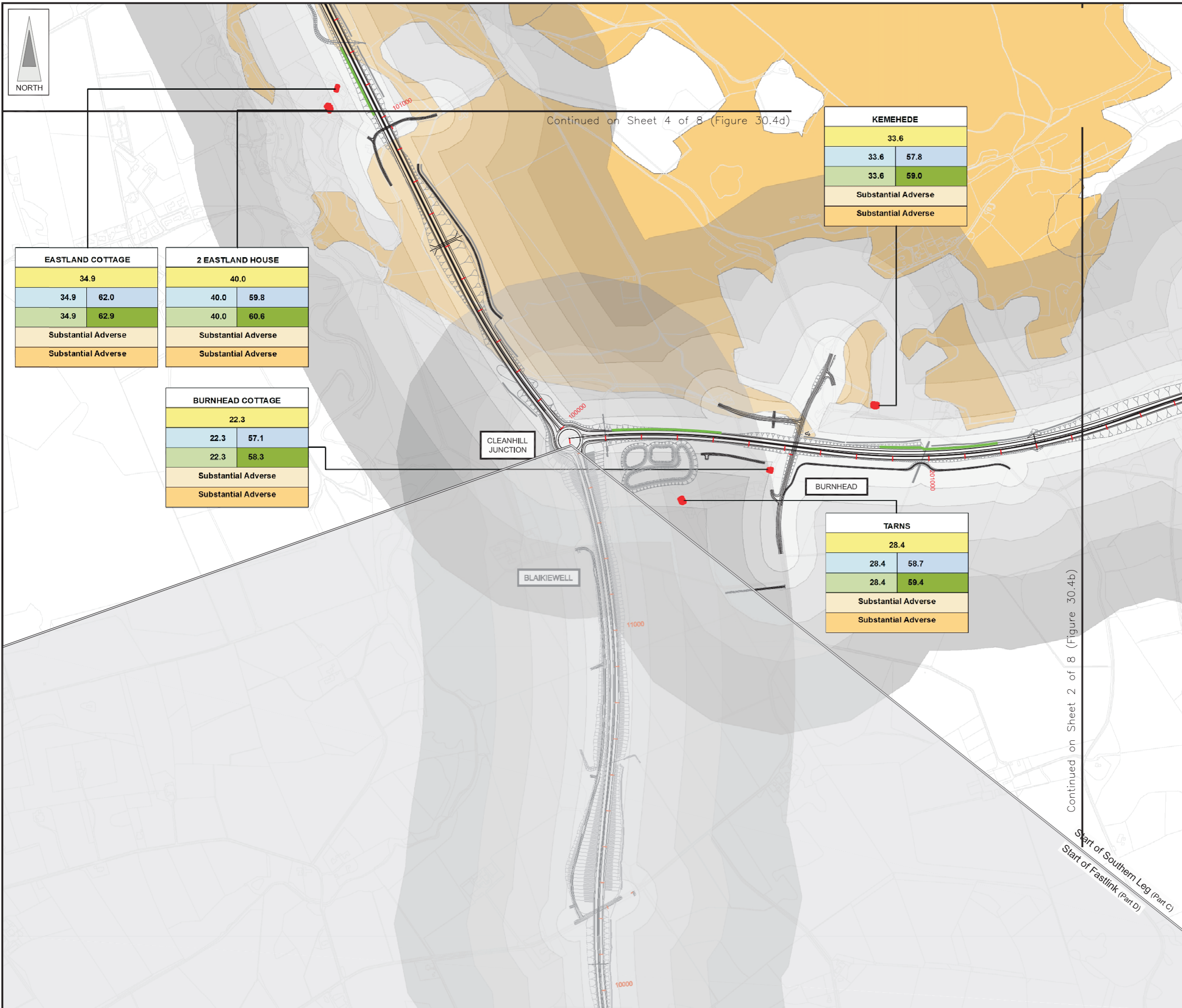
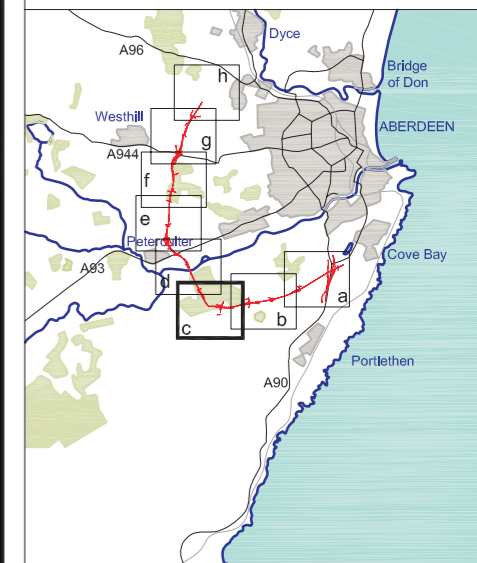
**JE JACOBS**  
 95 Bothwell Street, Glasgow, G2 7HX, UK  
 Tel: 0141 204 2511 Fax: 0141 226 3109  
 www.jacobsbabtie.com

**Hamilton & McGregor**  
 ACUSTICS DIVISION

Client	Aberdeen Western Peripheral Route	
Project	Aberdeen Western Peripheral Route Environmental Statement, Part C - Southern Leg	
Title	Predicted LA10(18hours) dB with Mitigation (Receiver Height = 4.5m) Sheet 2 of 8	
Drawing Status	FINAL	Revisions
JB No.	0010332	
Figure No.	FIGURE 30.4b	
Scale	1:10,000	Date July 2007
Drawn	RB	Checked BMcK
		Approved SH



FIGURE 30.4c



Continued on Sheet 4 of 8 (Figure 30.4d)

KEMEHEDE	
33.6	
33.6	57.8
33.6	59.0
Substantial Adverse	
Substantial Adverse	

EASTLAND COTTAGE	
34.9	
34.9	62.0
34.9	62.9
Substantial Adverse	
Substantial Adverse	

2 EASTLAND HOUSE	
40.0	
40.0	59.8
40.0	60.6
Substantial Adverse	
Substantial Adverse	

BURNHEAD COTTAGE	
22.3	
22.3	57.1
22.3	58.3
Substantial Adverse	
Substantial Adverse	

TARNS	
28.4	
28.4	58.7
28.4	59.4
Substantial Adverse	
Substantial Adverse	

**LEGEND**

- Proposed Route (Engineering Profile 04/05/07)
- 0-50m
- >50-100m
- >100-200m
- >200-300m
- >300-500m
- Sample Properties
- Non Residential Receptors
- Barriers

Location Name	
BASE 2005	
Do Minimum Year of Opening	Do Something Year of Opening
Do Minimum Design Year	Do Something Design Year
SIGNIFICANCE OF IMPACT Year of Opening	
SIGNIFICANCE OF IMPACT Design Year	

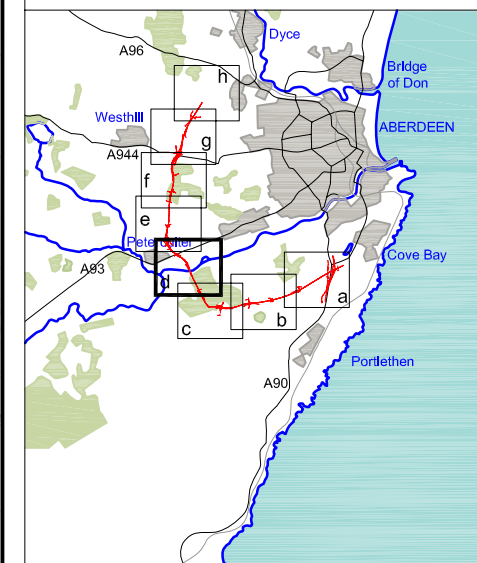
**JE JACOBS**  
 95 Bothwell Street, Glasgow, G2 7HX, UK  
 Tel: 0141 204 2511 Fax: 0141 226 3109  
 www.jacobsbattie.com

**Hamilton & McGregor**  
 ACOUSTICS DIVISION

Client	Aberdeen Western Peripheral Route		
Project	Aberdeen Western Peripheral Route Environmental Statement, Part C - Southern Leg		
Title	Predicted LA10(18hours) dB with Mitigation (Receiver Height = 4.5m) Sheet 3 of 8		
Drawing Status	FINAL	Revisions	
JB No.	0010332	Date	July 2007
Figure No.	FIGURE 30.4c	Drawn	RB
Scale	1:10,000	Checked	BMCK
		Approved	SH

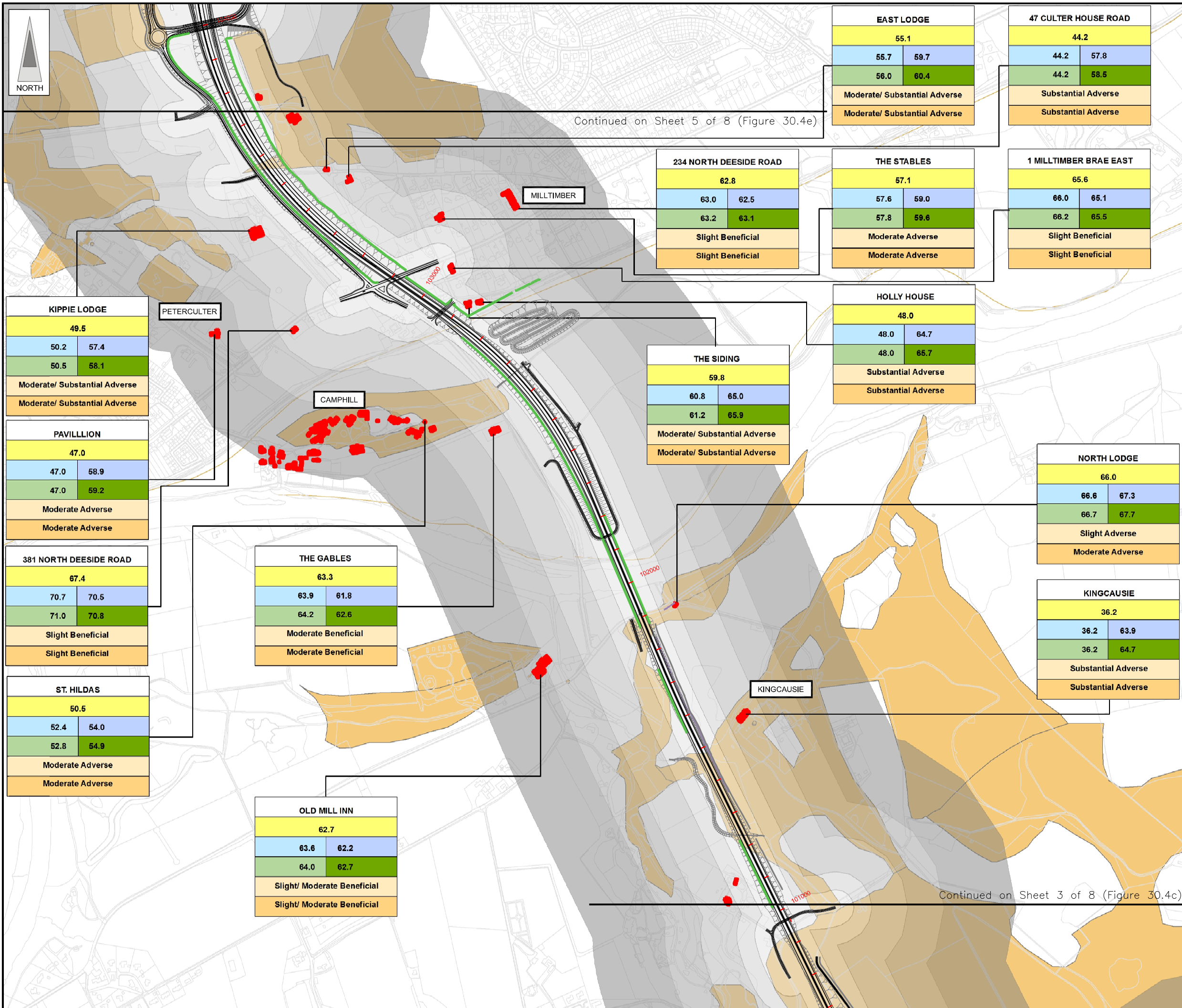


FIGURE 30.4d



Continued on Sheet 5 of 8 (Figure 30.4e)

Continued on Sheet 3 of 8 (Figure 30.4c)



KIPPIE LODGE	
49.5	
50.2	57.4
50.5	58.1
Moderate/ Substantial Adverse	
Moderate/ Substantial Adverse	

PAVILLION	
47.0	
47.0	58.9
47.0	59.2
Moderate Adverse	
Moderate Adverse	

381 NORTH DEESIDE ROAD	
67.4	
70.7	70.5
71.0	70.8
Slight Beneficial	
Slight Beneficial	

ST. HILDAS	
50.5	
52.4	54.0
52.8	54.9
Moderate Adverse	
Moderate Adverse	

THE GABLES	
63.3	
63.9	61.8
64.2	62.6
Moderate Beneficial	
Moderate Beneficial	

OLD MILL INN	
62.7	
63.6	62.2
64.0	62.7
Slight/ Moderate Beneficial	
Slight/ Moderate Beneficial	

234 NORTH DEESIDE ROAD	
62.8	
63.0	62.5
63.2	63.1
Slight Beneficial	
Slight Beneficial	

THE SIDING	
59.8	
60.8	65.0
61.2	65.9
Moderate/ Substantial Adverse	
Moderate/ Substantial Adverse	

EAST LODGE	
55.1	
55.7	59.7
56.0	60.4
Moderate/ Substantial Adverse	
Moderate/ Substantial Adverse	

THE STABLES	
57.1	
57.6	59.0
57.8	59.6
Moderate Adverse	
Moderate Adverse	

HOLLY HOUSE	
48.0	
48.0	64.7
48.0	65.7
Substantial Adverse	
Substantial Adverse	

47 CULTER HOUSE ROAD	
44.2	
44.2	57.8
44.2	58.5
Substantial Adverse	
Substantial Adverse	

1 MILLTIMBER BRAE EAST	
65.6	
66.0	65.1
66.2	65.5
Slight Beneficial	
Slight Beneficial	

NORTH LODGE	
66.0	
66.6	67.3
66.7	67.7
Slight Adverse	
Moderate Adverse	

KINGCAUSIE	
36.2	
36.2	63.9
36.2	64.7
Substantial Adverse	
Substantial Adverse	

**LEGEND**

- Proposed Route (Engineering Profile 04/05/07)
- 0-50m
- >50-100m
- >100-200m
- >200-300m
- >300-500m
- Sample Properties
- Non Residential Receptors
- Barriers

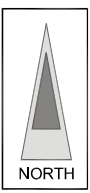
Location Name	
BASE 2005	
Do Minimum Year of Opening	Do Something Year of Opening
Do Minimum Design Year	Do Something Design Year
SIGNIFICANCE OF IMPACT Year of Opening	
SIGNIFICANCE OF IMPACT Design Year	

**JE JACOBS**  
 95 Bothwell Street, Glasgow, G2 7HX, UK  
 Tel: 0141 204 2511 Fax: 0141 226 3109  
 www.jacobsabtie.com

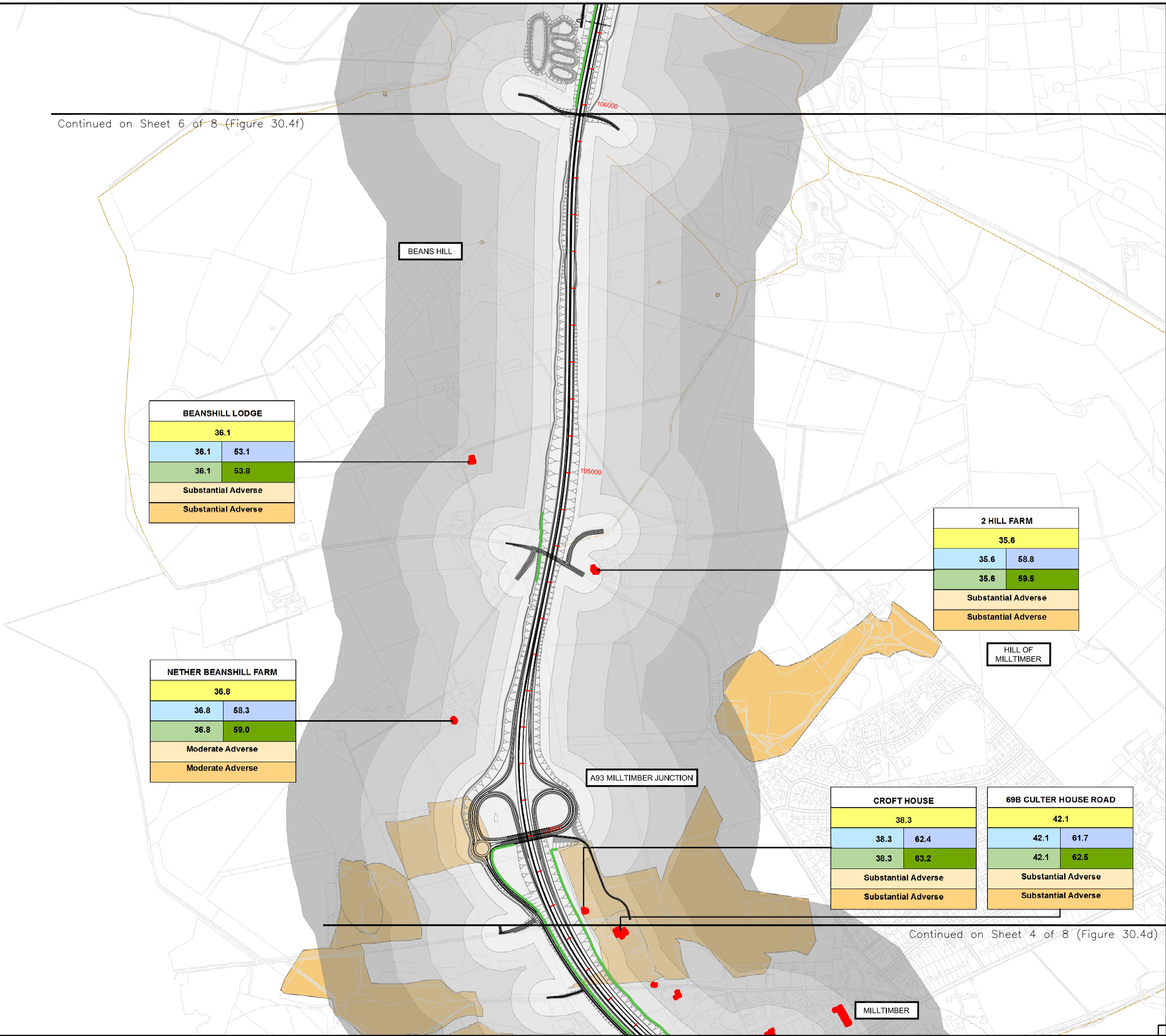
**Hamilton & McGregor**  
 ACOUSTICS DIVISION

Client	Aberdeen Western Peripheral Route	
Project	Aberdeen Western Peripheral Route Environmental Statement, Part C - Southern Leg	
Title	Predicted LA10(18hours) dB with Mitigation (Receiver Height = 4.5m) Sheet 4 of 8	
Drawing Status	FINAL	
JB No.	0010332	
Figure No.	FIGURE 30.4d	Revisions
Scale	1:10,000	Date July 2007
Drawn	RB	Checked BMcK
		Approved SH





Continued on Sheet 6 of 8 (Figure 30.4f)



BEANSHILL LODGE	
36.1	
36.1	53.1
36.1	53.8
Substantial Adverse	
Substantial Adverse	

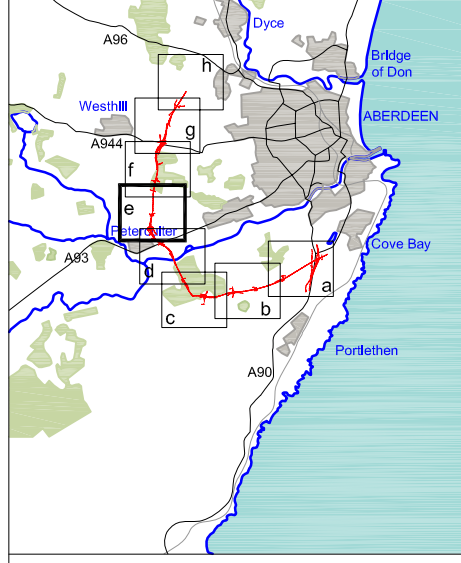
2 HILL FARM	
35.6	
35.6	58.8
35.6	59.5
Substantial Adverse	
Substantial Adverse	

NETHER BEANSHILL FARM	
36.8	
36.8	58.3
36.8	59.0
Moderate Adverse	
Moderate Adverse	

CROFT HOUSE	
38.3	
38.3	62.4
38.3	63.2
Substantial Adverse	
Substantial Adverse	

69B CULTER HOUSE ROAD	
42.1	
42.1	61.7
42.1	62.5
Substantial Adverse	
Substantial Adverse	

FIGURE 30.4e



**LEGEND**

- Proposed Route (Engineering Profile 04/05/07)
- 0-50m
- >50-100m
- >100-200m
- >200-300m
- >300-500m
- Sample Properties
- Non Residential Receptors
- Barriers

Location Name	
BASE 2005	
Do Minimum Year of Opening	Do Something Year of Opening
Do Minimum Design Year	Do Something Design Year
SIGNIFICANCE OF IMPACT Year of Opening	
SIGNIFICANCE OF IMPACT Design Year	

**JE JACOBS**  
 95 Bothwell Street, Glasgow, G2 7HX, UK  
 Tel: 0141 204 2511 Fax: 0141 226 3109  
 www.jacobsbattle.com

**Hamilton & McGregor**  
 ACOUSTICS DIVISION

Client: Aberdeen Western Peripheral Route

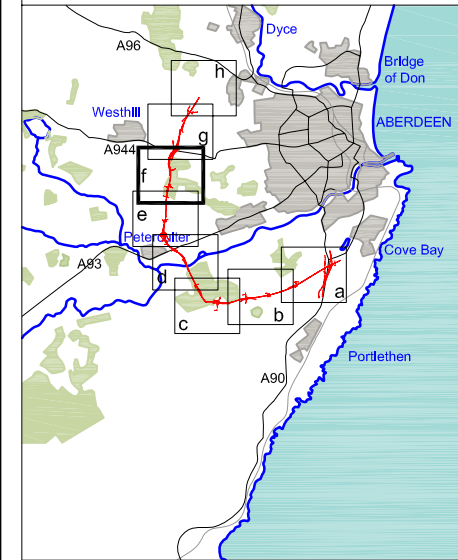
Project: Aberdeen Western Peripheral Route Environmental Statement, Part C - Southern Leg

Title: Predicted LA10(18hours) dB with Mitigation (Receiver Height = 4.5m)  
 Sheet 5 of 8

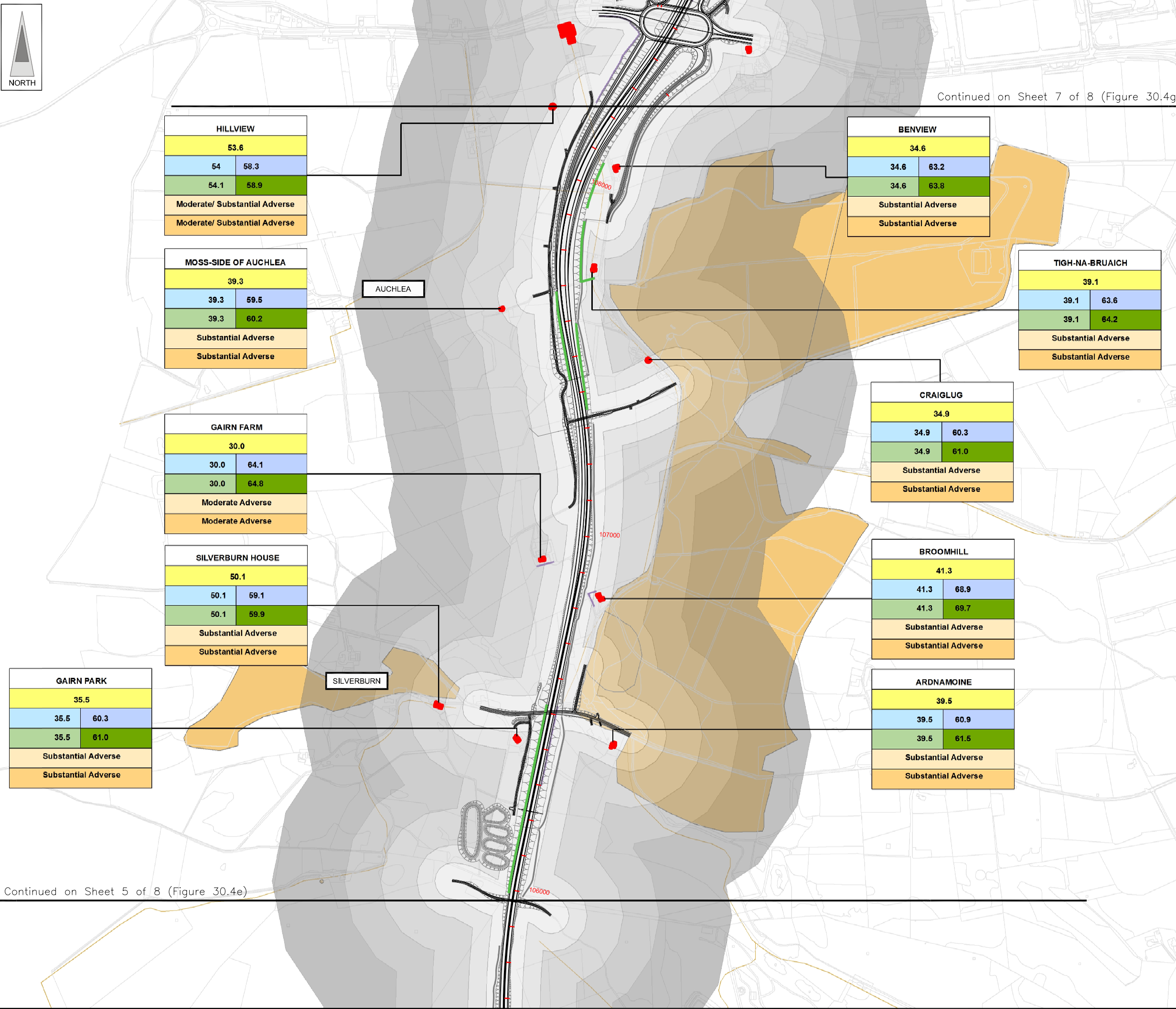
Drawing Status	FINAL	Revisions	
JB No.	0010332	Date	July 2007
Figure No.	FIGURE 30.4e	Approved	SH
Scale	1:10,000	Checked	BMcK
Drawn	RB	Approved	SH



FIGURE 30.4f



Continued on Sheet 7 of 8 (Figure 30.4g)



Continued on Sheet 5 of 8 (Figure 30.4e)

**LEGEND**

- Proposed Route (Engineering Profile 04/05/07)
- 0-50m
- >50-100m
- >100-200m
- >200-300m
- >300-500m
- Sample Properties
- Non Residential Receptors
- Barriers

Location Name	
BASE 2005	
Do Minimum Year of Opening	Do Something Year of Opening
Do Minimum Design Year	Do Something Design Year
SIGNIFICANCE OF IMPACT Year of Opening	
SIGNIFICANCE OF IMPACT Design Year	

**JE JACOBS**  
 95 Bothwell Street, Glasgow, G2 7HX, UK  
 Tel: 0141 204 2511 Fax: 0141 226 3109  
 www.jacobsbabtie.com

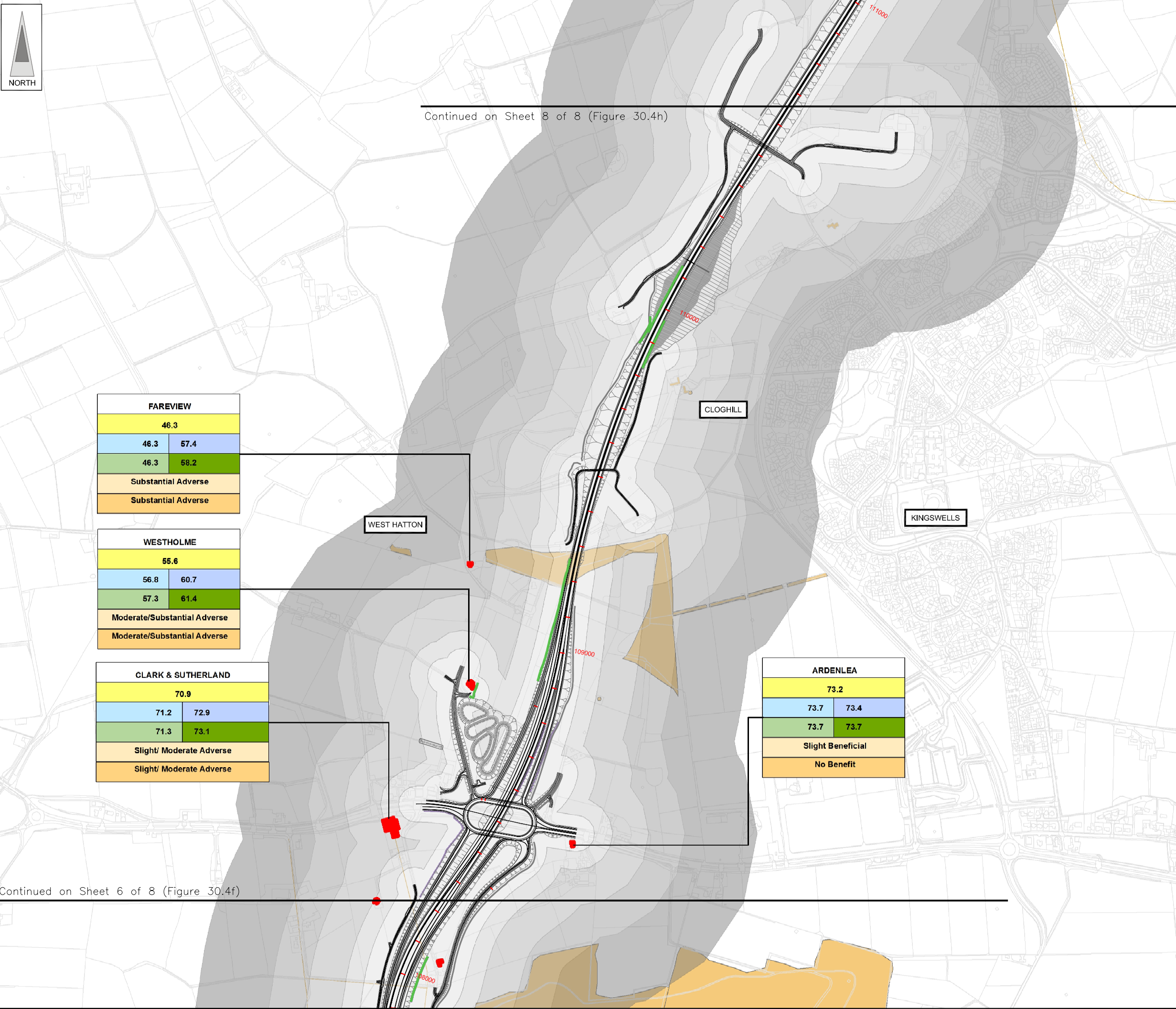
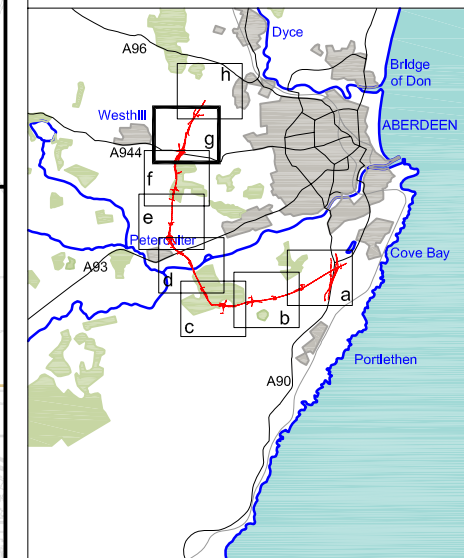
**Hamilton & McGregor**  
 ACOUSTICS DIVISION

Client	Aberdeen Western Peripheral Route		
Project	Aberdeen Western Peripheral Route Environmental Statement, Part C - Southern Leg		
Title	Predicted LA10(18hours) dB with Mitigation (Receiver Height = 4.5m) Sheet 6 of 8		
Drawing Status	FINAL	Revisions	
JB No.	0010332	Date July 2007	
Figure No.	FIGURE 30.4f	Drawn	Approved
Scale	1:10,000	RB	SH
		Checked	Approved
		BMcK	SH

This map is based on Ordnance Survey material with the permission of Ordnance Survey on behalf of the controller of Her Majesty's Stationery Office. Crown copyright. Unauthorized reproduction infringes Crown copyright and may lead to prosecution or civil proceedings. Scottish Executive Licence Number, 100020540 (2007).



FIGURE 30.4g



Continued on Sheet 8 of 8 (Figure 30.4h)

Continued on Sheet 6 of 8 (Figure 30.4f)

FAREVIEW	
46.3	
46.3	57.4
46.3	58.2
Substantial Adverse	
Substantial Adverse	

WESTHOLME	
55.6	
56.8	60.7
57.3	61.4
Moderate/Substantial Adverse	
Moderate/Substantial Adverse	

CLARK & SUTHERLAND	
70.9	
71.2	72.9
71.3	73.1
Slight/ Moderate Adverse	
Slight/ Moderate Adverse	

ARDENLEA	
73.2	
73.7	73.4
73.7	73.7
Slight Beneficial	
No Benefit	

- LEGEND**
- Proposed Route (Engineering Profile 04/05/07)
  - 0-50m
  - >50-100m
  - >100-200m
  - >200-300m
  - >300-500m
  - Sample Properties
  - Non Residential Receptors
  - Barriers

Location Name	
BASE 2005	
Do Minimum Year of Opening	Do Something Year of Opening
Do Minimum Design Year	Do Something Design Year
SIGNIFICANCE OF IMPACT Year of Opening	
SIGNIFICANCE OF IMPACT Design Year	

**JE JACOBS**  
 95 Bothwell Street, Glasgow, G2 7HX, UK  
 Tel: 0141 204 2511 Fax: 0141 226 3109  
 www.jacobsbattle.com

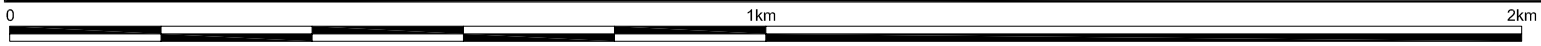
**Hamilton & McGregor**  
 ACOUSTICS DIVISION

Client: Aberdeen Western Peripheral Route

Project: Aberdeen Western Peripheral Route Environmental Statement, Part C - Southern Leg

Title: Predicted LA10(18hours) dB with Mitigation (Receiver Height = 4.5m)  
 Sheet 7 of 8

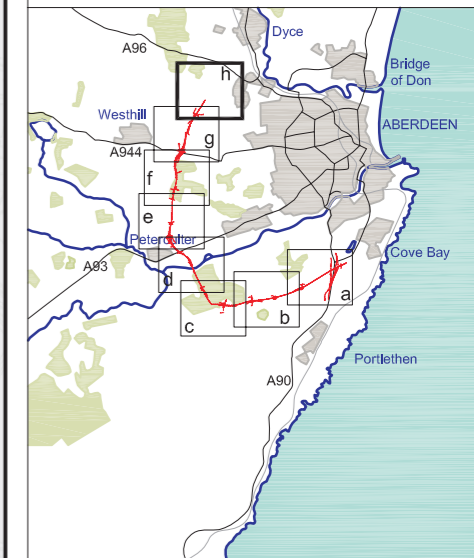
Drawing Status	FINAL
JB No.	0010332
Figure No.	FIGURE 30.4g
Scale	1:10,000
Drawn	RB
Checked	BMCK
Date	July 2007
Approved	SH



This map is based on Ordnance Survey material with the permission of Ordnance Survey on behalf of the controller of Her Majesty's Stationary Office. Crown copyright. Unauthorized reproduction infringes Crown copyright and may lead to prosecution or civil proceedings. Scottish Executive Licence Number, 100020540 (2007).  
 This drawing is not to be used in whole or part other than for the intended purpose and project as defined on this drawing. Refer to the contract for full terms and conditions. Maps produced by Jacobs UK Ltd. This map should NOT be rescaled. Copyright reserved.



FIGURE 30.4h



Continued on Sheet 7 of 8 (Figure 30.4g)

**LEGEND**

- Proposed Route  
(Engineering Profile 04/05/07)
- 0-50m
- >50-100m
- >100-200m
- >200-300m
- >300-500m
- Sample Properties
- Non Residential Receptors
- Barriers

Location Name	
BASE 2005	
Do Minimum Year of Opening	Do Something Year of Opening
Do Minimum Design Year	Do Something Design Year
SIGNIFICANCE OF IMPACT Year of Opening	
SIGNIFICANCE OF IMPACT Design Year	

**JE JACOBS**  
 95 Bothwell Street, Glasgow, G2 7HX, UK  
 Tel: 0141 204 2511 Fax: 0141 226 3109  
 www.jacobsabtable.com

**Hamilton & McGregor**  
 ACOUSTICS DIVISION

Client **Aberdeen Western Peripheral Route**

Project **Aberdeen Western Peripheral Route  
 Environmental Statement, Part C - Southern Leg**

Title **Predicted LA10(18hours) dB with  
 Mitigation (Receiver Height = 4.5m)  
 Sheet 8 of 8**

Drawing Status	FINAL	Revisions	
JB No.	0010332	Date	July 2007
Figure No.	FIGURE 30.4h	Drawn	Approved
Scale	1:10,000	RB	SH
		Checked	Approved
		BMcK	SH